



CONSULTANTS  
**NEUF ARCHITECTS**  
 630 RENÉ-LÉVESQUE BLVD W SUITE 3200, MONTREAL, QC H3B 1S6  
 514-847-1117

SURVEYORS  
**Stantec**  
 1331 CLYDE AVE SUITE 400, OTTAWA, ON K2C 3G4  
 613.722.4420

- GENERAL NOTES
- IT IS THE RESPONSIBILITY OF THE APPROPRIATE CONTRACTOR OR OFFICIAL TO REPORT ANY ERRORS, OMISSIONS OR DISCREPANCIES ON THIS PLAN WITH ACTUAL SITE CONDITIONS TO THE LANDSCAPE ARCHITECT BEFORE PROCEEDING WITH CONSTRUCTION.
  - THE CONTRACTOR IS TO NOTIFY ALL UTILITY COMPANIES AND AUTHORITIES PRIOR TO ANY EXCAVATION AND ASCERTAIN LOCATIONS OF UNDERGROUND SERVICES.
  - THE CONTRACTOR IS TO REINSTATE ALL AREAS AND ITEMS DAMAGED AS A RESULT OF CONSTRUCTION ACTIVITY.
  - THE CONTRACTOR IS TO COMPLY WITH ALL PERTINENT CODES AND BY-LAWS.
  - THE CONTRACTOR IS TO MAINTAIN A POSITIVE SURFACE RUN-OFF THROUGHOUT THE ENTIRE CONSTRUCTION PERIOD.
  - THE LANDSCAPE ARCHITECT IS NOT RESPONSIBLE FOR SUBSURFACE CONDITIONS.
  - THE CONTRACTOR IS TO IDENTIFY ALL EXISTING TREES TO REMAIN ON SITE WITH THE LANDSCAPE ARCHITECT PRIOR TO CONSTRUCTION.
  - THE CONTRACTOR IS TO STAKE THE PROPOSED LOCATION OF ALL PLANT MATERIAL IN CONJUNCTION WITH THE LANDSCAPE ARCHITECT PRIOR TO EXCAVATION.
  - MINIMUM DISTANCES FOR SELECTED DECIDUOUS TREES ARE AS FOLLOWS:
    - BUILDING FOUNDATIONS 7.5M
    - SIDEWALKS 1.5M
    - PUBLIC STREETS 2.5M
    - UNDERGROUND INFRASTRUCTURE 2.0M
  - ALL TREES WITHIN 1M OF UNDERGROUND UTILITY TRENCHES ARE TO BE EXCAVATED BY HAND.
  - REMOVE ALL PROTECTIVE WRAPPING FROM TREE TRUNKS AFTER INSTALLATION.
  - STAKING OF TREES SHALL ONLY BE PERFORMED IF NECESSARY.
  - ENSURE THAT MULCH IS PULLED BACK A MIN. DISTANCE OF 75MM FROM BASE OF TREE TRUNK.

No.	Issue	Date	By
2	ISSUED FOR COORDINATION AND REVIEW	09/23/2020	ML / JL
1	ISSUED FOR SITE PLAN CONTROL	03/20/2020	ML / JL

**JAMES B. LENNOX & ASSOCIATES INC.**  
 LANDSCAPE ARCHITECTS  
 3332 CARLING AVE. OTTAWA, ONTARIO K2H 5A8  
 Tel. (613) 722-5168 Fax. (1866) 343-3942

PROJECT  
 MIXED USE APARTMENT BUILDING  
 320 McRAE AVENUE, OTTAWA, ON

DRAWING  
 LANDSCAPE PLAN

STAMP  
  
 SCALE  
 AS SHOWN  
 START DATE  
 JUNE, 2019  
 PROJECT NO.  
 19MIS1965

PROJECT NORTH  
  
 DRAWING NO.  
**L.1**  
 PLOT SIZE ARCH-D

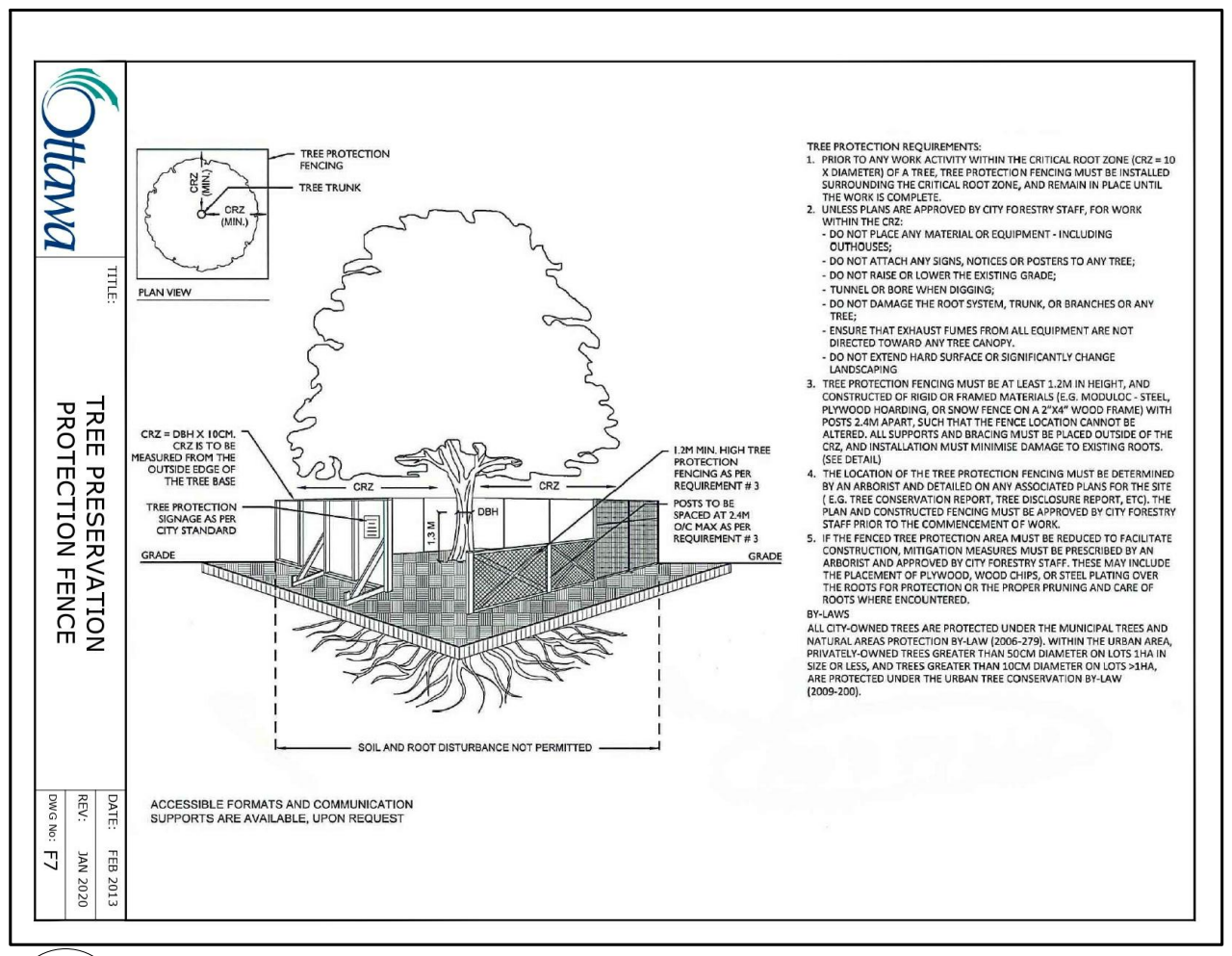
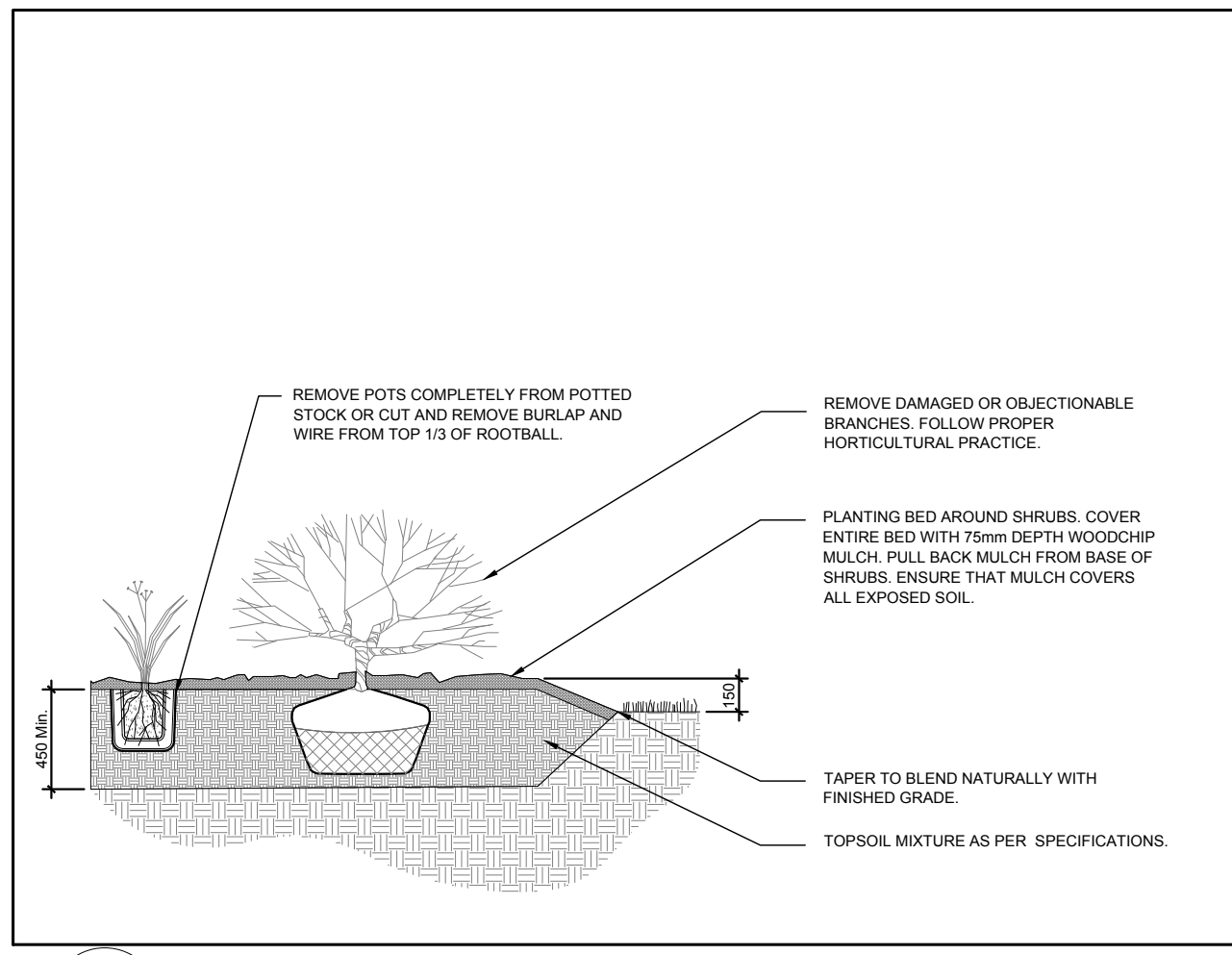
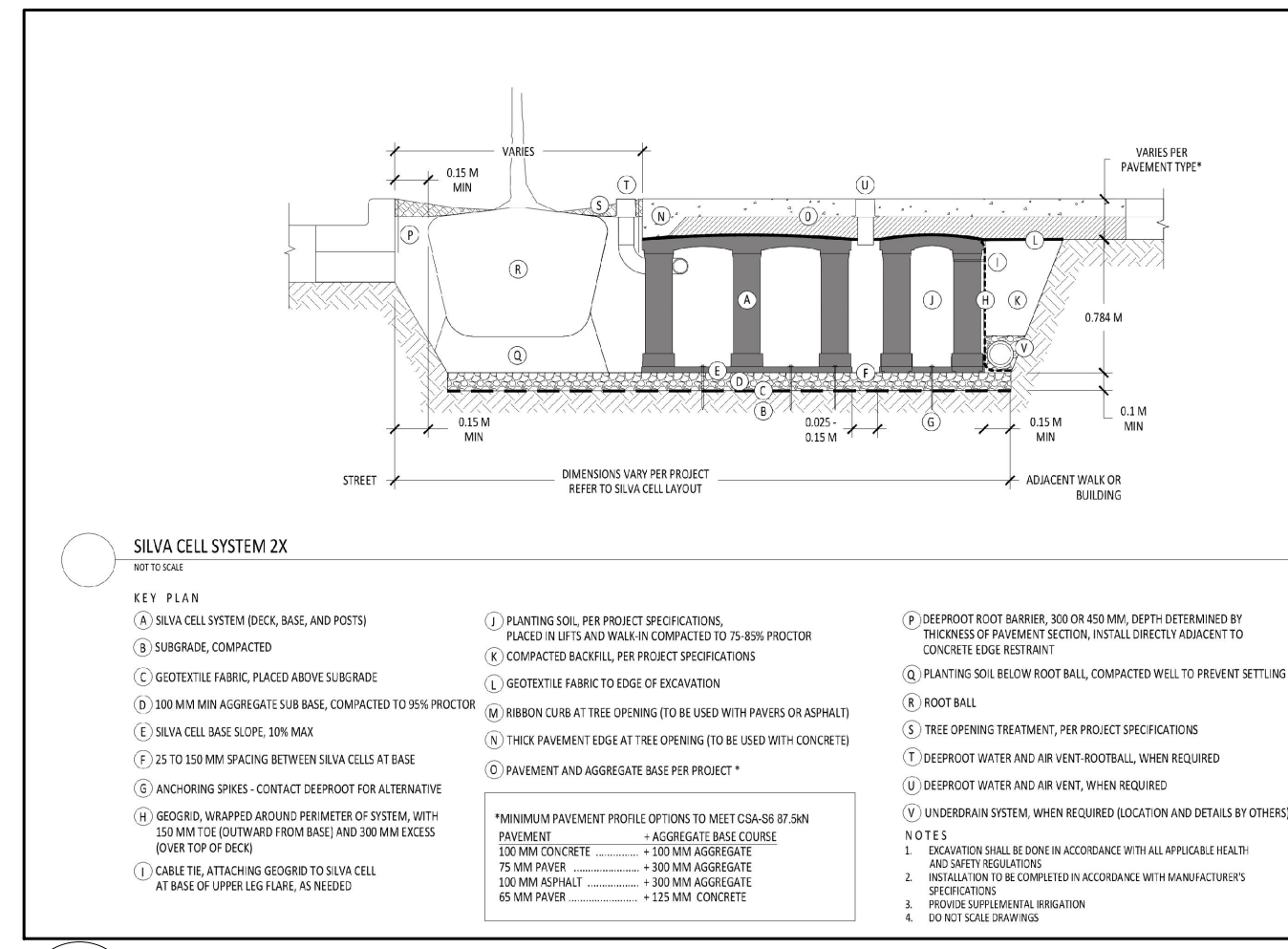

**PROPOSED PLANT LIST**

KEY	QTY	BOTANICAL NAME	COMMON NAME	SIZE	CONDITION	REMARKS
<b>TREES</b>						
AM	2	<i>Acer ginnala</i>	Amur Maple	60mm ø	B&B	Single leader
GB	3	<i>Ginkgo biloba</i> 'Princeton Sentry'	Princeton Sentry Ginkgo	60mm ø	B&B	Male tree
HL	5	<i>Gleditsia triacanthos</i> 'Draves'	Street Keeper Honey Locust	60mm ø	B&B	
<b>SHRUBS</b>						
SS	7	<i>Sorbaria sorbifolia</i> 'Sem'	Sem False Spirea	600mm Ht.	Potted	Space 1000mm O.C.
<b>ORNAMENTAL GRASSES</b>						
KF	33	<i>Calamagrostis x acutiflora</i> 'Karl Foerster'	Feather Reed Grass	250mm pot	Potted	Space 800mm O.C.
SG	58	<i>Panicum virgatum</i> 'Shenandoah'	Shenandoah Switch Grass	250mm pot	Potted	Space 800mm O.C.

- LEGEND
- EXISTING TREE TO REMAIN
  - PROPOSED DECIDUOUS TREE IN LANDSCAPE AREA REFER TO DETAIL 2/L.1
  - PROPOSED SHRUBS AND PERENNIALS
  - PROPOSED TABLE AND CHAIRS
  - PROPOSED 1.5m H. SCREEN FENCE
  - PROPOSED 1.8m H. PRIVACY FENCE
  - PROPOSED TREE PROTECTION FENCE SEE DETAIL 4/L.1 THIS SHEET
  - PROPOSED CONCRETE PAVERS TYPE I
  - PROPOSED CONCRETE PAVERS TYPE II
  - PROPOSED PERMEABLE PAVERS
  - PROPOSED SOIL
  - PROPOSED PEASTONE MULCH
  - PROPOSED SILVA CELL AREA
  - PROPOSED 75mm OF COMPOSTED PINE MULCH
  - EXISTING UTILITY POLE
  - EXISTING GATCH BASIN
  - EXISTING FIRE HYDRANT

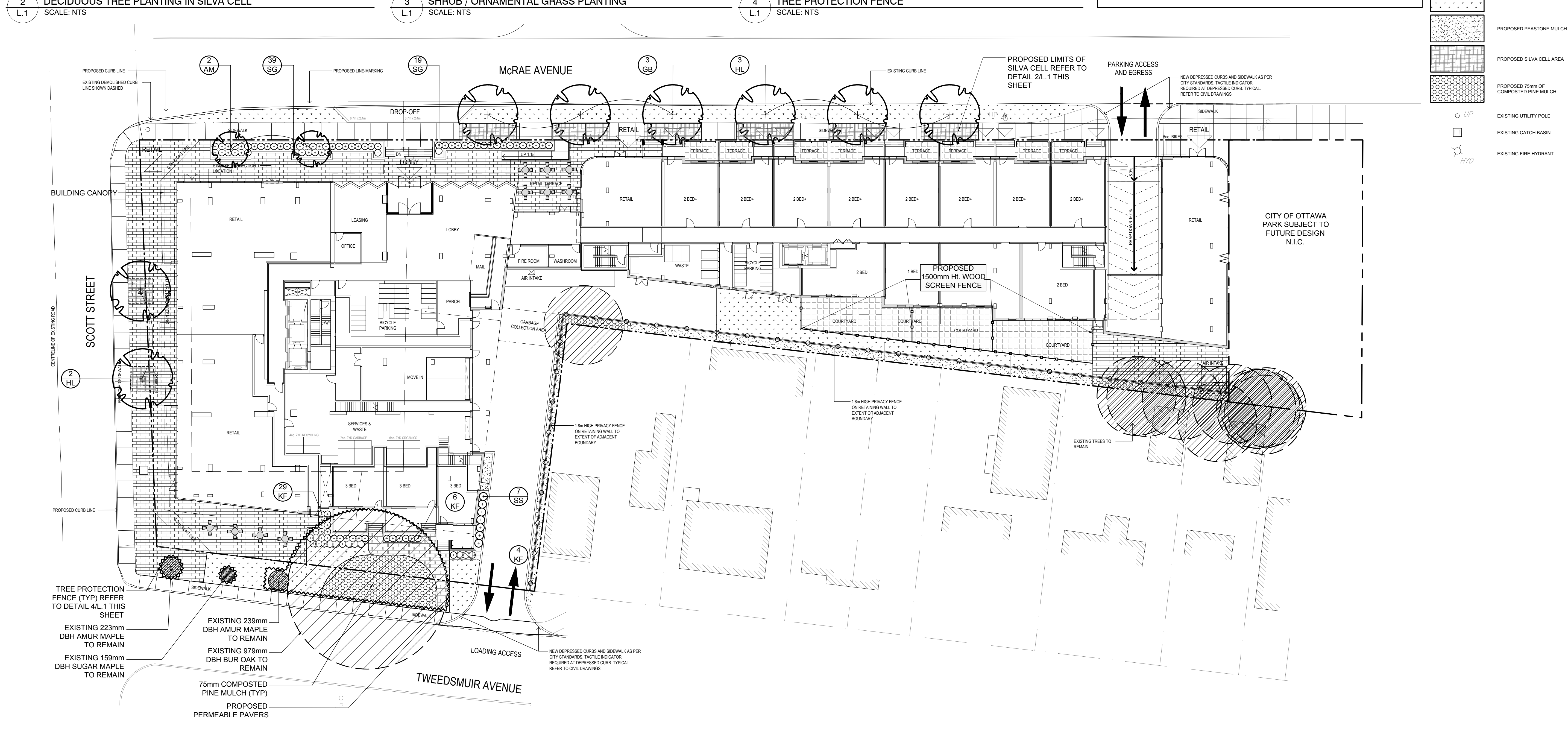

**1 LANDSCAPE PLAN**  
 SCALE 1:250

0 2 4 6 8 10m

TREE PROTECTION FENCE (TYP) REFER TO DETAIL 4/L.1 THIS SHEET

EXISTING 223mm DBH AMUR MAPLE TO REMAIN

EXISTING 159mm DBH SUGAR MAPLE TO REMAIN

EXISTING 239mm DBH AMUR MAPLE TO REMAIN

EXISTING 979mm DBH BUR OAK TO REMAIN

75mm COMPOSTED PINE MULCH (TYP)

PROPOSED PERMEABLE PAVERS