

**SITE PLAN**  
ÉCHELLE: 1 : 400

**APPROVED**  
By Kersten Nitsche at 4:22 pm, Apr 18, 2024

*Kersten Nitsche*

**KERSTEN NITSCHÉ, MCIP RPP  
MANAGER (A), DEVELOPMENT REVIEW WEST  
PLANNING, DEVELOPMENT AND BUILDING SERVICES  
DEPARTMENT, CITY OF OTTAWA**

**GENERAL SYMBOLS LEGEND**

- LOT LINES
- SETBACK LINES
- EG. DIMENSIONS
- SYMBOLS:
  - MAIN ENTRANCE TO THE BUILDING
  - BOLLARD
- TEXTURES:
  - PRECAST PAVER
  - PROPOSED NEW LAWN
  - SIDE WALK

**GENERAL NOTE**

THE PROPERTY BOUNDARIES INDICATED ON THE SITE PLAN ARE DERIVED FROM TOPOGRAPHICAL PLAN OF SURVEY OF LOT 41, PART OF LOT 42, 56 AND 57 REGISTERED PLAN 311 CITY OF OTTAWA, SURVEYED BY ANNIS, O'SULLIVAN, VOLLEBECK TLD AND DATED 2019-04-30.

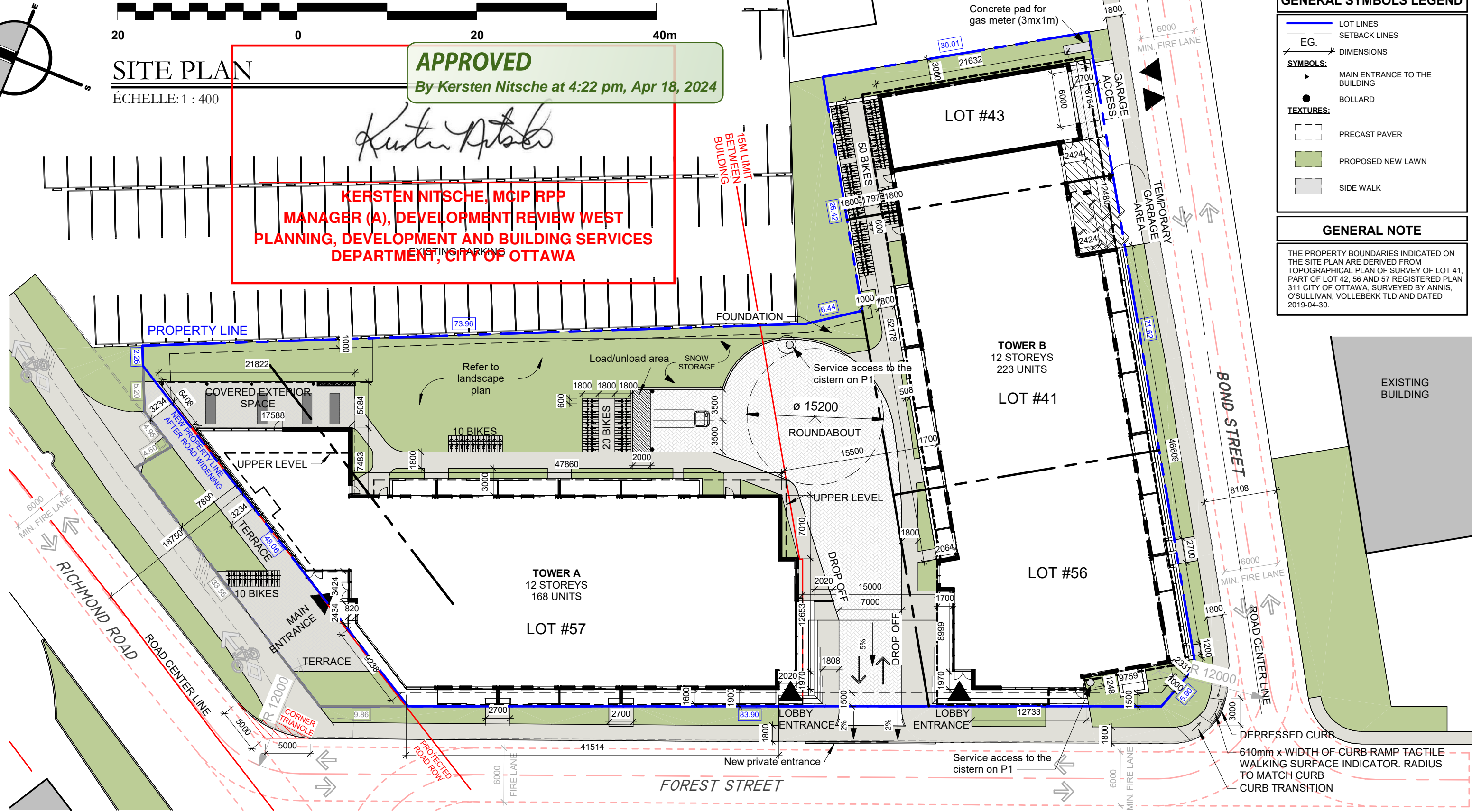

**GROUP HEAFEY**

365 Forest Street, 1420 Richmon Road and 2583-2589 Bond Street, Ottawa

**LAPALME RHEAULT**  
ARCHITECTES | ASSOCIÉS

Dessiné par : Tanya Nadeau  
Conçu par : Christian Rheault

53 blvd Saint-Raymond, Suite 200-A  
Gatineau, QC J8Y 1R8  
www.lrarch.ca

**PMA**  
ARCHITECTES

**Heafey**  
GROUP

As indicated  
1887-2303-19

D07-12-20-0041

|             |            |
|-------------|------------|
| REVISION 01 | 2020-12-18 |
| REVISION 02 | 2022-08-29 |
| REVISION 03 | 2022-12-09 |
| REVISION 04 | 2023-08-03 |
| REVISION 05 | 2023-10-18 |
| REVISION 06 | 2023-12-06 |
| REVISION 07 | 2024-01-18 |