

CONSULTANTS ARCHITECTS
NEUF ARCHITECTS/ES
6630, BOUL. RENE-LEVESQUE O. 32E ETAGE, MONTREAL, QC
TEL: (514) 847-1117

SURVEYORS:
ANNIS O'SULLIVAN VOLLEBEK LTD.
14, CONCOURSE GATE, SUITE 500, NEPEAN, ON
TEL: (613) 727-0850

CIVIL ENGINEERS:
NOVATECH ENG. CONSULTANTS LTD.
240, MICHAEL COWPLAND DRIVE, SUITE 200, OTTAWA, ON
TEL: (613) 234-9643

LEGEND

	EXISTING TREE TO REMAIN		EXISTING TREE TO BE REMOVED
	EXISTING GRASS/SHRUB/PERENNIAL MASS TO REMAIN		TREE PROTECTION FENCE
	PROPOSED DECIDUOUS TREE		PROPOSED CONIFEROUS TREE
	PROPOSED SHRUBS / PERENNIALS / ORNAMENTAL GRASSES / VINE		PROPOSED FLOWER BED BY OWNER
	PROPOSED PRECAST CONCRETE PAVERS TYPE 1		PROPOSED PRECAST CONCRETE PAVERS TYPE 2
	PROPOSED RIVERSTONE MULCH		PROPOSED SODDED AREA
	PROPOSED CONCRETE SIDEWALK		PROPOSED BENCH
	PROPOSED 1.8m HT. SOLID SOUND ATTENUATION FENCING BY ALCUF FENCING		PROPOSED 1.05m HT. METAL GUARDRAIL FENCE FOR RETAINING WALLS
	PROPOSED 1.8m HT. REGULAR WOOD SCREEN FENCE BY ALCUF FENCING		

5	ISSUED FOR SITE PLAN APPROVAL	11/04/2020	SH	JL
4	REVISED PER CHANGES TO SITE PLAN	09/04/2020	KS	JL
3	ISSUED FOR COORDINATION	08/07/2020	KS	JL
2	REVISED PER CITY COMMENTS	07/13/2020	KS	JL
1	ISSUED FOR SITE PLAN CONTROL	05/01/2020	ML	JL
No.	Issue	Date	ADDY/PT	DR CK

JAMES B. LENNOX & ASSOCIATES INC.
LANDSCAPE ARCHITECTS
3332 CARLING AVE. OTTAWA, ONTARIO K2H 5A8
Tel. (613) 722-5168 Fax. (613) 866-343-942

PROJECT
WATERFORD OTTAWA APARTMENTS
2425-2431 BANK STREET,
OTTAWA ON

DRAWING
TREE CONSERVATION REPORT AND
LANDSCAPE PLAN

STAMP
ASSOCIATION OF LANDSCAPE ARCHITECTS
MEMBER

SCALE
AS NOTED

START DATE
APRIL 2020

PROJECT NO.
20-MIS-2022

DRAWING NO.
L.1
PLOT SIZE ARCH-D

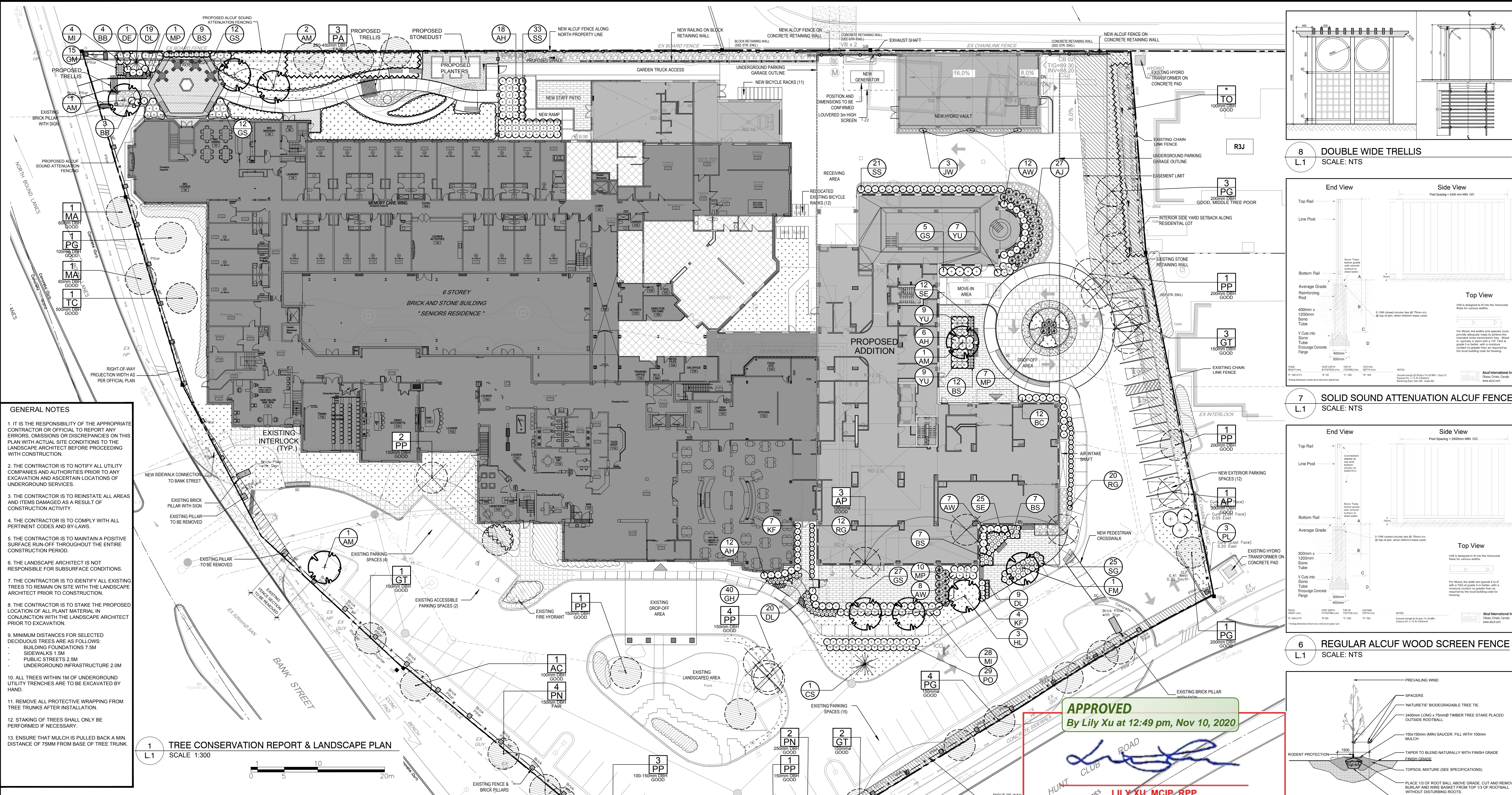

GENERAL NOTES

- IT IS THE RESPONSIBILITY OF THE APPROPRIATE CONTRACTOR OR OFFICIAL TO REPORT ANY ERRORS, OMISSIONS OR DISCREPANCIES ON THIS PLAN WITH ACTUAL SITE CONDITIONS TO THE LANDSCAPE ARCHITECT BEFORE PROCEEDING WITH CONSTRUCTION.
- THE CONTRACTOR IS TO NOTIFY ALL UTILITY COMPANIES AND AUTHORITIES PRIOR TO ANY EXCAVATION AND ASCERTAIN LOCATIONS OF UNDERGROUND SERVICES.
- THE CONTRACTOR IS TO RENSTATE ALL AREAS AND ITEMS DAMAGED AS A RESULT OF CONSTRUCTION ACTIVITY.
- THE CONTRACTOR IS TO COMPLY WITH ALL PERTINENT CODES AND BY-LAWS.
- THE CONTRACTOR IS TO MAINTAIN A POSITIVE SURFACE RUN-OFF THROUGHOUT THE ENTIRE CONSTRUCTION PERIOD.
- THE LANDSCAPE ARCHITECT IS NOT RESPONSIBLE FOR SUBSURFACE CONDITIONS.
- THE CONTRACTOR IS TO IDENTIFY ALL EXISTING TREES TO REMAIN ON SITE WITH THE LANDSCAPE ARCHITECT PRIOR TO CONSTRUCTION.
- THE CONTRACTOR IS TO STAKE THE PROPOSED LOCATION OF ALL PLANT MATERIAL IN CONJUNCTION WITH THE LANDSCAPE ARCHITECT PRIOR TO EXCAVATION.
- MINIMUM DISTANCES FOR SELECTED DECIDUOUS TREES ARE AS FOLLOWS:
BUILDING FOUNDATIONS 7.5M
SIDEWALKS 1.5M
PUBLIC STREETS 2.5M
UNDERGROUND INFRASTRUCTURE 2.0M
- ALL TREES WITHIN 1M OF UNDERGROUND UTILITY TRENCHES ARE TO BE EXCAVATED BY HAND.
- REMOVE ALL PROTECTIVE WRAPPING FROM TREE TRUNKS AFTER INSTALLATION.
- STAKING OF TREES SHALL ONLY BE PERFORMED IF NECESSARY.
- ENSURE THAT MULCH IS PULLED BACK A MIN. DISTANCE OF 75MM FROM BASE OF TREE TRUNK.

1 TREE CONSERVATION REPORT & LANDSCAPE PLAN
SCALE 1:300

PROPOSED PLANT LIST QTY KEY O/C = ON CENTRE

KEY	QTY	BOTANICAL NAME	COMMON NAME	SIZE	CONDITION	REMARKS
TREES						
AM	5	<i>Acer ginnala</i> 'Flame'	Flame Amur Maple	60mm CAL.	B&B	REFER TO PLAN
CS	1	<i>Picea pungens</i>	Colorado Spruce	1.5m HT.	B&B	REFER TO PLAN
FM	1	<i>Acer x freemanii</i>	Freeman's Maple	60mm CAL.	B&B	REFER TO PLAN
HL	3	<i>Gleditsia triacanthos</i> 'Draves'	Streetkeeper Honeylocust	60mm CAL.	B&B	REFER TO PLAN
SHRUBS						
AH	36	<i>Hydrangea arborescens</i> 'Annabelle'	Annabelle Hydrangea	3 GALLON POT	POTTED	800 mm O/C
AJ	27	<i>Juniperus horizontalis</i> 'Andorra Compacta'	Compact Andorra Juniper	600mm HT.	POTTED	800 mm O/C
AJ	27	<i>Spiraea x bumalda</i> 'Anthony Waterer'	Anthony Waterer Spirea	2 GALLON POT	POTTED	1000mm O/C
BB	12	<i>Sarothamnus fruticosus</i> 'Sunsation'	Sunsation Barberry	2 GALLON POT	POTTED	1000mm O/C
BC	27	<i>Berberis thunbergii</i> 'Concorde'	Concorde Barberry	2 GALLON POT	POTTED	1000mm O/C
GS	56	<i>Spiraea x arguta</i>	Garland Spirea	800mm SPR.	POTTED	1000 mm O/C
MP	18	<i>Pinus mugo</i> 'Pumilio'	Dwarf Mugo Pine	600mm SPR.	POTTED	800 mm O/C
PL	3	<i>Syringa vulgaris</i>	Common Purple Lilac	2000mm HT.	STRINGBALL	2000 mm O/C
PD	29	<i>Potentilla fruticosa</i> 'Goldfinger'	Goldfinger Potentilla	600mm HT.	POTTED	1000 mm O/C
SS	54	<i>Sorbus sorbifolia</i> 'Sem'	Sem False Spirea	600mm HT.	POTTED	800 mm O/C
TF	1	<i>Thuja occidentalis</i> 'Fastigiata'	Columnar Cedar	1200mm HT	POTTED	REFER TO PLAN - SPECIMEN

PERENNIALS AND ORNAMENTAL GRASSES

BS	35	<i>Rudbeckia hirta</i>	Black Eyed Susan	250mm POT	POTTED	800 mm O/C
DL	48	<i>Hemerocallis</i> 'Stella D'Oro'	Stella D'Oro Day Lily	150mm POT	POTTED	300 mm O/C
GH	40	<i>Hosta</i> 'Guacamole'	Guacamole Hosta	1 GALLON POT	POTTED	600 mm O/C
MI	15	<i>Coreopsis verticillata</i> 'Moonbeam'	Moonbeam Tickseed	100mm POT	POTTED	400 mm O/C
KF	11	<i>Calamagrostis</i> 'Karl Foerster'	Karl Foerster Grass	250mm POT	POTTED	800 mm O/C
GM	32	<i>Miscanthus sinensis</i>	Chinese Silver Grass	250mm POT	POTTED	1000 mm O/C
RG	32	<i>Phalaris arundinacea</i> 'Strawberries & Cream'	Strawberries & Cream Ribbon Grass	250mm POT	POTTED	600 mm O/C
SE	37	<i>Sedum</i> 'Autumn Joy'	Autumn Joy Sedum	100mm POT	POTTED	500 mm O/C
SG	25	<i>Panicum virgatum</i> 'Shenandoah'	Shenandoah Switch Grass	250mm POT	POTTED	800 mm O/C
YU	25	<i>Yucca glauca</i>	Spanish Bayonet	250mm POT	POTTED	1000 mm O/C
VINES						
JW	3	<i>Wisteria floribunda</i> 'Lawrence'	Japanese Wisteria	3 GALLON POT	POTTED	TRAIN UP WALL REQUIRES STRUCTURE

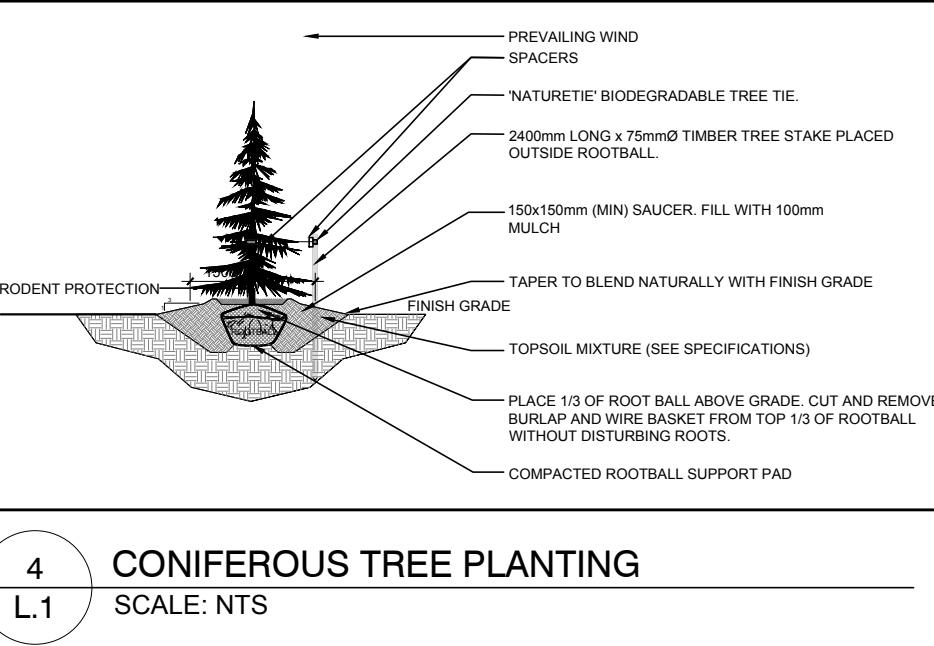
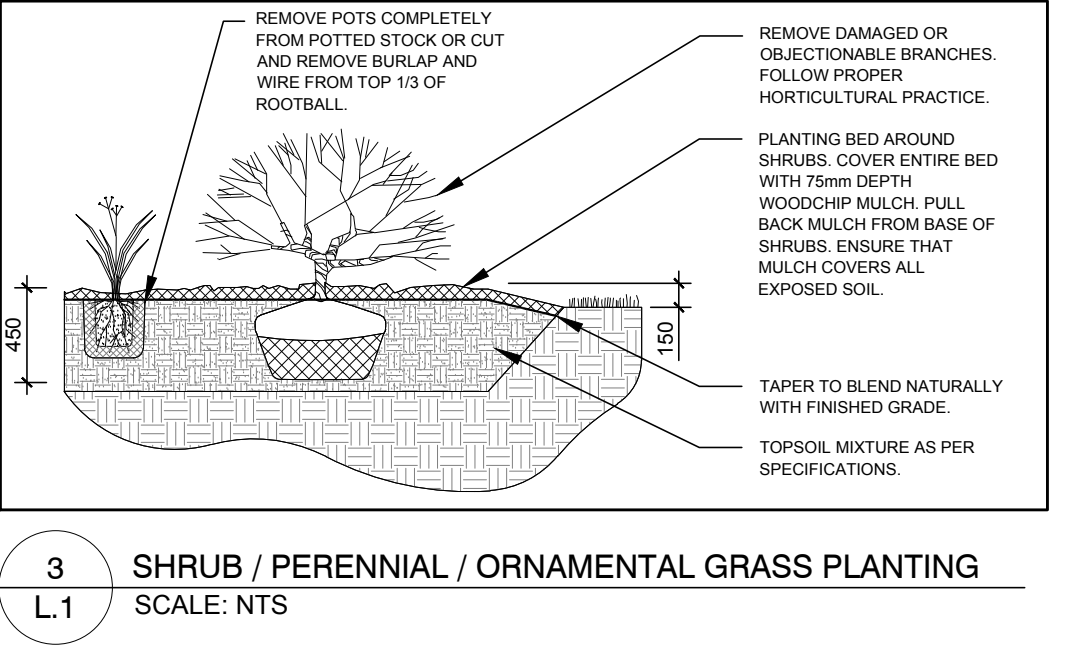
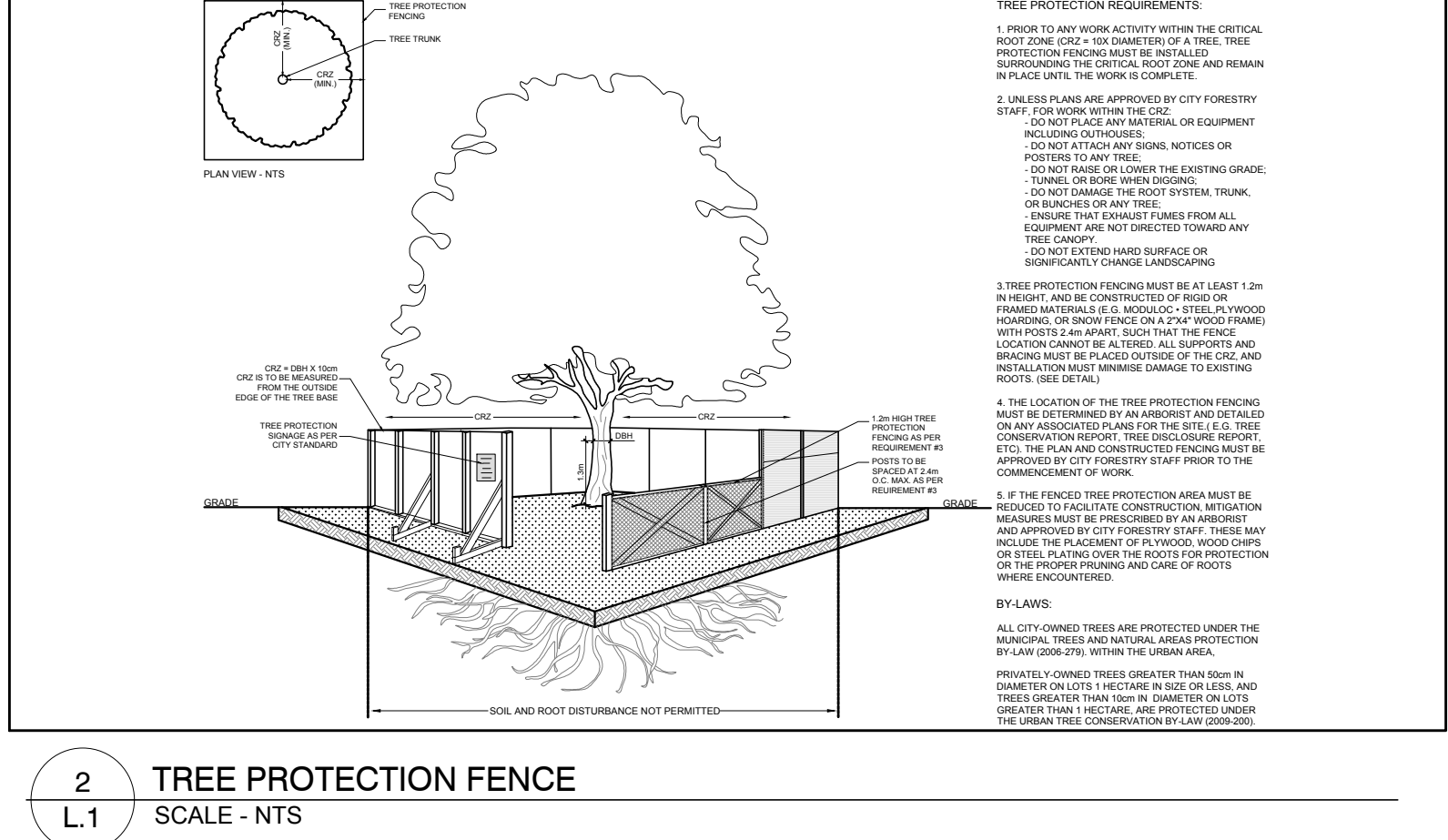

EXISTING TREE LIST QTY KEY *DENOTES NUMEROUS AA = AIRPORT AUTHORITY

KEY	QTY	BOTANICAL NAME	COMMON NAME	SIZE	CONDITION	REMARKS
AC	1	<i>Amenlancher canadensis</i>	Downy Serviceberry	100mm DBH	GOOD	CITY OWNED TREE - MAY NEED TO BE REMOVED - AA
AP	4	<i>Acer platanoides</i>	Norway Maple	100-300mm DBH	GOOD	REFER TO PLAN
GT	6	<i>Gleditsia triacanthos</i>	Honey Locust	150mm DBH	GOOD	REFER TO PLAN
MA	2	<i>Malus sp.</i>	Crabapple Species	60mm DBH	GOOD	CITY OWNED TREE - MAY NEED TO BE REMOVED - AA
PA	3	<i>Picea abies</i>	Norway Spruce	250-450mm DBH	FAIR	REFER TO PLAN
PG	9	<i>Picea glauca</i>	White Spruce	100-200mm DBH	POOR-GOOD	REFER TO PLAN
PN	6	<i>Pinus nigra</i>	Austrian Pine	150-250mm DBH	GOOD	REFER TO PLAN
PP	14	<i>Picea pungens</i>	Colorado Spruce	100-200mm DBH	GOOD	REFER TO PLAN
TC	1	<i>Thuja occidentalis</i>	Littleleaf Linden	500mm DBH	GOOD	REFER TO PLAN
TO	1	<i>Thuja occidentalis</i>	White Cedar Hedge	100mm DBH	GOOD	REFER TO PLAN - MAY NEED TO BE REMOVED - AA