

- LEGEND
- EXISTING TREE TO REMAIN
 - EXISTING TREE TO BE REMOVED
 - EXISTING SHRUB / PERENNIAL MASS TO REMAIN
 - PROPOSED CONCRETE SIDEWALK
 - TREE PROTECTION FENCE
 - PROPOSED DECIDUOUS TREE
 - PROPOSED CONIFEROUS TREE
 - PROPOSED SHRUBS / PERENNIALS / ORNAMENTAL GRASSES / VINE
 - PROPOSED PRECAST CONCRETE PAVERS TYPE 1
 - PROPOSED PRECAST CONCRETE PAVERS TYPE 2
 - PROPOSED PRECAST CONCRETE PAVERS TYPE 3
 - PROPOSED RIVERSTONE MULCH
 - PROPOSED SODDED GRASS AREA
 - PROPOSED PERENNIAL BED BY OWNER
 - PROPOSED BENCH
 - PROPOSED 1.2m Hl. ORNAMENTAL METAL FENCE
 - PROPOSED 1.5m Hl. GUARDRAIL FENCE FOR RETAINING WALLS

3			
2	ISSUED FOR SITE PLAN CONTROL	05/01/2020	ML JL
1		Date: 05/01/2020	DR CK

JAMES B. LENNOX & ASSOCIATES INC.
 LANDSCAPE ARCHITECTS
 3332 CARLING AVE. OTTAWA, ONTARIO K2H 3A8
 TEL: (613) 722-5168 FAX: (866) 343-3942

PROJECT:
 WATERFORD OTTAWA SENIORS APARTMENTS
 2425-2431 BANK STREET, OTTAWA ON

DRAWING:
 TREE CONSERVATION REPORT & LANDSCAPE PLAN

STAMP	SCALE
	AS SHOWN
	START DATE
	APRIL 2020
	PROJECT NO.
	20MIS2022

PROJECT NORTH

DRAWING NO. **L.1**

PLOT SIZE Arch D

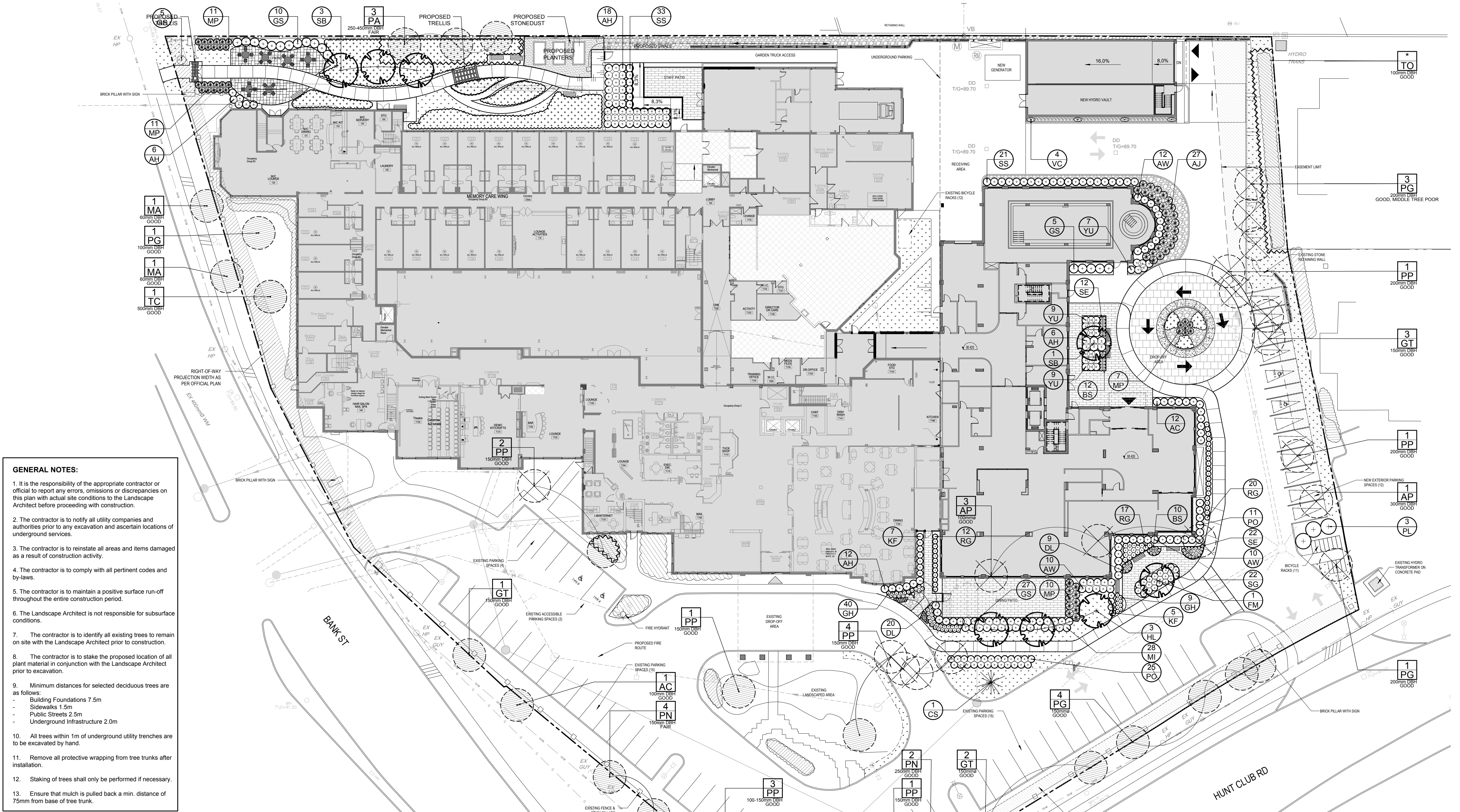

- GENERAL NOTES:**
- It is the responsibility of the appropriate contractor or official to report any errors, omissions or discrepancies on this plan with actual site conditions to the Landscape Architect before proceeding with construction.
 - The contractor is to notify all utility companies and authorities prior to any excavation and ascertain locations of underground services.
 - The contractor is to reinstate all areas and items damaged as a result of construction activity.
 - The contractor is to comply with all pertinent codes and by-laws.
 - The contractor is to maintain a positive surface run-off throughout the entire construction period.
 - The Landscape Architect is not responsible for subsurface conditions.
 - The contractor is to identify all existing trees to remain on site with the Landscape Architect prior to construction.
 - The contractor is to stake the proposed location of all plant material in conjunction with the Landscape Architect prior to excavation.
 - Minimum distances for selected deciduous trees are as follows:
 - Building Foundations 7.5m
 - Sidewalks 1.5m
 - Public Streets 2.5m
 - Underground Infrastructure 2.0m
 - All trees within 1m of underground utility trenches are to be excavated by hand.
 - Remove all protective wrapping from tree trunks after installation.
 - Staking of trees shall only be performed if necessary.
 - Ensure that mulch is pulled back a min. distance of 75mm from base of tree trunk.

1 TREE CONSERVATION REPORT & LANDSCAPE PLAN
 SCALE: 1:300

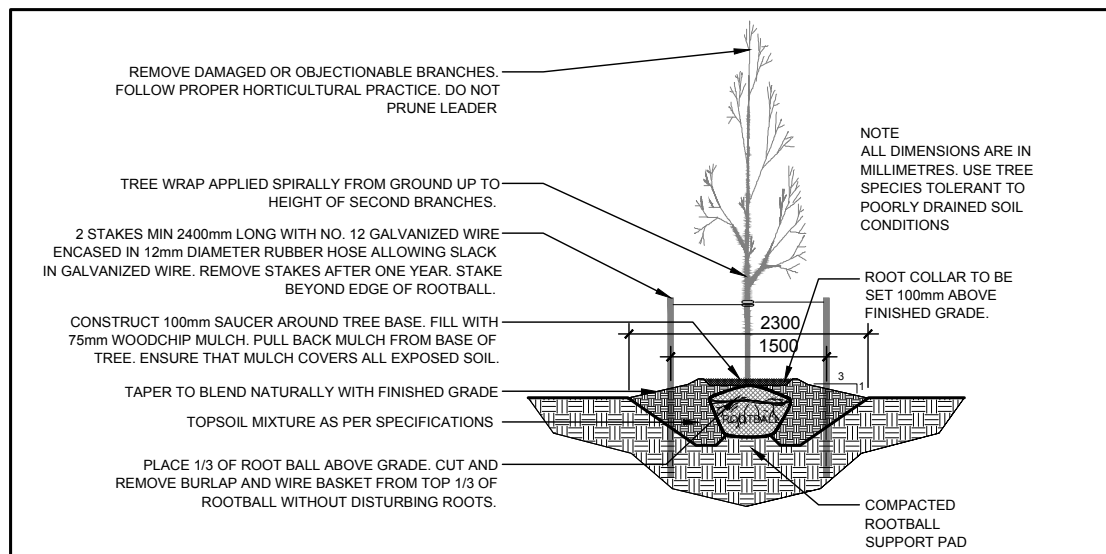

2 DECIDUOUS TREE PLANTING
 SCALE: NTS

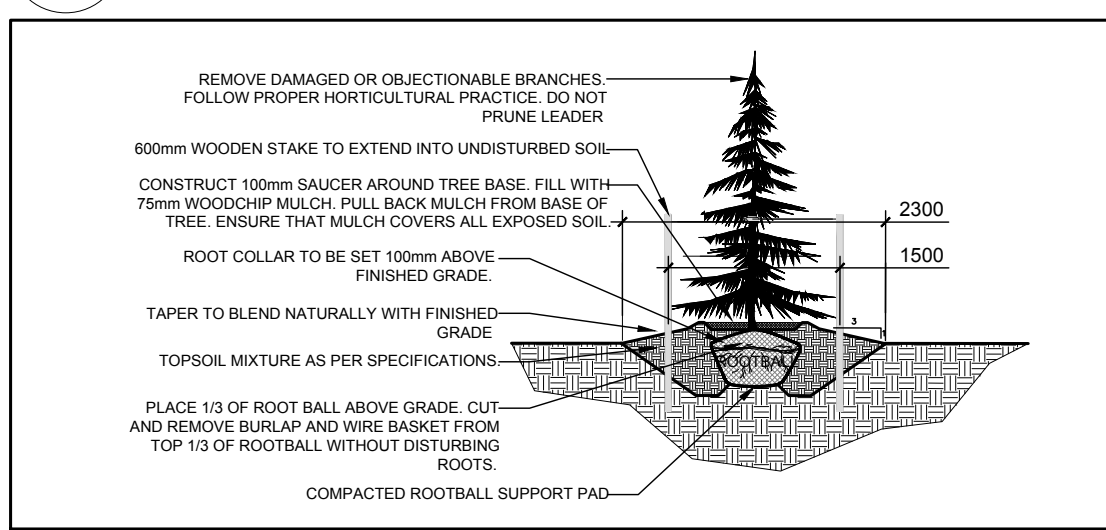

3 CONIFEROUS TREE PLANTING
 SCALE: NTS

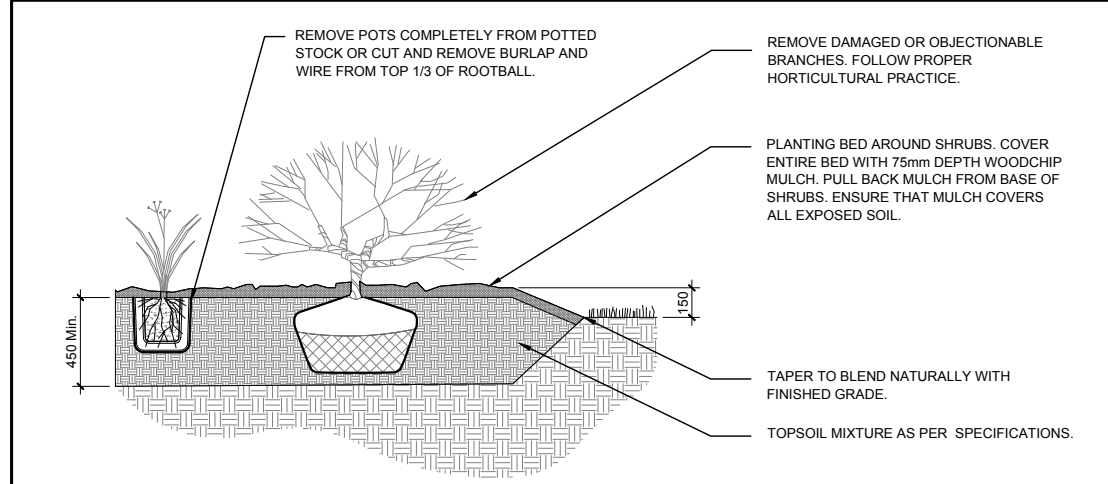

4 SHRUB / PERENNIAL / ORNAMENTAL GRASS PLANTING
 SCALE: NTS

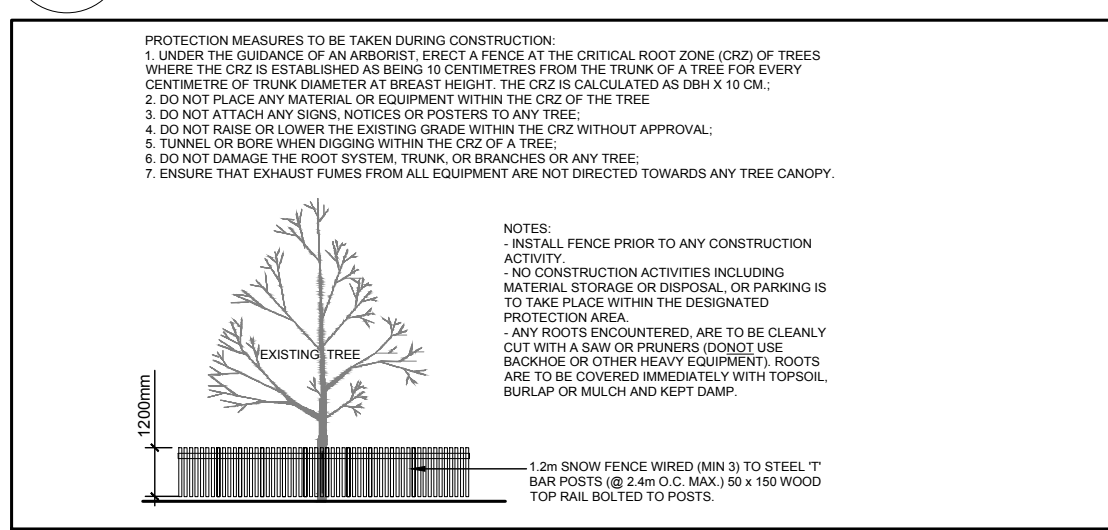

5 TREE PROTECTION FENCE
 SCALE: NTS

PROPOSED PLANT LIST

KEY	QTY	BOTANICAL NAME	COMMON NAME	SIZE	CONDITION	REMARKS
TREES						
CS	1	Picea pungens	Colorado Spruce	1.8m ht.	B&B	
FM	1	Acer x freemanii	Freeman's Maple	60mm cal.	B&B	
HL	3	Gleditsia triacanthos 'Draves'	Silverleaved Honeylocust	60mm cal.	B&B	
SB	4	Amelanchier canadensis	Serviceberry	60mm cal.	B&B	
SHRUBS						
AC	12	Ribes alpinum	Alpine Currant	600mm ht.	Potted	1000mm o.c.
AH	40	Hydrangea arborescens 'Annabelle'	Annabelle Hydrangea	3 gal. pot.	Potted	800 mm o.c.
AJ	27	Juniperus horizontalis 'Andorra Compacta'	Compact Andorra Juniper	600 mm spr.	Potted	800 mm o.c.
AW	33	Spiraea x bumalda 'Anthony Waterer'	Anthony Waterer Spiraea	600mm ht.	Potted	1000 mm o.c.
GS	43	Spiraea x arguta	Garland Spiraea	800mm spr.	Potted	1000 mm o.c.
MP	38	Pinus mugo 'Pumilio'	Dwarf Mugo Pine	600mm spr.	Potted	800mm o.c.
PL	3	Syringa vulgaris	Common Purple Lilac	2000mm ht.	Stringball	2000 mm o.c.
PO	36	Potentilla fruticosa 'Goldfinger'	Goldfinger Potentilla	600mm ht.	Potted	1000 mm o.c.
SS	64	Sorbaria sorbifolia 'Sem'	Sem False Spiraea	600mm ht.	Potted	800 mm o.c.
PERENNIALS & ORNAMENTAL GRASSES						
BS	22	Rudbeckia hirta	Black Eyed Susan	250mm pot	Potted	800 mm o.c.
DL	29	Hemerocallis 'Stella D'Oro'	Stella D'Oro Day Lily	150mm pot	Potted	300 mm o.c.
GH	49	Hosta 'Guacamole'	Guacamole Hosta	1 gal pot	Potted	800 mm o.c.
KF	12	Calamagrostis 'Karl Foerster'	Karl Foerster Grass	250mm pot	Potted	800 mm o.c.
MI	28	Miscanthus sinensis	Chinese Silver Grass	250mm pot	Potted	1000 mm o.c.
RG	66	Phalaris arundinacea 'Strawberries & Cream'	Strawberries & Cream Ribbon Grass	250mm pot	Potted	600 mm o.c.
SE	34	Sedum 'Autumn Joy'	Autumn Joy Sedum	100mm pot	Potted	500 mm o.c.
SG	32	Panicum virgatum 'Shenandoah'	Shenandoah Switch Grass	250mm pot	Potted	800 mm o.c.
YU	15	Yucca glauca	Spanish Bayonet	250mm pot	Potted	1000 mm o.c.
VINES						
VC	4	Parthenocissus quinquefolia	Virginia Creeper	2 gallon pot	Potted	Train up wall

EXISTING TREE LIST

KEY	QTY	BOTANICAL NAME	COMMON NAME	SIZE	CONDITION	REMARKS
AC	1	Amelanchier canadensis	Serviceberry	100mm DBH	GOOD	See Plan
AP	4	Acer platanoides	Norway Maple	100-300mm DBH	GOOD	See Plan
GT	6	Gleditsia triacanthos	Honey Locust	150mm DBH	GOOD	See Plan
MA	2	Malus sp.	Crabapple	60mm DBH	GOOD	See Plan
PA	3	Picea abies	Norway Spruce	250-450mm DBH	FAIR	See Plan
PG	9	Picea glauca	White Spruce	100-200mm DBH	POOR-GOOD	See Plan
PN	6	Pinus nigra	Austrian Pine	150-250mm DBH	GOOD	See Plan
PP	14	Picea pungens	Colorado Spruce	100-200mm DBH	GOOD	See Plan
TC	1	Tilia cordata	Littleleaf Linden	500mm DBH	GOOD	See Plan
TO	*	Thuja occidentalis	White Cedar Hedge	100mm DBH	GOOD	To Remain

* DENOTES NUMEROUS