

Copyright Reserved

The Contractor shall verify and be responsible for all dimensions. DO NOT scale the drawing - any errors or omissions shall be reported to Stantec without delay.
The Copyrights to all designs and drawings are the property of Stantec. Reproduction or use for any purpose other than that authorized by Stantec is forbidden.

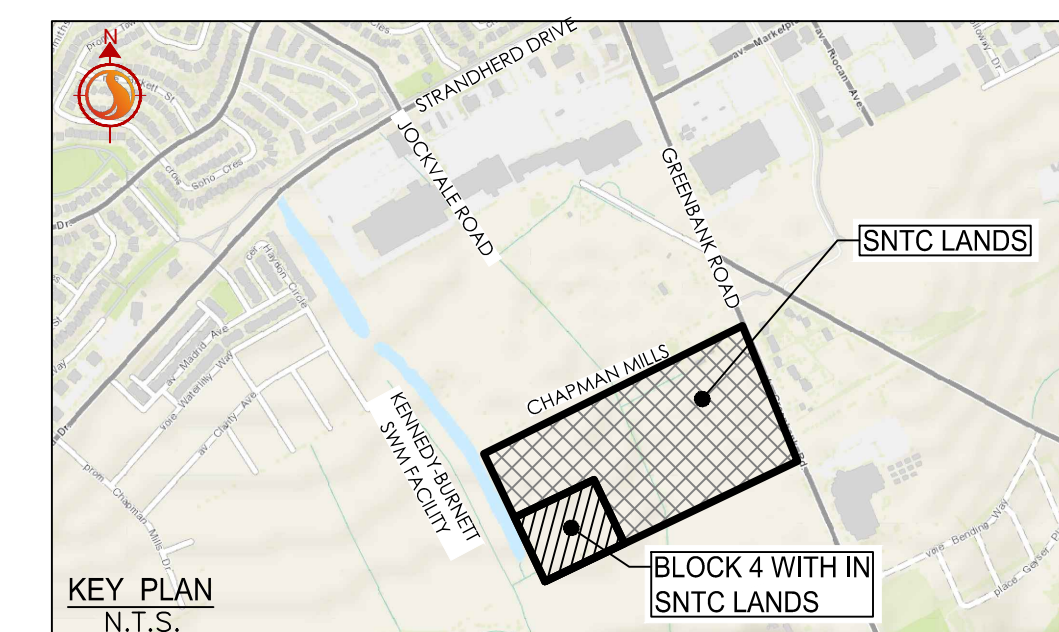

Legend

- ORIGINAL GROUND ELEVATION
- PROPOSED ELEVATION
- EXISTING ELEVATION AT LOT CORNER
- PROPOSED LOT CORNER ELEVATION
- FLOW DIRECTION AND GRADE
- FINISHED FIRST FLOOR ELEVATION
- UNDERSIDE OF FOOTING ELEVATION
- TOP OF FOUNDATION WALL ELEVATION
- DIRECTION OF PROPOSED OVERLAND FLOW
- DIRECTION OF EXISTING OVERLAND FLOW
- PROPOSED VALVE BOX
- PROPOSED VALVE CHAMBER
- PROPOSED FIRE HYDRANT
- PROPOSED SANITARY SEWER MANHOLE
- PROPOSED STORM SEWER MANHOLE
- PROPOSED CATCHBASIN MANHOLE
- PROPOSED CATCHBASIN
- PROPOSED DEPRESSED CURB LOCATION
- PROPOSED BARRIER CURB
- OVERLAND SPILL LOCATION
- MAXIMUM STATIC PONDING LIMITS

1. MAINTENANCE HOLES LOCATED IN PONDING AREAS SHALL HAVE WATER TIGHT FRAME AND COVERS AS PER CITY STANDARD S24, S24.1 AND S25. (SAN MH's 4 AND 5)

Notes

Revision	By	Appd.	YY.MM.DD
1	MJS	TR	20.08.05
0	MJS	TR	20.05.01

File Name:	MJS	AMP	MJS	20.02.25
160401085 BLK 4 DB	Dwn.	Chkd.	Dgn.	YY.MM.DD

Permit-Seal

Client/Project
NEPEAN TOWN CENTRE DEVELOPMENT CORPORATION
2934 BASELINE ROAD, SUITE 302, OTTAWA, ON, K2H 1B2
PH: (613) 518-1864
SNTC LANDS
BLOCK 4
OTTAWA, ON

Title
PONDING PLAN

Project No. 160401085	Scale 1:500	Sheet 7 of 7	Revision 1
--------------------------	----------------	-----------------	---------------

Drawing No. PD-1
Project No. 160401085
Sheet 7 of 7
Revision 1
Title PONDING PLAN
Project # 18168

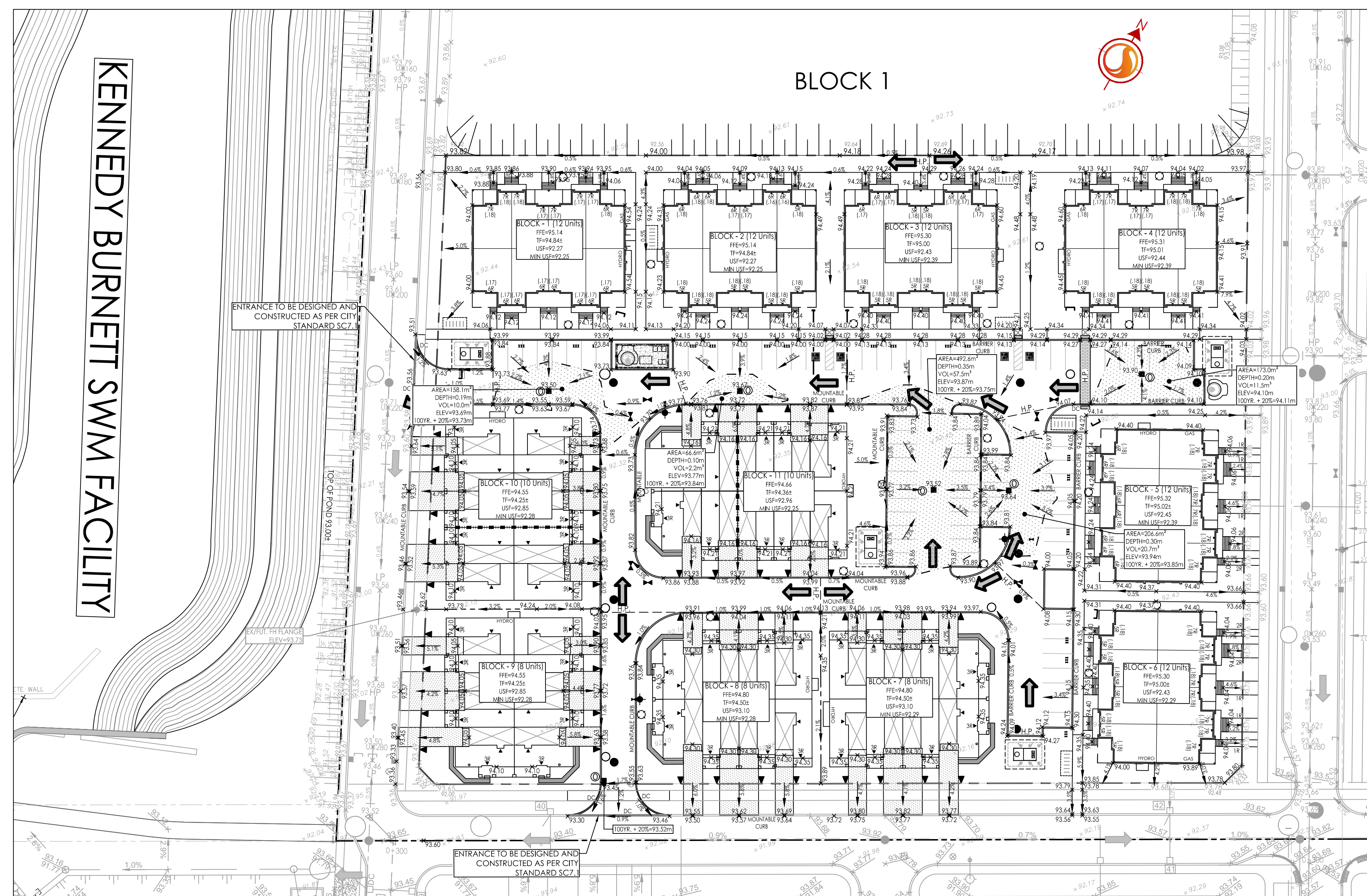

KENNEDY BURNETT SWM FACILITY

X:\Projects\160401085\160401085_Corner_SNTC_Lands_Design\Drawing\Detailed Design\Design\Detailed Site Plan\Design\Block 4\160401085_Blk_4_DB.dwg
20200805 10:54 AM S:\Users\mjs\My Documents\mjs.dwg