

Copyright Reserved

The Contractor shall verify and be responsible for all dimensions. DO NOT scale the drawing - any errors or omissions shall be reported to Stantec without delay.
The Copyrights to all designs and drawings are the property of Stantec. Reproduction or use for any purpose other than that authorized by Stantec is forbidden.

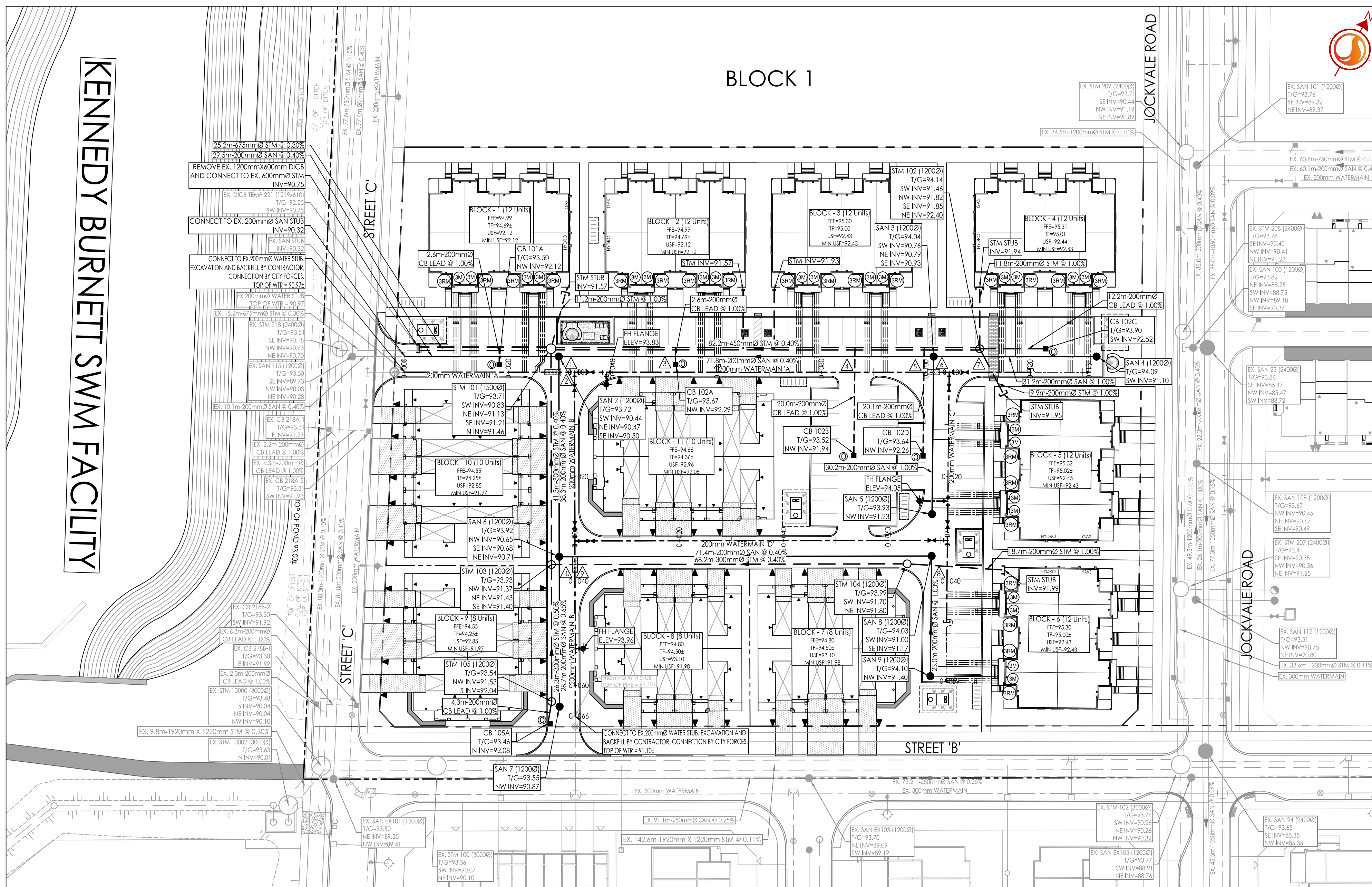
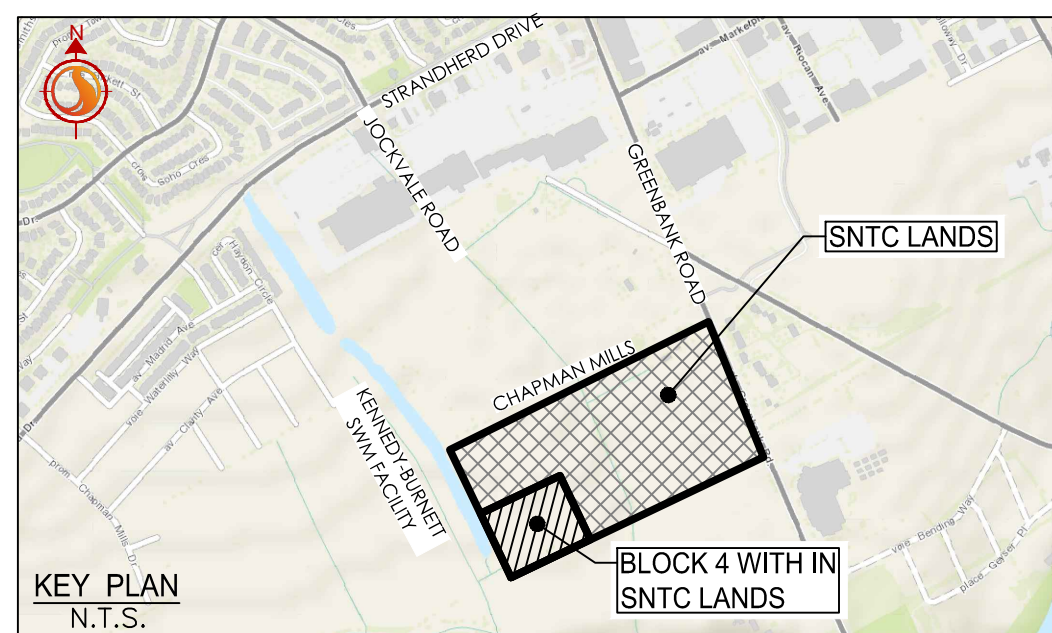

200mmØ / 50mmØ WATERMAIN A

| STATION | FINISHED GRADE | TOP OF W/M | ITEM |
|---------|----------------|------------|-------------------------------------------------------------------------|
| 0+000 | 93.51 | 90.97± | CONNECT TO EX. 200mmØ WATERMAIN STUB |
| 0+020 | 93.55 | 91.150 | TOP OF PIPE |
| 0+027 | 93.67 | 91.270 | 45° VERTICAL BEND CROSSING OVER SEWER AS PER W25.2 AND INSULATE PER W22 |
| 0+027.7 | 93.68 | 92.230 | 45° VERTICAL BEND CROSSING OVER SEWER AS PER W25.2 AND INSULATE PER W22 |
| 0+029.2 | 93.70 | 92.230 | 45° VERTICAL BEND CROSSING OVER SEWER AS PER W25.2 AND INSULATE PER W22 |
| 0+029.9 | 93.70 | 91.300 | 45° VERTICAL BEND CROSSING OVER SEWER AS PER W25.2 AND INSULATE PER W22 |
| 0+032.7 | 93.71 | 91.310 | 200mmØ X 200mmØ TEE |
| 0+035.7 | 93.75 | 91.350 | 200mmØ VALVE AND VALVE BOX |
| 0+038.7 | 93.78 | 91.380 | 150mmØ FIRE HYDRANT TEE |
| 0+050 | 93.71 | 91.310 | TOP OF PIPE |
| 0+060 | 93.76 | 91.360 | TOP OF PIPE |
| 0+080 | 93.80 | 91.400 | TOP OF PIPE |
| 0+085.4 | 93.83 | 91.430 | 45° VERTICAL BEND CROSSING OVER SEWER AS PER W25 |
| 0+085.9 | 93.83 | 91.250 | 45° VERTICAL BEND CROSSING UNDER SEWER AS PER W25 |
| 0+086.9 | 93.84 | 91.250 | 45° VERTICAL BEND CROSSING UNDER SEWER AS PER W25 |
| 0+087.4 | 93.85 | 91.450 | 45° VERTICAL BEND CROSSING UNDER SEWER AS PER W25 |
| 0+100 | 94.00 | 91.600 | TOP OF PIPE |
| 0+100.3 | 94.00 | 91.600 | 45° VERTICAL BEND CROSSING OVER SEWER AS PER W25.2 AND INSULATE PER W22 |
| 0+101.0 | 94.01 | 91.860 | 45° VERTICAL BEND CROSSING OVER SEWER AS PER W25.2 AND INSULATE PER W22 |
| 0+102.0 | 94.01 | 91.860 | 45° VERTICAL BEND CROSSING OVER SEWER AS PER W25.2 AND INSULATE PER W22 |
| 0+102.7 | 94.02 | 91.620 | 45° VERTICAL BEND CROSSING OVER SEWER AS PER W25.2 AND INSULATE PER W22 |
| 0+104.5 | 94.03 | 91.620 | 200mmØ X 200mmØ TEE |
| 0+107.5 | 94.05 | 91.650 | 200mmØ VALVE AND VALVE BOX |
| 0+111.7 | 94.09 | 91.690 | 45° VERTICAL BEND CROSSING UNDER SEWER AS PER W25 |
| 0+112.2 | 94.09 | 91.380 | 45° VERTICAL BEND CROSSING UNDER SEWER AS PER W25 |
| 0+113.2 | 94.11 | 91.380 | 45° VERTICAL BEND CROSSING UNDER SEWER AS PER W25 |
| 0+113.7 | 94.11 | 91.710 | 45° VERTICAL BEND CROSSING UNDER SEWER AS PER W25 |
| 0+119.4 | 94.07 | 91.670 | 50mmØ TVS FOR PEX TUBING WATER SERVICE |
| 0+120 | 94.07 | 91.670 | 200mmØ CAP AND THRUST BLOCK |
| 0+131.3 | 94.07 | 91.100 | 50mmØ REDUCED TO 19mmØ WATER SERVICE AND COIL |

200mmØ WATERMAIN B

| STATION | FINISHED GRADE | TOP OF W/M | ITEM |
|---------|----------------|------------|-------------------------------------------------------------------------|
| 0+000 | 93.71 | 91.310 | 200mmØ X 200mmØ TEE |
| 0+003 | 93.69 | 91.290 | 200mmØ VALVE AND VALVE BOX |
| 0+020 | 93.78 | 91.380 | TOP OF PIPE |
| 0+029.3 | 93.84 | 91.440 | 200mmØ VALVE AND VALVE BOX |
| 0+032.3 | 93.88 | 91.480 | 200mmØ X 200mmØ TEE |
| 0+033.3 | 93.89 | 91.490 | 45° VERTICAL BEND CROSSING OVER SEWER AS PER W25.2 AND INSULATE PER W22 |
| 0+034.3 | 93.88 | 92.450 | 45° VERTICAL BEND CROSSING OVER SEWER AS PER W25.2 AND INSULATE PER W22 |
| 0+037.3 | 93.87 | 92.450 | 45° VERTICAL BEND CROSSING OVER SEWER AS PER W25.2 AND INSULATE PER W22 |
| 0+038.3 | 93.87 | 91.470 | 45° VERTICAL BEND CROSSING OVER SEWER AS PER W25.2 AND INSULATE PER W22 |
| 0+040 | 93.85 | 91.450 | TOP OF PIPE |
| 0+053 | 93.69 | 91.290 | 150mmØ FIRE HYDRANT TEE |
| 0+060 | 93.62 | 91.220 | TOP OF PIPE |
| 0+065.9 | 93.56 | 91.160 | CONNECT TO EX. 200mmØ WATERMAIN STUB |

200mmØ / 50mmØ WATERMAIN C

| STATION | FINISHED GRADE | TOP OF W/M | ITEM |
|---------|----------------|------------|---------------------------------------------------|
| 0+000 | 94.03 | 91.630 | 200mmØ X 200mmØ TEE |
| 0+003 | 94.00 | 91.600 | 200mmØ VALVE AND VALVE BOX |
| 0+020 | 93.89 | 91.490 | TOP OF PIPE |
| 0+024.6 | 93.93 | 91.530 | 150mmØ FIRE HYDRANT TEE |
| 0+029.2 | 93.98 | 91.580 | 200mmØ VALVE AND VALVE BOX |
| 0+032.2 | 94.02 | 91.620 | 200mmØ X 200mmØ TEE |
| 0+036.2 | 94.06 | 91.660 | 45° VERTICAL BEND CROSSING UNDER SEWER AS PER W25 |
| 0+036.7 | 94.06 | 91.360 | 45° VERTICAL BEND CROSSING UNDER SEWER AS PER W25 |
| 0+037.7 | 94.06 | 91.360 | 45° VERTICAL BEND CROSSING UNDER SEWER AS PER W25 |
| 0+038.2 | 94.06 | 91.660 | 45° VERTICAL BEND CROSSING UNDER SEWER AS PER W25 |
| 0+040 | 94.07 | 91.670 | TOP OF PIPE |
| 0+047.3 | 94.07 | 91.670 | 50mmØ TVS FOR PEX TUBING WATER SERVICE |
| 0+047.9 | 94.07 | 91.670 | 200mmØ CAP AND THRUST BLOCK |
| 0+059.2 | 94.12 | 91.720 | 50mmØ REDUCED TO 19mmØ WATER SERVICE AND COIL |

200mmØ WATERMAIN D

| STATION | FINISHED GRADE | TOP OF W/M | ITEM |
|---------|----------------|------------|----------------------------|
| 0+000 | 93.88 | 91.480 | 200mmØ X 200mmØ TEE |
| 0+003 | 93.87 | 91.470 | 200mmØ VALVE AND VALVE BOX |
| 0+020 | 93.94 | 91.540 | TOP OF PIPE |
| 0+040 | 93.96 | 91.560 | TOP OF PIPE |
| 0+060 | 93.93 | 91.530 | TOP OF PIPE |
| 0+084.4 | 94.02 | 91.620 | 200mmØ VALVE AND VALVE BOX |
| 0+071.4 | 94.02 | 91.620 | 200mmØ X 200mmØ TEE |

SCHEDULE OF INLET CONTROL DEVICES

| OUTLET ORIFICE NAME | CATCHBASIN ID | TRIBUTARY AREA ID | ICD TYPE | 2YR HEAD (m) | 100YR HEAD (m) | 2YR FLOW (L/s) | 100YR FLOW (L/s) |
|---------------------|---------------|-------------------|---------------|--------------|----------------|----------------|------------------|
| L101A-IC | CB101A | L101A | 178mm ORIFICE | 1.35 | 1.58 | 70.91 | 76.88 |
| L102A-IC | CB102A | L102A | 108mm ORIFICE | 1.41 | 1.54 | 27.11 | 28.27 |
| L102B-IC | CB102B | L102B | 178mm ORIFICE | 1.52 | 1.77 | 75.49 | 81.84 |
| L102C-IC | CB102C | L102C | 94mm ORIFICE | 1.07 | 1.55 | 17.76 | 21.57 |
| L102D-IC | CB102D | L102D | 108mm ORIFICE | 1.32 | 1.56 | 23.34 | 25.44 |
| L105A-IC | CB105A | L105A | 94mm ORIFICE | 1.38 | 1.44 | 20.33 | 20.72 |

SEWER AND WATERMAIN CROSSING TABLE

| CROSSING | STM INV | STM OBV | SAN INV | SAN OBV | WTR TOP | WTR STM |
|----------|---------|---------|---------|---------|---------|---------|
| ▲ | 91.14 | 91.52 | 90.43 | 90.63 | | |
| ▲ | 91.15 | 91.53 | 90.51 | 90.75 | 92.23 | 92.03 |
| ▲ | 92.27 | 92.47 | 90.56 | 90.76 | | |
| ▲ | 91.75 | 91.95 | 90.69 | 90.89 | 91.25 | 91.05 |
| ▲ | 92.10 | 92.30 | 90.75 | 90.95 | 91.56 | 91.36 |
| ▲ | | | 90.96 | 91.16 | 91.86 | 91.66 |
| ▲ | 91.88 | 92.08 | 90.89 | 91.09 | 91.38 | 91.18 |
| ▲ | 91.86 | 92.06 | 91.19 | 91.39 | 91.36 | 91.16 |
| ▲ | 91.45 | 91.75 | 90.72 | 90.92 | 92.45 | 92.25 |
| ▲ | 91.44 | 91.74 | 90.70 | 90.90 | | |

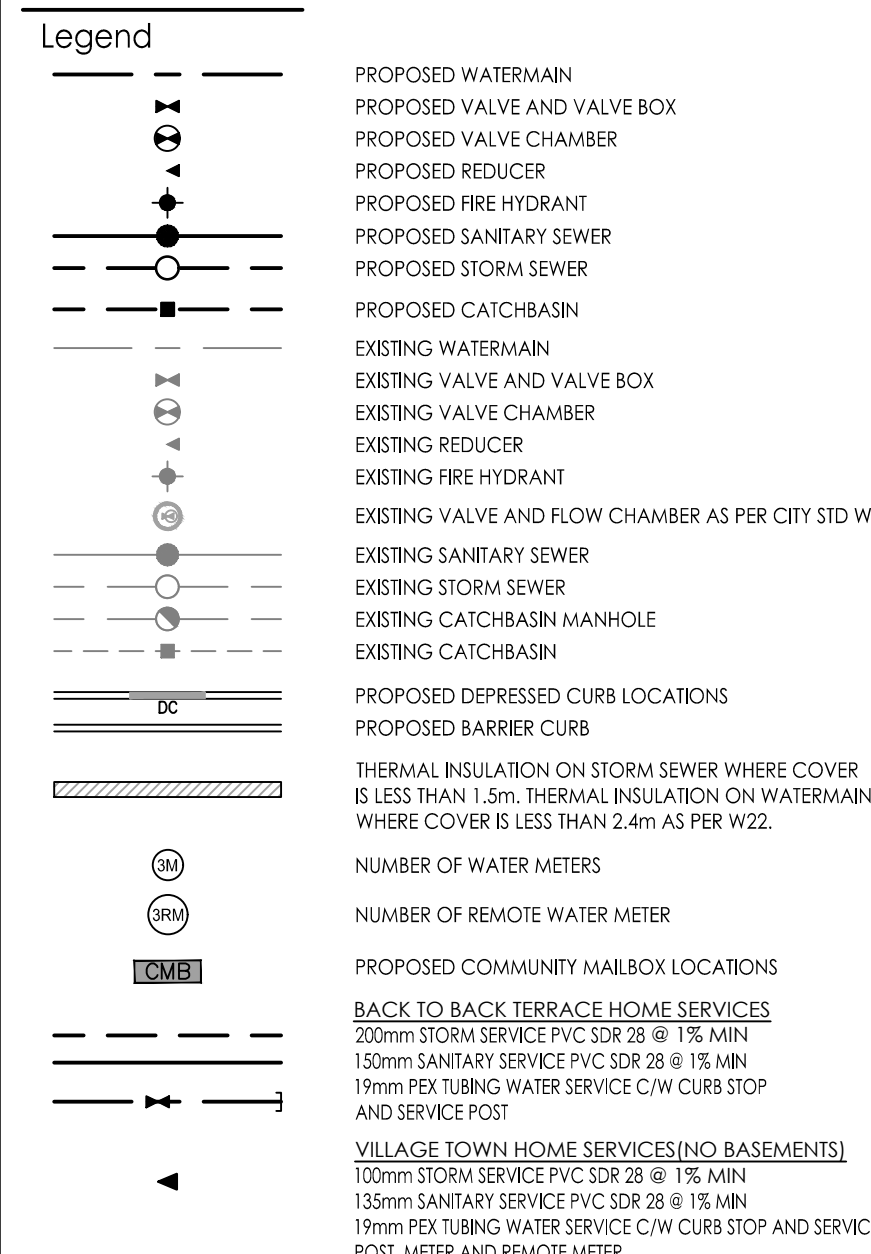

- ### Notes
- FINAL SERVICE LATERAL SIZES TO BE CONFIRMED BY MECHANICAL CONSULTANT.
 - ALL ROOF EAVES TROUGH TO OUTLET TO INTERNAL SURFACE PARKING AREAS.
 - PRESSURE REDUCING VALVES (PRVs) ON ALL UNITS TO BE INSTALLED AS PER ONTARIO PLUMBING CODE.
 - MAINTENANCE HOLES LOCATED IN PONDING AREAS SHALL HAVE TIGHT FRAME AND COVERS AS PER CITY STANDARD S24, S24-1 AND S25, (SAN MHs 4 AND 5)
 - BLOCKS 1 TO 5 UNITS WILL BE SERVICED THROUGH SNTC LANDS BLOCK 4 PROPOSED SANITARY SYSTEM.

Revision

| 0 | ISSUED TO CITY FOR SPA | MJS | TR | 20.05.01 |
|---|------------------------|-----|----|----------|
| | | | By | Appd. |

File Name: 160401085 BLK 4.DWG

| | MJS | AMP | MJS | 20.02.25 |
|--|------|-------|------|----------|
| | Dwn. | Chkd. | Dgn. | YY.MM.DD |



Client/Project
NEPEAN TOWN CENTRE DEVELOPMENT CORPORATION

SNTC LANDS BLOCK 4
OTTAWA, ON

Title
SITE SERVICING PLAN

| | | | |
|--------------------------|----------------|------------|---------------|
| Project No. 160401085 | Scale 1:500 | Sheet 1 | Revision 0 |
|--------------------------|----------------|------------|---------------|

SSP-1 2 of 7 0