

20m Setback from Normal High Water Mark

30m Setback from Normal High Water Mark

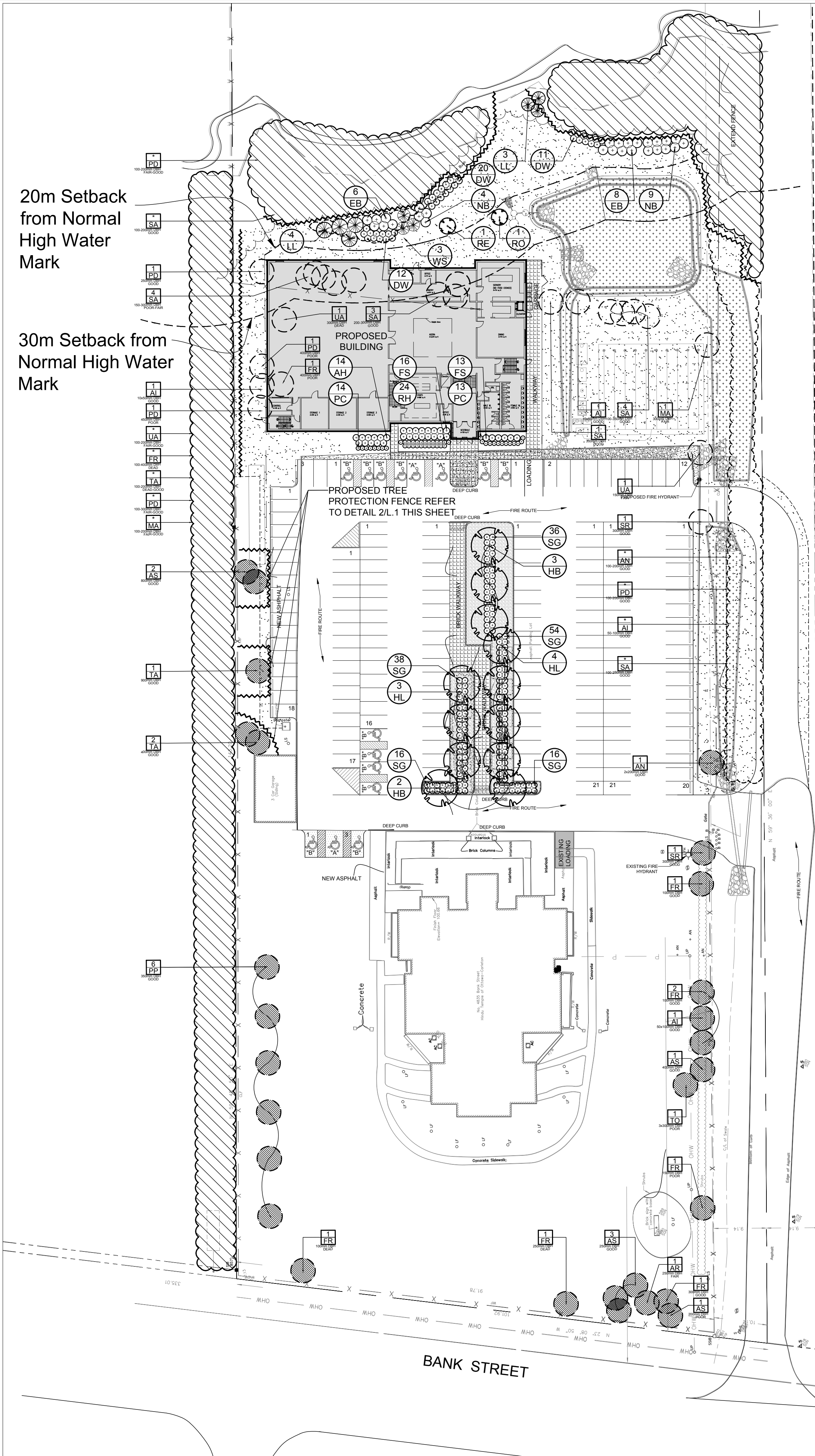

1 TREE CONSERVATION REPORT & LANDSCAPE PLAN
SCALE: 1:500

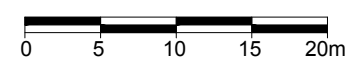

2 TREE PROTECTION FENCE
SCALE: NTS

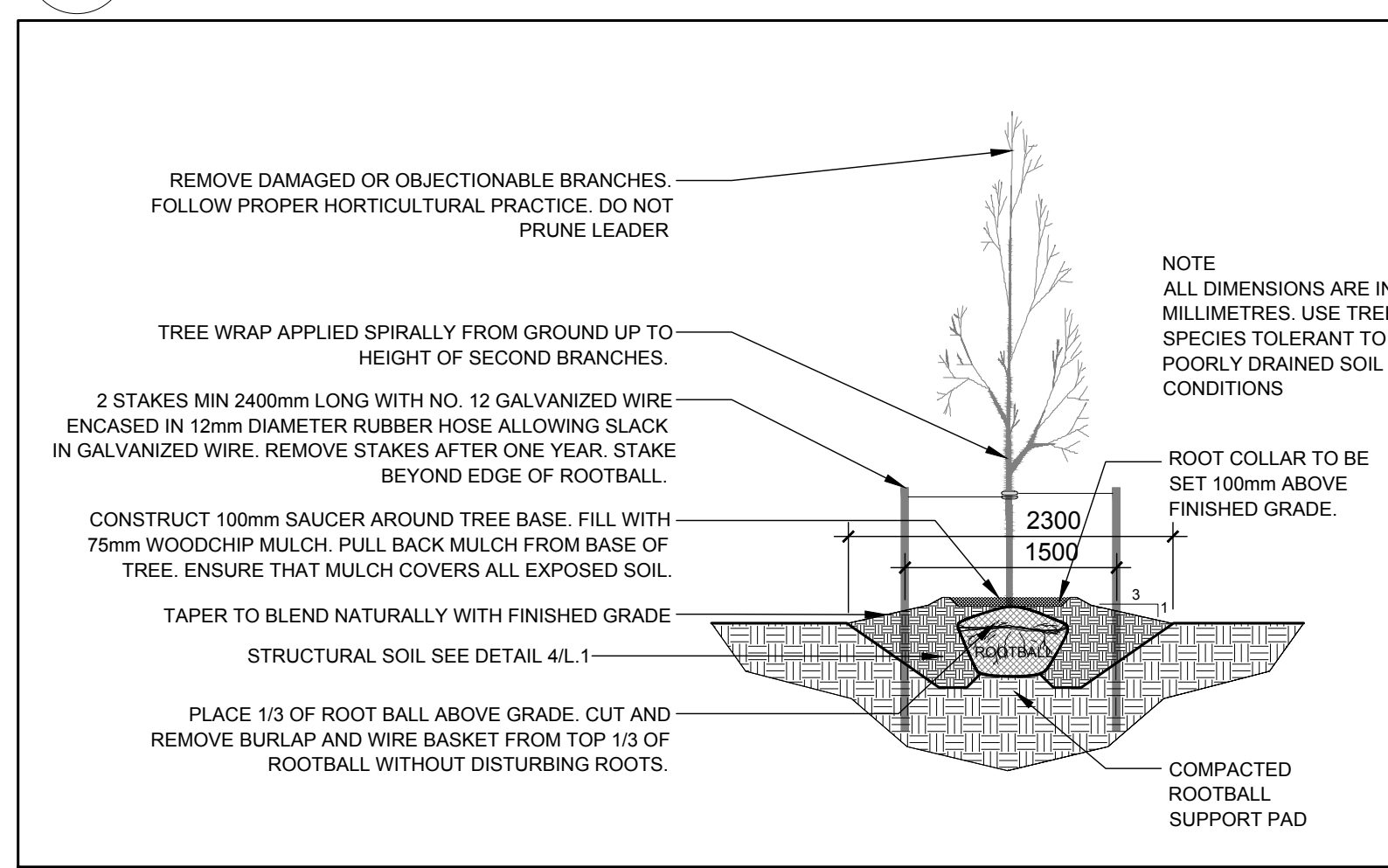

3 DECIDUOUS TREE PLANTING
SCALE: NTS

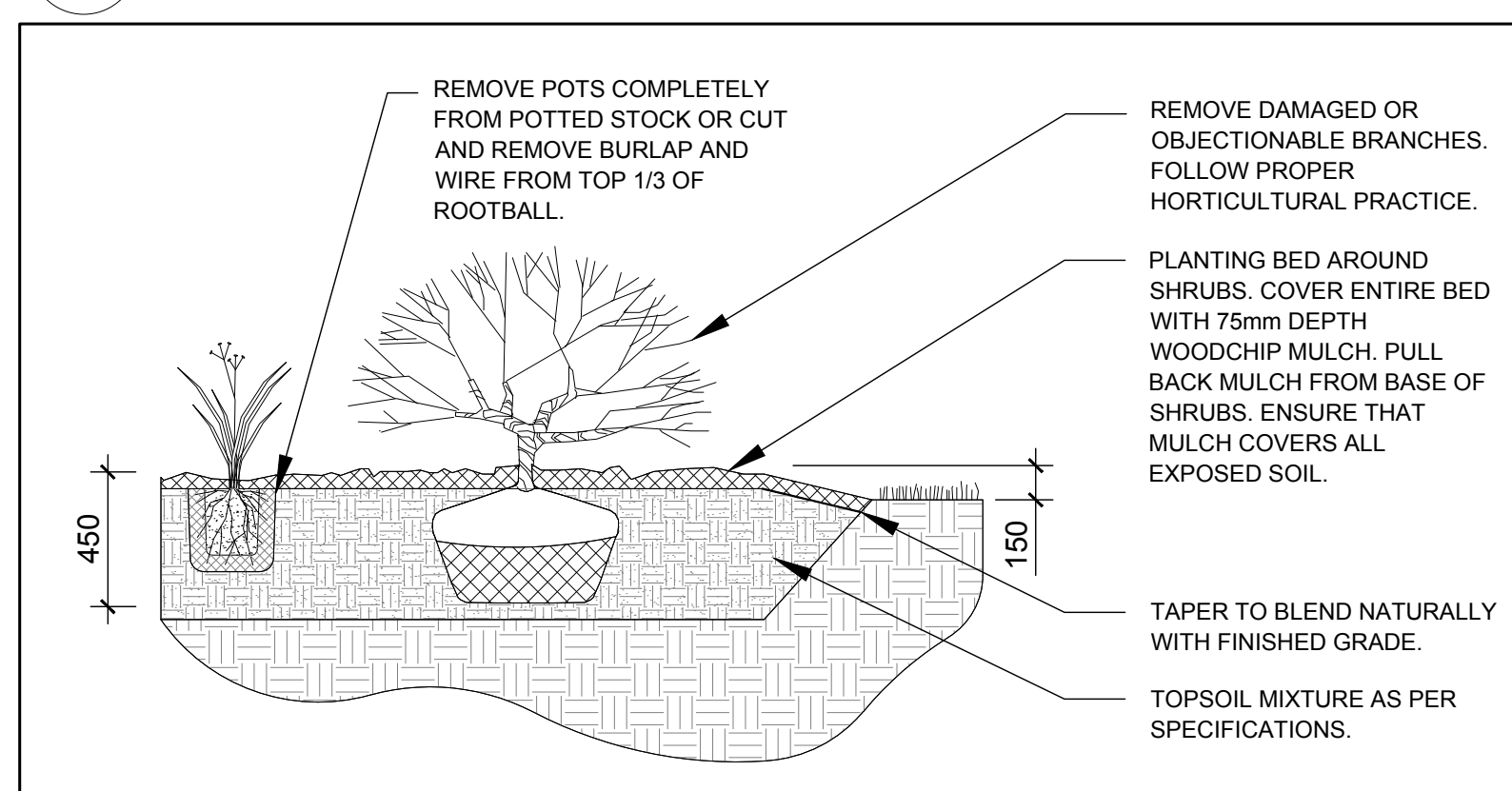

4 SHRUB / PERENNIAL PLANTING
SCALE: NTS

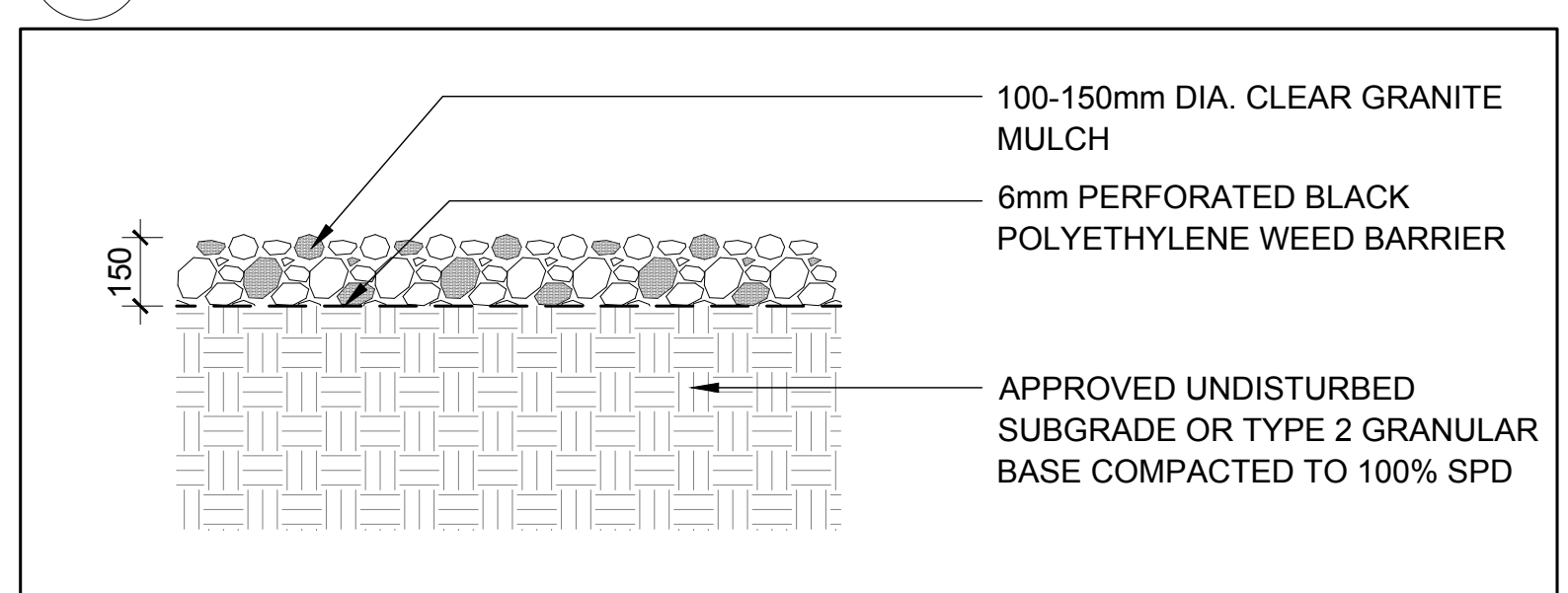

5 RIVERSTONE MULCH
SCALE: NTS

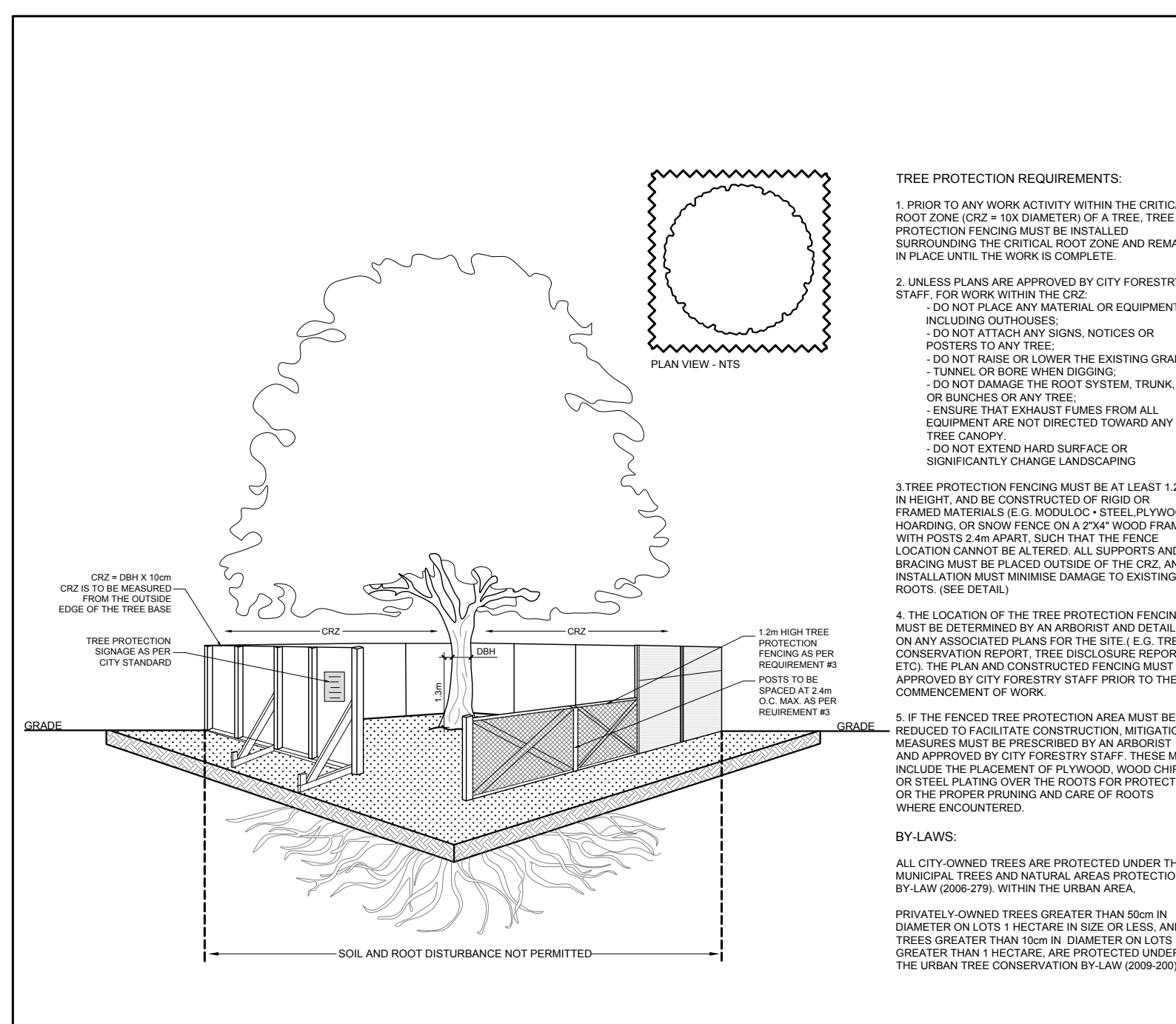
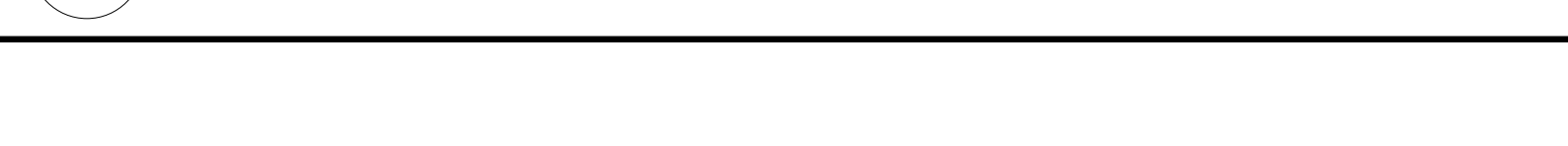

PROPOSED PLANT LIST

KEY	QTY	BOTANICAL NAME	COMMON NAME	SIZE	CONDITION	REMARKS
TREES						
HB	5	Celtis occidentalis	Hackberry	60mm ø	B&B	
HL	7	Gleditsia triacanthos 'Draves'	Street Keeper Honey Locust	60mm ø	B&B	
LL	7	Larix laricina	Tamarack	15 gallon pot	Potted	
RE	1	Acer rubrum	Red Maple	15 gallon pot	Potted	
RM	1	Acer rubrum	Red Maple	60mm ø	B&B	
RO	1	Quercus rubra	Red Oak	15 gallon pot	Potted	
WS	3	Picea glauca	White Spruce	15 gallon pot	Potted	
SHRUBS						
DW	37	Cornus sericea	Red Osier Dogwood	800mm ht.	Potted / bare root	1200 mm o.c.
EB	14	Sambucus racemosa	Red Elderberry	800mm ht.	Potted / bare root	1200 mm o.c.
FS	29	Rhus aromatica	Fragrant Sumac	800mm ht.	Potted	
NB	13	Viburnum lentago	Nannyberry	800mm ht.	Potted / bare root	1500 mm o.c.
PERENNIALS AND ORNAMENTAL GRASSES						
PC	27	Echinacea purpurea	Purple Coneflower	100mm pot	Potted	400 mm o.c.
RH	24	Rudbeckia hirta	Black Eyed Susan	100mm pot	Potted	400 mm o.c.
SG	160	Panicum virgatum	Switch Grass	250mm pot	Potted	800 mm o.c.

EXISTING TREE LIST

KEY	QTY	BOTANICAL NAME	COMMON NAME	SIZE	CONDITION	REMARKS
TREES						
AI	*	Alnus incana	Speckled Alder	50-100mm DBH	Good	See Plan
AN	*	Acer negundo	Manitoba Maple	100-200mm DBH	Good	See Plan
AR	1	Acer rubrum	Red Maple	250mm DBH	Fair	See Plan
AS	10	Acer saccharum	Sugar Maple	100-800mm DBH	Dead-Good	See Plan
FR	*	Fraxinus sp.	Ash	100-499mm DBH	Dead-Good	See Plan
MA	*	Morus sp.	Crabapple	100-300mm DBH	Fair-Good	See Plan
PP	6	Picea pungens 'Glauca'	Colorado Blue Spruce	300mm DBH	Good	See Plan
PD	*	Populus deltoides	Eastern Cottonwood	100-450mm DBH	Poor-Good	See Plan
SR	1	Syringia reticulata	Japanese Tree Lilac	300mm DBH	Good	See Plan
SA	*	Salix sp.	Willow	100-350mm DBH	Poor-Good	See Plan
TA	*	Tilia americana	Basswood	100-900mm DBH	Dead-Good	See Plan
TO	*	Thuja occidentalis	Eastern White Cedar	100-300mm DBH	Dead-Good	See Plan
UA	*	Ulmus americana	American Elm	100-300mm DBH	Dead-Good	See Plan

*DENOTES NUMEROUS

- ### GENERAL NOTES:
- It is the responsibility of the appropriate contractor or official to report any errors, omissions or discrepancies on this plan with actual site conditions to the Landscape Architect before proceeding with construction.
 - The contractor is to notify all utility companies and authorities prior to any excavation and ascertain locations of underground services.
 - The contractor is to reinstatement all areas and items damaged as a result of construction activity.
 - The contractor is to comply with all pertinent codes and by-laws.
 - The contractor is to maintain a positive surface run-off throughout the entire construction period.
 - The Landscape Architect is not responsible for subsurface conditions.
 - The contractor is to identify all existing trees to remain on site with the Landscape Architect prior to construction.
 - The contractor is to stake the proposed location of all plant material in conjunction with the Landscape Architect prior to excavation.
 - Minimum distances for selected deciduous trees are as follows:
 - Building Foundations 7.5m
 - Sidewalks 1.5m
 - Public Streets 2.5m
 - Underground Infrastructure 2.0m
 - All trees within 1m of underground utility trenches are to be excavated by hand.
 - Remove all protective wrapping from tree trunks after installation.
 - Staking of trees shall only be performed if necessary.
 - Ensure that mulch is pulled back a min. distance of 75mm from base of tree trunk.

CLIENT: **HINDU TEMPLE OF OTTAWA CARLETON**
4835 BANK STREET, OTTAWA, ONTARIO K1J 1G6
Tel: (613) 613.822.1531

CONSULTANTS:
ARCHITECTS: **VECTOR DESIGN ARCHITECTS**
14 STRATHBURY STREET, OTTAWA, ONTARIO K2G 5N8
Tel: (613) 613.421.9869

CIVIL ENGINEERS: **LRL ASSOCIATES LTD.**
5430 CANOTEX RD. GLOUCESTER ON K1J 9G2
Tel: (613) 613.842.3434

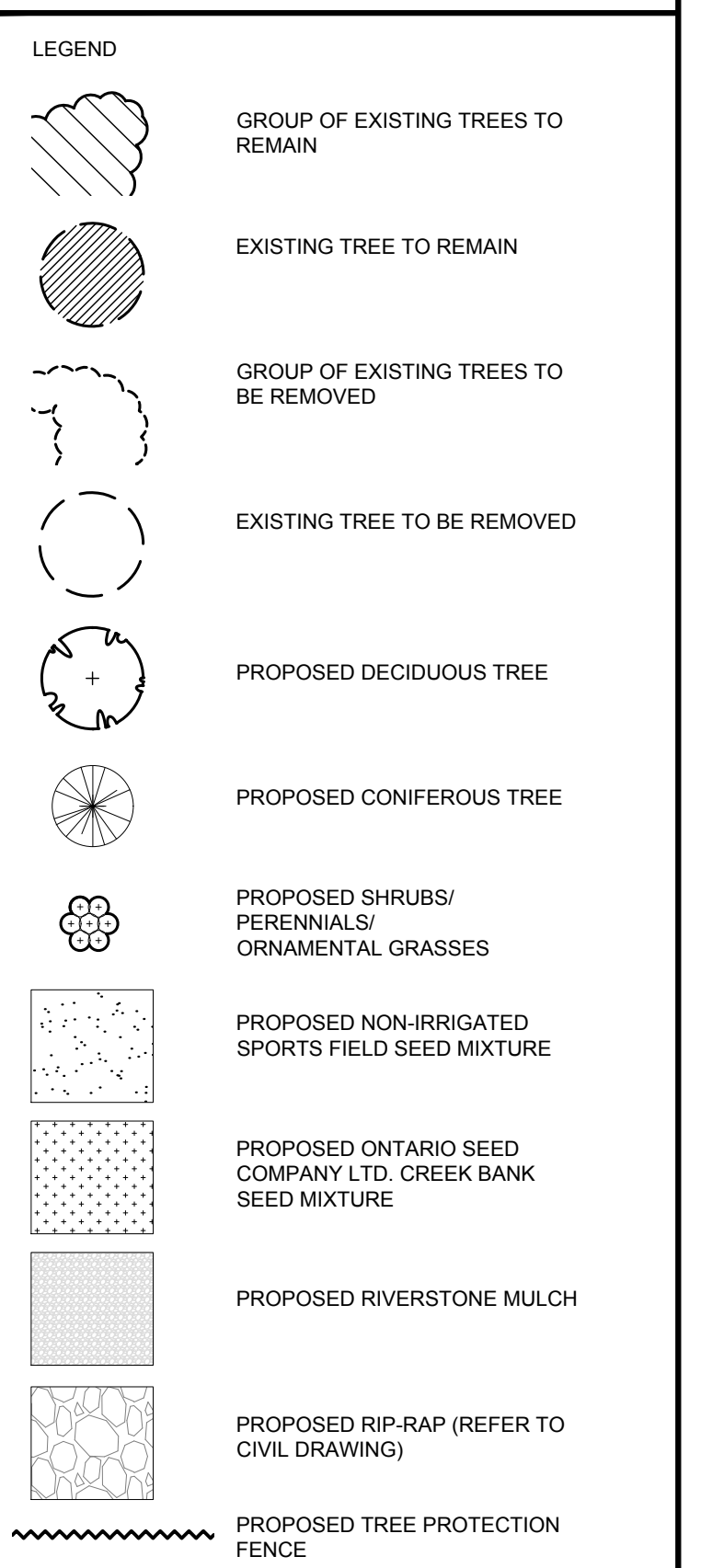

2	REVISED PER CITY COMMENTS	01/27/2021	ML	JL
1	ISSUED FOR SITE PLAN CONTROL	03/11/2020	ML	JL
No.	Issue	Date	Job	DR

JAMES B. LENNOX & ASSOCIATES INC.
LANDSCAPE ARCHITECTS
3332 CARLING AVE. OTTAWA, ONTARIO K2J 5A8
Tel: (613) 722-5168 Fax: (866) 343-3942

PROJECT: **PROPOSED ASSEMBLY HALL - HINDU TEMPLE**
4835 BANK STREET, OTTAWA ON

DRAWING: **TREE CONSERVATION REPORT & LANDSCAPE PLAN**

STAMP: AS SHOWN

SCALE: AS SHOWN

START DATE: AUGUST 2019

PROJECT NO.: 19MIS1974

PROJECT NORTH:

DRAWING NO.: **L.1**

PLOT SIZE ARCH-D