

UTILITY LEGEND

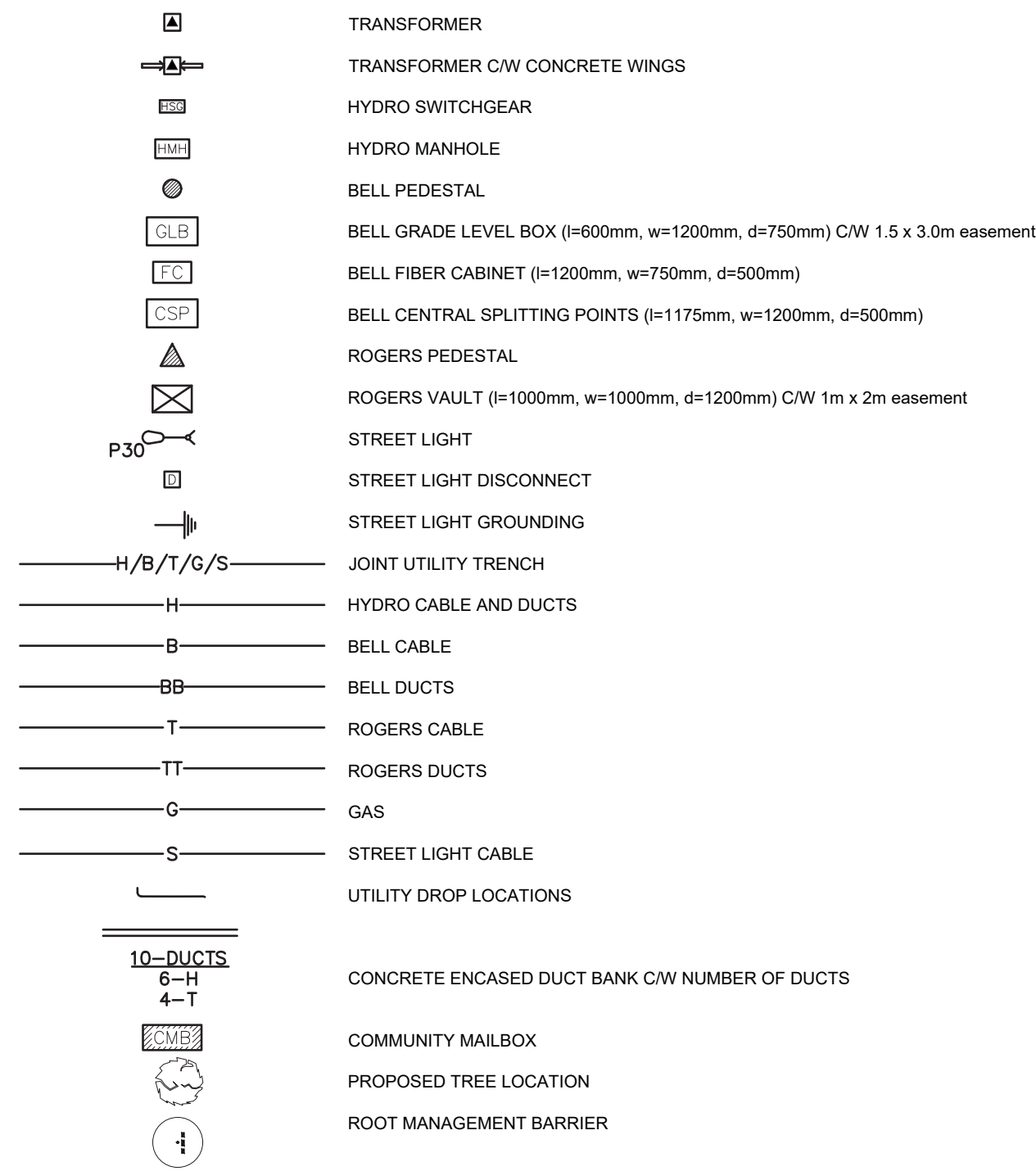

SEDIMENT EROSION LEGEND

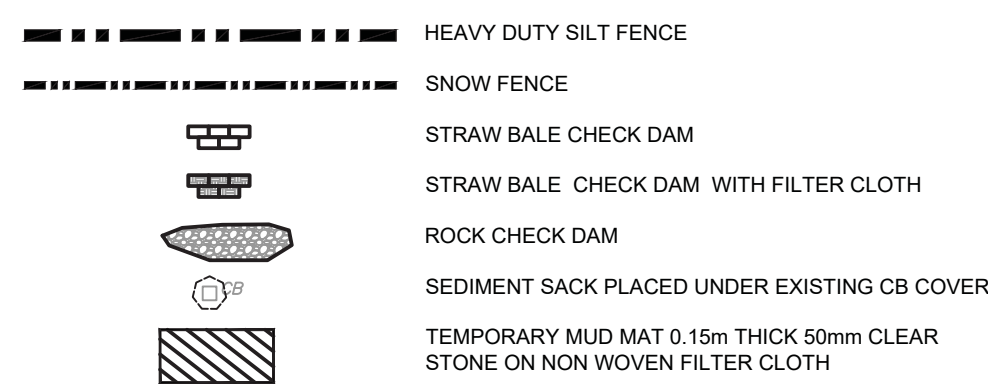

GENERAL LEGEND

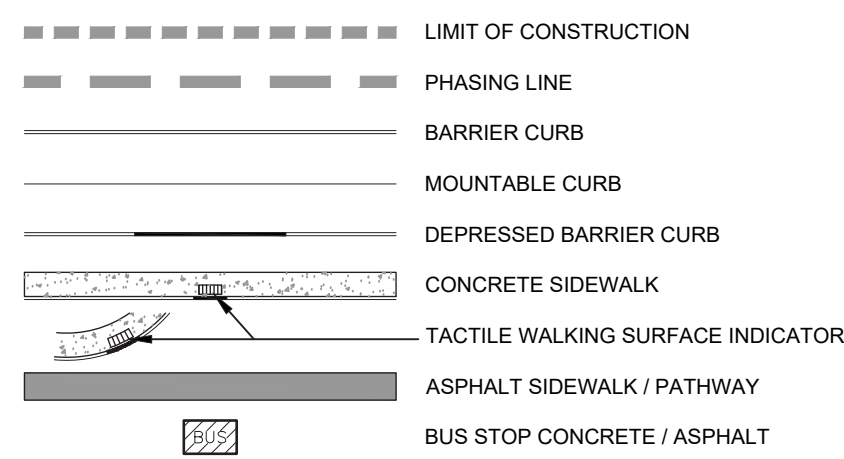

SERVICING LEGEND

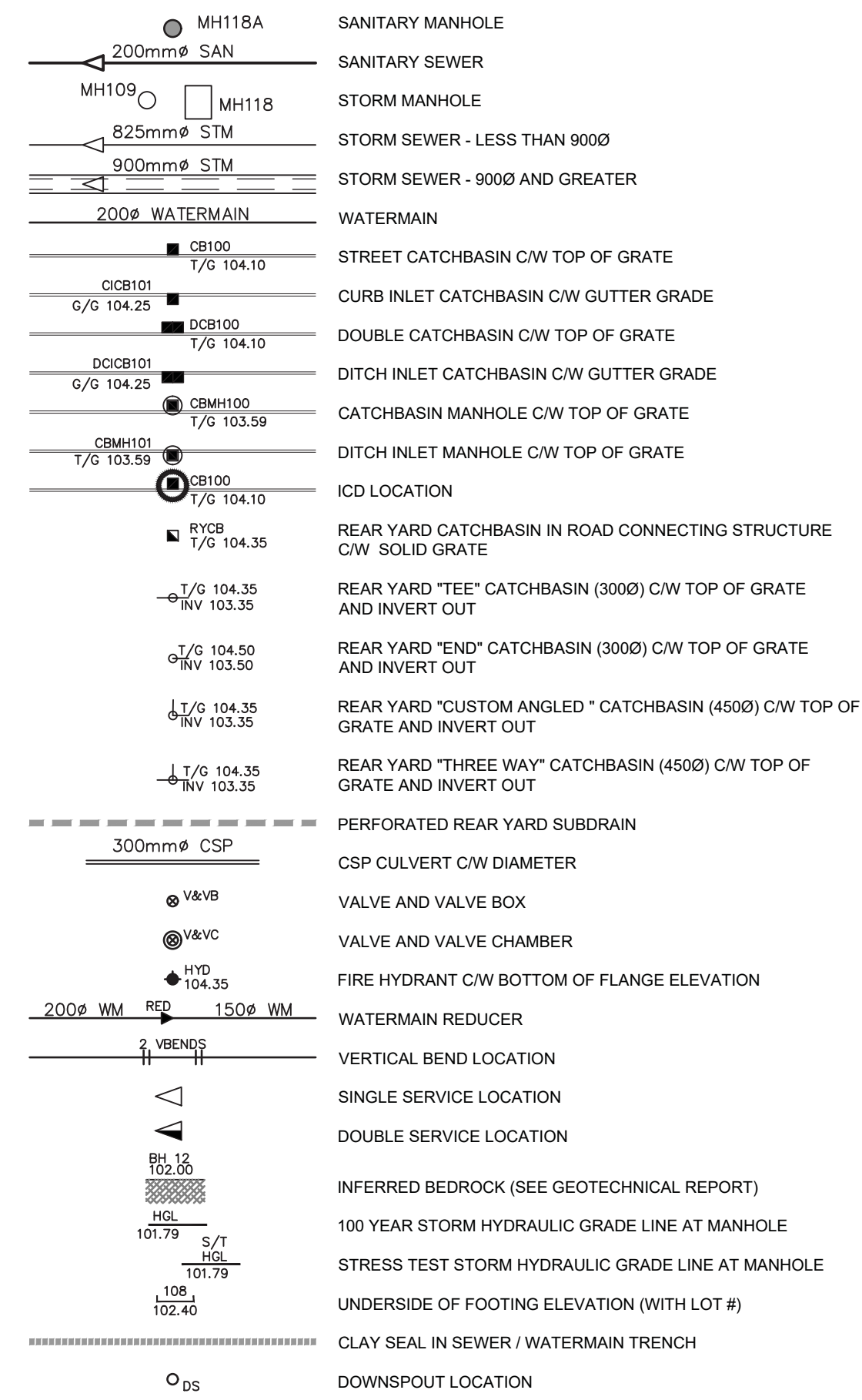

GRADING LEGEND

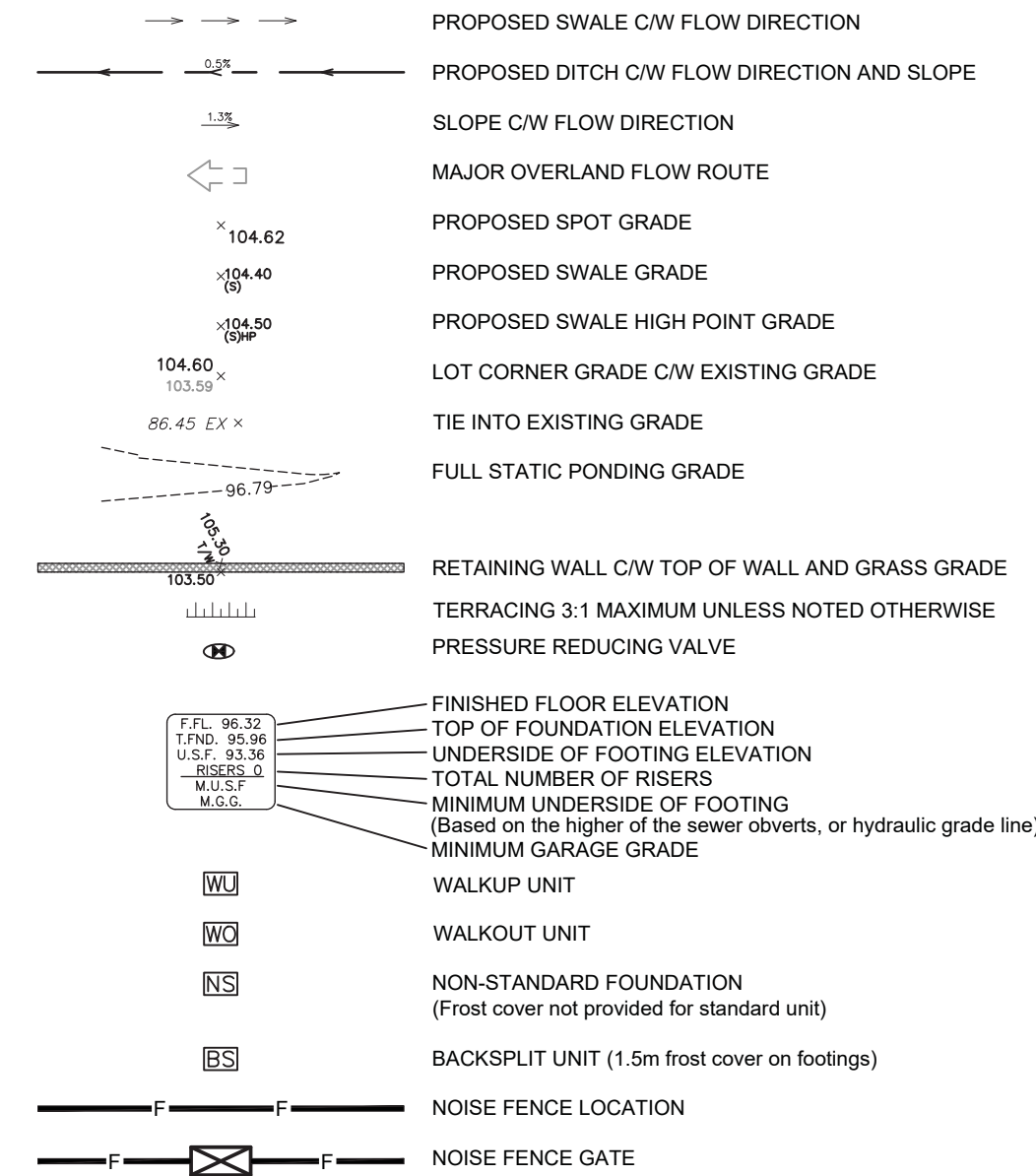

NOTES :

- ALL MATERIALS AND CONSTRUCTION IS TO BE IN ACCORDANCE WITH THE CURRENT CITY OF OTTAWA STANDARD DRAWINGS & SPECIFICATIONS OR OPSD/OPSS IF CITY DRAWINGS AND SPECIFICATIONS DO NOT APPLY.
 - ALL SEWER PIPE MATERIAL TO BE PVC DR35 UNLESS NOTED OTHERWISE
 - ALL SUBDRAIN PIPE MATERIAL TO BE HDPE UNLESS NOTED OTHERWISE
 - ALL WATERMAIN PIPE TO BE PVC DR18 UNLESS NOTED OTHERWISE
- THE CONTRACTOR IS RESPONSIBLE FOR DETERMINING THE EXACT LOCATION, SIZE, MATERIAL AND ELEVATION OF ALL EXISTING SERVICES AND UTILITIES PRIOR TO CONSTRUCTION AND SHALL PROTECT AND ASSUME RESPONSIBILITY FOR ALL UTILITIES WHETHER OR NOT SHOWN ON THESE DRAWINGS.
- FOR GEOTECHNICAL INFORMATION REFER TO GEOTECHNICAL REPORT _____ PREPARED BY _____.
- FOR GEODETIC BENCHMARK AND GEOMETRIC LAYOUT OF STREET AND LOTS, REFER TO TOPOGRAPHICAL SURVEY AND PLAN OF SUBDIVISION PREPARED BY MACKAY MACKAY & PETERS LIMITED. BENCHMARK BASED ON CAN-NET VIRTUAL REFERENCE SYSTEM NETWORK.
- ROADWAY SECTIONS REQUIRING GRADE RAISE TO PROPOSED SUB GRADE LEVEL TO BE FILLED WITH ACCEPTABLE NATIVE EARTH BORROW OR IMPORTED OPSS SELECTED SUBGRADE MATERIAL IF NATIVE MATERIAL IS DEFICIENT AS PER RECOMMENDATION OF GEOTECHNICAL ENGINEER.
- IN AREAS WHERE EXISTING GROUND IS BELOW THE PROPOSED ELEVATION OF SEWER AND WATERMANS, GRADE RAISING AND FILLING IS TO BE IN ACCORDANCE WITH THE RECOMMENDATIONS OF THE GEOTECHNICAL REPORT. AS PER CITY GUIDELINES ALL WATERMANS IN FILL AREAS ARE TO BE TIED WITH RESTRAINING JOINTS AND THRUST BLOCKS.
- REFER TO DRAWING 011 FOR ROADWAY CROSS SECTIONS.
- SILT FENCE TO BE ERECTED PRIOR TO EARTH WORKS BEING COMMENCED. SILT FENCE TO BE MAINTAINED UNTIL VEGETATION IS ESTABLISHED OR UNTIL START OF SUBSEQUENT PHASE.
- STRAW BALE SEDIMENT TRAPS TO BE PLACED AND MAINTAINED IN EXISTING AND CONSTRUCTED ROAD SIDE DITCHES. TRAPS TO REMAIN AND BE MAINTAINED UNTIL VEGETATION IS ESTABLISHED (IF APPLICABLE).
- SILT SACK TO BE PLACED AND MAINTAINED UNDER COVER OF ALL CATCHBASINS. GEOTEXTILE SILT SACK IN STREET C/S TO REMAIN UNTIL ALL CURBS ARE CONSTRUCTED. GEOTEXTILE FABRIC IN RYCBs TO REMAIN UNTIL VEGETATION IS ESTABLISHED. ALL CATCHBASINS TO BE REGULARLY INSPECTED AND CLEANED, AS NECESSARY, UNTIL SOD AND CURBS ARE CONSTRUCTED.
- ALL CONNECTIONS TO EXISTING WATERMANS ARE TO BE COMPLETED BY CITY FORCES. CONTRACTOR IS TO EXCAVATE, BACKFILL, COMPACT AND REINSTATE.
- ALL LEADS FOR STREET C/Ss TO AND C/CB's CONNECTED TO MAIN SHALL BE 250mmØ PVC DR35 @ MIN 2% SLOPE UNLESS NOTED OTHERWISE. ALL LEADS FOR RYCB's CONNECTED TO MAIN SHALL BE 200mmØ PVC DR35 @ MIN 1% SLOPE UNLESS NOTED OTHERWISE.
- EROSION AND SEDIMENT CONTROL MEASURES SHALL BE INSPECTED WEEKLY OR IMMEDIATELY FOLLOWING A STORM EVENT. ANY DAMAGED CONTROL MEASURE SHALL BE REPAIRED IMMEDIATELY. CONTRACTOR TO BE RESPONSIBLE FOR PROTECTING EROSION AND SEDIMENT CONTROL MEASURES DURING CONSTRUCTION.
- ALL SEDIMENT DEPOSITS SHALL BE REMOVED FROM SITE AND DISPOSED OF AT APPROPRIATE DISPOSAL FACILITY. OR SHALL BE TESTED BY GEOTECHNICAL ENGINEER WHO MAY PROVIDE RECOMMENDATIONS FOR MATERIALS TO BE USED ONSITE PRIOR TO LANDSCAPING.
- ALL LEADS FOR STREET C/Ss TO AND C/CB's CONNECTED TO MAIN SHALL BE 200mmØ PVC DR35 @ MIN 2% SLOPE UNLESS NOTED OTHERWISE. ALL LEADS FOR RYCB's CONNECTED TO MAIN SHALL BE 200mmØ PVC DR35 @ MIN 1% SLOPE UNLESS NOTED OTHERWISE.
- THESE DRAWINGS ARE NOT TO BE SCALED OR USED FOR LAYOUT PURPOSES.
- THE COMPOSITE UTILITY PLAN HAS BEEN REVIEWED BY IBI GROUP FOR CONFORMITY TO THE DESIGN CONCEPT FOR THE DEVELOPMENT AND FOR GENERAL ARRANGEMENT ONLY AND AS SUCH SHALL NOT RELIEVE THE CONTRACTOR OF RESPONSIBILITY FOR ERRORS OR OMISSIONS IN EITHER LAYOUT OR WORKMANSHIP.
- THIS DRAWING IS A COMPILATION OF OTHER UTILITY DESIGNS AND DOES NOT INDICATE IN ANY WAY THAT THE PARTY SIGNING THIS DRAWING HAS DESIGNED OR APPROVED THE RESPECTIVE UTILITY PLANTS INDICATED ON THIS DRAWING. THE DRAWING WAS PREPARED TO BE USED AS REFERENCE ONLY AS PER REQUIREMENTS OF THE CITY OF OTTAWA. IT IS THE CONTRACTORS RESPONSIBILITY TO ENSURE IT HAS REVIEWED THE CURRENT AND EXISTING DESIGNS BY HYDRO, STREET LIGHTING, BELL, CANADA POST, O.C. TRANSPCO, CABLE TV AND ANY OTHER PARTIES INCLUDED BUT NOT MENTIONED AND COMPLETE THE INSTALLATION IN ACCORDANCE WITH THE REQUIREMENTS OF THE STAKEHOLDER UTILITY DESIGNS.
- THE HGL PROVIDED IS BASED ON HYDRAULIC MODELING COMPLETED USING XPSWMM AND THE 100 YEAR CHICAGO STORM EVENT (CH10010).
- ALL UTILITY BOXES (I.E. PEDESTALS, TRANSFORMERS, ETS) ARE TO BE INSTALLED IN ACCORDANCE WITH THE LATEST EDITION OF THE CITY OF OTTAWA'S "GUIDELINES FOR UTILITY PEDESTALS WITHIN THE ROAD RIGHT OF WAY".
- ALL WATERMANS TO BE INSTALLED AT MINIMUM COVER OF 2.4m BELOW FINISHED GRADE, WHERE WATERMANS CROSS OVER OTHER UTILITIES. A MINIMUM OF 0.25m CLEARANCE SHALL BE MAINTAINED. WHERE WATERMANS CROSS UNDER OTHER UTILITIES, A MINIMUM OF 0.50m SHALL BE MAINTAINED. WHERE THE SEPERATION CANNOT BE ACHIEVED, THE WATERMAIN SHALL BE INSTALLED AS PER CITY OF OTTAWA STANDARDS W25 AND W25.2. WHERE 2.4m MINIMUM DEPTH CANNOT BE ACHIEVED, THERMAL INSULATION SHALL BE PROVIDED AS PER CITY OF OTTAWA STANDARD W22. WHERE A WATERMAIN IS IN CLOSE PROXIMITY TO AN OPEN STRUCTURE, THERMAL INSULATION SHALL BE PROVIDED AS PER CITY OF OTTAWA STANDARD W23.
- ANY SANITARY AND STORM SEWER WITH LESS THAN 2.0m COVER REQUIRES THERMAL INSULATION AS PER CITY OF OTTAWA STANDARD W22, OR APPROVED BY THE ENGINEER.

ROADWAY STRUCTURE:

PAVEMENT STRUCTURE - (540mm)

40mm	- SUPERPAVE 12.5 ASPHALTIC CONCRETE
50mm	- SUPERPAVE 19.0 ASPHALTIC CONCRETE
150mm	- OPSS GRANULAR "A" CRUSHED STONE
300mm	- OPSS GRANULAR "B" TYPE II

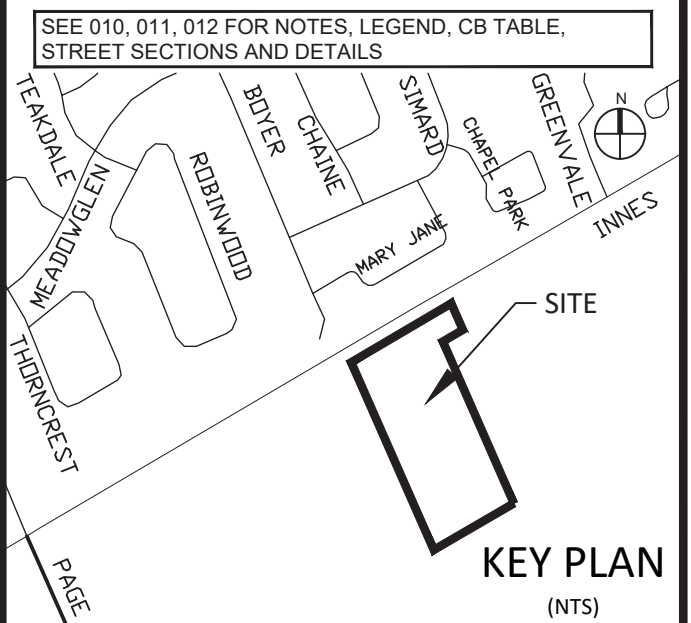

14			
13			
12			
11			
10			
9			
8			
7			
6			
5			
4			
3			
2			
1	ISSUED FOR SPA	DGY	2020-02-18
No.	REVISIONS	By	Date

IBI GROUP
 400 - 333 Preston Street
 Ottawa ON K1S 5N4 Canada
 tel 613 225 1311 fax 613 225 9888
 ibigroup.com

Project Title
U-HAUL
 3636 INNES ROAD

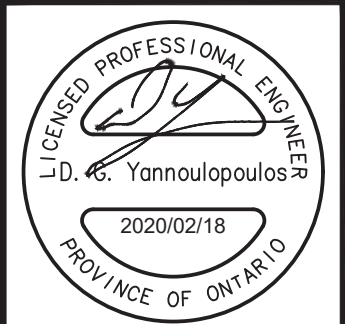

GENERAL NOTES, LEGEND AND CB DATA TABLE

Scale N.T.S.	
Design R.M./W.Z.	Date JANUARY 2020
Drawn E.H.	Checked DGY
Project No. 122012	Drawing No. 010

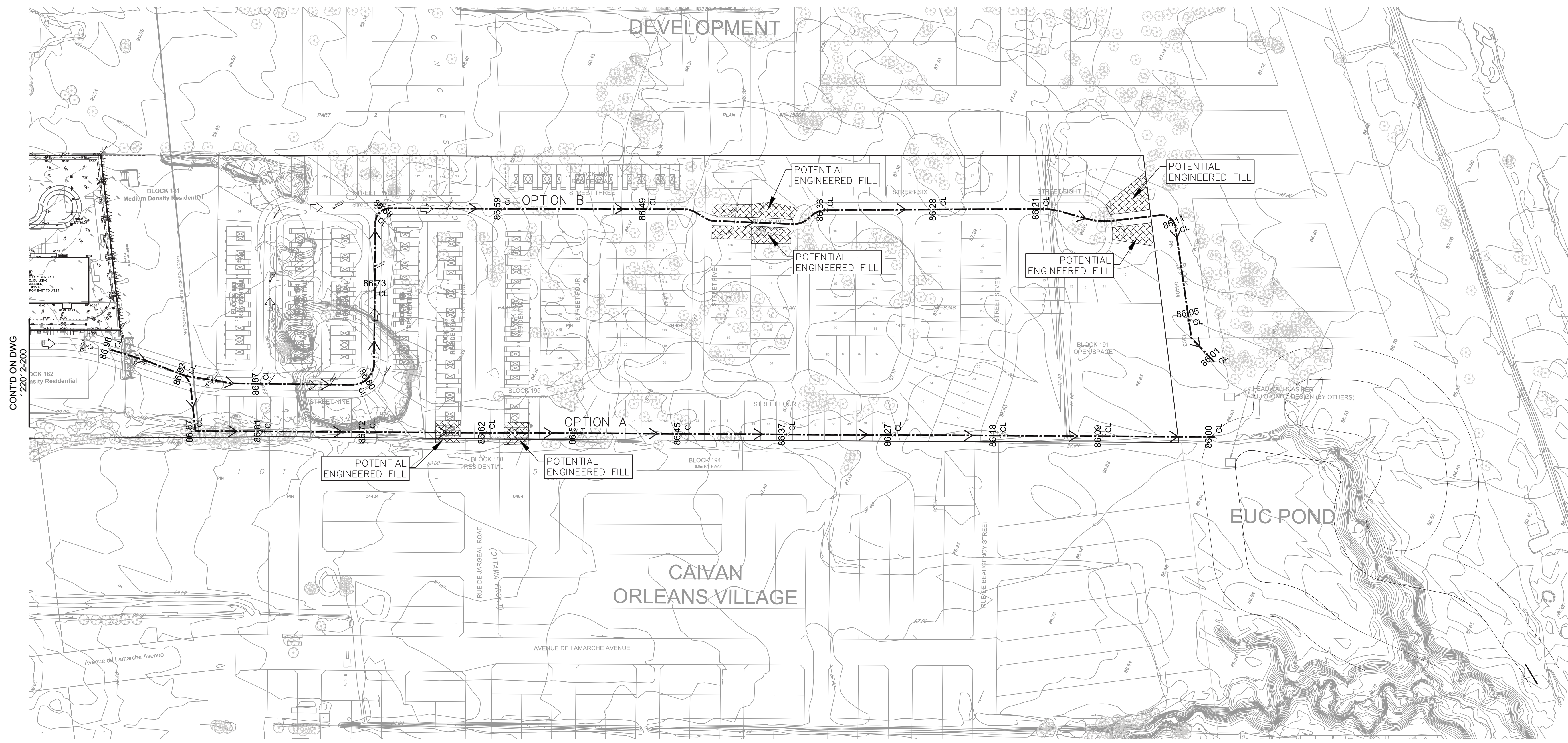

CONT'D ON DWG
122012-200

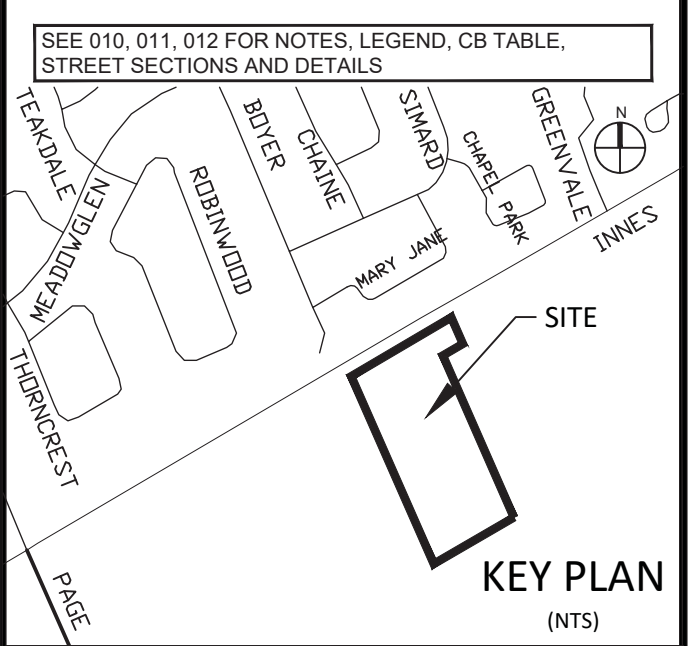
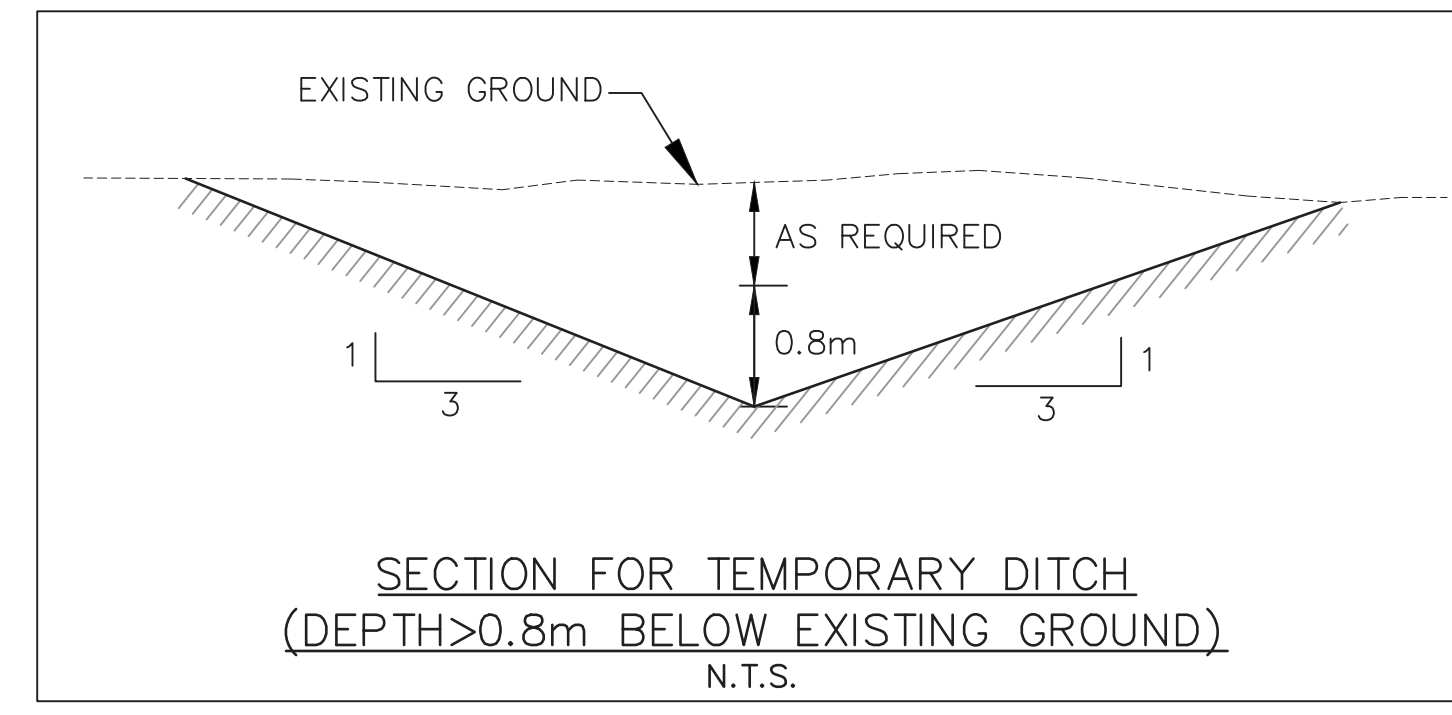
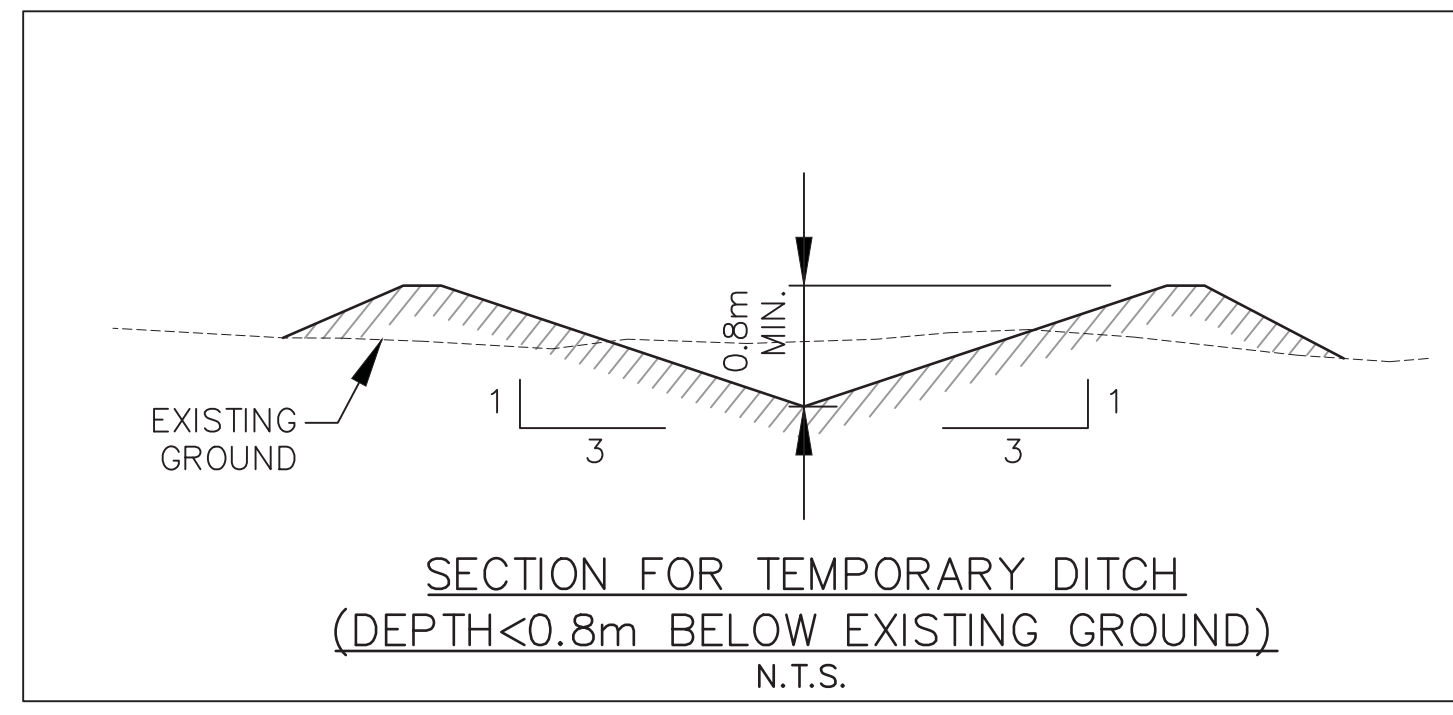

14			
13			
12			
11			
10			
9			
8			
7			
6			
5			
4			
3			
2			
1	ISSUED FOR SPA	DGY	2020-02-18
No.	REVISIONS	By	Date

IBI GROUP
400 - 333 Preston Street
Ottawa ON K1S 5N4 Canada
tel 613 225 1311 fax 613 225 9868
ibigroup.com

Project Title
U-HAUL
3636 INNES ROAD

Professional Engineer
D. Yannopoulos
2020/02/18
PROVINCE OF ONTARIO

Drawing Title
GRADING PLAN

Scale
1 : 750

Design R.M./W.Z.	Date JANUARY 2020
Drawn E.H.	Checked DGY

Project No. 122012	Drawing No. 201
------------------------------	---------------------------

A:\122012_122012-200\122012-200_Production\7.3_Steps\04_Cad\Sheet\301_Grading_Plan.dwg Layout Name: 301_Grading_Plan_Plot_S1.dwg AIA STANDARD - FULL CTB Post Score: 1.508 Printed At: 2020-02-18 10:58:18 User: AIA STANDARD - FULL CTB Post Score: 1.508 Printed At: 2020-02-18 10:58:18 User: AIA STANDARD - FULL CTB Post Score: 1.508 Printed At: 2020-02-18

CITY PLAN No.#### CITY FILE No.####

