

LEGEND

- PROPERTY LINE
- SETBACK LIMIT
- PROPOSED CURB
- PROPOSED DEPRESSED CURB
- PROPOSED STORM MANHOLE
- PROPOSED CATCHBASIN
- PROPOSED CATCHBASIN MANHOLE
- AD ○ PROPOSED AREA DECK DRAIN BY OTHERS (REFER TO MECH DRAWINGS FOR MORE INFO)
- SANMH PROPOSED SANITARY SERVICE CW MANHOLE
- PROPOSED WATER SERVICE
- PROPOSED STORM SEWER
- ▲ BUILDING ENTRANCE / EXIT
- UNDERGROUND PARKING P1 LIMIT
- V&V ○ PROPOSED VALVE AND VALVE BOX
- ⊞ PROPOSED CAP
- ⊞ PROPOSED WATER METER
- ⋈ SIAMSESE CONNECTION
- WILDLIFE EXCLUSION FENCE
- EXISTING DITCH CENTRELINE
- TOS EXISTING TOP OF SLOPE
- BOS EXISTING BOTTOM OF SLOPE
- V&V ○ EXISTING VALVE & VALVE BOX
- EXISTING SANITARY SEWER
- EXISTING WATERMAIN
- EXISTING STORM SEWER
- EX CB ○ EXISTING CATCHBASIN
- EX STMMH ○ EXISTING STORM MANHOLE
- IW ○ EXISTING WATER WALLE
- FH ○ EXISTING HYDRANT
- EX UP ○ EXISTING UTILITY POLE
- EXISTING FENCE

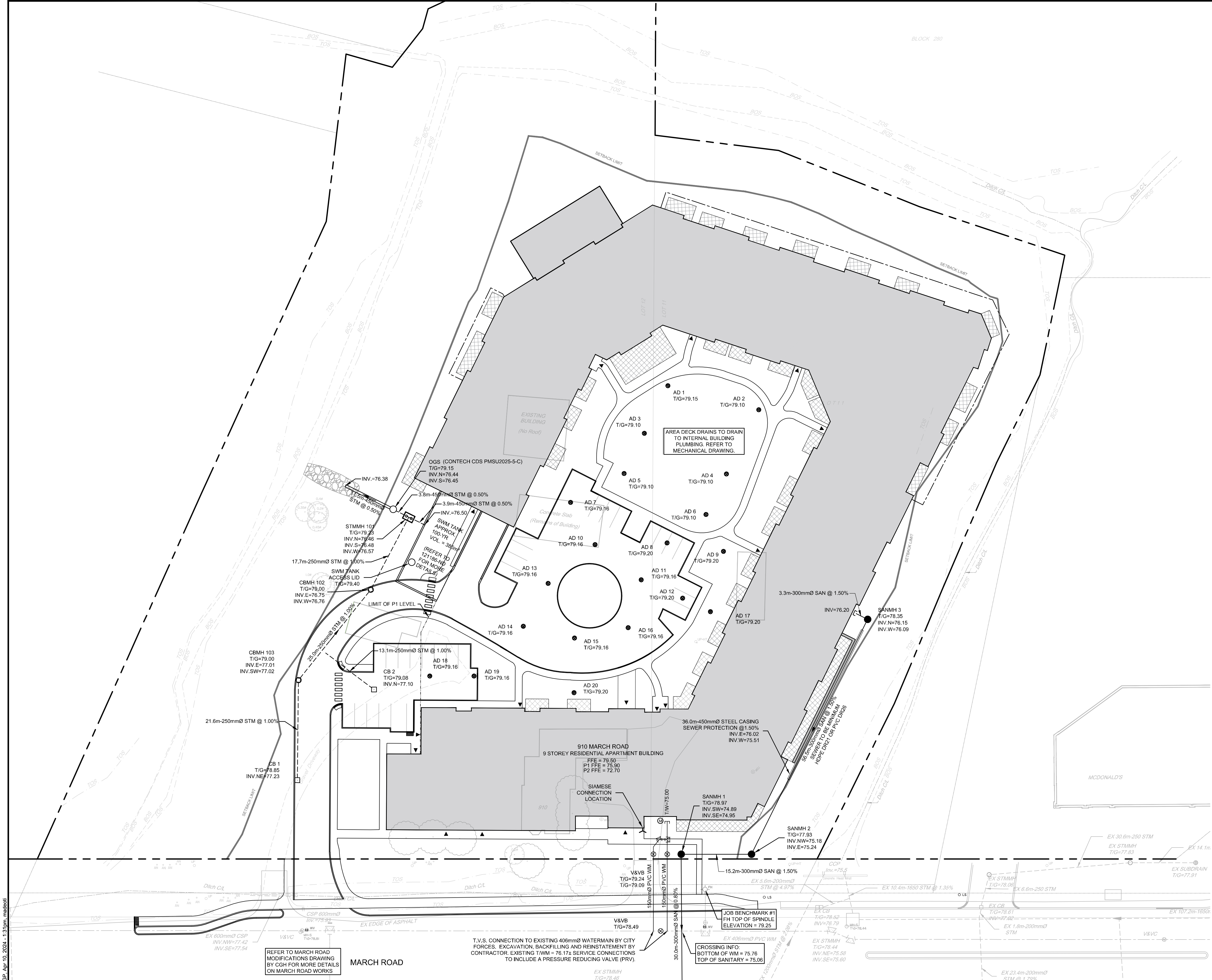

REFER TO MARCH ROAD MODIFICATIONS DRAWING BY CGH FOR MORE DETAILS ON MARCH ROAD WORKS

T.V.S. CONNECTION TO EXISTING 406mmØ WATERMAIN BY CITY FORCES. EXCAVATION, BACKFILLING AND REINSTATEMENT BY CONTRACTOR. EXISTING TWM = 78.17± SERVICE CONNECTIONS TO INCLUDE A PRESSURE REDUCING VALVE (PRV).

CROSSING INFO. BOTTOM OF WM = 75.76 TOP OF SANITARY = 75.06

REFER TO 121186-ND FOR ADDITIONAL NOTES AND DETAILS

NOTE: THE POSITION OF ALL POLE LINES, CONDUITS, WATERMANS, SEWERS AND OTHER UNDERGROUND AND OVERGROUND UTILITIES AND STRUCTURES IS NOT NECESSARILY SHOWN ON THE CONTRACT DRAWINGS, AND WHERE SHOWN, THE ACCURACY OF THE POSITION OF SUCH UTILITIES AND STRUCTURES IS NOT GUARANTEED. BEFORE STARTING WORK, DETERMINE THE EXACT LOCATION OF ALL SUCH UTILITIES AND STRUCTURES AND ASSUME ALL LIABILITY FOR DAMAGE TO THEM.

NOT FOR CONSTRUCTION

No.	REVISION	DATE	BY
1.4	REVISED PER CITY COMMENTS	APR 18/24	CJR
1.3	REVISED PER CITY COMMENTS	DEC 22/23	CJR
1.2	REVISED PER CITY COMMENTS	DEC 14/23	CJR
1.1	RE-ISSUED FOR SITE PLAN	AUG 4/23	CJR
1.0	ISSUED FOR SITE PLAN	MAR 29/23	CJR

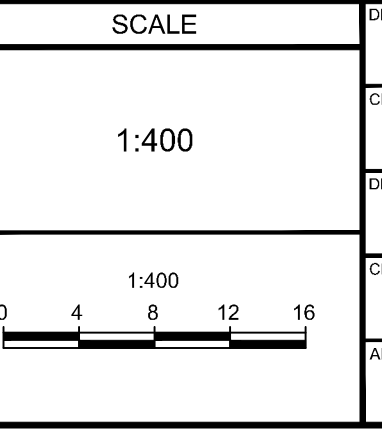

SCALE 1:400

DESIGN SM

CHECKED CJR

DRAWN SM

CHECKED CJR

APPROVED JLS

FOR REVIEW ONLY

PROFESSIONAL ENGINEER
C. J. RIDDLE
APR 18/24
PROVINCE OF ONTARIO

NOVATECH
Engineers, Planners & Landscape Architects
Suite 200, 240 Michael Cowpland Drive
Ottawa, Ontario, Canada K2M 1P6
Telephone (613) 254-9643
Facsimile (613) 254-5867
Website www.novatech-eng.com

LOCATION
CITY OF OTTAWA
910 MARCH ROAD

DRAWING NAME
GENERAL SERVICING PLAN

PROJECT No. 121186

REV # 1.4

DRAWING No. 121186-GP

M:\2024\121186\CD\Drawings\121186-GP.dwg, GP, Apr 10, 2024, 1:31pm, mcsd@novatech.com

D02-02-20-0050 & D07-12-20-0089 PLAN#18358