

GENERAL NOTES

- 1. ALL WORKS AND MATERIALS SHALL CONFORM TO THE LATEST REVISION OF THE STANDARDS AND SPECIFICATIONS FOR THE CITY OF OTTAWA, ONTARIO PROVINCIAL STANDARD DRAWINGS (OPSD) AND SPECIFICATIONS (OPSS), WHERE APPLICABLE. LOCAL UTILITY STANDARDS AND MINISTRY OF TRANSPORTATION STANDARD DRAWINGS WILL APPLY WHERE REQUIRED.

WATERMAIN NOTES

- 1. ALL WATERMAIN INSTALLATION SHALL CONFORM TO THE LATEST REVISIONS OF THE CITY OF OTTAWA AND THE ONTARIO PROVINCIAL STANDARD DRAWINGS (OPSD) AND SPECIFICATIONS (OPSS).

SANITARY AND STORM SEWER NOTES

- 1. LASER ALIGNMENT CONTROL TO BE UTILIZED ON ALL SEWER INSTALLATIONS.

- 1. ALL SANITARY SEWER INSTALLATION SHALL CONFORM TO THE LATEST REVISIONS OF THE CITY OF OTTAWA AND THE ONTARIO PROVINCIAL STANDARD DRAWINGS (OPSD) AND SPECIFICATIONS (OPSS).

- 17. ALL REINFORCED CONCRETE STORM SEWER PIPE SHALL BE IN ACCORDANCE WITH CSA A257.2, OR LATEST AMENDMENT. ALL NON-REINFORCED CONCRETE STORM SEWER PIPE SHALL BE IN ACCORDANCE WITH CSA A257.1, OR LATEST AMENDMENT.

- 1. ALL SANITARY GRAVITY SEWER SHALL BE PVC SDR 35, IPEX "RING-TITE" (OR APPROVED EQUIVALENT) PER CSA STANDARD B182.2 OR LATEST AMENDMENT, UNLESS SPECIFIED OTHERWISE.

- 1. ALL SANITARY GRAVITY SEWER TRENCH AND BEDDING SHALL BE PER CITY OF OTTAWA STD. 56 AND 57, CLASS 'B' BEDDING, UNLESS SPECIFIED OTHERWISE.

- 1. ALL SANITARY GRAVITY SEWER FRAME AND COVERS SHALL BE PER CITY OF OTTAWA STD. 524 AND 525.

- 1. ALL SANITARY GRAVITY SEWER STRUCTURE FRAME AND COVERS SHALL BE PER CITY OF OTTAWA STD. 525 AND 524.1, UNLESS OTHERWISE NOTED.

- 1. ALL SANITARY GRAVITY SEWER STRUCTURE FRAME AND COVERS SHALL BE PER OPSD 701.021.

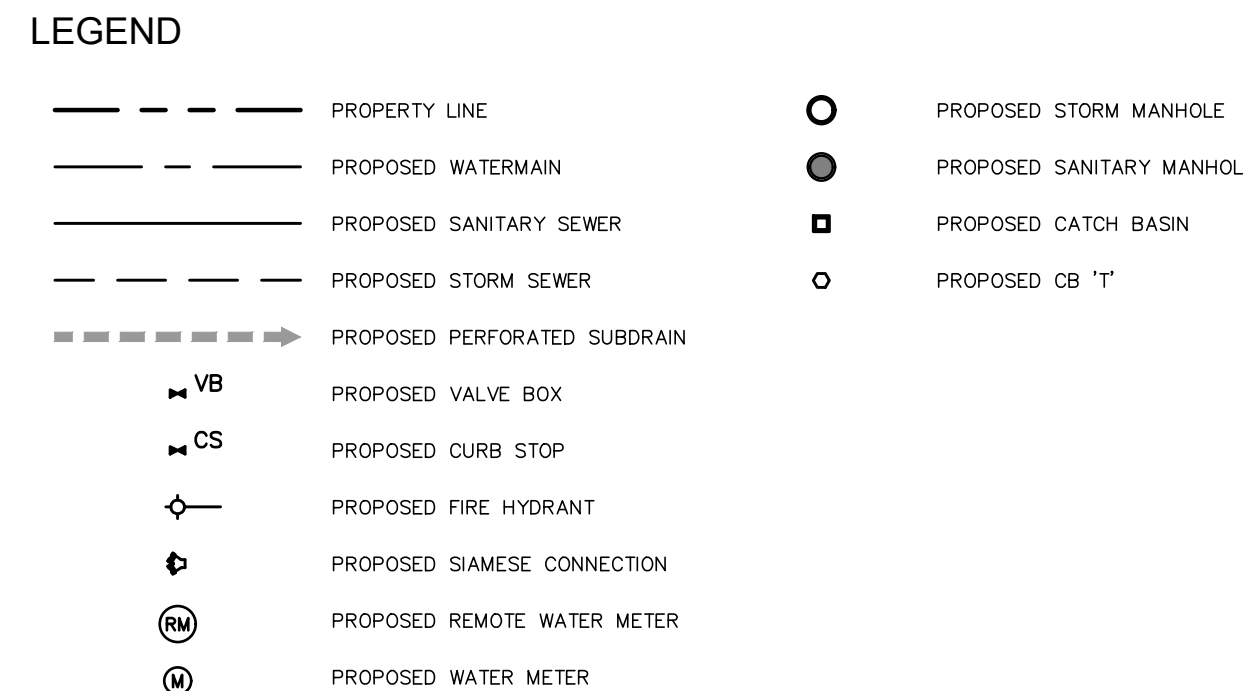
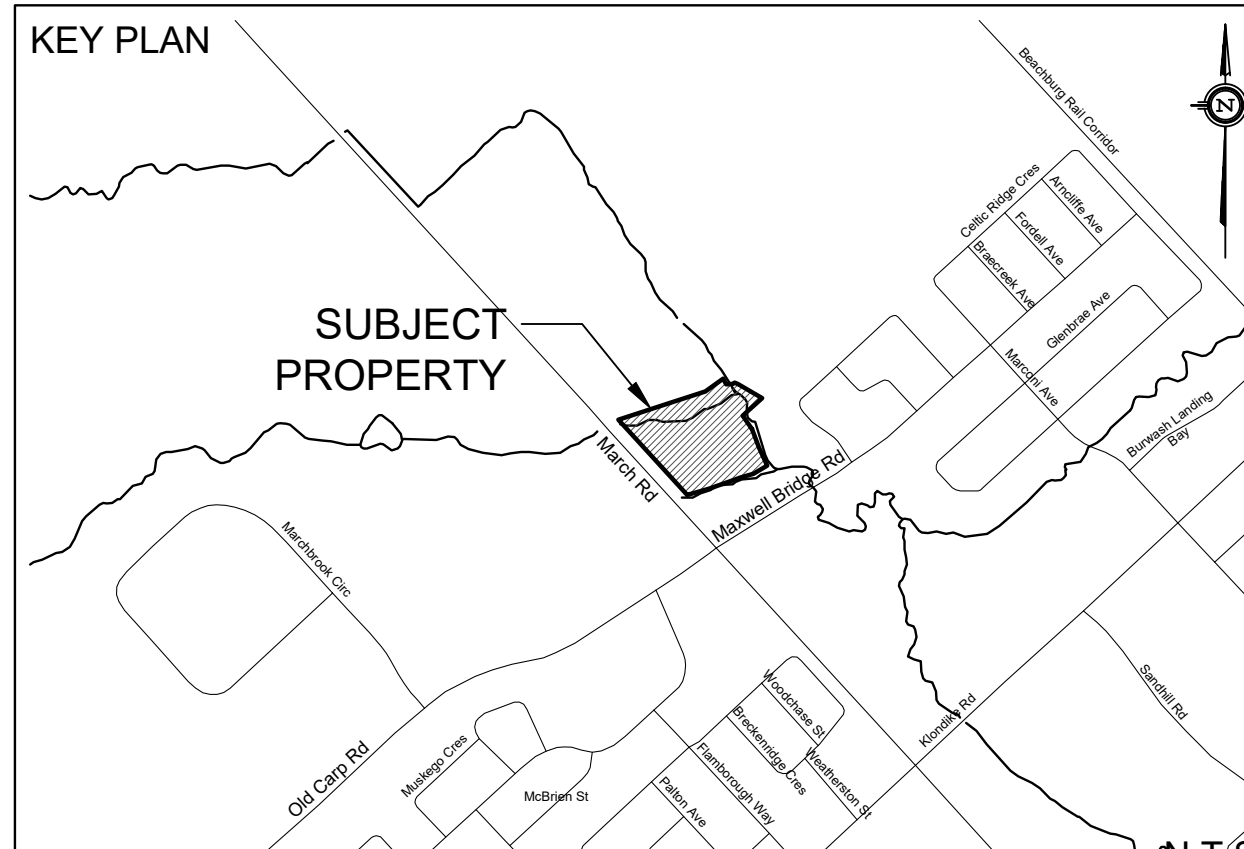
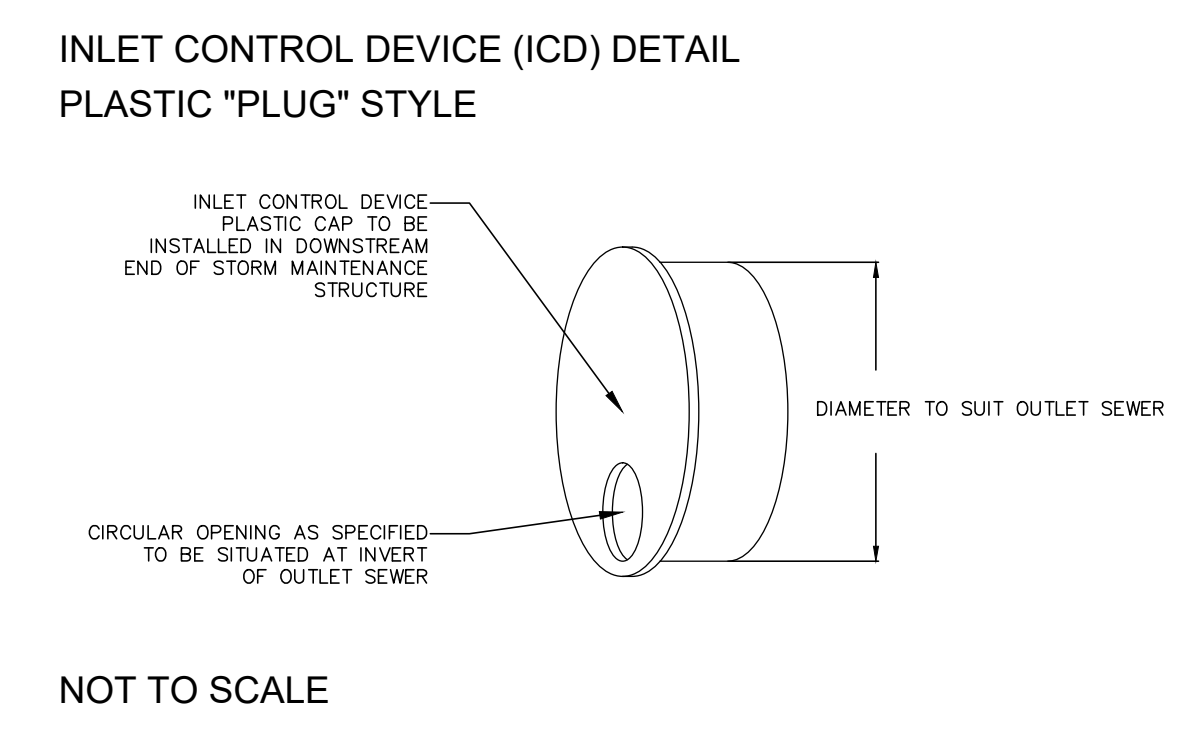

EXISTING UNDERGROUND SERVICES AND UTILITY LOCATIONS DERIVED FROM THE BEST AVAILABLE DATA. AS-CONSTRUCTED DRAWINGS, UTILITY DRAWINGS AND INFRASTRUCTURE MAPPING PROVIDED BY THE CITY OF OTTAWA.

CONTRACTOR TO CONFIRM ELEVATIONS AND LOCATIONS OF EXISTING UNDERGROUND SERVICES AND UTILITIES WITHIN THE RIGHT OF WAY PRIOR TO INSTALLATION OF SITE SERVICING INFRASTRUCTURE.

THE CONTRACTOR SHALL IMPLEMENT BEST MANAGEMENT PRACTICES, TO PROVIDE FOR PROTECTION OF THE AREA DRAINAGE SYSTEM AND THE RECEIVING WATERCOURSE, DURING CONSTRUCTION ACTIVITIES. THE CONTRACTOR ACKNOWLEDGES THAT THE FAILURE TO IMPLEMENT APPROPRIATE EROSION AND SEDIMENT CONTROL MEASURES MAY BE SUBJECT TO PENALTIES IMPOSED BY ANY APPLICABLE REGULATORY AGENCY.

NOT FOR CONSTRUCTION

TOPOGRAPHIC INFORMATION TOPOGRAPHIC INFORMATION PROVIDED BY STATTEC GEOMATICS LTD. PROJ. NO. 161813685-111 DATED JULY 10, 2017

SITE PLAN INFORMATION SITE PLAN PROVIDED BY GREYSTONE PROJ. NO. 17300 DATED JUNE 26, 2020

GEOTECHNICAL STUDY GEOTECHNICAL RECOMMENDATIONS PROVIDED BY PATERSON GROUP PROJ. NO. PG5119-1 DATED NOVEMBER 13, 2019

SITE SERVICING AND STORMWATER MANAGEMENT STUDY SERVICING AND STORMWATER MANAGEMENT RECOMMENDATIONS PROVIDED BY DSEL PROJ. NO. 17-962 DATED JUNE 2020

BENCH MARK TOP OF SPINDLE OF FIRE HYDRANT LOCATED AT MARCH ROAD AND MAXWELL BRIDGE ROAD INTERSECTION ELEV=79.35

Table with 3 columns: No., BY, DESCRIPTION. Row 1: 1 B.N.C. 20.06.26 ISSUED FOR MUNICIPAL REVIEW. Row 2: No. BY YY.MM.DD DESCRIPTION

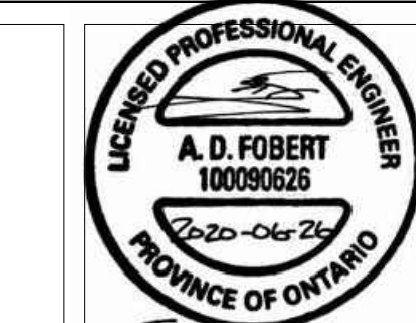

PROJECT No. 17-962 REVIEWED BY

SITE SERVICING PLAN 910 MARCH ROAD

WEXFORD COMMERCIAL DEVELOPMENTS LTD. 6 Malabar Court Hamilton, Ontario, L9C 2B9 Tel. (289) 680-7711



DRAWN BY: B.N.C. CHECKED BY: A.D.F. DRAWING NO. SHEET NO. DESIGNED BY: B.N.C. CHECKED BY: A.D.F. SCALE: 1:500 DATE: JUNE 2020 SSP-1 3 of 4