



SCALE:

Catchment / Storm Event	SWM Requirements		
	Release Rate (L/s)	Surface Ponding Depth (m)	Storage (m³)
CA1 / 5 year	7	0.2	15
CA1 / 100 year	7	0.29	37
CA2 / 5 year	16	none	26
CA2 / 100 year	18	none	59

Andrew McCreight
ANDREW MCCREIGHT
 MANAGER (A), DEVELOPMENT REVIEW CENTRAL
 PLANNING, REAL ESTATE & ECONOMIC DEVELOPMENT
 DEPARTMENT, CITY OF OTTAWA

APPROVED
 By Andrew McCreight at 8:29 am, Aug 10, 2023

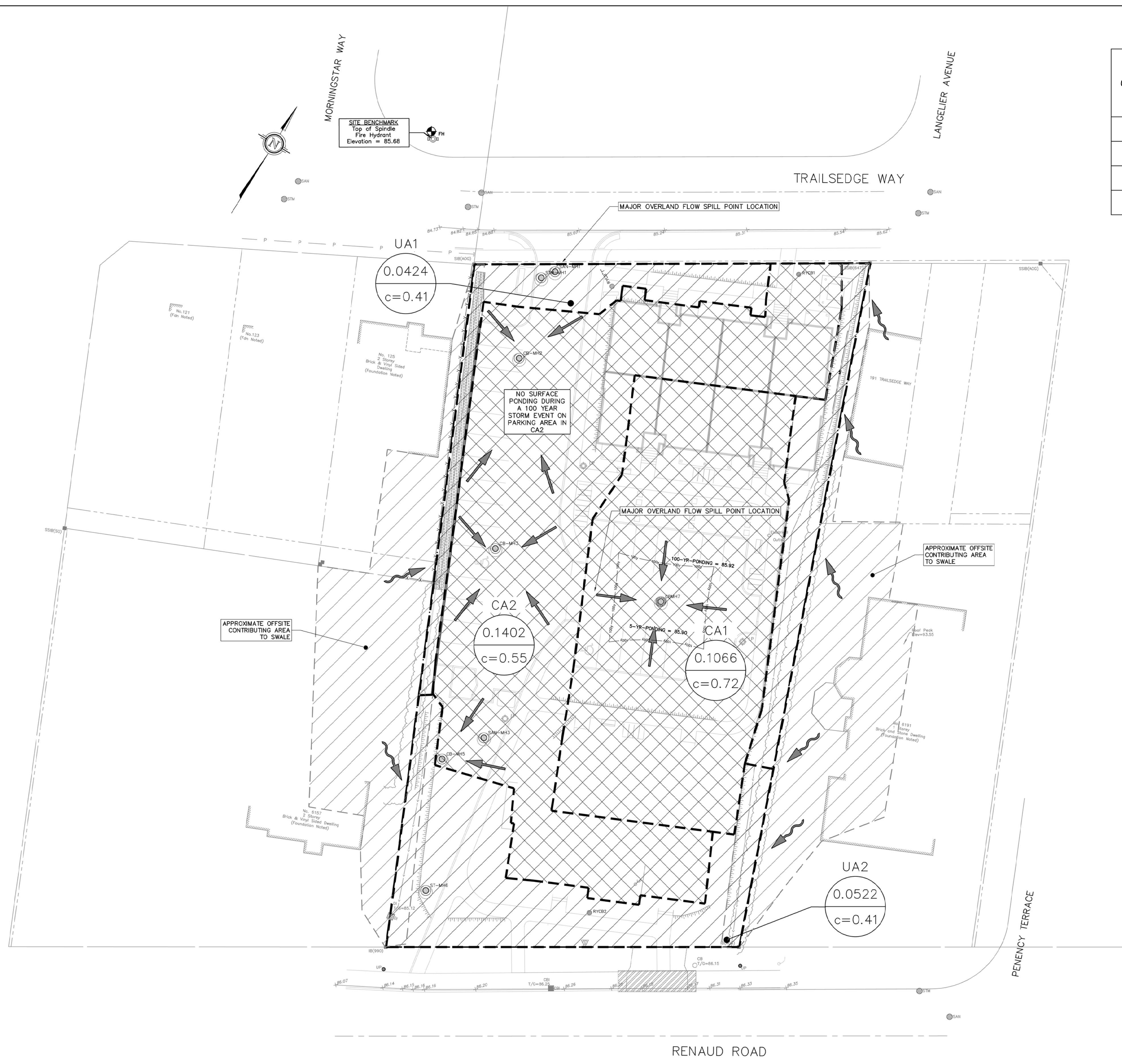

LEGEND (STORM WATER MANAGEMENT)

- CA1 2.037 0.58: CATCHMENT LABEL, CATCHMENT AREA (HECTARES), 5 YEAR RUNOFF COEFFICIENT
- : CATCHMENT AREA BOUNDARY
- : PROPERTY LINE
- : TOP OF SLOPE
- : DIRECTION OF CONTROLLED FLOW
- ~: PRE-DEVELOPMENT DRAINAGE PATTERN
- : OVERLAND FLOW ROUTE
- [Hatched Box]: CONTROLLED AREA
- [Diagonal Lines Box]: UNCONTROLLED AREA

No.	REVISION	DATE	BY
7	REVISIONS PER 5th REVIEW COMMENTS	2023 FEB 06	SD
6	REVISIONS PER 4th REVIEW COMMENTS	NOV. 15/2022	ML
5	REVISIONS PER 3rd REVIEW COMMENTS	AUG. 15/2022	ML
4	REVISIONS PER NEW SITE PLAN AND REVIEW COMMENTS	APR. 13/2022	ML
3	ISSUED FOR SPC RE-SUBMISSION	APR. 22/2021	ML
2	REVISIONS PER SITE PLAN AND 1ST REVIEW COMMENTS	MAR. 29/2021	ML
1	ISSUED FOR SPC APPLICATION	JUNE 30/2020	ML
#	REVISION ITEM / DESCRIPTION	REV. DATE	INT.

Kollaard Associates Engineers
 (613) 860-0923
 info@kollaard.ca
 P.O. BOX 189, 210 PRESCOTT ST.
 KEMPTVILLE, ONTARIO
 K0G 1J0 FAX (613) 258-0475
 http://www.kollaard.ca

CLIENT:
 TEAK DEVELOPMENTS
 31 WOODVIEW CRESCENT
 OTTAWA, ON K1B 3B1

PROJECT:
 PROPOSED RESIDENTIAL DEVELOPMENT

LOCATION:
 6173 RENAUD ROAD
 CITY OF OTTAWA, ON
 K1W 0K9

DESIGNED BY: ML **CHECKED BY:** SD
DRAWN BY: ML **APPROVED BY:** SD
DATE: MARCH 17, 2021
KOLLAARD FILE NUMBER: 190867

DRAWING NUMBER: 190867-SWM
DRAWING NAME: STORMWATER MANAGEMENT PLAN

SITE BENCHMARK
 Top of Spindle
 Fire Hydrant
 Elevation = 86.66

STORMWATER MANAGEMENT PLAN
 SCALE = 1:250

D07-12-20-0094