

- GENERAL NOTES:**
- All dimensions are in metres; all elevations are in metres and are geodetic. TBM = top of spindle of existing fire hydrant on Trailsege Way, Elevation = 85.68. Geodetic datum reference: CGD-1928/1978.
 - This is not a legal survey. Boundary and topographic information were derived from FARLEY, SMITH & DENIS SURVEYING LTD File No. 253-17.
 - Contractor is responsible for location and protection of utilities. All dimensions to be verified on site by contractor prior to construction.
 - Any changes made to this plan must be verified and approved by Kollaard Associates Inc.
 - Client is responsible for acquiring all necessary permits. This drawing is not for construction until a building permit has been granted.
 - The proposed grades have been set and verified for site grading control only. The grade rises at the building location should be verified with regard to subsurface conditions by qualified geotechnical personnel after completion of the excavation.
 - The underside of footing elevation has been set based on the information available and may not have accounted for actual ground water conditions at the exact house location and should be verified by qualified geotechnical personnel upon completion of the excavation.
 - A geotechnical engineer should be retained to provide recommendations with respect to the sub-grade conditions prior to footing installation.
 - The owner agrees to prepare and implement an erosion and sediment control plan to the satisfaction of the City of Ottawa, appropriate to the site conditions prior to undertaking any site alterations (filling, grading, removal of vegetation, etc.) and during all phases of site preparation and construction in accordance with the current Best Management Practices for Erosion and Sediment Control such as, and not limited to installing filter cloths across manholes/catchbasin lids to prevent sediments from entering structures and install and maintain a light duty silt fence barrier as required.
 - All materials and construction to be in accordance with City of Ottawa standards and Ontario Provincial Standards and Specifications; sewer and watermain material types; disinfection, provide minimum 2.4 metres of cover for water services, cathodic protection, City of Ottawa insulation specifications for watermain, pipe bedding, reinstatement of disturbed areas and leakage testing. Reference to Kollaard File No. 190867 for Servicing and Stormwater Management Design and Geotechnical Reports.

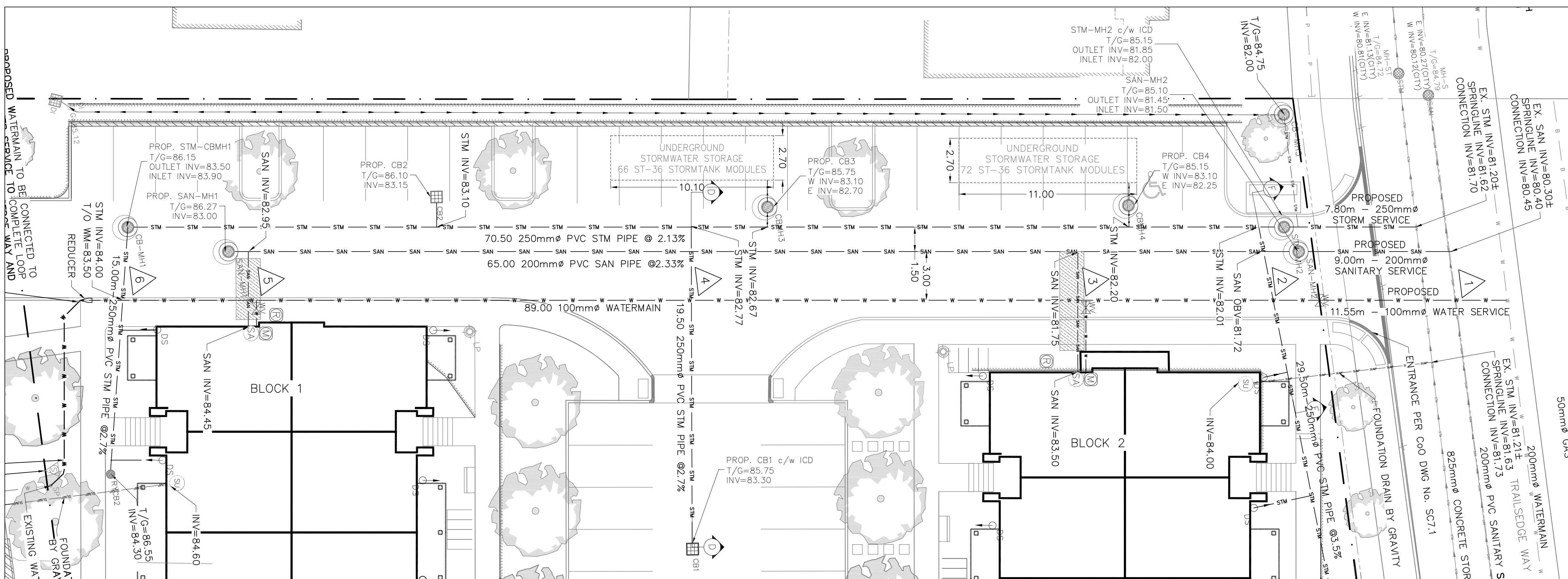

SITE SERVICING PLAN
SCALE = 1:150

SERVICE CONNECTION DETAIL (BLOCK 1)
NOT TO SCALE

SERVICE CONNECTION DETAIL (BLOCK 2)
NOT TO SCALE

WATER CROSSING TABLE

1	BOTTOM OF W/M = 82.45 STM OBV = 82.05± SAN OBV = 80.55±
2	BOTTOM OF W/M = 82.70 STM OBV = 82.44
3	SAN INV = 83.40 TOP OF W/M = 82.90
4	BOTTOM OF W/M = 83.40 STM OBV = 83.14
5	SAN INV = 84.40 TOP OF W/M = 83.90
6	STM INV = 84.00 TOP OF W/M = 83.50

WATER TABLE [6173 RENAUD ROAD - SERVICE CONNECTION ON TRAILSEGE WAY]

LOCATION	DISTANCE (m)	GRADE ELEV. (m)	TOP OF WATER SERVICE ELEV. (m)
CONNECTION @ TRAILSEGE WAY	0.00	85.00	82.60
PROPERTY LINE	11.50	85.10	82.70
BLOCK 1	26.50	85.30	82.80
BLOCK 2	76.50	86.35	83.80
PROPERTY LINE @ RENAUD ROAD	100.50	86.25	83.85

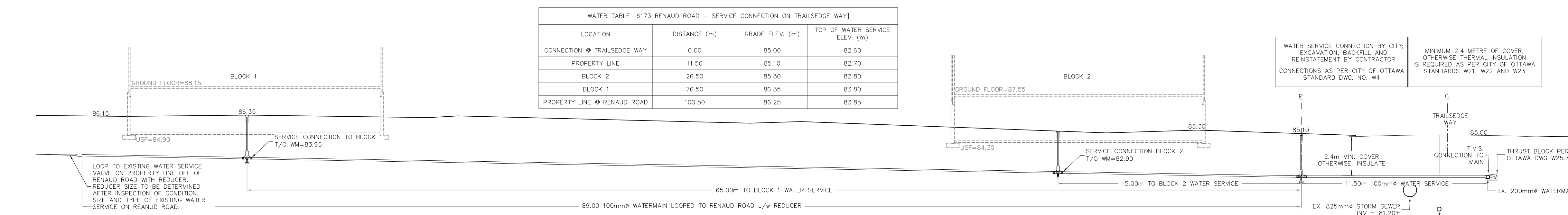

WATERMAIN DETAIL
SCALE = 1:150

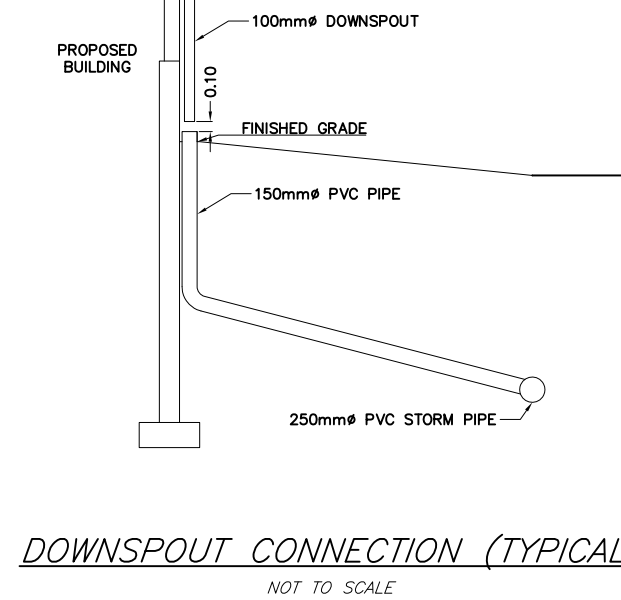

DOWNSPOUT CONNECTION (TYPICAL)
NOT TO SCALE

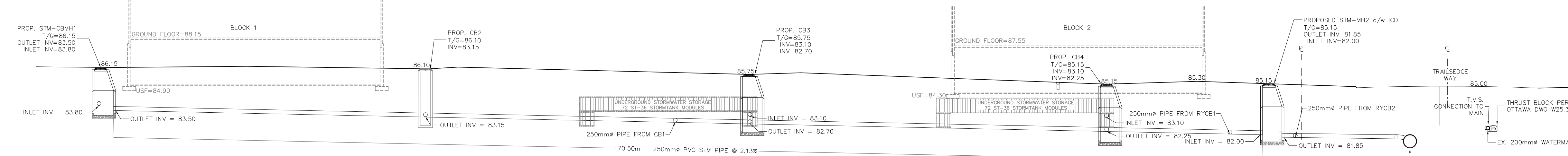

STORM SEWER DETAIL
SCALE = 1:150

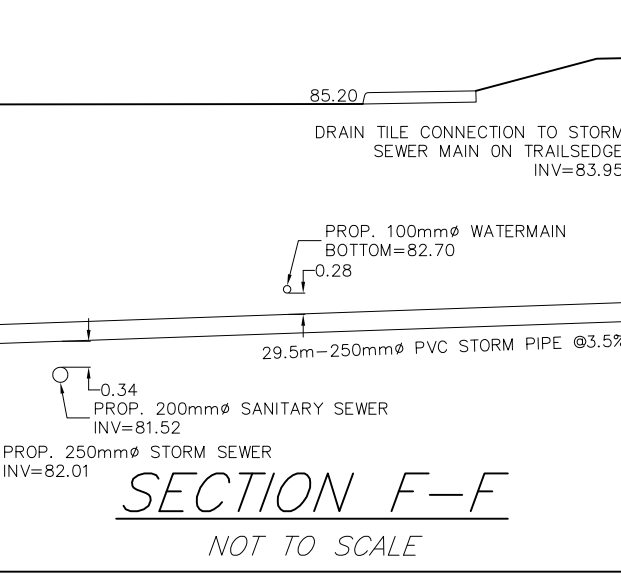

SECTION F-F
NOT TO SCALE

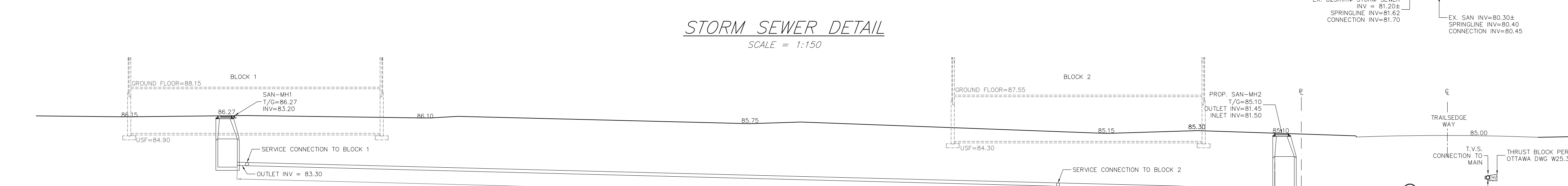

SANITARY SEWER DETAIL
SCALE = 1:150

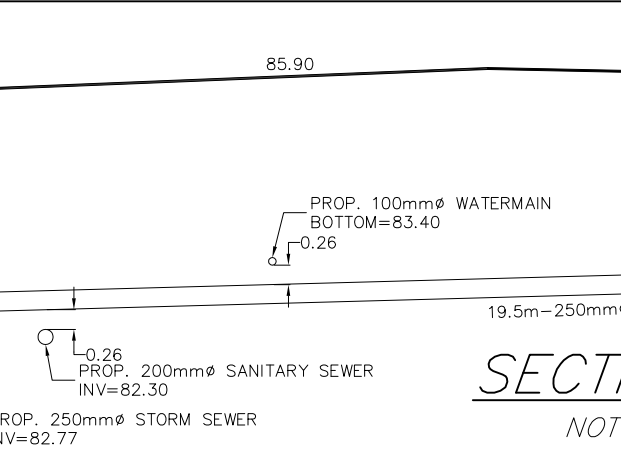

SECTION D-D
NOT TO SCALE

No.	REVISION	DATE	BY
3	ISSUED FOR SPC RE-SUBMISSION	APR. 22/2021	ML
2	REVISIONS PER SITE PLAN AND 1ST REVIEW COMMENTS	MAR. 29/2021	ML
1	ISSUED FOR SPC APPLICATION	JUNE 30/2020	ML
#	REVISION ITEM / DESCRIPTION	REV. DATE	INT.

Kollaard Associates Engineers
(613) 860-0923
info@kollaard.ca

P.O. BOX 189, 210 PRESCOTT ST.
KEMPTVILLE, ONTARIO
K0G 1J0 FAX (613) 258-0475
http://www.kollaard.ca

CLIENT:
TEAK DEVELOPMENTS
31 WOODVIEW CRESCENT
OTTAWA, ON K1B 3B1

PROJECT:
PROPOSED RESIDENTIAL DEVELOPMENT

LOCATION:
6173 RENAUD ROAD
CITY OF OTTAWA, ON
K1W 0K9

DESIGNED BY: SD	CHECKED BY: SD
DRAWN BY: ML	APPROVED BY: SD
DATE: NOV. 11, 2019	KOLLAARD FILE NUMBER: 190867

DRAWING NUMBER: 190867-DET
DRAWING NAME: DETAILS

#18196

D07-12-20-0094