

Catchment / Storm Event	SWM Requirements		
	Release Rate (L/s)	Surface Ponding Depth (m)	Storage (m³)
CA1 / 5 year	7	0.2	15
CA1 / 100 year	7	0.29	37
CA2 / 5 year	16	none	26
CA2 / 100 year	18	none	59



SCALE:

LEGEND (STORM WATER MANAGEMENT)

- CA1 (2.037) CATCHMENT LABEL
- 0.58 CATCHMENT AREA (HECTARES)
- 0.58 5 YEAR RUNOFF COEFFICIENT
- CATCHMENT AREA BOUNDARY
- PROPERTY LINE
- ||| TOP OF SLOPE
- DIRECTION OF CONTROLLED FLOW
- ~ PRE-DEVELOPMENT DRAINAGE PATTERN
- OVERLAND FLOW ROUTE
- ▨ CONTROLLED AREA
- ▩ UNCONTROLLED AREA

No.	REVISION	DATE	BY
5	REVISIONS PER 3rd REVIEW COMMENTS	AUG. 15/2022	ML
4	REVISIONS PER NEW SITE PLAN AND REVIEW COMMENTS	APR. 13/2022	ML
3	ISSUED FOR SPC RE-SUBMISSION	APR. 22/2021	ML
2	REVISIONS PER SITE PLAN AND 1ST REVIEW COMMENTS	MAR. 29/2021	ML
1	ISSUED FOR SPC APPLICATION	JUNE 30/2020	ML
#	REVISION ITEM / DESCRIPTION	REV. DATE	INT.

Kollaard Associates Engineers
 (613) 860-0923
 info@kollaard.ca
 P.O. BOX 189, 210 PRESCOTT ST.
 KEMPTVILLE, ONTARIO
 K0G 1J0 FAX (613) 258-0475
 http://www.kollaard.ca

CLIENT:
 TEAK DEVELOPMENTS
 31 WOODVIEW CRESCENT
 OTTAWA, ON K1B 3B1

PROJECT:
 PROPOSED RESIDENTIAL DEVELOPMENT

LOCATION:
 6173 RENAUD ROAD
 CITY OF OTTAWA, ON
 K1W 0K9

DESIGNED BY: ML CHECKED BY: SD
 DRAWN BY: ML APPROVED BY: SD
 DATE: MARCH 17, 2021
 KOLLAARD FILE NUMBER: 190867

DRAWING NUMBER: 190867-SWM
 DRAWING NAME: STORMWATER MANAGEMENT PLAN

© COPYRIGHT 2020 KOLLAARD ASSOCIATES INCORPORATED

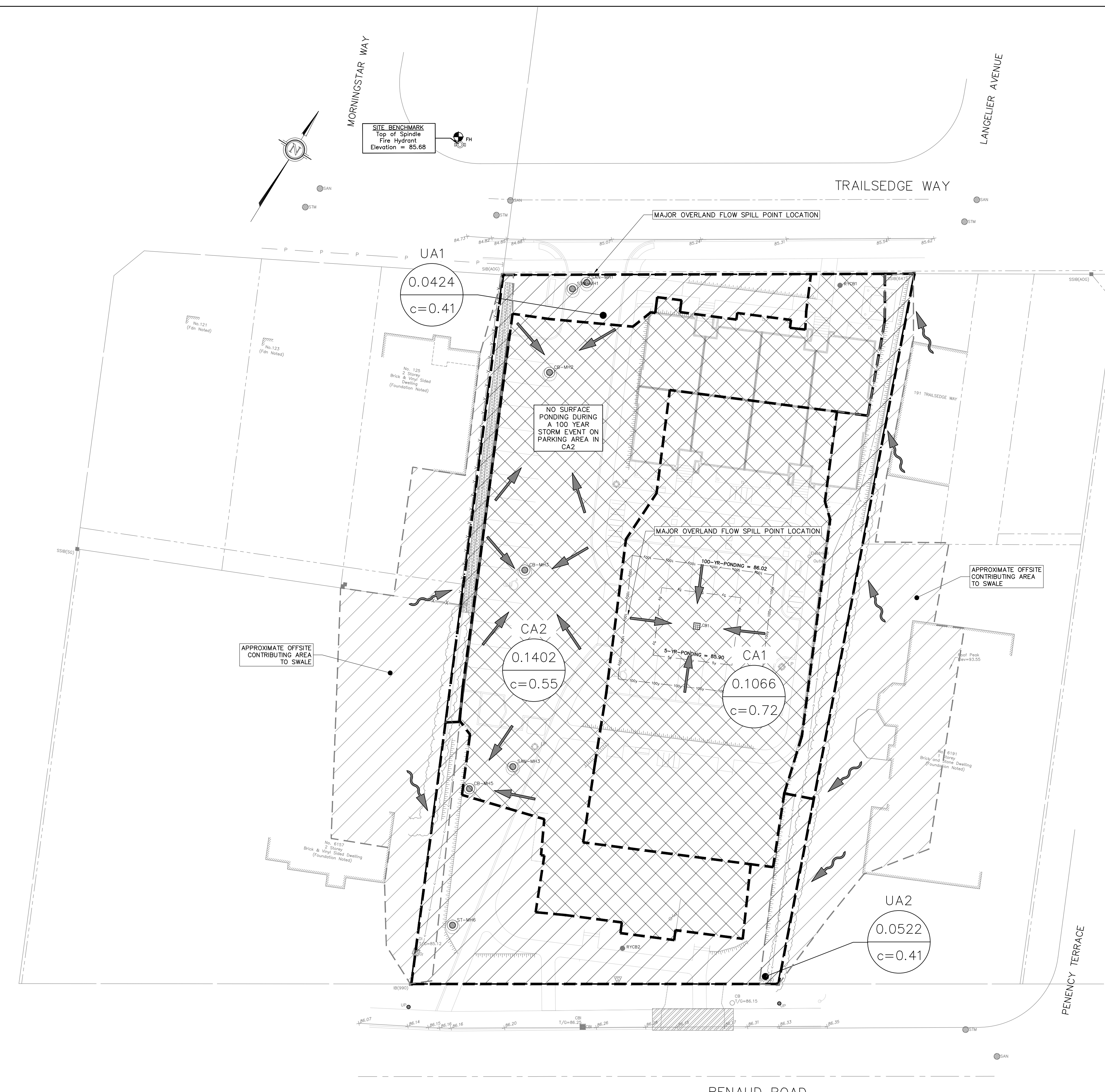

STORMWATER MANAGEMENT PLAN
 SCALE = 1:250

D07-12-20-0094

#18196