

CLIENT: MR. GEORGE ELIAS
31 WOODVIEW CRESCENT
OTTAWA, ON K1B 3B1

CONSULTANTS
ARCHITECTS: Rosaline J. Hill Architect Inc.

SURVEYORS: FARLEY, SMITH & DENIS SURVEYING LTD.
ONTARIO LAND SURVEYORS
GENERAL LAND SURVEYORS
190 COLLEGE ROAD, OTTAWA, ONTARIO K2E 7J5
TEL: (613) 721-8226 FAX: (613) 721-1828

CIVIL ENGINEERS: **K** Kollaard Associates
Engineers (613) 860-0923
1500 BROADVIEW AVE. #110 MISSISSAUGA, ONTARIO L4X 1L3
TEL: (905) 276-0475 FAX: (905) 276-0476
WWW.KOLLAARD.COM

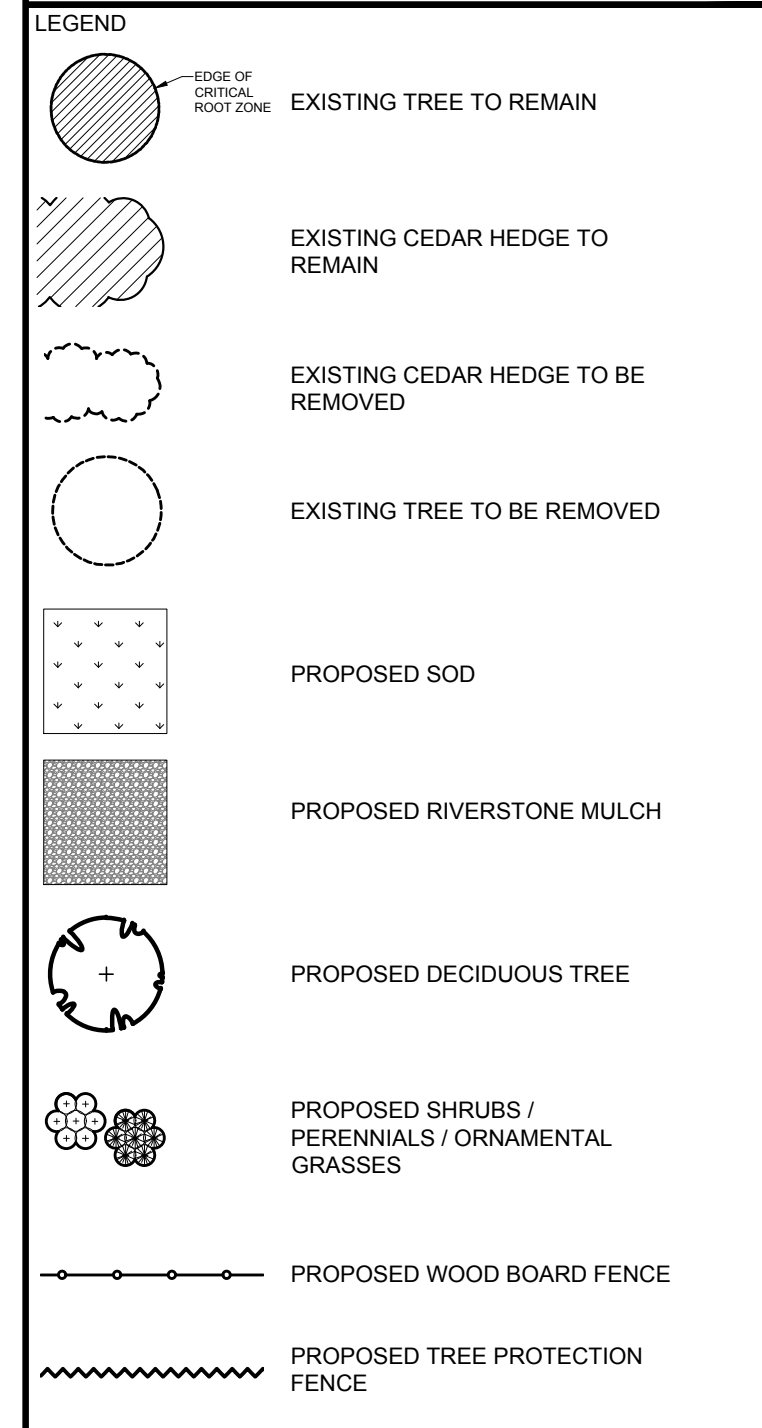

No.	Issue	Date	DR	CK
8	REVISED PER CITY COMMENTS	09/09/2022	ML	JL
7	REVISED PER NEW SITE PLAN	01/04/2022	ML	JL
6	LIGHT STANDARDS REVISED	05/17/2021	ML	JL
5	LIGHT STANDARDS ADDED	05/13/2021	ML	JL
4	REVISED PER CITY COMMENTS	05/07/2021	ML	JL
3	ISSUED FOR DISCUSSION AND REVIEW	06/18/2020	ML	JL
2	ISSUED FOR DISCUSSION AND REVIEW	06/17/2020	ML	JL
1	ISSUED FOR DISCUSSION AND REVIEW	06/04/2020	ML	JL

JAMES B. LENNOX & ASSOCIATES INC.
LANDSCAPE ARCHITECTS
3332 CARLING AVE. OTTAWA, ONTARIO K2H 5A8
Tel: (613) 722-5168 Fax: (866) 343-3942

PROJECT
6173 RENAUD ROAD, OTTAWA ON

DRAWING
TREE CONSERVATION REPORT & LANDSCAPE PLAN

STAMP
ASSOCIATION OF LANDSCAPE ARCHITECTS OF ONTARIO
MEMBER
JBL

SCALE
AS SHOWN
START DATE
JUNE 2020
PROJECT NO.
20MIS2002

PROJECT NORTH
DRAWING NO.
L.1
PLOT SIZE ARCH-D

1 TREE CONSERVATION REPORT & LANDSCAPE PLAN
SCALE: 1:200

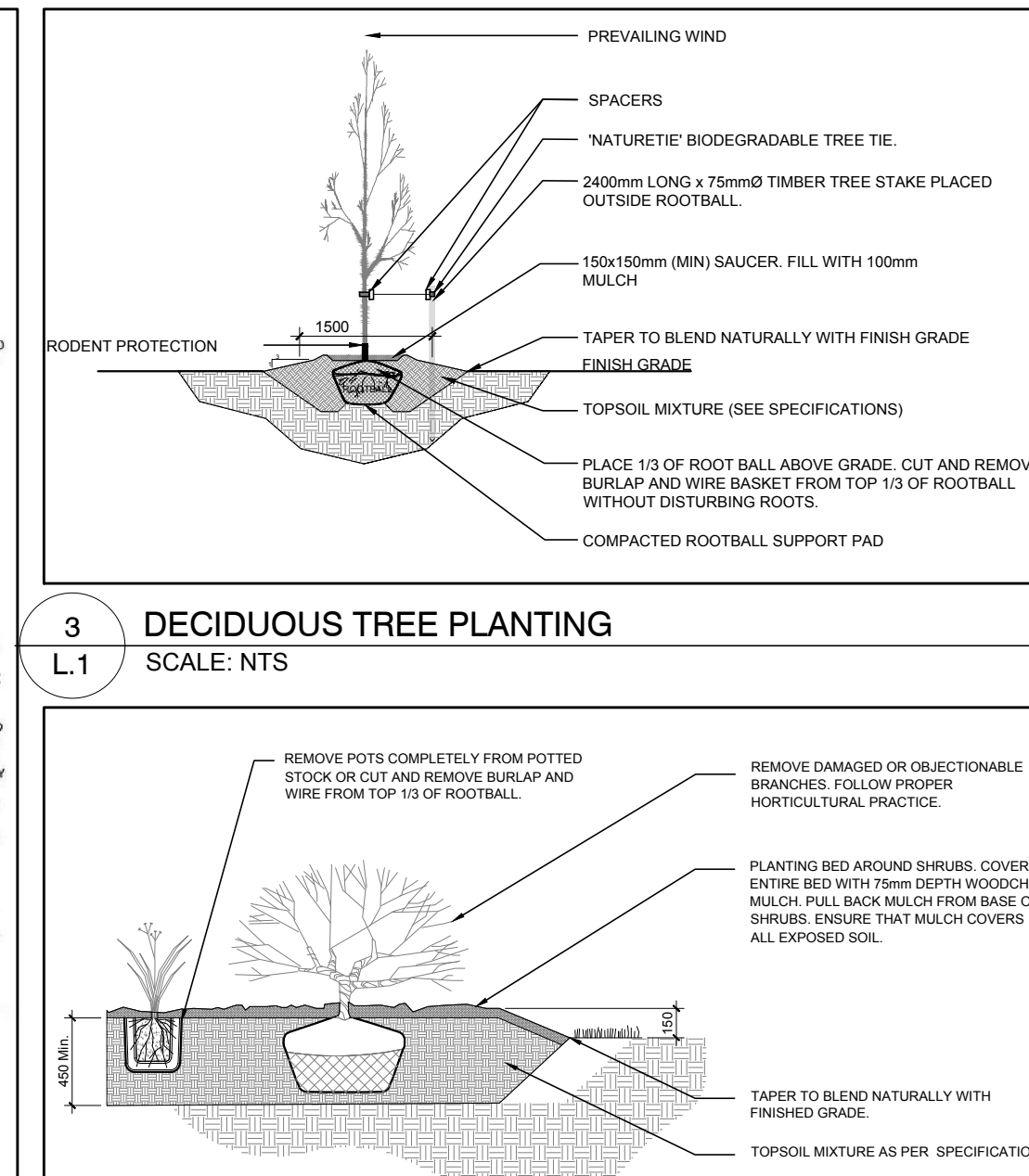
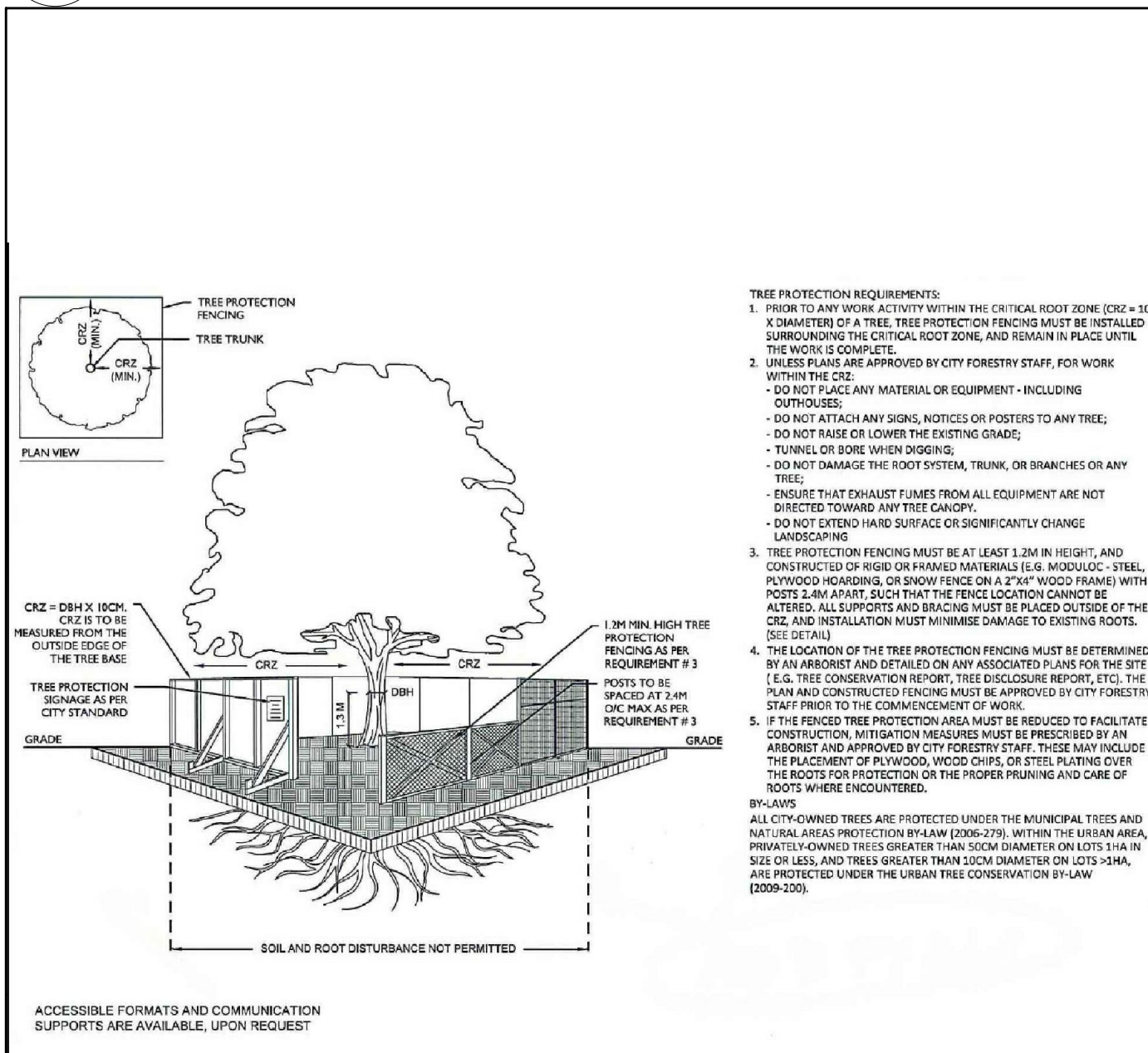

PROPOSED PLANT LIST

KEY	QTY	BOTANICAL NAME	COMMON NAME	SIZE	CONDITION	REMARKS
TREES						
HB	3	<i>Celtis occidentalis</i>	Hackberry	60mm ø	B&B	
HL	5	<i>Gleditsia triacanthos</i>	Honey Locust	60mm ø	B&B	
JL	2	<i>Syringa reticulata</i>	Japanese Tree Lilac	60mm ø	B&B	
GB	5	<i>Ginkgo biloba</i>	Maidenhair Tree	60mm ø	B&B	Male tree
SHRUBS						
AH	27	<i>Hydrangea arborescens</i> 'Annabelle'	Annabelle Hydrangea	1 Gallon pot	Potted	1200 mm o.c.
AW	28	<i>Spiraea japonica</i> 'Anthony Waterer'	Anthony Waterer Spiraea	800mm ht.	Potted	800 mm o.c.
JH	21	<i>Juniperus horizontalis</i> 'Compact Andorra'	Compact Andorra Juniper	600mm spr.	Potted	800 mm o.c.
PC	10	<i>Cotoneaster acutifolia</i>	Peking Cotoneaster	600mm ht.	Potted	1000 mm o.c.
PF	45	<i>Potentilla fruticosa</i> 'Goldfinger'	Goldfinger Cinquefoil	600mm ht.	Potted	800 mm o.c.
PO	4	<i>Physocarpus opulifolius</i>	Ninebark	800mm ht.	Potted	800 mm o.c.
SS	13	<i>Sorbaria sorbifolia</i> 'Sem'	Sem False Spiraea	600mm ht.	Potted	1000 mm o.c.
WC	17	<i>Thuja occidentalis</i> 'Fastigiata'	Pyramidal White Cedar	1500mm ht.	Potted	400 mm o.c.
PERENNIALS AND ORNAMENTAL GRASSES						
AJ	20	<i>Sedum 'Autumn Joy'</i>	Autumn Joy Sedum	100mm pot	Potted	400 mm o.c.
BS	63	<i>Rutbeckia fulgida</i> 'Goldsturm'	Yellow Coneflower	250mm pot	Potted	500 mm o.c.
KF	47	<i>Calamagrostis x acutiflora</i> 'Karl Foerster'	Feather Reed Grass	250mm pot	Potted	800 mm o.c.
PJ	8	<i>Echinacea purpurea</i> 'Magnus'	Magnus' Purple Coneflower	100mm pot	Potted	400 mm o.c.
SD	11	<i>Hemerocallis 'Stella D'Oro'</i>	Stella D'Oro Daylily	100mm pot	Potted	400 mm o.c.
SG	20	<i>Panicum virgatum</i> 'Shenandoah'	Shenandoah Switch Grass	250mm pot	Potted	800 mm o.c.

EXISTING TREE LIST

KEY	QTY	BOTANICAL NAME	COMMON NAME	SIZE	CONDITION	REMARKS
TREES						
AC	3	<i>Amelanchier canadensis</i>	Serviceberry	50-200mm DBH	Good	See Plan
AP	1	<i>Acer platanoides</i>	Norway Maple	300mm DBH	Good	See Plan
AR	1	<i>Acer rubrum</i>	Red Maple	700mm DBH	Good	See Plan
AS	1	<i>Acer saccharum</i>	Sugar Maple	150mm DBH	Fair	See Plan
CK	5	<i>Acer platanoides</i> 'Crimson King'	Crimson King Maple	300-400mm DBH	Good	See Plan
CO	7	<i>Celtis occidentalis</i>	Hackberry	80-100mm DBH	Good	See Plan
QR	2	<i>Quercus rubra</i>	Red Oak	500-700mm DBH	Good	See Plan
TO	*	<i>Thuja occidentalis</i>	Eastern White Cedar	100-200mm DBH	Good	See Plan
WM	1	<i>Morus alba</i> 'Pendula'	Weeping Mulberry	100mm DBH	Good	See Plan

*Denotes numerous

GENERAL NOTES:

- It is the responsibility of the appropriate contractor or official to report any errors, omissions or discrepancies on this plan with actual site conditions to the Landscape Architect before proceeding with construction.
- The contractor is to notify all utility companies and authorities prior to any excavation and ascertain locations of underground services.
- The contractor is to restate all areas and items damaged as a result of construction activity.
- The contractor is to comply with all pertinent codes and by-laws.
- The contractor is to maintain a positive surface run-off throughout the entire construction period.
- The Landscape Architect is not responsible for subsurface conditions.
- The contractor is to identify all existing trees to remain on site with the Landscape Architect prior to construction.
- The contractor is to stake the proposed location of all plant material in conjunction with the Landscape Architect prior to excavation.
- Minimum distances for selected deciduous trees are as follows:
 - Building Foundations 7.5m
 - Sidewalks 1.5m
 - Public Streets 2.5m
 - Underground Infrastructure 2.0m
- All trees within 1m of underground utility trenches are to be excavated by hand.
- Remove all protective wrapping from tree trunks after installation.
- Staking of trees shall only be performed if necessary.
- Ensure that mulch is pulled back a min. distance of 75mm from base of tree trunk.

D07-12-20-0094