

KEY PLAN:

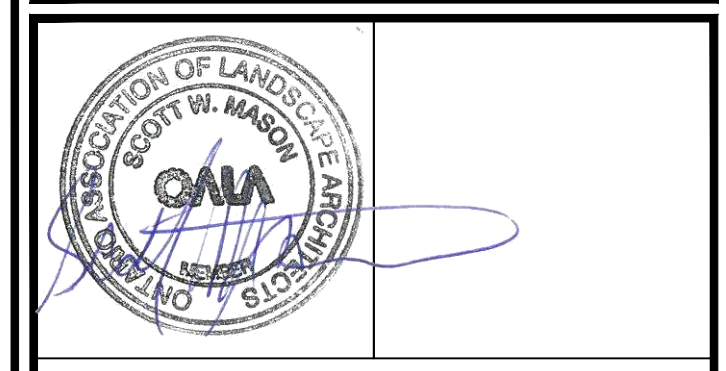

Urbantypology
 UNIT 10 163 STERLING ROAD TORONTO ON CANADA M8R 2R2 PH: 437.700.5446
 499 PRESTON STREET OTTAWA ON CANADA K1T 4N7 PH: 613.267.3042 / 613.897.1237

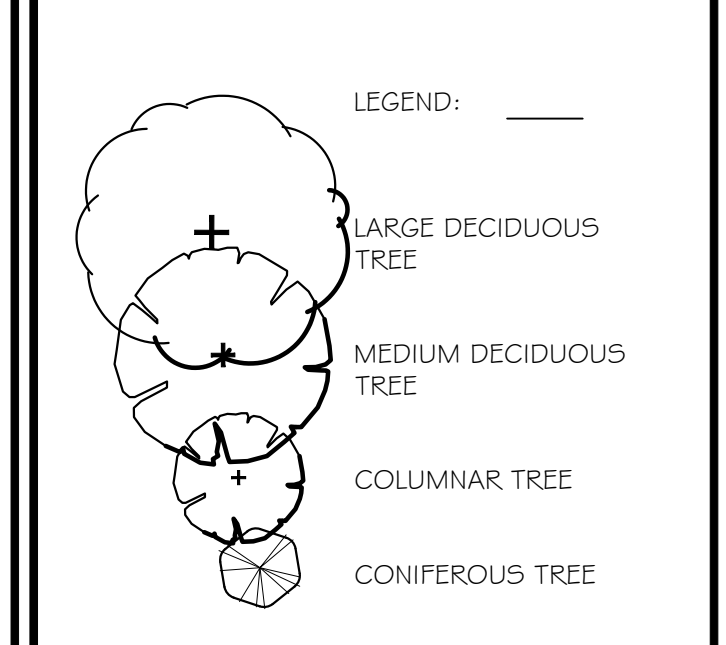

NO.	REVISION	DATE
02	ISSUED FOR SITE PLAN CONTROL	03 JUL 2024
01	ISSUED FOR SITE PLAN CONTROL	02 JUL 2024

ALL MEASUREMENTS ARE IN MILLIMETERS UNLESS SPECIFIED OTHERWISE. DO NOT SCALE THE DRAWINGS. ALL DRAWINGS TO BE READ IN CONJUNCTION WITH CONTRACT SPECIFICATIONS.
 COPYRIGHT RESERVED. THIS DRAWING IS THE EXCLUSIVE PROPERTY OF URBANTYPOLOGY INC. AND SHALL NOT BE REPRODUCED OR USED FOR PURPOSES OTHER THAN INTENDED BY THE OWNER, WITHOUT PERMISSION.
 THIS DRAWING SHALL ONLY BE USED FOR CONSTRUCTION WHEN FIXED WITH A PROFESSIONAL SEAL AND SIGNATURE BY THE LANDSCAPE ARCHITECT. IT IS THE RESPONSIBILITY OF THE CONTRACTOR TO:
 • VERIFY ALL DIMENSIONS AND CONDITIONS ON SITE.
 • REPORT ALL ERRORS AND/OR OMISSIONS TO THE CONTRACT ADMINISTRATOR.
 • COMPLY WITH ALL PERTINENT CODES, BY-LAWS AND LAWS.
 • VERIFY LOCATION OF ALL UNDERGROUND SERVICES AND UTILITIES WITH RESPECTIVE AUTHORITIES PRIOR TO COMMENCEMENT OF WORK.

PROJECT:
**200 BARIBEAU ST.
 PARK RIVER PROPERTIES**
 LOCATION:
 200 BARIBEAU STREET
 OTTAWA, ON

DRAWN: SM START DATE:
 CHECKED: SM 24 JUN, 2024

DRAWING:
LANDSCAPE PLAN

SCALE: 1:200 PAGE SIZE: 24X36
 PROJECT NUMBER: 24.19

NORTH: SHEET NO.:
L1.1

Last Save: 7/26/2024 3:46:52 PM
 File Location: C:\Users\Urban\Documents\Projects\200 Baribeu - Street\DWG\200 Baribeu - Street\24.19 - 200 Baribeu - Street\24.19 - 200 Baribeu - Street.dwg
 Project: 200 Baribeu - Street\DWG\200 Baribeu - Street\24.19 - 200 Baribeu - Street.dwg
 User: Urban

XXX-XX-XX-XXXX

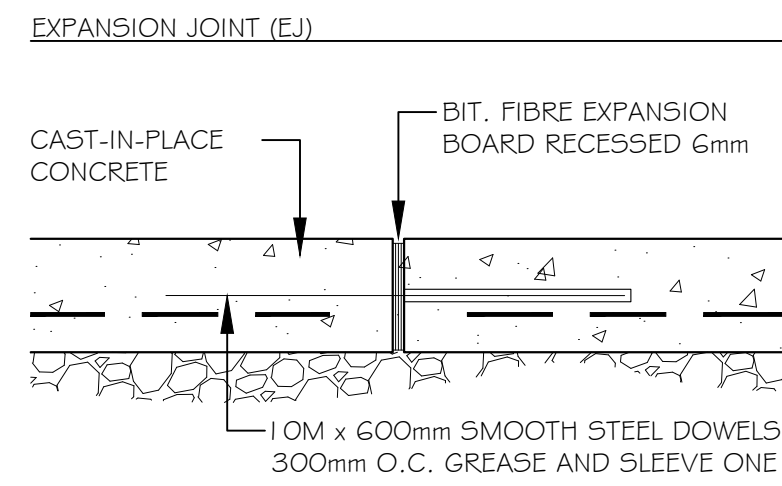
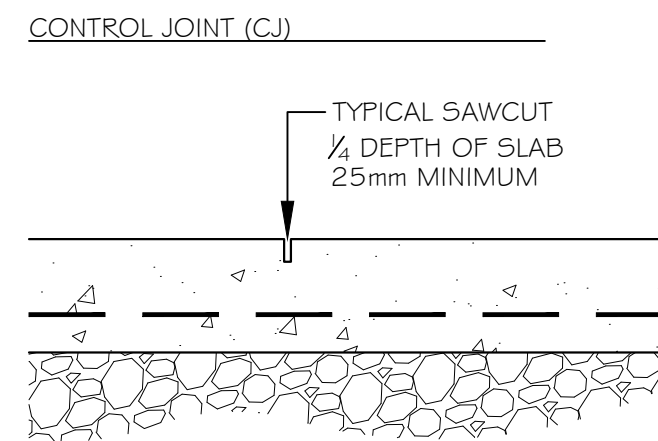

- NOTES:
1. REFER TO DRAWINGS FOR JOINT LAYOUT
 2. SAWCUT WITHIN 48 HOURS OF POUR
 3. NO TOOLED EDGES
 4. FINISH - LIGHT BROOM

- NOTES:
1. REFER TO DRAWINGS FOR JOINT LAYOUT
 2. ALL STEEL DOWELS TO BE EPOXY-COATED
 3. NO TOOLED EDGES
 4. LIGHT BROOM FINISH

CONCRETE PAVING JOINTS

Scale: 1:10

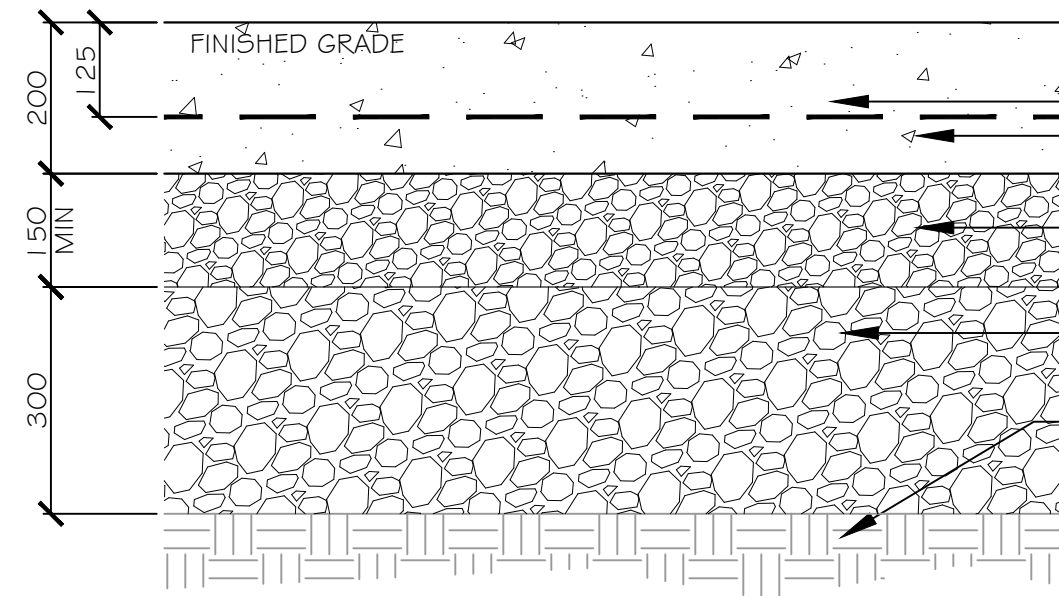

- CAST-IN-PLACE CONCRETE
150x150 WELDED WIRE MESH
- OPSS GRANULAR A CRUSHED STONE
COMPACTED TO 100% SPMD
- OPSS GRANULAR B CRUSHED STONE
COMPACTED TO 100% SPMD
- UNDISTURBED SUBGRADE OR COMPACTED
FILL AS APPROVED BY THE GEOTECHNICAL
ENGINEER

- NOTE:
CONCRETE FINISH: MAGNESIUM TROWEL
'CIRCULAR/SWIRL FINISH'
- EXCAVATION AND SUBGRADE
CONDITION TO BE REVIEWED BY
GEOTECHNICAL ENGINEER

CONCRETE PAVING - HEAVY DUTY

Scale: 1:10

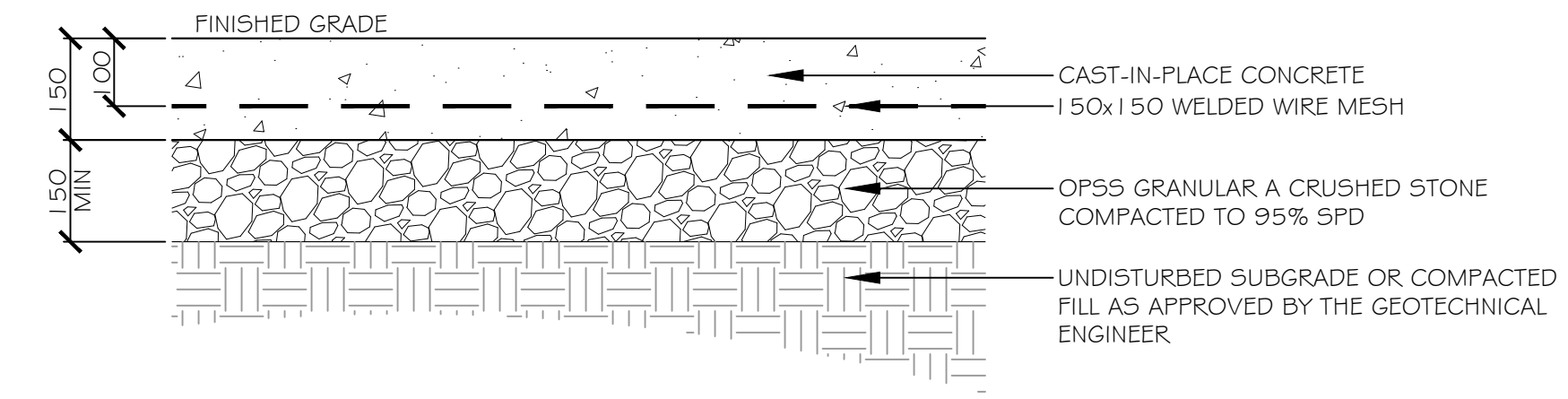

CONCRETE PAVING - LIGHT DUTY

Scale: 1:10

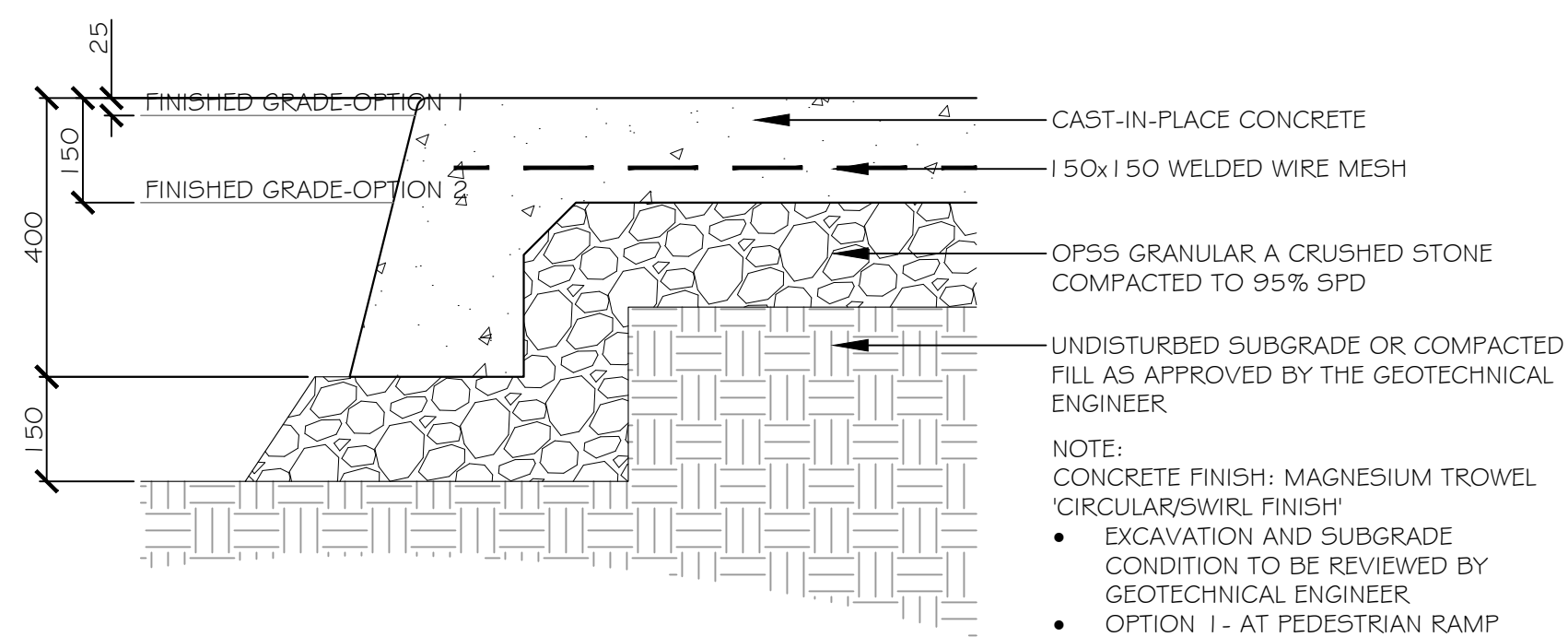

- NOTE:
CONCRETE FINISH: MAGNESIUM TROWEL
'CIRCULAR/SWIRL FINISH'
- EXCAVATION AND SUBGRADE
CONDITION TO BE REVIEWED BY
GEOTECHNICAL ENGINEER
 - OPTION 1 - AT PEDESTRIAN RAMP
 - OPTION 2 - AT SIDEWALK
 - SLOPE AS REQUIRED, MAXIMUM 8%

MONOLITHIC CURB AND SIDEWALK

Scale: 1:10

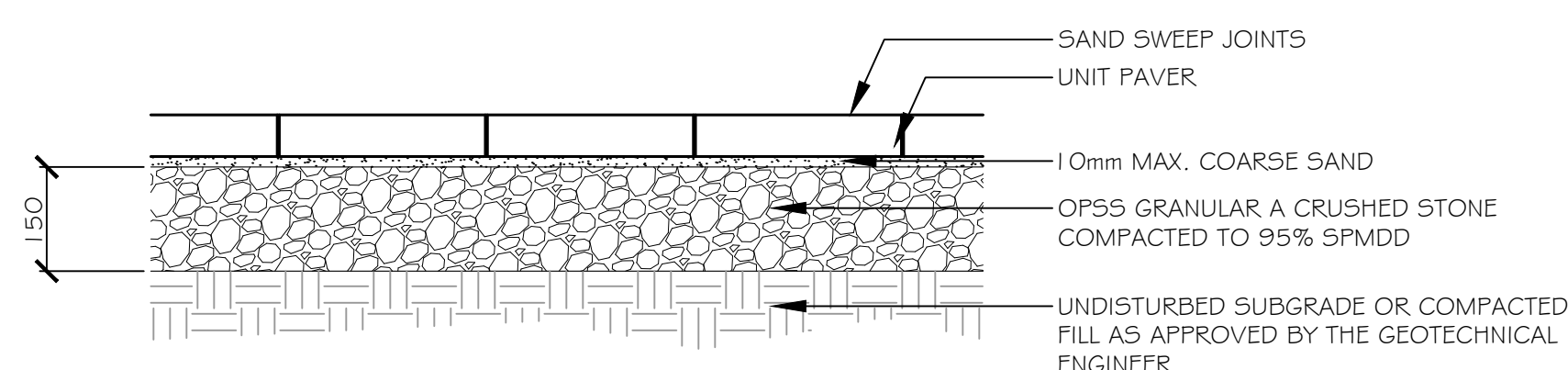

UNIT PAVING

Scale: 1:10

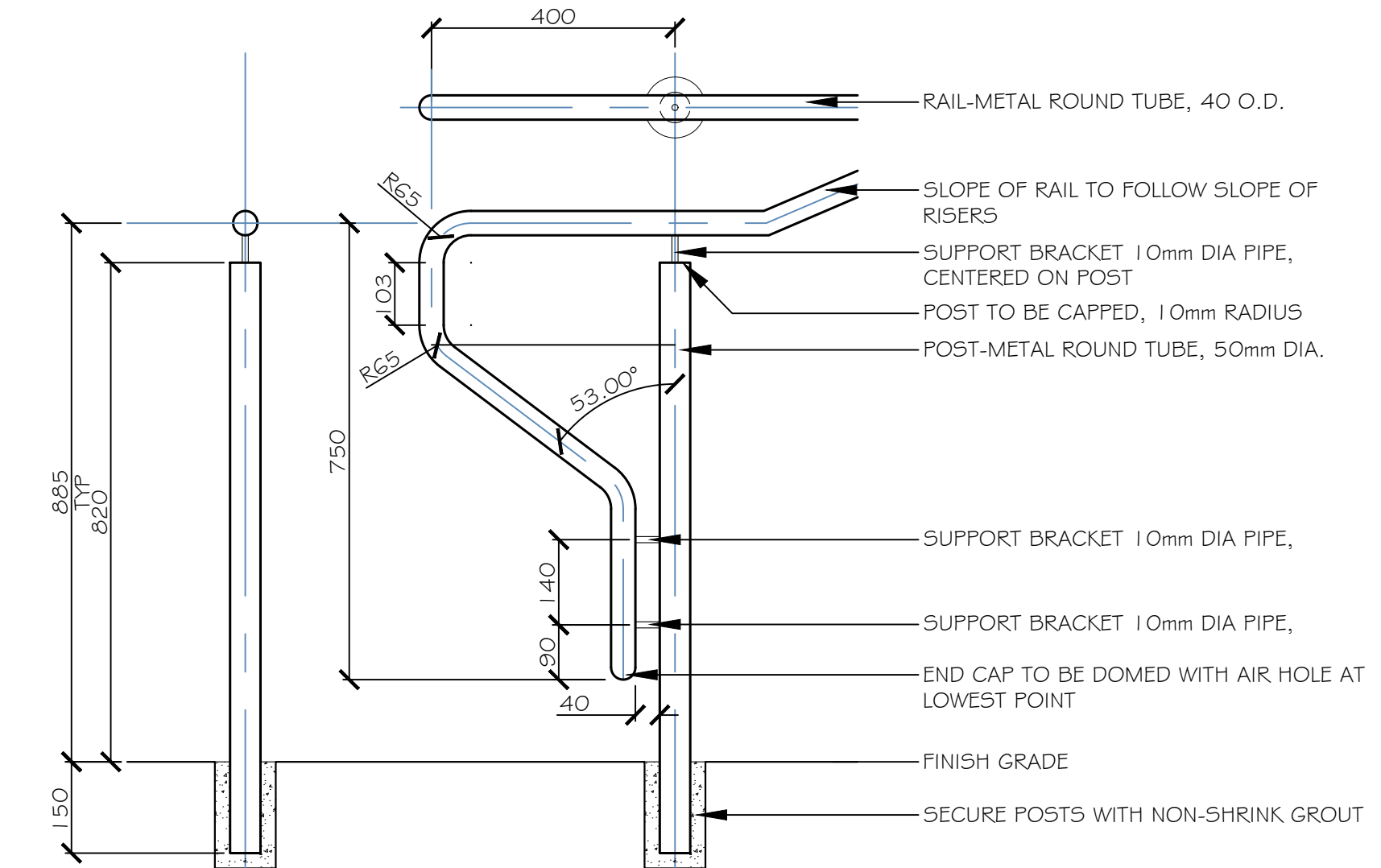

- NOTES:
1. HANDRAIL TO BE MARINE GRADE, SAE 316, STAINLESS STEEL
 2. ALL WELDS TO BE FULL LENGTH AND BOTH SIDES OF ALL METAL SURFACES
 3. GRIND SMOOTH ALL JOINTS AND EDGES
 4. CONTRACTOR TO SUBMIT SHOP DRAWINGS FOR REVIEW PRIOR TO FABRICATION

HANDRAIL

Scale: 1:10

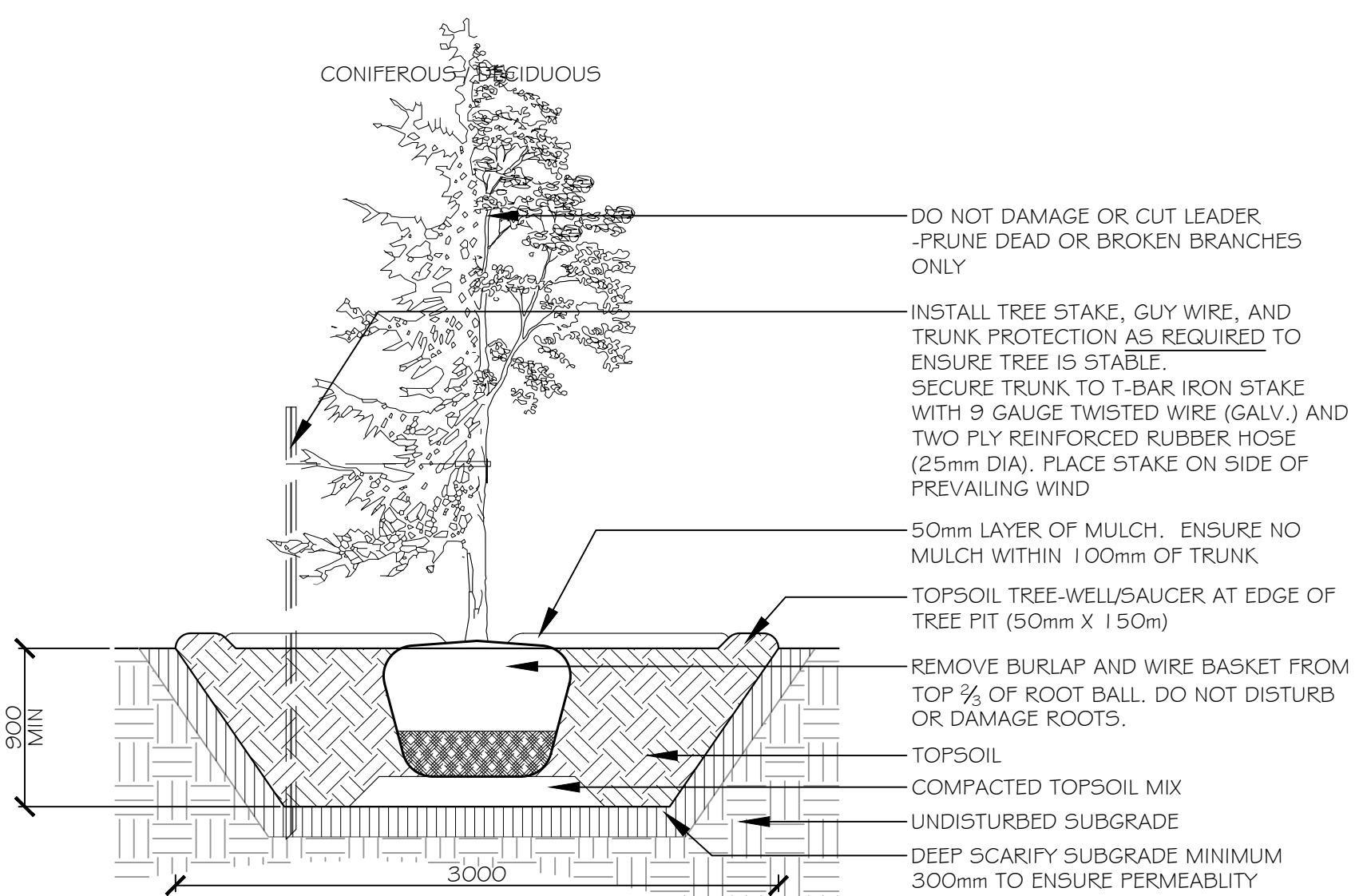

- NOTES:
- TREE STAKES ARE GENERALLY TO BE USED FOR CONDITIONS WHERE THE INSTALLED TREE IS UNSTABLE AND/OR BECOMES UNSTABLE
 - ALLOW 10mm TO 25mm SLACK ON GUY WIRE SUPPORT FOR TREE
 - TOP OF ROOT BALL TO RETAIN SAME ELEVATION AS GROWING CONDITIONS
 - REMOVE STAKES ONE YEAR AFTER INSTALL
 - INSTALL STAKE BEYOND EDGE OF ROOT BALL

TREE PLANTING

Scale: 1:30

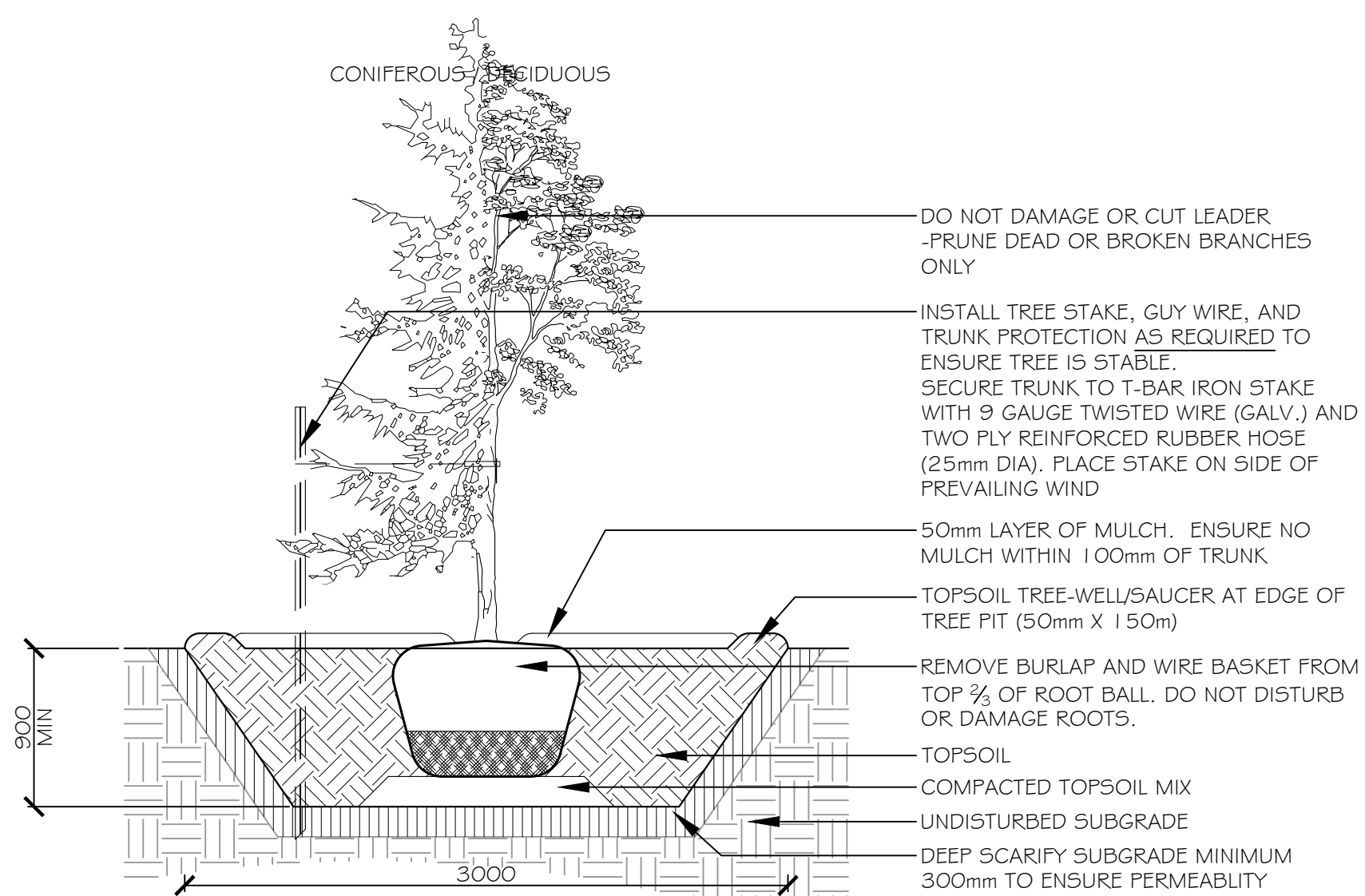

- NOTES:
- TREE STAKES ARE GENERALLY TO BE USED FOR CONDITIONS WHERE THE INSTALLED TREE IS UNSTABLE AND/OR BECOMES UNSTABLE
 - ALLOW 10mm TO 25mm SLACK ON GUY WIRE SUPPORT FOR TREE
 - TOP OF ROOT BALL TO RETAIN SAME ELEVATION AS GROWING CONDITIONS
 - REMOVE STAKES ONE YEAR AFTER INSTALL
 - INSTALL STAKE BEYOND EDGE OF ROOT BALL

SHRUB PLANTING

Scale: 1:30

KEY PLAN:

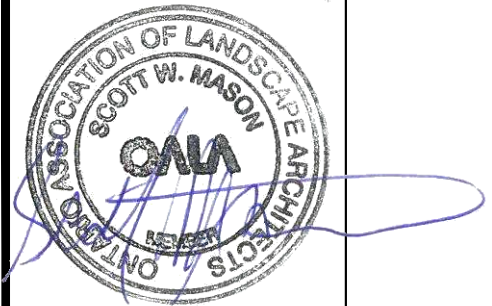

Urbantypology

UNIT 10 163 STERLING ROAD
TORONTO ON CANADA, M8R 2B2
PH: 437-700-5446

499 PRESTON STREET
OTTAWA ON CANADA, K1S 4N7
PH: 613 267 3042 / 613 897 1237

02	ISSUED FOR SITE PLAN CONTROL	03 JUL 2024
01	ISSUED FOR SITE PLAN CONTROL	02 JUL 2024

NO.: REVISION: DATE:

ALL MEASUREMENTS ARE IN MILLIMETERS UNLESS SPECIFIED OTHERWISE. DO NOT SCALE THE DRAWINGS. ALL DRAWINGS TO BE READ IN CONJUNCTION WITH CONTRACT SPECIFICATIONS.

THIS DRAWING IS THE EXCLUSIVE PROPERTY OF URBANTYPOLOGY INC. AND SHALL NOT BE REPRODUCED OR USED FOR PURPOSES OTHER THAN INTENDED BY THE OWNER, WITHOUT PERMISSION.

THIS DRAWING SHALL ONLY BE USED FOR CONSTRUCTION WHEN FIXED WITH A PROFESSIONAL SEAL AND SIGNATURE BY THE LANDSCAPE ARCHITECT. IT IS THE RESPONSIBILITY OF THE CONTRACTOR TO:

- REPORT ALL DIMENSIONS AND CONDITIONS ON SITE.
- REPORT ALL ERRORS AND/OR OMISSIONS TO THE CONTRACT ADMINISTRATOR.
- COMPLY WITH ALL PERTINENT CODES, BY-LAWS AND LAWS.
- VERIFY LOCATION OF ALL UNDERGROUND SERVICES AND UTILITIES WITH RESPECTIVE AUTHORITIES PRIOR TO COMMENCEMENT OF WORK.

PROJECT:
**200 BARIBEAU ST.
PARK RIVER PROPERTIES**

LOCATION:
**200 BARIBEAU STREET
OTTAWA, ON**

DRAWN: **SM** START DATE:
CHECKED: **SM** **24 JUN, 2024**

DRAWING:
LANDSCAPE DETAILS

SCALE: **1:200** PAGE SIZE: **24X36**

PROJECT NUMBER: **24.19**

NORTH: SHEET NO.:

L2.1