

STORM OUTLET VIA 127 CARILLON

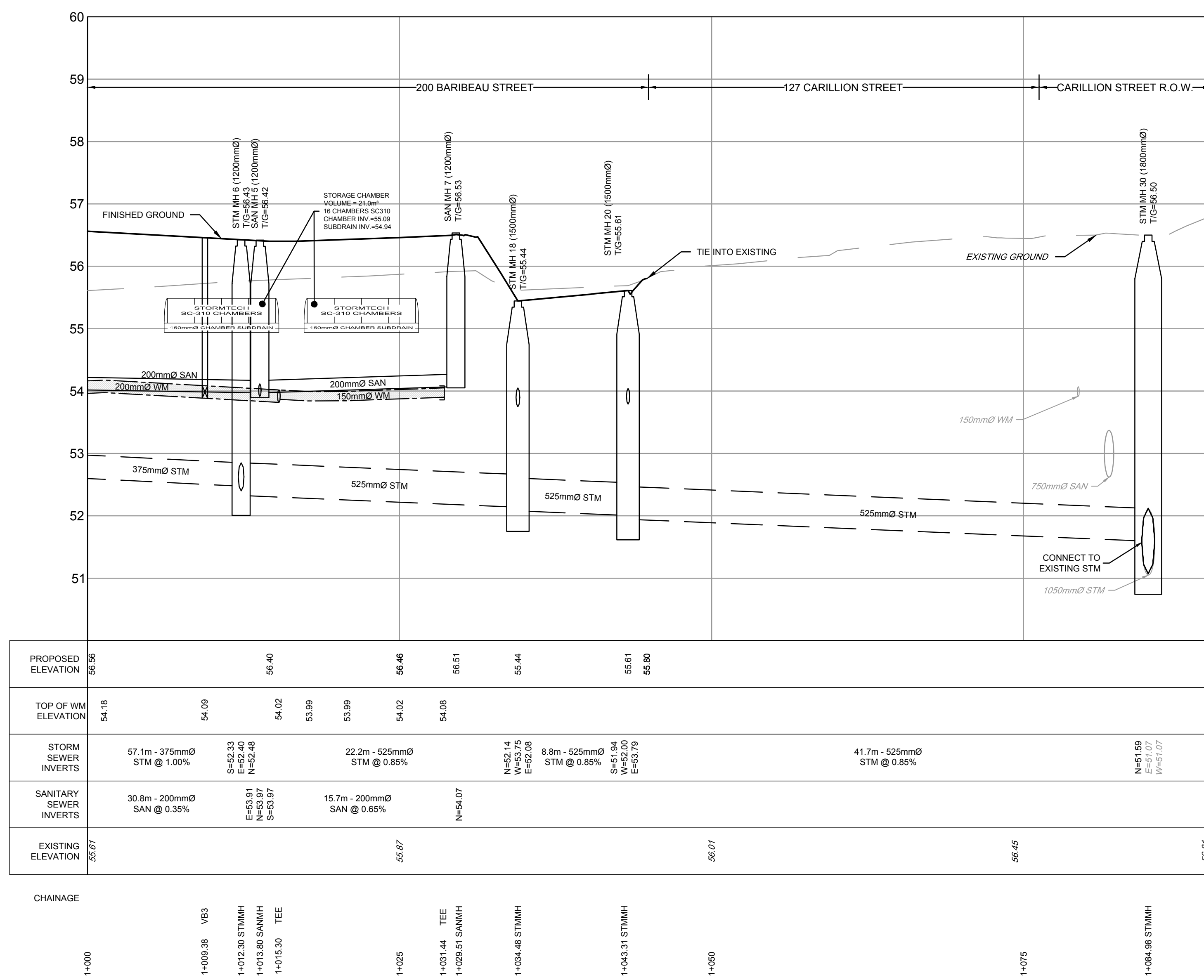

C:\Users\11068628\OneDrive\11068628\PR1 (2).Jun.09.2021.11:52am.dwg

NOTE:  
 THE POSITION OF ALL POLE LINES, CONDUITS,  
 WATERMANS, SEWERS AND OTHER  
 UNDERGROUND AND OVERGROUND UTILITIES AND  
 STRUCTURES IS NOT NECESSARILY SHOWN ON  
 THE CONTRACT DRAWINGS, AND WHERE SHOWN,  
 THE ACCURACY OF THE POSITION OF SUCH  
 UTILITIES AND STRUCTURES IS NOT GUARANTEED.  
 BEFORE STARTING WORK, DETERMINE THE EXACT  
 LOCATION OF ALL SUCH UTILITIES AND  
 STRUCTURES AND ASSUME ALL LIABILITY FOR  
 DAMAGE TO THEM.



NO.	REVISION	DATE	BY
3	CITY SUBMISSION	JUN 8 21	MAB
2	CITY SUBMISSION	FEB 5 21	MAB
1	STORM OUTLET VIA 127 CARILLON	OCT 29 20	MAB

SCALE	DATE	BY
1:250 HORIZONTAL		
1:50 VERTICAL		

DESIGN	DATE	BY
DTD		
LRW		
DTD		
LRW		
MAB		

**FOR REVIEW ONLY**

REGISTERED PROFESSIONAL ENGINEER  
 L.R. WILSON  
 10160055  
 PROVINCE OF ONTARIO

REGISTERED PROFESSIONAL ENGINEER  
 M.A. BISSETT  
 2021.06.09  
 PROVINCE OF ONTARIO

**NOVATECH**  
 Engineers, Planners & Landscape Architects  
 Suite 200, 240 Michael Cowpland Drive  
 Ottawa, Ontario, Canada K2M 1P6  
 Telephone: (613) 254-9643  
 Facsimile: (613) 254-5867  
 Website: www.novatech-eng.com

CITY OF OTTAWA  
 200 BARIBEAU STREET

PLAN AND PROFILE  
 STM OUTLET VIA 127 CARILLON  
 1+000 to 1+090

PROJECT NO.	REV	REV #3
119068		

DRAWING NO: 119068-PR1