

COORDINATES TO URBAN ACCURACY PER SEC. 107 OF OREG. 21410 MIM ZONE 9, NAD83 (ORIGINAL)	EASTING	NORTHING
5017248.98	347823.16	5017248.98
5017248.98	348252.74	5017248.98

OBSERVED REFERENCE POINTS DERIVED FROM GPS OBSERVATIONS USING THE CANADIAN NATIONAL NETWORK.
COORDINATES TO URBAN ACCURACY PER SEC. 107 OF OREG. 21410
MIM ZONE 9, NAD83 (ORIGINAL)
COORDINATES CANNOT, IN THEMSELVES, BE USED TO RE-ESTABLISH CORNERS OR BOUNDARIES SHOWN ON THIS PLAN.

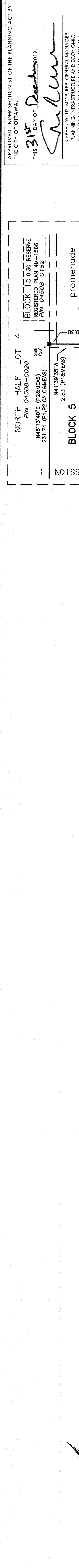

PLAN 4M-1649
I HEREBY CERTIFY THAT THIS PLAN 4M-1649 IS REGISTERED IN THE LAND REGISTRY OFFICE FOR THE LAND TITLES DIVISION OF OTTAWA-CARLETON (NO.4) AT 12:00 O'CLOCK ON THE 31ST DAY OF December, 2019 AND ENTERED IN THE REGISTER FOR P.L.N. 04508-0132 AND THE REQUIRED CONSENTS ARE REGISTERED AS PLAN DOCUMENT NUMBER 06218095.

APPROVED UNDER SECTION 51 OF THE PLANNING ACT BY THE CITY OF OTTAWA.
THIS 31ST DAY OF December 2019.
STEPHEN WILKS, M.C.P., P.P., GENERAL MANAGER
PLANNING, INFRASTRUCTURE AND ECONOMIC DEVELOPMENT DEPARTMENT, CITY OF OTTAWA

THIS PLAN COMPRESSES ALL OF PIN 04508-0132. BLOCKS 1, 3, 4 AND 7 ARE SUBJECT TO EASEMENT PER INST. OCT188377. BLOCKS 2, 5, 6 AND 7 INCLUDE AND UPPER CANADA STREET ARE SUBJECT TO EASEMENT PER INST. OCT176587.

PLAN OF SUBDIVISION OF PART OF LOT 4 CONCESSION 1 (SECTION 14, TOWNSHIP OF HUNTERLEY) CITY OF OTTAWA

METRIC CONVERSION
DISTANCES AND COORDINATES SHOWN ON THIS PLAN ARE IN METRES AND CAN BE CONVERTED TO FEET BY DIVIDING BY 0.3048

GRID SCALE CONVERSION
DISTANCES SHOWN ON THIS PLAN ARE IN METRES AND CAN BE CONVERTED TO GRID BY MULTIPLYING BY THE COMBINED SCALE FACTOR OF 0.99994

BEARING NOTE
BEARINGS ARE OBTAINED FROM CANMET VRS NETWORK GPS OBSERVATIONS ON A HORIZONTAL CONTROL MONUMENTS 1972033 AND 1980119 AND ARE REFERRED TO THE CANADIAN MEASUREMENT SYSTEM (NAD83). THE POINTS ARE LOCATED AT THE FOLLOWING COORDINATES (Easting, Northing) (NAD83):
1972033: N500069.42 E388688.04
1980119: N525594.46 E388688.04

- LEGEND**
- FOUND MONUMENTS
 - IRREGULAR MONUMENTS
 - IRON BAR
 - WOODEN MONUMENT
 - STANDARD IRON BAR
 - SICKE STANDARD IRON BAR
 - CONCRETE PIN
 - PROPERTY IDENTIFICATION NUMBER
 - MEASUREMENT
 - COGNATE UNKNOWN
 - COGNATE KNOWN
 - PLAN 4M-29646
 - PLAN 4M-29647
 - PLAN 4M-29648
 - PLAN 4M-29649
 - PLAN 4M-29650
 - PLAN 4M-29651
 - PLAN 4M-29652
 - PLAN 4M-29653
 - PLAN 4M-29654
 - PLAN 4M-29655
 - PLAN 4M-29656
 - PLAN 4M-29657
 - PLAN 4M-29658
 - PLAN 4M-29659
 - PLAN 4M-29660
 - PLAN 4M-29661
 - PLAN 4M-29662
 - PLAN 4M-29663
 - PLAN 4M-29664
 - PLAN 4M-29665
 - PLAN 4M-29666
 - PLAN 4M-29667
 - PLAN 4M-29668
 - PLAN 4M-29669
 - PLAN 4M-29670
 - PLAN 4M-29671
 - PLAN 4M-29672
 - PLAN 4M-29673
 - PLAN 4M-29674
 - PLAN 4M-29675
 - PLAN 4M-29676
 - PLAN 4M-29677
 - PLAN 4M-29678
 - PLAN 4M-29679
 - PLAN 4M-29680
 - PLAN 4M-29681
 - PLAN 4M-29682
 - PLAN 4M-29683
 - PLAN 4M-29684
 - PLAN 4M-29685
 - PLAN 4M-29686
 - PLAN 4M-29687
 - PLAN 4M-29688
 - PLAN 4M-29689
 - PLAN 4M-29690
 - PLAN 4M-29691
 - PLAN 4M-29692
 - PLAN 4M-29693
 - PLAN 4M-29694
 - PLAN 4M-29695
 - PLAN 4M-29696
 - PLAN 4M-29697
 - PLAN 4M-29698
 - PLAN 4M-29699
 - PLAN 4M-29700
 - PLAN 4M-29701
 - PLAN 4M-29702
 - PLAN 4M-29703
 - PLAN 4M-29704
 - PLAN 4M-29705
 - PLAN 4M-29706
 - PLAN 4M-29707
 - PLAN 4M-29708
 - PLAN 4M-29709
 - PLAN 4M-29710
 - PLAN 4M-29711
 - PLAN 4M-29712
 - PLAN 4M-29713
 - PLAN 4M-29714
 - PLAN 4M-29715
 - PLAN 4M-29716
 - PLAN 4M-29717
 - PLAN 4M-29718
 - PLAN 4M-29719
 - PLAN 4M-29720
 - PLAN 4M-29721
 - PLAN 4M-29722
 - PLAN 4M-29723
 - PLAN 4M-29724
 - PLAN 4M-29725
 - PLAN 4M-29726
 - PLAN 4M-29727
 - PLAN 4M-29728
 - PLAN 4M-29729
 - PLAN 4M-29730
 - PLAN 4M-29731
 - PLAN 4M-29732
 - PLAN 4M-29733
 - PLAN 4M-29734
 - PLAN 4M-29735
 - PLAN 4M-29736
 - PLAN 4M-29737
 - PLAN 4M-29738
 - PLAN 4M-29739
 - PLAN 4M-29740
 - PLAN 4M-29741
 - PLAN 4M-29742
 - PLAN 4M-29743
 - PLAN 4M-29744
 - PLAN 4M-29745
 - PLAN 4M-29746
 - PLAN 4M-29747
 - PLAN 4M-29748
 - PLAN 4M-29749
 - PLAN 4M-29750
 - PLAN 4M-29751
 - PLAN 4M-29752
 - PLAN 4M-29753
 - PLAN 4M-29754
 - PLAN 4M-29755
 - PLAN 4M-29756
 - PLAN 4M-29757
 - PLAN 4M-29758
 - PLAN 4M-29759
 - PLAN 4M-29760
 - PLAN 4M-29761
 - PLAN 4M-29762
 - PLAN 4M-29763
 - PLAN 4M-29764
 - PLAN 4M-29765
 - PLAN 4M-29766
 - PLAN 4M-29767
 - PLAN 4M-29768
 - PLAN 4M-29769
 - PLAN 4M-29770
 - PLAN 4M-29771
 - PLAN 4M-29772
 - PLAN 4M-29773
 - PLAN 4M-29774
 - PLAN 4M-29775
 - PLAN 4M-29776
 - PLAN 4M-29777
 - PLAN 4M-29778
 - PLAN 4M-29779
 - PLAN 4M-29780
 - PLAN 4M-29781
 - PLAN 4M-29782
 - PLAN 4M-29783
 - PLAN 4M-29784
 - PLAN 4M-29785
 - PLAN 4M-29786
 - PLAN 4M-29787
 - PLAN 4M-29788
 - PLAN 4M-29789
 - PLAN 4M-29790
 - PLAN 4M-29791
 - PLAN 4M-29792
 - PLAN 4M-29793
 - PLAN 4M-29794
 - PLAN 4M-29795
 - PLAN 4M-29796
 - PLAN 4M-29797
 - PLAN 4M-29798
 - PLAN 4M-29799
 - PLAN 4M-29800
 - PLAN 4M-29801
 - PLAN 4M-29802
 - PLAN 4M-29803
 - PLAN 4M-29804
 - PLAN 4M-29805
 - PLAN 4M-29806
 - PLAN 4M-29807
 - PLAN 4M-29808
 - PLAN 4M-29809
 - PLAN 4M-29810
 - PLAN 4M-29811
 - PLAN 4M-29812
 - PLAN 4M-29813
 - PLAN 4M-29814
 - PLAN 4M-29815
 - PLAN 4M-29816
 - PLAN 4M-29817
 - PLAN 4M-29818
 - PLAN 4M-29819
 - PLAN 4M-29820
 - PLAN 4M-29821
 - PLAN 4M-29822
 - PLAN 4M-29823
 - PLAN 4M-29824
 - PLAN 4M-29825
 - PLAN 4M-29826
 - PLAN 4M-29827
 - PLAN 4M-29828
 - PLAN 4M-29829
 - PLAN 4M-29830
 - PLAN 4M-29831
 - PLAN 4M-29832
 - PLAN 4M-29833
 - PLAN 4M-29834
 - PLAN 4M-29835
 - PLAN 4M-29836
 - PLAN 4M-29837
 - PLAN 4M-29838
 - PLAN 4M-29839
 - PLAN 4M-29840
 - PLAN 4M-29841
 - PLAN 4M-29842
 - PLAN 4M-29843
 - PLAN 4M-29844
 - PLAN 4M-29845
 - PLAN 4M-29846
 - PLAN 4M-29847
 - PLAN 4M-29848
 - PLAN 4M-29849
 - PLAN 4M-29850
 - PLAN 4M-29851
 - PLAN 4M-29852
 - PLAN 4M-29853
 - PLAN 4M-29854
 - PLAN 4M-29855
 - PLAN 4M-29856
 - PLAN 4M-29857
 - PLAN 4M-29858
 - PLAN 4M-29859
 - PLAN 4M-29860
 - PLAN 4M-29861
 - PLAN 4M-29862
 - PLAN 4M-29863
 - PLAN 4M-29864
 - PLAN 4M-29865
 - PLAN 4M-29866
 - PLAN 4M-29867
 - PLAN 4M-29868
 - PLAN 4M-29869
 - PLAN 4M-29870
 - PLAN 4M-29871
 - PLAN 4M-29872
 - PLAN 4M-29873
 - PLAN 4M-29874
 - PLAN 4M-29875
 - PLAN 4M-29876
 - PLAN 4M-29877
 - PLAN 4M-29878
 - PLAN 4M-29879
 - PLAN 4M-29880
 - PLAN 4M-29881
 - PLAN 4M-29882
 - PLAN 4M-29883
 - PLAN 4M-29884
 - PLAN 4M-29885
 - PLAN 4M-29886
 - PLAN 4M-29887
 - PLAN 4M-29888
 - PLAN 4M-29889
 - PLAN 4M-29890
 - PLAN 4M-29891
 - PLAN 4M-29892
 - PLAN 4M-29893
 - PLAN 4M-29894
 - PLAN 4M-29895
 - PLAN 4M-29896
 - PLAN 4M-29897
 - PLAN 4M-29898
 - PLAN 4M-29899
 - PLAN 4M-29900
 - PLAN 4M-29901
 - PLAN 4M-29902
 - PLAN 4M-29903
 - PLAN 4M-29904
 - PLAN 4M-29905
 - PLAN 4M-29906
 - PLAN 4M-29907
 - PLAN 4M-29908
 - PLAN 4M-29909
 - PLAN 4M-29910
 - PLAN 4M-29911
 - PLAN 4M-29912
 - PLAN 4M-29913
 - PLAN 4M-29914
 - PLAN 4M-29915
 - PLAN 4M-29916
 - PLAN 4M-29917
 - PLAN 4M-29918
 - PLAN 4M-29919
 - PLAN 4M-29920
 - PLAN 4M-29921
 - PLAN 4M-29922
 - PLAN 4M-29923
 - PLAN 4M-29924
 - PLAN 4M-29925
 - PLAN 4M-29926
 - PLAN 4M-29927
 - PLAN 4M-29928
 - PLAN 4M-29929
 - PLAN 4M-29930
 - PLAN 4M-29931
 - PLAN 4M-29932
 - PLAN 4M-29933
 - PLAN 4M-29934
 - PLAN 4M-29935
 - PLAN 4M-29936
 - PLAN 4M-29937
 - PLAN 4M-29938
 - PLAN 4M-29939
 - PLAN 4M-29940
 - PLAN 4M-29941
 - PLAN 4M-29942
 - PLAN 4M-29943
 - PLAN 4M-29944
 - PLAN 4M-29945
 - PLAN 4M-29946
 - PLAN 4M-29947
 - PLAN 4M-29948
 - PLAN 4M-29949
 - PLAN 4M-29950
 - PLAN 4M-29951
 - PLAN 4M-29952
 - PLAN 4M-29953
 - PLAN 4M-29954
 - PLAN 4M-29955
 - PLAN 4M-29956
 - PLAN 4M-29957
 - PLAN 4M-29958
 - PLAN 4M-29959
 - PLAN 4M-29960
 - PLAN 4M-29961
 - PLAN 4M-29962
 - PLAN 4M-29963
 - PLAN 4M-29964
 - PLAN 4M-29965
 - PLAN 4M-29966
 - PLAN 4M-29967
 - PLAN 4M-29968
 - PLAN 4M-29969
 - PLAN 4M-29970
 - PLAN 4M-29971
 - PLAN 4M-29972
 - PLAN 4M-29973
 - PLAN 4M-29974
 - PLAN 4M-29975
 - PLAN 4M-29976
 - PLAN 4M-29977
 - PLAN 4M-29978
 - PLAN 4M-29979
 - PLAN 4M-29980
 - PLAN 4M-29981
 - PLAN 4M-29982
 - PLAN 4M-29983
 - PLAN 4M-29984
 - PLAN 4M-29985
 - PLAN 4M-29986
 - PLAN 4M-29987
 - PLAN 4M-29988
 - PLAN 4M-29989
 - PLAN 4M-29990
 - PLAN 4M-29991
 - PLAN 4M-29992
 - PLAN 4M-29993
 - PLAN 4M-29994
 - PLAN 4M-29995
 - PLAN 4M-29996
 - PLAN 4M-29997
 - PLAN 4M-29998
 - PLAN 4M-29999
 - PLAN 4M-30000

OWNERS CERTIFICATE
THIS SURVEY AND PLAN ARE CORRECT AND IN ACCORDANCE WITH THE SURVEY ACT.
BLOCKS 1 TO 7, BOTH INCLUSIVE AND THE STREET RUE UPPER CANADA STREET, HAVE BEEN LAID OUT IN ACCORDANCE WITH OUR INSTRUCTIONS.
THE STREET IS HEREBY DEDICATED TO CITY OF OTTAWA AS PUBLIC HIGHWAY.

WEST OTTAWA LAND INCORPORATED (2) INC.
I HAVE THE AUTHORITY TO BIND THE CORPORATION
KYLE MACGRIFFIN, VICE PRESIDENT
WEST OTTAWA LAND INCORPORATED (2) INC.
I HAVE THE AUTHORITY TO BIND THE CORPORATION

Dec 19, 2019
DATE

Dec 19, 2019
DATE

Dec 19, 2019
DATE

Dec 19, 2019
DATE

Dec 19, 2019
DATE

Dec 19, 2019
DATE

Dec 19, 2019
DATE

Dec 19, 2019
DATE

Dec 19, 2019
DATE

Dec 19, 2019
DATE

Dec 19, 2019
DATE

Dec 19, 2019
DATE

Dec 19, 2019
DATE

Dec 19, 2019
DATE

Dec 19, 2019
DATE

Dec 19, 2019
DATE

Dec 19, 2019
DATE

Dec 19, 2019
DATE

Dec 19, 2019
DATE

Dec 19, 2019
DATE

Dec 19, 2019
DATE

Dec 19, 2019
DATE

Dec 19, 2019
DATE

Dec 19, 2019
DATE

Dec 19, 2019
DATE

Dec 19, 2019
DATE

Dec 19, 2019
DATE

Dec 19, 2019
DATE

Dec 19, 2019
DATE

Dec 19, 2019
DATE

Dec 19, 2019
DATE

Dec 19, 2019
DATE

Dec 19, 2019
DATE

Stantec
CANADA LAND SURVEYORS
1251 OYSTER AVENUE SUITE 400
OTTAWA, ONTARIO K1P 5E4
TEL: 613 724 4200
BOMES.COM

Stantec Geomatics Ltd.
CANADA LAND SURVEYORS
1251 OYSTER AVENUE SUITE 400
OTTAWA, ONTARIO K1P 5E4
TEL: 613 724 4200
BOMES.COM

PROJECT NO.: 1616245-002
DRAWING NO.: CHECKED BY: PAL - BW
DATE: Dec 19, 2019