

REFER TO SWM POND BLOCK DESIGN BY CAIVAN COMMUNITIES (D07-16-19-0005)

REFER TO GRADING PLAN (GP-1)

REFER TO EXPANSION ROAD DESIGN BY CAIVAN COMMUNITIES (D07-16-19-0005)

REFER TO HAIKU STREET DESIGN BY CAIVAN COMMUNITIES (D07-16-19-0005)

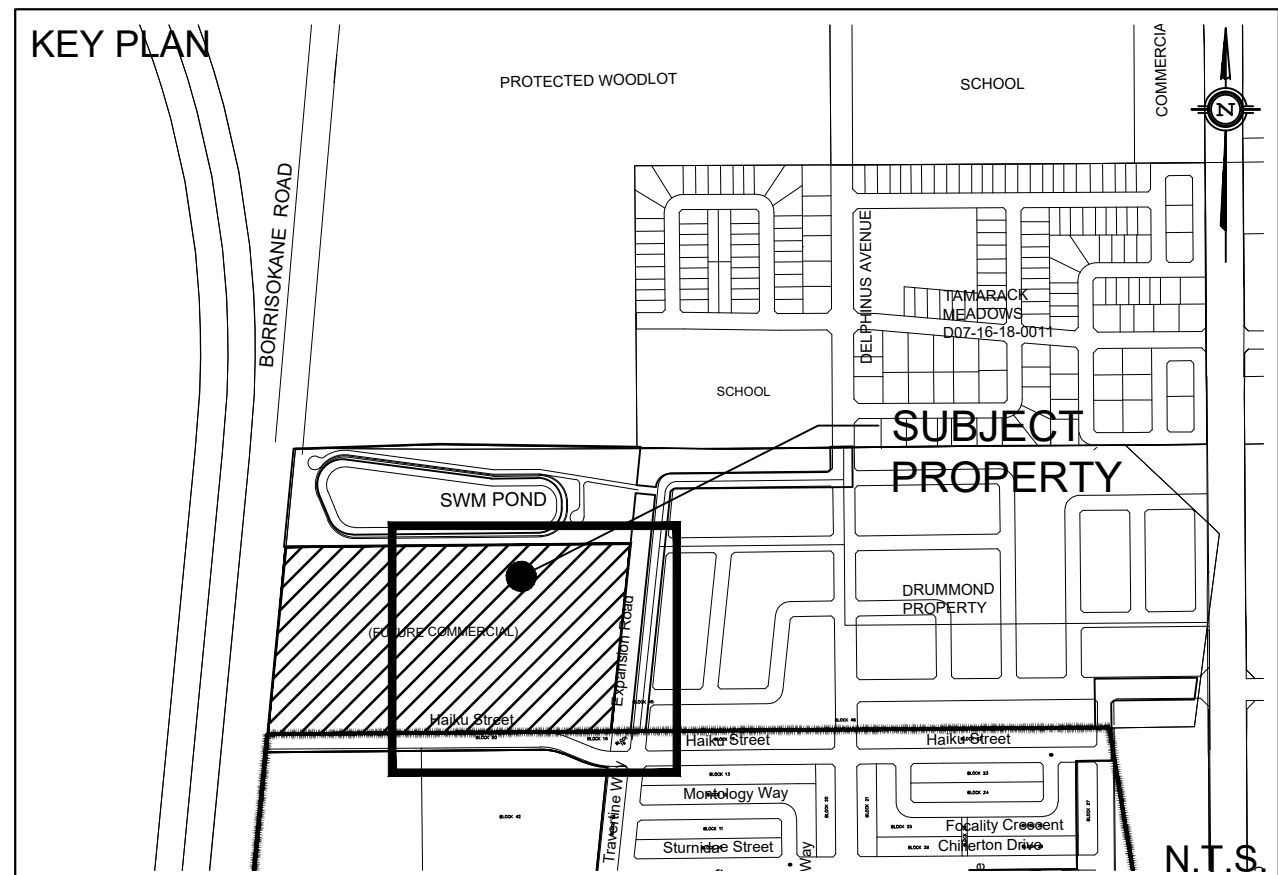

LEGEND

---	PROPERTY LINE	[Pattern]	PROPOSED HEAVY DUTY ASPHALT
---	PROPOSED SWALE	○	PROPOSED STORM MANHOLE
---	PROPOSED PERFORATED SUBDRAIN	●	PROPOSED SANITARY MANHOLE
---	EXISTING SPOT ELEVATION	□	PROPOSED CATCH BASIN
---	PROPOSED SPOT ELEVATION	○	PROPOSED CB 'T' OR CB 'L'
---	PROPOSED TOP OF CURB ELEVATION	○	PROPOSED FIRE HYDRANT
---	PROPOSED BOTTOM OF WALL ELEVATION	→	EMERGENCY FLOW ROUTE
---	PROPOSED TOP OF WALL ELEVATION	[Pattern]	CONCRETE PAD
---	PROPOSED TOP OF LID ELEVATION	---	5-YR WATER LEVEL
---	EXISTING GRADE AND DIRECTION		
---	PROPOSED GRADE AND DIRECTION		
---	PROPOSED 3:1 TERRACING		
---	PROPOSED/EXISTING SPOT ELEVATION		

NOT FOR CONSTRUCTION

TOPOGRAPHIC INFORMATION
 TOPOGRAPHIC INFORMATION PROVIDED BY J.D. BARNES LIMITED
 PROJ. NO. 18-10-145-00
 DATED JULY 10, 2019

SITE PLAN INFORMATION
 SITE PLAN PROVIDED BY FIGURR COLLECTIF D'ARCHITECTES
 PROJ. NO. 19-1134
 DATED AUGUST 28, 2020

GEO TECHNICAL STUDY
 GEO TECHNICAL RECOMMENDATIONS PROVIDED BY PATERSON GROUP
 PROJ. NO. PG5155-1
 DATED FEBRUARY 10, 2020

SITE SERVICING AND STORMWATER MANAGEMENT STUDY
 SERVICING AND STORMWATER MANAGEMENT RECOMMENDATIONS PROVIDED BY DSEL
 DATED SEPTEMBER 2020

BENCH MARK
 LOCATION: CONCRETE ROAD BRIDGE OVER JOCK RIVER (N45°15'39", W75°44'06")
 ELEVATIONS SHOWN ON THIS PLAN ARE RELATED TO GEODETIC DATUM AND ARE DERIVED FROM THE MUNICIPALITY BENCHMARK NO. 001196403710 HAVING A PUBLISHED ELEVATION OF 91.724 METERS

No.	BY	YYMM.DD	DESCRIPTION
9	A.J.G.	20.09.24	ISSUED FOR MUNICIPAL REVIEW
8	A.J.G.	20.09.21	ISSUED FOR MUNICIPAL REVIEW
7	A.J.G.	20.07.17	ISSUED FOR MUNICIPAL REVIEW
6	A.J.G.	20.07.09	ISSUED FOR MUNICIPAL REVIEW
5	A.J.G.	20.06.24	ISSUED FOR MUNICIPAL REVIEW
4	A.J.G.	20.06.12	ISSUED FOR MUNICIPAL REVIEW
3	A.J.G.	20.05.28	ISSUED FOR MUNICIPAL REVIEW
2	A.J.G.	20.04.24	ISSUED FOR MUNICIPAL REVIEW
1	A.J.T.	20.01.15	ISSUED FOR MUNICIPAL REVIEW

PROJECT No. 19-1134

GRADING PLAN
3713 BORRISOKANE ROAD

CAIVAN GREENBANK NORTH INC. 2934 Baseline Road, Suite 302
 Ottawa, Ontario, K2H 1B2
 Tel. (613) 518-1864

DSEL
 david schaeffer engineering ltd
 SMART SUBDIVISIONS™

120 Ibr Road Unit 103
 Stittsville, Ontario, K2S 1E9
 Tel. (613) 836-0856
 Fax. (613) 836-7183
 www.DSEL.ca

DRAWN BY: A.J.G.	CHECKED BY: R.D.F.	DRAWING NO. GP-2	SHEET NO. 3 of 7
DESIGNED BY: B.N.C.	CHECKED BY: S.J.P.		
SCALE: 1:500	DATE: DECEMBER 2019		