



REFER TO SWM POND BLOCK DESIGN BY CAIVAN COMMUNITIES (D07-16-19-0005)

REFER TO GRADING PLAN (GP-1)

REFER TO EXPANSION ROAD DESIGN BY CAIVAN COMMUNITIES (D07-16-19-0005)

BLDG B
FFE = 103.00

REFER TO HAIKU STREET DESIGN BY CAIVAN COMMUNITIES (D07-16-19-0005)

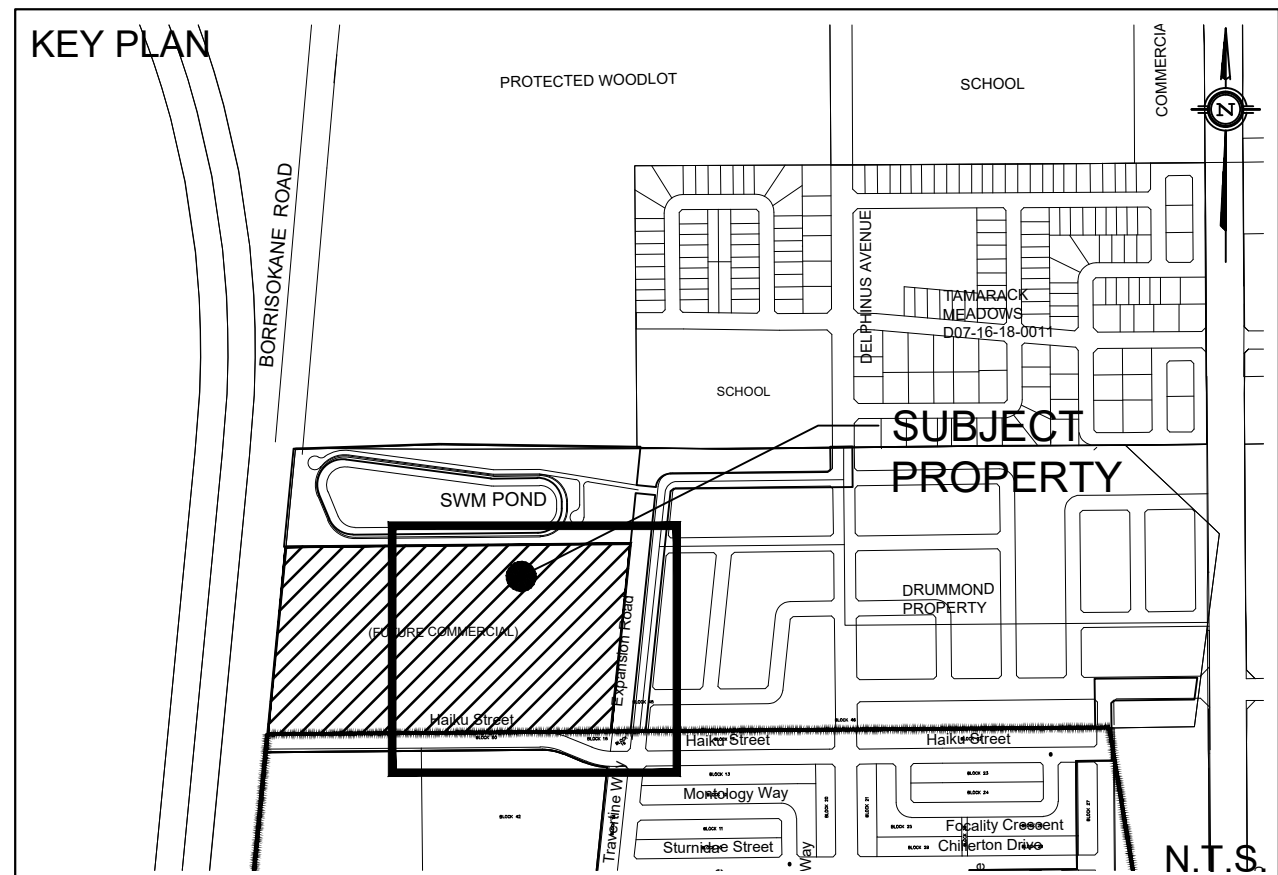

LEGEND

---	PROPERTY LINE	[Pattern]	PROPOSED HEAVY DUTY ASPHALT
---	PROPOSED SWALE	[Pattern]	PROPOSED GRAVEL STORAGE YARD
---	PROPOSED PERFORATED SUBDRAIN	○	PROPOSED STORM MANHOLE
x 100.00	EXISTING SPOT ELEVATION	●	PROPOSED SANITARY MANHOLE
x 100.00	PROPOSED SPOT ELEVATION	□	PROPOSED CATCH BASIN
x 100.00T/C	PROPOSED TOP OF CURB ELEVATION	○	PROPOSED CB 'T' OR CB 'L'
x 100.00B/W	PROPOSED BOTTOM OF WALL ELEVATION	○	PROPOSED FIRE HYDRANT
x 100.00T/W	PROPOSED TOP OF WALL ELEVATION	→	EMERGENCY FLOW ROUTE
x 100.00L	PROPOSED TOP OF LID ELEVATION	■	CONCRETE PAD
1.0%	EXISTING GRADE AND DIRECTION	---	5-YR WATER LEVEL
3:1 SLOPE	PROPOSED GRADE AND DIRECTION		
100/100	PROPOSED 3:1 TERRACING		
100/100	PROPOSED/EXISTING SPOT ELEVATION		

NOT FOR CONSTRUCTION

TOPOGRAPHIC INFORMATION
TOPOGRAPHIC INFORMATION PROVIDED BY J.D. BARNES LIMITED
PROJ. NO. 18-10-145-00
DATED JULY 10, 2019

SITE PLAN INFORMATION
SITE PLAN PROVIDED BY FIGURR COLLECTIF D'ARCHITECTES
PROJ. NO. 19-1134
DATED DECEMBER 2020

GEO TECHNICAL STUDY
GEO TECHNICAL RECOMMENDATIONS PROVIDED BY PATERSON GROUP
PROJ. NO. PG5155-1
DATED FEBRUARY 10, 2020

SITE SERVICING AND STORMWATER MANAGEMENT STUDY
SERVICING AND STORMWATER MANAGEMENT RECOMMENDATIONS PROVIDED BY DSEL
PROJ. NO. 19-1134
DATED DECEMBER 2020

BENCH MARK
LOCATION: CONCRETE ROAD BRIDGE OVER JOCK RIVER (N45°15'39" W75°44'06")
ELEVATIONS SHOWN ON THIS PLAN ARE RELATED TO GEODETIC DATUM AND ARE DERIVED FROM THE MUNICIPALITY BENCHMARK NO. 00119640371D HAVING A PUBLISHED ELEVATION OF 91.724 METERS

No.	BY	DATE	DESCRIPTION
15	A.D.F.	21.01.05	REVISED PER CITY COMMENTS
14	A.J.G.	20.12.17	ISSUED FOR MUNICIPAL REVIEW
13	A.J.G.	20.12.16	ISSUED FOR CONTRACTOR COORDINATION
12	A.J.G.	20.11.19	ISSUED FOR CONTRACTOR COORDINATION
11	A.J.G.	20.11.10	ISSUED FOR CONTRACTOR COORDINATION
10	A.J.G.	20.10.07	ISSUED FOR TENDER
9	A.J.G.	20.09.24	ISSUED FOR MUNICIPAL REVIEW
8	A.J.G.	20.09.21	ISSUED FOR MUNICIPAL REVIEW
7	A.J.G.	20.07.17	ISSUED FOR MUNICIPAL REVIEW
6	A.J.G.	20.07.09	ISSUED FOR MUNICIPAL REVIEW
5	A.J.G.	20.06.24	ISSUED FOR MUNICIPAL REVIEW

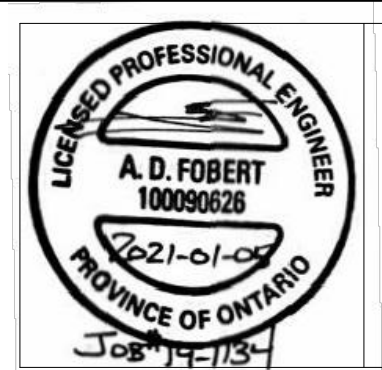

PROJECT No. 19-1134

GRADING PLAN
3713 BORRISOKANE ROAD

CAIVAN GREENBANK NORTH INC. 2934 Baseline Road, Suite 302
Ottawa, Ontario, K2H 1B2
Tel. (613) 518-1864

DSEL
david schaeffer engineering ltd
SMART SUBDIVISIONS™

120 Iber Road Unit 103
Stittsville, Ontario, K2S 1E9
Tel. (613) 836-0856
Fax. (613) 836-7183
www.DSEL.ca

DRAWN BY: A.J.G.	CHECKED BY: A.D.F.	DRAWING NO. GP-2	SHEET NO. 3 of 7
DESIGNED BY: B.N.C.	CHECKED BY: S.J.P.		
SCALE: 1:500	DATE: JANUARY 2021		

CITY PLAN No.: #18112
CITY FILE No.: D07-12-20-0002