

NOTES:
 CIVIL COMPONENTS SHOWN ARE FOR REFERENCE ONLY, REFER TO CIVIL DRAWINGS.
 REFER TO CIVIL DRAWINGS FOR DETAILS FOR RAINWATER GARDEN AND BIOSWALE SECTIONS.

NOTES:
 THIS PLAN IS ISSUED FOR SITE PLAN CONTROL SUBMISSION ONLY.
 ADDITIONAL DETAILING AND SPECIFICATIONS ARE REQUIRED PRIOR TO TENDERING OR CONSTRUCTION.
 DRAWING TO BE READ IN CONJUNCTION WITH TREE CONSERVATION REPORT, 2020 10 09. REFER TO TREE CONSERVATION REPORT FOR TREE PROTECTION MEASURES AND DETAILS.

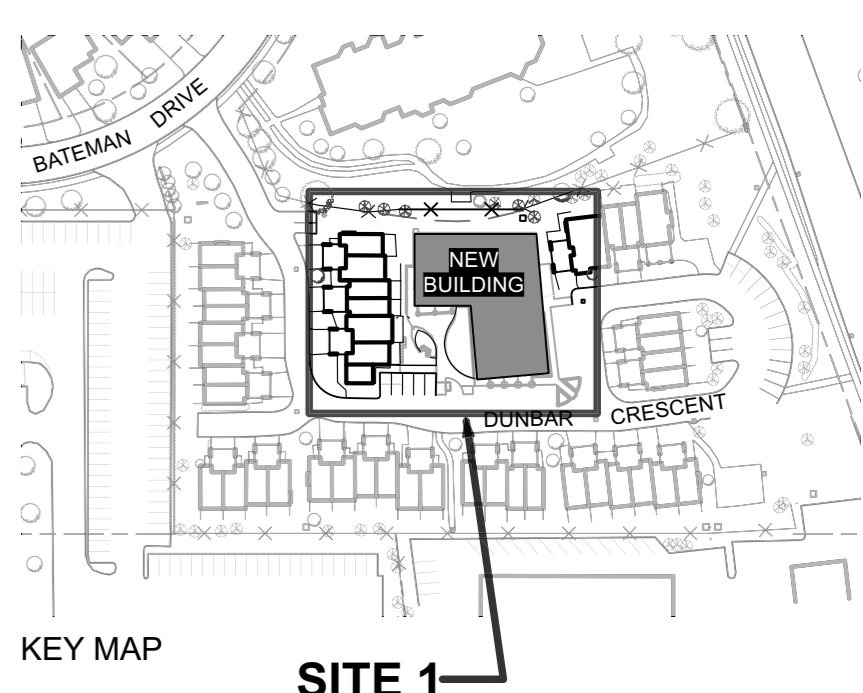

- LEGEND**
- PROPERTY LINE
 - LOW LINE OF SWALE
 - TOP OF SWALE SLOPE
 - APPROXIMATE EXTENT OF RAIN PONDING
 - PRECAST CONCRETE PAVERS
 - RUBBER TILE PLAY SURFACE
 - RAISED CURB
 - LOW RETAINING WALL
 - PEASTONE MAINTENANCE EDGE
 - CONCRETE PAVING
 - CONCRETE PAD (MAILBOXES)
 - SEATING
 - GALVANIZED IRON PLANTER
 - PLANTING BEDS
 - LOW-MAINTENANCE SEED MIX IN DISTURBED AREAS
 - PROPOSED TREES
 - PROPOSED SPECIMEN SHRUBS
 - PROPOSED SHRUBS
 - PROPOSED ORNAMENTAL GRASS
 - PROPOSED SHADE PERENNIALS
 - PROPOSED SUN PERENNIALS
 - EXISTING TREES

rev #	issue	date
02	SITE PLAN CONTROL RESUBMISSION	2021 03 15
01	ISSUED FOR SITE PLAN CONTROL	2020 10 21

jane thompson architect
 404 mackay street
 ottawa, ontario, K1M 2C4
 tel: (613)747-8104
 jtarch@rogers.com

stamp

date 2021-04-20

Ruhland & Associates Ltd
 landscape architecture • urban design • site planning
 Ph 613-224-7441 Fx 613-224-1531 info@rala.ca www.rala.ca

project **DUNBAR COURT APARTMENTS NEPEAN HOUSING**
 Ottawa, Ontario

drawing **BUILDING AREA LAYOUT**

designed	AA / MR	checked	MR
drawn	TF	job no.	1922
scale		dwg no.	L-01

SITE 1: NEW BUILDING LANDSCAPE LAYOUT
 Scale: 1:100



D07-12-20-0139

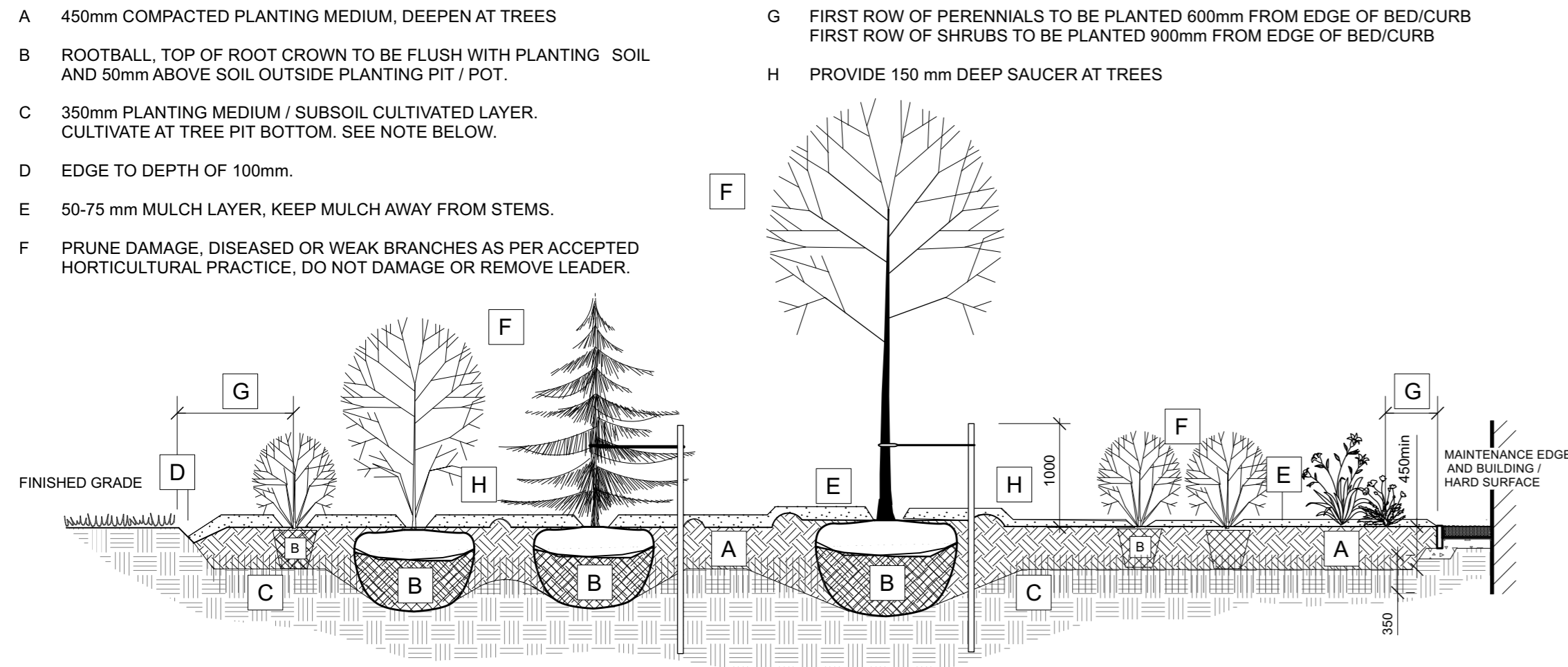

- BED PREPARATION**
- EXCAVATE OR PLACE FILL FOR PLANTING BED TO PROVIDE 450mm MINIMUM DEPTH OF PLANTING MEDIUM. PLANTING BED TO BE DEEPENED AT TREE LOCATIONS. IF BASE OF PIT IS OVER EXCAVATED, RAISE BOTTOM TO PROPER LEVEL WITH COMPACTED PLANTING MEDIUM.
 - PLACE 150mm PLANTING MEDIUM ON SUBGRADE AND CULTIVATE INTO TOP 200mm OF SUBSOIL. SEE NOTE BELOW.
 - PLACE REMAINDER OF PLANTING MEDIUM OVER CULTIVATED PORTION TO ACHIEVE FINAL GRADE.
 - CENTRE OF BED TO BE CROWNED ABOVE ADJACENT GRADE TO APPROVAL OF CONSULTANT.
 - ENSURE POSITIVE DRAINAGE AWAY FROM BUILDING WALLS WHERE APPLICABLE.
- TREE PLANTING:**
- CUT AND REMOVE TOP 2/3 OF BURLAP AND WIRE BASKET FROM ROOTBALL.
 - PLACE 1-METAL POST (40 x 40 x 2100 mm) AT OUTSIDE OF ROOTBALL ON THE PREVAILING WIND SIDE AND FASTEN TO TRUNK WITH APPROVED TREE TIES.
 - WATER THOROUGHLY SUBSEQUENT TO PLANTING AND THROUGHOUT THE WARRANTY PERIOD.
 - WRAP TREE TRUNK AFTER INSPECTION OF TREES BY LANDSCAPE ARCHITECT.
 - INSTALL RODENT GUARD AND PROTECT TREE FROM RODENT DAMAGE.
 - REMOVE TREE RINGS, STAKES AND TRUNK WRAPPING AFTER WARRANTY PERIOD.

1 TREE, SHRUB AND PERENNIAL BED PLANTING
L-02 NTS

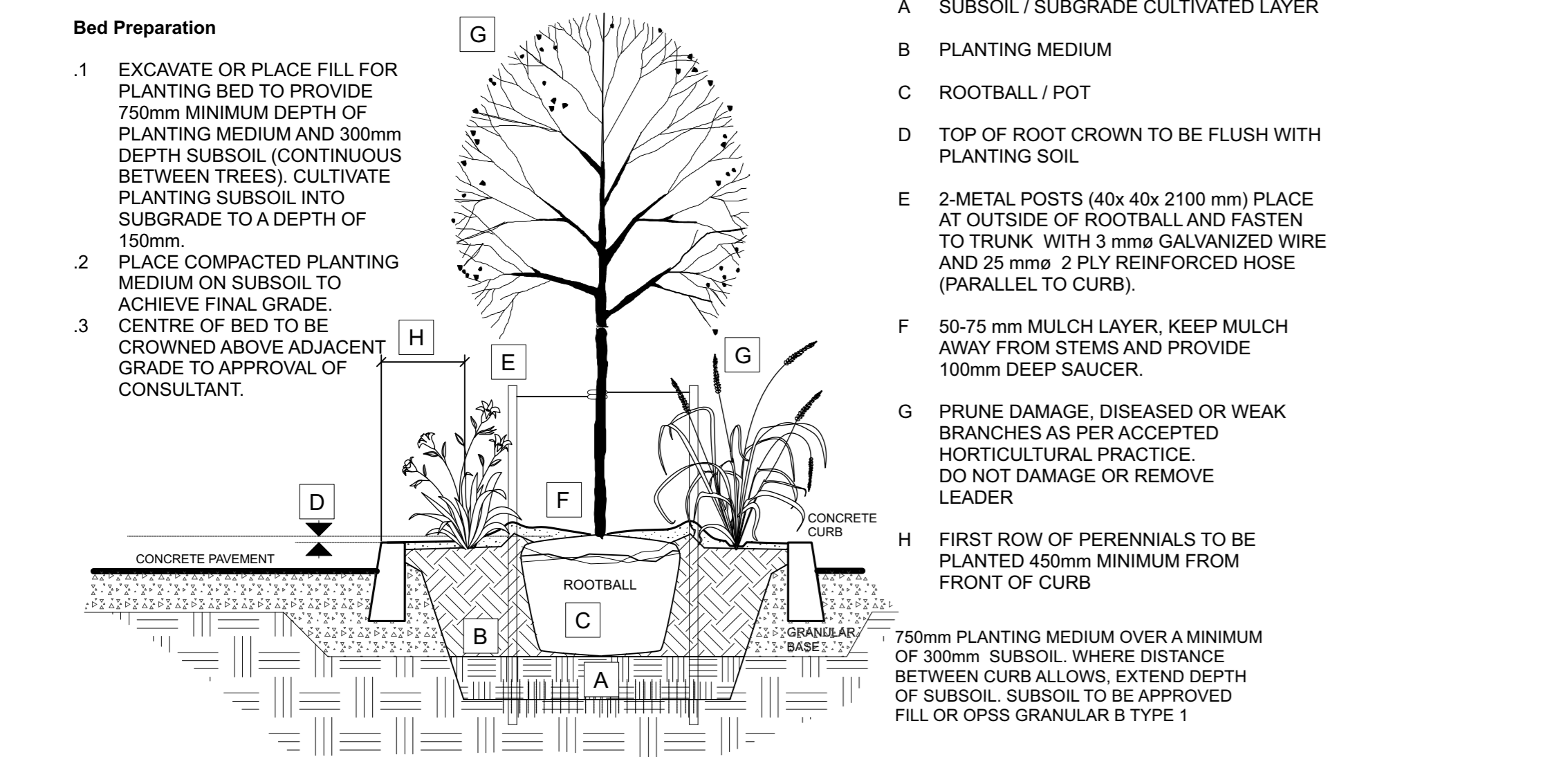

2 TREE AND PERENNIAL PLANTING IN MEDIAN
L-02 NTS

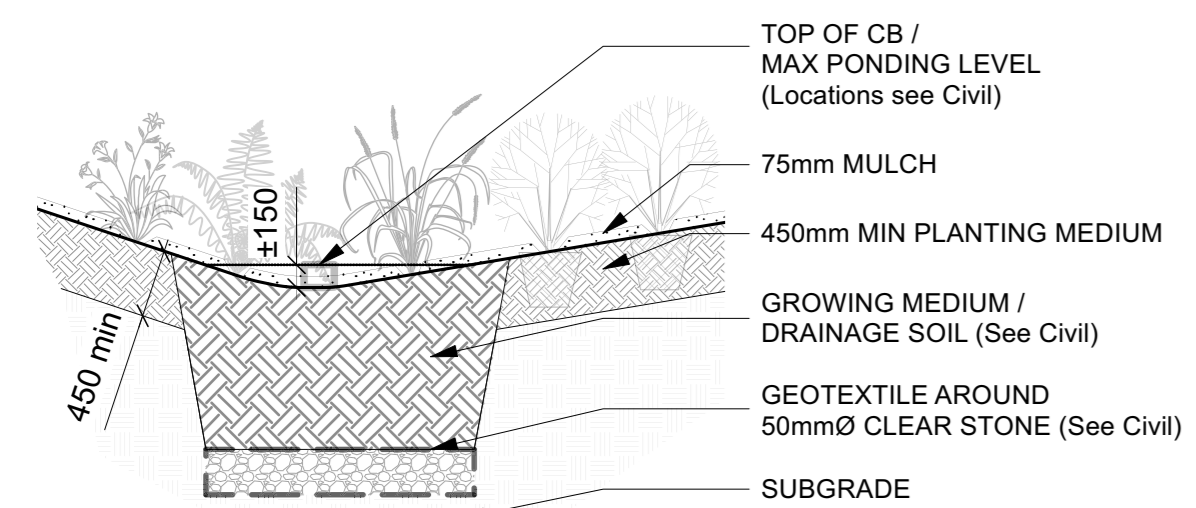

3 RAIN GARDEN / SWALE CONSTRUCTION
L-02 NTS

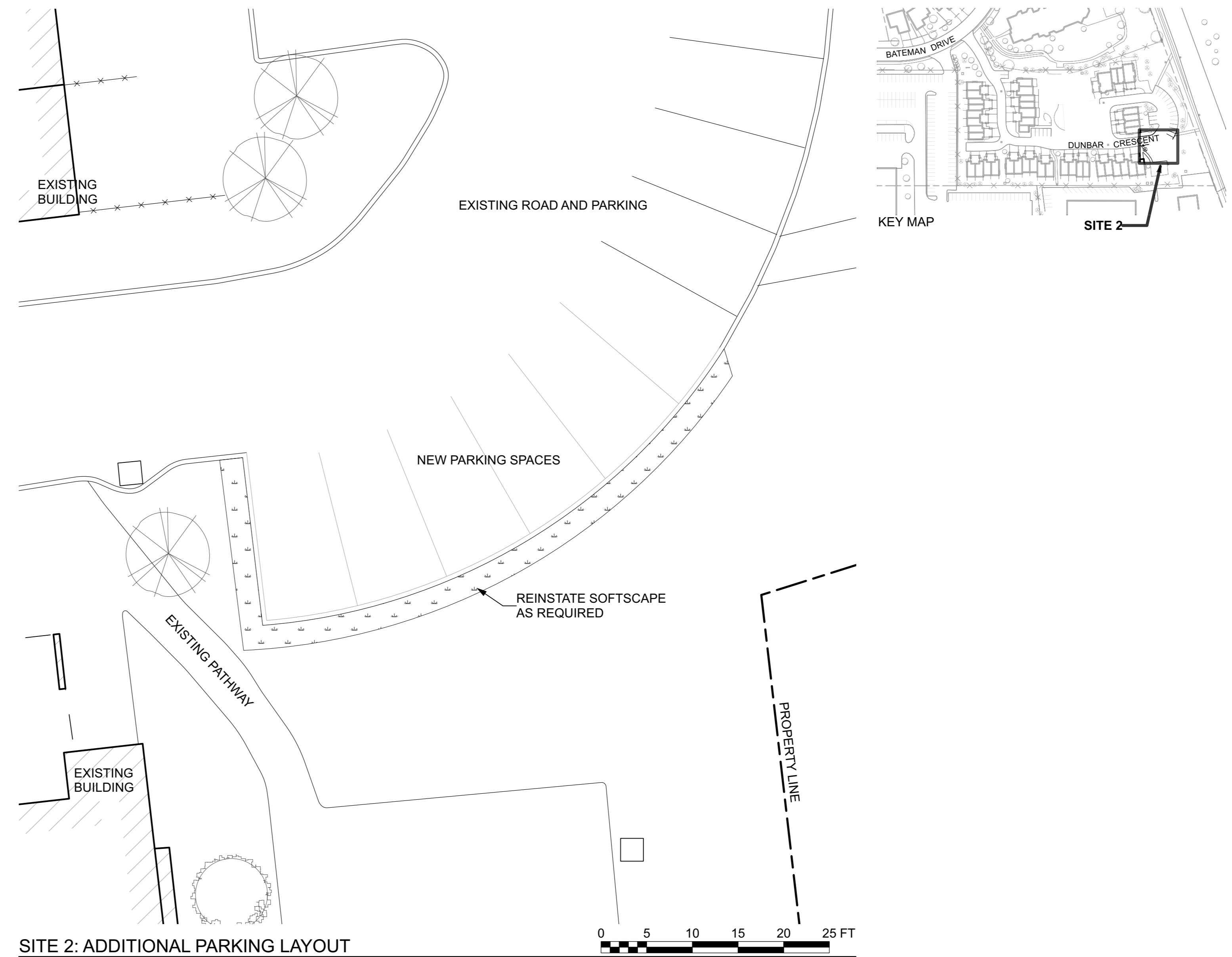

SITE 2: ADDITIONAL PARKING LAYOUT
Scale: 1:100

NOTES:
THIS PLAN IS ISSUED FOR SITE PLAN CONTROL SUBMISSION ONLY. ADDITIONAL DETAILING AND SPECIFICATIONS ARE REQUIRED PRIOR TO TENDERING OR CONSTRUCTION.
DRAWING TO BE READ IN CONJUNCTION WITH TREE CONSERVATION REPORT, 2020 10 09. REFER TO TREE CONSERVATION REPORT FOR TREE PROTECTION MEASURES AND DETAILS.

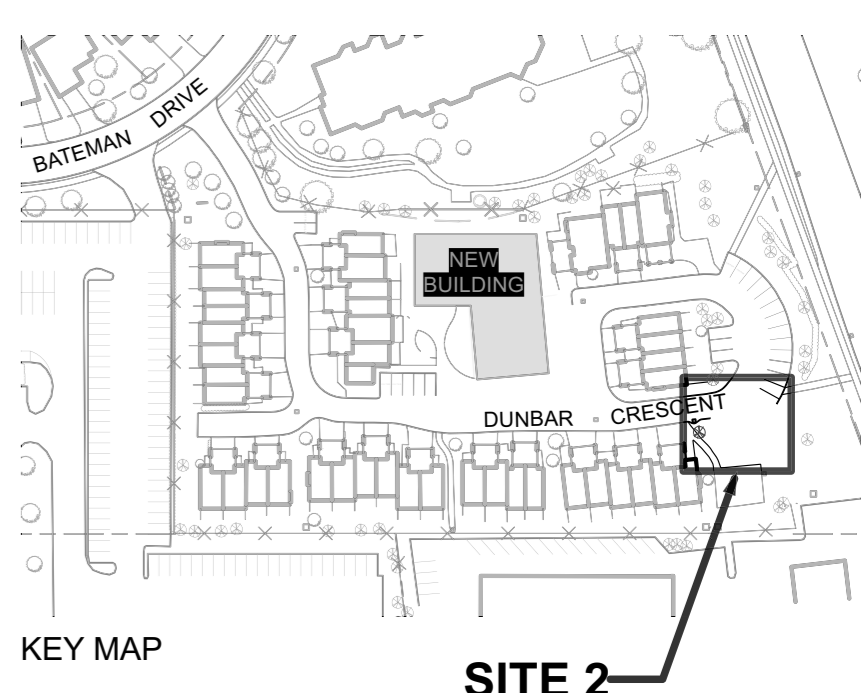

rev #	issue	date
02	SITE PLAN CONTROL RESUBMISSION	2021 03 15
01	ISSUED FOR SITE PLAN CONTROL	2020 10 21

jane thompson architect
404 mackay street
ottawa, ontario, K1M 2C4
tel: (613)747-8104
jtarch@rogers.com



Ruhland & Associates Ltd
landscape architecture • urban design • site planning
Ph 613-224-4744 Fx 613-224-1131 info@rala.ca www.rala.ca

project **DUNBAR COURT APARTMENTS NEPEAN HOUSING**
Ottawa, Ontario

drawing **NEW PARKING LAYOUT, PLANT LISTS & DETAILS**

designed **AA / MR** checked **MR**

drawn **TF** job no. **1922**

scale dwg no. **L-02**

Perennials list						
ID	Arrangement	# plants	Botanical Name	Common Name	Spacing (M.o.C.)	Sched Size
Pv-1: Sun perennials	Mixed	20	Echinacea purpurea	Purple Coneflower	0.5	15cm pots
		20	Leucanthemum superbum	Shasta Daisy	0.5	15cm pots
		20	Hemerocallis (Red/orange var.)	Daylily (Reds, oranges)	0.5	15cm pots
		20	Rudbeckia fulgida 'Goldsturm'	Goldsturm Black Eyed Susan	0.5	15cm pots
		20	Veronica spicata	Spiked Speedwell	0.5	15cm pots
Pv-2: Medium ht shade perennials	Mixed	95	Delosperma nubigenum	Yellow Hardy Ice Plant	0.3	10cm pots
		40	Hemerocallis (Yellow varieties)	Daylily (Yellows)	0.5	15cm pots
		40	Hosta varieties	Medium Height Hostas	0.5	15cm pots
Pv-3: Low shade perennials	Mixed	25	Matteuccia pennsylvanica	Ostrich Fern	0.75	15cm pots
		40	Geranium macrorrhiza	Bigroot Geranium	0.4	10cm pots
		90	Galium odoratum	Sweet woodruff	0.3	10cm pots
Pv-4: Low part-shade stonecrop	Mixed	90	Lamium maculatum	Dead nettle	0.3	10cm pots
		5	Sedum spurium 'John Creech'	John Creech Stonecrop	0.3	10cm pots
Pv-5: Swale perennials	Mixed	5	Sedum ternatum	Three-leafed Stonecrop	0.3	10cm pots
		30	Matteuccia pennsylvanica	Ostrich Fern	0.75	10cm pots
Pv-6: Rain garden perennials	Mixed	50	Onoclea sensibilis	Sensitive Fern	0.5	10cm pots
		4	Carex bebbii	Bebb's Sedge	0.6	10cm pots
		4	Iris versicolor	Blue Flag Iris	0.6	10cm pots
		4	Lobelia cardinalis	Cardinal Flower	0.6	10cm pots
		4	Eutrochium purpureum	Joe Pye weed	0.6	10cm pots
		4	Panicum virgatum	Switch Grass	0.6	10cm pots

Plant List						
ID	Qty	Botanical Name	Common Name	Sched. Size	Remarks	
TREES						
AgF	1	Acer ginnala 'Flame'	Flame Amur Maple	50mm caliper	WB, Staked	
As	1	Acer saccharum	Sugar Maple	60mm caliper	WB, Staked	
Ac	2	Amelanchier canadensis	Serviceberry	50mm caliper	WB, Staked	
CoC	2	Celtis occidentalis 'Chicagoland'	Chicagoland Hackberry	60mm caliper	WB, Staked	
Pp	2	Picea pungens	Colorado Spruce	200cm ht	WB, Staked	
Ps	1	Pinus strobus	Eastern White Pine	200cm ht	WB, Staked	
Qr	2	Quercus rubra	Northern Red Oak	60mm caliper	WB Staked	
Rp	10	Rosa palustris	Swamp Rose	50 cm ht.	Bare root	
UmF	1	Ulmus minor x parvifolia 'Frontier'	Frontier Elm	60mm caliper	WB Staked	
SHRUBS						
Cr	10	Cornus racemosa	Gray Dogwood	50cm ht	1.2m o.c.	
CsK	8	Cornus sericea 'Kelseyi'	Kelsey Dogwood	50cm ht	1.0m o.c.	
DI	31	Diervilla lonicera	Dwarf Bush Honeysuckle	50 cm ht.	Potted, 1m o.c.	
HaA	10	Hydrangea arborescens 'Annabelle'	Annabelle Hydrangea	50cm ht.	Potted, 1m o.c.	
HpFI	2	Hydrangea paniculata 'Fire & Ice'	Fire & Ice pannicle hydrangea	80cm ht.	Potted	
Phv	1	Philadelphus x virginialis	Mock Orange	80cm ht.	Potted	
PoDG	12	Physocarpus opulifolius 'Darts Gold'	Darts Gold Ninebark	50cm ht.	Potted	
PoN	7	Physocarpus opulifolius 'Nanus'	Dwarf Ninebark	50cm ht.	Potted	
RaLG	17	Rhus aromatica 'Gro-Low'	Gro-Low Fragrant Sumac	40 cm ht.	Potted	
RaGM	22	Ribes alpinum 'Green Mound'	Green Mound Alpine Currant	50cm ht	Potted, 1m o.c.	
Sal	16	Spiraea alba	White Meadowsweet	50 cm ht.	Potted 1.2m o.c.	
SbC	7	Spiraea bumalda 'Coccinea'	Dwarf Red Spirea	50cm ht.	Potted, 0.9m o.c.	
SjS	5	Spiraea japonica 'Shirobana'	Shirobana Spirea	50cm ht.	Potted, 0.9m o.c.	
Sp	1	Spiraea prunifolia	Bridal Wreath Spirea	80cm ht.	Potted	
TcC	1	Taxus cuspidata 'Capitata'	Clipped Cone Yew	90cm ht	Potted	
ORNAMENTAL GRASSES						
Ah	16	Anthoxanthum hirtum	Sweetgrass, vanilla sweetgrass	1 gal. pots	Potted, 0.5m o.c.	
CaKF1	13	Calamagrostis x acutiflora 'Karl Foerster'	Karl Foerster Feather Reed Grass	1 gal. pots	Potted, 0.75m o.c.	
Cv	16	Carex vulpinoidea	American Fox Sedge	1 gal. pots	Potted, 0.5m o.c.	
Da	16	Dulichium arundinaceum	Three-way sedge, Dwarf bamboo	1 gal. pots	Potted, 0.5m o.c.	
Pv	19	Panicum virgatum	Switch Grass	1 gal. pots	Potted, 0.6m o.c.	

D07-12-20-0139