

SEPTEMBER/MARCH 21, 2020 - 8:00 a.m.

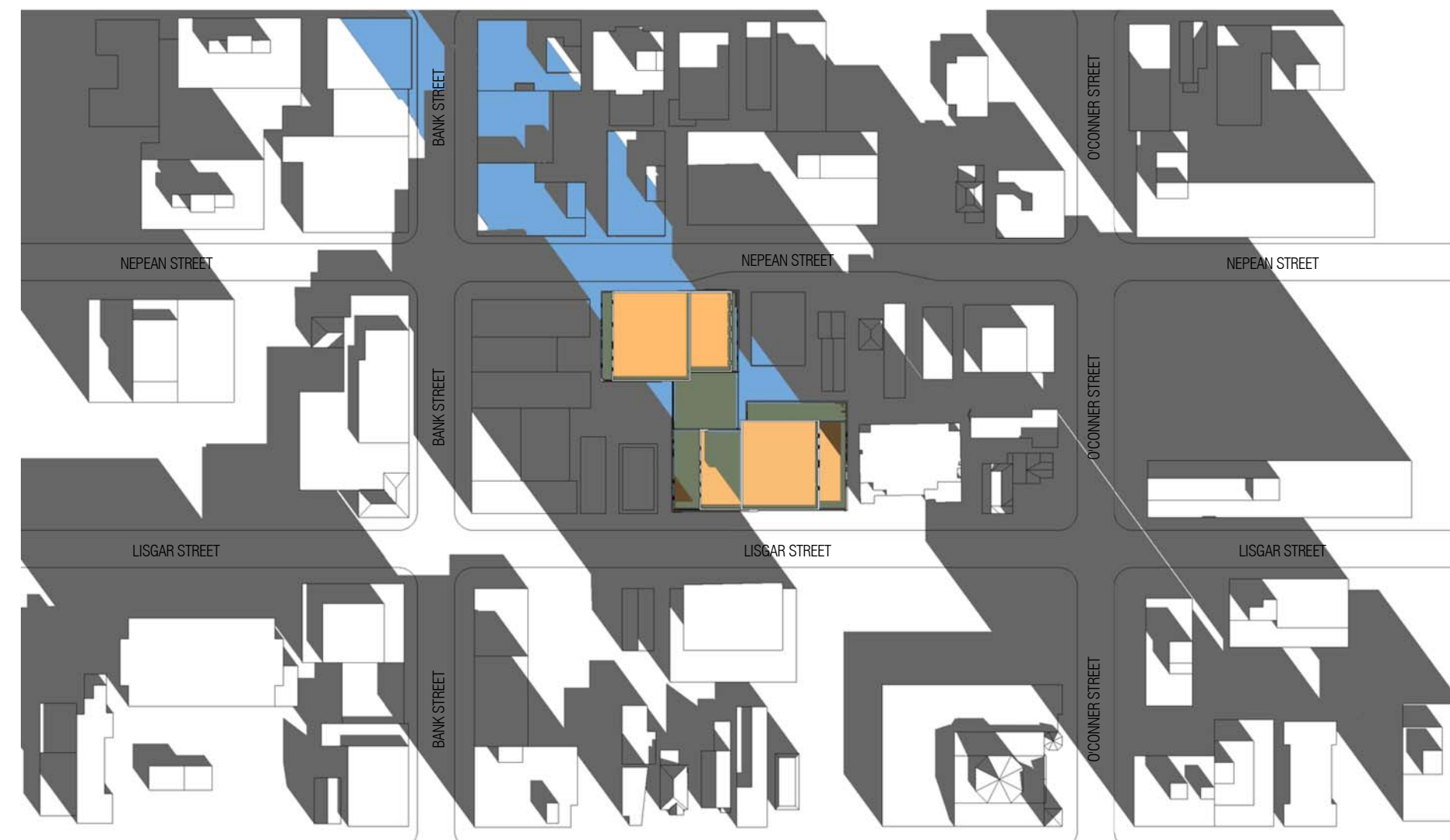

SEPTEMBER/MARCH 21, 2020 - 9:00 a.m.

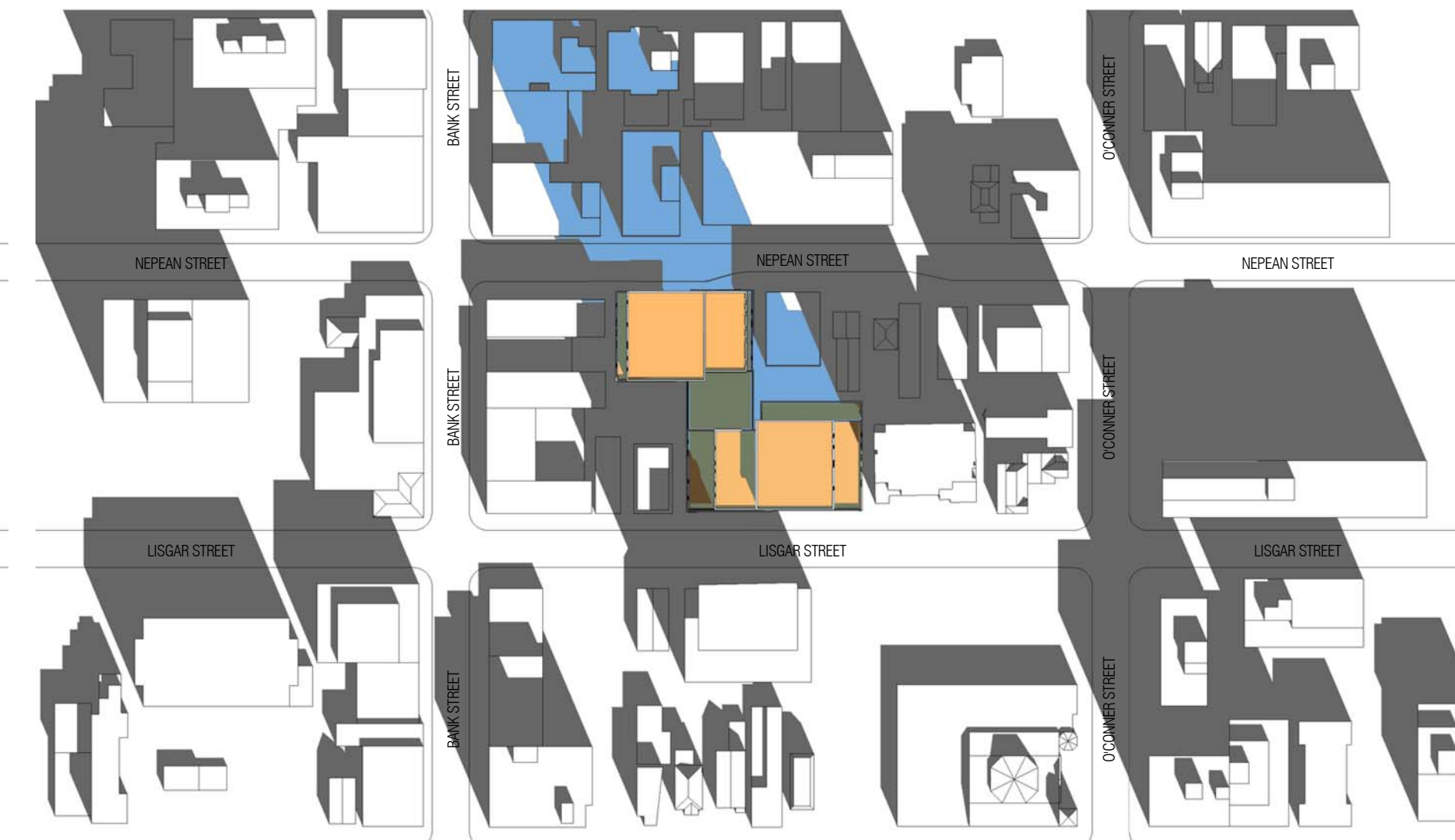

SEPTEMBER/MARCH 21, 2020 - 10:00 a.m.

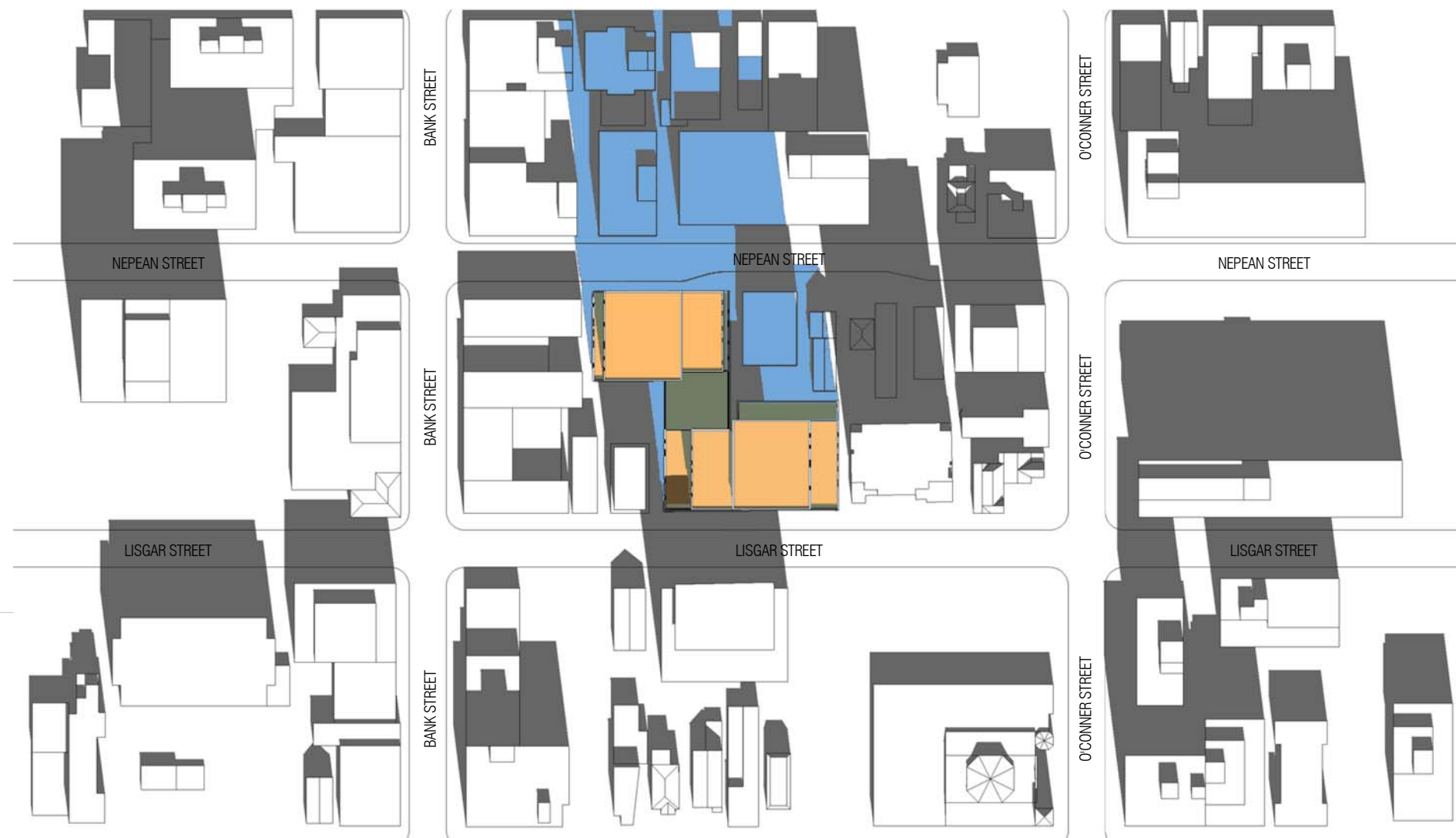

SEPTEMBER/MARCH 21, 2020 - 11:00 a.m.



SEPTEMBER/MARCH 21, 2020 - 12:00 p.m.

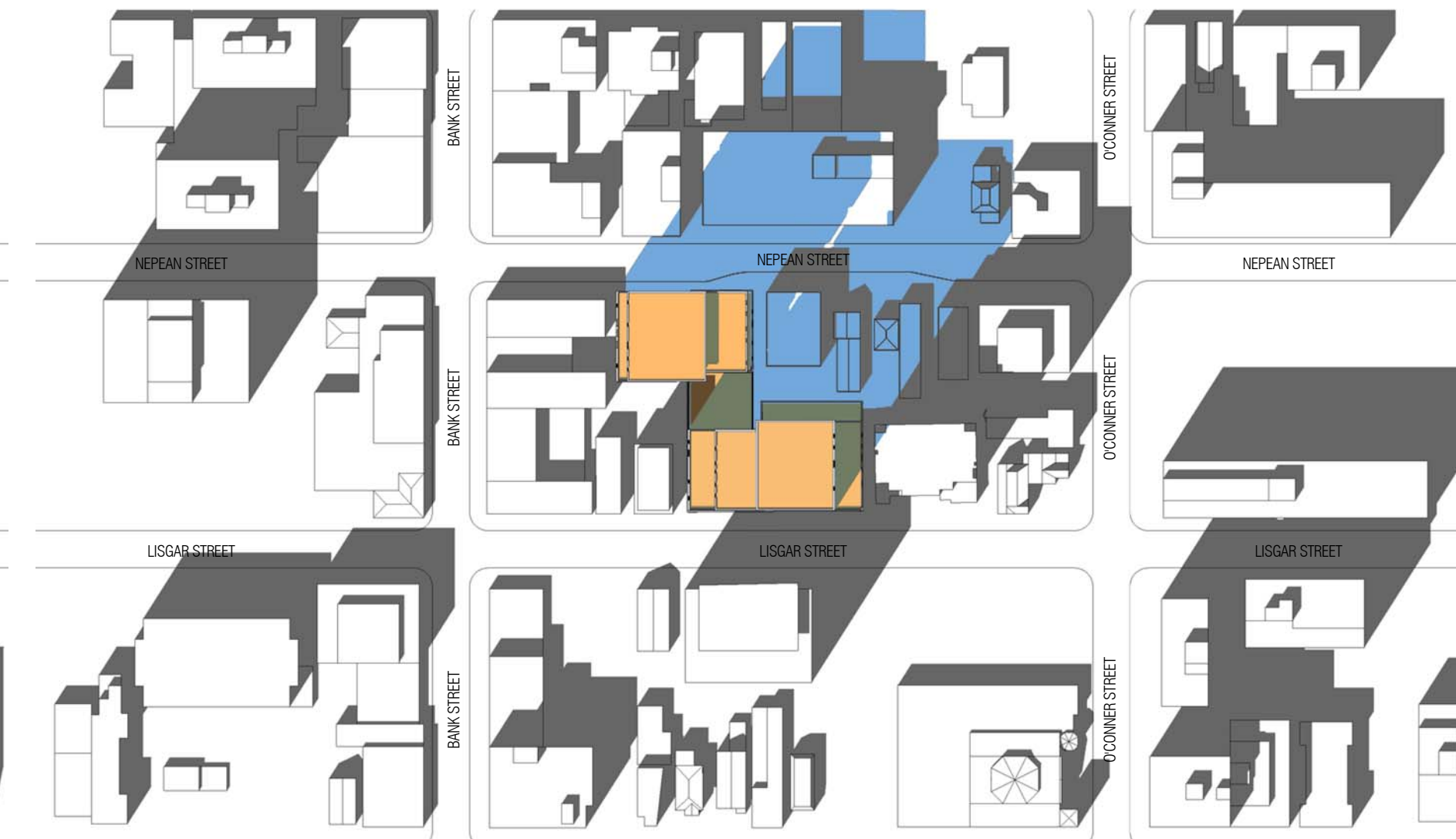

SEPTEMBER/MARCH 21, 2020 - 1:00 p.m.

This drawing, as an instrument of service, is provided by and is the property of Graziani + Corazza Architects Inc. The contractor must verify and accept responsibility for all dimensions and conditions on site and must notify Graziani + Corazza Architects Inc. of any variations from the supplied information. Graziani + Corazza Architects Inc. is not responsible for the accuracy of survey, structural, mechanical, electrical, etc., engineering information shown on this drawing. Refer to the appropriate engineering drawings before proceeding with the work. Construction must conform to all applicable codes and requirements of the authorities having jurisdiction. Unless otherwise noted, no investigation has been undertaken or reported on by this office in regards to the environmental condition of this site.

This drawing is not to be scaled for construction purpose and may be scaled for review purposes only. All architectural symbols indicated on this drawing are graphic representations only.

Conditions for electronic information transfer

Electronic information is supplied to the other associated firms to assist them in the execution of their work/review. The recipient firms must determine the completeness/appropriateness/relevance of the information in respect to their particular responsibility.

Graziani + Corazza Architects Inc. shall not be responsible for:

1. Errors, omissions, incompleteness due to loss of information in whole or part when information is transferred
2. Transmission of any virus or damage to the receiving electronic system when information is transferred

01. NOV.06.2020 ISSUED FOR SPA SUBMISSION

E.C.

GRAZIANI + CORAZZA ARCHITECTS INC.
 ENZO M. CORAZZA
 LICENCE 4702

1320 Shawan Drive, Suite 100 Mississauga Ontario L4W 1C3
 Phone: 905.795.2601 Fax: 905.795.2844 www.gc-architects.com

PROPOSED MIXED USE DEVELOPMENT

176 Nepean & 293-307 Lisgar



OTTAWA ONTARIO

Project Architect: E. CORAZZA
 Assistant Designer: L. WONG
 Drawn By: J. CHU/CHIU
 Checked By: D. BIASE
 Plot Date: NOV.06.2020
 Job #: 1353.16

SHADOW STUDY
 SEPTEMBER/MARCH

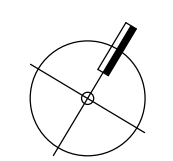

A901

TITLEBLOCK SIZE: 610 x 950

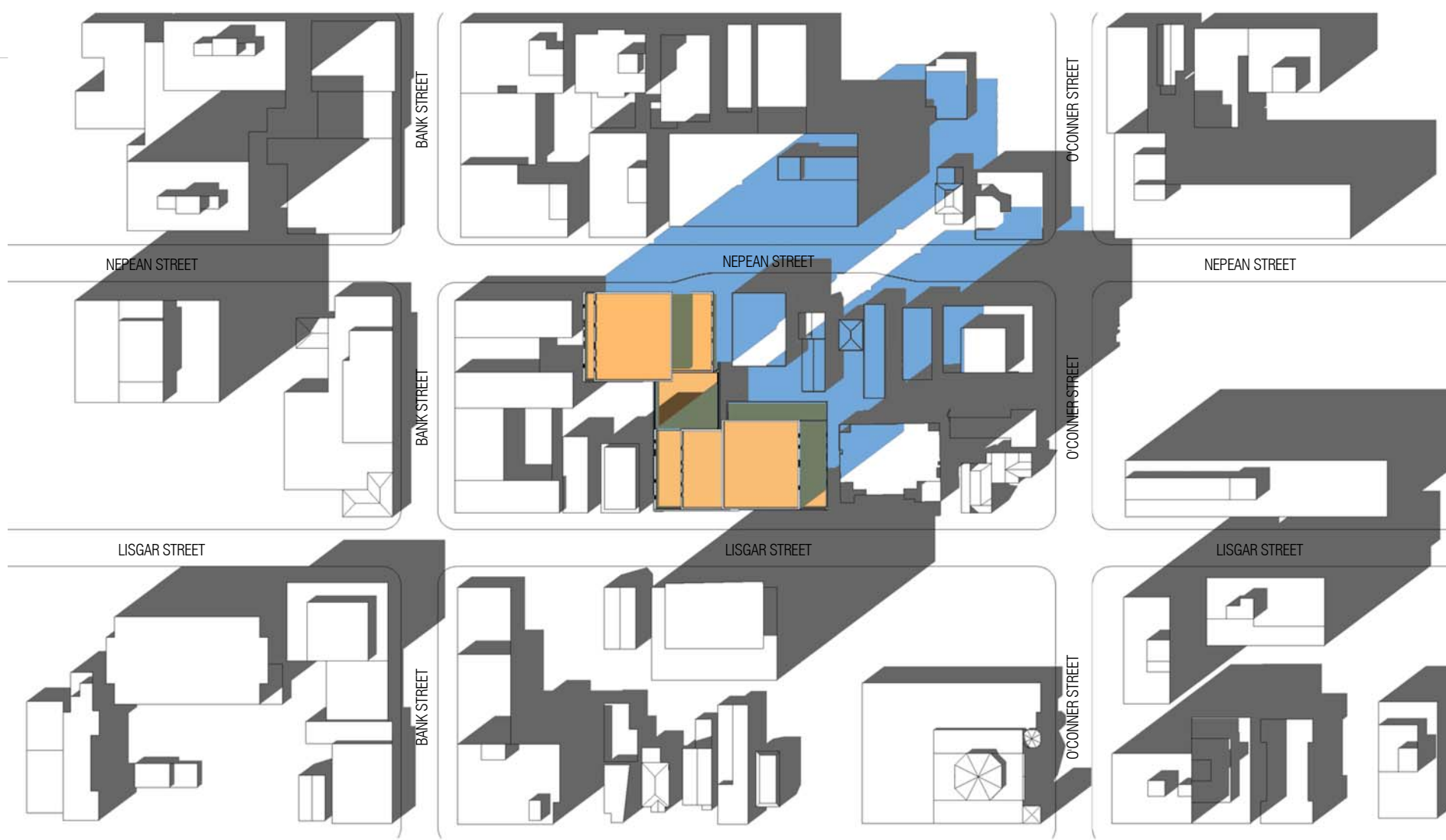

SEPTEMBER/MARCH 21, 2020 - 2:00 p.m.

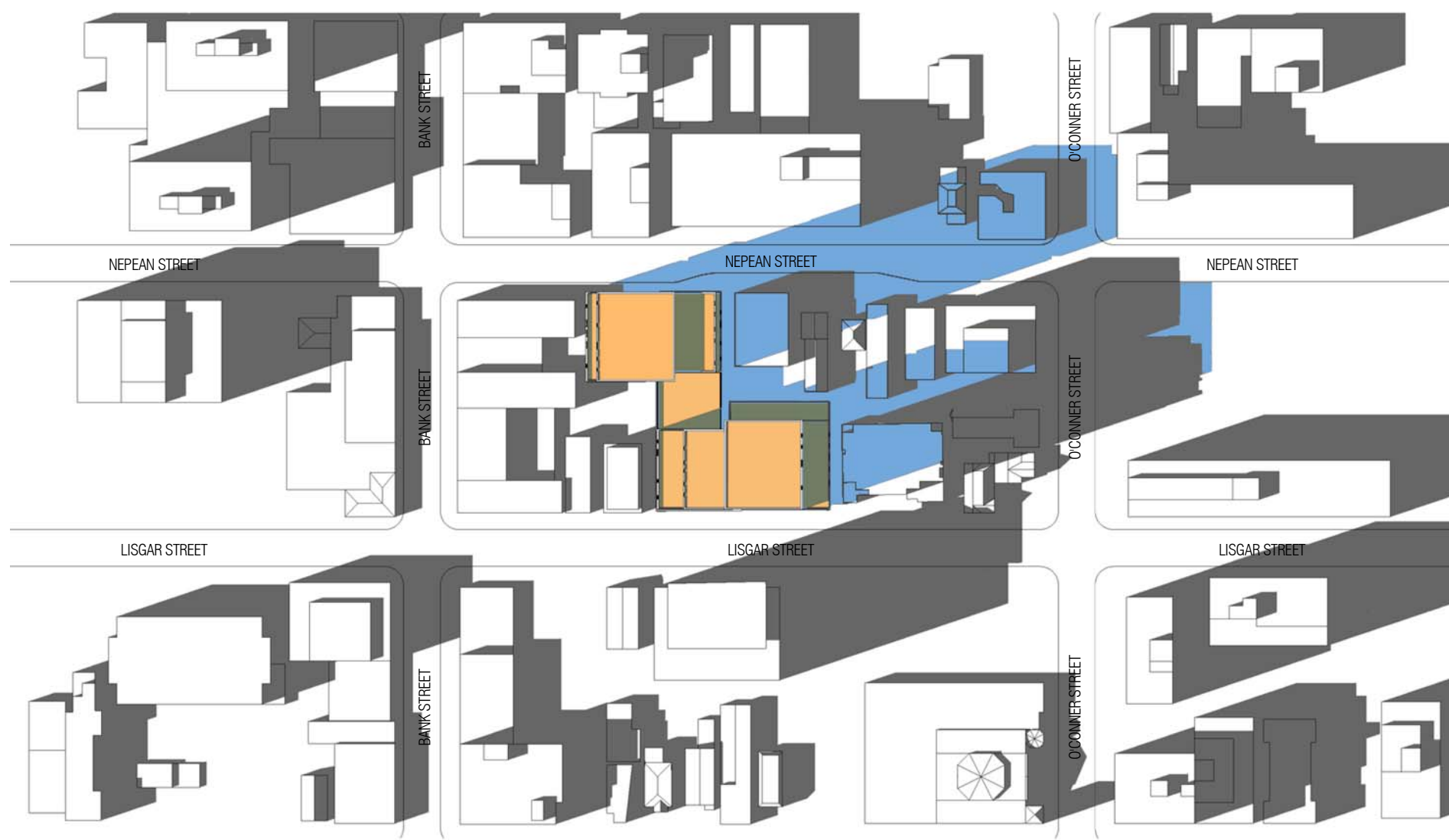

SEPTEMBER/MARCH 21, 2020 - 3:00 p.m.



SEPTEMBER/MARCH 21, 2020- 4:00 p.m.

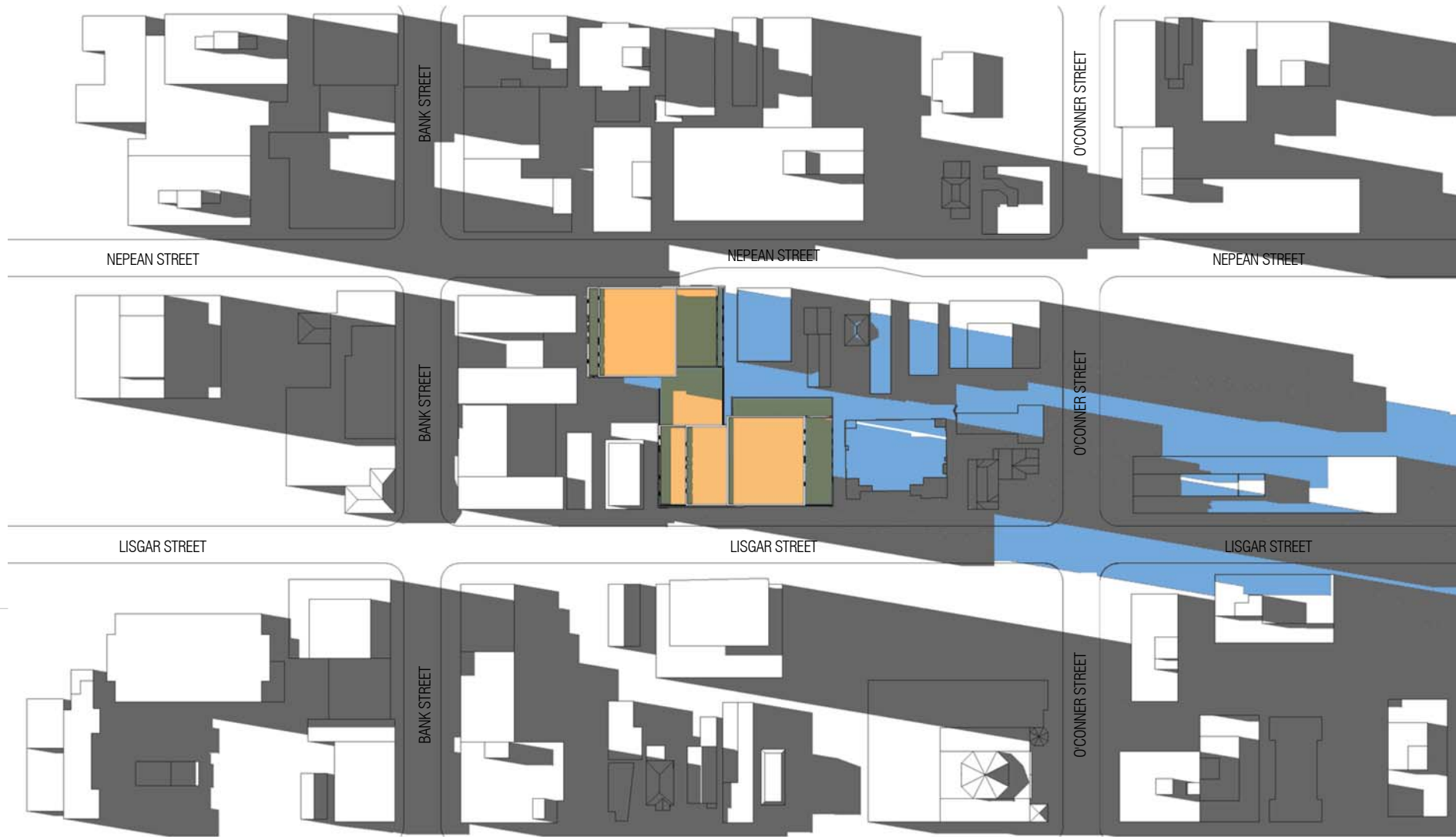

SEPTEMBER/MARCH 21, 2020 - 5:00 p.m.

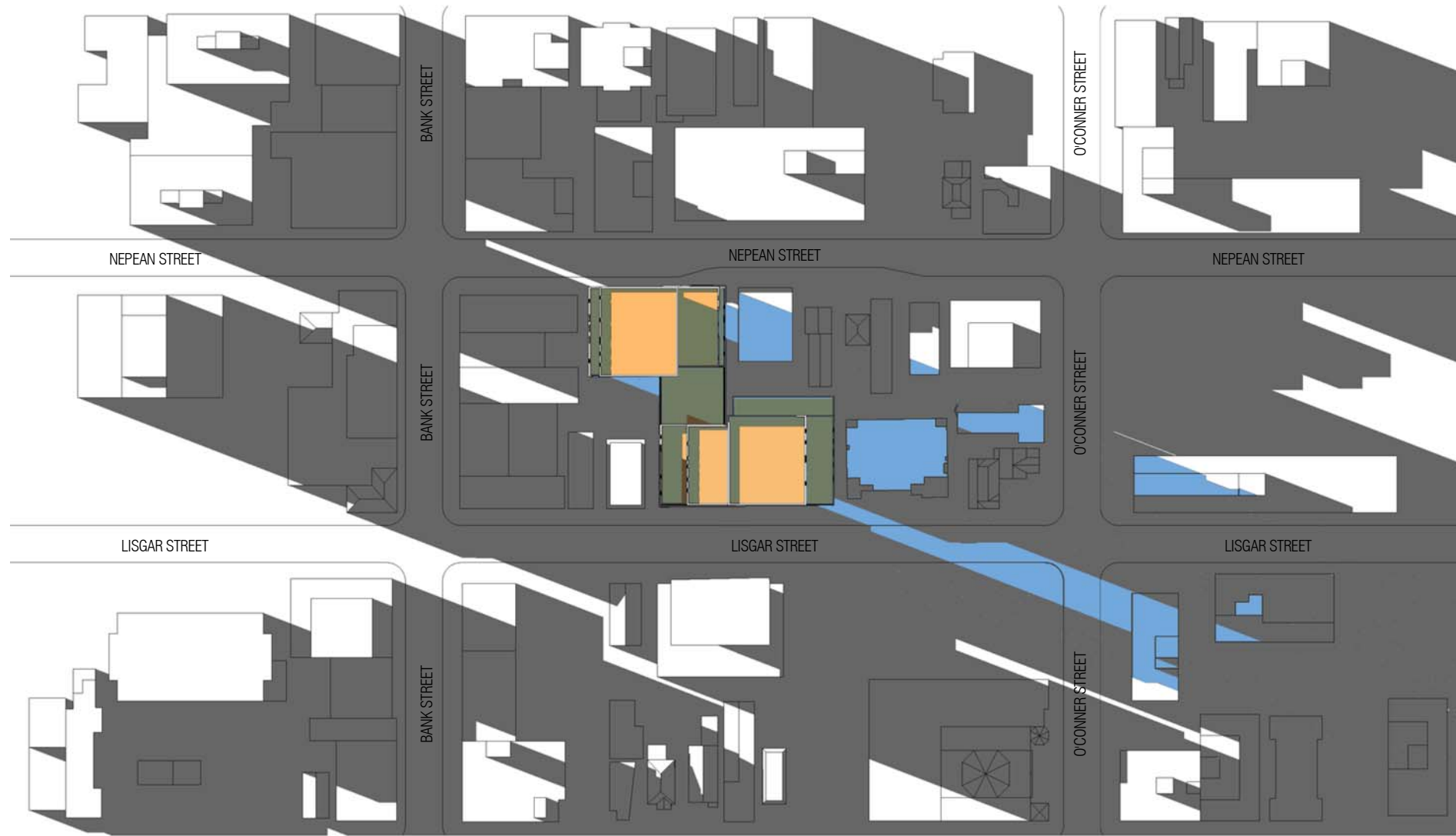

SEPTEMBER/MARCH 21, 2020 - 6:00 p.m.

This drawing, as an instrument of service, is provided by and is the property of Graziani + Corazza Architects Inc. The contractor must verify and accept responsibility for all dimensions and conditions on site and must notify Graziani + Corazza Architects Inc. of any variations from the supplied information. Graziani + Corazza Architects Inc. is not responsible for the accuracy of survey, structural, mechanical, electrical, etc., engineering information shown on this drawing. Refer to the appropriate engineering drawings before proceeding with the work. Construction must conform to all applicable codes and requirements of the authorities having jurisdiction. Unless otherwise noted, no investigation has been undertaken or reported on by this office in regards to the environmental condition of this site.

This drawing is not to be scaled for construction purpose and may be scaled for review purposes only. All architectural symbols indicated on this drawing are graphic representations only.

Conditions for electronic information transfer

Electronic information is supplied to the other associated firms to assist them in the execution of their work/review. The recipient firms must determine the completeness/appropriateness/relevance of the information in respect to their particular responsibility.

Graziani + Corazza Architects Inc. shall not be responsible for:

1. Errors, omissions, incompleteness due to loss of information in whole or part when information is transferred
2. Transmission of any virus or damage to the receiving electronic system when information is transferred

01. NOV.06.2020 ISSUED FOR SPA SUBMISSION

E.C.

GRAZIANI + CORAZZA ARCHITECTS INC.
 1320 Shawan Drive, Suite 100 Mississauga Ontario L4W 1C3
 Phone: 905.795.2601 Fax: 905.795.2844 www.gc-architects.com

PROPOSED MIXED USE DEVELOPMENT

176 Nepean & 293-307 Lisgar

OTTAWA ONTARIO

Project Architect: E.CORAZZA
 Assistant Designer: L.WONG
 Drawn By: J.CH/W.CHIU
 Checked By: D.BIASE
 Plot Date: NOV.06.2020
 Job #: 1353.16

SHADOW STUDY
 SEPTEMBER/MARCH

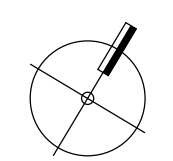

A902

TITLEBLOCK SIZE: 610 x 950



JUNE 21, 2021 - 8:00 a.m.

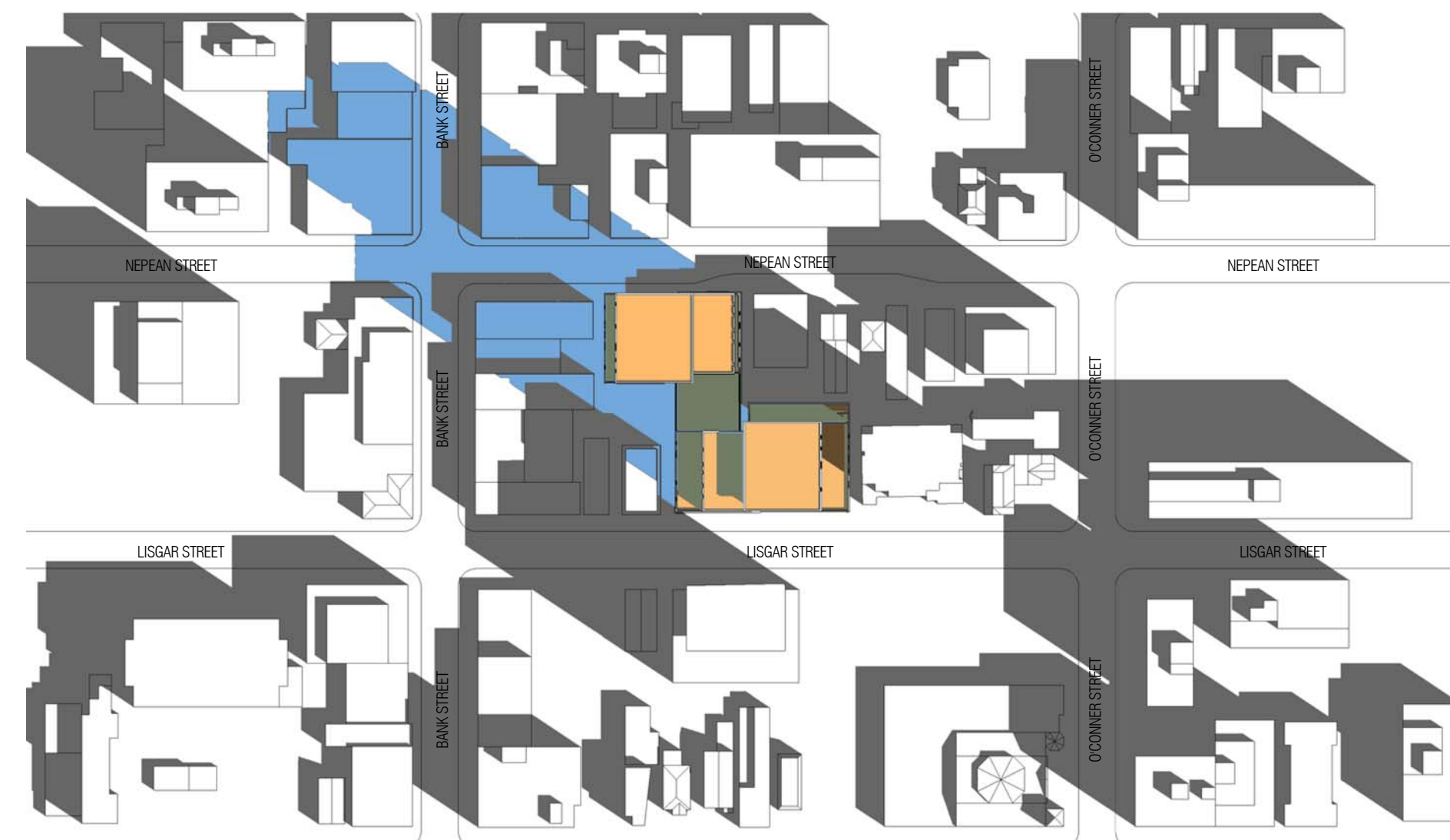

JUNE 21, 2021 - 9:00 a.m.

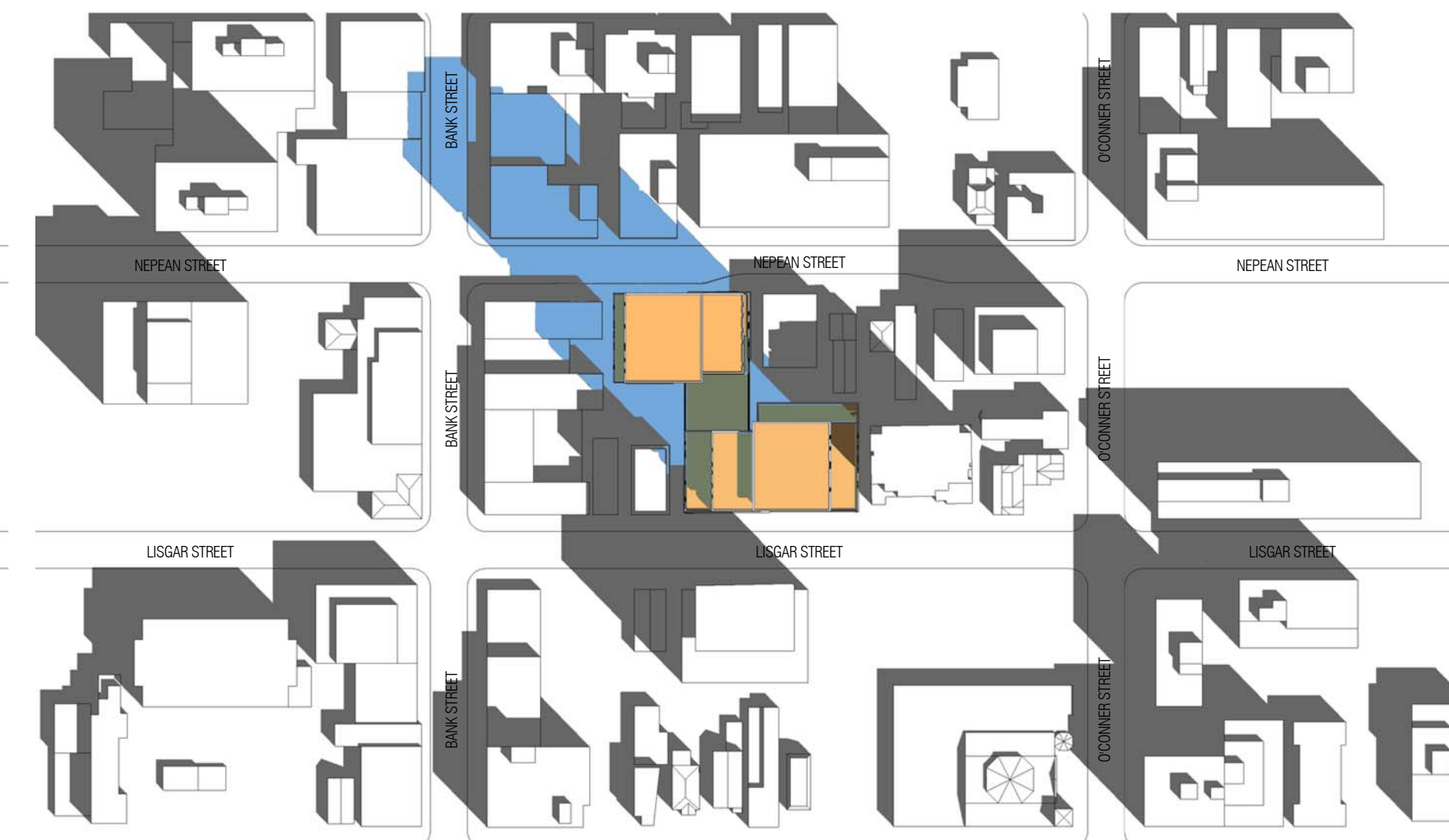

JUNE 21, 2021 - 10:00 a.m.

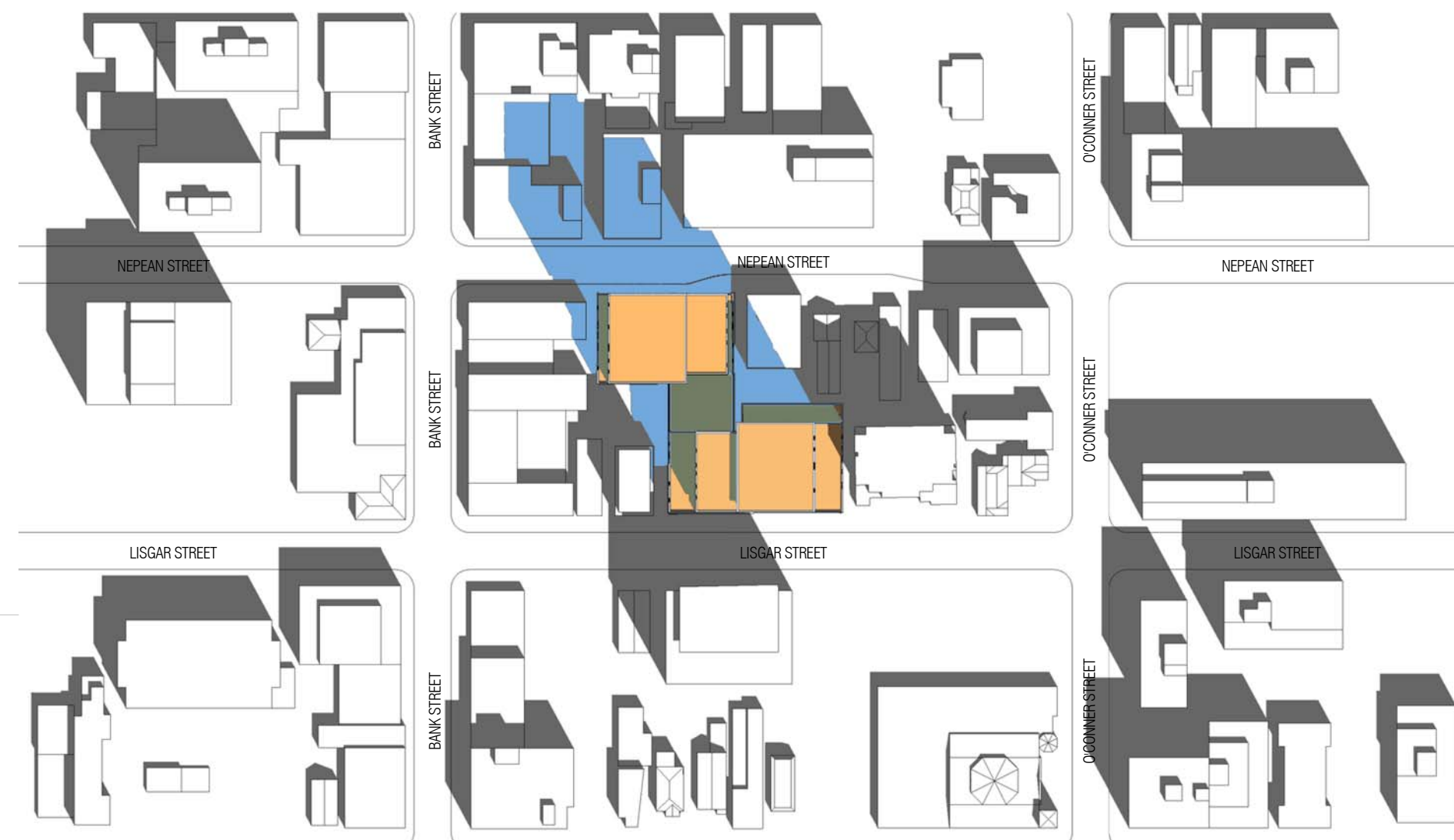

JUNE 21, 2021 - 11:00 a.m.



JUNE 21, 2021 - 12:00 p.m.



JUNE 21, 2021 - 1:00 p.m.



JUNE 21, 2021 - 2:00 p.m.

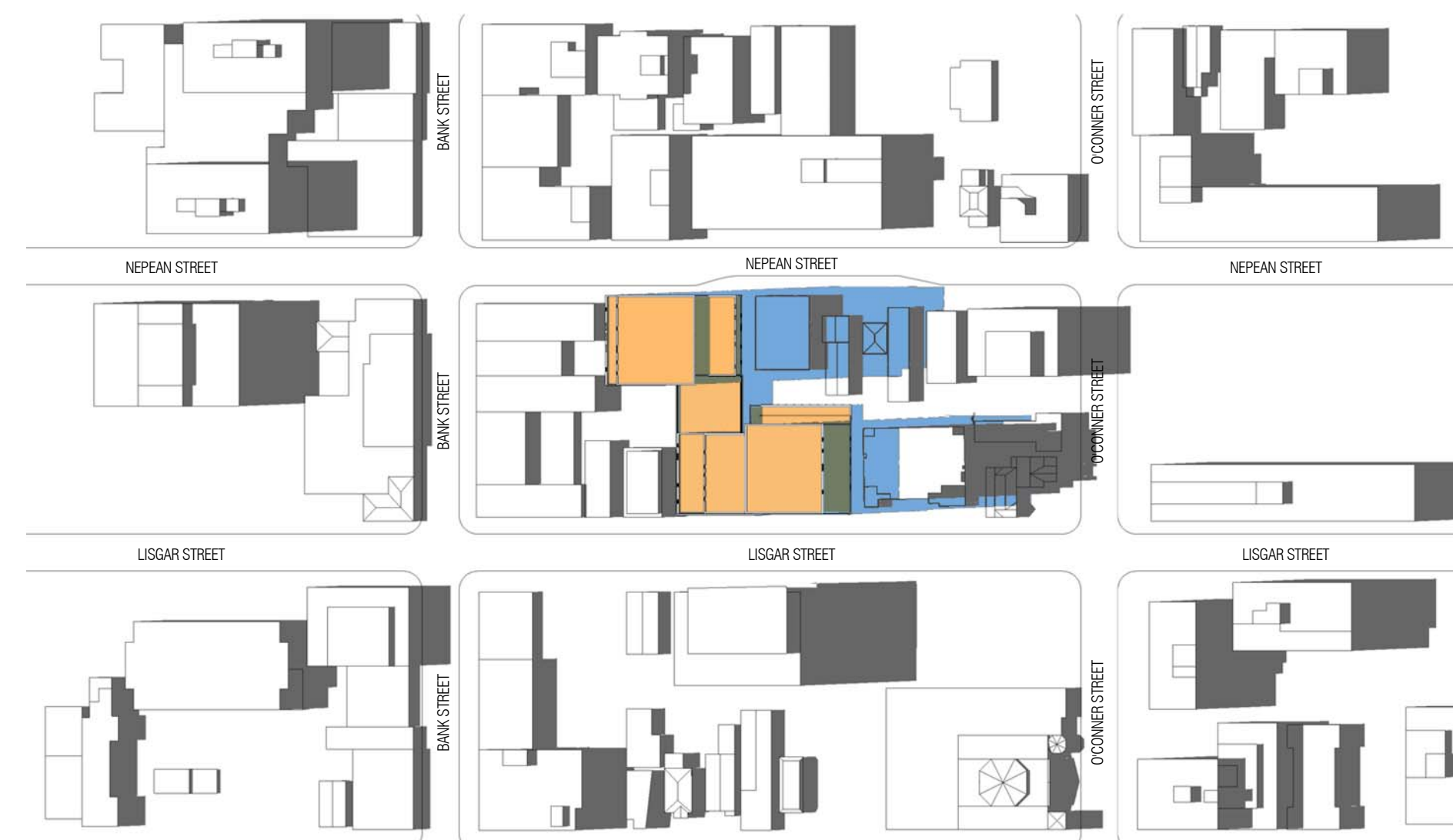

JUNE 21, 2021 - 3:00 p.m.

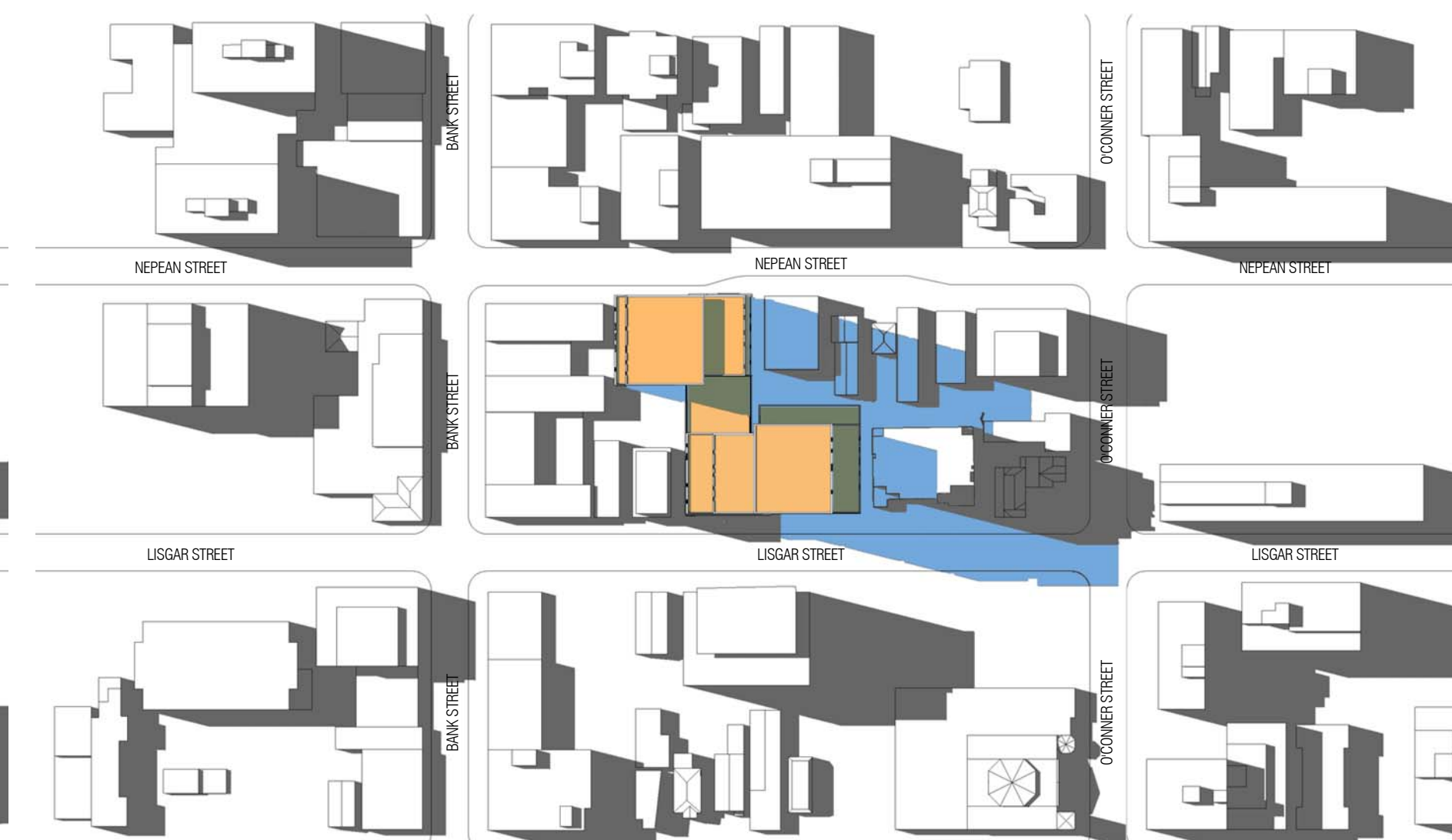

JUNE 21, 2021 - 4:00 p.m.

This drawing, as an instrument of service, is provided by and is the property of Graziani + Corazza Architects Inc. The contractor must verify and accept responsibility for all dimensions and conditions on site and must notify Graziani + Corazza Architects Inc. of any variations from the supplied information. Graziani + Corazza Architects Inc. is not responsible for the accuracy of survey, structural, mechanical, electrical, etc., engineering information shown on this drawing. Refer to the appropriate engineering drawings before proceeding with the work. Construction must conform to all applicable codes and requirements of the authorities having jurisdiction. Unless otherwise noted, no investigation has been undertaken or reported on by this office in regards to the environmental condition of this site.

This drawing is not to be scaled for construction purpose and may be scaled for review purposes only. All architectural symbols indicated on this drawing are graphic representations only.

Conditions for electronic information transfer

Electronic information is supplied to the other associated firms to assist them in the execution of their work/review. The recipient firms must determine the completeness/appropriateness/relevance of the information in respect to their particular responsibility.

Graziani + Corazza Architects Inc. shall not be responsible for:

1. Errors, omissions, incompleteness due to loss of information in whole or part when information is transferred
2. Transmission of any virus or damage to the receiving electronic system when information is transferred

01. NOV.06.2020 ISSUED FOR SPA SUBMISSION E.C.

GRAZIANI + CORAZZA ARCHITECTS INC.
1320 Shawan Drive, Suite 100, Mississauga, Ontario L4W 1C3
Phone: 905.795.2601 Fax: 905.795.2844 www.gc-architects.com

ONTARIO ASSOCIATION OF ARCHITECTS
luvo loay
ENZO M. CORAZZA
LICENCE 4702

PROPOSED MIXED USE DEVELOPMENT

176 Nepean & 293-307 Lisgar

RICH CRAFT
Group of Companies

OTTAWA ONTARIO

Project Architect: E. CORAZZA
Assistant Designer: L. WONG
Drawn By: J. CHU, W. CHIU
Checked By: D. BIASE
Plot Date: NOV. 06. 2020
Job #: 1353.16

SHADOW STUDY JUNE

A903

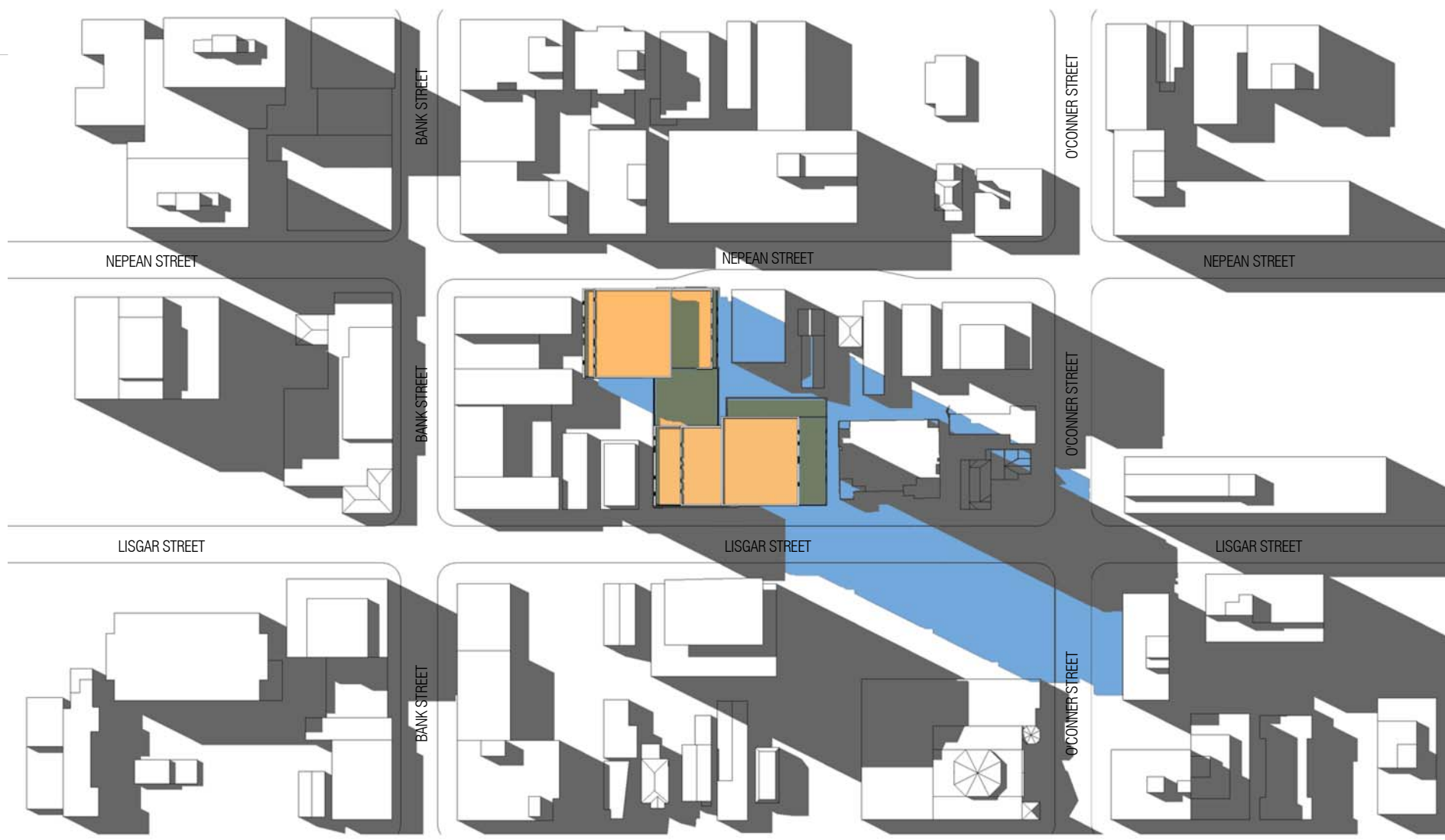

JUNE 21, 2021 - 5:00 p.m.

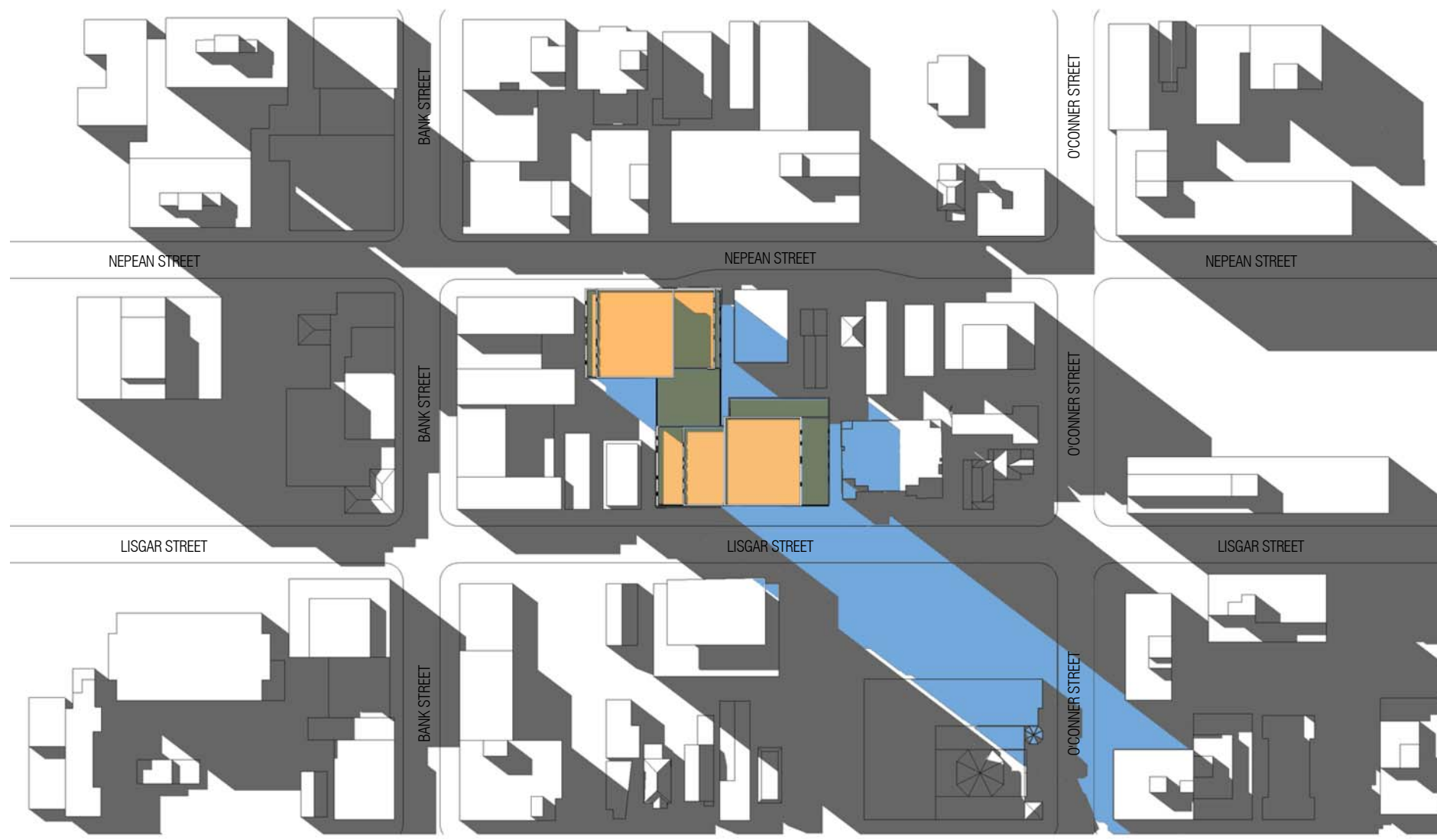

JUNE 21, 2021 - 6:00 p.m.

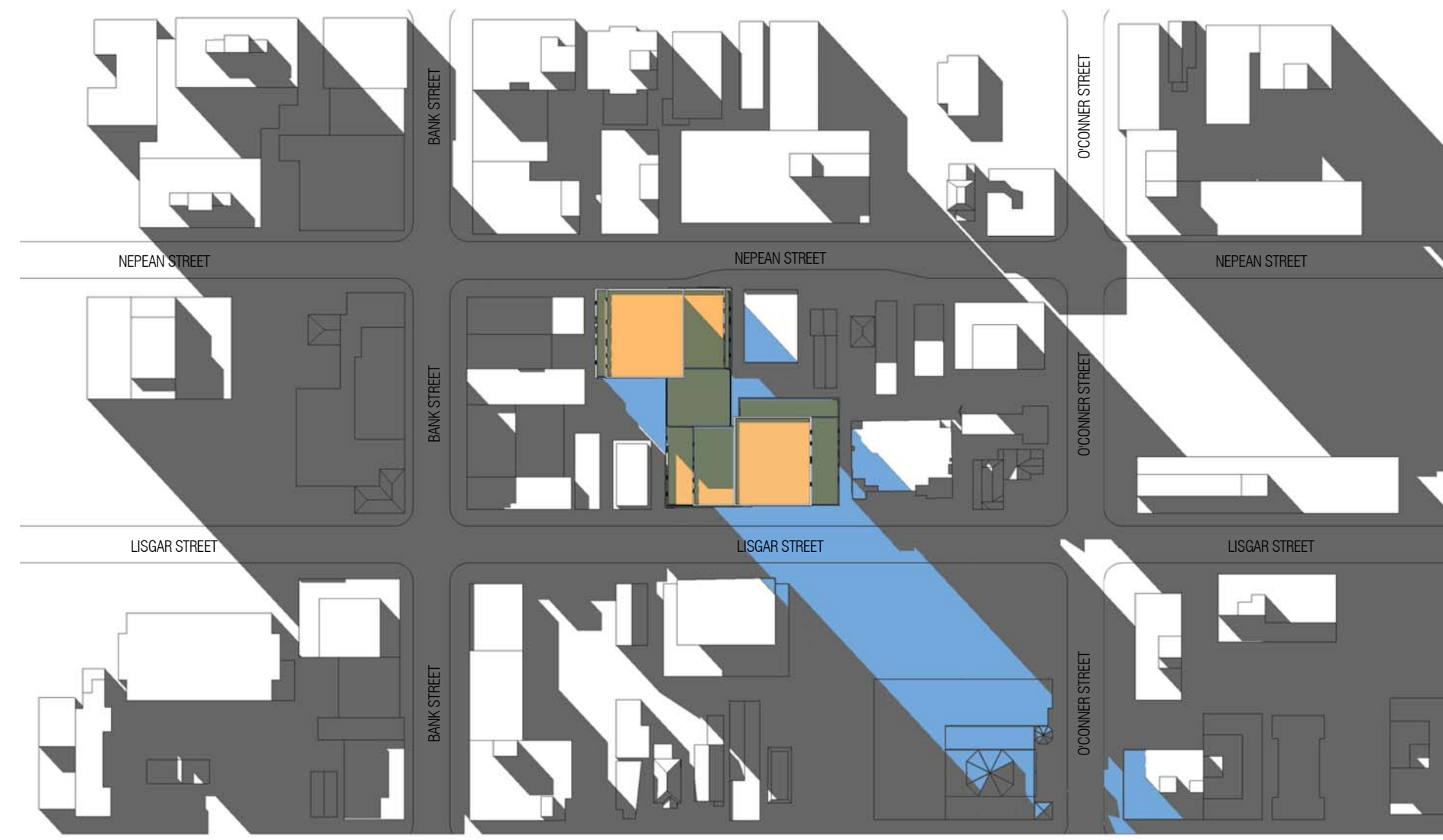

JUNE 21, 2021 - 7:00 p.m.

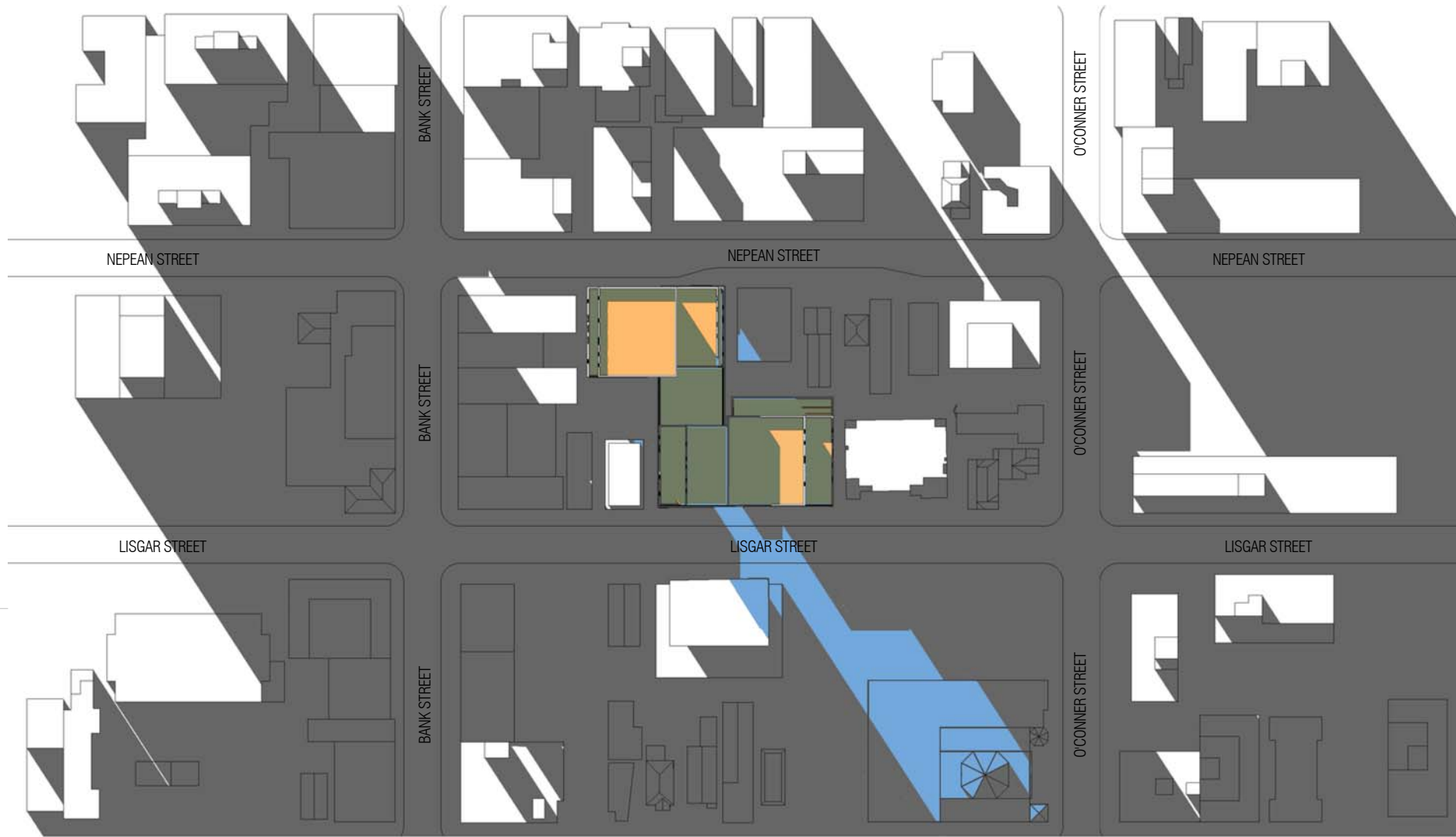

JUNE 21, 2021 - 8:00 p.m.

This drawing, as an instrument of service, is provided by and is the property of Graziani + Corazza Architects Inc. The contractor must verify and accept responsibility for all dimensions and conditions on site and must notify Graziani + Corazza Architects Inc. of any variations from the supplied information. Graziani + Corazza Architects Inc. is not responsible for the accuracy of survey, structural, mechanical, electrical, etc., engineering information shown on this drawing. Refer to the appropriate engineering drawings before proceeding with the work. Construction must conform to all applicable codes and requirements of the authorities having jurisdiction. Unless otherwise noted, no investigation has been undertaken or reported on by this office in regards to the environmental condition of this site.

This drawing is not to be scaled for construction purpose and may be scaled for review purposes only. All architectural symbols indicated on this drawing are graphic representations only.

Conditions for electronic information transfer

Electronic information is supplied to the other associated firms to assist them in the execution of their work/review. The recipient firms must determine the completeness/appropriateness/relevance of the information in respect to their particular responsibility.

Graziani + Corazza Architects Inc. shall not be responsible for:

1. Errors, omissions, incompleteness due to loss of information in whole or part when information is transferred
2. Transmission of any virus or damage to the receiving electronic system when information is transferred

01. NOV.06.2020 ISSUED FOR SPA SUBMISSION E.C.

GRAZIANI + CORAZZA ARCHITECTS INC.
 1320 Shawan Drive, Suite 100 Mississauga Ontario L4W 1C3
 Phone: 905.795.2601 Fax: 905.795.2844 www.gc-architects.com

PROPOSED MIXED USE DEVELOPMENT

176 Nepean & 293-307 Lisgar

OTTAWA ONTARIO

Project Architect: E. CORAZZA
 Assistant Designer: L. WONG
 Drawn By: J. CH'W. CHIU
 Checked By: D. BIASE
 Plot Date: NOV.06.2020
 Job #: 1353.16

SHADOW STUDY JUNE

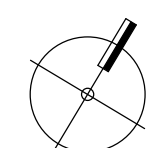

A904

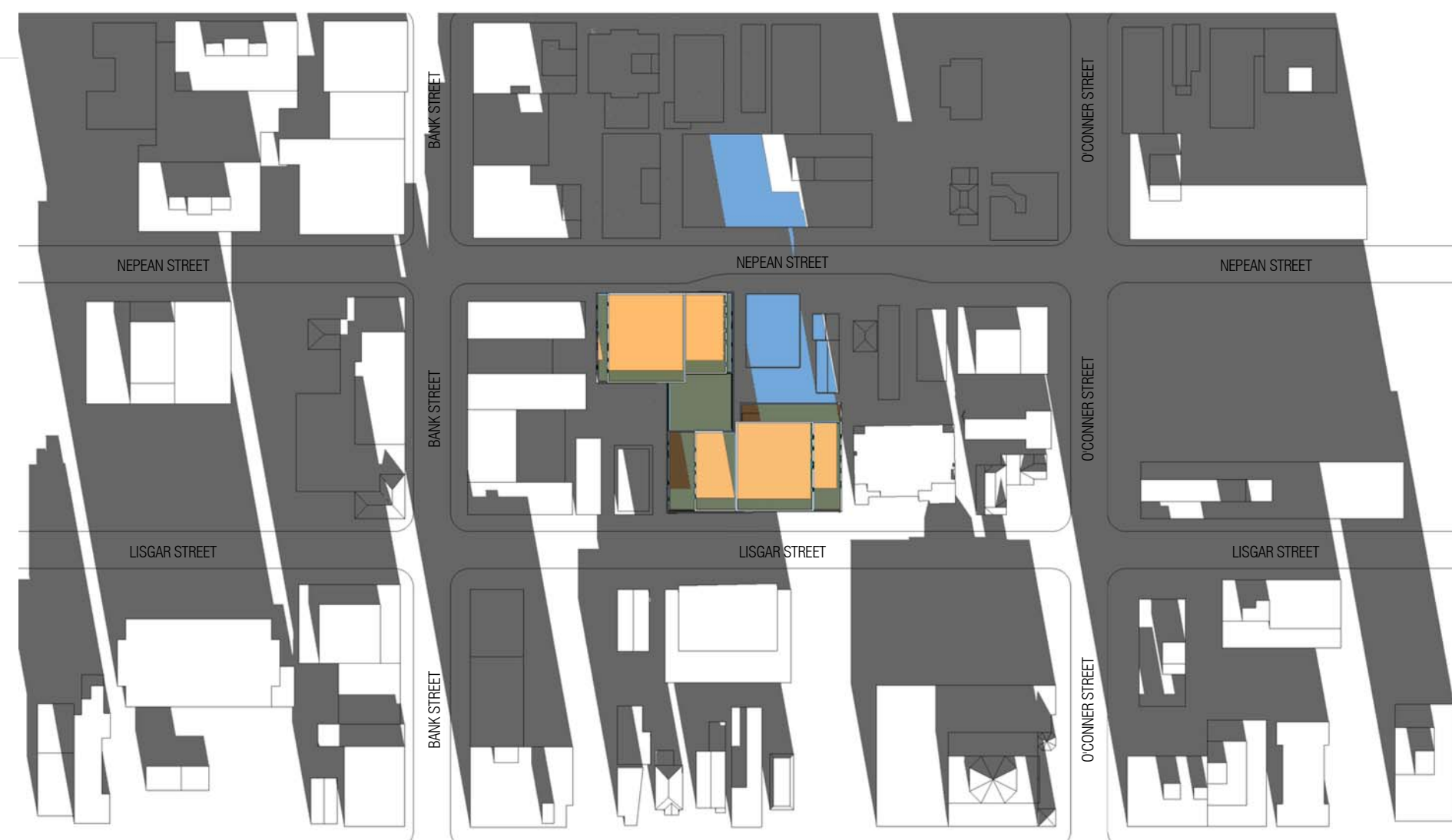

DECEMBER 21, 2021 - 9:00 a.m.

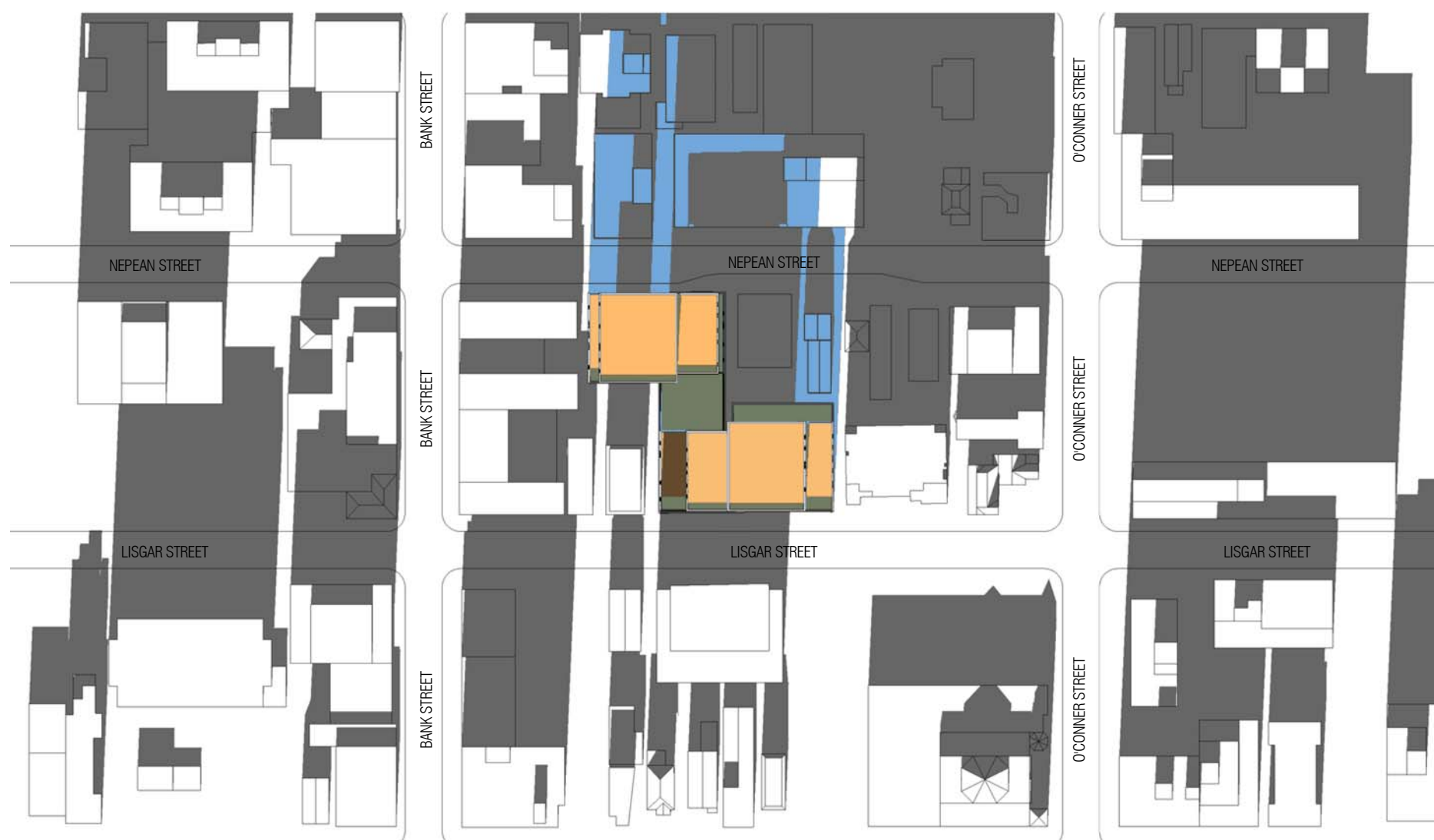

DECEMBER 21, 2021 - 10:00 a.m.

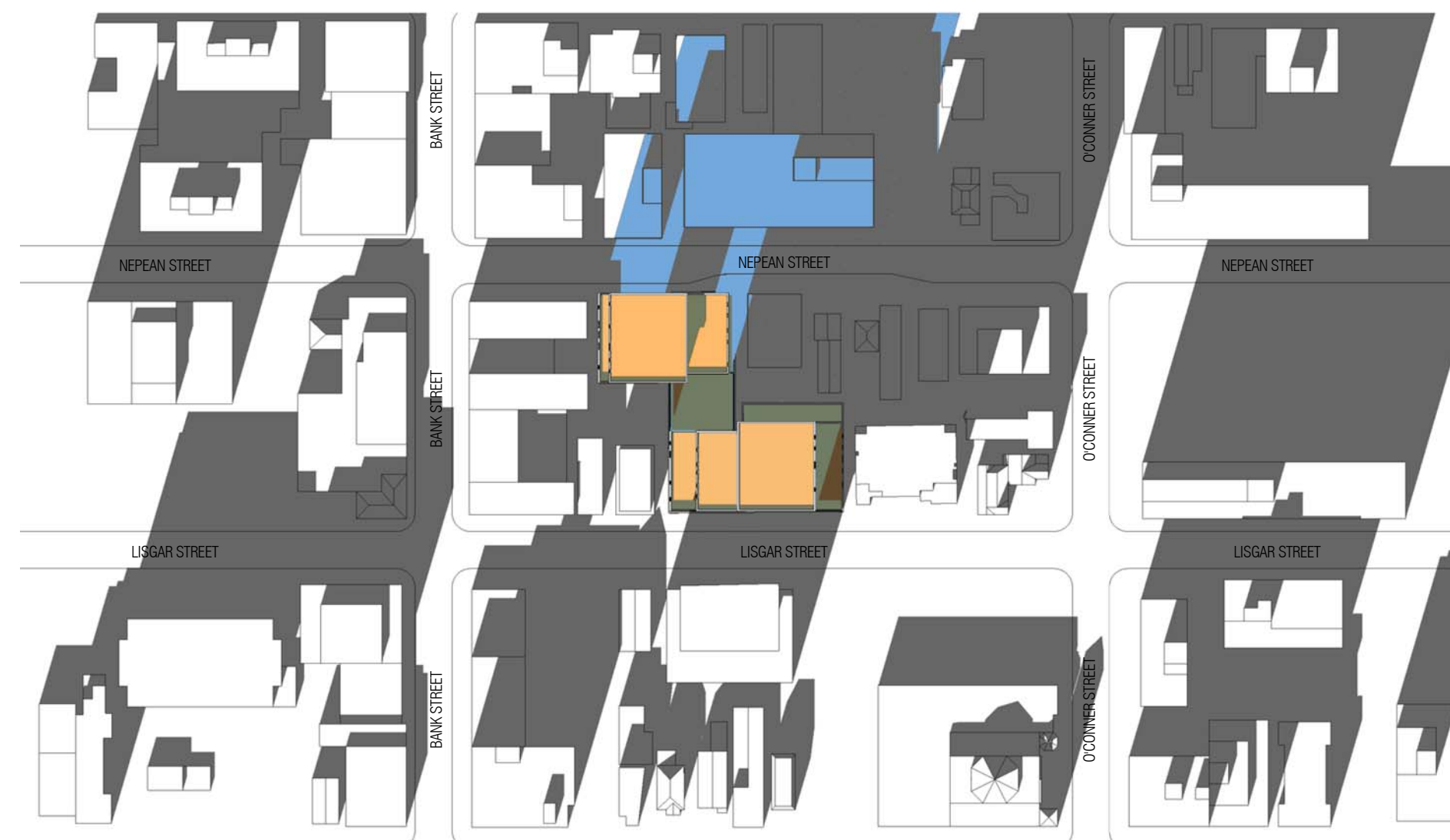

DECEMBER 21, 2021 - 11:00 a.m.

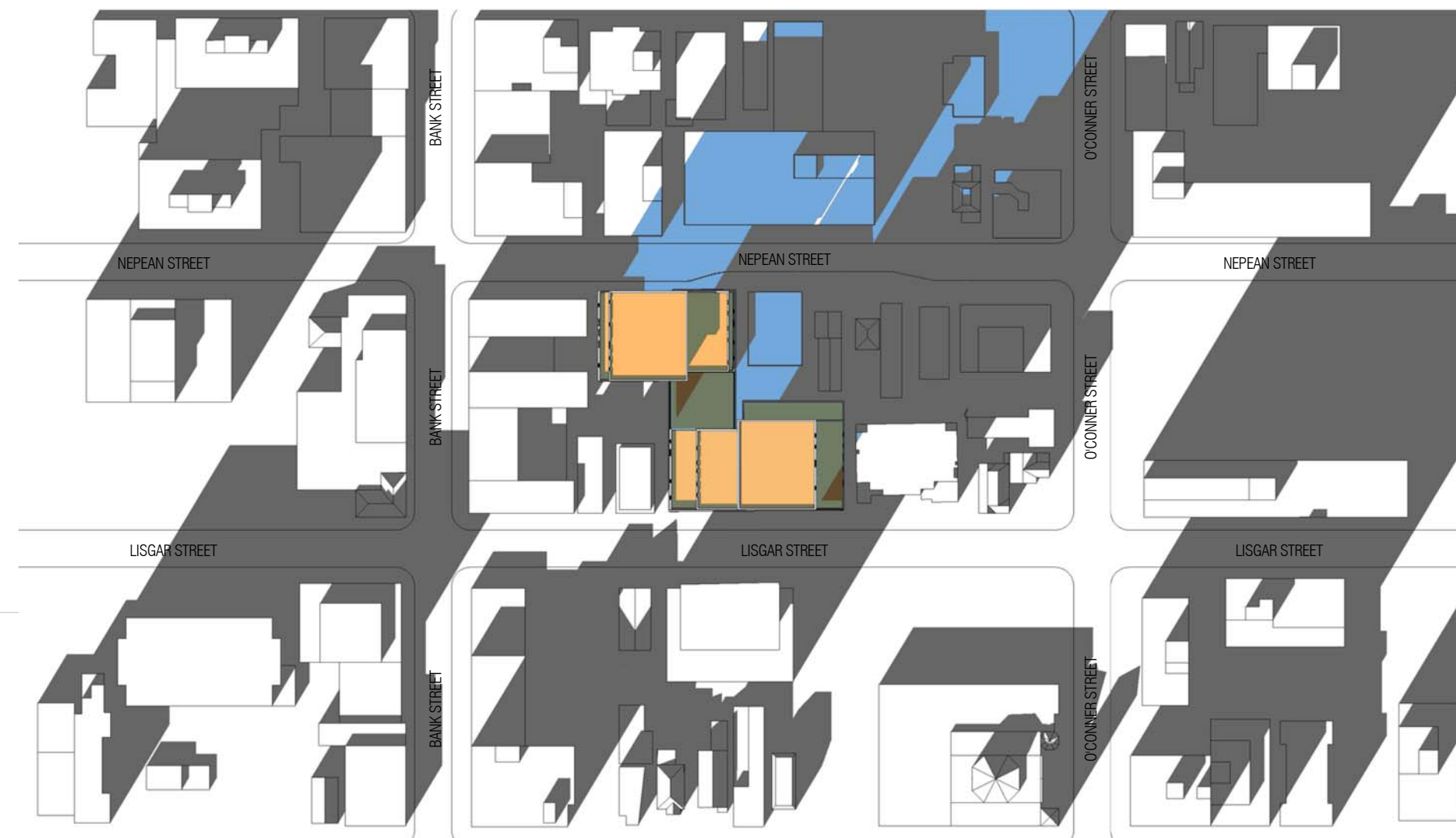

DECEMBER 21, 2021 - 12:00 p.m.

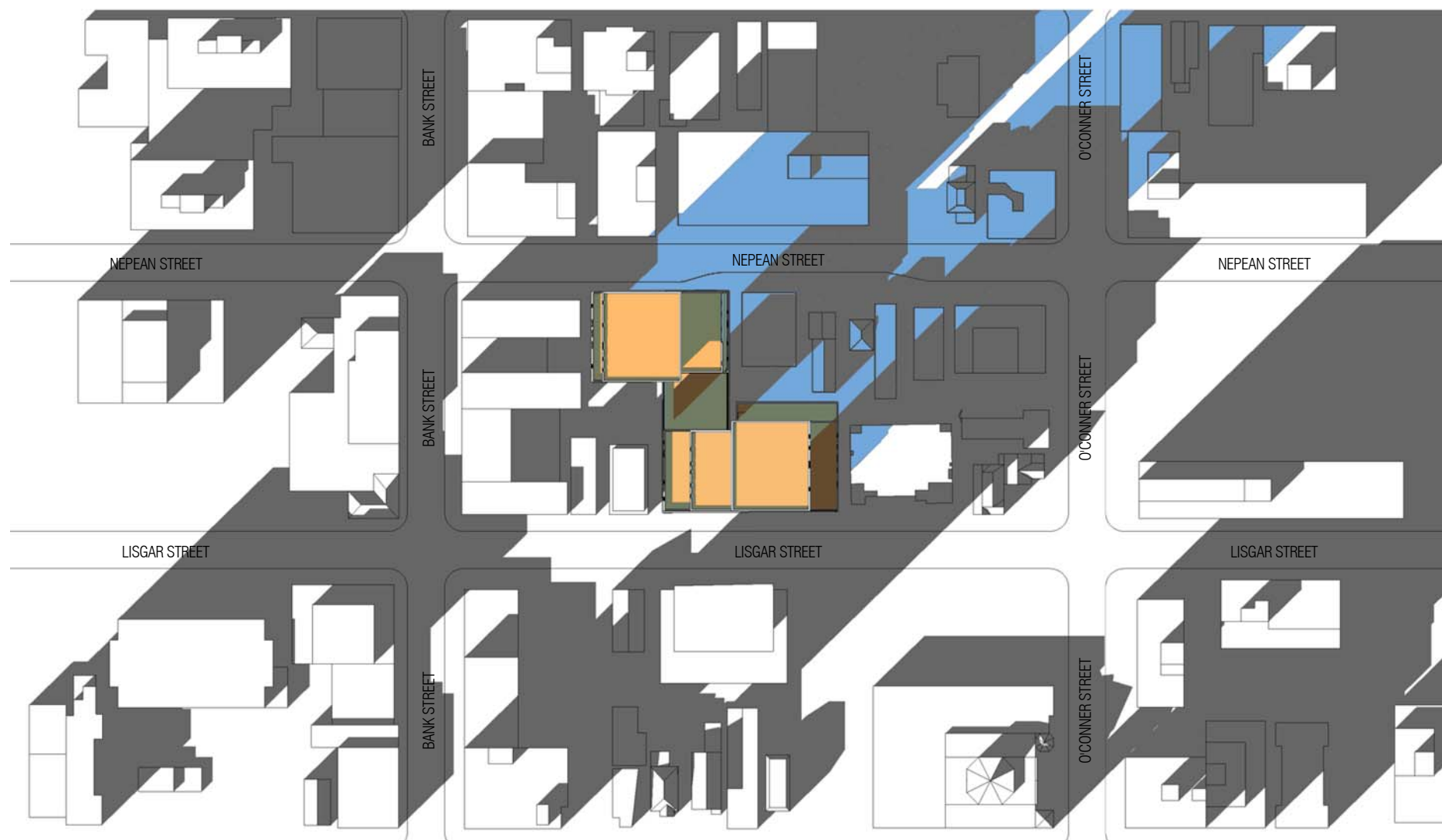

DECEMBER 21, 2021 - 1:00 p.m.

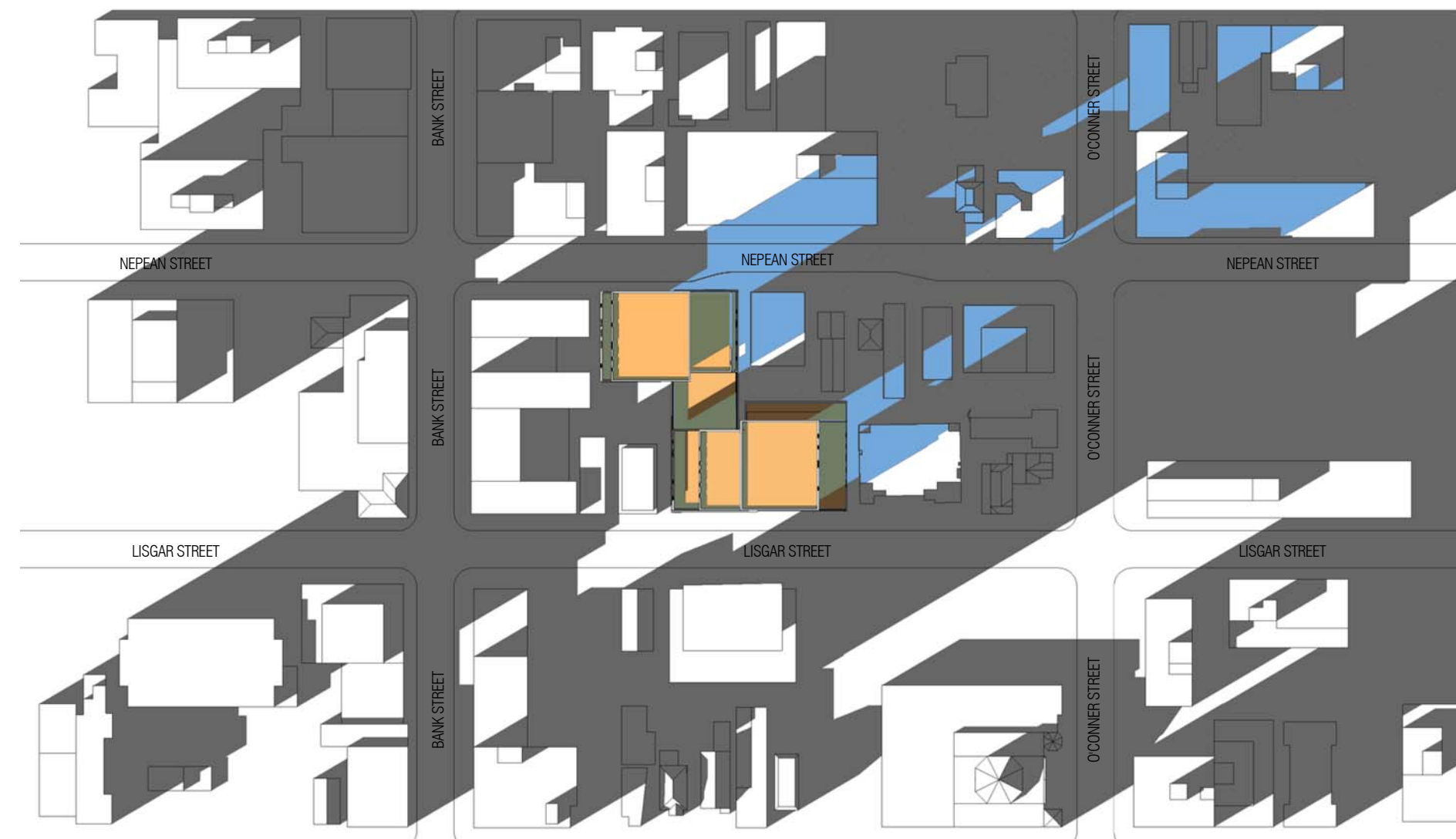

DECEMBER 21, 2021 - 2:00 p.m.

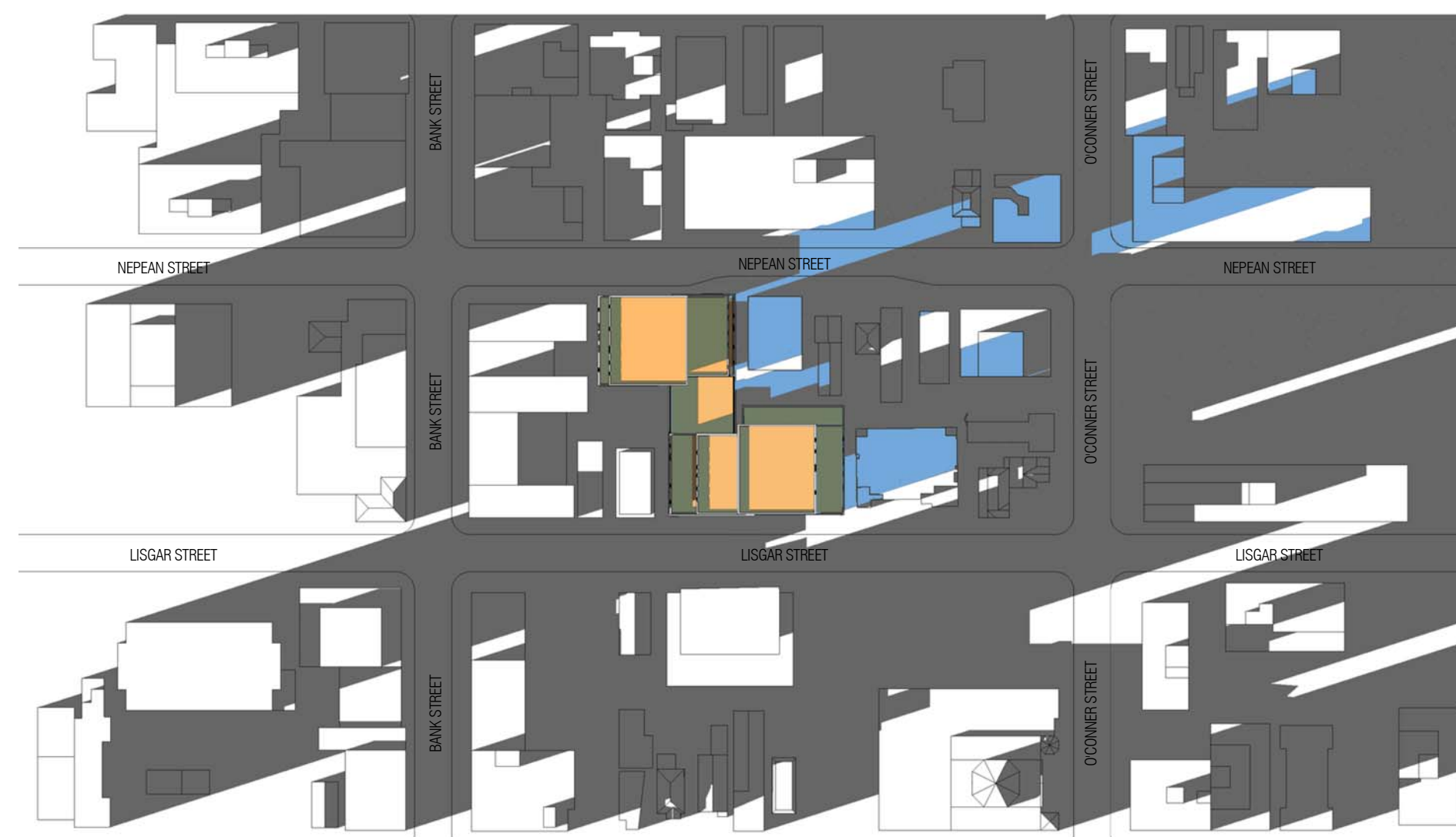

DECEMBER 21, 2021 - 3:00 p.m.

This drawing, as an instrument of service, is provided by and is the property of Graziani + Corazza Architects Inc. The contractor must verify and accept responsibility for all dimensions and conditions on site and must notify Graziani + Corazza Architects Inc. of any variations from the supplied information. Graziani + Corazza Architects Inc. is not responsible for the accuracy of survey, structural, mechanical, electrical, etc., engineering information shown on this drawing. Refer to the appropriate engineering drawings before proceeding with the work. Construction must conform to all applicable codes and requirements of the authorities having jurisdiction. Unless otherwise noted, no investigation has been undertaken or reported on by this office in regards to the environmental condition of this site.

This drawing is not to be scaled for construction purpose and may be scaled for review purposes only. All architectural symbols indicated on this drawing are graphic representations only.

Conditions for electronic information transfer

Electronic information is supplied to the other associated firms to assist them in the execution of their work/review. The recipient firms must determine the completeness/appropriateness/relevance of the information in respect to their particular responsibility.

Graziani + Corazza Architects Inc. shall not be responsible for:

1. Errors, omissions, incompleteness due to loss of information in whole or part when information is transferred
2. Transmission of any virus or damage to the receiving electronic system when information is transferred

01. NOV.06.2020 ISSUED FOR SPA SUBMISSION E.C.

GRAZIANI + CORAZZA ARCHITECTS INC.
1320 Shawan Drive, Suite 100, Mississauga, Ontario L4W 1C3
Phone: 905.735.2601 Fax: 905.735.2844 www.gc-architects.com

ONTARIO ASSOCIATION OF ARCHITECTS
lujo loay
ENZO M. CORAZZA
LICENCE 4702

PROPOSED MIXED USE DEVELOPMENT

176 Nepean & 293-307 Lisgar

OTTAWA RICHCRAFT Group of Companies ONTARIO

Project Architect: E.CORAZZA
Assistant Designer: L.WONG
Drawn By: J.OH/W.CHIU
Checked By: D.BIASE
Plot Date: NOV.06.2020
Job #: 1353.16

SHADOW STUDY
DECEMBER



TITLEBLOCK SIZE: 610 x 950