

GENERAL NOTES:
 1. IT IS THE CONTRACTOR'S RESPONSIBILITY TO USE FIXED DIMENSIONS IN PREFERENCE TO SCALING.
 2. VERIFY AND CHECK ALL DIMENSIONS PRIOR TO AND DURING CONSTRUCTION.
 3. DETERMINE LOCATIONS OF ALL EXISTING SERVICES.
 4. PLANS ARE IN CONFORMANCE WITH THE ONTARIO BUILDING CODE.
 ANY CHANGES, DISCREPANCIES OR SUBSTITUTIONS SHALL BE REPORTED TO AND REVIEWED BY THE ARCHITECT BEFORE PROCEEDING.

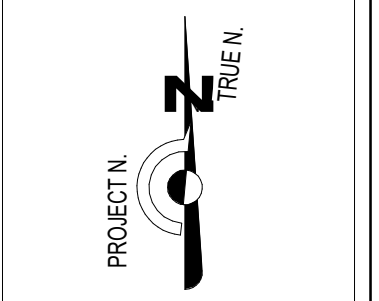

NO.	DATE	DESCRIPTION
1	2011.12.26	ISSUED FOR PERMIT
2	2012.03.11	ISSUED FOR CONSTRUCTION

NO.	DATE	DESCRIPTION
1	2011.12.26	ISSUED FOR PERMIT
2	2012.03.11	ISSUED FOR CONSTRUCTION



PROJECT NAME: **KANATA MIXED-USE RESIDENTIAL PROJECT**
 6301 CAMPEAU DRIVE, OTTAWA
 DRAWING TITLE: **APARTMENT A+B FLOOR PLANS**

DRAWN BY: KP	CHECKED BY: FF
DATE: 20-11-26	SCALE: 1:250
PROJECT NO: F19-049	PARCEL # 1

DRAWING NO: **A-200A** SHEET ISSUE NO: **1**

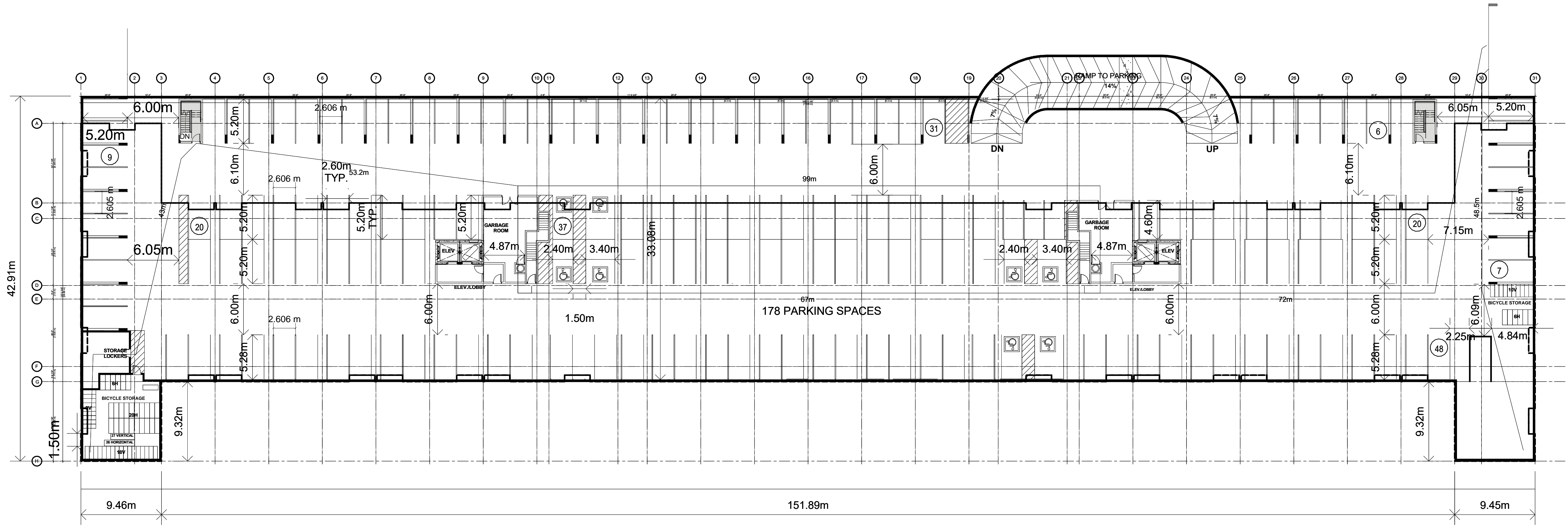

1 UNDERGROUND PARKING 1
 A-200A 1:250

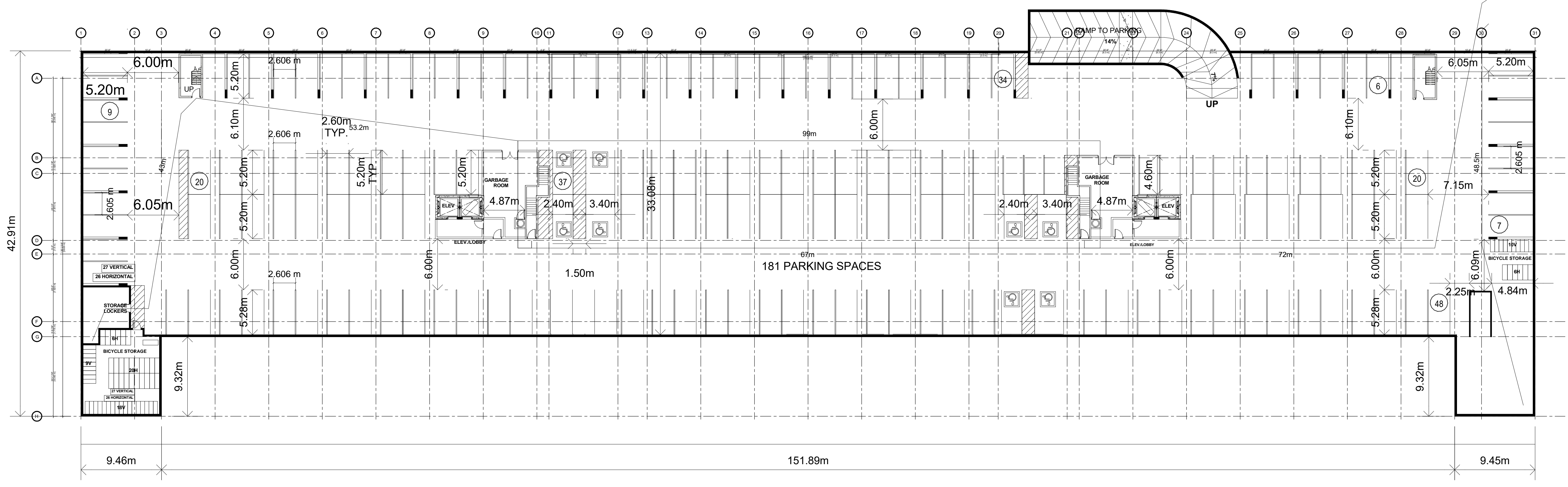

2 T/O UNDERGROUND PARKING 2
 A-200A 1:250

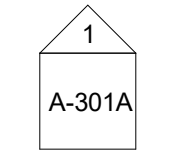



1 UNDERGROUND PARKING PLAN
A-200C 1:250

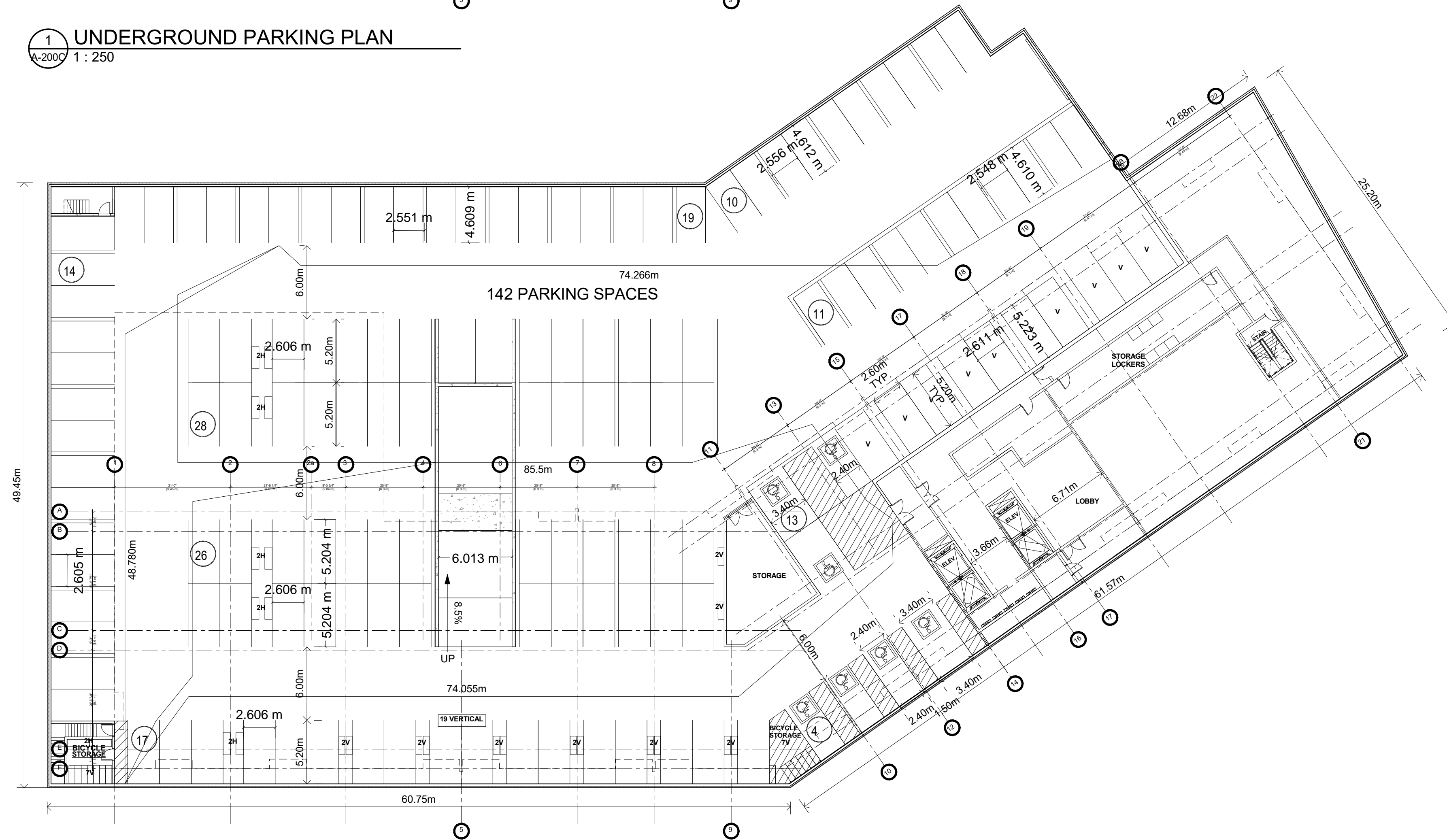

2 T/O UNDERGROUND PARKING 2
A-200C 1:250

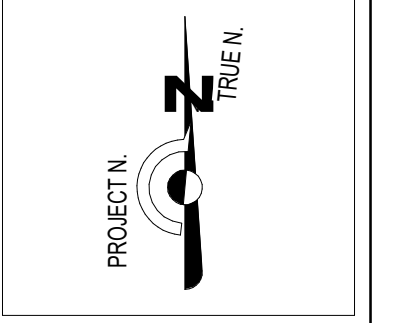

NO.	DATE	DESCRIPTION
1	2011.05.24	ISSUED FOR PERMIT
2	2011.05.24	ISSUED FOR PERMIT

DESIGNED BY	ARCHITECT
REVIEWED BY	ARCHITECT
DATE	2011.05.24
SCALE	1:250
PROJECT NO.	F19-049
PARCEL #	2



PROJECT NAME: KANATA MIXED-USE RESIDENTIAL PROJECT
691 CAMPEAU DR. CANATA, ON. K2K 5E9

DRAWING TITLE: APARTMENT C UNDERGROUND PLAN

DRAWN BY: KP	CHECKED BY: FF
DATE: 20-11-26	SCALE: 1:250
PROJECT NO: F19-049	PARCEL # 2
DRAWING NO: A-200C	SHEET ISSUE NO: 1

7-1661 CORNWALL ROAD ORAVILLE, ON L6J 7W5
P: (905) 337-7249 E: aam@apiconsultants.net
#17421