

PLANT MATERIAL SCHEDULE

| CODE | BOTANICAL NAME | COMMON NAME | QTY. | SIZE | REMARKS |
|---------------------------|--|--------------------------|------|-----------|-------------------|
| DECIDUOUS TREES | | | | | |
| AF | ACER FREEMANI JEFFERSRED | AUTUMN BLAZE MAPLE | 12 | 60mm cal | B&B, single stem |
| AR | ACER RUBRUM | RED MAPLE | 3 | 60mm cal | B&B, single stem |
| AS | ACER SACCHARUM | SUGAR MAPLE | 3 | 60mm cal | B&B, single stem |
| ASa | ACER SACCHARUM | SILVER MAPLE | 10 | 60mm cal | B&B, single stem |
| BA | BETULA ALLEGANIENSIS | YELLOW BIRCH | 9 | 60mm cal | B&B, single stem |
| CO | CELTIS OCCIDENTALIS | COMMON HACKBERRY | 8 | 60mm cal | B&B, single stem |
| OT | QUERCUS TRACANTHOS SKYLINE | SKYLINE HONEYLOCUST | 7 | 60mm cal | B&B, single stem |
| NS | NYSSA SYLVATICA | BLACK GUM (SOURGUM) | 5 | 60mm cal | B&B, single stem |
| QM | QUERCUS MACROCARPA | BUR OAK | 7 | 60mm cal | B&B, single stem |
| QR | QUERCUS RUBRA | RED OAK | 5 | 60mm cal | B&B, single stem |
| TA | TILIA AMERICANA | AMERICAN BASSWOOD | 5 | 60mm cal | B&B, single stem |
| CONIFEROUS TREES | | | | | |
| PG | PICEA GLAUCAL | WHITE SPRUCE | 11 | 200 cm ht | B&B |
| PP | PICEA PUNGENS | COLORADO GREEN SPRUCE | 6 | 200 cm ht | B&B |
| PSI | PINUS STROBUS | WHITE PINE | 6 | 200 cm ht | B&B |
| TO | THUJA OCCIDENTALIS | EASTERN WHITE CEDAR | 108 | 150cm ht | B&B, 120cm o/c |
| DECIDUOUS SHRUBS | | | | | |
| CR | CORNUS RACEMOSA | GRAY DOGWOOD | 72 | 50cm ht | potted, 100cm o/c |
| PFD | POTENTILLA FRUTICOSA | GOLD DROP CINQUEFOIL | 129 | 50cm ht | potted, 80cm o/c |
| PO | PHYSCARPUS OPULIFOLIUS | COMMON NINEBARK | 112 | 50cm ht | potted, 100cm o/c |
| RAU | RIBES AUREUM | GOLDEN CURRANT | 102 | 50cm ht | potted, 100cm o/c |
| RB | ROSA BLANDA | SHRUB ROSE | 146 | 50cm ht | potted, 100cm o/c |
| SBAW | SPIRAEA BUMALDA ANTHONY WATERER | ANTHONY WATERER SPIREA | 85 | 50cm ht | potted, 100cm o/c |
| SJF | SPIRAEA JAPONICA FLAMING MOUND | FLAMING MOUND SPIREA | 98 | 50cm ht | potted, 80cm o/c |
| VD | VIBURNUM DENTATUM | ARROWWOOD | 56 | 50cm ht | potted, 100cm o/c |
| WFPF | WEIGELA FLORIDA PINK PRINCESS | PINK PRINCESS WEIGELA | 18 | 50cm ht | potted, 100cm o/c |
| CONIFEROUS SHRUBS | | | | | |
| JCF | JUNIPERUS CHINENSIS FAIRVIEW | FAIRVIEW JUNIPER | 48 | 100cm ht | potted, 100cm o/c |
| JHP | JUNIPERUS HORIZONTALIS PLUMOSA COMPACTA | COMPACT ANDORRA JUNIPER | 36 | 60cm spr | potted, 100cm o/c |
| PM | PINUS MUGO MUGHUS | MUGHO PINE | 47 | 50cm ht | potted, 100cm o/c |
| PERENNIALS | | | | | |
| Ger | GERANIUM maculatum | WILD GERANIUM | 75 | 15 cm pot | plant 60cm o/c |
| Rud | RUDBECKIA fulgida 'Goldstrum' | BLACK-EYED SUSAN | 55 | 15 cm pot | plant 60cm o/c |
| ORNAMENTAL GRASSES | | | | | |
| And | ANDROPOGON gerardii | BIG BLUESTEM GRASS | 38 | 15cm pot | plant 75cm o/c |
| Cal | CALAMAGROSTIS x acutiflora 'Karl Foerster' | KARL FOERSTER REED GRASS | 220 | 15cm pot | plant 75cm o/c |
| Pv | PANICUM virgatum | SWITCH GRASS | 78 | 15cm pot | plant 75cm o/c |
| Sar | SORGHASTRUM nutans | INDIAN GRASS | 19 | 15cm pot | plant 75cm o/c |
| Sp | SPOROBOLUS heterolepis | PRAIRIE DROPSEED | 33 | 15cm pot | plant 75cm o/c |

LEGEND / SYMBOL

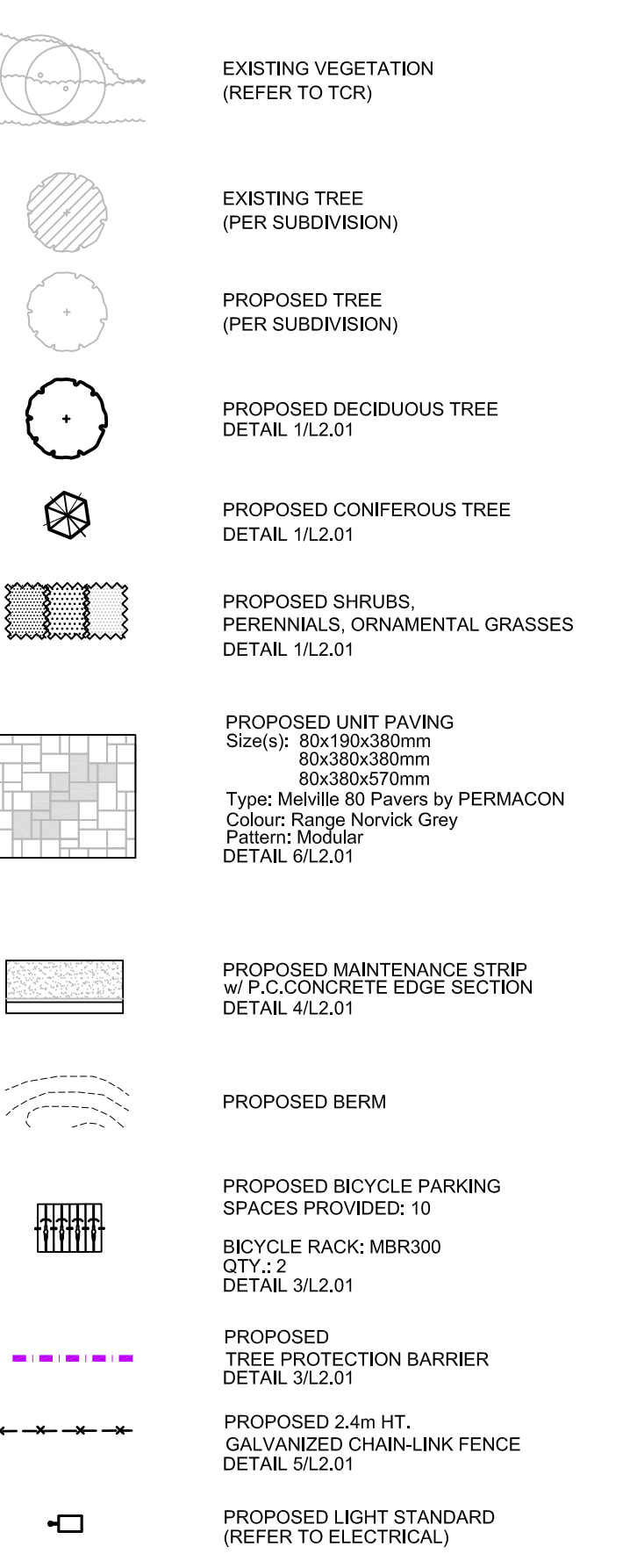

GENERAL NOTES

- This drawing shall be read in conjunction with all relevant Architectural, Engineering and related Drawings and Documents.
- Refer to Engineering Drawings for Grading and Servicing.
- Refer to Architectural Drawings for Site layout.
- Contractor shall provide the location(s) of all services/utilities by consulting Municipal Authorities and Utility companies and shall be responsible for adequate protection from damage during construction.
- Plant material shall be No. 1 Grade and shall comply with the Metric Guide Specifications For Nursery Stock (latest edition), published by the Canadian Nursery Trades Association.
- Plant Material locations are Schematic / Approximate only. Contractor shall stake out locations on site prior to work.
- Contractor shall guarantee all plant material for a period of one (1) full year from the date of final acceptance.
- Shrubs shall be planted in a continuous prepared bed of 450mm depth planting soil mix covered over with a woven polypropylene weed control fabric (LANDSCAPE FABRIC-Green-Line by Thrace-LINQ) and 75mm depth composted pine mulch to finish grade, as specified.
- Perennials and Ornamental Grasses shall be planted in a continuous prepared bed of 450mm depth planting soil mix covered over with 75mm depth composted pine mulch to finish grade. (NO WEED CONTROL FABRIC), as specified.
- Sod areas to receive 125mm topsoil. Sod shall be No. 1 quality conforming to the Canadian Nursery Sod Growers Specification.
- Seed areas to receive 150mm topsoil. Grass seed shall be Certified Canada No. 1 Grade in accordance with Government of Canada Seeds Acts and Regulations. Reinstatement areas damaged or disturbed beyond the limit of work.
- Plant Material substitutions shall not be permitted without written approval from the Consultant.
- Contractor shall advise Consultant a minimum of 48hrs. prior to proceeding landscape work and any required Field Reviews.
- THIS PLAN HAS BEEN PREPARED FOR MUNICIPAL SITE PLAN APPROVAL ONLY AND MAY NOT BE USED FOR ANY OTHER PURPOSE.**

Allison Hamlin

**ALLISON HAMLIN
MANAGER (A), DEVELOPMENT REVIEW WEST
PLANNING, REAL ESTATE & ECONOMIC DEVELOPMENT
DEPARTMENT, CITY OF OTTAWA**

APPROVED
By Allison Hamlin at 1:19 pm, May 05, 2022

FOR APPROVAL ONLY

| | | |
|-------------|------------|-----------------------|
| 3b. | JULY 27/21 | PER CITY COMMENTS (2) |
| 3. | MAY 31/21 | PER CITY COMMENTS (1) |
| 2. | MAR.29/21 | ISSUE FOR PERMIT |
| 1. | DEC.11/20 | ISSUE FOR SPA |
| no. | date | revision |
| North Arrow | Stamp | |

Contractor shall check and verify all dimensions on site and report all errors and/or omissions to the Consultant.

Work to be done in accordance with all applicable codes and by-laws.

Do not scale Drawing.

Copyright reserved. This Drawing is the exclusive property of Levstek Consultants Inc. and shall not be used without consent.

Consultant:
LEVSTEK CONSULTANTS INC.
5871 Hugh Crockett, Ottawa, Ontario K2A 2W8
613 826 1818

Client:
**MARITIME-ONTARIO
OTTAWA**
8800 CAMPEAU DRIVE

Project:
LANDSCAPE PLAN

Drawn: [] Date: **NOV 2020** Drawing No. []
Scale: **1:500** Project No. **1186** Drawing No. **L1.01**

SCALE 1:500
0 5 10 15 20 25 30 35 40m

D07-12-20-0189

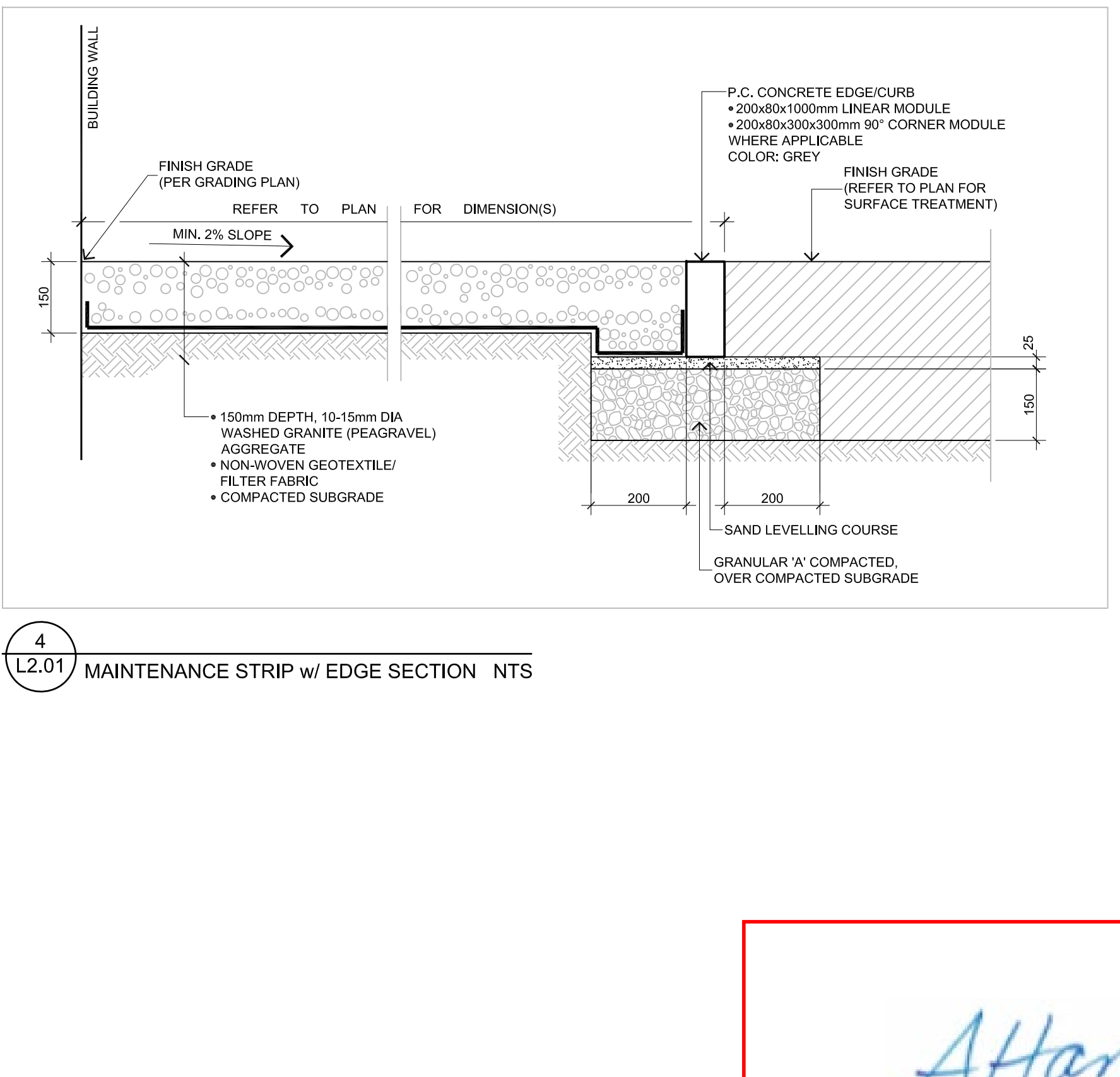
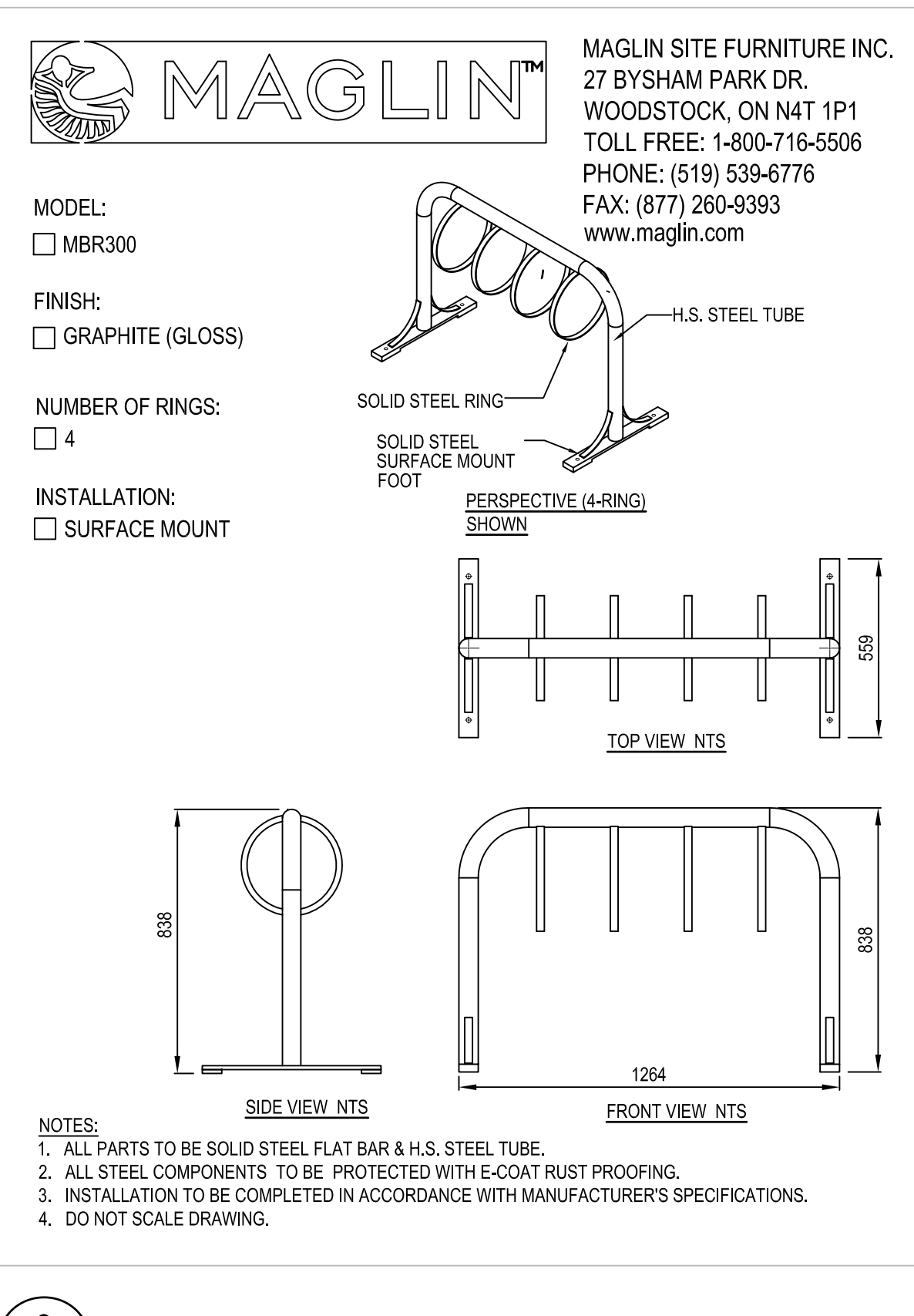
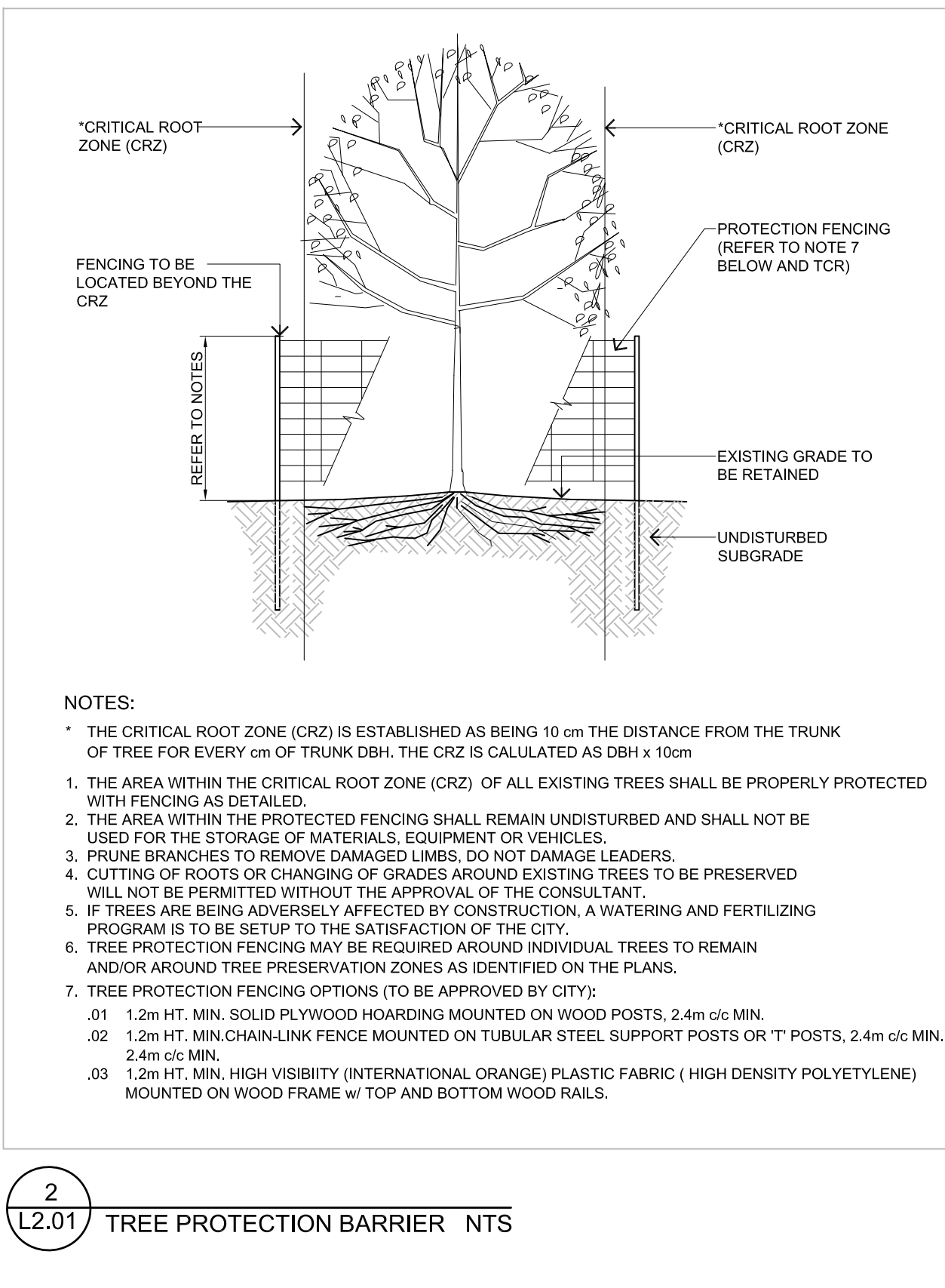
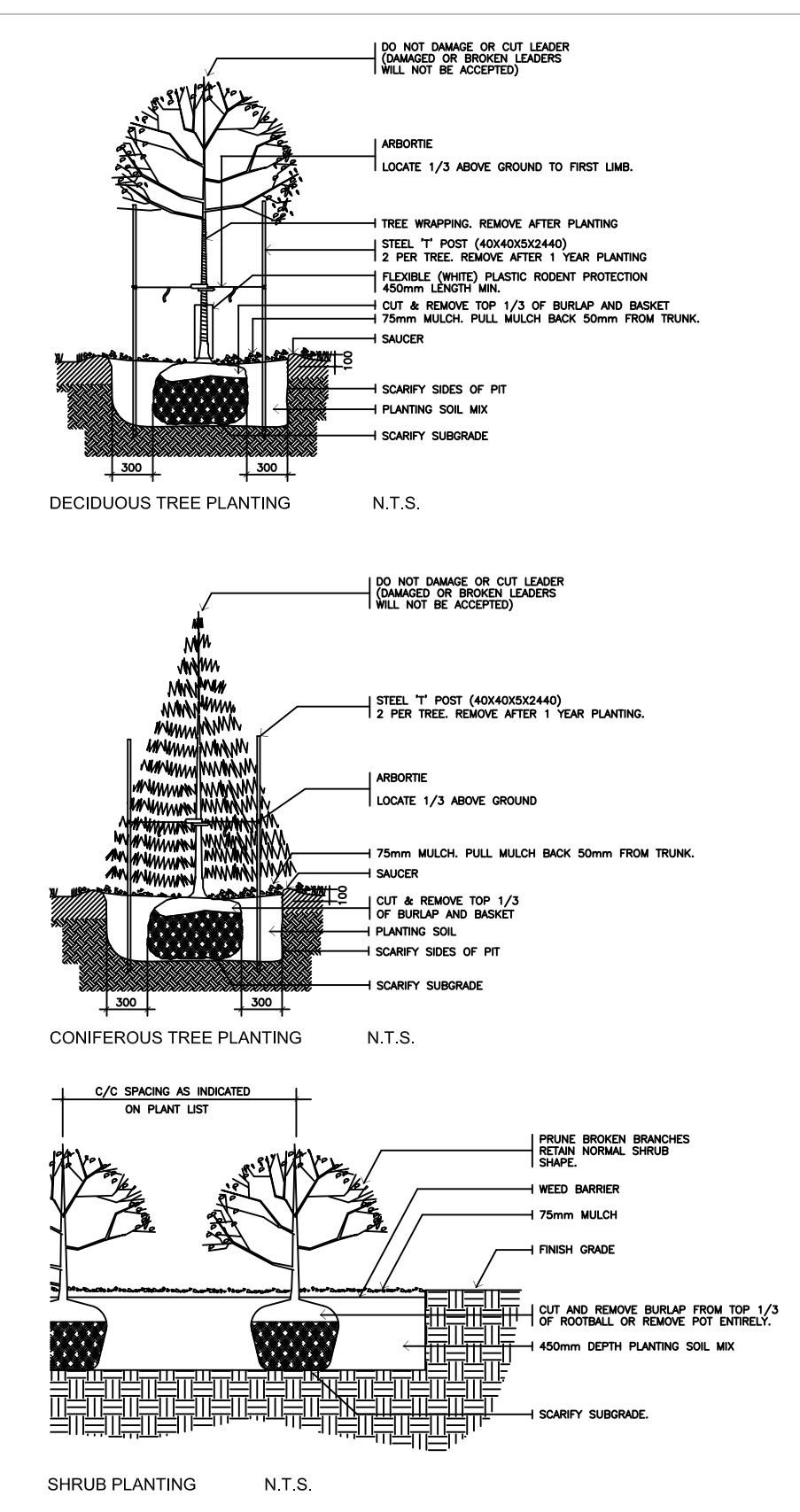

Allison Hamlin

**ALLISON HAMLIN
MANAGER (A), DEVELOPMENT REVIEW WEST
PLANNING, REAL ESTATE & ECONOMIC DEVELOPMENT
DEPARTMENT, CITY OF OTTAWA**

APPROVED
By Allison Hamlin at 1:20 pm, May 05, 2022

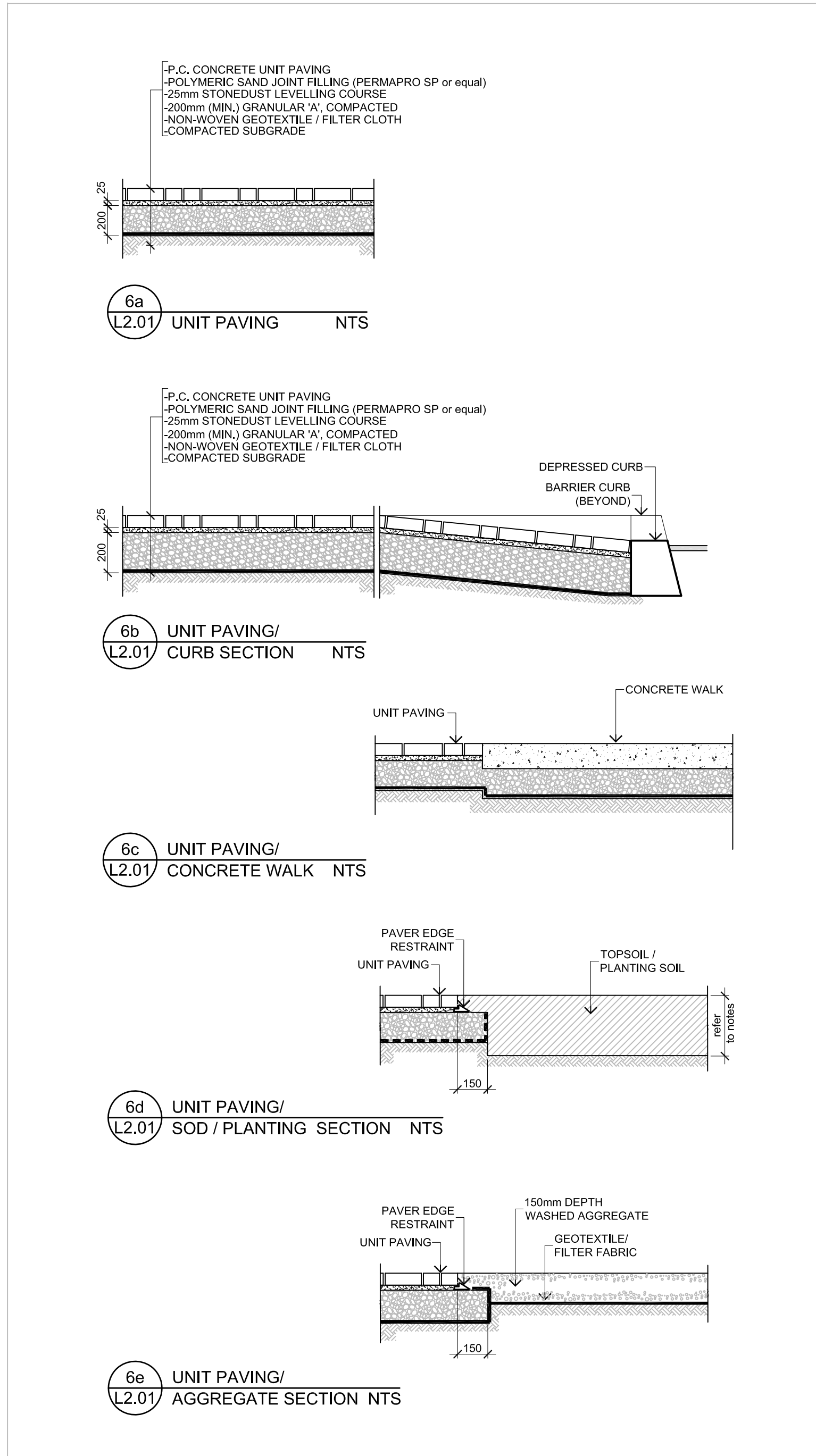
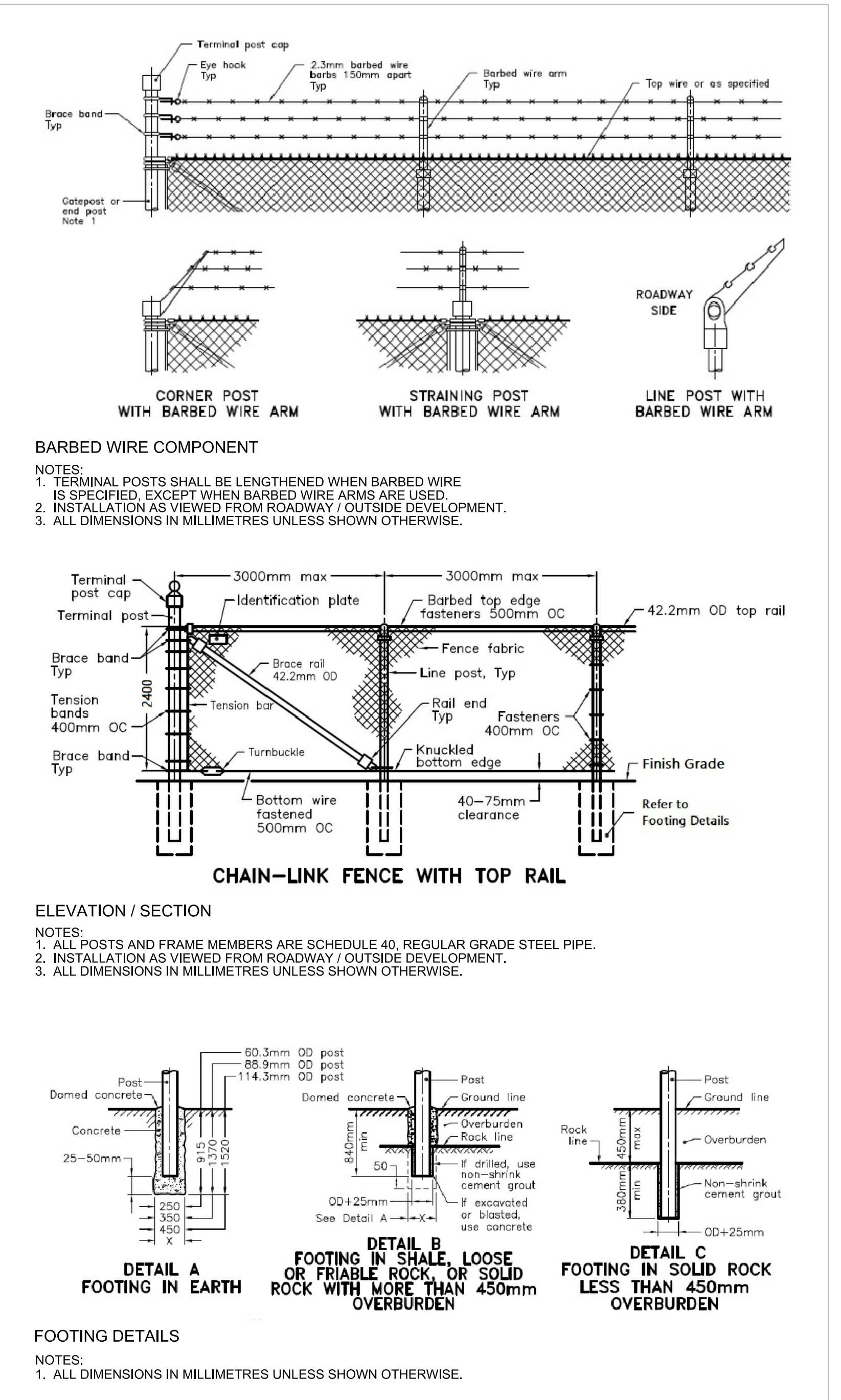

FOR APPROVAL ONLY

| NO. | DATE | REVISION |
|-----|-----------|-----------------------|
| 1. | MAY 31/21 | PER CITY COMMENTS (1) |

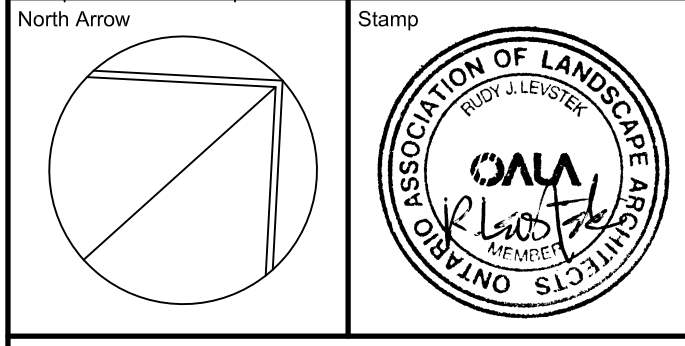

Contractor shall check and verify all dimensions on site and report all errors and/or omissions to the Consultant.
Work to be done in accordance with all applicable codes and by-laws.
Do not scale Drawing.
Copyright reserved. This Drawing is the exclusive property of Levstek Consultants Inc. and shall not be used without consent.

Consultant:
LEVSTEK CONSULTANTS INC.
3871 Hugh Crawford • Ottawa • Ontario • K2A 2W8
613 826 1818

| | |
|---|--------------------------|
| Client: | |
| Project: MARITIME-ONTARIO OTTAWA | |
| Drawing Title: LANDSCAPE DETAILS | |
| Drawn: | Date: NOV 2020 |
| Scale: AS NOTED | Project No.: 1186 |
| Drawing No.: L2.01 | |

D07-12-20-0189 #18376