

ROAD ALLOWANCE BETWEEN CONCESSIONS 1 AND 2 (NOT TRAVELLED)
P/N 04508-0035

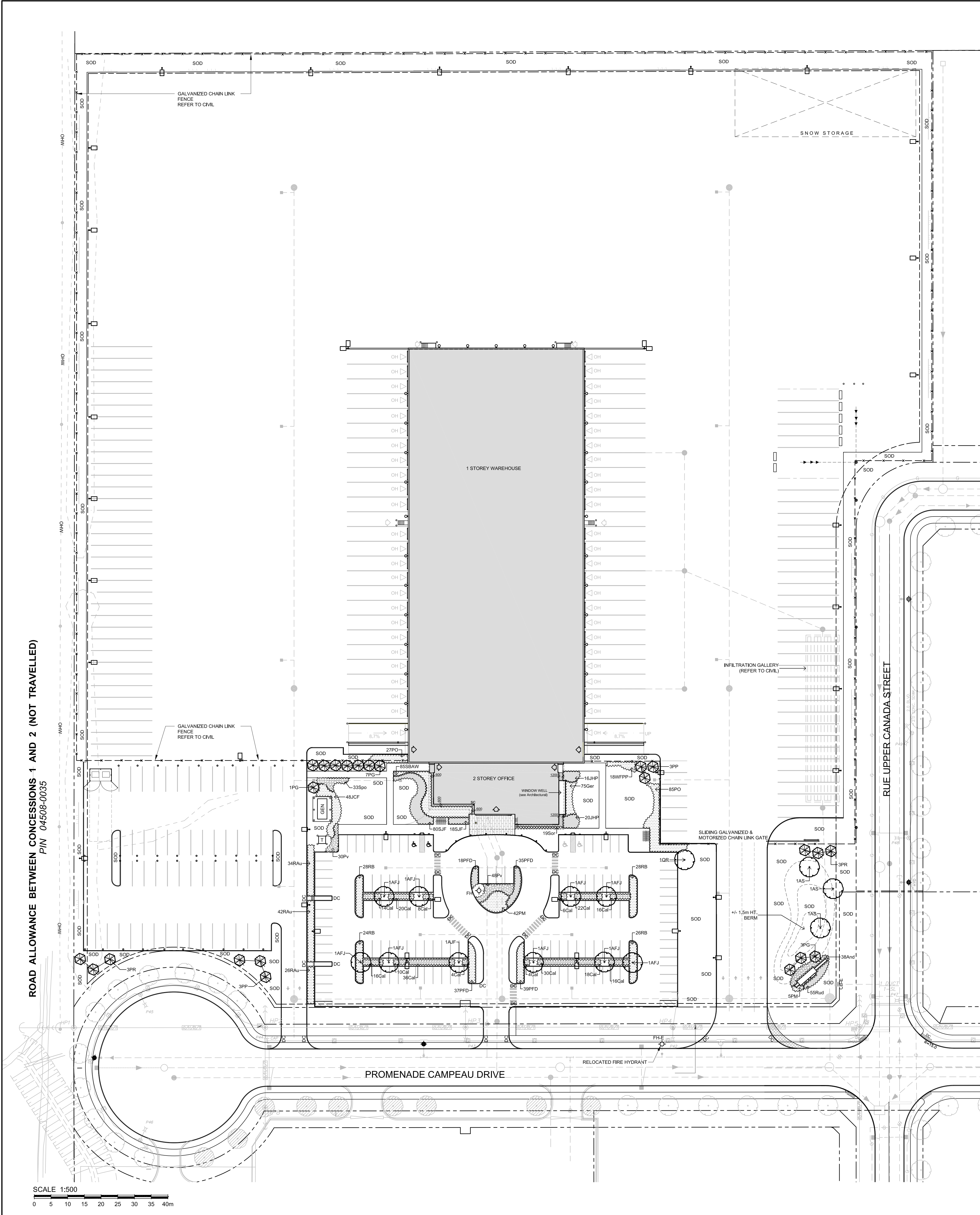

PLANT MATERIAL SCHEDULE

CODE	BOTANICAL NAME	COMMON NAME	QTY.	SIZE	REMARKS
DECIDUOUS TREES					
AFJ	ACER x FREEMANI JEFFERSRED	AUTUMN BLAZE MAPLE	10	60mm cal	B&B, single stem
AS	ACER SACCHARUM	SUGAR MAPLE	3	60mm cal	B&B, single stem
QR	QUERCUS RUBRA	RED OAK	1	60mm cal	B&B, single stem
CONIFEROUS TREES					
PG	PICEA GLAUCA	WHITE SPRUCE	11	180 cm ht	B&B
PP	PICEA PUNGENS	COLORADO GREEN SPRUCE	6	180 cm ht	B&B
PR	PINUS RESINOSA	RED PINE	6	180 cm ht	B&B
DECIDUOUS SHRUBS					
PFJ	POTENTILLA FRUTICOSA 'GOLD DROP'	GOLD DROP CINQUEFOIL	129	50cm ht	potted, 80cm o/c
PO	PHYTOSCARPUS OPULIFOLIUS	COMMON NINEBARK	112	50cm ht	potted, 100cm o/c
RAU	RIBES AUREUM	GOLDEN CURRIANT	102	50cm ht	potted, 100cm o/c
RB	ROSA BLANDA	SHRUB ROSE	106	50cm ht	potted, 100cm o/c
SBW	SPIRAEA BUMALDA ANTHONY WATERER	ANTHONY WATERER SPIREA	85	50cm ht	potted, 100cm o/c
SJF	SPIRAEA JAPONICA FLAMING MOUND	FLAMING MOUND SPIREA	98	50cm ht	potted, 80cm o/c
WFPP	WEIGELA FLORIDA PINK PRINCESS	PINK PRINCESS WEIGELA	18	50cm ht	potted, 100cm o/c
CONIFEROUS SHRUBS					
JCF	JUNIPERUS CHINENSIS	FAIRVIEW JUNIPER	48	100cm ht	potted, 100cm o/c
JHP	JUNIPERUS HORIZONTALIS 'PLUMOSA COMPACTA'	COMPACT ANDORRA JUNIPER	36	60cm spr	potted, 100cm o/c
PM	PINUS MUGO MUGHUS	MUGHO PINE	47	50cm ht	potted, 100cm o/c
PERENNIALS					
Ger	GERANIUM maculatum	WILD GERANIUM	75	15 cm pot	plant 60cm o/c
Rud	RUDBECKIA fulgida 'Goldstrum'	BLACK EYED SUSAN	55	15 cm pot	plant 60cm o/c
ORNAMENTAL GRASSES					
And	ANDROPOGON gerardi	BIG BLUESTEM GRASS	38	15cm pot	plant 75cm o/c
Cal	CALAMAGROSIS x acutiflora 'Karl Foerster'	KARL FOERSTER REED GRASS	220	15cm pot	plant 75cm o/c
Pv	PANICUM virgatum	SWITCH GRASS	78	15cm pot	plant 75cm o/c
Sor	SORGHASTRUM nutans	INDIAN GRASS	19	15cm pot	plant 75cm o/c
Spo	SPOROBOLUS heterolepis	PRAIRIE DROPSEED	33	15cm pot	plant 75cm o/c

- ### GENERAL NOTES
- This drawing shall be read in conjunction with all relevant Architectural, Engineering and related Drawings and Documents.
 - Refer to Engineering Drawings for Grading and Servicing.
 - Refer to Architectural Drawings for Site layout.
 - Contractor shall provide the location(s) of all services/utilities by consulting Municipal Authorities and Utility companies and shall be responsible for adequate protection from damage during construction.
 - Plant material shall be No. 1 Grade and shall comply with the Metric Guide Specifications For Nursery Stock (latest edition), published by the Canadian Nursery Trades Association.
 - Plant material locations are Schematic / Approximate only. Contractor shall stake out locations on site prior to work.
 - Contractor shall guarantee all plant material for a period of one (1) full year from the date of final acceptance.
 - Shrubs shall be planted in a continuous prepared bed of 450mm depth planting soil mix covered over with a woven polypropylene weed control fabric (LANDSCAPE FABRIC-Green-Line by Trace-LiNG) and 75mm depth composted pine mulch to finish grade, (NO WEED CONTROL FABRIC), as specified.
 - Sod areas to receive 125mm topsoil. Sod shall be No. 1 quality conforming to the Canadian Nursery Sod Growers Specification.
 - Reinstalls all areas damaged or disturbed beyond the limit of Work.
 - Plant Material substitutions shall not be permitted without written approval from the Consultant.
 - Contractor shall advise Consultant a minimum of 48hrs. prior to proceeding landscape work and any required Field Reviews.
 - THIS PLAN HAS BEEN PREPARED FOR MUNICIPAL SITE PLAN APPROVAL ONLY AND MAY NOT BE USED FOR ANY OTHER PURPOSE.**

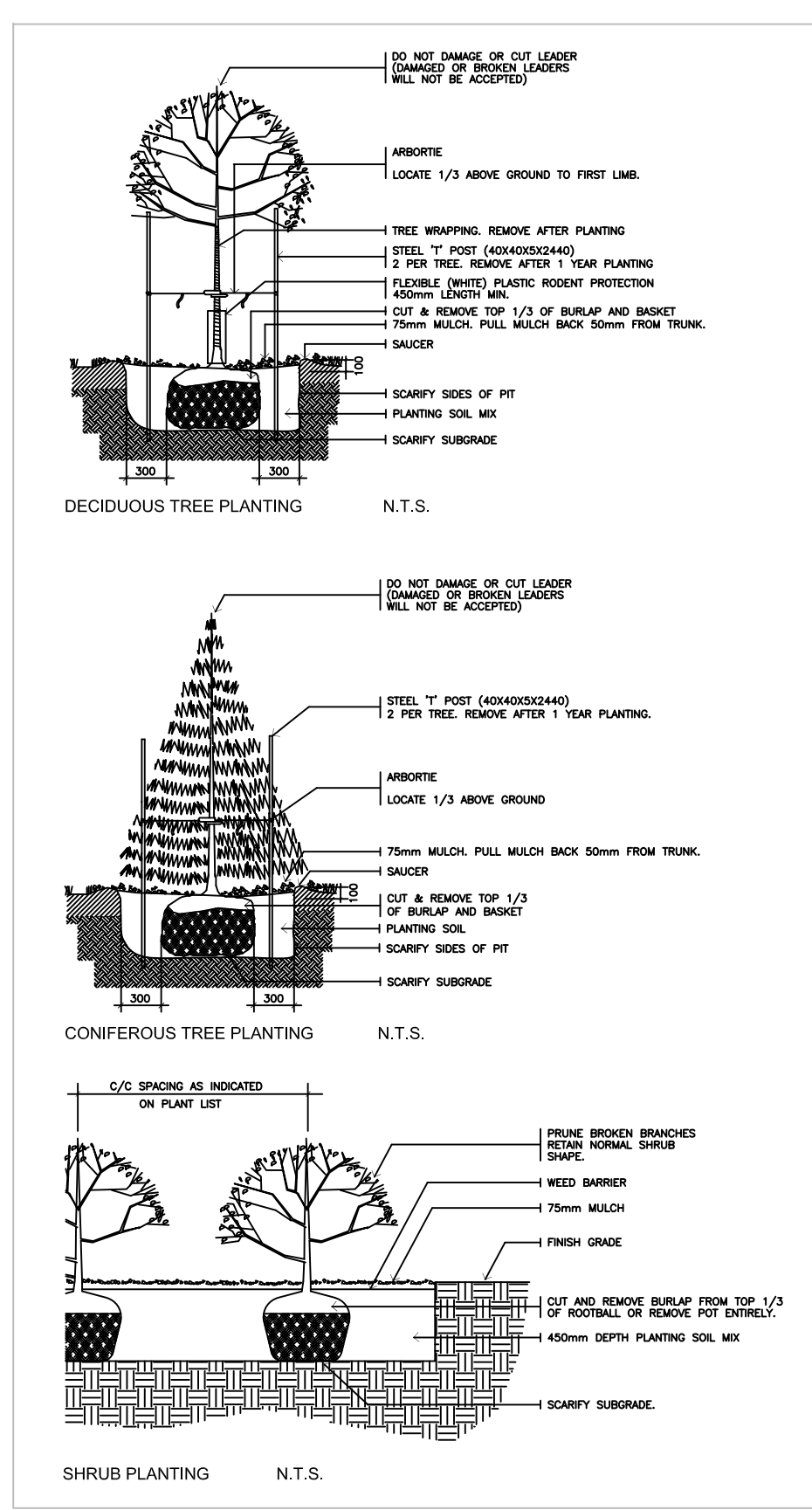
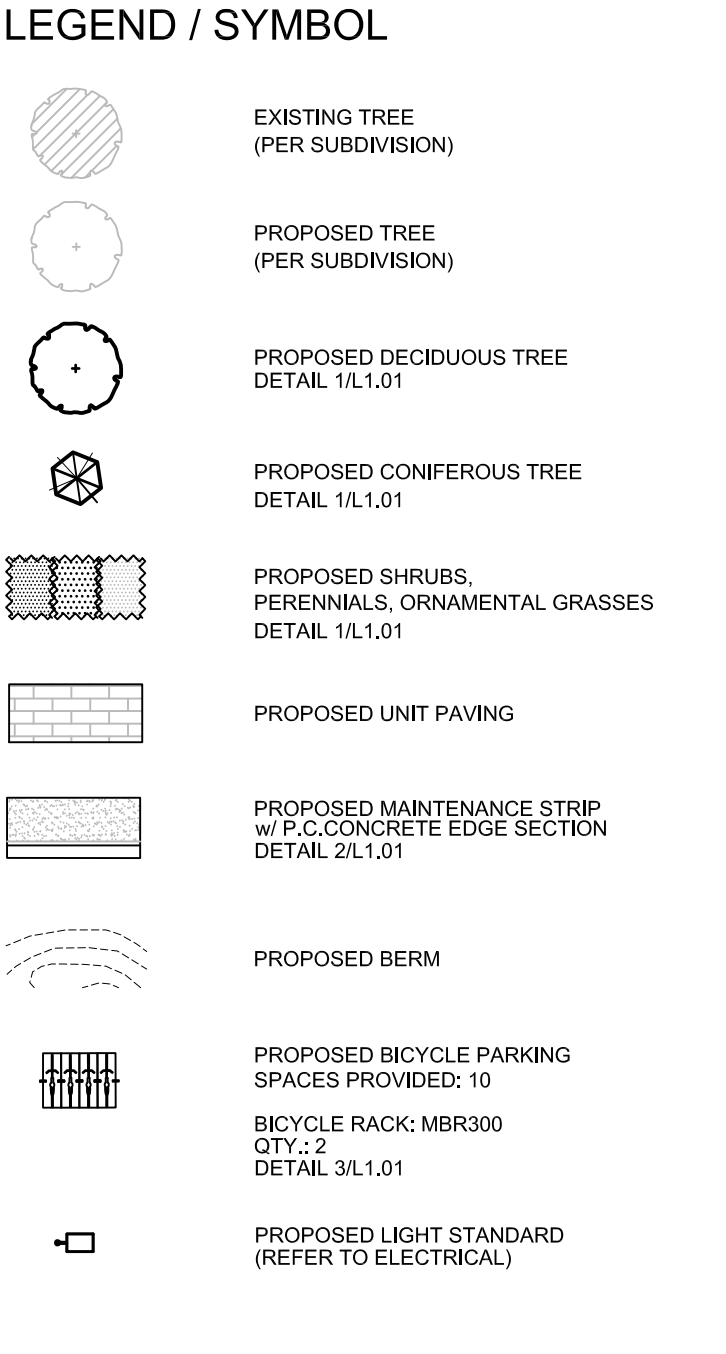

1 L1.01 PLANTING DETAILS N.T.S.

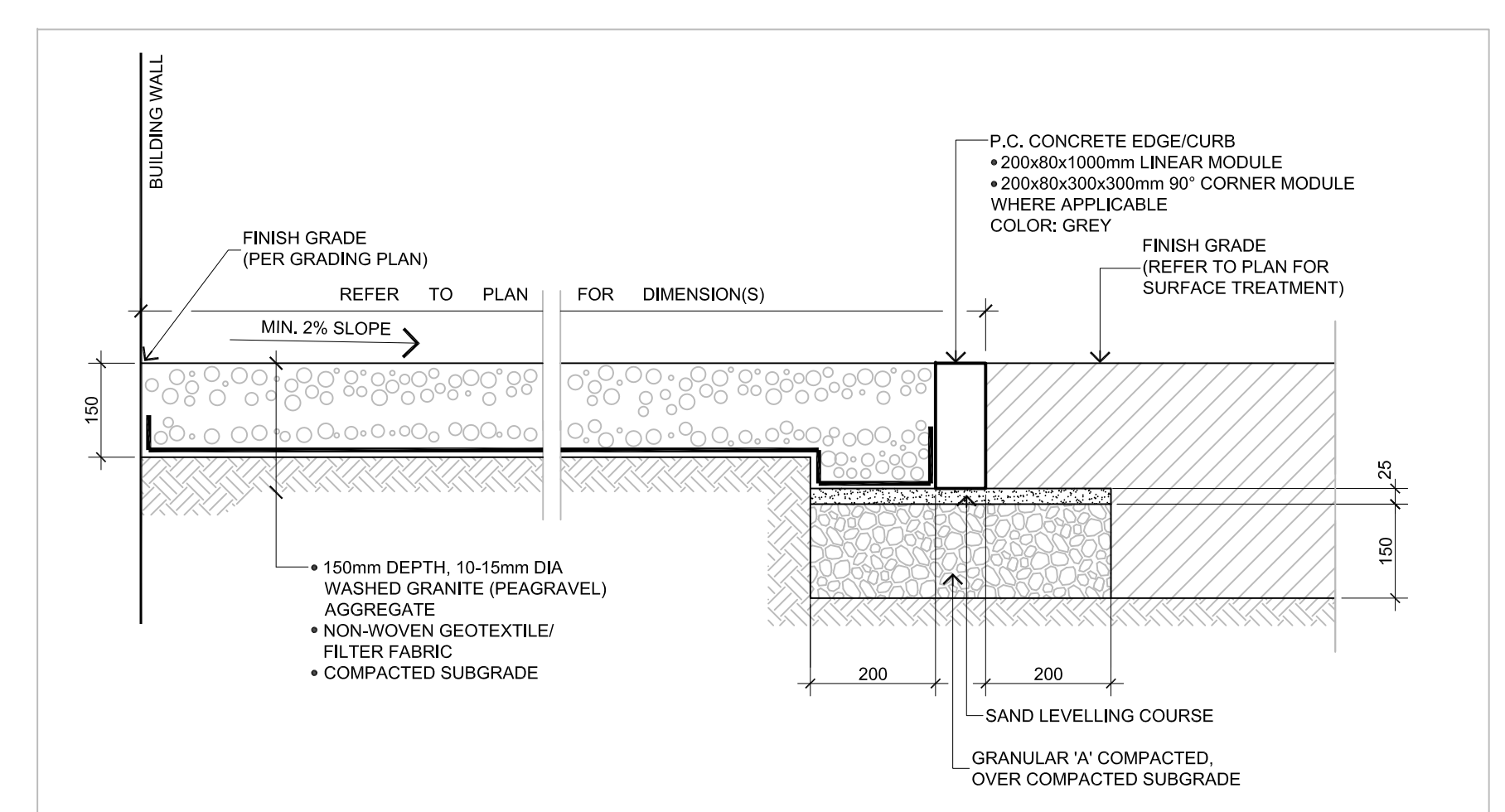

2 L1.01 MAINTENANCE STRIP w/ EDGE SECTION N.T.S.

MAGLIN

MODEL:
 MBR300

FINISH:
 GRAPHITE (GLOSS)

NUMBER OF RINGS:
 4

INSTALLATION:
 SURFACE MOUNT

MAGLIN SITE FURNITURE INC.
27 BYSHAM PARK DR.
WOODSTOCK, ON N4T 1P1
TOLL FREE: 1-800-716-5506
PHONE: (519) 539-6776
FAX: (877) 260-9393
www.maglin.com

NOTES:
1. ALL PARTS TO BE SOLID STEEL FLAT BAR & H.S. STEEL TUBE.
2. ALL STEEL COMPONENTS TO BE PROTECTED WITH E-COAT RUST PROOFING.
3. INSTALLATION TO BE COMPLETED IN ACCORDANCE WITH MANUFACTURER'S SPECIFICATIONS.
4. DO NOT SCALE DRAWING.

3 L1.01 BICYCLE RACK - 4-RING (5-STATION) N.T.S.

FOR APPROVAL ONLY

<table border="1" style="width: 100%; border-collapse: collapse;"> <tr> <td style="width: 50%;">1. DEC.11/20</td> <td style="width: 50%;">ISSUE FOR SPA</td> </tr> <tr> <td>RD. date</td> <td>revision</td> </tr> </table> <p>North Arrow</p> <p>Stamp</p> <p>Contractor shall check and verify all dimensions on site and report all errors and/or omissions to the Consultant.</p> <p>Work to be done in accordance with all applicable codes and by-laws.</p> <p>Do not scale Drawing.</p> <p>Copyright reserved. This Drawing is the exclusive property of Levstek Consultants Inc. and shall not be used without consent.</p> <p>Consultant:</p> <p>LEVSTEK CONSULTANTS 5871 Hugh Crockett, Ottawa, Ontario K2A 2W8 613 826 6218</p> <p>Client:</p>	1. DEC.11/20	ISSUE FOR SPA	RD. date	revision	<p>Project:</p> <p>MARITIME-ONTARIO OTTAWA</p> <p>8800 CAMPEAU DRIVE</p> <p>Drawing Title:</p> <p>LANDSCAPE PLAN</p> <table border="1" style="width: 100%; border-collapse: collapse;"> <tr> <td style="width: 33%;">Drawn</td> <td style="width: 33%;">Date</td> <td style="width: 33%;">Drawing No.</td> </tr> <tr> <td></td> <td>NOV 2020</td> <td>L1.01</td> </tr> <tr> <td>Scale</td> <td>Project No.</td> <td></td> </tr> <tr> <td>1:500</td> <td>1186</td> <td></td> </tr> </table>	Drawn	Date	Drawing No.		NOV 2020	L1.01	Scale	Project No.		1:500	1186	
1. DEC.11/20	ISSUE FOR SPA																
RD. date	revision																
Drawn	Date	Drawing No.															
	NOV 2020	L1.01															
Scale	Project No.																
1:500	1186																

