

RETAINING WALL SCHEDULE

(WALLS 1 TO 4: REFER TO STRUCTURAL SK-1) (WALLS 5 TO 9: REFER TO STRUCTURAL SK-2)

REF	TOP OF WALL	BOTTOM OF WALL	HEIGHT	LENGTH	NOTES	REF	TOP OF WALL	BOTTOM OF WALL	HEIGHT	LENGTH	NOTES	REF	TOP OF WALL	BOTTOM OF WALL	HEIGHT	LENGTH	NOTES
①	84.09 TO 84.31	84.09 TO ±83.63m	0m TO ±0.68m	±8.4m	T.O.W. MIN. 0.15 ABOVE PROPOSED GRADE B.O.W TO MATCH EXISTING GRADE	④	84.31	±83.45 TO ±84.31m	±0.86m TO 0m	±43.4m	T.O.W. MIN. 0.15 ABOVE PROPOSED GRADE B.O.W TO MATCH EXISTING GRADE	⑦A	±84.95 TO ±84.84	84.45 TO 84.76	±0.50m TO ±0.08m	±16.8m	T.O.W TO MATCH EXISTING GRADE
②	84.31	±83.63 TO ±83.46	±0.68m TO ±0.85m	±27.3m	T.O.W. MIN. 0.15 ABOVE PROPOSED GRADE B.O.W TO MATCH EXISTING GRADE	⑤	±85.01 TO ±84.89	84.86 TO 84.32	±0.15m TO ±0.57m	±14.2m	T.O.W TO MATCH EXISTING GRADE	⑦B	±84.84 TO ±84.81	84.76 TO 84.38	±0.08m TO ±0.43m	±8.0m	T.O.W TO MATCH EXISTING GRADE
③	84.31	±83.46 TO ±83.40	±0.85m TO ±0.91m	±10.6m	T.O.W TO MATCH EXISTING GRADE	⑥	±84.89 TO ±84.95	84.45 TO 84.43	±0.44m TO ±0.50m	±24.6m	T.O.W TO MATCH EXISTING GRADE	⑧	±84.81 TO ±84.73	84.38 TO 84.26	±0.43m TO ±0.47m	±11.8m	T.O.W TO MATCH EXISTING GRADE
												⑨	±84.73 TO 84.36m	84.26 TO 84.21	±0.47m TO 0.15m	±14.0m	-

DRAWING LEGEND	
CB	CATCH BASIN
MH	MANHOLE
CB/MH	CATCH BASIN/MANHOLE
SPL	SPRINGLINE OF PIPE
INV	INVERT OF PIPE
SAN	SANITARY SEWER
ST	STORM SEWER
WS/WM	WATER SERVICE/WATERMAIN
VB	VALVE & VALVE BOX
FH	FIRE HYDRANT
FDC	FIRE DEPARTMENT CONNECTION
RD	ROOF DRAIN
WM	WATER METER
WRM	REMOTE WATER METER READOUT
EG	EXISTING GRADE ELEVATION
+EG	PROPOSED GRADE ELEVATION
2%	PROPOSED SLOPE OF GRADE
→	EMERGENCY OVERLAND FLOW
---	CENTERLINE OF SWALE
---	PROPERTY LINE
---	SILT FENCE BARRIER
D.C.	150mm CURB/DEPRESSED CURB
---	LIGHT-DUTY PAVEMENT
---	HEAVY-DUTY PAVEMENT
---	ROAD CUT REINSTATEMENT
---	CONCRETE
---	LANDSCAPE
FFL	FIRST FLOOR ELEVATION
TOF	TOP OF FOUNDATION
USF	UNDERSIDE OF FOOTING

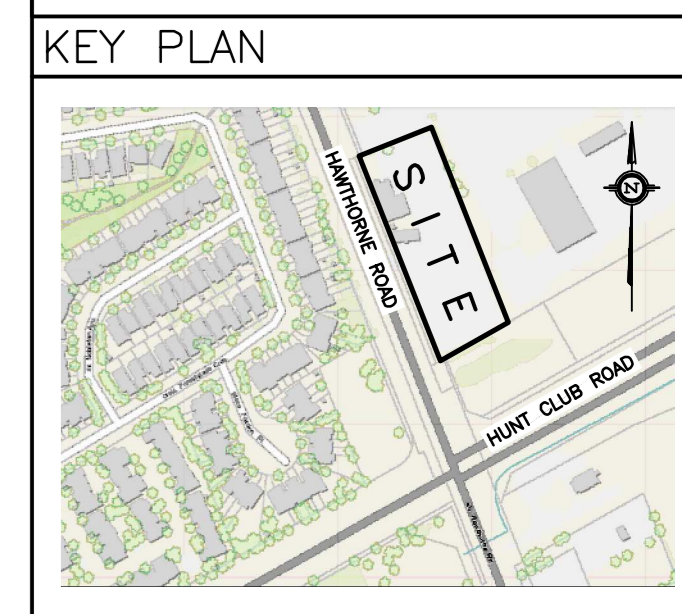
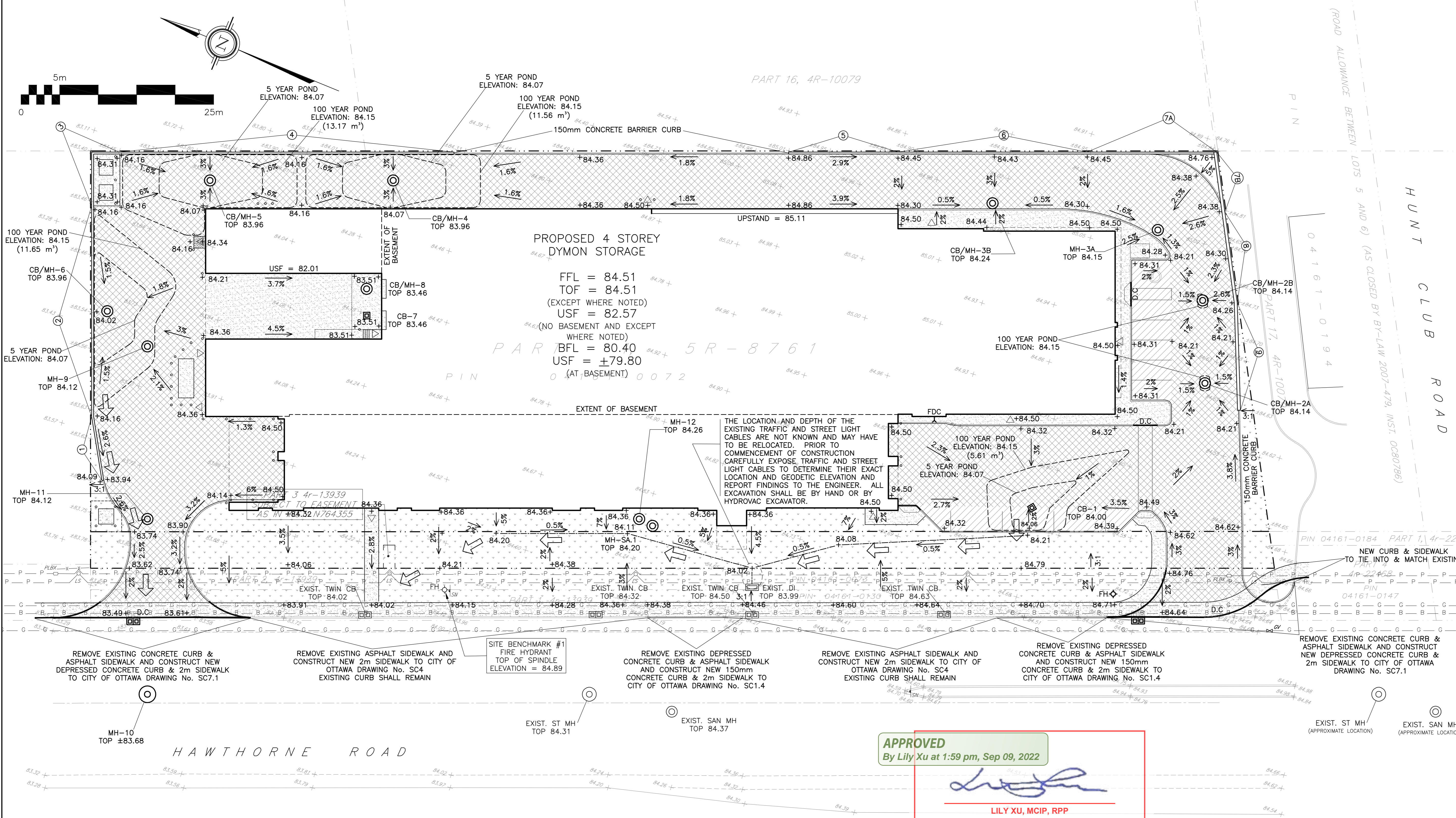

No.	DATE	REVISION
8	AUG 24-22	RE-ISSUED FOR CONSTRUCTION
7	AUG 11-22	ISSUED FOR CONSTRUCTION
6A	AUG 4-22	RE-ISSUED FOR APPROVAL
6	MAY 31-22	RE-ISSUED FOR APPROVAL
5	JAN 28-22	ISSUED WITH AN ADDENDUM
4	NOV 1-21	ISSUED FOR TENDER
3	OCT 8-21	ISSUED FOR BUILDING PERMIT
2	DEC 11-20	ISSUED FOR APPROVAL
1	DEC 9-20	ISSUED FOR COORDINATION
No.	DATE	REVISION

D. B. GRAY ENGINEERING INC.
 Stormwater Management - Grading & Drainage - Storm & Sanitary Sewers - Watermain
 700 Long Point Circle
 Ottawa, Ontario
 613-425-8044
 d.gray@dbgrayengineering.com

PROPOSED 4-STOREY DYMON STORAGE BUILDING
 3455 HAWTHORNE ROAD
 OTTAWA, ONTARIO

GRADING PLAN

APPROVED
 By Lily Xu at 1:59 pm, Sep 09, 2022

 LILY XU, MCIP, RPP
 MANAGER, DEVELOPMENT REVIEW SOUTH
 PLANNING, INFRASTRUCTURE & ECONOMIC
 DEVELOPMENT DEPARTMENT, CITY OF OTTAWA

REFER TO NOTES, DETAILS & SCHEDULES ON DRAWINGS C-5, C-6 & C-7

Engineer's Seal

 NOT VALID UNLESS SIGNED & DATED

Drawn: D.B.G.
 Hor. Scale: 1:250
 Vert. Scale: 1:250
 Date: NOV 17-20
 Job No.: 19107
 Drawing No.: C-3 of 8