

1 L.1 LANDSCAPE PLAN  
SCALE 1:125

- GENERAL NOTES:**
1. It is the responsibility of the appropriate contractor or official to report any errors, omissions or discrepancies on this plan with actual site conditions to the Landscape Architect before proceeding with construction.
  2. The contractor is to notify all utility companies and authorities prior to any excavation and ascertain locations of underground services.
  3. The contractor is to reinstate all areas and items damaged as a result of construction activity.
  4. The contractor is to comply with all pertinent codes and by-laws.
  5. The contractor is to maintain a positive surface run-off throughout the entire construction period.
  6. The Landscape Architect is not responsible for subsurface conditions.
  7. The contractor is to identify all existing trees to remain on site with the Landscape Architect prior to construction.
  8. The contractor is to stake the proposed location of all plant material in conjunction with the Landscape Architect prior to excavation.
  9. Minimum distances for selected deciduous trees are as follows:
    - Building Foundations 7.5m
    - Sidewalks 1.5m
    - Public Streets 2.5m
    - Underground Infrastructure 2.0m
  10. All trees within 1m of underground utility trenches are to be excavated by hand.
  11. Remove all protective wrapping from tree trunks after installation.
  12. Staking of trees shall only be performed if necessary.
  13. Ensure that mulch is pulled back a min. distance of 75mm from base of tree trunk.

**PART 1** Plan of  
**LOTS 10, 11, 12, 24, 25, 26**  
**PART OF REAR PASSAGE (as closed**  
**by Judge's Order LT476512 and**  
**Judge's Order LT113018)**  
**REGISTERED PLAN 4M-30**  
**CITY OF OTTAWA**

PROPOSED PLANT LIST						
KEY	QTY.	BOTANICAL NAME	COMMON NAME	SIZE	CONDITION	REMARKS
TREES						
SB	2	Amelanchier canadensis	Serviceberry	50mm CAL.	B&B	
SF	3	Amelanchier laevis 'JFS-ARB'	Spring Flurry Serviceberry	50mm CAL.	B&B	
SHRUBS						
CN	87	Physocarpus opulifolius	Common Ninebark	600mm HT.	POTTED	1000 mm O/C
FS	51	Rhus aromatica	Fragrant Sumac	600mm HT.	POTTED	800 mm O/C
JH	22	Juniperus horizontalis	Creeping Juniper	1000mm SPR.	POTTED	1200 mm O/C
RD	29	Cornus sericea	Red Osier Dogwood	2 GALLON POT	POTTED	1000mm O/C
WC	18	Teddy Bear Cedar	Teddy Bear Cedar	600mm SPR.	POTTED	1000 mm O/C
TO	5	Thuja occidentalis 'Teddys'	Pyramidal Cedar	1.5m ht.	POTTED	
PERENNIALS AND ORNAMENTAL GRASSES						
BS	10	Rudbeckia hirta	Black-Eyed Susan	150mm POT	POTTED	300 mm O/C
OF	27	Matteuccia struthiopteris	Ostrich Fern	250mm POT	POTTED	800 mm O/C
SG	193	Panicum virgatum	Switchgrass	250mm POT	POTTED	600 mm O/C

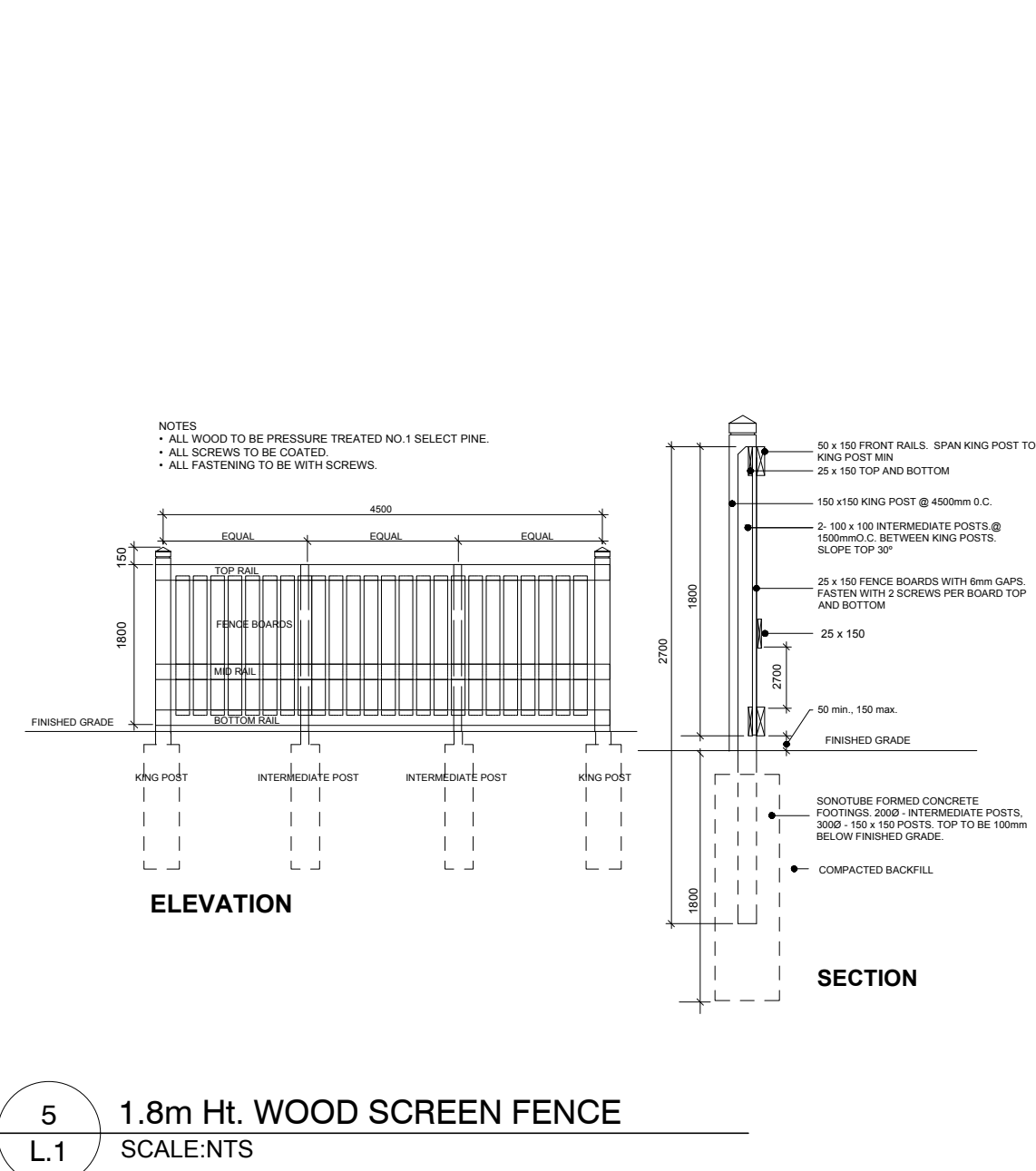
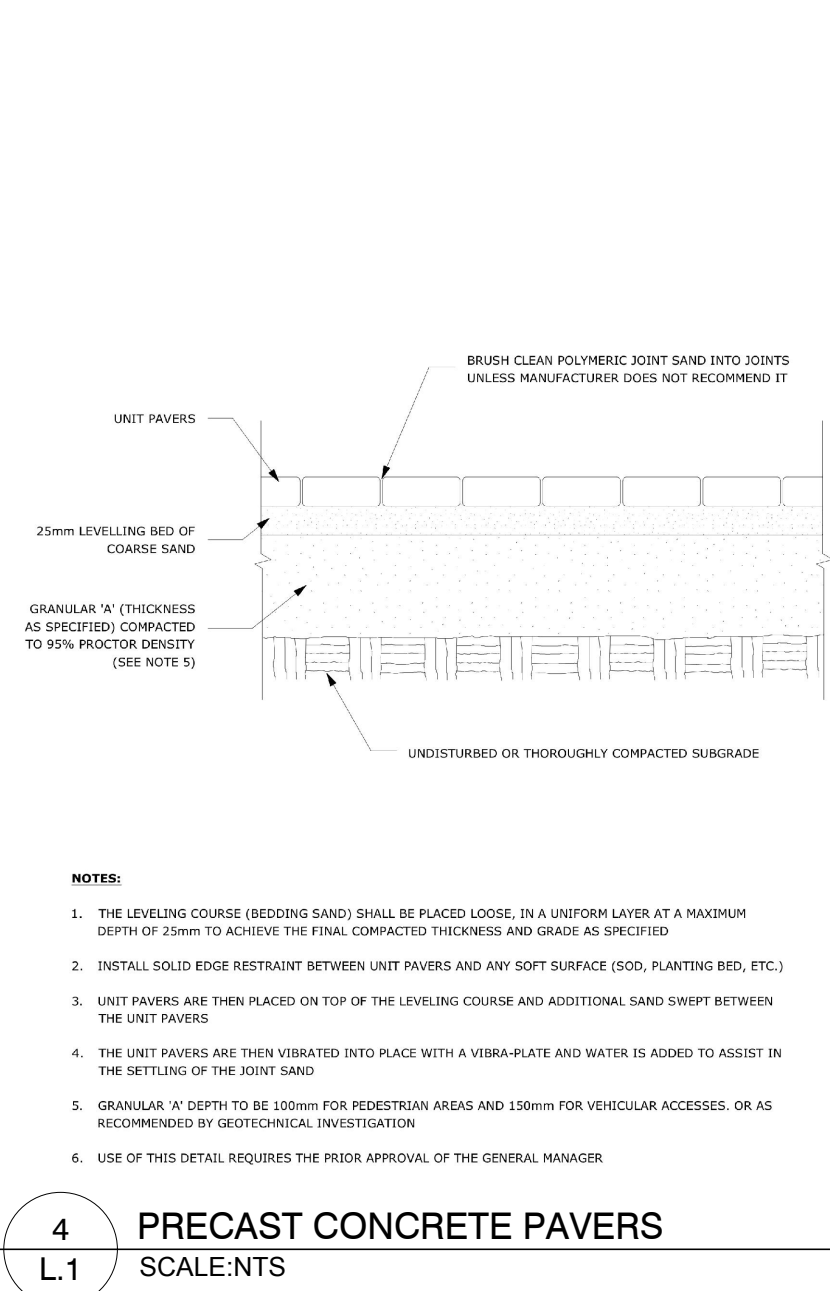
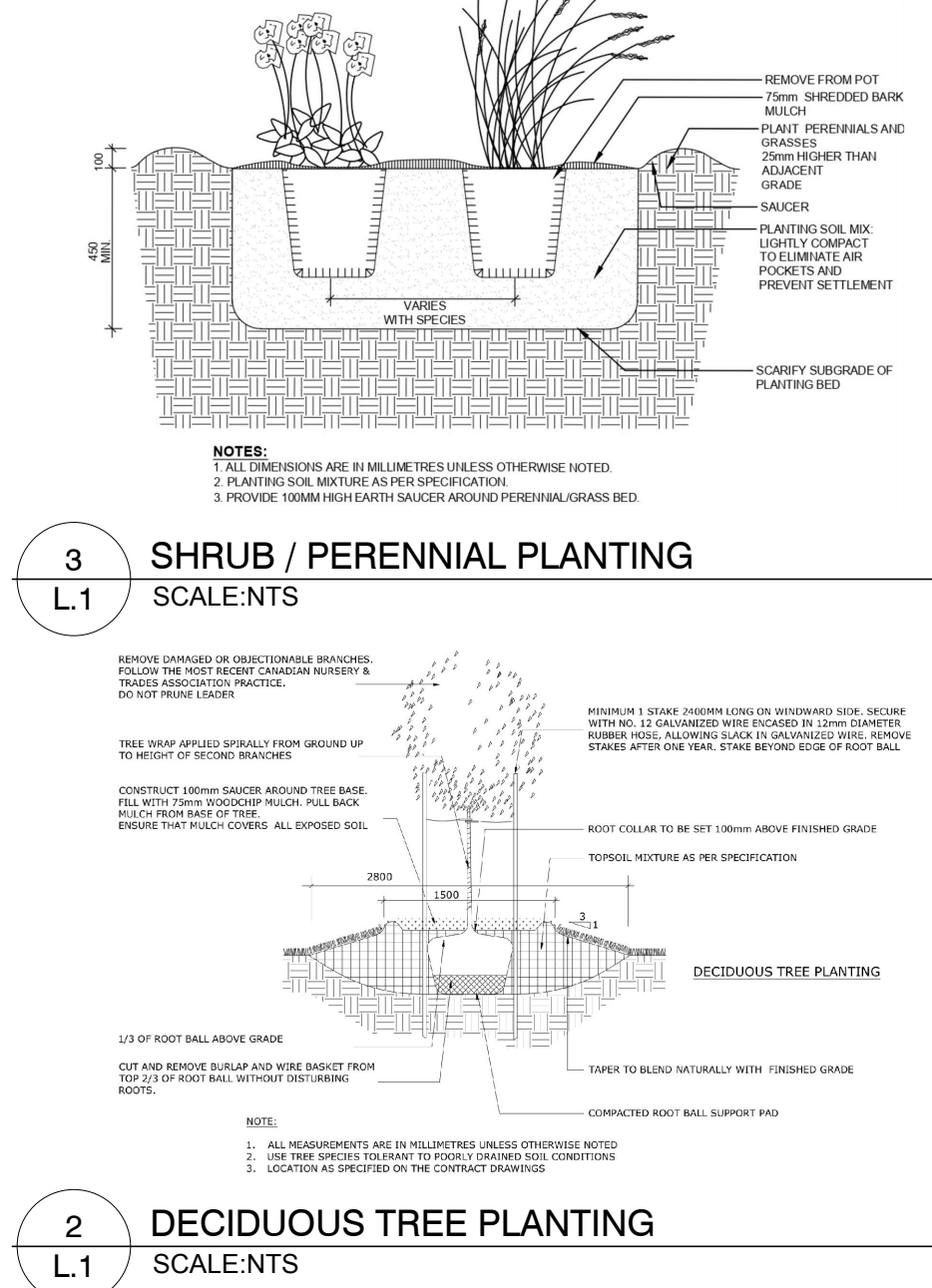

CLIENT:

**SMART LIVING PROPERTIES**

CONSULTANTS

ARCHITECTS:

**WOODMAN ARCHITECT ASSOCIATES LTD.**

4 BEECHWOOD AVE. UNIT 201 OTTAWA, ON. K1L 8L8 - TEL: (613) 233-6030

SURVEYORS:

**FARLEY, SMITH & DENIS SURVEYING LTD.**

ONTARIO LAND SURVEYORS  
CANADA LANDS SURVEYORS

190 COLONNADE ROAD, OTTAWA, ONTARIO K2E 7J5  
PHONE: (613) 727-8226 - FAX: (613) 727-1823

LEGEND

- PROPOSED DECIDUOUS TREE
- REQUIRED SOIL VOLUME AT A 1.5m DEPTH
- PROPOSED UPRIGHT CONIFEROUS SHRUB
- EXISTING TREE TO REMAIN
- PROPOSED SHRUBS / PERENNIALS
- PROPOSED RIVERSTONE
- PROPOSED SOD
- PROPOSED PRECAST CONCRETE PAVERS
- PROPOSED 1.8m Ht. WOOD SCREEN FENCE

12	REVISED PER NEW SITE PLAN	06/04/2025	ML	JL
11	REVISED PER CITY COMMENTS	05/09/2025	ML	JL
10	ISSUED FOR DISCUSSION AND REVIEW	02/28/2025	ML	JL
9	ISSUED FOR DISCUSSION AND REVIEW	08/02/2023	CM	JL
8	REVISED PER CITY COMMENTS	08/01/2023	CM	JL
7	REVISED PER NEW SITE PLAN	05/18/2023	ML	JL
6	REVISED PER NEW CIVIL DRAWING	03/18/2022	ML	JL
5	REVISED PER NEW SITE PLAN	03/04/2022	ML	JL
4	ISSUED FOR CLIENT DISCUSSION	01/31/2022	ML	JL
3	ISSUED FOR CLIENT DISCUSSION	11/24/2021	LC	JL
2	ISSUED FOR CLIENT DISCUSSION	07/21/2021	WF	JL
1	ISSUED FOR CLIENT DISCUSSION	05/11/2021	AF	JL
No.	Issue	Date	DR	CK

**JAMES B. LENNOX & ASSOCIATES INC.**  
**LANDSCAPE ARCHITECTS**

3332 CARLING AVE. OTTAWA, ONTARIO K3H 5A8  
Tel. (613) 722-5168 Fax. (866) 343-3942

PROJECT

**RESIDENTIAL DEVELOPMENT**

229 & 241 BEECHWOOD AVE, OTTAWA ON

DRAWING

**LANDSCAPE PLAN**

SCALE

AS SHOWN

START DATE

MAY 2021

PROJECT NO.

20SMT2054

PROJECT NORTH

DRAWING NO.

**L.1**

PLOT SIZE ARCH-D