

| SITE ABBREVIATIONS | | STREET SIGNS | | SITE LEGEND | |
|--------------------|---------------------------------|--|-----------------------------|-------------|---|
| AD | AREA DRAIN | FOR ALL THE SIGNS FOLLOW THE SPECIFICATIONS OF THE CITY OF OTTAWA | | | MAIN ENTRANCE |
| CB | CATCH BASIN | 1 | STOP SIGN | | BUILDING ENTRANCE |
| D.C. | DEPRESSED CURVE | 2 | FIRE ROUTE SIGN | | MECH. SERVICE ACCESS |
| UP | UTILITY POLE | 3 | PRIORITY TO PEDESTRIAN SIGN | | FIRE HYDRANT (FH) |
| RM | REMOTE MONITOR | 4 | DROP OFF ZONE ONLY SIGN | | SIEMSE CONNECTION (FDC) |
| STM MH | STORMWATER MANHOLE | THE PARKING SIGNS WILL BE LABELED AS: "VISITOR ONLY" (SIGN #1) "RESIDENT ONLY" (SIGN #2) "ACCESSIBLE PARKING" AND REINFORCED: "UNAUTHORIZED VEHICLES WILL BE TOWED AWAY" | | | STREET SIGNAGE |
| FDC | FIRE DEPARTMENT CONNECTION | | | | PROPERTY LINE |
| SC | SIEMSE CONNECTION | | | | TWIS |
| GW | GUIDE WIRE | | | | BICYCLE PARKING AT GROUND LEVEL 1800mm x 600mm |
| LS | LIGHT STANDARD (REFER TO ELEC.) | | | | REGULAR PARKING SPOT |
| FH | FIRE HYDRANT | | | | ACCESSIBLE PARKING SPOT TYPE A |
| TWIS | TACTILE WALKING INDICATOR STRIP | | | | |
| MUP | MULTI-USE PATHWAY | | | | |

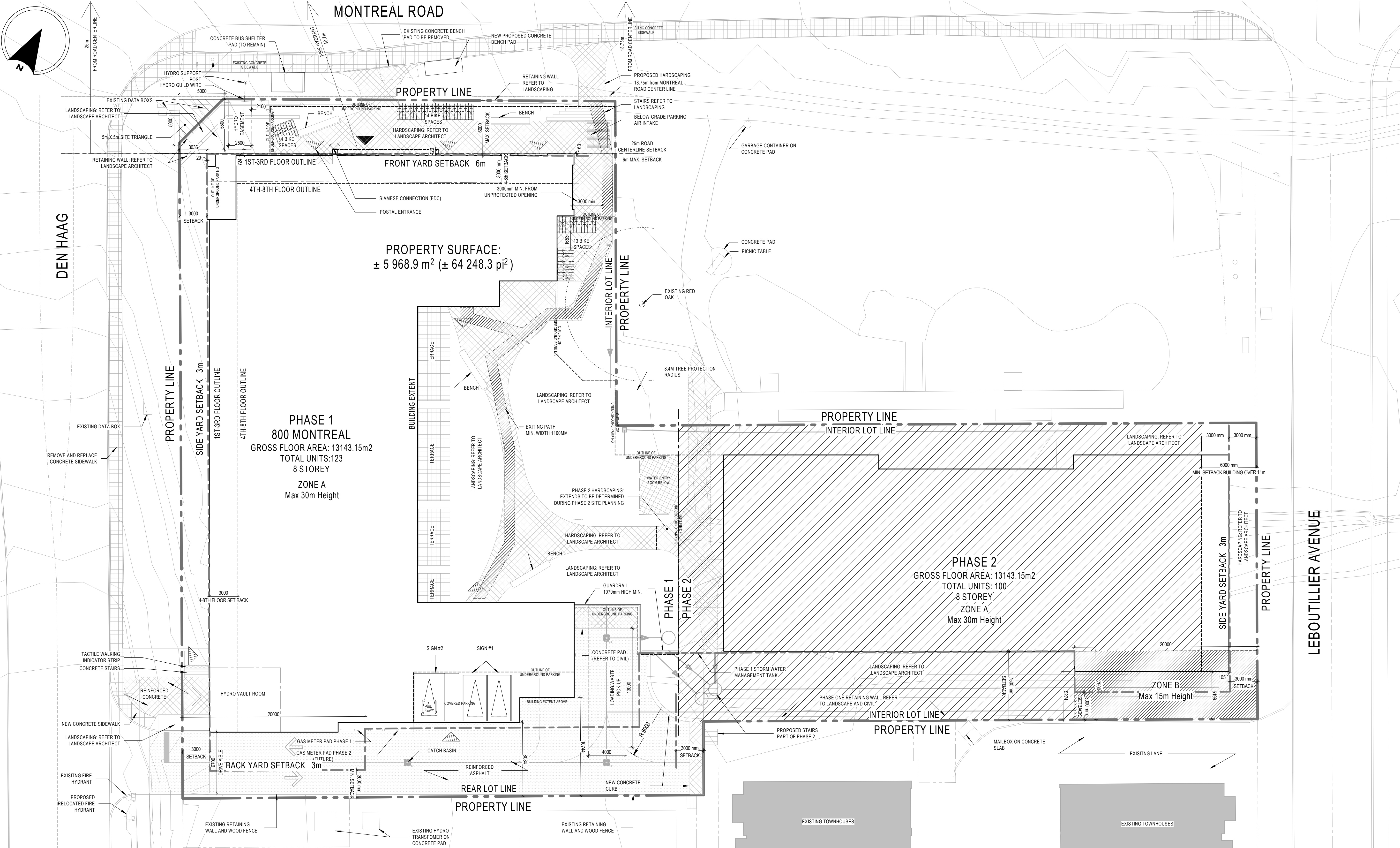

KEY PLAN



SITE PLAN
1: 200

NOTES GÉNÉRALES / General Notes

- Ces documents d'architecture sont la propriété exclusive de NEUF architect(e)s et ne doivent être utilisés, reproduits ou copiés sans autorisation écrite préalable. / These architectural documents are the exclusive property of NEUF architect(e)s and cannot be used, copied or reproduced without written pre-authorization.
- Les dimensions apparaissant sur les documents doivent être vérifiées par l'entrepreneur avant le début des travaux. / All dimensions which appear on the documents must be verified by the contractor before to start the work.
- Vous devez aviser l'architecte de toute dimension erreur et/ou divergence entre ces documents et ceux des autres professionnels. / The architect must be notified of all errors, omissions and discrepancies between these documents and those of the other professionals.
- Les dimensions sur ces documents doivent être lues et non mesurées. / The dimensions on these documents must be read and not measured.

ARCHITECTURE DE PAYSAGE Landscape Architect
Lashley+Associates
950 Gladstone Ave. Suite 202, Ottawa (ON) K1J 3E6
T 613.233.8579 lashleya.com

CIVIL Civil
IBI Group
333 Preston Street Suite 400 Ottawa (ON), K1S 5N4
T 613.447.0504 ibigroup.com

INGÉNIERIE TRANSPORT Engineering, Transportation
IBI - Transportation Eng.
333 Preston Street Suite 400 Ottawa (ON), K1S 5N4
T 613.447.0504 ibigroup.com

DESIGN INTERIEUR Interior Design
NINE Design
25 rue Richmond, Suite 200 - De Montarville, (QC) J3V 6E4
T 514.988.8973 nine-design.ca

STRUCTURE Structural
L2C Experts
4710 St-Ambrose St. Suite 103 Montreal (QC) H4C 2C
T 514.378.4999 l2cexperts.com

MÉCANIQUE / ÉLECTRIQUE Mechanical / Electrical
GOODKEY, WEEDMARK & ASSOCIATES LTD.
1888 St-Joseph St. Ottawa, ON K2C 3R6
T 613.727.5111 gwal.com

ARCHITECTES Architect
NEUF architect(e)s SENCRL
630, boul. René-Lévesque O. 32e étage, Montréal QC H3B 1S6
T 514.847.1117 NEUFarchitectes.com

SCEAU / Seal

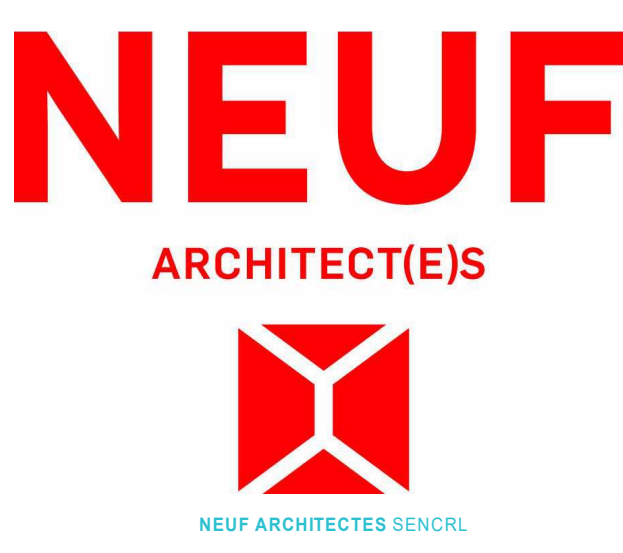

CLIENT Client
GROUPE SOVIMA
100 rue Landrienne, bureau 201, St-Benoit de Montarville (Québec) J3V 0B3
T 450.878.4478 sovimacabotations.com

OUVRAGE Project
800 MONTREAL ROAD
120 DEN HAAG DR,
OTTAWA

| NO | REVISION | DATE (aa-mm-ii) |
|----|--|-----------------|
| A | Issued for SPA | 2020.12.11 |
| B | Issued for Coordination 30% | 2020.12.20 |
| C | Issued for internal review - Architect | 2021.01.25 |
| D | Issued for Coordination 60% | 2021.05.25 |
| E | Issued for SPA Rev 1 | 2021.10.25 |
| F | Reissued for SPA Rev 1 | 2022.02.14 |
| G | Issued for 80% Review | 2022.03.05 |
| H | Issued for UDRP | 2022.03.06 |
| J | Reissued for SPA Rev 2 | 2022.12.21 |
| L | Issued for Permit Review | 2023.02.24 |
| K | Issued for Permit | 2023.03.01 |
| L | Issued for City Comments | 2023.07.19 |
| M | Issued to City for Clarification | 2024.02.20 |
| N | Issued to City for Review/SPA approval | 2024.03.26 |

DESIGN PAR Drawn by
AV

VERIFIÉ PAR Checked
AJ

DATE (aa mm ii)
2024.03.26

ÉCHELLE Scale
As indicated

TITRE DU DESSIN Drawing Title
SITE PLAN - OVERALL

REVISION Revision
N

NO. DESSIN Dwg Number
A101