



Copyright Reserved

The Contractor shall verify and be responsible for all dimensions. DO NOT scale the drawing - any errors or omissions shall be reported to Stantec without delay.
The Copyrights to all designs and drawings are the property of Stantec. Reproduction or use for any purpose other than that authorized by Stantec is forbidden.

Legend

- AREA ID
- RUNOFF COEFFICIENT
- STORM DRAINAGE AREA b.c.
- STORM DRAINAGE BOUNDARY
- PROPOSED STORM SEWER
- PROPOSED CATCHBASIN
- EXISTING STORM SEWER
- PROPOSED DOOR LOCATIONS
- INSULATION AS PER CITY STD W22
- DIRECTION OF OVERLAND FLOW
- MAXIMUM STATIC PONDING LIMITS
- CATCHBASIN TO BE INSTALLED WITH CIRCULAR ORIFICE (SEE DWG SD-1)

Notes

6	REVISED SITE PLAN	WAJ	KJK	24.05.15
5	REVISED SITE PLAN	WAJ	KJK	23.01.16
4	REVISED SITE PLAN	WAJ	KJK	22.08.24
3	REVISED AS PER CITY COMMENTS	WAJ	KJK	22.04.22
2	REVISED AS PER CITY COMMENTS	WAJ	AMP	22.02.17
1	ISSUED FOR REVIEW	WAJ	AMP	20.07.17

Revision			
File Name:	160401518-D8	AJ	KJK
		Dwn.	Chkd.
		WAJ	Dgn.
			YY.MM.DD

Permit-Seal

Client/Project
PULICKAL HOLDINGS INC.

TWO STOREY COMMERCIAL BUILDING
1994 ST-JOSEPH BLVD.
OTTAWA, ON

Title
STORM DRAINAGE PLAN

Project No.	Scale	0 1.5 4.5 7.5m
160401518	1:150	
Drawing No.	Sheet	Revision
SD-1	5 of 5	6

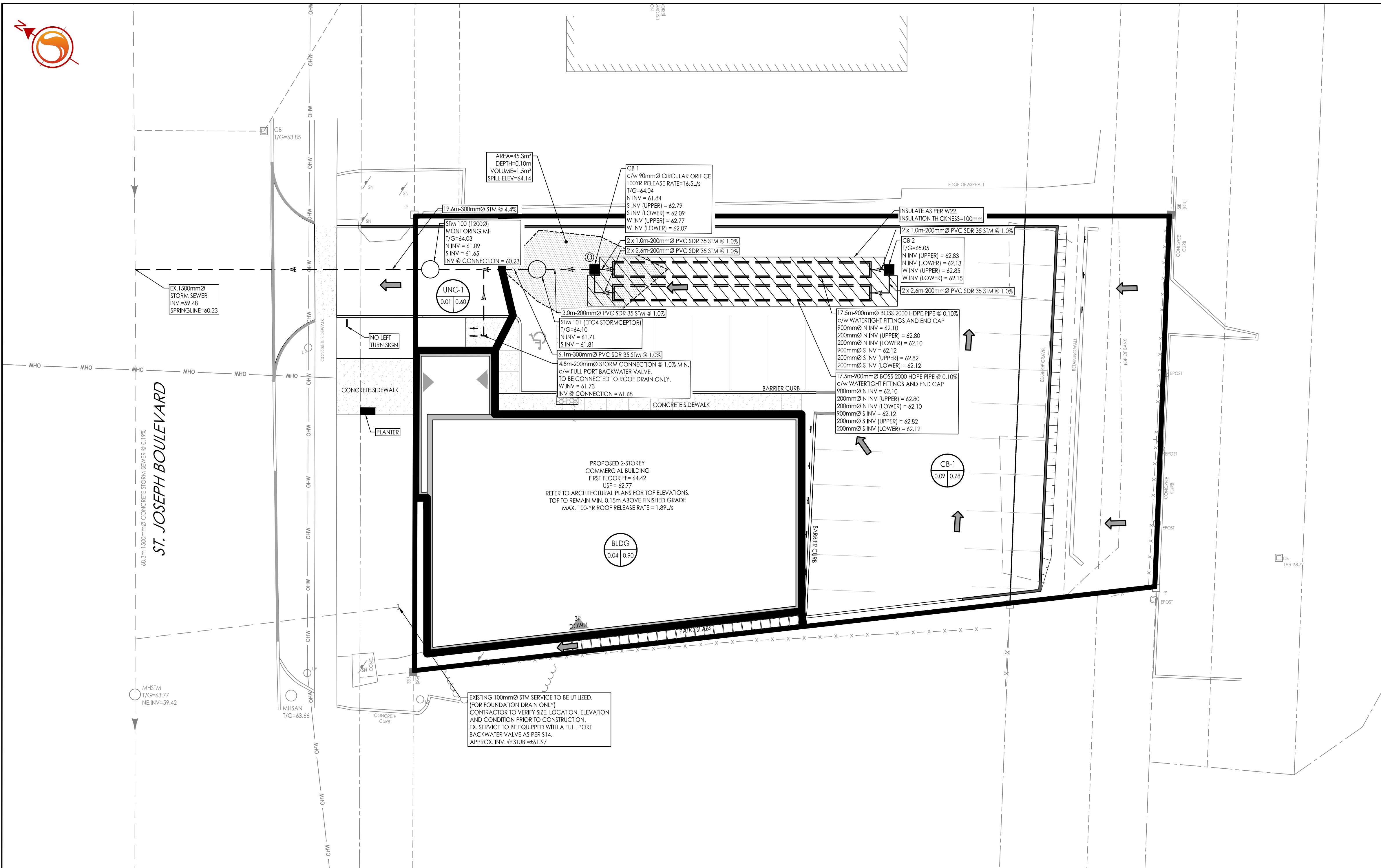

DRAINAGE AREA ID	DRAIN TYPE	# DRAINS	100 YEAR HEAD (m)	100 YEAR RELEASE RATE (L/s)
BLDG	WATTS ACCU/FLOW (25% OPEN)	2	0.15	1.89

CATCHBASIN ID	AREA ID	TYPE	100YR HEAD (m)	100YR RELEASE RATE (L/s)
CB 1	CB-1	90mmØ CIRCULAR ORIFICE	0.86	16.5

EXISTING 100mmØ STM SERVICE TO BE UTILIZED FOR FOUNDATION DRAIN ONLY. CONTRACTOR TO VERIFY SITE LOCATION, ELEVATION AND CONDITION PRIOR TO CONSTRUCTION. EX. SERVICE TO BE EQUIPPED WITH A FULL PORT BACKWATER VALVE AS PER S14. APPROX. INV. @ STUB = ±61.97

PROPOSED 2-STOREY COMMERCIAL BUILDING
FIRST FLOOR FF = 64.42
USF = 62.77
REFER TO ARCHITECTURAL PLANS FOR TOF ELEVATIONS.
TOF TO REMAIN MIN. 0.15m ABOVE FINISHED GRADE
MAX. 100-YR ROOF RELEASE RATE = 1.89 L/S

ST. JOSEPH BOULEVARD
68.3m 1500mmØ CONCRETE STORM SEWER @ 0.1%
MHO