

1 LANDSCAPE PLAN  
L.1 SCALE 1:300

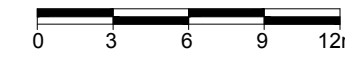

GENERAL NOTES:

- It is the responsibility of the appropriate contractor or official to report any errors, omissions or discrepancies on this plan with actual site conditions to the Landscape Architect before proceeding with construction.
- The contractor is to notify all utility companies and authorities prior to any excavation and ascertain locations of underground services.
- The contractor is to reinstaate all areas and items damaged as a result of construction activity.
- The contractor is to comply with all pertinent codes and by-laws.
- The contractor is to maintain a positive surface run-off throughout the entire construction period.
- The Landscape Architect is not responsible for subsurface conditions.
- The contractor is to identify all existing trees to remain on site with the Landscape Architect prior to construction.
- The contractor is to stake the proposed location of all plant material in conjunction with the Landscape Architect prior to excavation.
- Minimum distances for selected deciduous trees are as follows:
  - Sidewalks as per ROW Cross Sections
  - Public Streets/Curbs as per ROW Cross Sections
  - Service Lateral 1.5m
  - Fire Hydrant 2.5m
  - Hydro Transformer 3m
  - Street Light 2.5m for small trees
- All trees within 1m of underground utility trenches are to be excavated by hand.
- Remove all protective wrapping from tree trunks after installation.
- Staking of trees shall only be performed if necessary.
- Ensure that mulch is pulled back a min. distance of 75mm from base of tree trunk.

PROPOSED PLANT LIST

KEY	QTY	BOTANICAL NAME	COMMON NAME	SIZE	CONDITION	REMARKS
<b>TREES</b>						
AM	4	<i>Acer ginnala</i>	Amur Maple	60mm ø	B&B	
CS	6	<i>Picea pungens</i>	Colorado Spruce	1800mm ht.	B&B	
FM	3	<i>Acer x freemanii</i>	Freeman's Maple	60mm ø	B&B	
HB	5	<i>Celtis occidentalis</i>	Hackberry	60mm ø	B&B	
HL	6	<i>Gleditsia triacanthos</i>	Honey Locust	60mm ø	B&B	
JL	2	<i>Syringa reticulata 'Ivory Silk'</i>	Japanese Tree Lilac	60mm ø	B&B	
JT	4	<i>Syringa reticulata 'Summer Snow'</i>	Summer Snow Japanese Tree Lilac	60mm ø	B&B	
LL	6	<i>Tilia cordata 'Corzani'</i>	Corinthian Littleleaf Linden	60mm ø	B&B	
MD	4	<i>Malus 'Dolgo'</i>	Dolgo Crabapple	60mm ø	B&B	
ML	4	<i>Tilia mongolica</i>	Mongolian Linden	60mm ø	B&B	
MP	2	<i>Malus 'Profusion'</i>	Profusion Crabapple	60mm ø	B&B	
RM	5	<i>Acer rubrum</i>	Red Maple	60mm ø	B&B	
SB	3	<i>Amelanchier canadensis</i>	Shadblow Serviceberry	60mm ø	B&B	
SF	1	<i>Amelanchier laevis 'Spring Flurry'</i>	Spring Flurry Serviceberry	60mm ø	B&B	
SM	6	<i>Acer saccharum</i>	Sugar Maple	60mm ø	B&B	
WS	3	<i>Picea glauca</i>	White Spruce	2400mm ht.	B&B	

NOTES:

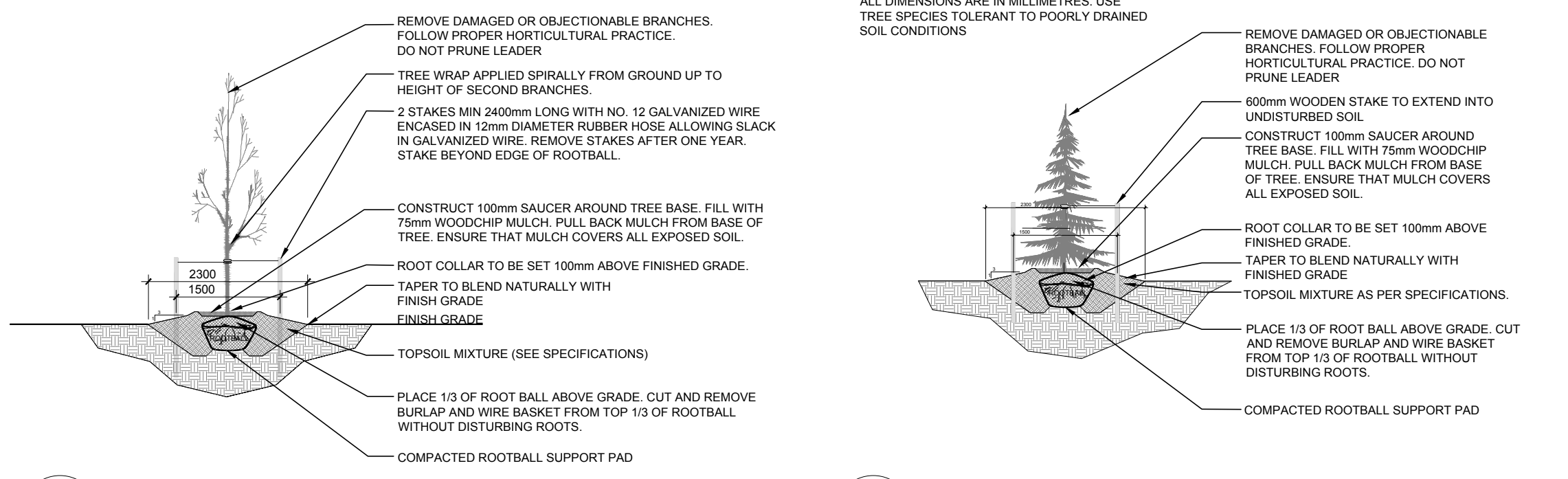

2 DECIDUOUS TREE PLANTING  
L.1 N.T.S.

3 CONIFEROUS TREE PLANTING  
L.1 N.T.S.

CLIENT:  
CLARIDGE HOMES  
250-270 GLEADSTONE AVE., OTTAWA, ON  
Tel: (613) 233-6030

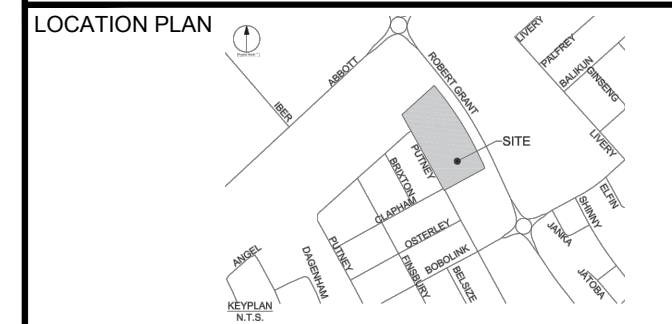

CONSULTANTS  
CIVIL ENGINEERS:  
IBI GROUP  
490-333 HURON STREET, OTTAWA, ON K1N 9M4  
Tel: (613) 225-1311

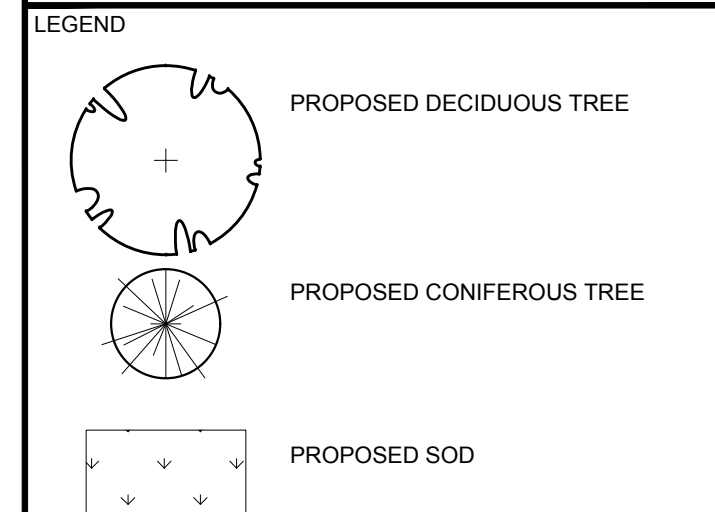

2	UPDATED AS PER GRADING PLAN CHANGES	07/27/2021	LC	JL
1	REVISED AS PER CITY COMMENTS	05/31/2021	LC	JL
No.	Issue	Date	DR	CK

JAMES B. LENNOX & ASSOCIATES INC.  
LANDSCAPE ARCHITECTS  
3332 CARLING AVE. OTTAWA, ONTARIO K2H 5A8  
Tel: (613) 722-5168 Fax: (866) 343-3942

PROJECT  
BLOCK 324 WESTWOOD

DRAWING  
LANDSCAPE PLAN

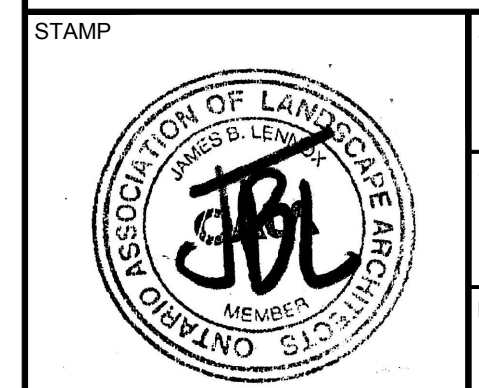

PROJECT NORTH

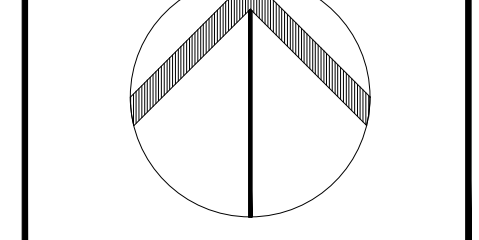

SCALE

AS SHOWN

START DATE

February, 2021

PROJECT NO.

21-CLG-2119

DRAWING NO.

L.1

PLOT SIZE ARCH-D