

**OWNER:**  
**STOKED INDUSTRIES INC**  
 14 KNOLL TERRACE,  
 NEPEAN ON  
 K2J 2K6

0283

25m

5m

**DRAWING LEGEND**

INV	INVERT OF PIPE
SAN	SANITARY SEWER
WL	WATER LINE
DS	EAVE TROUGH DOWNSPOUT
+	EXISTING GRADE ELEVATION
+	PROPOSED GRADE ELEVATION
2%	EXISTING SLOPE OF GRADE
2%	PROPOSED SLOPE OF GRADE
T.O.S	TOP OF SLOPE
B.O.S	BOTTOM OF SLOPE
---	CENTERLINE OF SWALE
---	SILT BARRIER FENCE
---	PROPERTY LINE
DC	150mm CURB/DEPRESSED CURB
---	LIGHT-DUTY PAVEMENT
---	HEAVY-DUTY PAVEMENT
---	CONCRETE
---	LANDSCAPE
C.R.Z	CRITICAL ROOT ZONE
FFL	FIRST FLOOR ELEVATION
USF	UNDERSIDE OF FOOTING
→	EMERGENCY OVERLAND FLOW

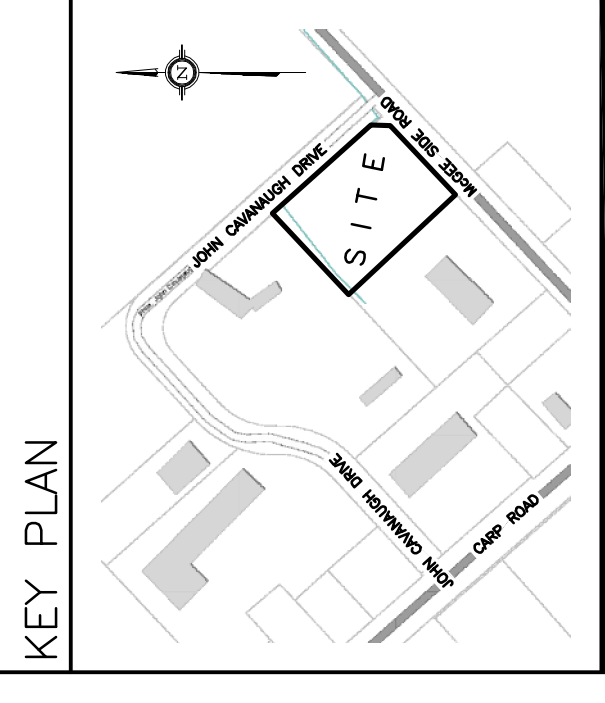

No.	DATE	REVISION
1	APR 19-23	ISSUED FOR CLIENT REVIEW
2	JUN 8-23	ISSUED FOR COORDINATION
3	JUN 23-23	RE-ISSUED FOR COORDINATION
4	JUN 29-23	RE-ISSUED FOR APPROVAL
5	AUG 10-23	RE-ISSUED FOR APPROVAL
6	DEC 21-23	RE-ISSUED FOR APPROVAL
7	OCT 15-24	RE-ISSUED FOR APPROVAL

**D. B. GRAY ENGINEERING INC.**  
 700 Long Point Circle  
 Ottawa, Ontario  
 613-425-8044  
 agray@dbgrayengineering.com

**Project**  
**OFFICE & WAREHOUSE**  
 2167 MCGEE SIDE ROAD  
 OTTAWA, ONTARIO

**SEPTIC SYSTEM**

Engineer's Seal  
 License No. 17016502  
 Date APR 19-23  
 Job No. 23024  
 Drawing No. **C-2**  
 of 7  
 NOT VALID UNLESS SIGNED & DATED

