

**OWNER:
STOKED INDUSTRIES INC
14 KNOLL TERRACE,
NEPEAN ON
K2J 2K6**

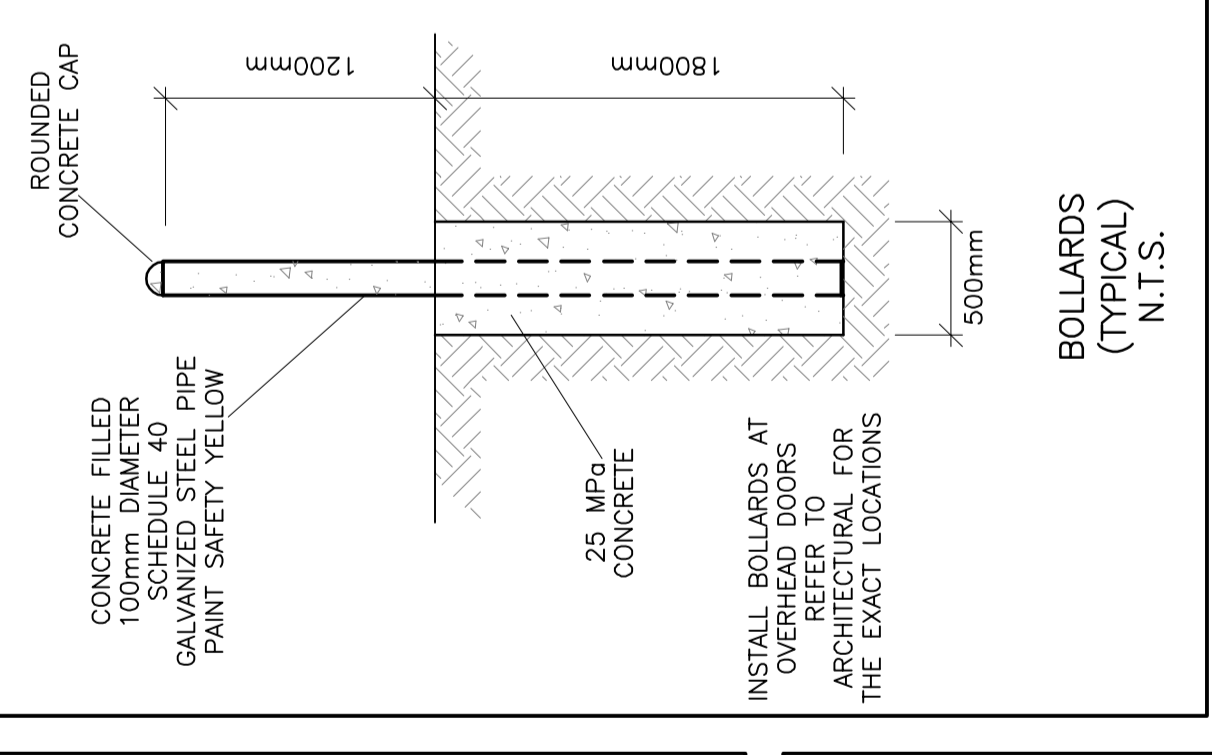

H (DEPTH OF COVER)	INSULATION THICKNESS	W (WIDTH OF INSULATION)
1800 TO 2400mm	50mm	1200mm
1500 TO 1800mm	75mm	1800mm
1200 TO 1500mm	100mm	2400mm

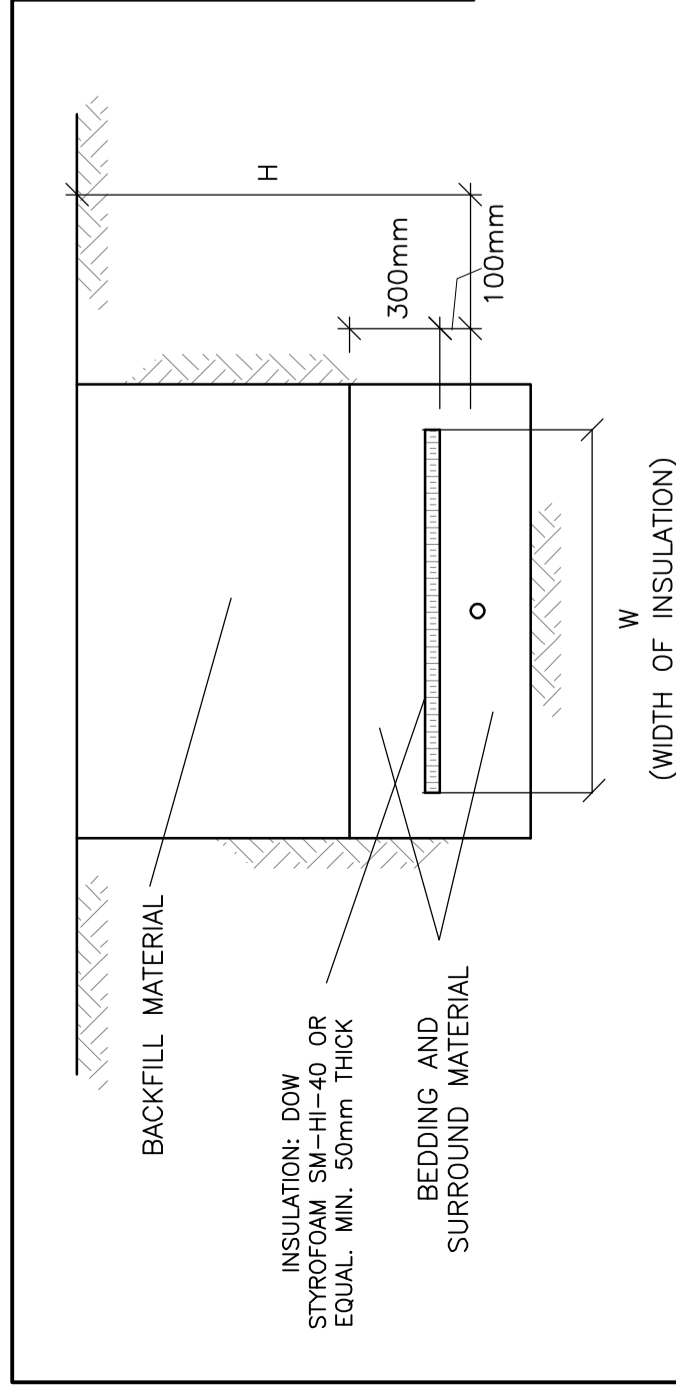
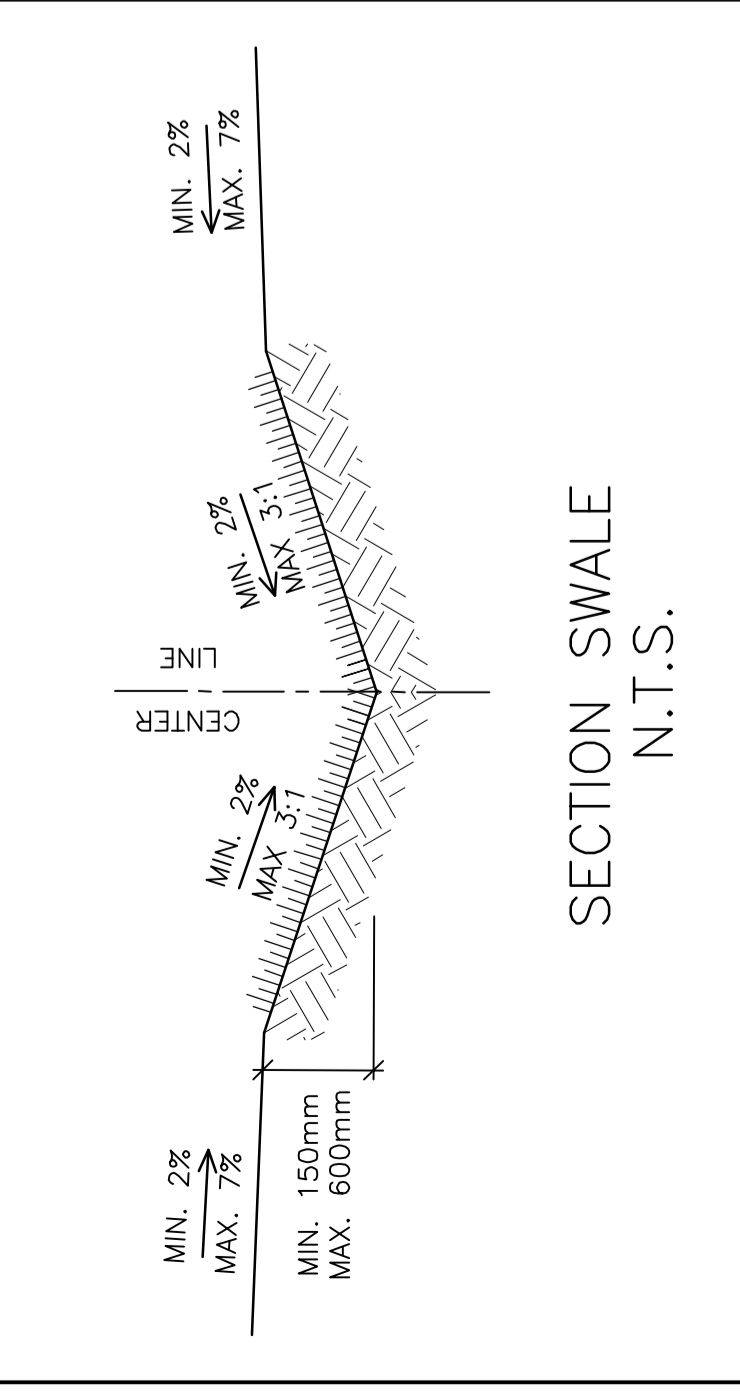

INSULATE SEWER AS INDICATED AND WHERE DEPTH OF COVER IS LESS THAN 2400mm. CENTER INSULATION OVER PIPE. JOINTS BETWEEN SHEETS OF INSULATION SHALL BE STAGGERED.

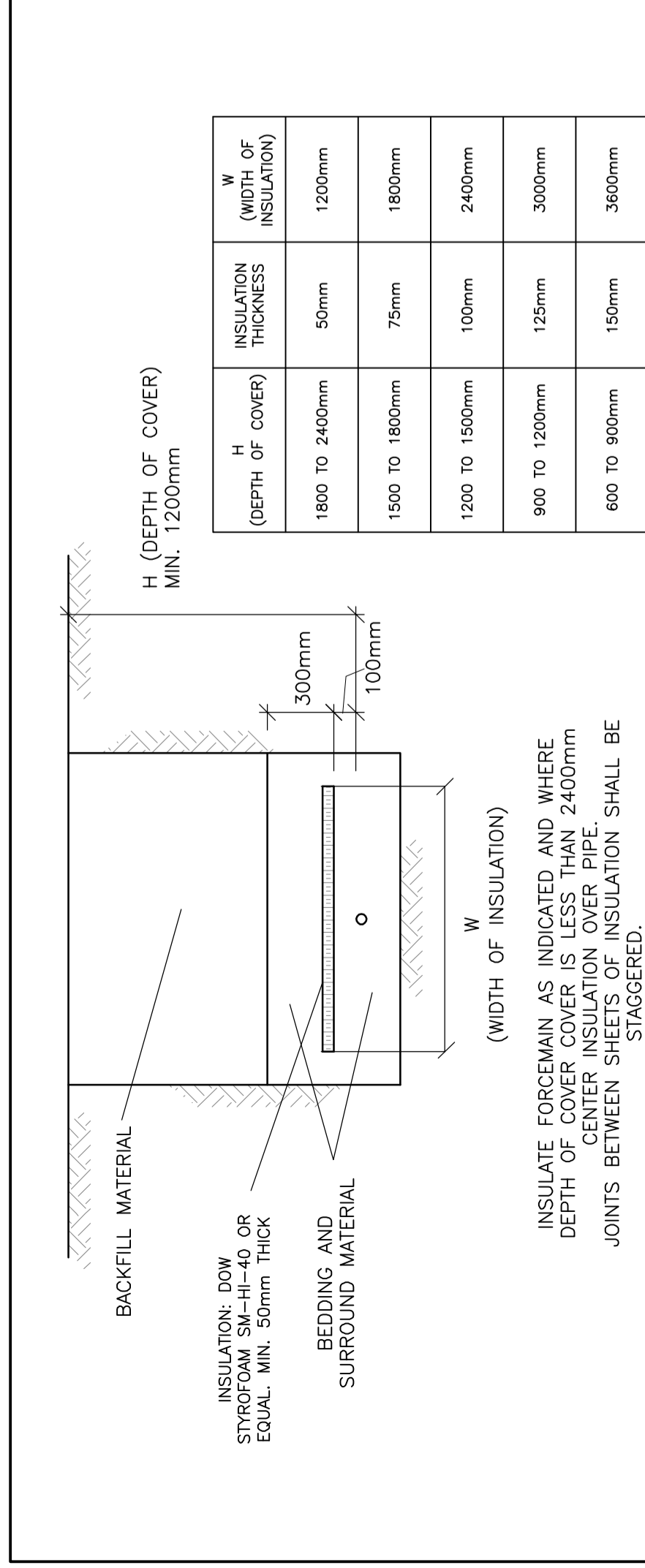

INSULATE FORCEMAIN AS INDICATED AND WHERE DEPTH OF COVER IS LESS THAN 2400mm. CENTER INSULATION OVER PIPE. JOINTS BETWEEN SHEETS OF INSULATION SHALL BE STAGGERED.

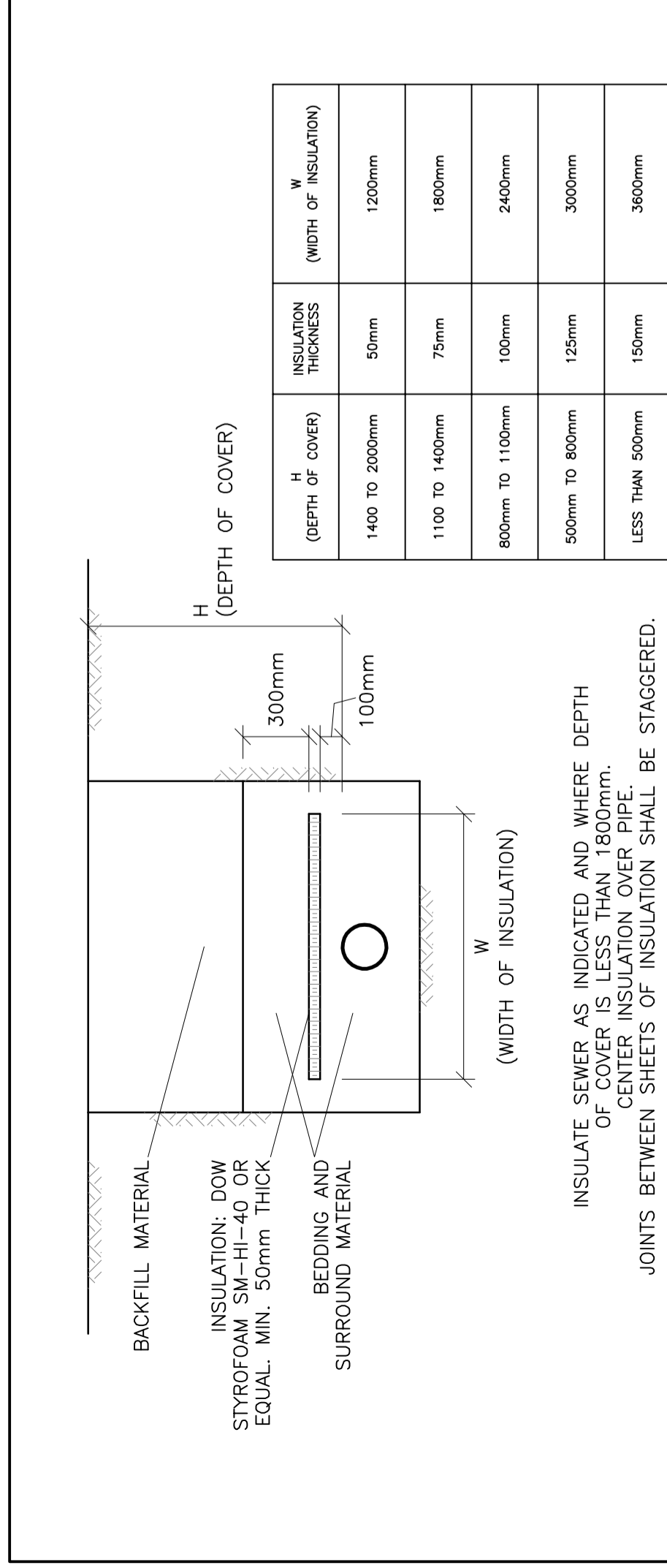

INSULATE SEWER AS INDICATED AND WHERE DEPTH OF COVER IS LESS THAN 600mm. CENTER INSULATION OVER PIPE. JOINTS BETWEEN SHEETS OF INSULATION SHALL BE STAGGERED.

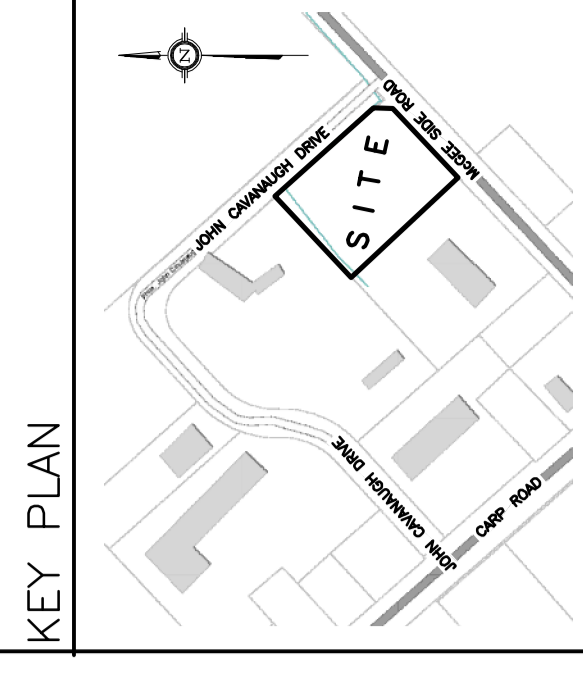
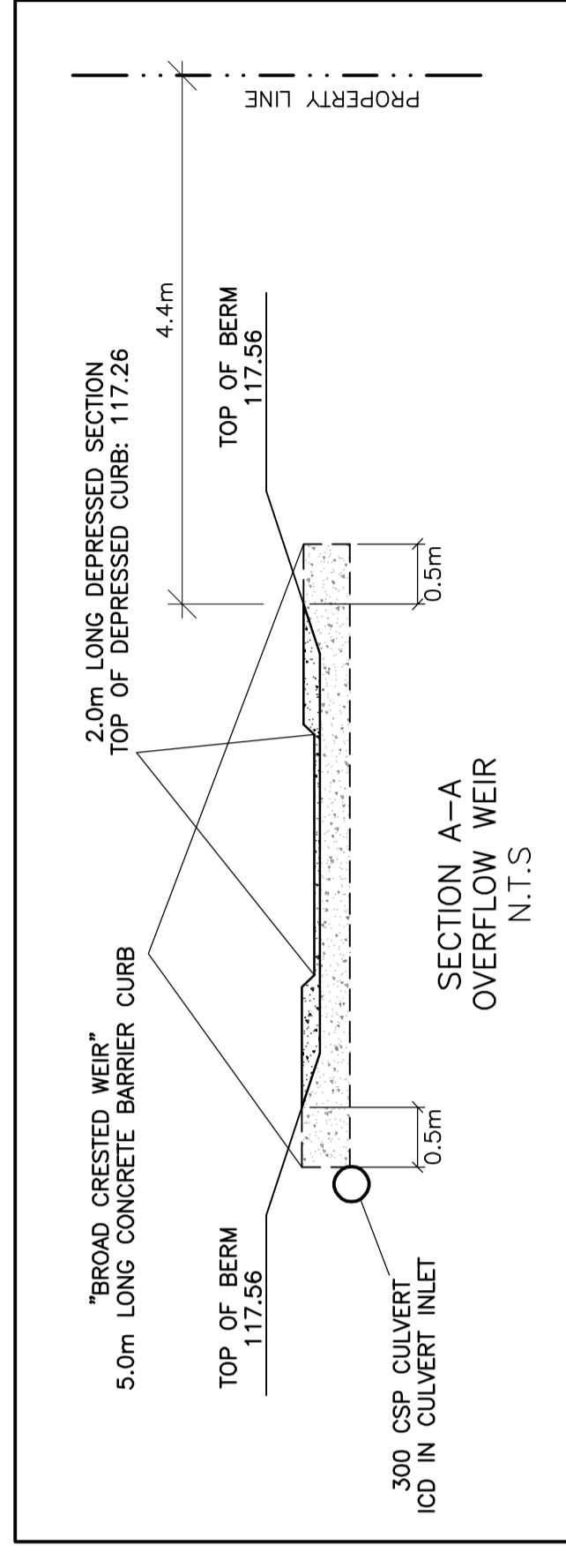
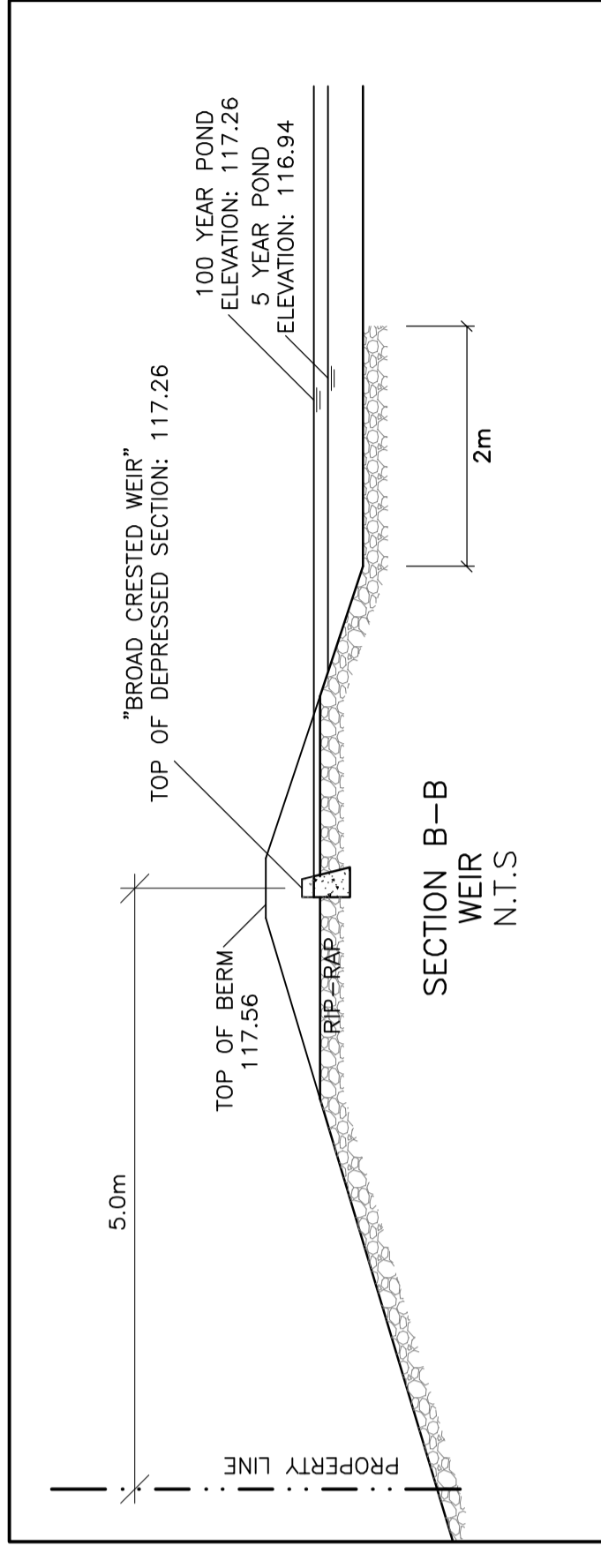
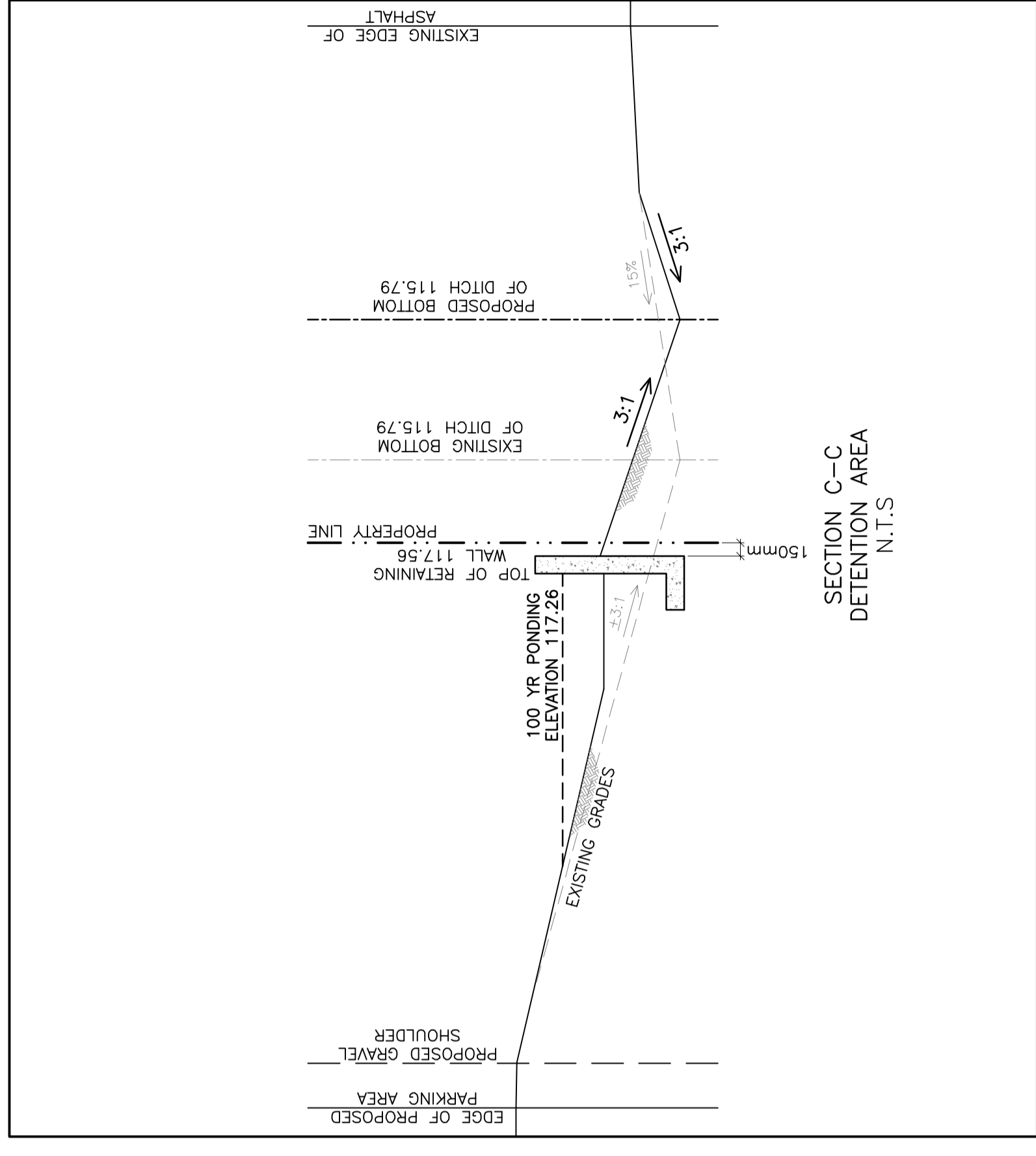
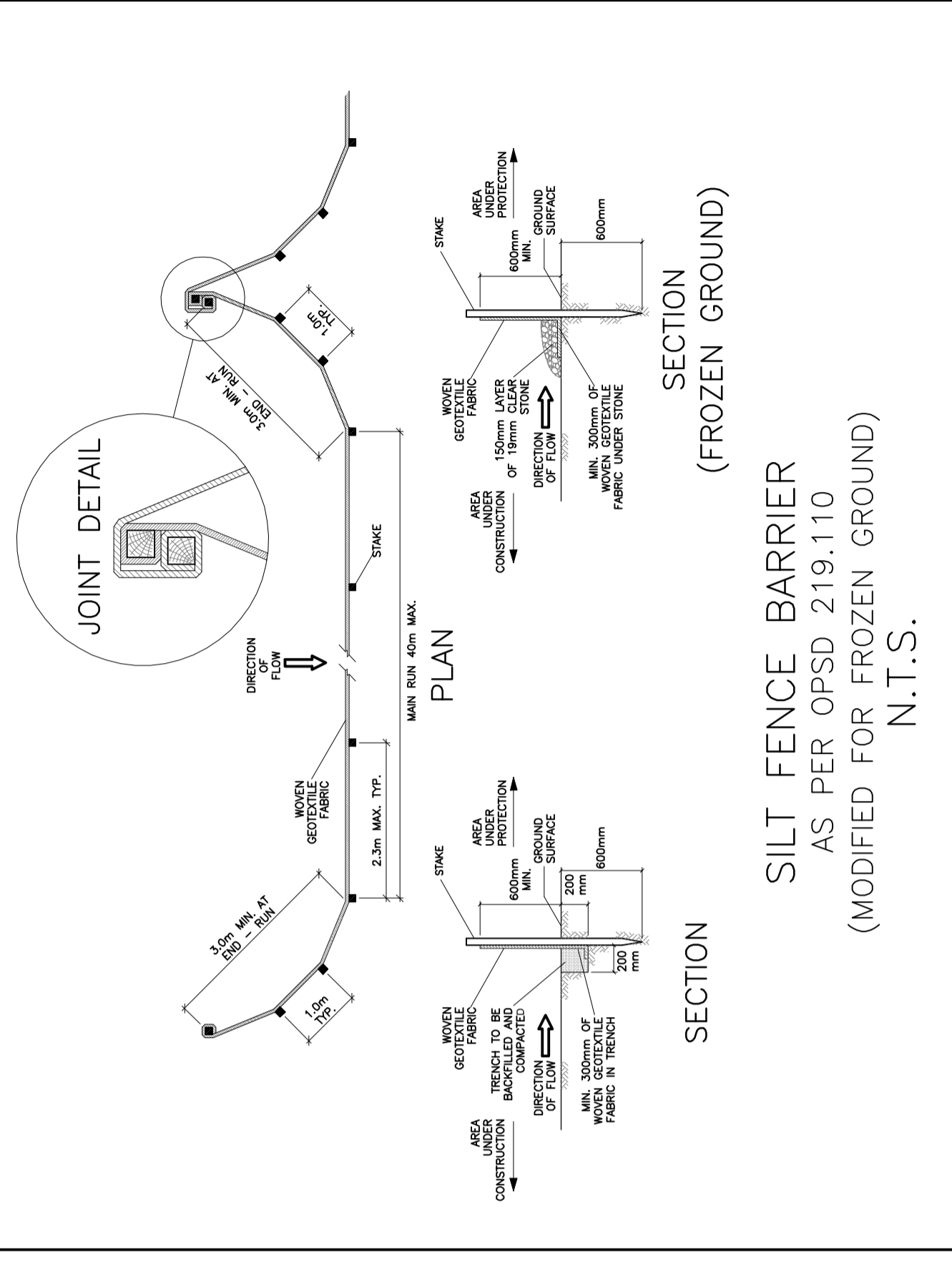
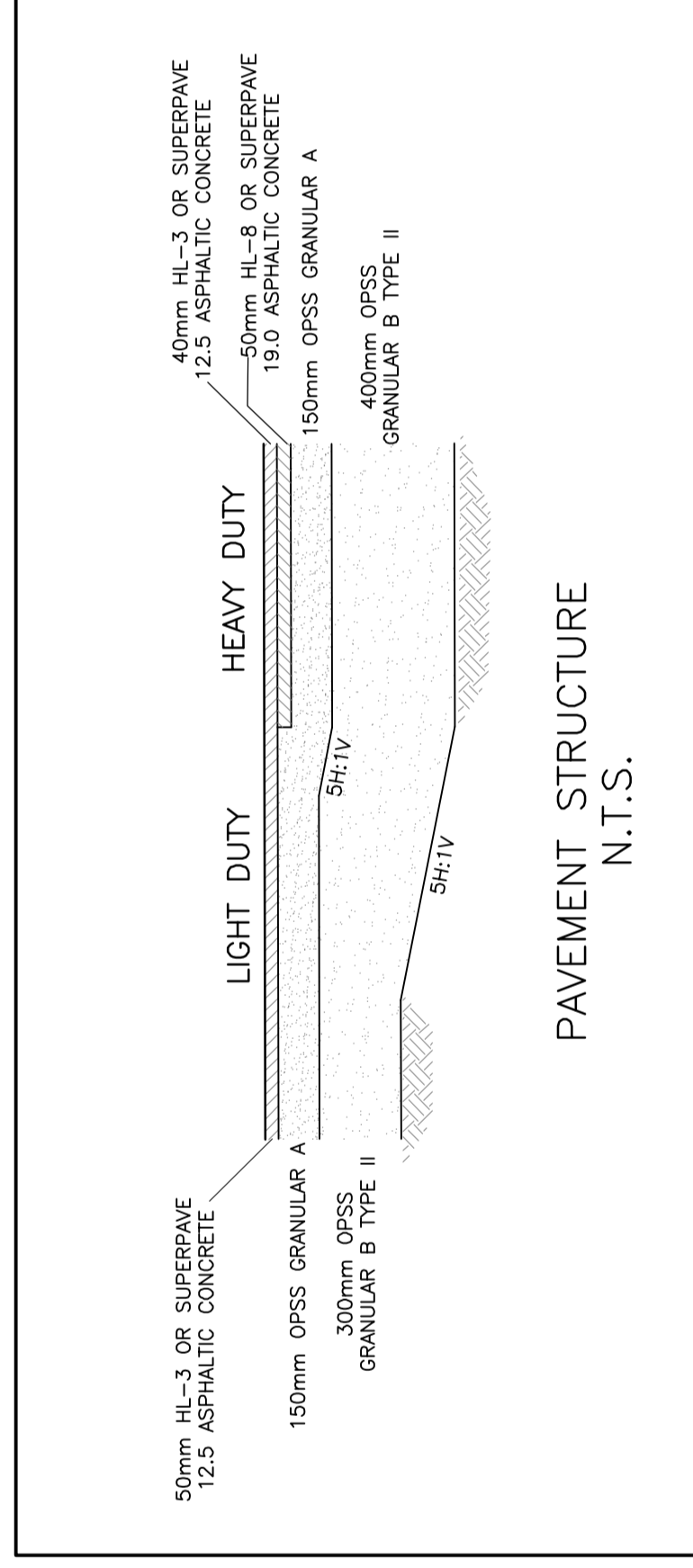
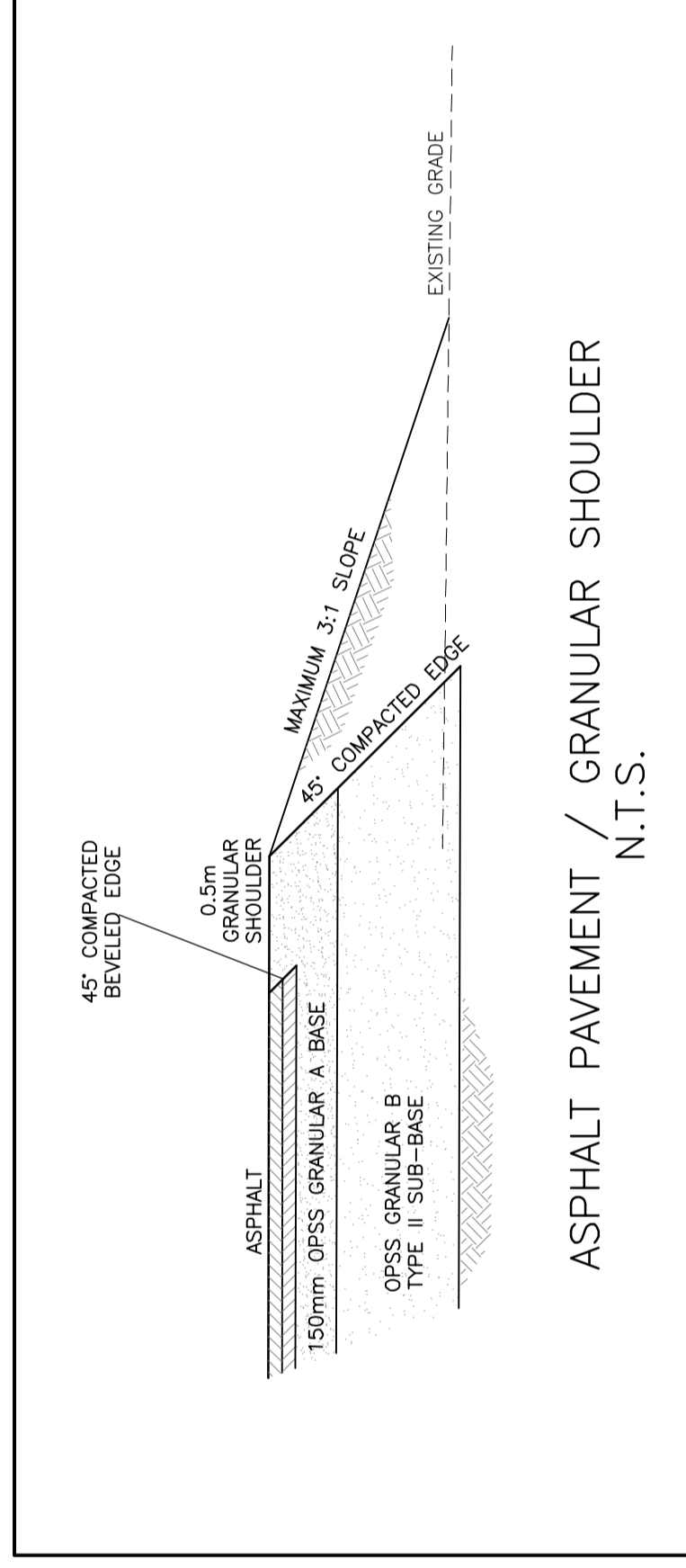
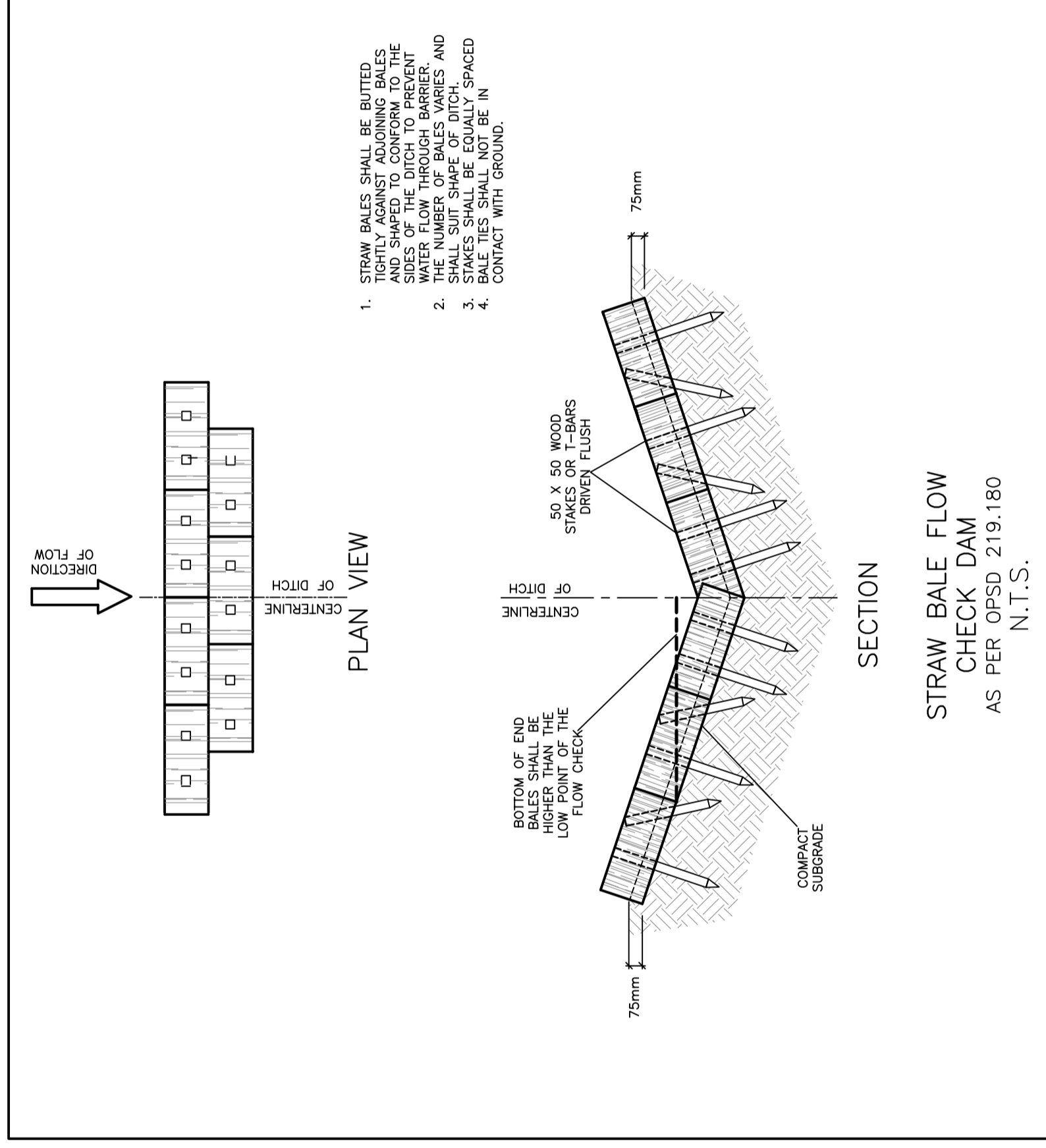

No.	DATE	REVISION
1	MAR 12-21	ISSUED FOR APPROVAL
2	JUN 14-21	RE-ISSUED FOR APPROVAL
3	JUL 26-21	RE-ISSUED FOR APPROVAL
4	APR 19-23	ISSUED FOR CLIENT REVIEW
5	JUN 23-23	ISSUED FOR COORDINATION
6	JUN 29-23	RE-ISSUED FOR APPROVAL
7	AUG 10-23	RE-ISSUED FOR APPROVAL
8	DEC 21-23	RE-ISSUED FOR APPROVAL
9	OCT 15-24	RE-ISSUED FOR APPROVAL

D. B. GRAY ENGINEERING INC.
700 Long Point Circle
Ottawa, Ontario
613-425-8044
4gray@dbgrayengineering.com

**OFFICE & WAREHOUSE
2167 MCGEE SIDE ROAD
OTTAWA, ONTARIO**

DETAILS

Engineer's Seal
Licensure No. 17016502
Date APR 19-23
Exp. Date APR 19-23
Drawing No. 23024
Drawing No. **C-5**
of **7**
NOT VALID UNLESS
SIGNED & DATED