

**LEGEND**

- PROPOSED BARRIER CURB
- PROPOSED DEPRESSED CURB
- DRAINAGE AREA LIMITS
- POST-DEVELOPMENT AREA ID
- POST-DEVELOPMENT DRAINAGE AREA (ha)
- 1.5 YEAR WEIGHTED RUNOFF COEFFICIENT
- CBMH 01 PROPOSED CATCHBASIN MANHOLE
- CB 02 PROPOSED CATCHBASIN
- FFE FINISHED FLOOR ELEVATION
- T/FND TOP OF FOUNDATION WALL ELEVATION
- USF UNDERSIDE OF FOOTING ELEVATION
- PROPOSED STORM SEWER AND FLOW DIRECTION
- EMERGENCY OVERLAND FLOW ROUTE
- PROPOSED BUILDING ENTRANCE / EXIT
- EXISTING STORM MH & SEWER
- EXISTING CATCHBASIN OR CATCHBASIN LEAD

INTERNAL SWM STORAGE SYSTEM			
DESIGN EVENT	STORAGE SYSTEM CONTROLLED FLOW	STORAGE VOLUMES REQUIRED	STORAGE VOLUMES PROVIDED
1:2 YR		16.5 m <sup>3</sup>	
1:5 YR		28.0 m <sup>3</sup>	
1:100 YR		75.5 m <sup>3</sup>	> 99 m <sup>3</sup>
1:100+20%		98.2 m <sup>3</sup>	

NOTES:

- ALL DRAINAGE FROM AREA R-1 (PROPOSED AMENITY AREA DECK DRAINS AND ALL ROOF DRAINS AS WELL AS THE TRENCH DRAINS FOR THE UNDERGROUND PARKING GARAGE RAMP AND PATIO OVERFLOW DRAIN) TO BE DIRECTED TO THE INTERNAL STORMWATER STORAGE SYSTEM. REFER TO ARCHITECTURAL AND MECHANICAL PLANS FOR DETAILS.
- REFER TO ARCHITECTURAL AND STRUCTURAL PLANS FOR EXACT SIZE AND DETAILS OF INTERNAL STORMWATER STORAGE SYSTEM.
- REFER TO ARCHITECTURAL AND MECHANICAL PLANS FOR LOCATION AND CONNECTIONS AND DETAILS OF THE INTERNAL STORMWATER STORAGE SYSTEM.

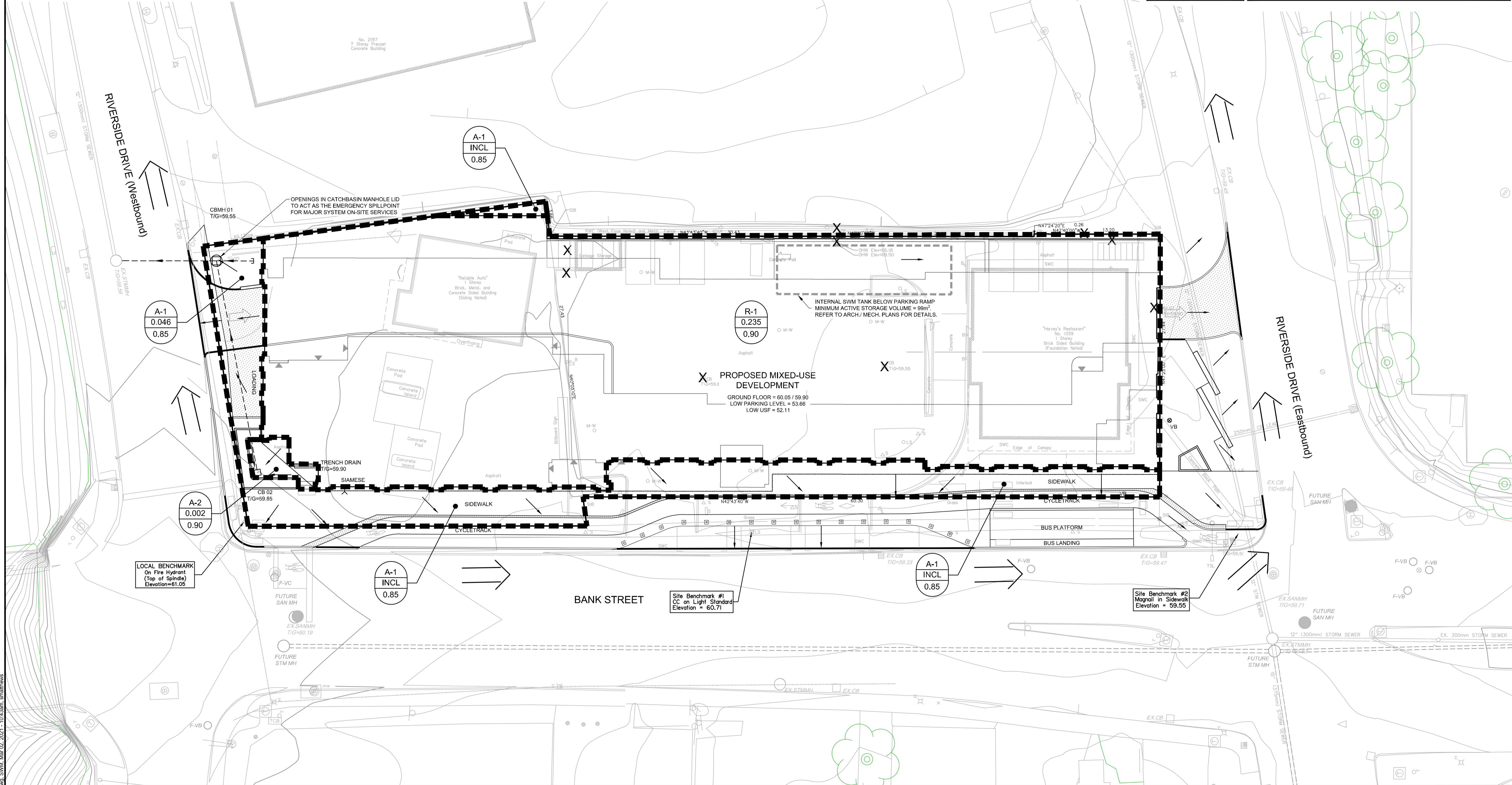
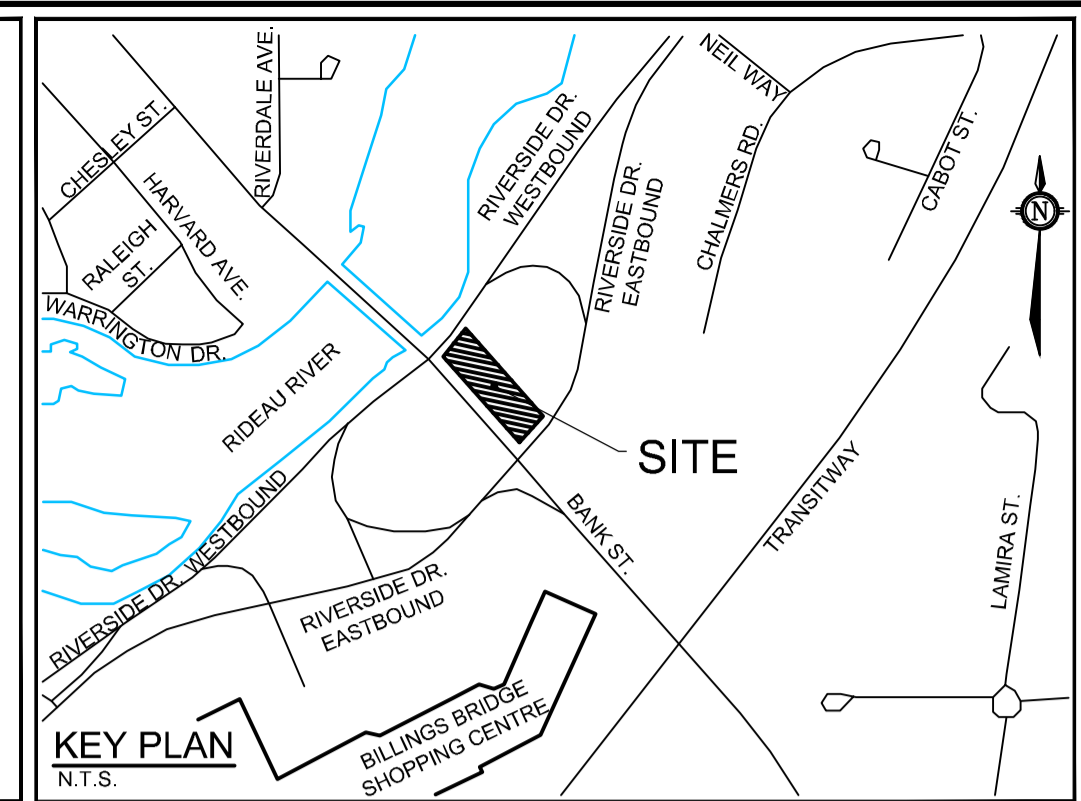
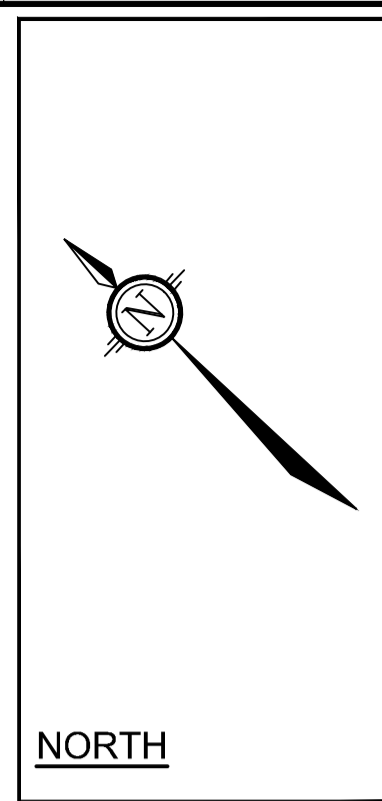

NOTE:  
THE POSITION OF ALL POLE LINES, CONDUITS, WATERMANS, SEWERS AND OTHER UNDERGROUND AND OVERGROUND UTILITIES AND STRUCTURES IS NOT NECESSARILY SHOWN ON THE CONTRACT DRAWINGS, AND WHERE SHOWN, THE ACCURACY OF THE POSITION OF SUCH UTILITIES AND STRUCTURES IS NOT GUARANTEED. BEFORE STARTING WORK, DETERMINE THE EXACT LOCATION OF ALL SUCH UTILITIES AND STRUCTURES AND ASSUME ALL LIABILITY FOR DAMAGE TO THEM.

**OWNER INFORMATION**  
Lofty Riverside Development LP  
206-900 boulevard de la Carrière  
Gatineau, Quebec, J8Y 6T5  
NAME: MR. MIKE WIEBE  
PHONE: (819) 664-4144  
EMAIL: mike@loftydevelopments.com

No.	REVISION	DATE	BY
1	ISSUED FOR SITE PLAN APPROVAL	MAR 3/21	FST

SCALE

1:200

DESIGN SM / FST

CHECKED SM

DRAWN RB / SM

CHECKED SM / FST

APPROVED FST



**NOVATECH**  
Engineers, Planners & Landscape Architects  
Suite 200, 240 Michael Cowpland Drive  
Ottawa, Ontario, Canada K2M 1P6  
Telephone: (613) 254-9643  
Facsimile: (613) 254-9867  
Website: www.novatech-eng.com

LOCATION  
CITY OF OTTAWA  
1335 & 1339 BANK STREET

DRAWING NAME  
**STORMWATER MANAGEMENT PLAN**

PROJECT No. 119210

REV # 1

DRAWING No. 119210-SWM

M:\2019\119210\CADD\Design\119210-SWM.dwg, SWM, Mar 02, 2021, 10:43:30am, smathews