

Copyright Reserved

The Contractor shall verify and be responsible for all dimensions. DO NOT scale the drawing - any errors or omissions shall be reported to Stantec without delay.  
The Copyrights to all designs and drawings are the property of Stantec. Reproduction or use for any purpose other than that authorized by Stantec is forbidden.

Legend

- PROPOSED WATERMAIN
- PROPOSED VALVE AND VALVE BOX
- PROPOSED FIRE HYDRANT
- PROPOSED SANITARY SEWER
- PROPOSED STORM SEWER
- PROPOSED CATCHBASIN
- PROPOSED DEPRESSURED CATCHBASIN
- EXISTING WATERMAIN
- EXISTING VALVE AND VALVE BOX
- EXISTING FIRE HYDRANT
- EXISTING SANITARY SEWER
- EXISTING CATCHBASIN
- CIRCULAR ORifice (SEE DWG S-1)
- INTERCONNECTED CATCHBASIN
- PROPOSED DEPRESSURED CURB LOCATIONS
- PROPOSED MOUNTABLE/BARRIER CURB LOCATION
- EXISTING EASEMENT
- EXISTING 4-PARTY UTILITY TRENCH
- EXISTING CONCRETE ENCASED DUCT BANK
- EXISTING HYDRO TRANSFORMER
- EXISTING ROGERS VAULT/PEDESTAL
- EXISTING BELL PEDESTAL
- EXISTING CSP
- EXISTING GLB
- EXISTING COMMUNITY MAIL BOX LOCATION
- THERMAL INSULATION AS PER W22
- CLAY SEAL LOCATION AS PER S8
- REFER TO GEOTECHNICAL REPORT FOR DETAILS
- UNIT TO BE EQUIPPED WITH PRESSURE REDUCING VALVE
- PROPOSED RETAINING WALL

BUILDING SERVICES

- 200mmØ STORM SERVICE PVC SDR 26 @ 1% MIN
- 150mmØ SANITARY SEWER PVC SDR 26 @ 1% MIN
- 38mmØ PEX WATER SERVICE C/W CURB STOP AND SERVICE POST UNLESS OTHERWISE SHOWN
- 0.50m BEHIND BACK OF CURB/SIDEWALK AS SHOWN ON PLAN

NOTES:

- PROPOSED UNITS TO BE EQUIPPED WITH PRESSURE REDUCING VALVES (PRVs) AS PER THE ONTARIO BUILDING CODE.
- SANITARY MANHOLES SHALL BE SW COVER AS PER CITY OF OTTAWA S24. STORM MANHOLES SHALL BE SW COVER AS PER CITY OF OTTAWA S24.1.

Revision	By	Appd.	YY.MM.DD
3	WAJ	TKR	21.10.15
2	WAJ	AMP	21.07.22
1	WAJ	AMP	21.03.25

File Name: 160401608-D8.dwg

Permit Seal	Dwn.	Chkd.	Dgn.	YY.MM.DD
	WAJ	AMP	WAJ	21.02.21
				YY.MM.DD



Client/Project  
RICHCRAFT GROUP OF COMPANIES

KANATA WEST BLOCK 29

OTTAWA, ON

Title  
SITE SERVICING PLAN

Project No. 160401608  
Scale 0 2.5 7.5 12.5m  
1:250

Drawing No. Sheet Revision

SSP-1 2 of 7 3  
CITY PLAN No. 18439

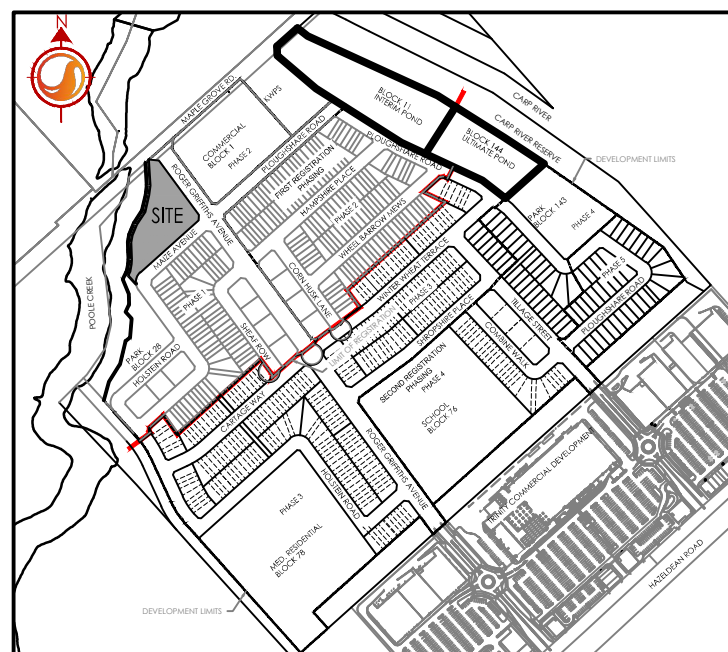

160401608 - Kanata West Block 29  
ICD Table  
Last updated on 2021-07-22 from PCSWMM model and drawings updated that same date

Area ID	CB Name	Diameter (mm)	Invert (m)	2-Year Head (m)	2-Year Flow (L/s)	100-Year Head (m)	100-Year Flow (L/s)	
L103A	L103A-1	83	96.50	0.85	12.3	1.63	17.3	
L103A	L103A-2	*CB L103A-1 and L103A-2 to be interconnected w single ICD at L103A-1						
L104A	L104A-1	83	96.54	0.91	12.8	1.54	16.8	
L104A	L104A-2	83	96.54	0.91	12.8	1.54	16.8	
L106A	L106A-1	152	96.55	0.84	40.2	1.54	55.6	

CROSSING	STM INV.	STM OBV.	SAN INV.	SAN OBV.	WTR TOP.	WTR BEM.	NOTES
1	94.98 (F4.88)	95.66 (P5.76)	93.98	94.18	96.46	96.26	DEFLECT WATER OVER STORM (AS PER W22.2)
2	94.99 (F4.89)	95.67 (P5.77)	94.07	94.27			
3	95.28	95.66	94.23	94.43	96.26	96.16	DEFLECT WATER OVER STORM (AS PER W22.2)
4	95.30	95.67	94.31	94.51			

\*BRACKETS DENOTE ADJUSTED VALUE WITH CONCRETE PIPE THICKNESS

200mm Ø WATERMAIN A			
STATION	FINISHED GRADE	TOP OF W/M	ITEM
0+00.0	98.10	95.70	CONNECTION TO EX. 300mmØ WATERMAIN
0+04.0	98.15	95.75	45° VERTICAL BEND
0+04.7	98.13	96.46	45° VERTICAL BEND
0+05.3	98.11	96.46	45° VERTICAL BEND
0+06.0	98.09	95.67	45° VERTICAL BEND
0+12.0	98.10	95.70	200mmØ VALVE AND BOX
0+00	98.19	95.79	TOP OF WATERMAIN
0+05.1	98.16	95.76	11.25° HORIZONTAL BEND
0+03.6	98.05	95.65	200mmØ VALVE AND BOX
0+06.1	98.08	95.68	200mmØ x 200mmØ TEE
0+04.0	98.14	95.74	200mmØ x 50mmØ REDUCER
0+00	97.98	95.58	TOP OF WATERMAIN
0+81.5	98.28	95.88	22.5° HORIZONTAL BEND
0+95.8	97.80	95.40	50mmØ x 38mmØ REDUCER

200mm Ø WATERMAIN B			
STATION	FINISHED GRADE	TOP OF W/M	ITEM
0+00	98.08	95.68	200mmØ x 200mmØ TEE
0+03.6	98.13	95.73	45° VERTICAL BEND
0+04.3	98.11	96.36	45° VERTICAL BEND
0+04.9	98.09	96.36	45° VERTICAL BEND
0+05.7	98.07	95.67	45° VERTICAL BEND
0+06.7	98.24	95.84	200mmØ VALVE AND BOX
0+10.4	98.23	95.83	150mmØ FIRE HYDRANT TEE
0+13.9	98.18	95.78	200mmØ x 50mmØ REDUCER
0+00	98.12	95.72	TOP OF WATERMAIN
0+00	98.16	95.76	TOP OF WATERMAIN
0+00	98.29	95.89	TOP OF WATERMAIN
0+07.8	98.15	95.75	50mmØ x 38mmØ REDUCER

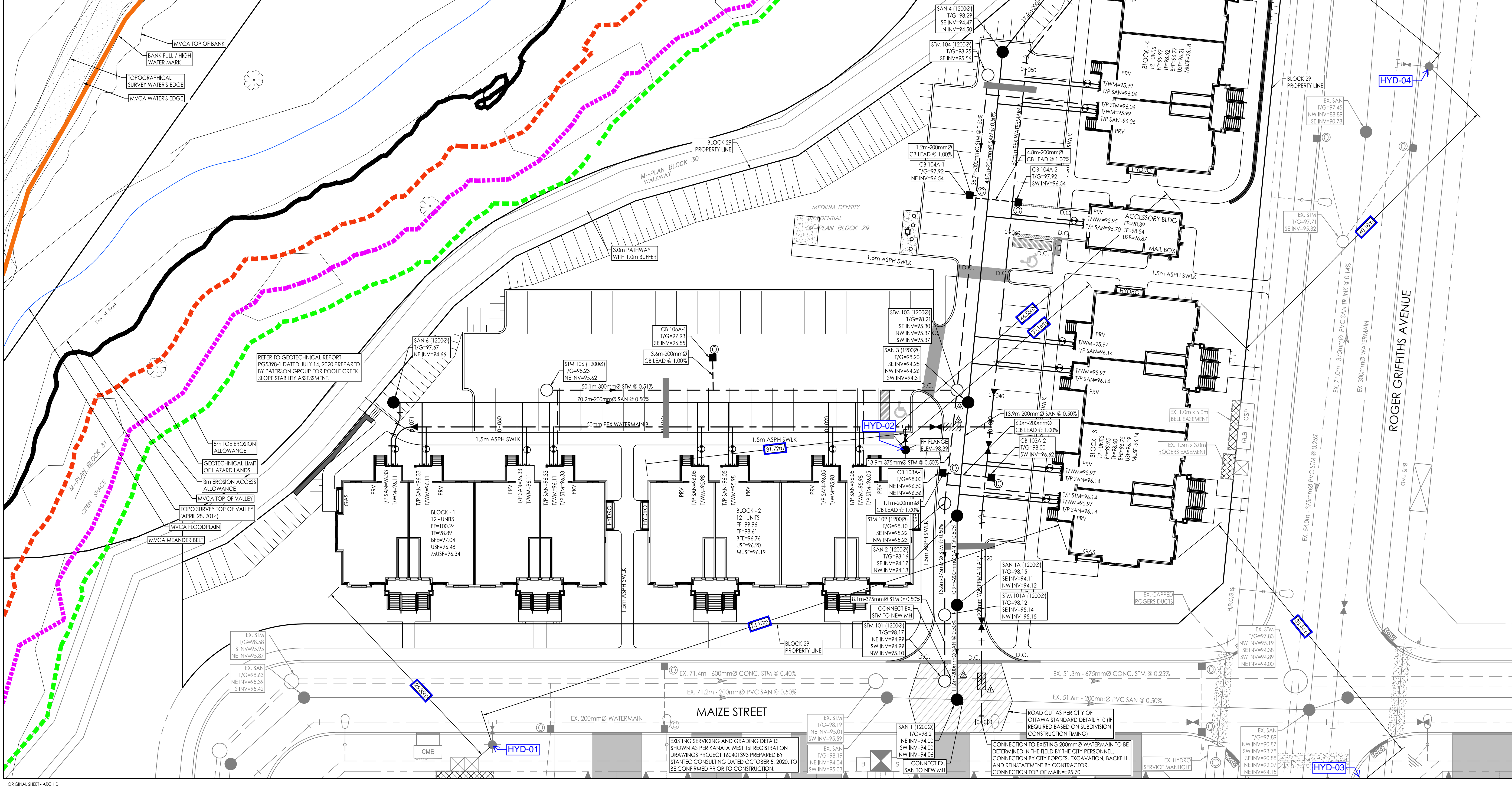

2021/10/15 11:00 AM T:\0160401608\160401608-D8.dwg  
 ORIGINAL SHEET - ARCH D