

**160401608 - Kanata West Block 29**  
**ICD Table**  
 Last updated on 2021-07-22 from PCSWMM model and drawings updated that same date

Area ID	CB Name	Diameter (mm)	Invert (m)	2-Year Head (m)	2-Year Flow (L/s)	100-Year Head (m)	100-Year Flow (L/s)	
L103A	L103A-1	83	96.50	0.85	12.3	1.63	17.3	
L103A	L103A-2	*CB L103A-1 and L103A-2 to be interconnected w/ single ICD at L103A-1						
L104A	L104A-1	83	96.54	0.91	12.8	1.54	16.8	
L104A	L104A-2	83	96.54	0.91	12.8	1.54	16.8	
L106A	L106A-1	152	96.55	0.84	40.2	1.54	55.6	

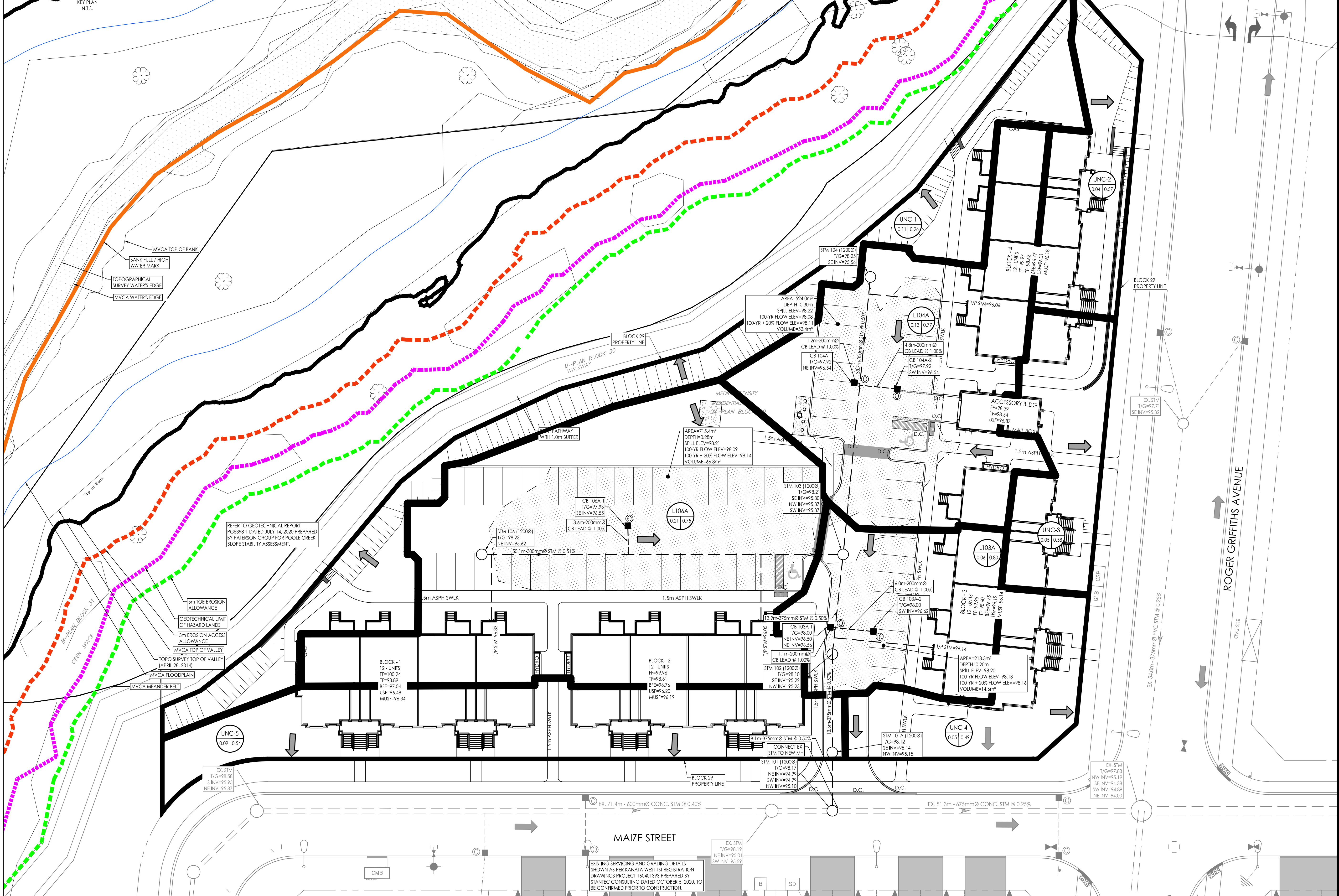

MAPLE GROVE ROAD

ROGER GRIFFITHS AVENUE

MAIZE STREET

Stantec Consulting Ltd.  
 400 - 1331 Clyde Avenue  
 Ottawa ON  
 Tel. 613.722.4420  
 www.stantec.com

Copyright Reserved  
 The Contractor shall verify and be responsible for all dimensions. DO NOT scale the drawing - any errors or omissions shall be reported to Stantec without delay.  
 The Copyrights to all designs and drawings are the property of Stantec. Reproduction or use for any purpose other than that authorized by Stantec is forbidden.

- Legend**
- 1-1 AREA ID
  - RUNOFF COEFFICIENT
  - STORM DRAINAGE AREA
  - STORM DRAINAGE BOUNDARY
  - EXISTING/FUTURE STORM DRAINAGE BOUNDARY
  - TYPICAL SERVICE LATERAL LOCATION
  - MAXIMUM PONDING LIMITS
  - PROPOSED STORM SEWER
  - PROPOSED CATCHBASIN
  - PROPOSED SUBDRAIN CATCHBASIN
  - EXISTING STORM SEWER
  - EXISTING CATCHBASIN
  - CIRCULAR ORIFICE (SEE DWG SD-1)

Revision	By	Appd.	Date
3	WAJ	TKR	21.10.15
2	WAJ	AMP	21.07.22
1	WAJ	AMP	21.03.25

File Name: 160401608-DB.dwg

Permit-Seal

Client/Project  
 RICHCRAFT GROUP OF COMPANIES  
 KANATA WEST BLOCK 29  
 OTTAWA, ON

Title  
 STORM DRAINAGE PLAN

Project No. 160401608  
 Drawing No. SD-1  
 Scale 1:250  
 Sheet 5 of 7  
 Revision 3  
 CITY PLAN No. 18439

I:\Projects\160401608\160401608-DB.dwg  
 2021/10/15 10:53 AM  
 ORIGINAL SHEET - ARCH D