

**NOTES:**

- DO NOT SCALE DRAWINGS;
- NOTES ARE APPLICABLE TO ALL DRAWINGS IN THE SET;
- Fotenn Consultants Inc. IS NOT RESPONSIBLE FOR ACCURACY OF BASE INFORMATION;
- REFER TO CIVIL ENGINEERING DRAWINGS FOR GRADING & SITE SERVICING INFORMATION;
- THE CONTRACTOR IS RESPONSIBLE FOR CONFIRMING SITE CONDITIONS AND REPORTING ANY DISCREPANCIES TO THE LANDSCAPE ARCHITECT;
- THE CONTRACTOR IS RESPONSIBLE FOR CONFIRMING EXACT LOCATIONS OF ALL UNDERGROUND SERVICES AND OBTAINING CLEARANCE FROM ALL APPLICABLE UTILITIES. PROPOSED WORKS FOUND TO BE IN CONFLICT WITH UNDERGROUND SERVICES MAY BE ADJUSTED AT THE DIRECTION OF THE LANDSCAPE ARCHITECT;
- LANDSCAPE ELEMENTS SHOWN ARE SUBJECT TO THE FINAL LOCATION OF UNDERGROUND SERVICES AND UTILITIES;
- DO NOT INSTALL TREES ON PROPERTY / LOT LINES OR WITHIN DRAINAGE EASEMENTS;
- PERFORM WORK IN ACCORDANCE WITH DETAILS AND SPECIFICATIONS;
- ALL PLANT MATERIAL SHALL BE No. 1 NURSERY STOCK AND SHALL MEET OR EXCEED THE SPECIFICATION OF THE Canadian Standards for Nursery Stock, AS PUBLISHED BY THE Canadian Nursery Landscape Association;
- SPECIES SUBSTITUTIONS ARE NOT PERMITTED WITHOUT PRIOR WRITTEN APPROVAL OF THE LANDSCAPE ARCHITECT;
- FENCING TO BE INSTALLED AT 100mm OFFSET FROM PROPERTY LINES AT SIDE AND REAR YARDS AS INDICATED;
- ALL UN-PAVED SURFACES TO RECEIVE 135mm DEPTH TOPSOIL & SOD.
- CITY OF OTTAWA STANDARDS FOR TREE PLANTING:**
- NO PLANTING ON CORNERS OR ANYWHERE WHERE IT WOULD CREATE A SIGHT LINE CONCERN;
- MAINTAIN A MINIMUM DISTANCE OF 4.5m FROM ALL BUILDINGS;
- MAINTAIN A MINIMUM DISTANCE OF 2.5m FROM THE CURB FOR DECIDUOUS TREES AND 4.5m FOR CONIFEROUS TREES;
- MAINTAIN A MINIMUM DISTANCE OF 1.5m FOR DECIDUOUS (4.5m FOR CONIFERS) FROM ANY SIDEWALK OR PRIVATE WALKWAY;
- MAINTAIN A MINIMUM DISTANCE OF 1.2m FROM ALL DRIVEWAYS;
- MAINTAIN A MINIMUM DISTANCE OF 2.5m FROM COMMUNITY MAILBOXES, LIGHT STANDARDS, FIRE HYDRANTS AND NO PLANTING IN FRONT OF HYDRANTS;
- MAINTAIN A MINIMUM DISTANCE OF 3.0m FROM ALL HYDRO TRANSFORMERS;
- MAINTAIN A MINIMUM DISTANCE OF 1.0m FROM ALL UNDERGROUND SERVICES;
- MAINTAIN A MINIMUM DISTANCE OF 1.0m FROM ALL BELL AND CABLE BOXES;
- MAINTAIN A MINIMUM DISTANCE OF 10.0 FROM BUS SHELTERS

**IMPORTANT NOTICE FOR CONTRACTOR:**

THE CITY OF OTTAWA REQUIRES A Certificate of Completion (F1) Landscape Works TO BE SUBMITTED AND SEALED BY THE LANDSCAPE ARCHITECT. CONTRACTORS ARE RESPONSIBLE FOR FAMILIARIZING THEMSELVES WITH THE REQUIREMENTS OF THIS PROCESS AND PROVIDING SUFFICIENT NOTICE TO THE LANDSCAPE ARCHITECT TO CONDUCT SITE REVIEWS DURING INSTALLATION OF TREES. THE 1 YEAR WARRANTY PERIOD SHALL NOT COMMENCE UNTIL THE LANDSCAPE ARCHITECT HAS SUBMITTED THE F1 Certificate.

PRIOR TO INSTALLATION OF TREES, THE DEVELOPER WILL CONTACT THE PLANNING AND GROWTH MANAGEMENT AND FORESTRY SERVICES TO REVIEW THE SPECIES AND LOCATION OF TREES.

SUBJECT TO THE CONDITIONS, IF ANY, SET FORTH IN OUR LETTER DATED March 10, 2022, THIS PLAN IS APPROVED BY THE CITY OF OTTAWA THIS 10 DAY OF MARCH, 2022.

*Court Curry*  
 COURT CURRY, MANAGER  
 DEVELOPMENT REVIEW WEST  
 PLANNING, REAL ESTATE AND ECONOMIC  
 DEVELOPMENT DEPARTMENT, CITY OF OTTAWA

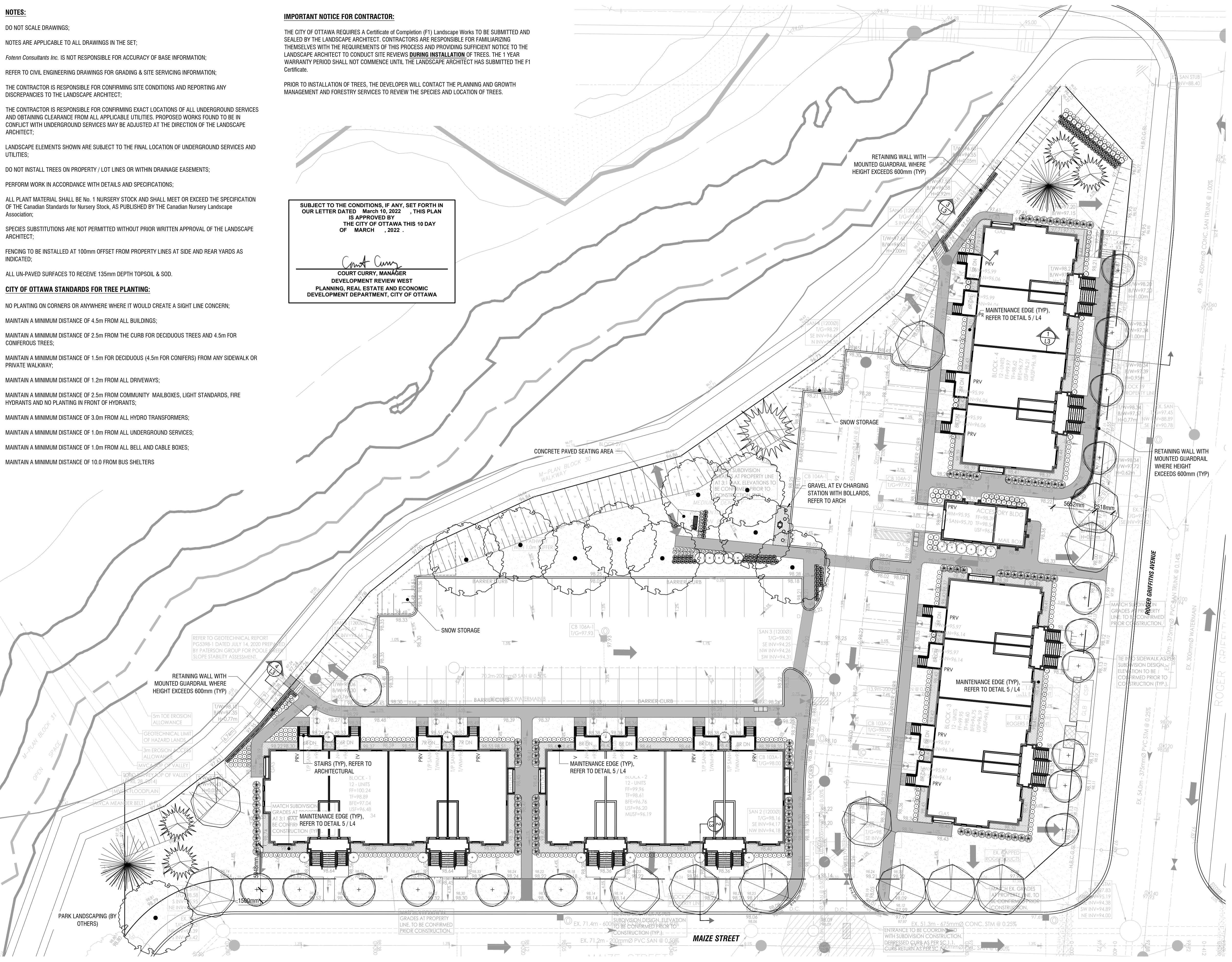

Copyright Reserved  
 The Copyrights to all designs and drawings are the property of Fotenn Consultants Inc. Unauthorized reproduction or use is forbidden. DO NOT SCALE DRAWING

Copyright réservés  
 Les droits d'auteur à tous les modèles et dessins sont la propriété de Fotenn Consultants Inc. Toute reproduction ou utilisation non autorisée est interdite. NE PAS L'ÉCHELLE DE DESSIN

Client / Client



key plan / plan repère

**PRELIMINARY**  
 NOT FOR CONSTRUCTION

legend / légende

- DECIDUOUS TREES (SEE PLANTING NOTES & SCHEDULE FOR SPECIES AND QUANTITIES) - REFER TO L2
- CONIFEROUS TREES (SEE PLANTING SCHEDULE FOR SPECIES AND QUANTITIES) - REFER TO L2
- SHRUBS AND PERENNIALS (SEE PLANTING NOTES & SCHEDULE FOR SPECIES AND QUANTITIES) - REFER TO L2
- ASPHALT PAVING
- NATIVE SEED MIX - OSC MIX 8130 - REFER TO L2
- SOD - REFER TO L2
- TYP. UNIVERSALLY ACCESSIBLE BENCH

rev/n	description / la description	yyyy/mm/dd
09	revised per 2nd technical circulation comments	2021/10/20
08	re-issued for SPA	2021/07/27
07	re-issued for SPA	2021/07/15
06	re-issued for SPA	2021/07/02
05	issued for SPA	2021/03/31
04	issued for Client Review	2021/03/26
03	issued for Client Review	2021/03/25
02	issued for Coordination	2020/12/22
01	issued for Coordination	2020/11/27
00	issued for Internal Review	2020/06/23

**FOTENN Planning + Design**  
 396 Cooper Street, Suite 300  
 Ottawa, ON, CANADA K2P 2H7  
 613.730.5709  
 fotenn.com

north / le nord stamp / le cachet

**BLOCK 29-KANATA WEST SUBDIVISION**

**LANDSCAPE PLAN**

designed / conçu	drawn / dessiné	reviewed / examiné
KP	PM/OM	KP
date	project number / No. du projet	
June 2020		
drawing number / No. du dessin		



**PRELIMINARY**  
 NOT FOR CONSTRUCTION

- DECIDUOUS TREES (SEE PLANTING NOTES & SCHEDULE FOR SPECIES AND QUANTITIES)
- CONIFEROUS TREES (SEE PLANTING SCHEDULE FOR SPECIES AND QUANTITIES)
- SHRUBS AND PERENNIALS (SEE PLANTING NOTES & SCHEDULE FOR SPECIES AND QUANTITIES)
- PLANT KEY
- ASPHALT PAVING
- NATIVE SEED MIX - OSC MIX 8130
- SOD
- TYP. UNIVERSALLY ACCESSIBLE BENCH

09	revised per 2nd technical circulation comments	2021/10/20
08	re-issued for SPA	2021/07/27
07	re-issued for SPA	2021/07/15
06	re-issued for SPA	2021/07/02
05	issued for SPA	2021/03/31
04	issued for Client Review	2021/03/26
03	issued for Client Review	2021/03/25
02	issued for Coordination	2020/12/22
01	issued for Coordination	2020/11/27
00	issued for Internal Review	2020/06/23

rev'n description / la description      yyyy/mm/dd

**FOTENN Planning + Design**  
 396 Cooper Street, Suite 300      613.730.5709  
 Ottawa, ON, CANADA K2P 2H7      fotenn.com



**BLOCK 29-  
 KANATA WEST SUBDIVISION**

**PLANTING PLAN**

designed / conçu <b>KP</b>	drawn / dessiné <b>PM/OM</b>	reviewed / examiné <b>KP</b>
date <b>June 2020</b>	project number / No. du projet	
drawing number / No. du dessin		

**PLANTING SCHEDULE**

KEY	QTY.	BOTANICAL NAME	COMMON NAME	SIZE / CONDITION / SPACING
<b>DECIDUOUS TREES (large)</b>				
AS	3	Acer saccharinum	Silver Maple	70mm cal. / W.B.
GD	2	Gymnocladus dioicus	Kentucky Coffee Tree	70mm cal. / W.B.
QP	3	Quercus palustris	Pin Oak	70mm cal. / W.B.
QR	2	Quercus rubra	Red Oak	70mm cal. / W.B.
<b>DECIDUOUS TREES (medium)</b>				
AG	5	Aesculus glabra	Ohio Buckeye	50mm cal. W.B.
SD	7	Sorbus decora	Showy Mountain Ash	40mm cal. / W.B. (tree form)
<b>DECIDUOUS TREES (small)</b>				
AC	3	Amelanchier canadensis	Serviceberry	50mm cal. / W.B. (tree form)
CC	5	Carpinus Caroliniana	Blue Beech	50mm cal. / W.B. (tree form)
PV	9	Prunus virginiana	Common Chokecherry	50mm cal. / W.B. (tree form)
<b>CONIFEROUS TREES</b>				
PP	4	Picea pungens	Blue Spruce	175cm ht. / W.B.
PS	2	Pinus strobus	Eastern White Pine	175cm ht. / W.B.
TC	1	Tsuga canadensis	Canadian Hemlock (Eastern Hemlock)	175cm ht. / W.B.
<b>CONIFEROUS SHRUBS</b>				
Jc	15	Juniperus communis 'Gold Cone'	Gold Cone Juniper	100cm ht. / W.B.
Jh	36	Juniperus horizontalis 'Gold Strike'	Gold Strike Creeping Juniper	70cm o.c.
Tm	20	Taxus x media 'Hicksii'	Hick's Yew	100cm ht. / W.B.
<b>DECIDUOUS SHRUBS</b>				
Ea	99	Euonymus alatus 'Little Moses' (Odom)	Little Moses Burning Bush	100cm o.c.
<b>PERENNIALS AND GRASSES</b>				
ag	5	Andropogon gerardii	Big Blue Stem	#2 Pot / 50cm o.c.
ca	76	Calamagrostis acutiflora 'Karl Foerster'	Feather Reed Grass	#2 Pot / 50cm o.c.
heg	122	Hemerocallis 'Gentle Shepherd'	Gentle Shepherd Daylily	#1 Pot / 60cm o.c.
her	97	Hemerocallis 'Rocket City'	Rocket City Daylily	#1 Pot / 60cm o.c.
hes	75	Hemerocallis 'Ruby Stella'	Ruby Stella Daylily	#1 Pot / 60cm o.c.
pa	14	Perovskia atriplicifolia	Russian Sage	#2 Pot / 50cm o.c.
rh	30	Rudbeckia hirta	Black-eyed Susan	#1 Pot / 50cm o.c.

SUBJECT TO THE CONDITIONS, IF ANY, SET FORTH IN OUR LETTER DATED March 10, 2022, THIS PLAN IS APPROVED BY THE CITY OF OTTAWA THIS 10 DAY OF MARCH, 2022.

*Court Curry*

COURT CURRY, MANAGER  
 DEVELOPMENT REVIEW WEST  
 PLANNING, REAL ESTATE AND ECONOMIC  
 DEVELOPMENT DEPARTMENT, CITY OF OTTAWA

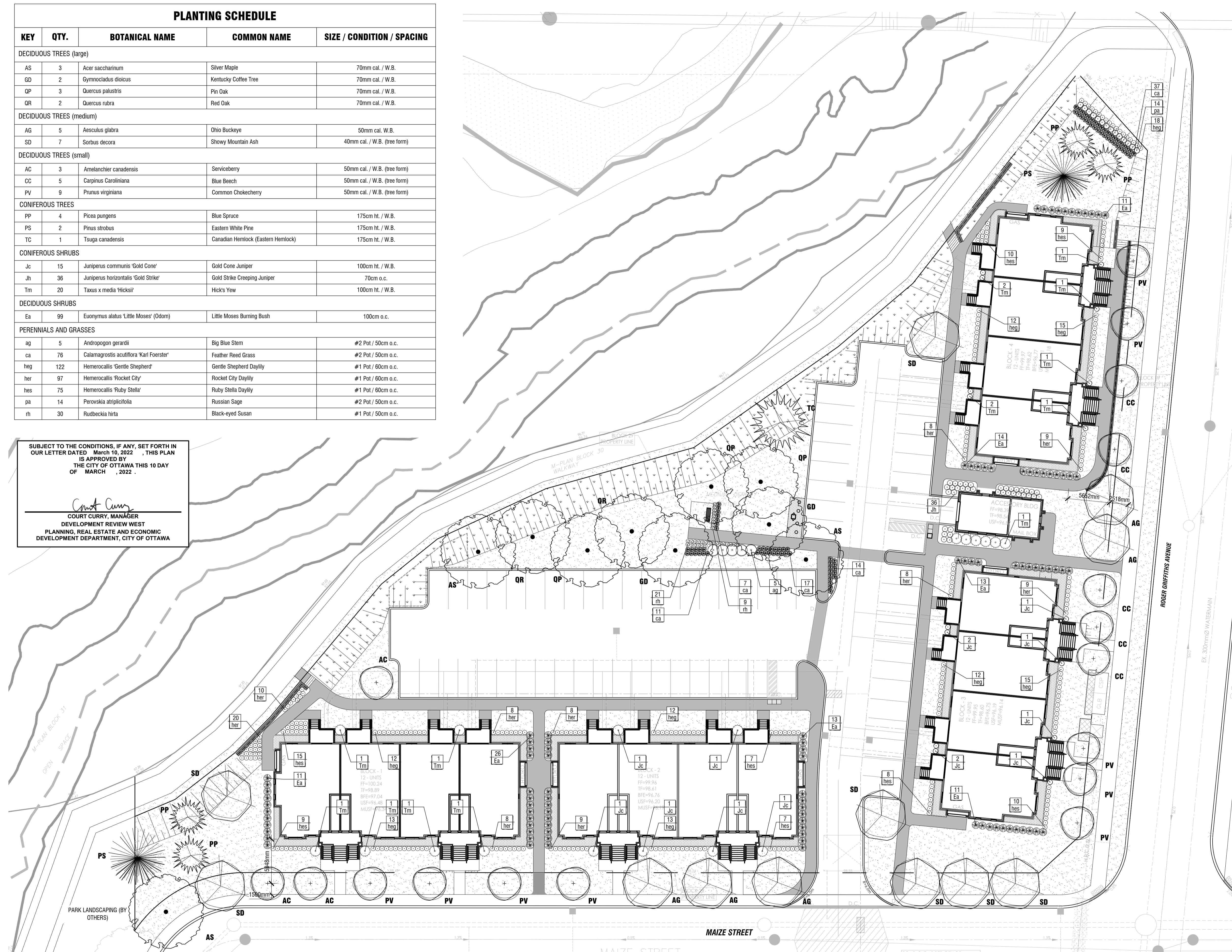



**PRELIMINARY**  
 NOT FOR CONSTRUCTION

SUBJECT TO THE CONDITIONS, IF ANY, SET FORTH IN OUR LETTER DATED March 10, 2022, THIS PLAN IS APPROVED BY THE CITY OF OTTAWA THIS 10 DAY OF MARCH, 2022.

*Court Curry*  
 COURT CURRY, MANAGER  
 DEVELOPMENT REVIEW WEST  
 PLANNING, REAL ESTATE AND ECONOMIC  
 DEVELOPMENT DEPARTMENT, CITY OF OTTAWA

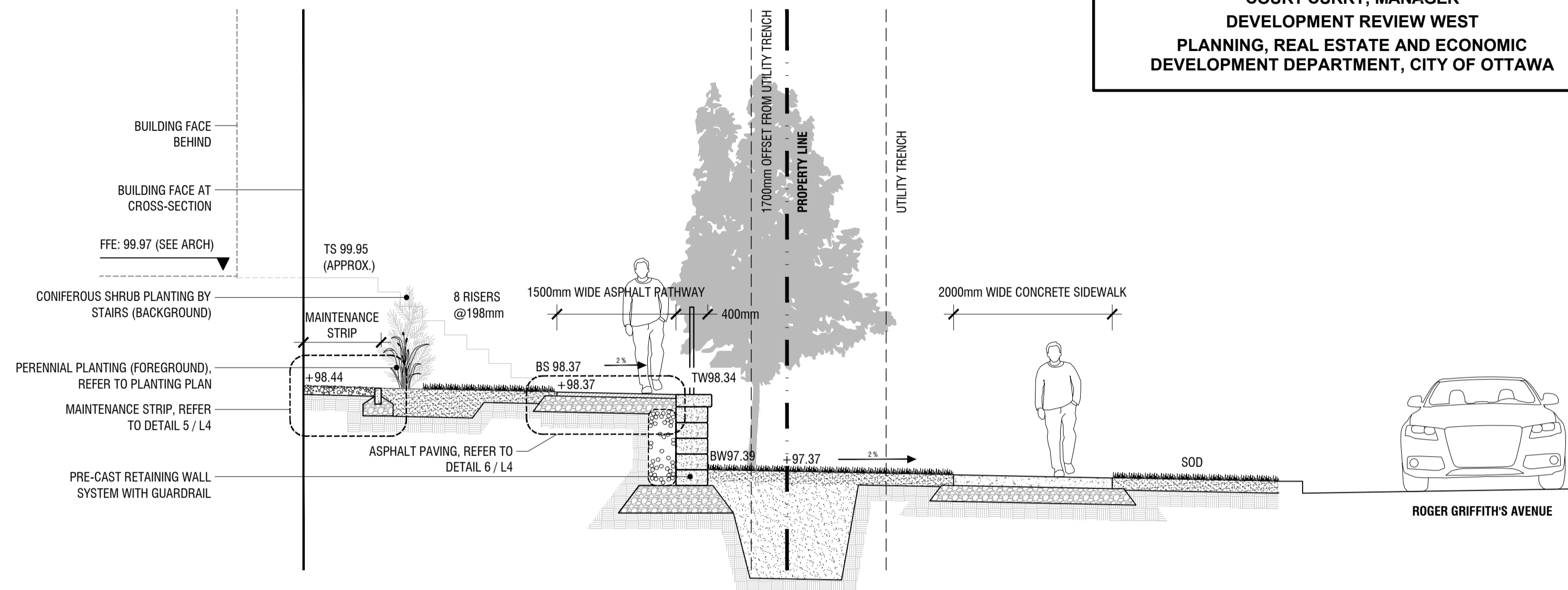

**1** CROSS-SECTION: BLOCK 4  
**L3** 1:50

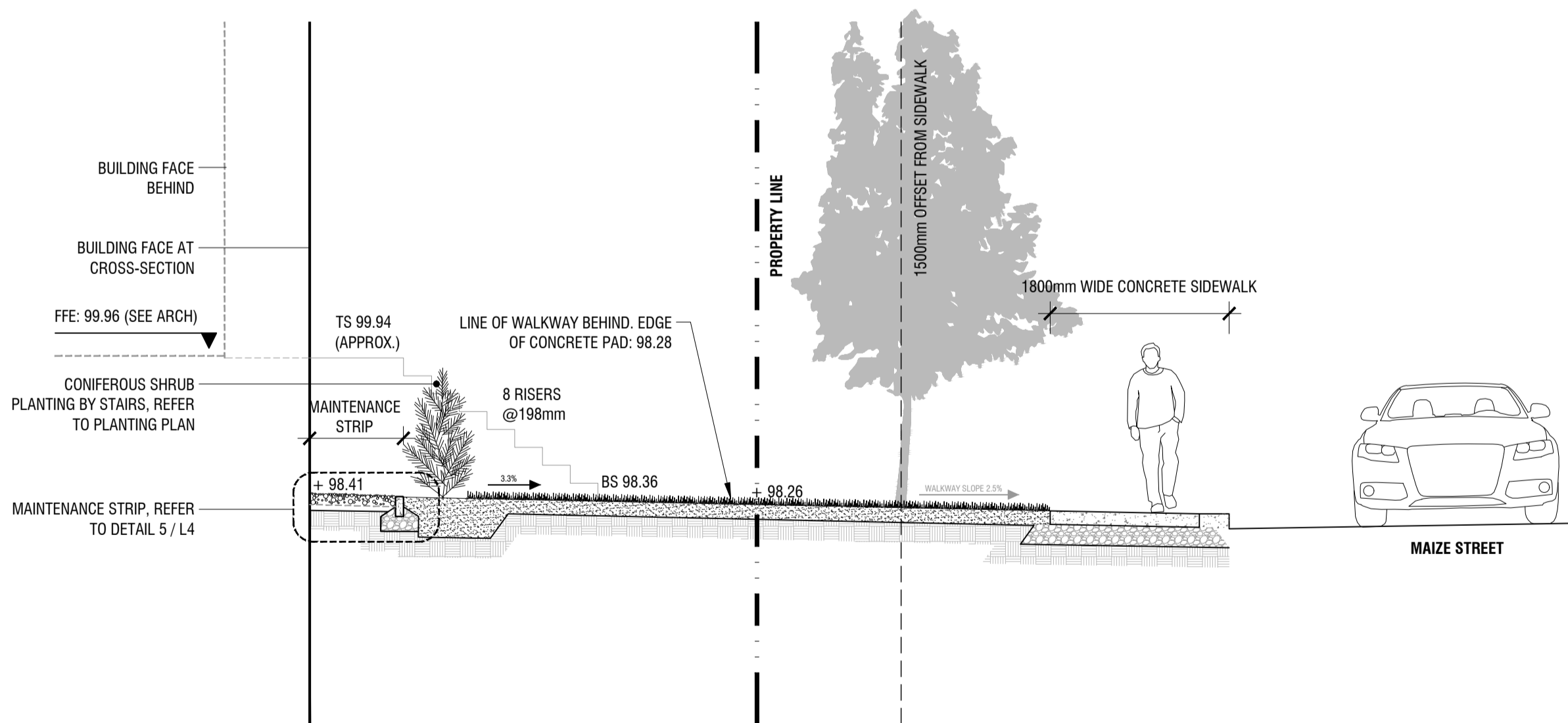

**2** CROSS-SECTION: BLOCKS 1-3 (TYP)  
**L3** 1:50

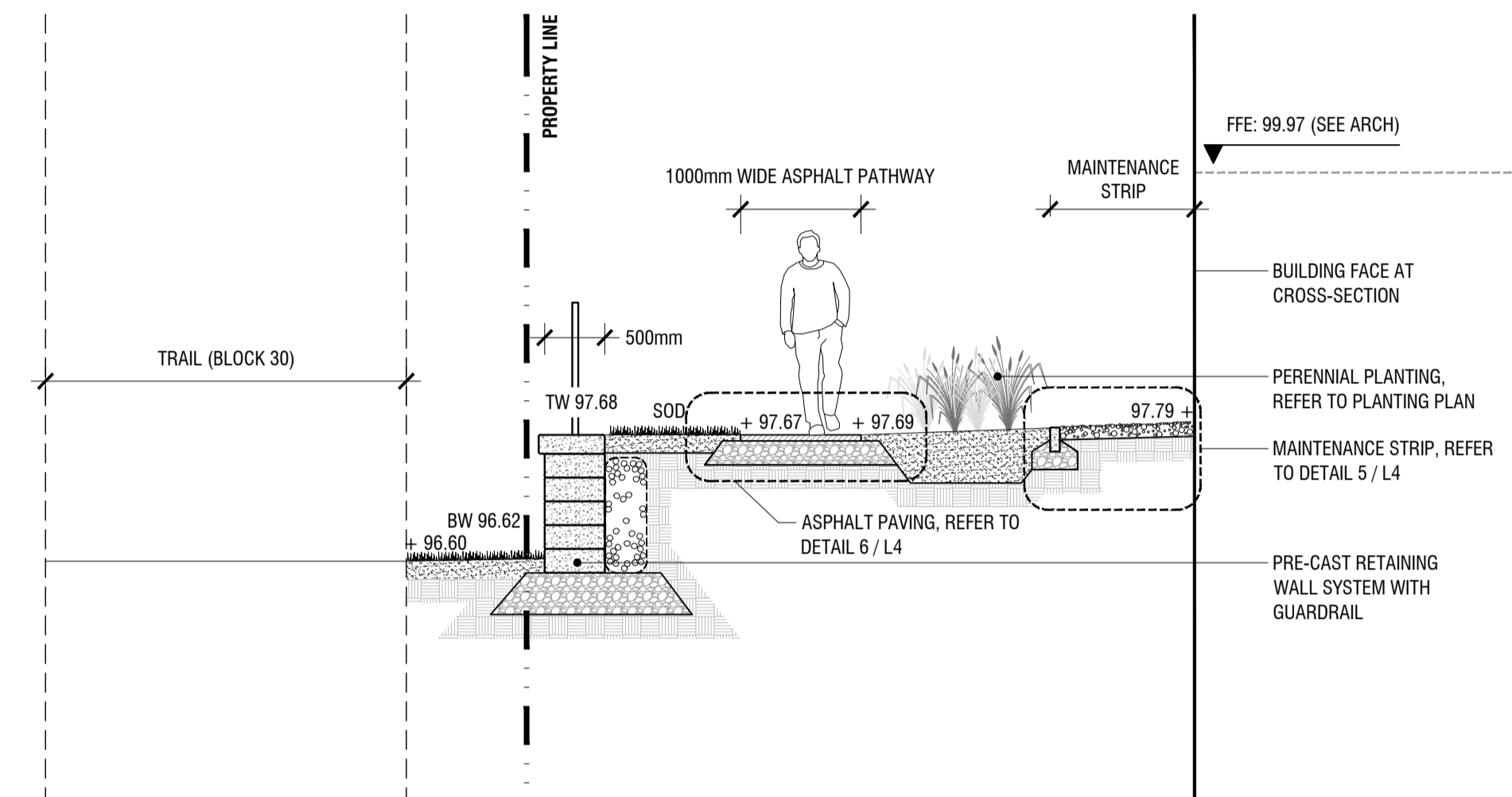

**3** CROSS-SECTION: NORTH RETAINING WALL  
**L3** 1:50

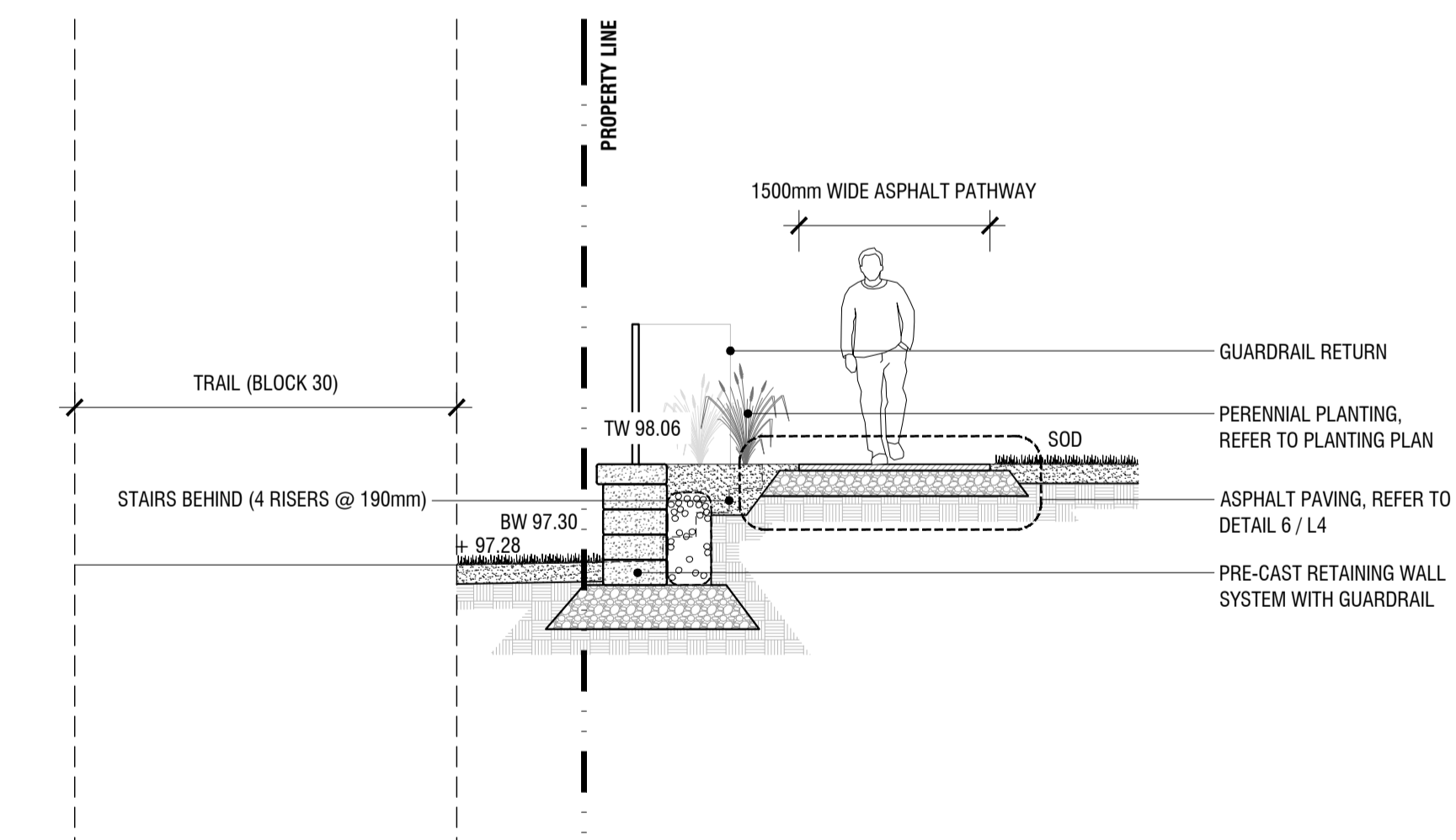

**4** CROSS-SECTION: SOUTH RETAINING WALL  
**L3** 1:50

rev'n	description / la description	yyyy/mm/dd
09	revised per 2nd technical circulation comments	2021/10/20
08	re-issued for SPA	2021/07/27
07	re-issued for SPA	2021/07/15
06	re-issued for SPA	2021/07/02
05	issued for SPA	2021/03/31
04	issued for Client Review	2021/03/26
03	issued for Client Review	2021/03/25
02	issued for Coordination	2020/12/22
01	issued for Coordination	2020/11/27
00	issued for Internal Review	2020/06/23

**FOTENN Planning + Design**  
 306 Cooper Street, Suite 300  
 Ottawa, ON, CANADA K2P 2H7  
 613.730.5709  
 fotenn.com

north / le nord stamp / le cachet

project / projet  
**BLOCK 29-  
 KANATA WEST SUBDIVISION**

drawing / dessin  
**SECTIONS**

designed / conçu	drawn / dessiné	reviewed / examiné
<b>KP</b>	<b>PM/OM</b>	<b>KP</b>
date	project number / No. du projet	
<b>June 2020</b>		



**PRELIMINARY**  
 NOT FOR CONSTRUCTION

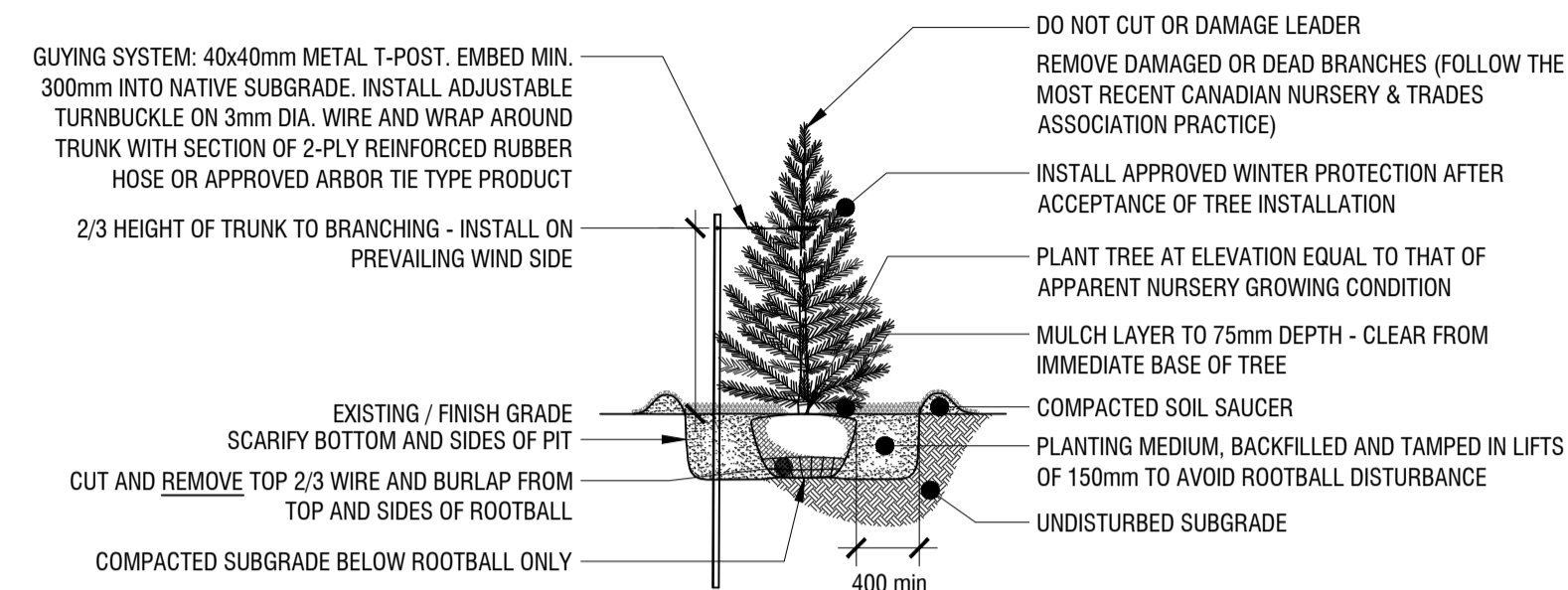
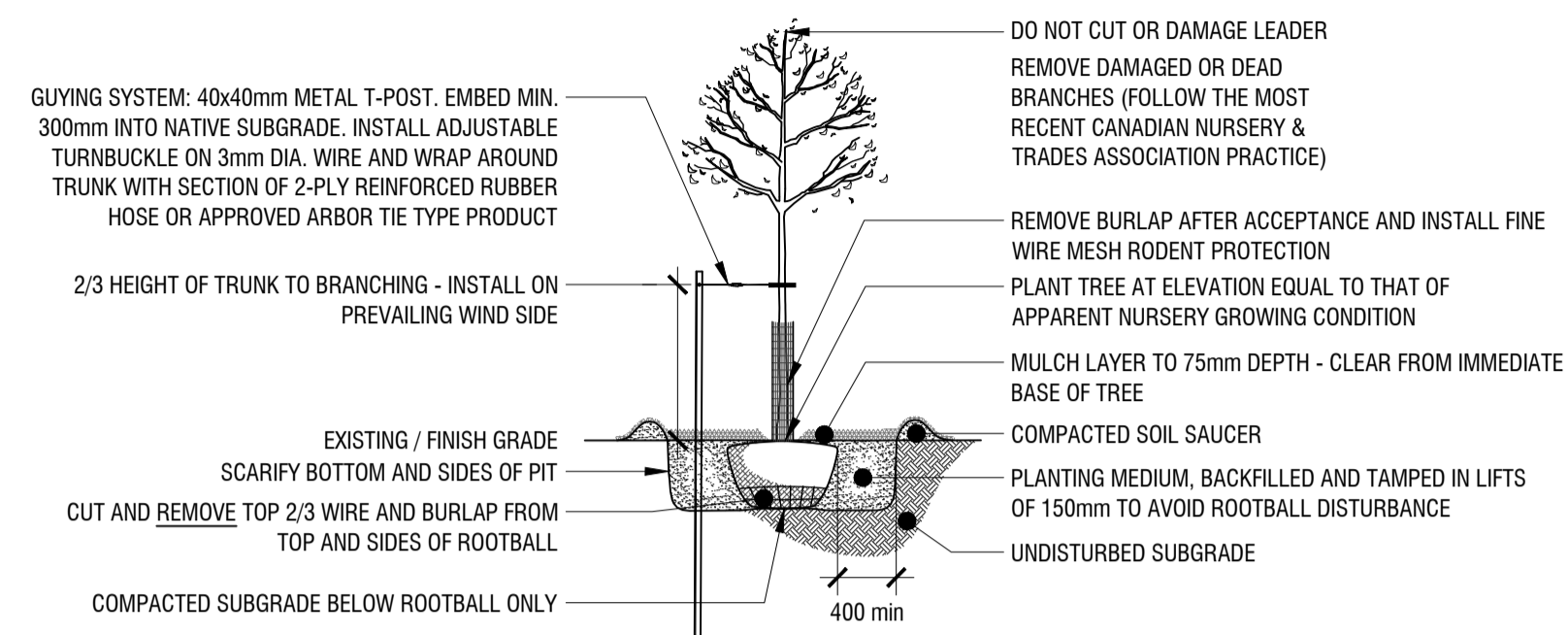

**1 DECIDUOUS TREE PLANTING DETAIL**

L4 n.t.s.

**2 CONIFEROUS TREE PLANTING DETAIL**

L4 n.t.s.

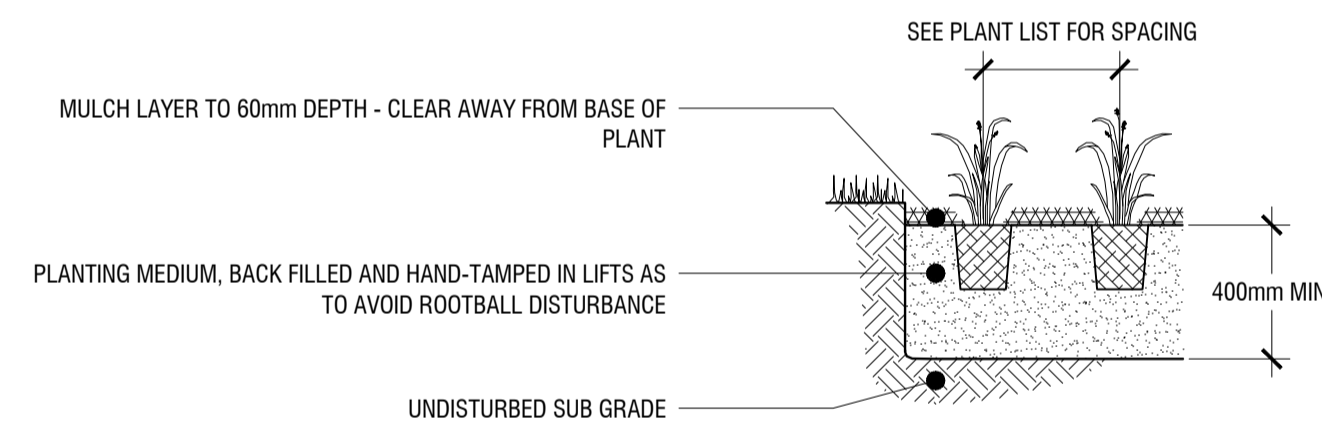
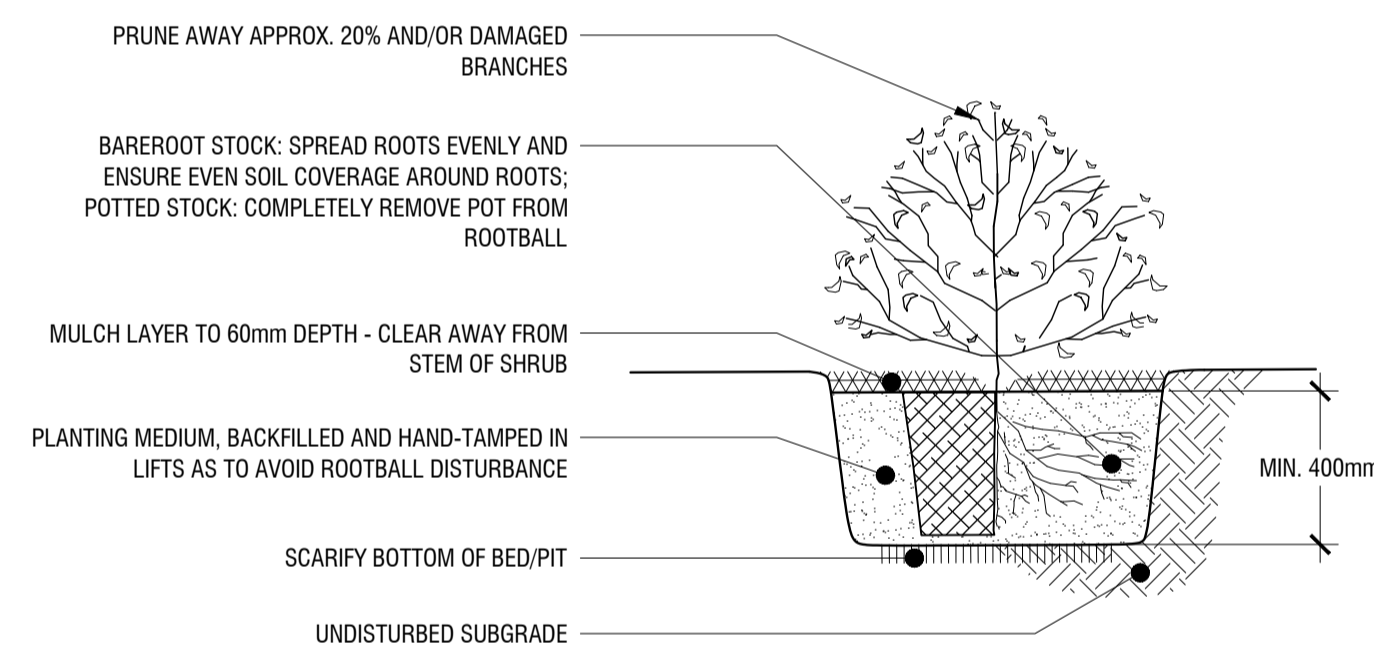

**3 SHRUB PLANTING DETAIL**

L4 n.t.s.

**4 PERENNIAL, GRASSES, AND GROUNDCOVER PLANTING**

L4 n.t.s.

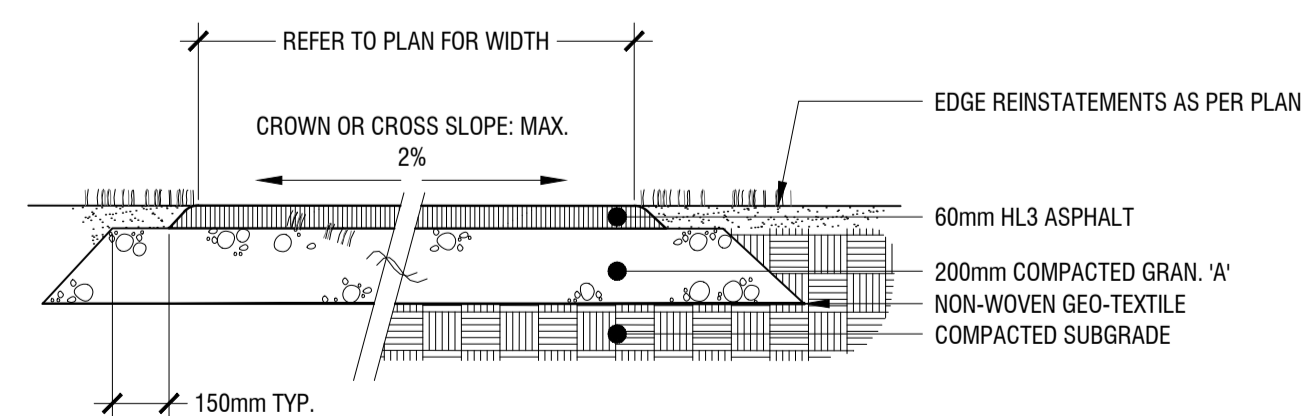
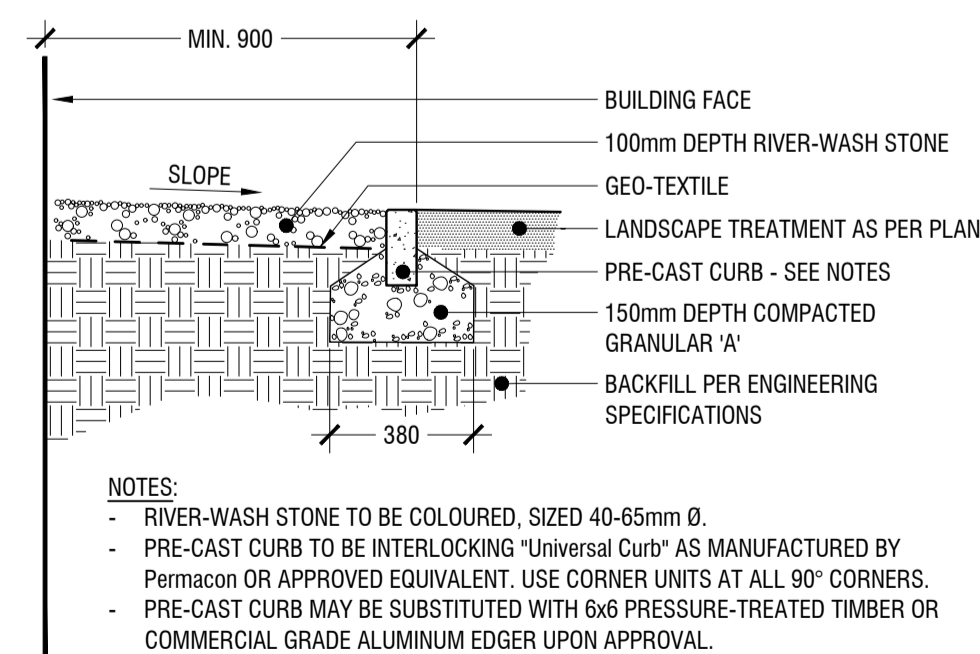

**5 MAINTENANCE EDGE**

L4 n.t.s.

**6 ASPHALT PAVING**

L4 n.t.s.

SUBJECT TO THE CONDITIONS, IF ANY, SET FORTH IN OUR LETTER DATED March 10, 2022, THIS PLAN IS APPROVED BY THE CITY OF OTTAWA THIS 10 DAY OF MARCH, 2022.

*Court Curry*  
 COURT CURRY, MANAGER  
 DEVELOPMENT REVIEW WEST  
 PLANNING, REAL ESTATE AND ECONOMIC  
 DEVELOPMENT DEPARTMENT, CITY OF OTTAWA



project / projet

**BLOCK 29-  
 KANATA WEST SUBDIVISION**

drawing / dessin

**CONSTRUCTION DETAILS**

designed / conçu <b>KP</b>	drawn / dessiné <b>PM/OM</b>	reviewed / examiné <b>KP</b>
date <b>June 2020</b>	project number / No. du projet	
drawing number / No. du dessin		

09	revised per 2nd technical circulation comments	2021/10/20
08	re-issued for SPA	2021/07/27
07	re-issued for SPA	2021/07/15
06	re-issued for SPA	2021/07/02
05	issued for SPA	2021/03/31
04	issued for Client Review	2021/03/26
03	issued for Client Review	2021/03/25
02	issued for Coordination	2020/12/22
01	issued for Coordination	2020/11/27
00	issued for Internal Review	2020/06/23
rev'n	description / la description	yyyy/mm/dd