

NOTES:

- DO NOT SCALE DRAWINGS;
- NOTES ARE APPLICABLE TO ALL DRAWINGS IN THE SET;
- Fotenn Consultants Inc. IS NOT RESPONSIBLE FOR ACCURACY OF BASE INFORMATION;
- REFER TO CIVIL ENGINEERING DRAWINGS FOR GRADING & SITE SERVICING INFORMATION;
- THE CONTRACTOR IS RESPONSIBLE FOR CONFIRMING SITE CONDITIONS AND REPORTING ANY DISCREPANCIES TO THE LANDSCAPE ARCHITECT;
- THE CONTRACTOR IS RESPONSIBLE FOR CONFIRMING EXACT LOCATIONS OF ALL UNDERGROUND SERVICES AND OBTAINING CLEARANCE FROM ALL APPLICABLE UTILITIES. PROPOSED WORKS FOUND TO BE IN CONFLICT WITH UNDERGROUND SERVICES MAY BE ADJUSTED AT THE DIRECTION OF THE LANDSCAPE ARCHITECT;
- LANDSCAPE ELEMENTS SHOWN ARE SUBJECT TO THE FINAL LOCATION OF UNDERGROUND SERVICES AND UTILITIES;
- DO NOT INSTALL TREES ON PROPERTY / LOT LINES OR WITHIN DRAINAGE EASEMENTS;
- PERFORM WORK IN ACCORDANCE WITH DETAILS AND SPECIFICATIONS;
- ALL PLANT MATERIAL SHALL BE No. 1 NURSERY STOCK AND SHALL MEET OR EXCEED THE SPECIFICATION OF THE Canadian Standards for Nursery Stock, AS PUBLISHED BY THE Canadian Nursery Landscape Association;
- SPECIES SUBSTITUTIONS ARE NOT PERMITTED WITHOUT PRIOR WRITTEN APPROVAL OF THE LANDSCAPE ARCHITECT;
- FENCING TO BE INSTALLED AT 100mm OFFSET FROM PROPERTY LINES AT SIDE AND REAR YARDS AS INDICATED;
- ALL UN-PAVED SURFACES TO RECEIVE 135mm DEPTH TOPSOIL & SOD.
- CITY OF OTTAWA STANDARDS FOR TREE PLANTING:**
- NO PLANTING ON CORNERS OR ANYWHERE WHERE IT WOULD CREATE A SIGHT LINE CONCERN;
- MAINTAIN A MINIMUM DISTANCE OF 4.5m FROM ALL BUILDINGS;
- MAINTAIN A MINIMUM DISTANCE OF 2.5m FROM THE CURB FOR DECIDUOUS TREES AND 4.5m FOR CONIFEROUS TREES;
- MAINTAIN A MINIMUM DISTANCE OF 1.5m FOR DECIDUOUS (4.5m FOR CONIFERS) FROM ANY SIDEWALK OR PRIVATE WALKWAY;
- MAINTAIN A MINIMUM DISTANCE OF 1.2m FROM ALL DRIVEWAYS;
- MAINTAIN A MINIMUM DISTANCE OF 2.5m FROM COMMUNITY MAILBOXES, LIGHT STANDARDS, FIRE HYDRANTS AND NO PLANTING IN FRONT OF HYDRANTS;
- MAINTAIN A MINIMUM DISTANCE OF 3.0m FROM ALL HYDRO TRANSFORMERS;
- MAINTAIN A MINIMUM DISTANCE OF 1.0m FROM ALL UNDERGROUND SERVICES;
- MAINTAIN A MINIMUM DISTANCE OF 1.0m FROM ALL BELL AND CABLE BOXES;
- MAINTAIN A MINIMUM DISTANCE OF 10.0 FROM BUS SHELTERS

IMPORTANT NOTICE FOR CONTRACTOR:

THE CITY OF OTTAWA REQUIRES A Certificate of Completion (F1) Landscape Works TO BE SUBMITTED AND SEALED BY THE LANDSCAPE ARCHITECT. CONTRACTORS ARE RESPONSIBLE FOR FAMILIARIZING THEMSELVES WITH THE REQUIREMENTS OF THIS PROCESS AND PROVIDING SUFFICIENT NOTICE TO THE LANDSCAPE ARCHITECT TO CONDUCT SITE REVIEWS **DURING INSTALLATION** OF TREES. THE 1 YEAR WARRANTY PERIOD SHALL NOT COMMENCE UNTIL THE LANDSCAPE ARCHITECT HAS SUBMITTED THE F1 Certificate.

PRIOR TO INSTALLATION OF TREES, THE DEVELOPER WILL CONTACT THE PLANNING AND GROWTH MANAGEMENT AND FORESTRY SERVICES TO REVIEW THE SPECIES AND LOCATION OF TREES.

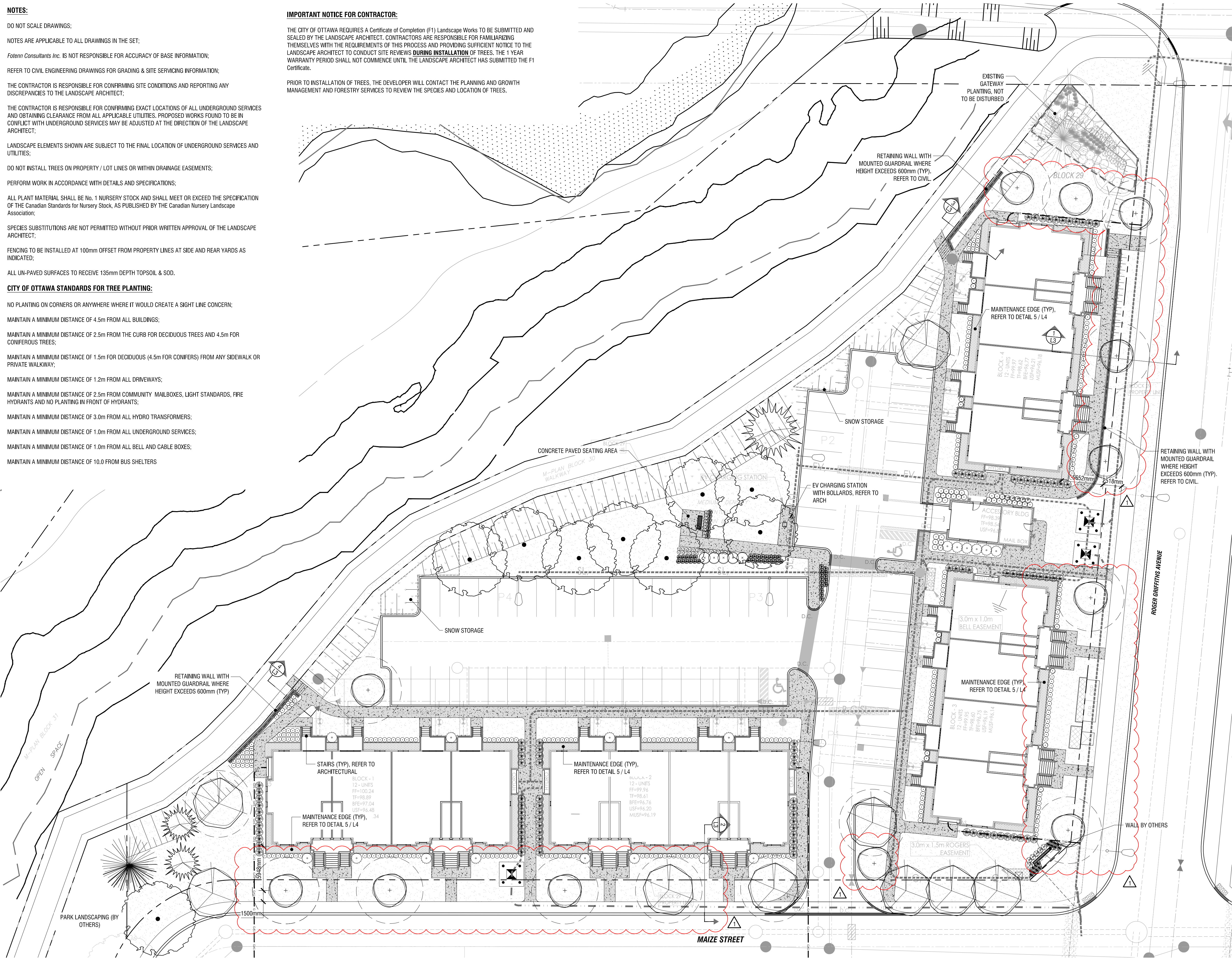

Copyright Reserved
The Copyrights to all designs and drawings are the property of Fotenn Consultants Inc. Unauthorized reproduction or use is forbidden. DO NOT SCALE DRAWING

Copyright réservés
Les droits d'auteur à tous les modèles et dessins sont la propriété de Fotenn Consultants Inc. Reproduction ou utilisation non autorisée est interdite. NE PAS L'ÉCHELLE DE DESSIN

Client / Client



legend / légende

- DECIDUOUS TREES (SEE PLANTING NOTES & SCHEDULE FOR SPECIES AND QUANTITIES) - REFER TO L2
- CONIFEROUS TREES (SEE PLANTING SCHEDULE FOR SPECIES AND QUANTITIES) - REFER TO L2
- SHRUBS AND PERENNIALS (SEE PLANTING NOTES & SCHEDULE FOR SPECIES AND QUANTITIES) - REFER TO L2
- CONCRETE PAVING
- NATIVE SEED MIX - OSC MIX 8130 - REFER TO L2
- SOD - REFER TO L2
- TYP. UNIVERSALLY ACCESSIBLE BENCH
- 4.5m RADIUS OFFSET

14	re-IFC - tree removal in streetscape due to stair conflict	2025/03/26
13	Issued for Construction	2025/02/19
12	Issued for Client Review	2024/10/28
11	revised per engineering coordination	2022/06/14
10	revised per engineering coordination	2022/03/08
09	revised per 2nd technical circulation comments	2021/10/20
08	re-issued for SPA	2021/07/27
07	re-issued for SPA	2021/07/15
06	re-issued for SPA	2021/07/02
05	issued for SPA	2021/03/31
04	issued for Client Review	2021/03/26
03	issued for Client Review	2021/03/25
02	issued for Coordination	2020/12/22
rev/n	description / la description	yyyy/mm/dd

FOTENN Planning + Design
420 O'Connor Street
Ottawa, ON, CANADA K2P 1W4
613.730.5709
fotenn.com

north / le nord

stamp / le cachet



project / projet

**BLOCK 29-
KANATA WEST SUBDIVISION**

drawing / dessin

LANDSCAPE PLAN

designed / conçu KP	drawn / dessiné PM/OM	reviewed / examiné KP
date Feb 2025	project number / No. du projet	
drawing number / No. du dessin		

L1 of 4

PLANTING SCHEDULE				
KEY	QTY.	BOTANICAL NAME	COMMON NAME	SIZE / CONDITION / SPACING
DECIDUOUS TREES (large)				
AS	2	Acer saccharinum	Silver Maple	70mm cal. / W.B.
GD	2	Gymnocladus dioicus	Kentucky Coffee Tree	70mm cal. / W.B.
QP	3	Quercus palustris	Pin Oak	70mm cal. / W.B.
QR	2	Quercus rubra	Red Oak	70mm cal. / W.B.
DECIDUOUS TREES (medium)				
AG	2	Aesculus glabra	Ohio Buckeye	50mm cal. W.B.
SD	7	Sorbus decora	Showy Mountain Ash	40mm cal. / W.B. (tree form)
DECIDUOUS TREES (small)				
AC	4	Amelanchier canadensis	Serviceberry	50mm cal. / W.B. (tree form)
CC	4	Carpinus caroliniana	Blue Beech	50mm cal. / W.B. (tree form)
PV	4	Prunus virginiana	Common Chokecherry	50mm cal. / W.B. (tree form)
CONIFEROUS TREES				
PP	2	Picea pungens	Blue Spruce	175cm ht. / W.B.
PS	1	Pinus strobus	Eastern White Pine	175cm ht. / W.B.
TC	1	Tsuga canadensis	Canadian Hemlock (Eastern Hemlock)	175cm ht. / W.B.
CONIFEROUS SHRUBS				
Jc	15	Juniperus communis 'Gold Cone'	Gold Cone Juniper	#3 Pot
Jh	36	Juniperus horizontalis 'Gold Strike'	Gold Strike Creeping Juniper	#3 Pot / 70cm o.c.
Jh1	16	Juniperus horizontalis 'Blue Chip'	Blue Chip Juniper	#3 Pot / 60cm spread
Tm	18	Taxus x media 'Hicksii'	Hick's Yew	100cm ht. BBC
DECIDUOUS SHRUBS				
Ca	6	Cornus alba 'Prairie Fire'	Prairie Fire Dogwood	#3 Pot / Potted
Ea	99	Euonymus alatus 'Little Moses' (Odom)	Little Moses Burning Bush	#3 Pot / 100cm o.c.
PERENNIALS AND GRASSES				
ag	5	Andropogon gerardii	Big Blue Stem	#2 Pot / 50cm o.c.
ca	53	Calamagrostis acutiflora 'Karl Foerster'	Feather Reed Grass	#2 Pot / 50cm o.c.
heg	104	Hemerocallis 'Gentle Shepherd'	Gentle Shepherd Daylily	#1 Pot / 60cm o.c.
her	97	Hemerocallis 'Rocket City'	Rocket City Daylily	#1 Pot / 60cm o.c.
hes	75	Hemerocallis 'Ruby Stella'	Ruby Stella Daylily	#1 Pot / 60cm o.c.
pl	15	Pennisetum alopecuroides 'Little Bunny'	Little Bunny Dwarf Fountain Grass	#1 Pot / 30cm o/c
rh	56	Rudbeckia hirta	Black-eyed Susan	#1 Pot / 50cm o.c.

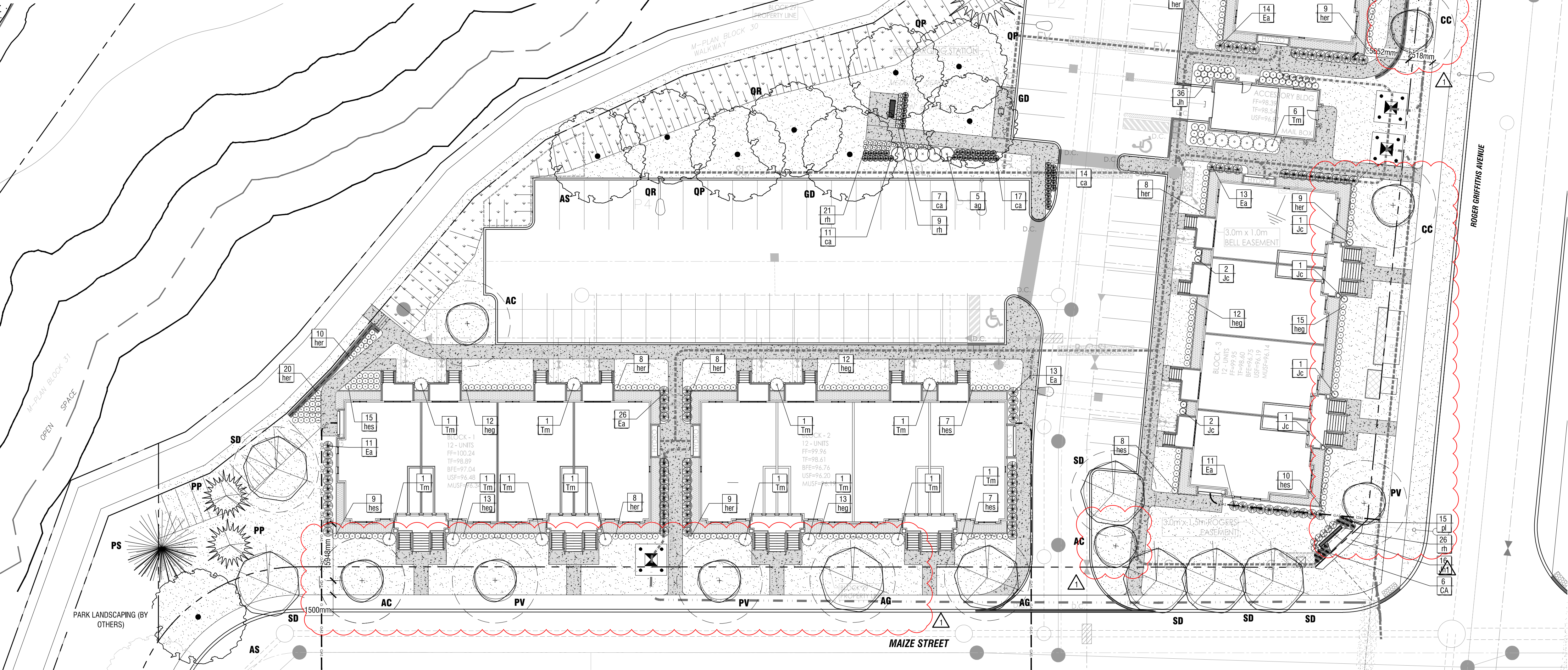

- DECIDUOUS TREES (SEE PLANTING SCHEDULE FOR SPECIES AND QUANTITIES)
- CONIFEROUS TREES (SEE PLANTING SCHEDULE FOR SPECIES AND QUANTITIES)
- SHRUBS AND PERENNIALS (SEE PLANTING NOTES & SCHEDULE FOR SPECIES AND QUANTITIES)
- EXISTING GATEWAY PLANTING TO BE RETAINED
- PLANT KEY
- CONCRETE PAVING
- NATIVE SEED MIX - OSC MIX 8130
- SOD
- TYP. UNIVERSALLY ACCESSIBLE BENCH
- 4.5m RADIUS OFFSET

14	re-IFC - tree removal in streetscape due to stair conflict	2025/03/26
13	Issued for Construction	2025/02/19
12	Issued for Client Review	2024/10/28
11	revised per engineering coordination	2022/06/14
10	revised per engineering coordination	2022/03/08
09	revised per 2nd technical circulation comments	2021/10/20
08	re-issued for SPA	2021/07/27
07	re-issued for SPA	2021/07/15
06	re-issued for SPA	2021/07/02
05	issued for SPA	2021/03/31
04	issued for Client Review	2021/03/26
03	issued for Client Review	2021/03/25
02	issued for Coordination	2020/12/22
rev/n	description / la description	yyyy/mm/dd

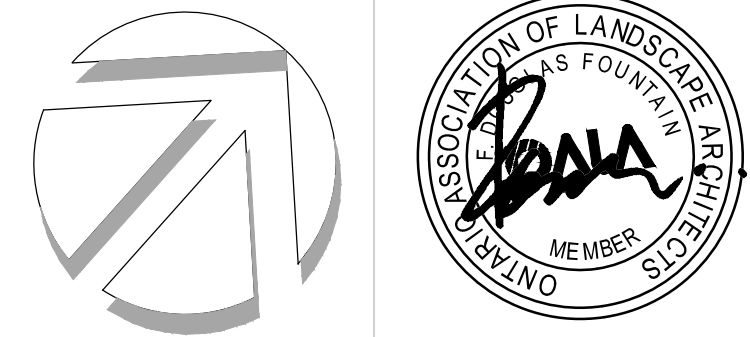

**BLOCK 29-
KANATA WEST SUBDIVISION**

PLANTING PLAN

designed / conçu KP	drawn / dessiné PM/OM	reviewed / examiné KP
date Feb 2025	project number / No. du projet	
drawing number / No. du dessin		

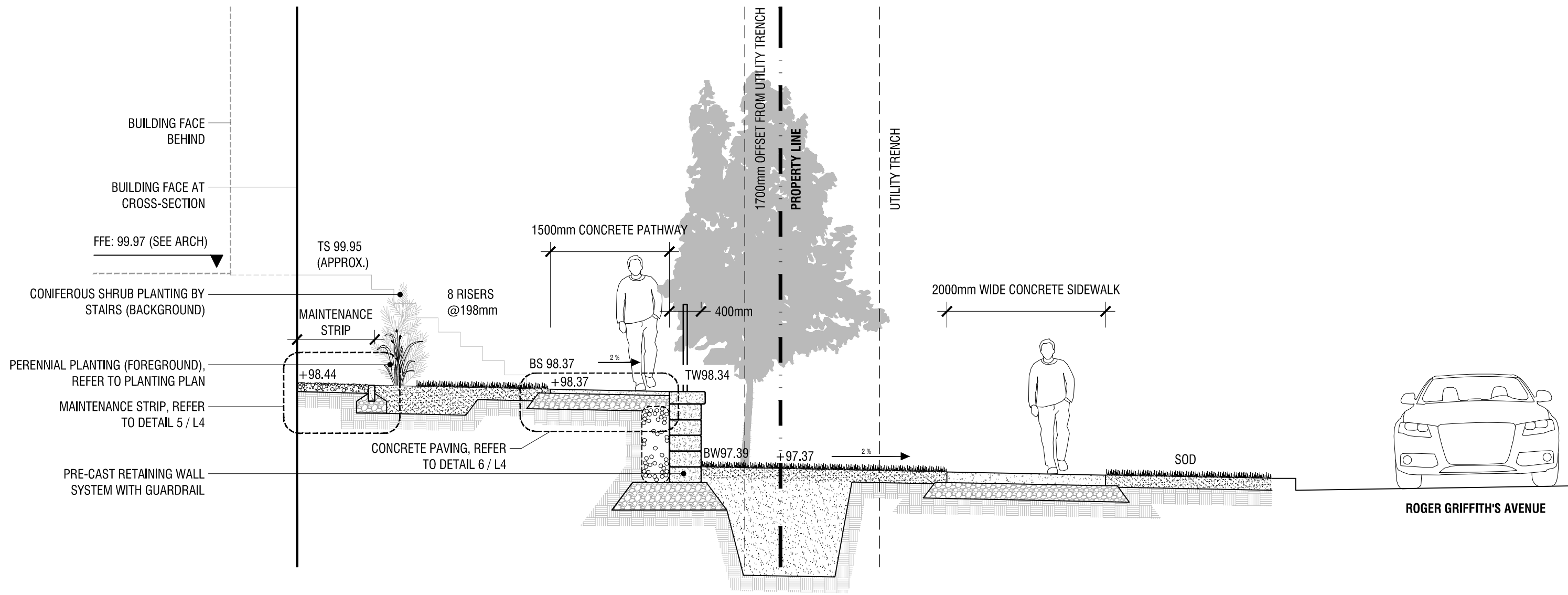

1
L3 **CROSS-SECTION: BLOCK 4**
1:50

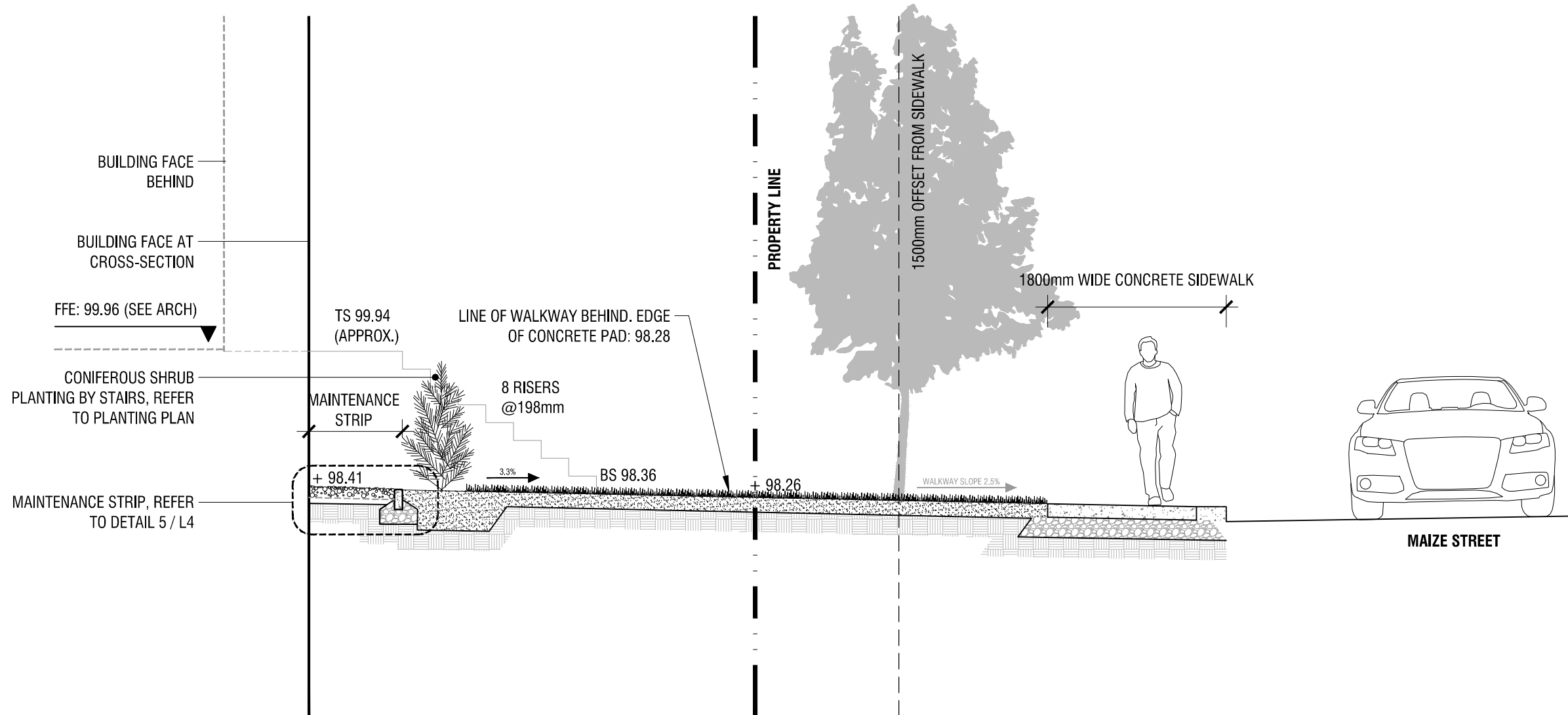

2
L3 **CROSS-SECTION: BLOCKS 1-3 (TYP)**
1:50

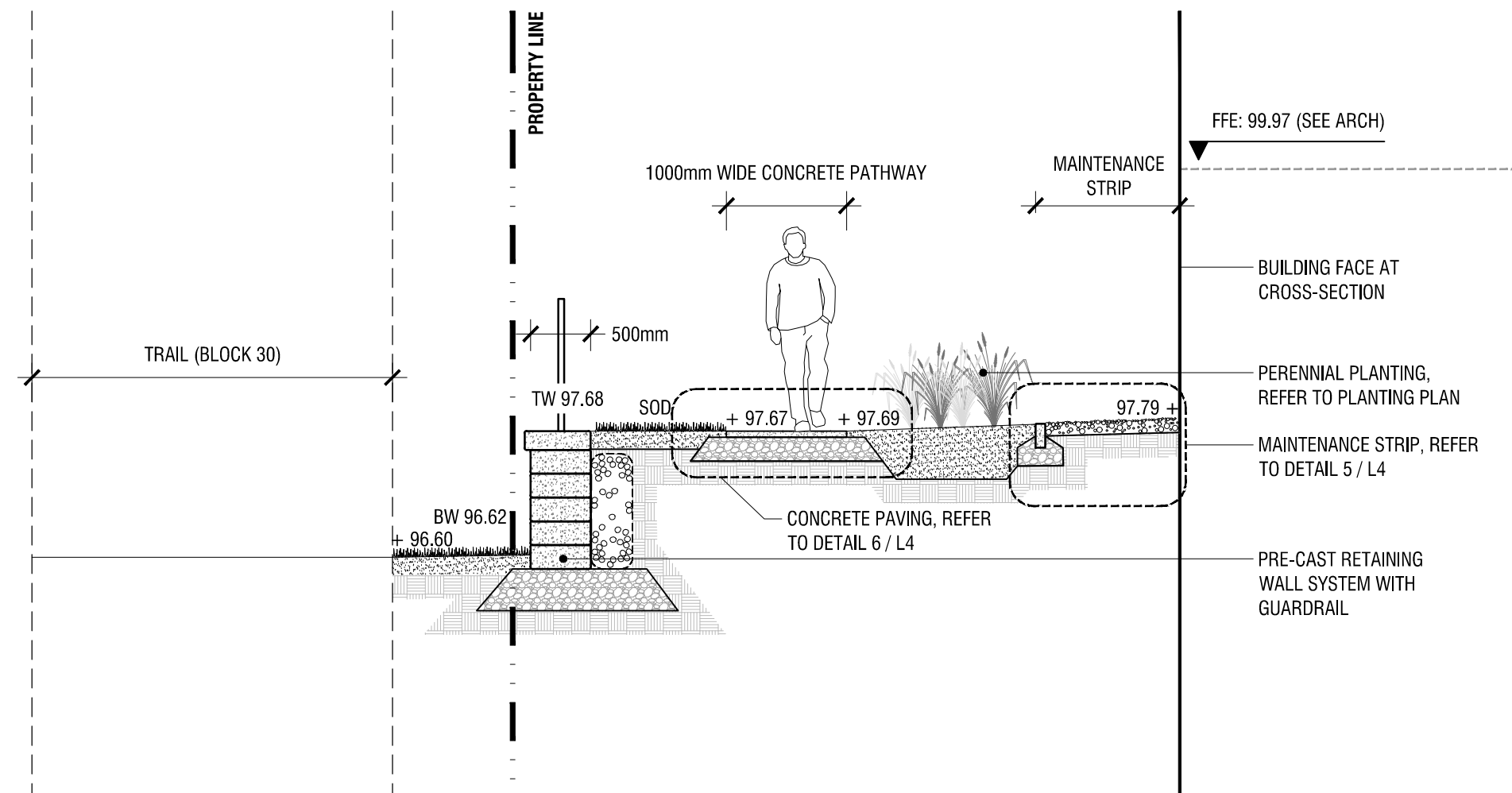

3
L3 **CROSS-SECTION: NORTH RETAINING WALL**
1:50

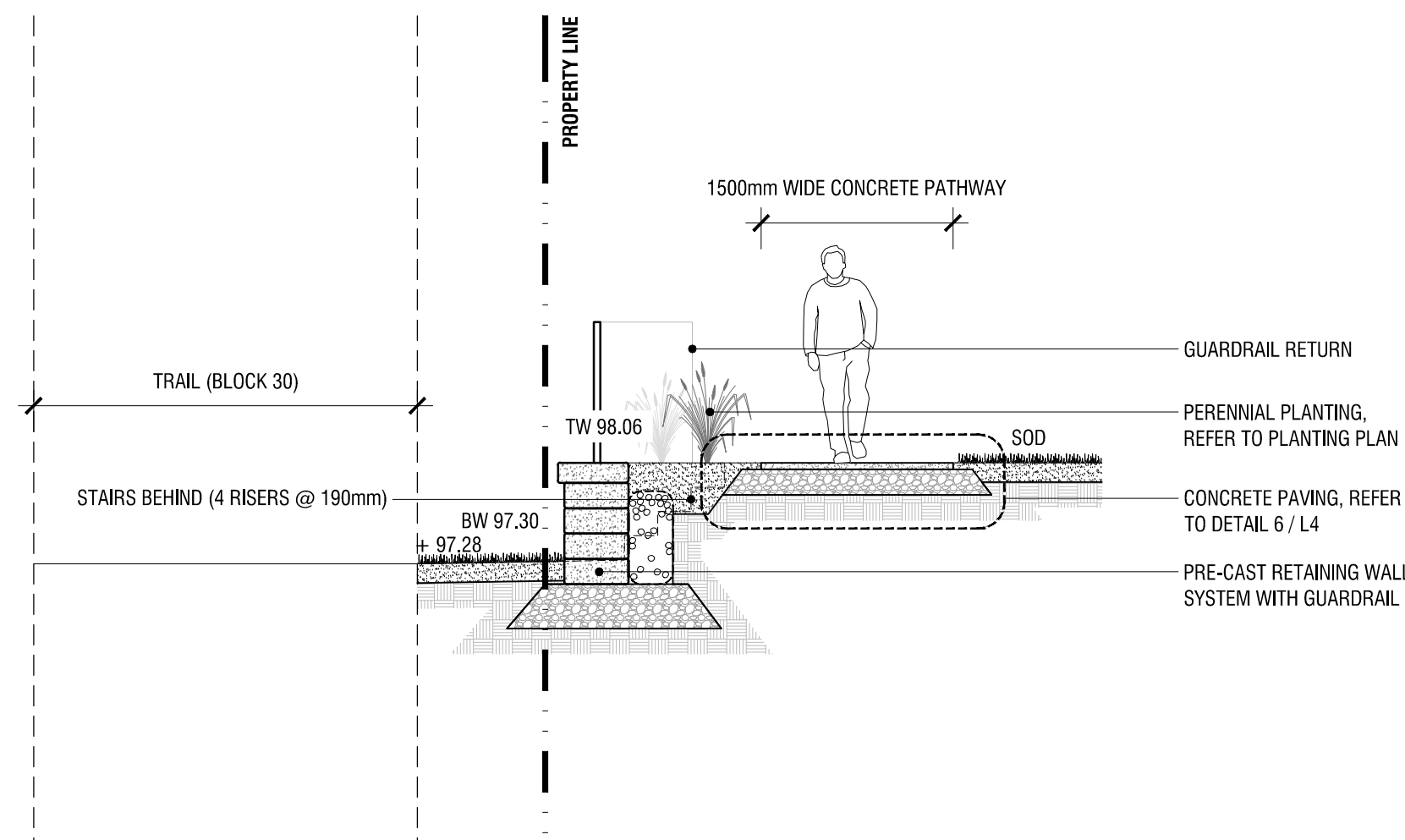

4
L3 **CROSS-SECTION: SOUTH RETAINING WALL**
1:50

rev'n	description / la description	yyyy/mm/dd
14	re-IFC - tree removal in streetscape due to stair conflict	2025/03/26
13	Issued for Construction	2025/02/19
12	Issued for Client Review	2024/10/28
11	revised per engineering coordination	2022/06/14
10	revised per engineering coordination	2022/03/08
09	revised per 2nd technical circulation comments	2021/10/20
08	re-issued for SPA	2021/07/27
07	re-issued for SPA	2021/07/15
06	re-issued for SPA	2021/07/02
05	issued for SPA	2021/03/31
04	issued for Client Review	2021/03/26
03	issued for Client Review	2021/03/25
02	issued for Coordination	2020/12/22

FOTENN Planning + Design
420 O'Connor Street
Ottawa, ON, CANADA K2P 1W4
613.730.5709
fotenn.com

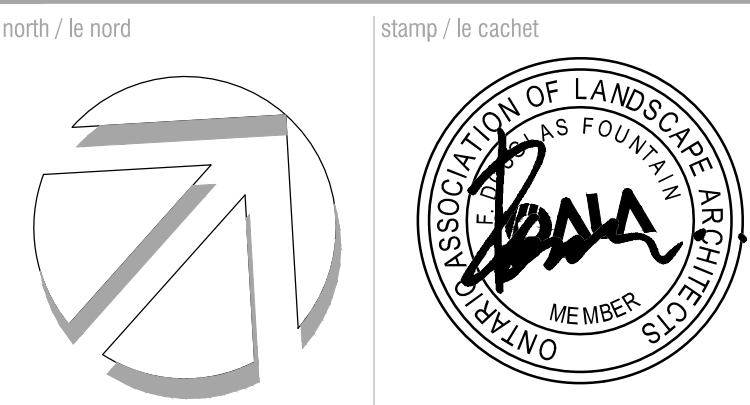

project / projet

BLOCK 29- KANATA WEST SUBDIVISION

drawing / dessin

SECTIONS

designed / conçu	drawn / dessiné	reviewed / examiné
KP	PM/OM	KP
date	project number / No. du projet	
Feb 2025		

drawing number / No. du dessin

L3 of 4

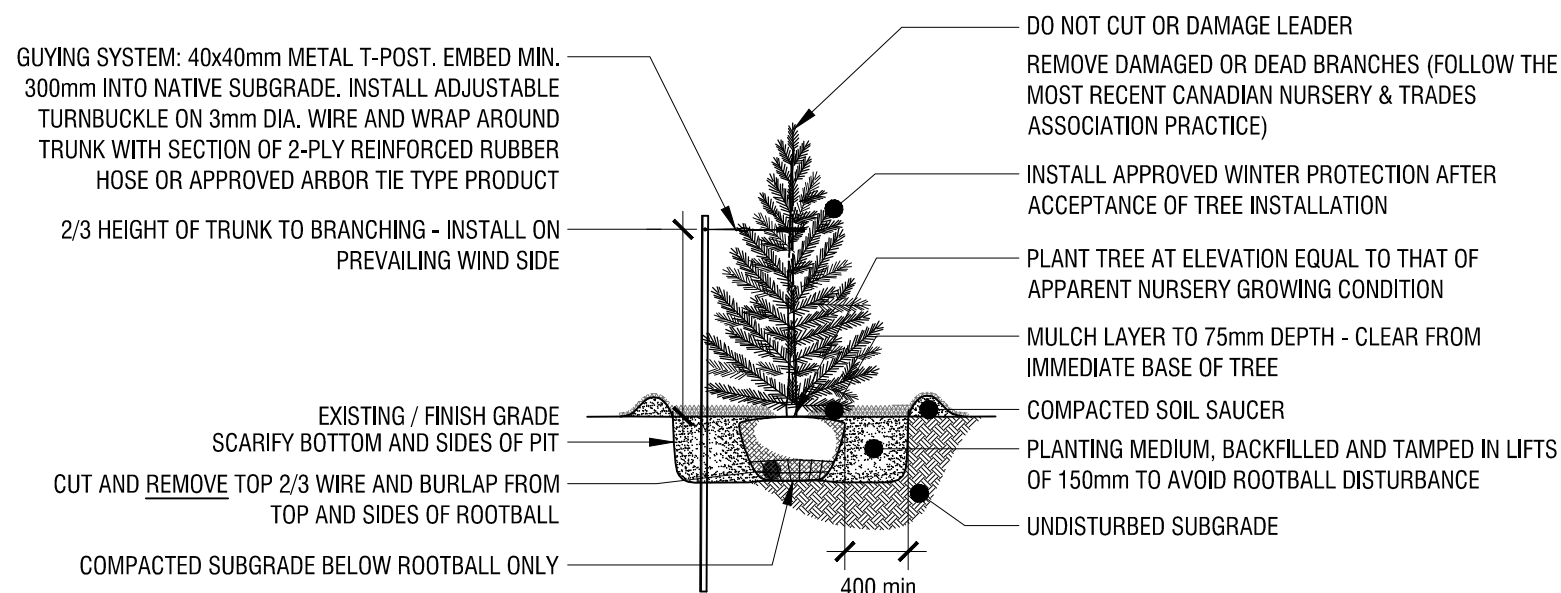

2	CONIFEROUS TREE PLANTING DETAIL
L4	n.t.s.

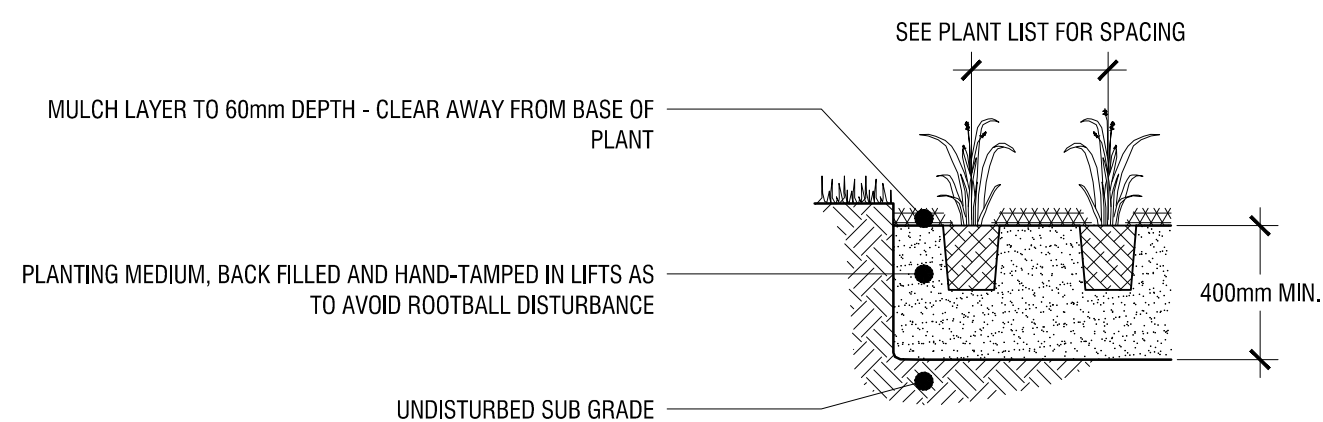

4	PERENNIAL, GRASSES, AND GROUNDCOVER PLANTING
L4	n.t.s.

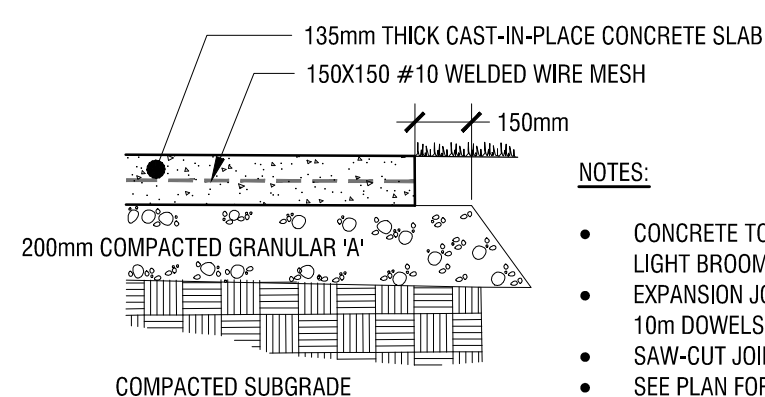

- NOTES:**
- CONCRETE TO BE 30MPa (4000 PSI) WITH 5-7% AIR ENTRAINMENT AND LIGHT BROOM FINISH;
 - EXPANSION JOINTS: 13mm THICK BITUMINOUS FIBRE BOARD WITH 300mm, 10m DOWELS @ 600mm O.C., GREASED OR SLEEVED ON ONE END;
 - SAW-CUT JOINTS: TO 10mm DEPTH;
 - SEE PLAN FOR JOINTING LAYOUT

6	CONCRETE PAVING
L4	n.t.s.

FOTENN Planning + Design
420 O'Connor Street
Ottawa, ON, CANADA K2P 1W4
613.730.5709
fotenn.com

| stamp / le cachet

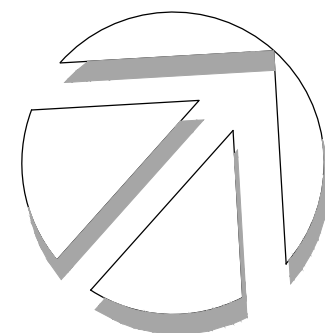

**BLOCK 29-
KANATA WEST SUBDIVISION**

CONSTRUCTION DETAILS

drawing number / No. du dessin