

Drawing Remains the Property of/Copyright Reserved by Gino J. Aiello Landscape Architect. Do Not Use or Reproduce Without Approval of Gino J. Aiello.  
**NOT** To Be Used For Construction **Unless** indicated by Revision: **"FOR LANDSCAPE CONSTRUCTION"**.  
**Contractor is Responsible** for Verification of Site Locations of all Utilities. Report any Discrepancies Between Site and Drawing Immediately to Gino J. Aiello. Do NOT Proceed Until Clarified.  
 TURF AREAS TO BE SOD C/W 150MM DEPTH TOPSOIL ON APPROVED SUBGRADE | SOD TO BE #1 GRADE TURFGRASS NURSERY SOD per NSGA - Fine Fescue/Kentucky Bluegrass Sod | PLANTING MIX TO BE APPROVED BY LANDSCAPE ARCHITECT | PLANT MATERIAL TO MEET CNLA STANDARDS/BE APPROVED BY LANDSCAPE ARCHITECT PRIOR TO PLANTING | ALL MATERIALS & WORK TO BE MAINTAINED UNTIL FINAL ACCEPTANCE. (MOWING TURF, WEEDING BEDS, WATERING TURF & PLANTS) & INCLUDE 1 YEAR WARRANTY FROM DATE OF FINAL ACCEPTANCE | PROVIDE WATERING OF ALL PLANT MATERIAL AS REQUIRED FOR PROPER ESTABLISHMENT, UNTIL END OF WARRANTY PERIOD | REFER TO CIVIL ENGINEER'S DRAWING FOR ELEVATIONS / GRADING |  
 The Landscape Plan is to be read in conjunction with the grading, servicing, site and survey plan | Bare root material to be planted in season only | All plant material locations to be staked on site by the landscape contractor and checked by the landscape architect prior to planting | All trees to be preserved on or directly adjacent to the site will be protected | Plant material are to be installed a minimum of, 3.0m away from any part of any hydro transformer, 3.0m corridor between a fire hydrant and the curb, a 2.5m radius beside or behind a fire hydrant, 2.0m from any servicing/utility line or structure |



- REFER TO TCR BY IFS**
- Existing Tree to Remain
  - Existing Tree to be Removed
  - Protection for Existing Trees
  - Proposed Coniferous Tree
  - Proposed Deciduous Tree
  - Proposed Planting Bed
  - PS-76-101-TP- Circum Bike Rack by HAUSER Anchor to Concrete
- BELOW GRADE SERVICES REFER TO CIVIL /CUP**
- U/G Water Service
  - U/G Storm Service
  - U/G Sanitary Service
  - U/G Gas Service
  - U/G TelCo Service
  - U/G Hydro Service
  - O/H Hydro Service
  - Catch Basin CB/Manhole
  - Fire Hydrant
  - FD Siamese Connection

TREES 103 SCHNEIDER ROAD KANATA				
Code	Qty.	Botanical Name	Common Name	Condition
AC	1	Amelanchier canadensis	Serviceberry	B + B specimen
AR	8	Acer rubrum	Red Maple	B + B specimen
AS	4	Acer saccharum	Sugar Maple	B + B specimen
CO	8	Celtis occidentalis	Common Hackberry	B + B specimen
GD	1	Gymnocladus dioica	Kentucky Coffee Tree	B + B specimen
QM	3	Quercus macrocarpa	Burr Oak	B + B specimen
QR	1	Quercus rubra	Red Oak	B + B specimen
AB	3	Abies balsamea	Balsam Fir	B + B specimen
LL	5	Larix laricina	Eastern Larch / Tamarack	B + B specimen
PG	14	Picea glauca	White Spruce	B + B specimen

SHRUBS 103 SCHNEIDER ROAD KANATA				
Code	Qty.	Botanical Name	Common Name	Condition
HK	105	Hypericum kalmianum	St. John's Wort	Pot
SA	325	Spiraea alba	Meadowsweet	Pot
VL	25	Viburnum lentago	Nannyberry	Pot
PV	75	Panicum virgatum	Switch Grass	9cm Pot

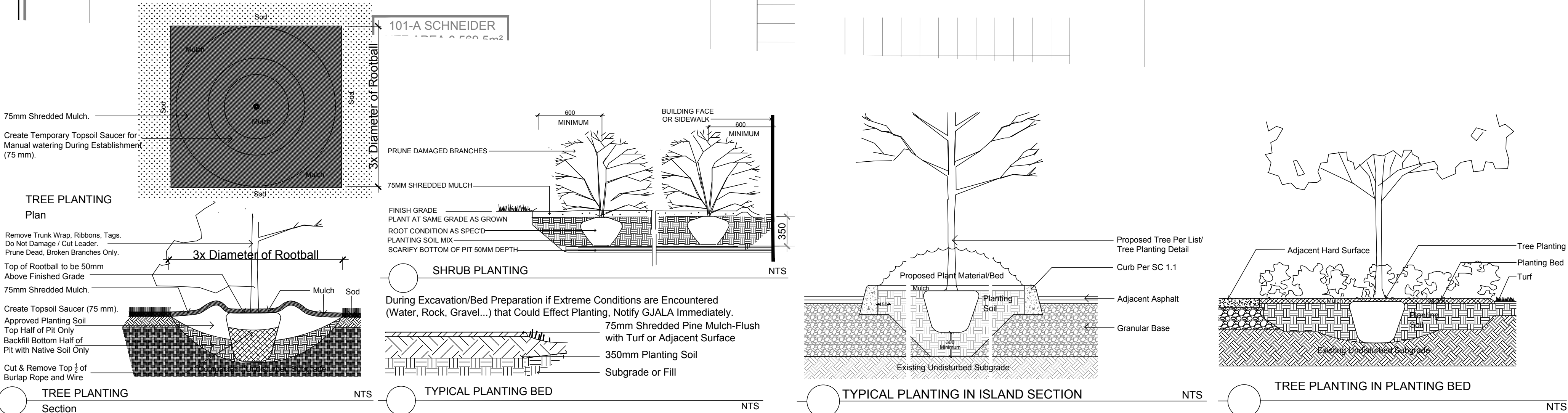

2	SECOND SUBMISSION SPC	JUNE 28 2021
1	FIRST SUBMISSION SPC	APRIL 1 2021
0	FOR COORDINATION / REVIEW	MARCH 2021
No.	Revision	Date

Property Owner: **KAPALI HOLDINGS LIMITED**  
 4017 Carling Avenue, Suite 301 Kanata, ON K2K 2A3

Project: **PROPOSED LIGHT INDUSTRIAL DEVELOPMENT**  
 103 SCHNEIDER ROAD

Drawing: **Landscape Plan**

Date: MARCH 2021  
 Scale: 1:400  
 City of Ottawa  
 Dwg - #####

Sheet Number: **L1**

D07-###-###