

LEGEND:

- IRON BAR
- BENCHMARK
- EX FIRE HYDRANT
- EX LIGHT POLE
- EX LIGHT STANDARD
- EX STORM MH
- EX SANITARY MH
- EX STORM CB
- EX WATER VALVE
- EX VALVE CHAMBER
- EX BELL & HYDRO POLE
- EX GUY WIRE AND ANCHOR
- EX TRAFFIC SIGNAL
- EX GAS VALVE
- EX SIGN
- EX TREE
- SUBJECT PROPERTY
- PROPERTY LINE
- EX CONC CURB
- EX CENTERLINE OF DITCH
- EX ROAD CENTERLINE
- EX FENCE
- EX STORM SEWER
- EX CONTOUR
- NEW YARD LIGHT
- NEW STORM MH
- NEW SANITARY MH
- NEW STORM CB
- NEW STORM CB/MH
- NEW CONC. CURB
- NEW CURB CUT/DEPRESSED CURB
- FIRE ROUTE SIGN
- NEW 1.8m HIGH WOOD FENCE
- DRAINAGE AREA BOUNDARY
- CATCHMENT I.D.
- AREA (ha) | FACILITY FLOW

No.	REVISIONS	Date	By	App.
C	RE-ISSUED FOR SPA	DEC 03 2021	ML	J.S.
B	RE-ISSUED FOR SPA	SEPT 24 2021	ML	J.S.
A	ISSUED FOR SPA	AUG 25 2021	ML	J.S.



exp Services Inc.
 1-1-905.793.9800 | F +1-905.793.0641
 1595 Clark Boulevard
 Brampton, ON L6T 4V1
 Canada
 www.exp.com

exp.

- BUILDINGS • EARTH & ENVIRONMENT • ENERGY •
- INDUSTRIAL • INFRASTRUCTURE • SUSTAINABILITY •



Location:
**1545 WOODROFFE AVE.
 OTTAWA, ON**

Title:
**POST-DEVELOPMENT
 SANITARY
 AREA PLAN**

Designed By: M.L.	Drawn By: M.L.	Checked By: J.S.
Scale: 1:250	Date: APRIL 2020	City Drawing No.:
Project No.: BRM00606364-B0	Drawing No.: C07	CITY DWG. # 17094

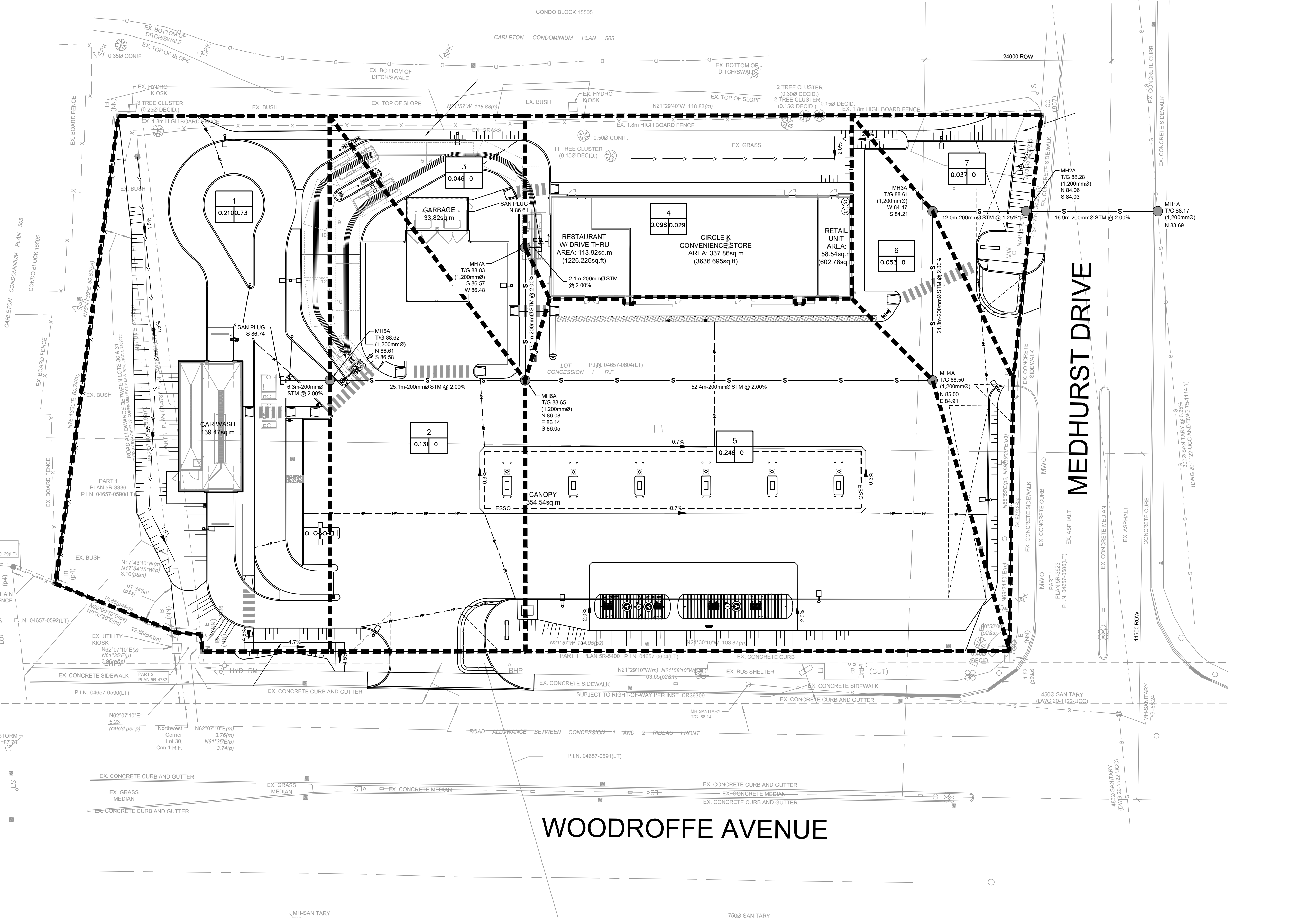

CITY # 007-1221-0005