

LEGEND

- Existing Deciduous Tree to Remain
- Existing Coniferous Tree to Remain
- Proposed Deciduous Tree
- Proposed Coniferous Tree
- Proposed Deciduous Shrub
- Proposed Coniferous Shrub
- Proposed Perennial
- Proposed Bike Rack
- Proposed Barrier-free Signage
- Proposed 1.8m Shadowbox Wood Fence
- Existing 1.8m Board Fence
- Re. L3.0 for planting and furnishing details
- #1- re. comments from City

Key	Botanical Name	Common Name	Qty	Size	Conditions	Spacing	Remarks
Deciduous Trees							
AF	Acer x freemanii 'Celebration'	Celebration Maple	5	60mm cal	WB		full crown
AM	Amelanchier leavis	Allegheny Serviceberry	5	50mm cal	WB		full crown
AR	Acer rubrum	Red Maple	6	60mm cal	WB		full crown
GT	Gleditsia triacanthos	Honey Locust	6	60mm cal	WB		full crown
Coniferous Trees							
AB	Abies concolor	White Fir	3	200cm	WB		uniform spread
PP	Picea glauca	White Spruce	3	200cm	WB		uniform spread
Shrubs							
Co	Cornus alba 'Siberica'	Redbark Dogwood	44	40cm 3gal	Cont.	120cm	min. 5 canes
Ju	Juniperus sabinna 'Blue Danube'	Blue Danube Juniper	60	40cm 3 gal	Cont.	100cm	uniform spread
Po	Potentilla fruticosa 'Red Ace'	Red Ace Cinqufoil	20	40cm 3 gal	Cont.	60cm	plant in offset lines / zig zag pattern to fill space
Rh	Rhus aromatica 'Gro-Low'	Fragrant Sumac	53	2gal	Cont.	100cm	plant in offset lines / zig zag pattern to fill space
Sj	Spiraea japonica 'Flaming Mound'	Flaming Mound Spirea	66	40cm 3 gal	Cont.	75cm	plant in offset lines / zig zag pattern to fill space
Ta	Taxus x media 'Wardii'	Ward's Yew	19	40cm 3 gal	Cont.	100cm	plant in offset lines / zig zag pattern to fill space
Perennials / Ornamental Grasses							
ach	Achillea millefolium 'Paprika'	Paprika Yarrow	129	1gal	Cont.	50cm	plant in offset lines / zig zag pattern to fill space
hem	Hemerocallis 'Anzac'	Anzac Daylily	286	1gal	Cont.	50cm	plant in offset lines / zig zag pattern to fill space
pan	Panicum virgatum 'Prairie Fire'	Prairie Fire Switch Grass	92	1gal	Cont.	60cm	plant in offset lines / zig zag pattern to fill space
rud	Rudbeckia 'Hirta'	Black Eyed Susan	242	1gal	Cont.	50cm	plant in offset lines / zig zag pattern to fill space

PLANT NOTES:
 ALL PLANT MATERIAL SUBJECT TO STANDARD TWO (2) YEAR MAINTENANCE PERIOD COMMENCING UPON ISSUANCE DATE OF THE CERTIFICATE OF SUBSTANTIAL COMPLETION AND ACCEPTANCE OF THE ABOVE GROUND WORKS.
 QUANTITIES INDICATED ON THE PLAN TO GOVERN.
 DO NOT PLANT IN SWALE CENTRES.
 ▲ THE MINIMUM OF SOIL AREA PER TREE IS 10 SQUARE METERS.

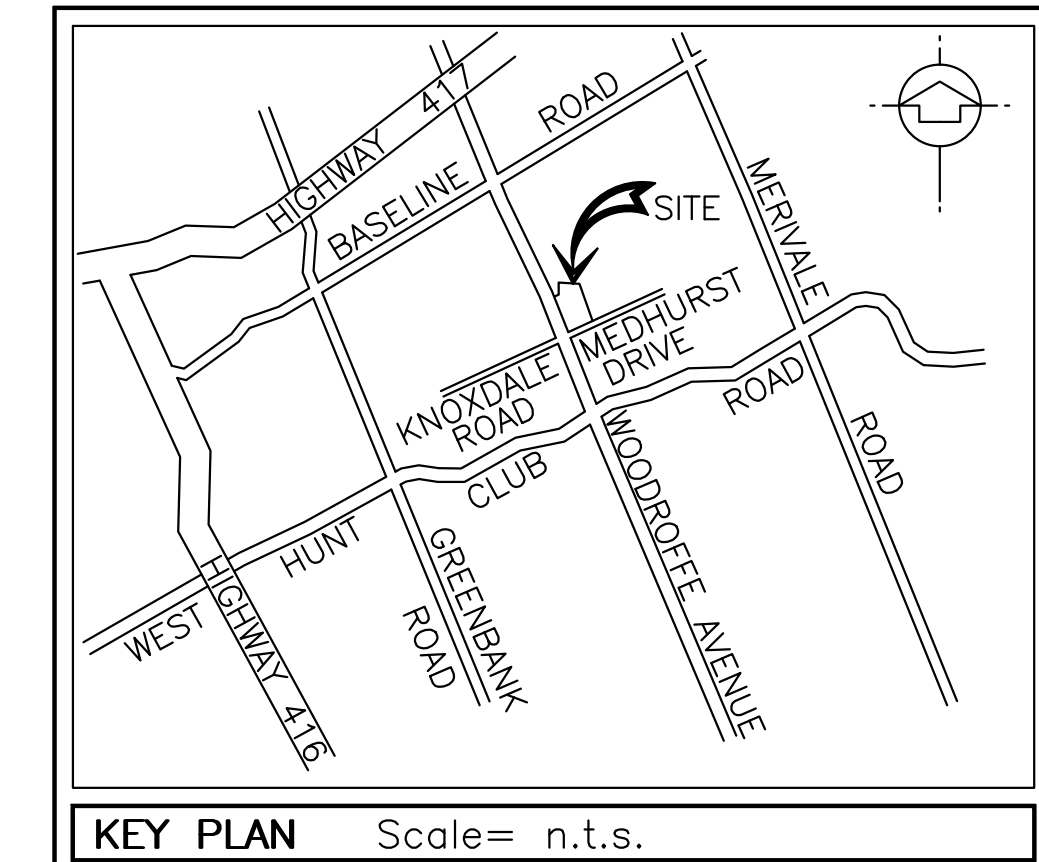

wood.
 Unless otherwise agreed in a written contract between Wood and its client, this document: (i) contains information, data and design that is confidential and may not be copied or disclosed; and (ii) may be used by the client only in the context and for the express purpose for which it was intended. Any use of, or reliance on, this document by any third party is the party's sole risk.
 COPYRIGHT NOTICE
 This drawing is the property of the above referenced Professional and is not to be used for any purpose other than the specific project and site named herein, and cannot be reproduced in any manner without the express written permission from the Professional.
 04/21/21 FOR CLIENT REVIEW
 04/27/21 ISSUED FOR SPA
 09/21/21 RE-ISSUED FOR SPA
 12/03/21 RE-ISSUED FOR SPA
 03/25/22 RE-ISSUED FOR SPA

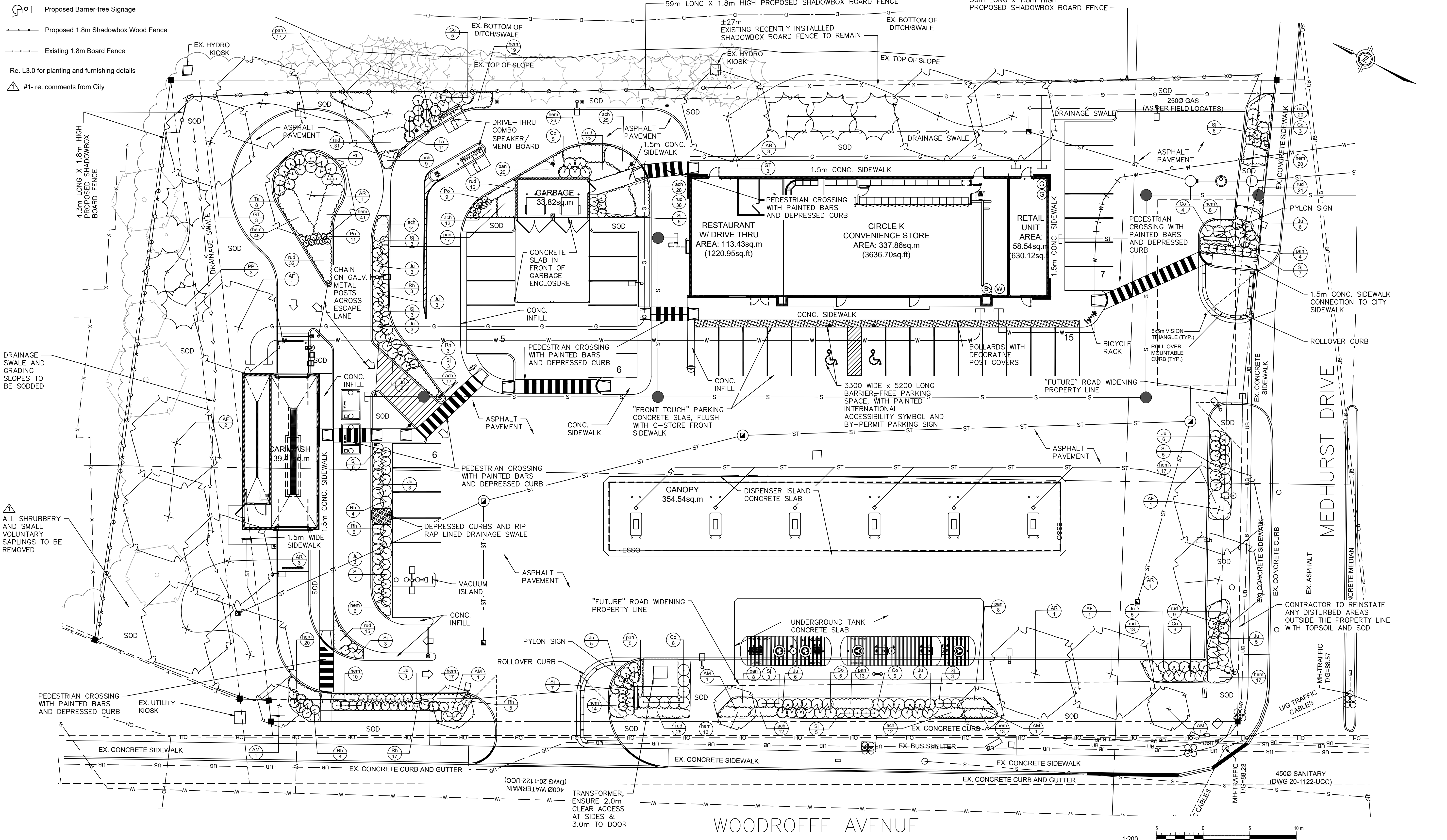

PROFESSIONAL SEAL

PROFESSIONAL SEAL

PROFESSIONAL IN CHARGE
 S. STEMPSKI
PROJECT MANAGER
 S. LAWRENCE
QUALITY CONTROL
 F. RIVARD
 DRAWN BY
 J. YI

PROJECT NAME
CIRCLE K STORES INC.
R&R No. 52287

NEPEAN ONTARIO
 1545 WOODROFFE AVENUE
 NEPEAN, ON, CANADA
 K2G 1W2



PROJECT NUMBER
 BE20207036
SHEET TITLE

LANDSCAPE PROPOSED PLANTING AND LANDSCAPING PLAN

SHEET NUMBER
L2.0

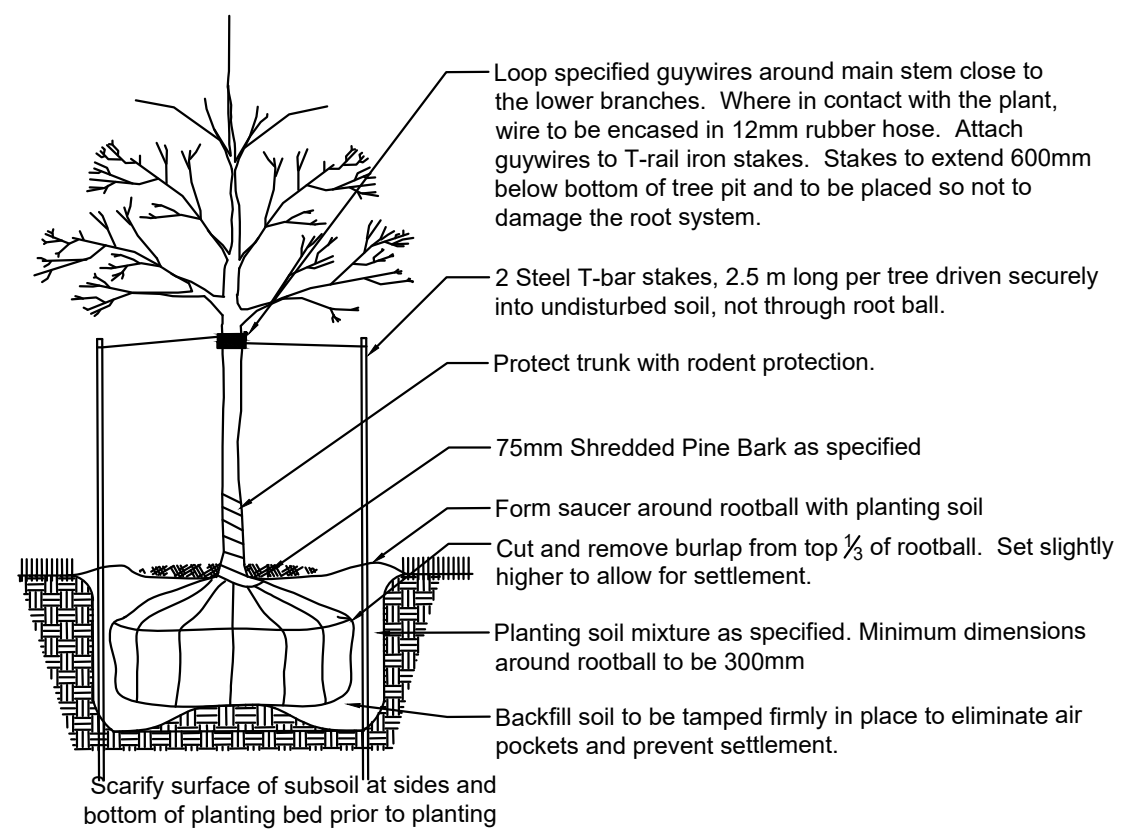

Notes:

- 1) Prune plants a min. amount to remove dead or injured members. Maintain natural character and shape of the species. Do not cut the leader branch.

DECIDUOUS TREE PLANTING
section NTS

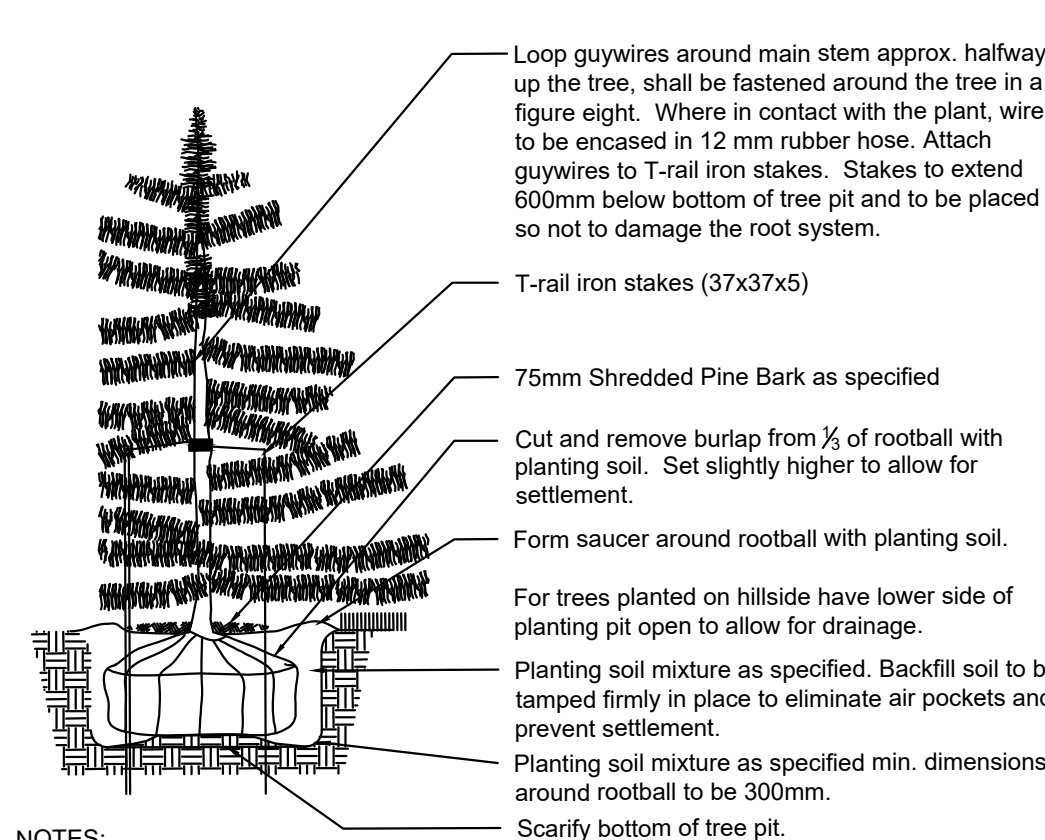

Notes:

- 1) Prune plants a min. amount to remove dead or injured members. Maintain natural character and or shape of species. Do not cut a leader branch.

CONIFEROUS TREE PLANTING
section NTS

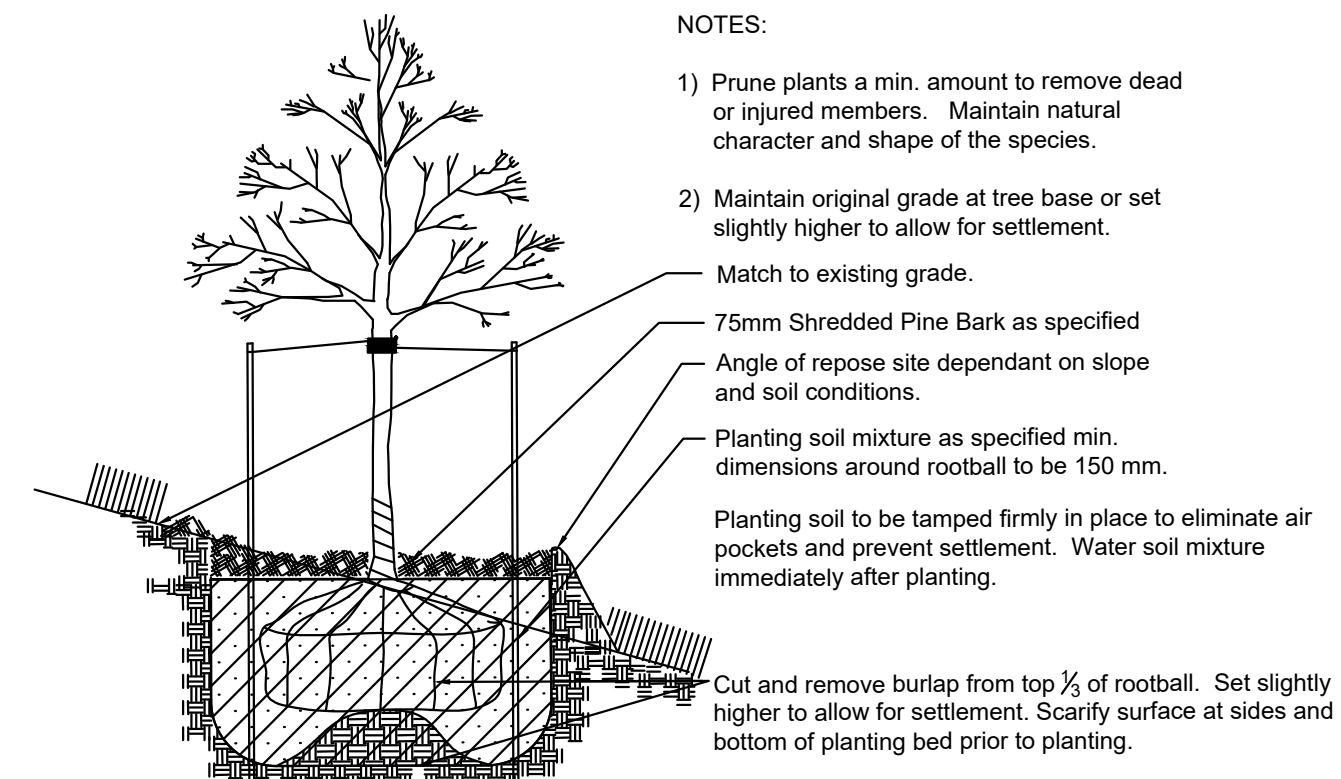

Notes:

- 1) Prune plants a min. amount to remove dead or injured members. Maintain natural character and shape of the species.
- 2) Maintain original grade at tree base or set slightly higher to allow for settlement.

DECIDUOUS TREE ON SLOPE
section NTS

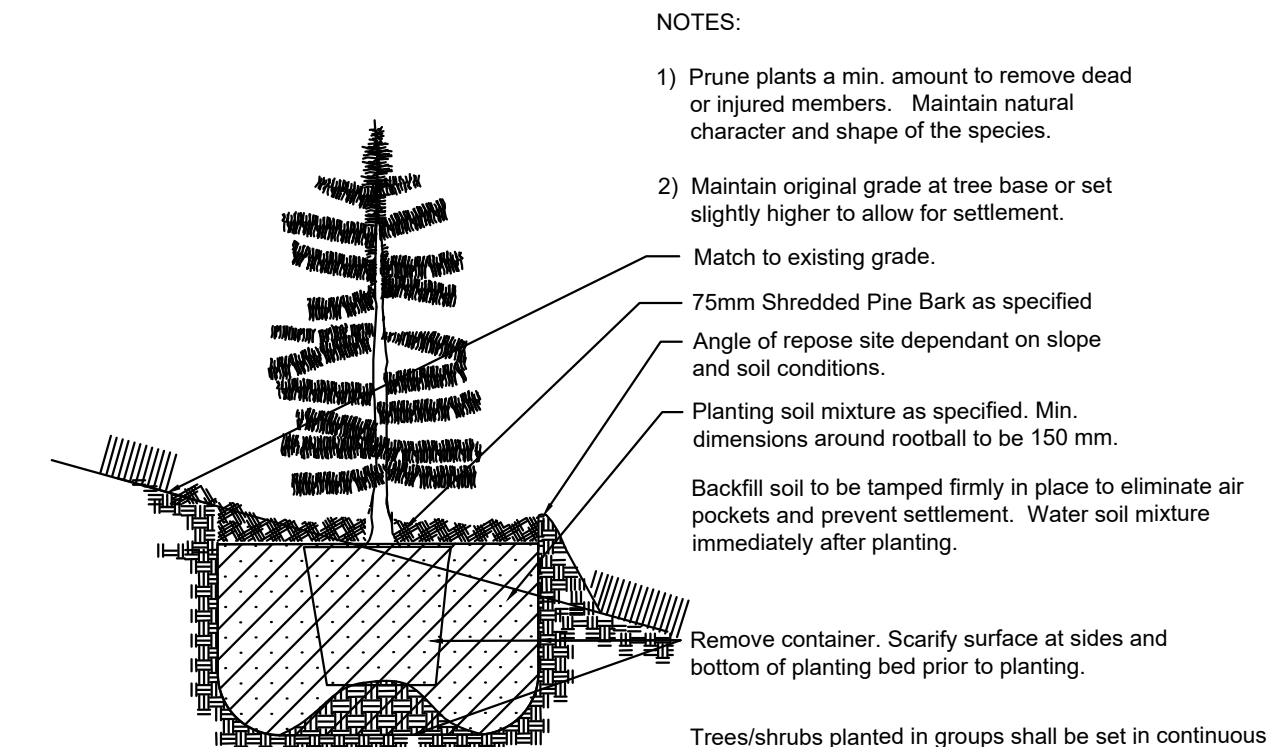

Notes:

- 1) Prune plants a min. amount to remove dead or injured members. Maintain natural character and shape of the species.
- 2) Maintain original grade at tree base or set slightly higher to allow for settlement.

CONIFEROUS TREE ON SLOPE
section NTS

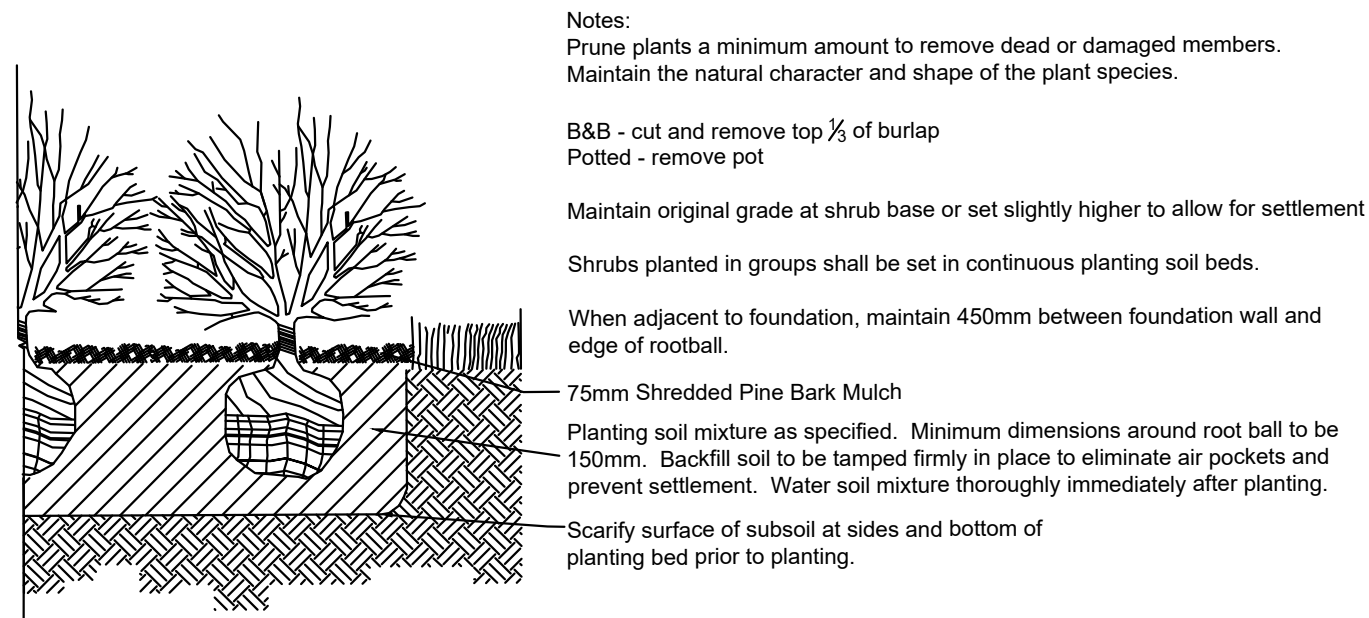

Notes:

- 1) Prune plants a min. amount to remove dead or injured members. Maintain natural character and shape of the species.
- 2) Maintain original grade at tree base or set slightly higher to allow for settlement.
- 3) When adjacent to foundation, maintain 450mm between foundation wall and edge of rootball.

MULTIPLE SHRUB PLANTING
section NTS

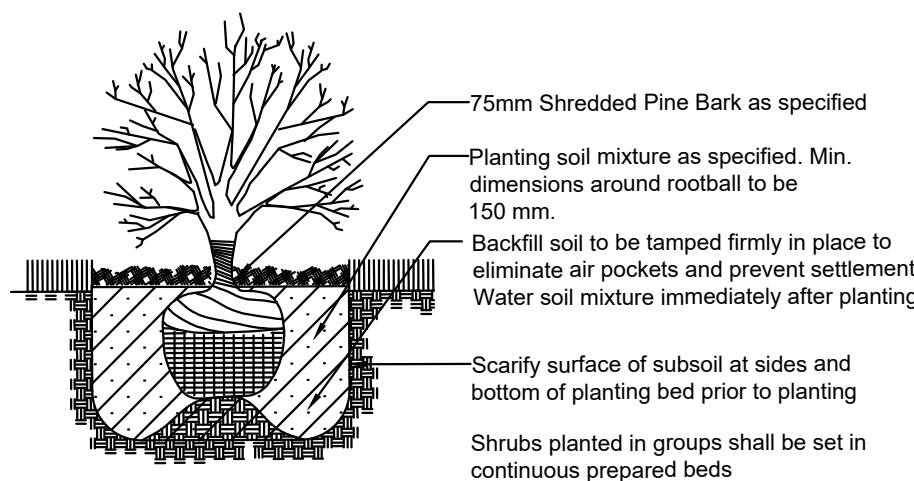

Notes:

- 1) Prune plants a min. amount to remove dead or injured members. Maintain natural character and shape of the species.
- 2) Maintain original grade at tree base or set slightly higher to allow for settlement.
- 3) When adjacent to foundation, maintain 450mm between foundation wall and edge of rootball.

SHRUB PLANTING
section NTS

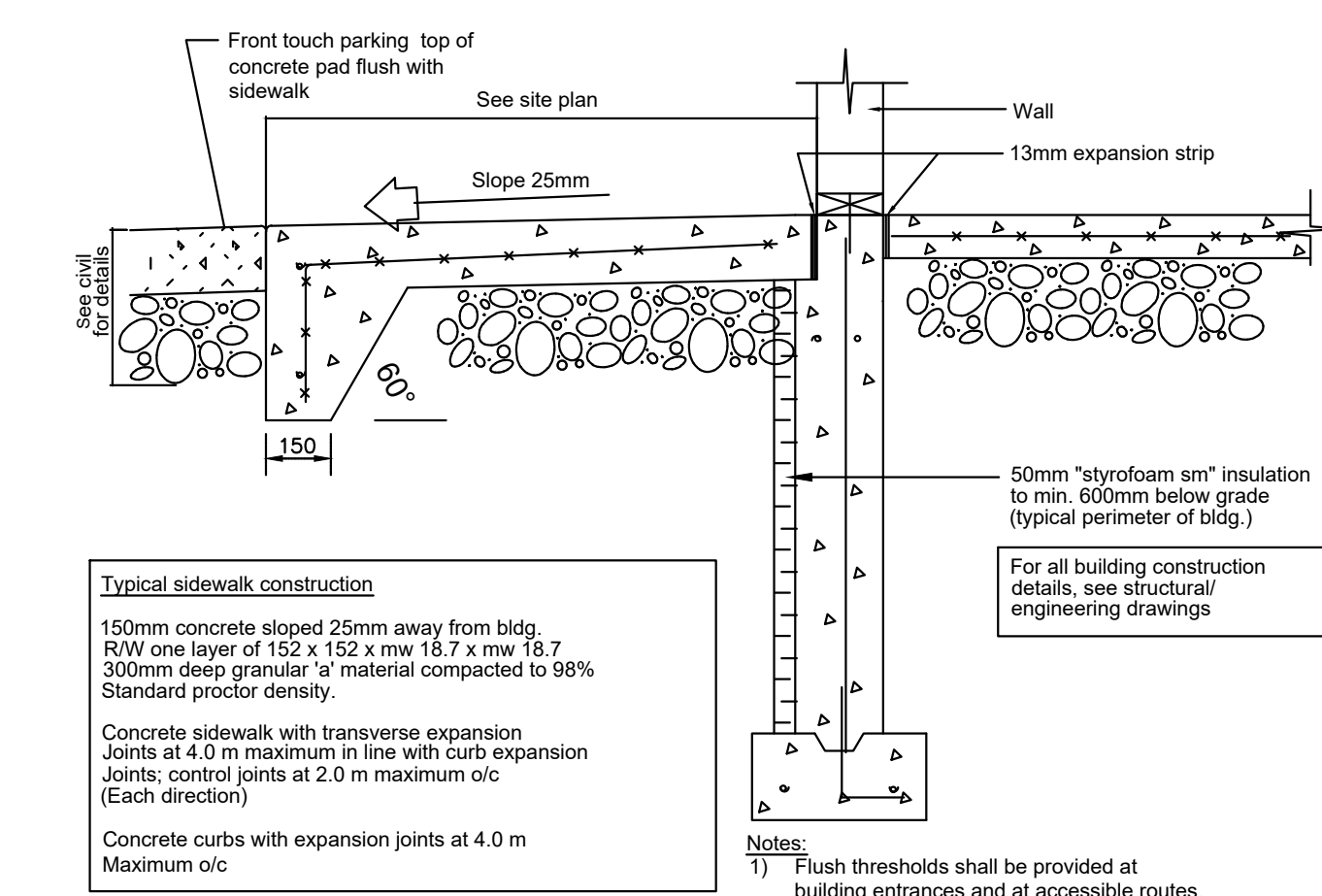

Notes:

- 1) Flush thresholds shall be provided at building entrances and at accessible routes.

TYPICAL SIDEWALK DETAIL
section NTS

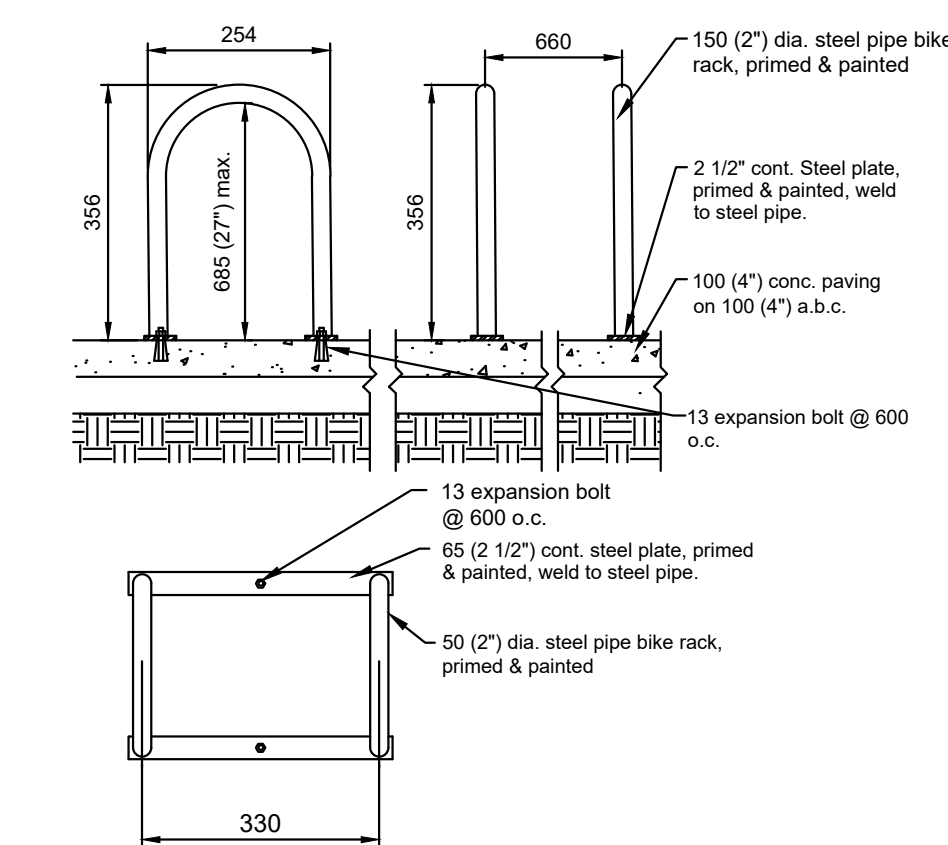

BIKE RACK
section NTS

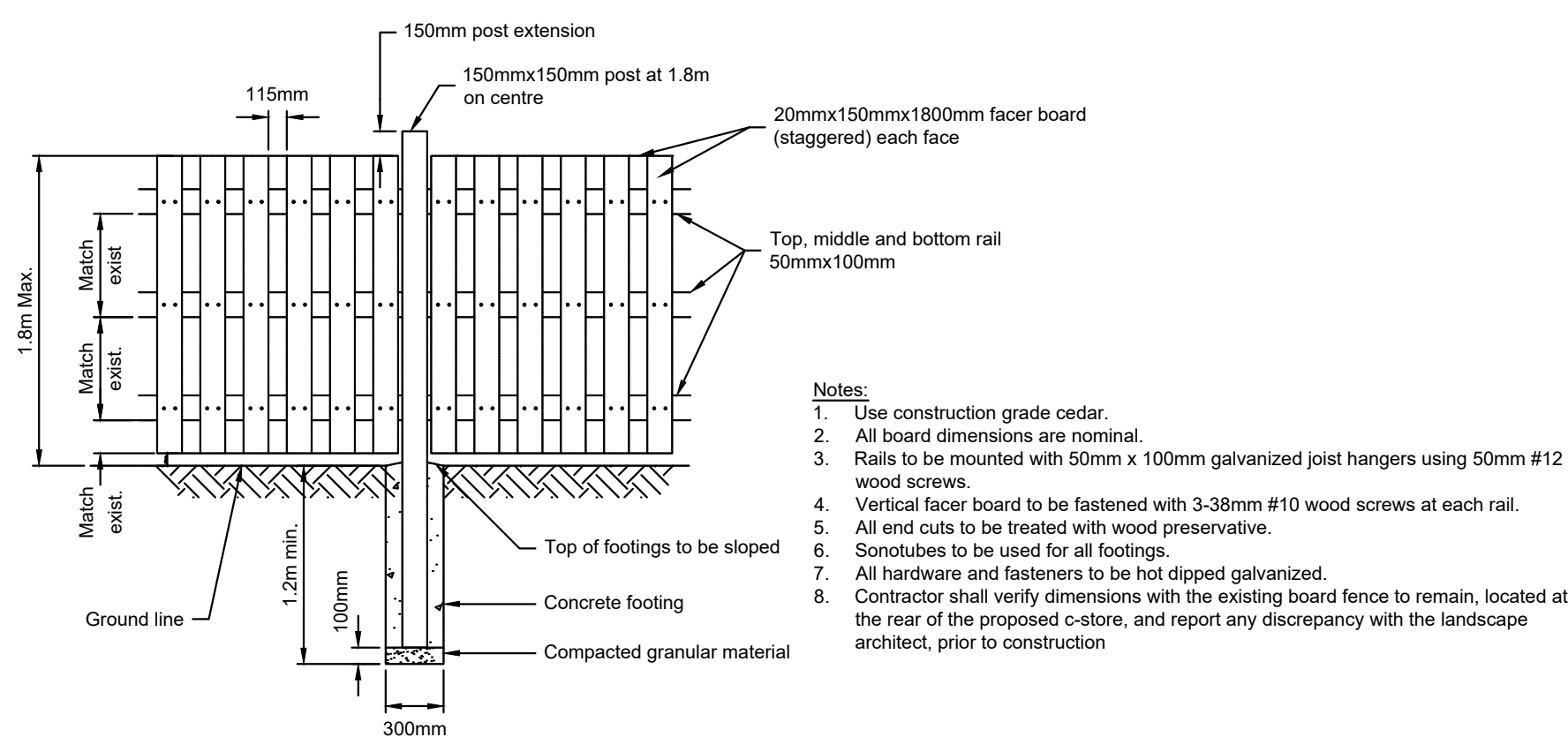

SHADOWBOX WOOD FENCE
section NTS

GENERAL CONSTRUCTION NOTE:

1. USE PLANTING MATERIAL TRUE TO NAME, SIZES, OR GRADES AS SPECIFIED, AND CONFORMING TO THE 'CANADIAN NURSERY TRADES ASSOCIATION METRIC GUIDE SPECIFICATIONS AND STANDARDS'.
2. CHECK ALL QUANTITIES AND REPORT ANY ERRORS/DISCREPANCIES TO THE LANDSCAPE ARCHITECT AND AGREE BEFORE PROCEEDING.
3. MATERIALS AND WORKMANSHIP NOT MEETING SPECIFICATIONS WILL BE REJECTED, AT TIME OF INSPECTIONS.
4. ALL TREES SHALL BE BALLED AND BURLAPPED AND ALL SHRUBS SHALL BE POT GROWN. PLANTING MATERIAL SIZES ARE MINIMUM.
5. WHEN PLANTING MATERIALS IS SUPPLIED IN WIRE BASKETS THE TOP 2/3 OF THE BASKET SHALL BE CUT AND REMOVED FROM THE PIT PRIOR TO BACKFILLING.
6. SPECIFIED MIX FOR TREE / SHRUB PLANTING: TOPSOIL SHALL BE A FERTILE, FRIABLE, NATURAL SANDY LOAM. IT SHALL BE FREE OF STONES, SUBSOIL, REFUSE OR OTHER EXTRANEIOUS MATERIALS, AND CAPABLE OF SUSTAINING HEALTHY PLANT GROWTH. THE CONTRACTOR SHALL NOT USE TOPSOIL WHILE IN A FROZEN OR MUDDY CONDITION. TEN PER CENT PEATMOSS AND TEN PERCENT WELL ROTTED FARMYARD MANURE SHOULD BE MIXED INTO THE TOPSOIL. THE SPECIFIED MIX SHALL BE SUBJECT TO THE APPROVAL OF THE TOWN/CITY'S AUTHORITY.
7. FINISH ALL PLANTING AREAS WITH 100MM OF SHREDDED PINE BARK MULCH. GROW BARK, 519-885-3411; ECONOMY MULCH SUBSTITUTIONS WILL BE REJECTED.
8. ALL SOD SHALL CONFORM TO THE 'CANADIAN NURSERY SOD GROWERS SPECIFICATIONS' / NO 1 NURSERY SOD. SOD SHALL BE INSTALLED UPON ARRIVAL, AND SHALL BE SMOOTHLY LAID WITH TIGHT JOINTS ON MINIMUM 10 CM CLEAN TOPSOIL AND RECOMMENDED MINIMUM 30 CM OF CLEAN FILL. SOD SHALL BE COMPOSED OF 90% KENTUCKY BLUEGRASS & 10% CREEPING RED FESCUE, OR APPROVED EQUAL. CONTRACTOR TO PEG SOD ON SLOPES GREATER THAN 3:1. SWALES & DITCHES. CONTRACTOR TO PROVIDE UNIT PRICE FOR SODDING, AREAS DETERMINED ON SITE, AT TIME OF CONSTRUCTION. CONTRACTOR RESPONSIBLE TO MAINTAIN GRASS UNTIL FINAL APPROVAL. ALLOW FOR ONE CUTTING AND REMOVE CLIPPINGS.
9. WARRANTY ON ALL PLANT MATERIAL, (INCLUDING TRANSPLANTED MATERIAL), SHALL BE FOR TWO YEARS FROM DATE OF FINAL ACCEPTANCE OF CONSTRUCTION. REPLACEMENTS WARRANTY SHALL BE FOR AN ADDITIONAL TWO YEARS, (CONTRACTORS RESPONSIBILITY).

CONTRACTOR RESPONSIBLE TO MAINTAIN & WATER PLANTINGS UNTIL FINAL APPROVAL & COORDINATE TAKE OVER OF MAINTENANCE WITH IO DEALER; (CONTRACTOR SHALL MONITOR SITE DURING. TWO YEAR WARRANTY, REPORT ANY CONCERN TO CK)

