

### EXISTING TREE LIST

KEY	QTY	BOTANICAL NAME	COMMON NAME	SIZE	CONDITION	OWNERSHIP
<b>TREES</b>						
ML	3	Malus spp.	Crab Apple	100-200mm DBH	GOOD	1050 KLONDIKE CITY OF OTTAWA
PG	7	Picea glauca	White Spruce	200-400mm DBH	FAIR-GOOD	1050 KLONDIKE & CITY OF OTTAWA
PP	1	Picea pungens	Colorado Spruce	300mm DBH	GOOD	1050 KLONDIKE
SA	1	Sorbus aucuparia	European Mountain Ash	100mm DBH	POOR	1050 KLONDIKE
TO	#	Thuja occidentalis	Eastern White Cedar	100-200mm DBH	GOOD	1050 KLONDIKE
TOF	2	Thuja occidentalis 'Fastigata'	Pyramidal Cedar	100mm DBH	GOOD	1050 KLONDIKE
WS	3	Picea glauca	White Spruce	200-400mm DBH	GOOD	1050 KLONDIKE

### PROPOSED PLANT LIST

KEY	QTY	BOTANICAL NAME	COMMON NAME	SIZE	CONDITION	REMARKS
<b>TREES</b>						
FM	2	Acer x freemanii	Freeman's Maple	60mm ø	B&B	
HB	1	Celtis occidentalis	Hackberry	60mm ø	B&B	
HL	2	Gleditsia triacanthos 'Draves'	Streetkeeper Honey Locust	60mm ø	B&B	
SR	2	Syringa reticulata	Japanese Tree Lilac	60mm ø	B&B	Single leader
<b>SHRUBS</b>						
AH	14	Hydrangea arborescens 'Annabelle'	Annabelle Hydrangea	3 gal. pot	Potted	1200 mm o.c.
BT	6	Berberis thunbergii 'Concorde'	Concorde Barberry	300mm ht.	Potted	800 mm o.c.
EA	4	Euonymus alatus 'Compactus'	Dwarf Burning Bush	600mm ht.	Potted	800 mm o.c.
EB	11	Juniperus horizontalis 'Bar Harbor'	Bar Harbor Juniper	600 mm spr.	Potted	800 mm o.c.
JA	6	Juniperus horizontalis 'Andora Compacta'	Compact Andora Juniper	600mm spr.	Potted	800 mm o.c.
PLS	4	Prunus x cistena	Purpleleaf Sandcherry	1 m ht.	Potted	1500 mm o.c.
PO	3	Physocarpus opulifolius 'Little Devil'	Little Devil Ninebark	600mm ht.	Potted	1000 mm o.c.
SA	3	Spiraea x arguta	Garland Spirea	800mm spr.	Potted	1400 mm o.c.
SB	6	Spiraea x bumalda 'Anthony Waterer'	Anthony Waterer Spirea	600mm ht.	Potted	1000 mm o.c.
WC	15	Thuja occidentalis 'Clumps'	White Cedar Clumps	1200mm ht.	Bare root	450 mm o.c.
YD	4	Cornus alba 'Spaethii'	Yellow edge Dogwood	800 mm ht.	Potted	1800mm o.c.
<b>PERENNIALS</b>						
CG	18	Catagrostis x scoufiori 'Karl Foerster'	Karl Foerster Grass	250mm pot	Potted	800 mm o.c.
EP	14	Echinacea purpurea	Purple Coneflower	100mm pot	Potted	400 mm o.c.
HS	23	Hemerocallis 'Stella D'Oro'	Stella D'Oro Day Lily	150mm pot	Potted	400 mm o.c.
MS	3	Miscanthus sinensis 'Huron Blush'	Huron Blush Maiden Grass	250mm pot	Potted	500 mm o.c.
ST	12	Sedum telephium 'Autumn Joy'	Autumn Joy Sedum	150mm pot	Potted	400 mm o.c.

#### GENERAL NOTES:

- It is the responsibility of the appropriate contractor or official to report any errors, omissions or discrepancies on this plan with actual site conditions to the Landscape Architect before proceeding with construction.
- The contractor is to notify all utility companies and authorities prior to any excavation and ascertain locations of underground services.
- The contractor is to reinstate all areas and items damaged as a result of construction activity.
- The contractor is to comply with all pertinent codes and by-laws.
- The contractor is to maintain a positive surface run-off throughout the entire construction period.
- The Landscape Architect is not responsible for subsurface conditions.
- The contractor is to identify all existing trees to remain on site with the Landscape Architect prior to construction.
- The contractor is to stake the proposed location of all plant material in conjunction with the Landscape Architect prior to excavation.
- Minimum distances for selected deciduous trees are as follows:
  - Building Foundations 7.5m
  - Sidewalks 1.5m
  - Public Streets 2.5m
  - Underground Infrastructure 2.0m
- All trees within 1m of underground utility trenches are to be excavated by hand.
- Remove all protective wrapping from tree trunks after installation.
- Staking of trees shall only be performed if necessary.
- Ensure that mulch is pulled back a min. distance of 75mm from base of tree trunk.
- The landscape plan has been developed as per the geotechnical report prepared by Gemtech Consulting Engineers and Scientists Limited September 2, 2021.

CLIENT: **Israr Akhtar**  
1111 Havelock Road, Ottawa ON, K1V 6B5

CONSULTANTS: **CSV ARCHITECTS**  
sustainable design - conception écologique  
613.566.8118 190 D'Orville Street, Suite 100  
www.csv.ca Ottawa, Ontario K2P 2K3

CIVIL ENGINEERS: **JAIN**  
Jain Infrastructure Consultants Ltd.  
7405 EAST DAWSON CRESCENT  
MISSISSAUGA, ON L5N 6P9  
TEL: (905) 285-9900, FAX: (905) 567-6246  
Email: jay@jainconsultants.com

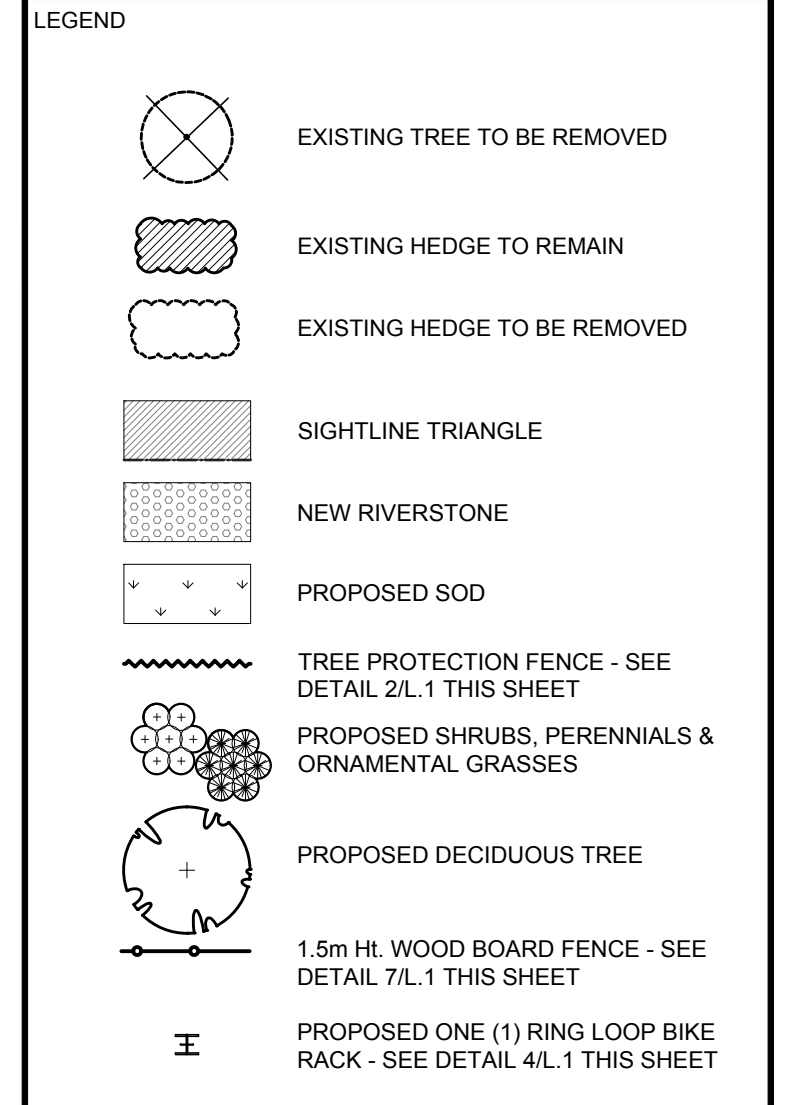

6	REVISED PER CITY COMMENTS	11/14/2022	ML	JL
5	REVISED PER CITY COMMENTS	11/16/2021	ML	JL
4	REVISED PER CITY COMMENTS	11/11/2021	ML	JL
3	REVISED PER CITY COMMENTS	10/28/2021	ML	JL
2	REVISED PER NEW SITE PLAN	05/20/2021	ML	JL
1	ISSUED FOR COORDINATION AND REVIEW	04/16/2021	WF	JL
No.	Issue	Date	DR	CK

**JAMES B. LENNOX & ASSOCIATES INC. LANDSCAPE ARCHITECTS**  
3332 CARLING AVE. OTTAWA, ONTARIO K2H 5A8  
Tel: (613) 722-5168 Fax: (866) 343-3942

PROJECT: 1050 KLONDIKE ROAD OTTAWA, ON

DRAWING: TREE CONSERVATION REPORT & LANDSCAPE PLAN

SCALE: AS SHOWN  
START DATE: OCTOBER 2020  
PROJECT NO.: 20MIS2084

DRAWING NO.: L.1  
PLOT SIZE ARCH-D

1 TREE CONSERVATION REPORT & LANDSCAPE PLAN  
SCALE 1:150

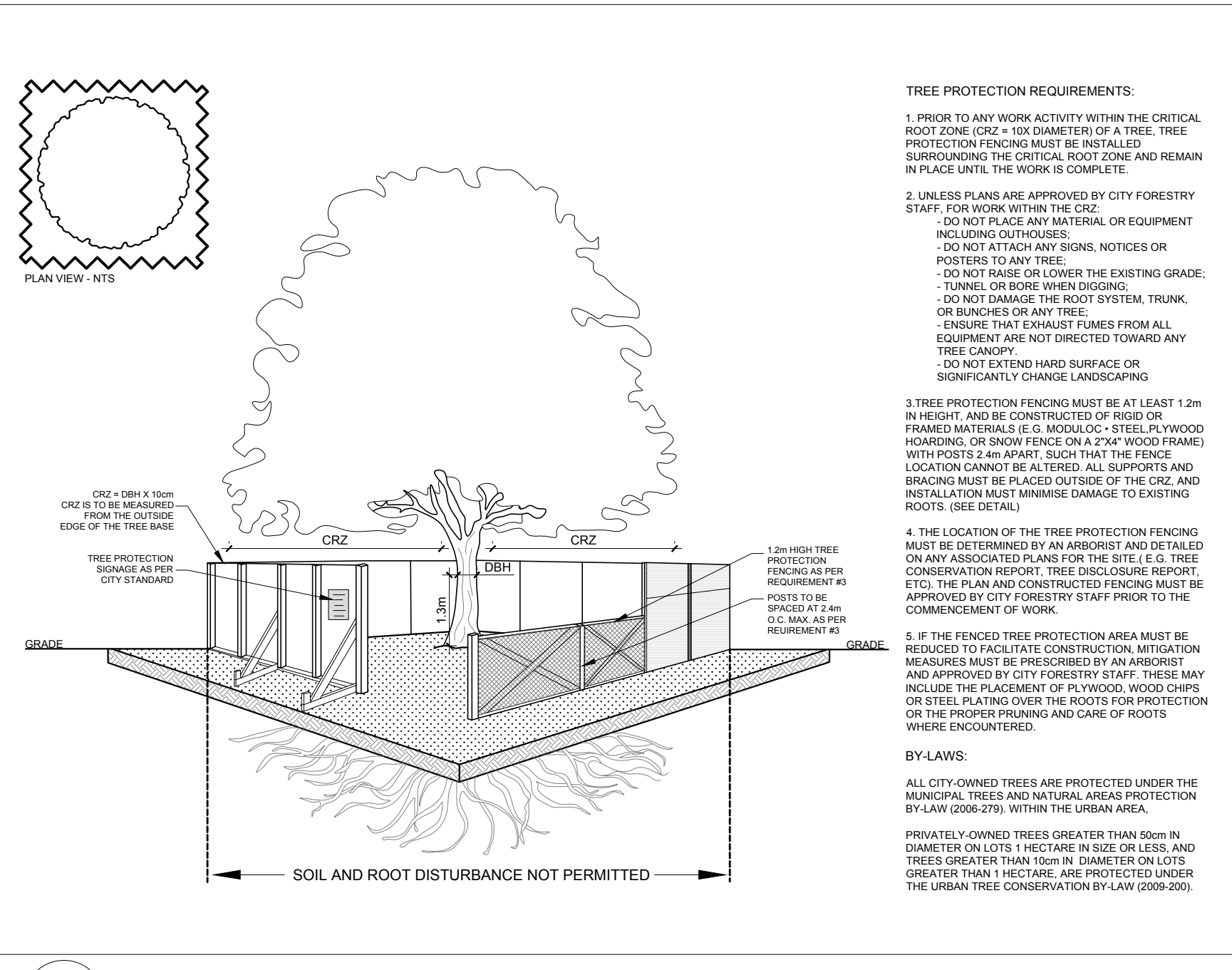
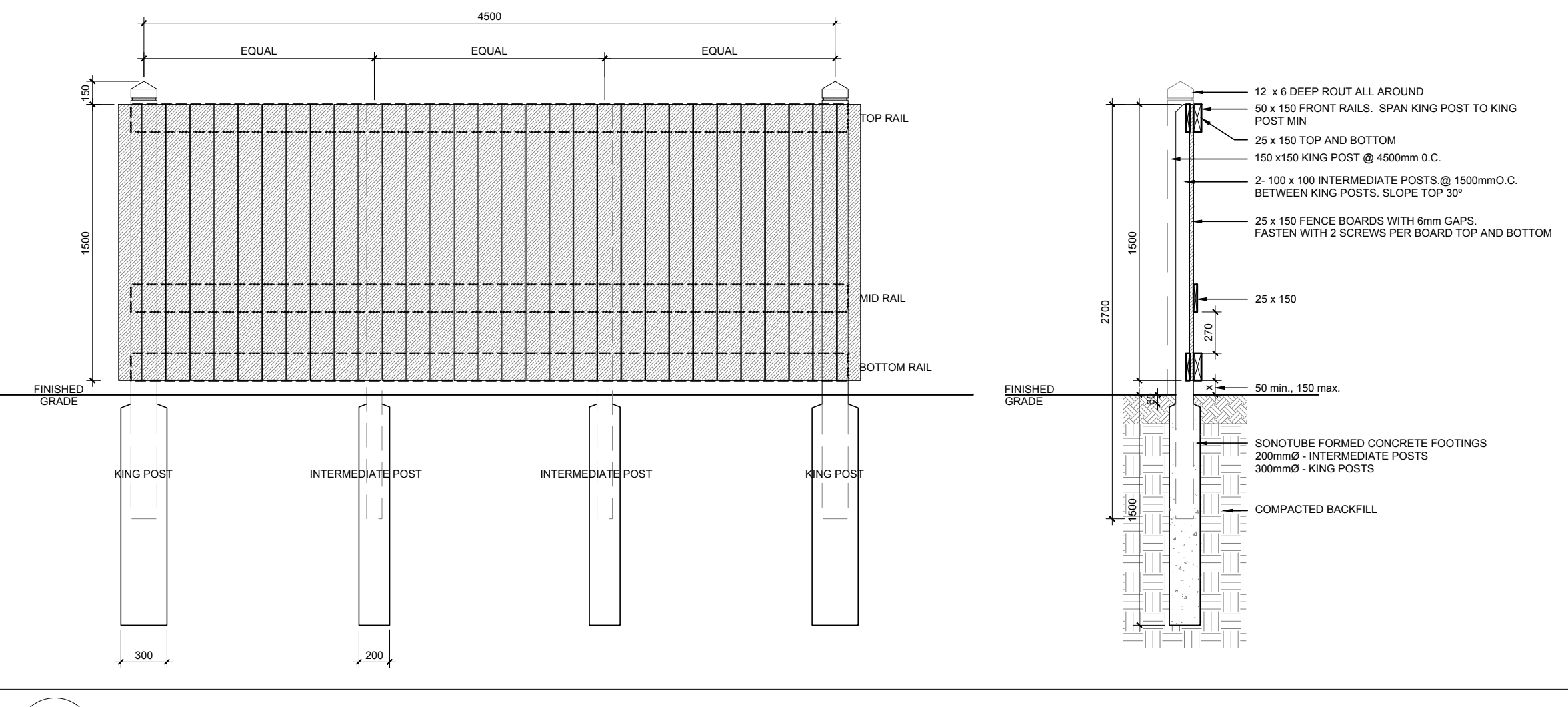
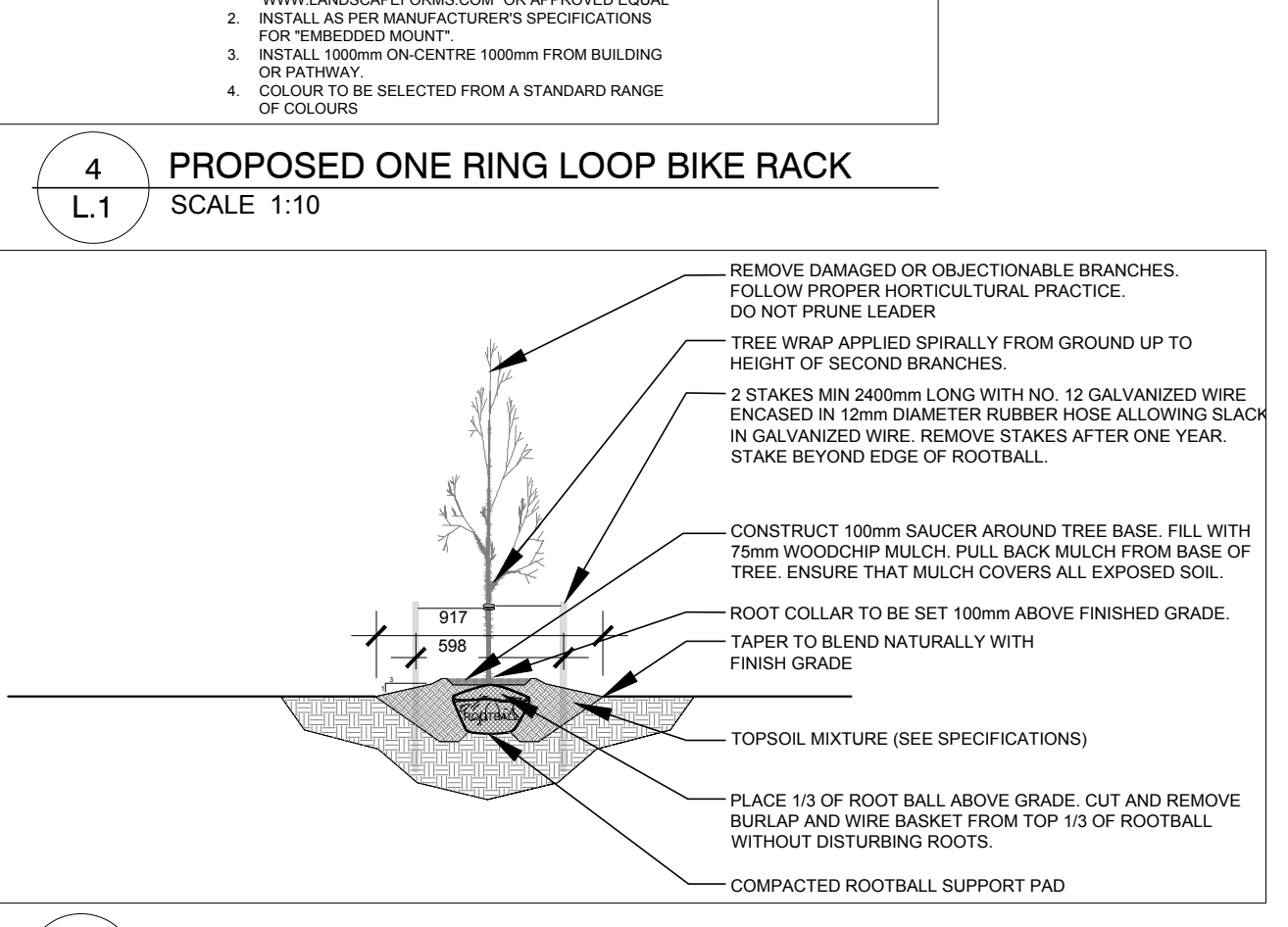
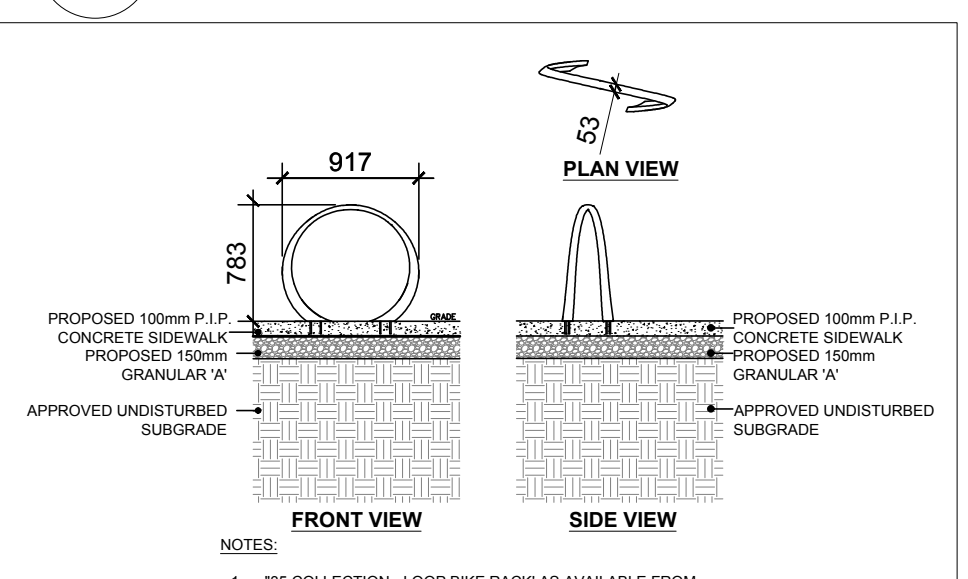
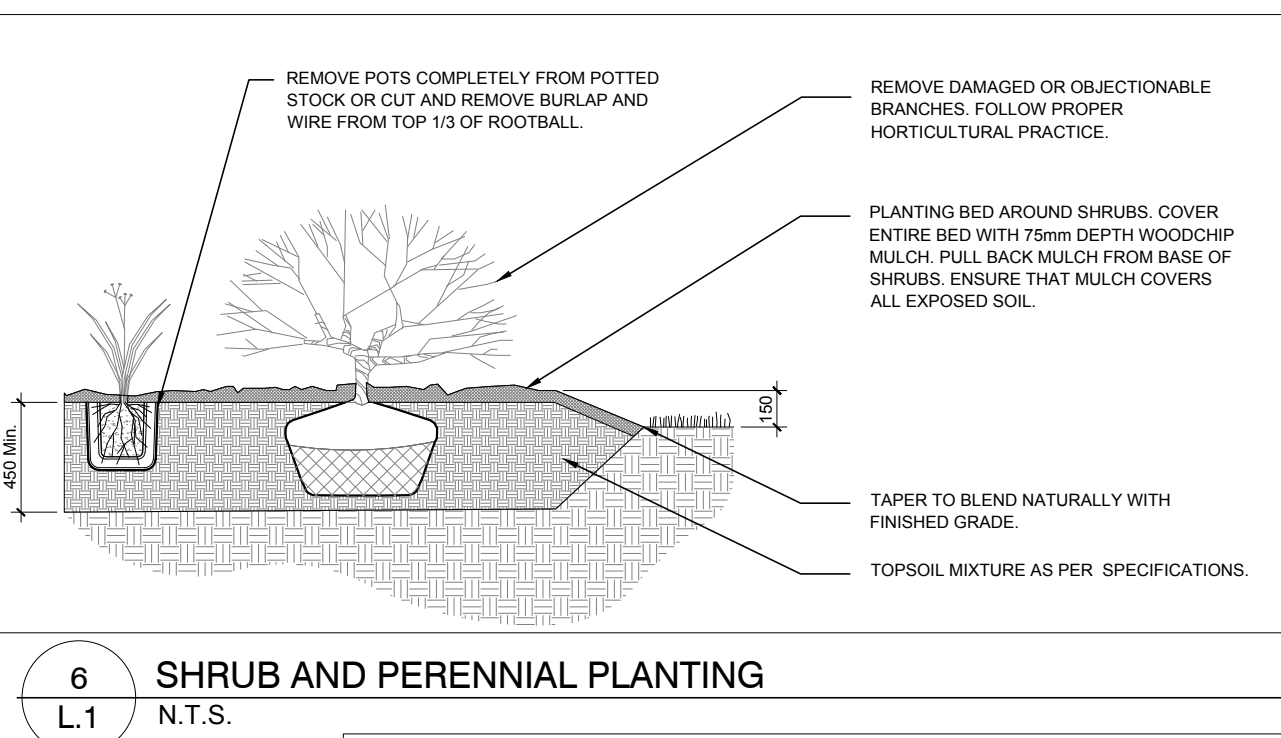
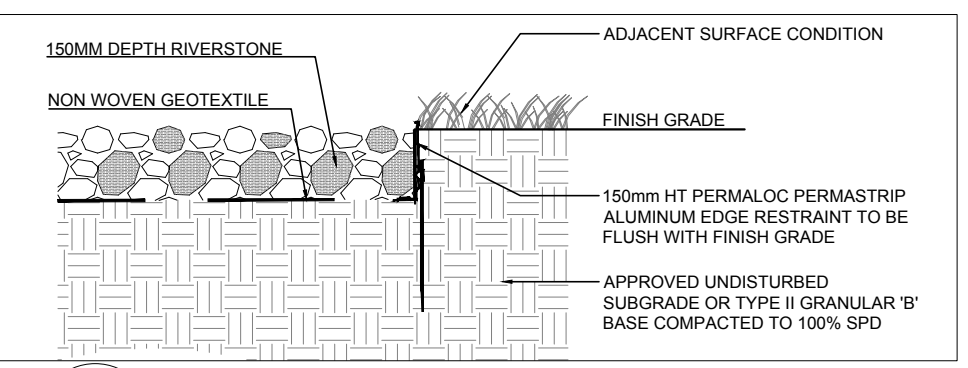

D07-12-21-0066

#18639