

GENERAL NOTES

- CONTRACTOR IS RESPONSIBLE FOR ALL LAYOUT FOR CONSTRUCTION.
- ALL ELEVATIONS ARE GEODETIC AND UTILIZE METRIC UNITS.
- JOB BENCH MARK - CONFIRM WITH JIC LTD. PRIOR TO UTILIZATION.
- ALL DIMENSIONS ARE IN METERS UNLESS OTHERWISE STATED. ALL DRAWINGS SHOULD NOT BE SCALED BY THE CONTRACTOR. ANY MISSING OR QUESTIONABLE DIMENSIONS ARE TO BE CONFIRMED WITH THE CONSULTANT IN WRITING.
- CONSTRUCTION SHALL BE IN ACCORDANCE WITH CITY OF OTTAWA AND ONTARIO PROVINCIAL STANDARD DRAWING SUPPLEMENTS WHERE APPLICABLE AND ONTARIO PROVINCIAL STANDARDS SHALL APPLY WHERE NO CITY STANDARDS ARE AVAILABLE.
- ANY DISCREPANCIES, INTERPRETATIONS, CHANGES AND ADDITIONS TO THESE DRAWINGS MUST BE BROUGHT TO THE ATTENTION OF THE ENGINEER, WHEN NOTED AND BEFORE PROCEEDING WITH CONSTRUCTION WORKS.
- REFER TO ARCHITECT'S SITE PLAN FOR BUILDING DIMENSIONS AND SITE LAYOUT DIMENSIONS AND LAYOUT

- INFORMATION SHALL BE CONFIRMED PRIOR TO COMMENCEMENT OF CONSTRUCTION.
- REFER TO THE LANDSCAPE ARCHITECT'S PLAN FOR SIDEWALK, PATHWAYS, PLANTING AND OTHER LANDSCAPE FEATURE MATERIALS AND LOCATIONS.
- FOR GEOTECHNICAL INFORMATION REFER TO THE GEOTECHNICAL INVESTIGATION REPORT PREPARED BY GEMTEC CONSULTING ENGINEERS AND SCIENTISTS LTD. DATED OCTOBER 2020.
- ALL DISTURBED AREAS TO BE REINSTATED TO EQUAL OR BETTER CONDITION. ALL NEW WORK SHALL TIE INTO EXISTING.
- ALL GROUND SURFACES SHALL BE EVENLY GRADED WITHOUT PONDING AREAS AND WITHOUT LOW POINTS EXCEPT WHERE APPROVED SWALE OR CATCHBASIN OUTLETS ARE PROVIDED.
- ALL EDGES OF DISTURBED PAVEMENT SHALL BE SAWCUT TO FORM A NEAT AND STRAIGHT LINE PRIOR TO PLACING NEW PAVEMENT.
- CONTRACTOR IS TO COMPLY WITH THE CITY OF OTTAWA REQUIREMENTS FOR TRAFFIC CONTROL WHEN WORKING ON CITY STREETS.

- ALL MATERIAL SUPPLIED AND PLACED FOR PARKING LOT AND ACCESS ROAD CONSTRUCTION SHALL BE TO CITY OF OTTAWA AND OPSS STANDARDS AND SPECIFICATIONS UNLESS OTHERWISE NOTED (CONSTRUCTION OPSS 206, 310 & 314 MATERIALS OPSS 1001, 1003 & 1010).
- THE CONTRACTOR SHALL CONFIRM LOCATIONS AND ELEVATIONS OF EXISTING SERVICES AND STRUCTURES TO BE CONNECTED TO AND EXISTING SERVICES THAT MAY BE DAMAGED OR CAUSE CONFLICTS PRIOR TO CONSTRUCTION OF ANY NEW SEWER, WATER AND/OR STORM WATER WORKS. THE ENGINEER SHALL BE INFORMED IMMEDIATELY OF ANY ERRORS, DISCREPANCIES, CONFLICTS, OMISSIONS ETC THAT ARE FOUND. DO NOT CONTINUE CONSTRUCTION IN AREAS WHERE DISCREPANCIES APPEAR UNTIL SUCH DISCREPANCIES HAVE BEEN RESOLVED.
- THE CONTRACTOR SHALL PROTECT ANY SUCH EXISTING SERVICES & FACILITIES. SUCH REQUIRED MEASURES INCLUDE, BUT ARE NOT LIMITED TO: ENSURE ALL CONCERNED UTILITIES HAVE LOCATED THEIR PLANT PRIOR TO ANY EXCAVATING, LOCATE AND FLAG/PAINT THE LOCATIONS OF OTHER U/G PLANT WHICH MIGHT BE

- DAMAGED BY EXCAVATION AND CONSTRUCTION TRAFFIC. HAND DIG IN PROXIMITY TO EXISTING BURIED SERVICES TO LOCATE THEM WITHOUT ANY RESULTING DAMAGE, BRACE AND SUPPORT WHERE REQUIRED.
- THE CONTRACTOR SHALL IMPLEMENT BEST MANAGEMENT PRACTICES FOR THE PROTECTION OF THE AREA'S DRAINAGE SYSTEM AND THE RECEIVING WATERCOURSE DURING CONSTRUCTION ACTIVITIES. THIS INCLUDES LIMITING THE AMOUNT OF EXPOSED SOIL, USING FILTER CLOTH UNDER GRATES OF CATCHBASINS AND MANHOLES AND INSTALLING SILT FENCES AND OTHER EFFECTIVE SEDIMENT TRAPS. THE CONTRACTOR ACKNOWLEDGES THAT FAILURE TO IMPLEMENT APPROPRIATE EROSION AND SEDIMENT CONTROL MEASURES MAY BE SUBJECT TO PENALTIES IMPOSED BY ANY APPLICABLE REGULATORY AGENCY.
- DESIGN ELEVATIONS GIVEN ON THESE PLANS ARE TO BE ADHERED TO WITH NO CHANGES WITHOUT PRIOR WRITTEN APPROVAL BY JIC LTD. SURFACE PONDING STORAGE VOLUMES AND INLET CONTROL DEVICE DIMENSIONS MUST COMPLY WITH THE DESIGN REPORT PREPARED BY JIC LTD. FOR THIS PROJECT.

- THE CONTRACTOR IS RESPONSIBLE FOR AND SHALL PROVIDE FOR DEWATERING, SUPPORT AND PROTECTION OF EXCAVATION AND TRENCHING AS WELL AS RELEASE OF ANY PUMPED GROUND WATER IN A CONTROLLED AND APPROVED MANNER. THE CONTRACTOR SHALL APPLY FOR A PERMIT TO TAKE WATER FROM THE MINISTRY OF ENVIRONMENT IF MORE THAN 50,000 LITERS PER/DAY OF GROUNDWATER IS PUMPED FOR CONSTRUCTION ACTIVITIES.
- FOR TOPOGRAPHICAL INFORMATION REFER TO PLAN PREPARED BY ANNIS, O'SULLIVAN, VOLLEBEK LTD. FOR LEGAL PROPERTY LINE DESCRIPTIONS.
- CITY INSPECTOR IS TO NOTIFIED OF ANY WORKS IN THE ROW WITH SUFFICIENT NOTICE.
- CLAY SEAL TO BE AS PER OPSS 802.095.
- WHICH DIFFER FROM THE TEST LOCATIONS IDENTIFIED IN THE GEOTECHNICAL REPORT. GEMTEC'S GEOTECHNICAL ENGINEER IS TO BE NOTIFIED IMMEDIATELY IN ORDER TO PERMIT REASSESSMENT OF THE GEOTECHNICAL RECOMMENDATIONS.

ROADWAYS & CURBS

- ASPHALT REINSTATEMENT AS PER CITY OF OTTAWA STANDARD DRAWING R10.
- CURBS TO BE CONCRETE BARRIER CURBS AS PER CITY OF OTTAWA STANDARD DRAWING SC1.1
- THE CONTRACTOR SHALL COMPLETE ALL RESTORATION WITHIN CITY ROW'S TO A CONDITION EQUAL TO ORIGINAL OR BETTER AND TO THE SATISFACTION OF THE MUNICIPAL AUTHORITIES.

PAVEMENT SPECIFICATION

FOR THE ACCESS ROADWAYS AND PARKING LOTS, THE FOLLOWING MINIMUM PAVEMENT STRUCTURE SHOULD BE USED:

- 100 MILLIMETRES OF HOT MIX ASPHALTIC CONCRETE, OVER
- 150 MILLIMETRES OF OPSS GRANULAR A BASE, OVER
- 450 MILLIMETRES OF OPSS GRANULAR B, TYPE II SUBBASE

THE HOT MIX ASPHALT SHOULD CONSIST OF THE FOLLOWING LAYERS:

- 40 MILLIMETRES OF SUPERPAVE 12.5 (TRAFFIC LEVEL B), OVER
- 60 MILLIMETRES OF SUPERPAVE 19.0 (TRAFFIC LEVEL B)

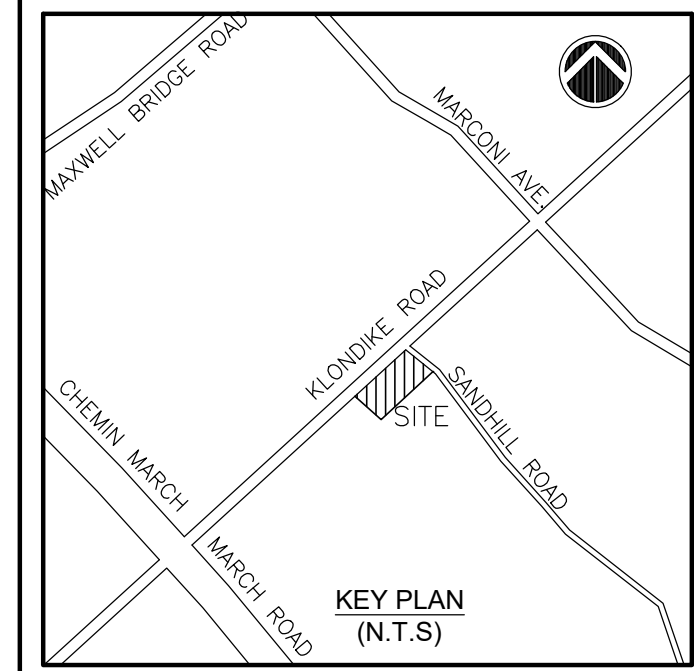
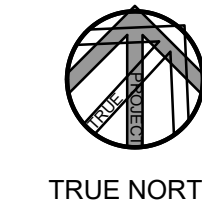

- DRAWING REFERENCES**
- THE SITE PLAN MUST BE READ IN CONJUNCTION WITH ARCHITECTURAL, LANDSCAPING, ELECTRICAL & STRUCTURAL PLANS.
 - FOR SERVISING PLAN, REFER DRAWING C101.
 - FOR EROSION CONTROL, CITY STANDARD NOTES & DETAILS REFER DRAWING C103.

LEGAL DESCRIPTION:
 PLAN OF SURVEY & TOPOGRAPHIC INFORMATION PREPARED BY ANNIS, O'SULLIVAN, VOLLEBEK LTD. (O.S.), IDENTIFIED AS PART OF LOT 10, CONCESSION 4 GEOGRAPHIC TOWNSHIP OF MARCH CITY OF OTTAWA

BEARING NOTE:
 BEARINGS ARE GRID, DERIVED FROM CAN-NET 2016 REL TIME NETWORK GPS OBSERVATIONS, MTM ZONE 9 (76° 30' WEST LONGITUDE) NAD-83 (ORIGINAL).

LEGEND

- EXISTING ELEVATION (SURVEY)
- PROPOSED STORM MANHOLE
- PROPOSED CATCH BASIN
- EXISTING MANHOLE
- EXISTING CATCH BASIN
- EXISTING VALVE CHAMBER (WATERMAIN)
- EXISTING FIRE HYDRANT
- +76.04(Ex) EXISTING ELEVATION TO REMAIN
- +76.15 PROPOSED ELEVATION
- +76.30 TC PROP. TOP OF CURB ELEVATION
- PROPOSED SLOPE
- OVERLAND FLOW ROUTE
- V&B VALVE & BOX
- RD ROOF DRAIN

REVISION

| No. | DESCRIPTION | DATE |
|-----|----------------|-----------|
| 1 | ISSUED FOR SPA | MAY 19,21 |

| No. | DESCRIPTION | DATE |
|-----|----------------|-----------|
| 1 | ISSUED FOR SPA | MAY 19,21 |

JAIN
 Jain Infrastructure Consultants Ltd.
 7405 EAST DANBRO CRESCENT
 MISSISSAUGA, ON L5N 6P8
 TEL: (905) 285-9900, FAX: (905) 567-5246
 Email: yayub@jainconsultants.com

PROJECT
 1050 KLONDIKE ROAD
 OTTAWA, ONTARIO, K2K 1X7

DRAWING TITLE
 SITE GRADING PLAN

| | |
|--------------------|---------|
| SCALE: 1:150 | DWG No. |
| DATE: May 20, 2021 | C102 |
| DRAWN BY: CC | |
| CHECKED BY: YA | |

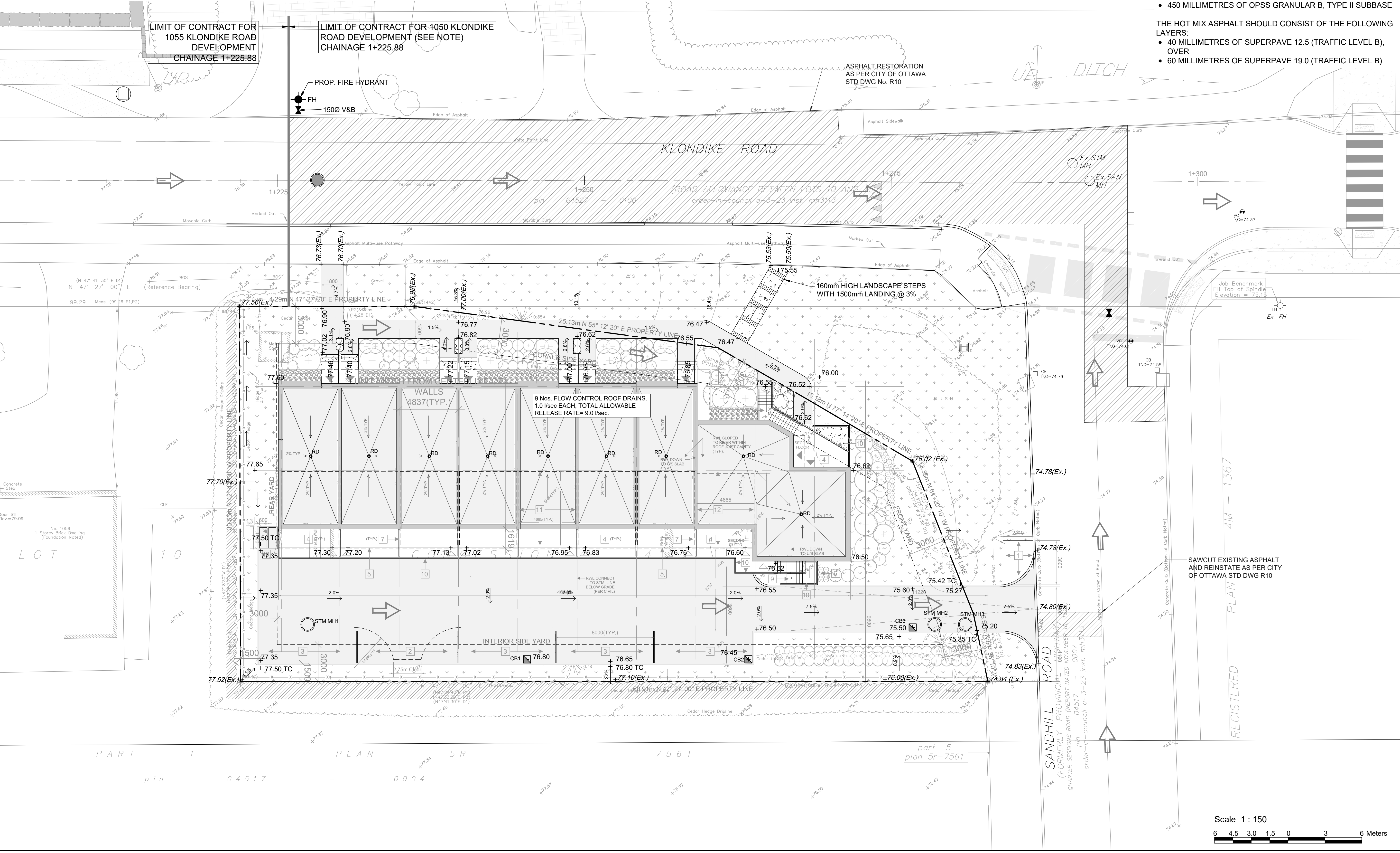

SAWCUT EXISTING ASPHALT AND REINSTATE AS PER CITY OF OTTAWA STD DWG R10

REGISTERED PLAN 4M-1367



Scale 1:150

PART 1 PLAN 5R - 7561
 pin 04517 - 0004

part 5 plan 5r-7561

SANDHILL ROAD
 (FOR LOTS 1, 2, 3, 4, 5, 6, 7, 8, 9, 10, 11, 12, 13, 14, 15, 16, 17, 18, 19, 20, 21, 22, 23, 24, 25, 26, 27, 28, 29, 30, 31, 32, 33, 34, 35, 36, 37, 38, 39, 40, 41, 42, 43, 44, 45, 46, 47, 48, 49, 50, 51, 52, 53, 54, 55, 56, 57, 58, 59, 60, 61, 62, 63, 64, 65, 66, 67, 68, 69, 70, 71, 72, 73, 74, 75, 76, 77, 78, 79, 80, 81, 82, 83, 84, 85, 86, 87, 88, 89, 90, 91, 92, 93, 94, 95, 96, 97, 98, 99, 100)
 QUARTER SESSIONS ROAD 04517 - 0007
 order-in-council a-3-23 inst. rnh-3-23