

A:\25508\_Panorama\070\_Ponding\03\_Design\04\_Civil\Sheet\M60-PONDING PLAN.dwg Layout Name: 000 Plot Size: AIA STANDARD-FULLCOTE Plot Scale: 1:25.4 Plotted At: 2021-09-29 Last Saved By: mmh Last Saved At: 2021-07-22

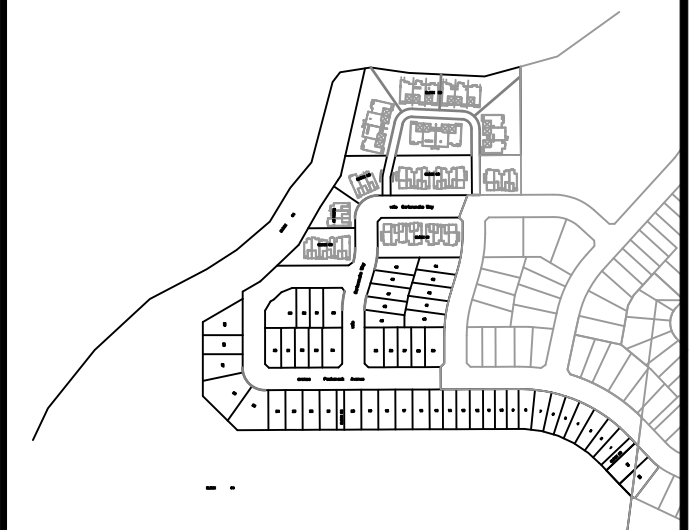
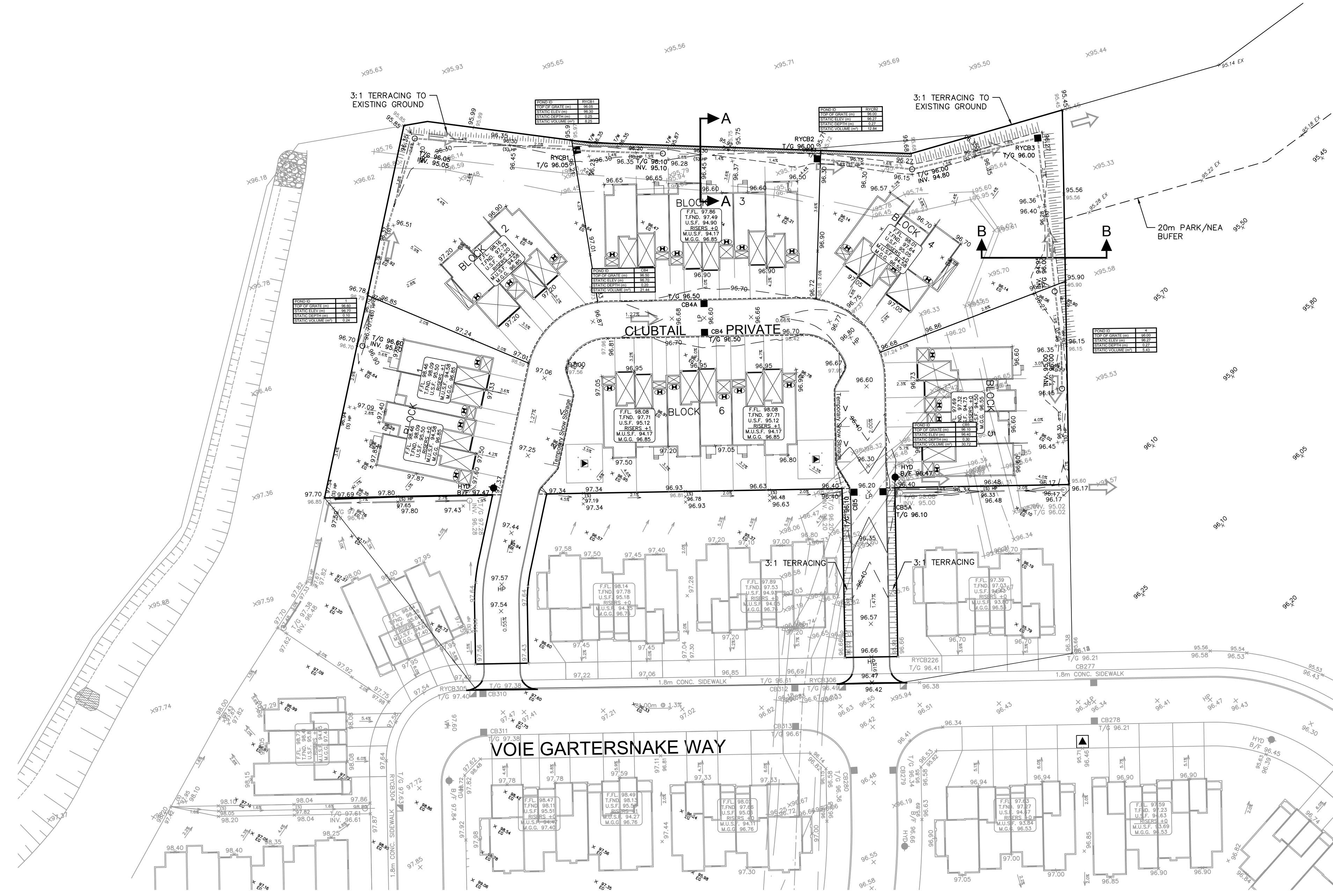

14			
13			
12			
11			
10			
9			
8			
7			
6			
5			
4	REVISED PER CITY COMMENTS	D.G.Y.	2021.08.29
3	ISSUED FOR TENDER	D.G.Y.	2021.09.16
2	REVISED PER CITY COMMENTS	D.G.Y.	2021.08.24
1	SUBMISSION No.1 FOR CITY REVIEW	D.G.Y.	2021.05.13
No.	REVISIONS	By	Date

**LEITRIM SOUTH HOLDINGS INC.**

**IBI** IBI GROUP  
 400 - 333 Preston Street  
 Ottawa ON K1S 5N4 Canada  
 tel 613 225 1311 fax 613 225 9868  
 ibigroup.com

Project Title   
**pathways**  
 at FINDLAY CREEK  
 BLOCK 60

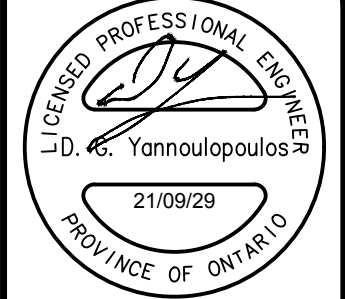
  
 D. Yannouloupoulos  
 21/09/29  
 PROVINCE OF ONTARIO

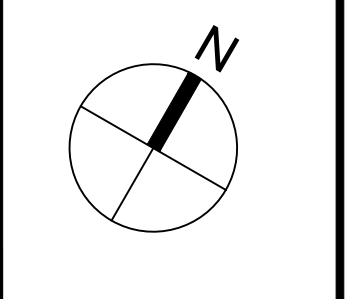

Drawing Title  
**PONDING PLAN**

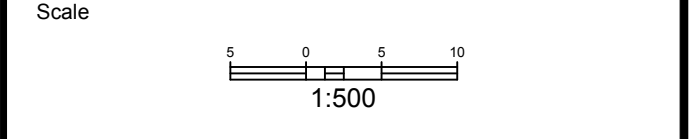

Design	R.M.	Date	OCTOBER 2020
Drawn	M.M.	Checked	K.H.
Project No.	125506	Drawing No.	600