

NOT FOR CONSTRUCTION

NOTE:
THE POSITION OF ALL POLE LINES, CONDUITS,
WATERMANS, SEWERS AND OTHER
UNDERGROUND AND OVERGROUND UTILITIES AND
STRUCTURES IS NOT NECESSARILY SHOWN ON
THE CONTRACT DRAWINGS, AND WHERE SHOWN,
THE ACCURACY OF THE POSITION OF SUCH
UTILITIES AND STRUCTURES IS NOT GUARANTEED.
BEFORE STARTING WORK, DETERMINE THE EXACT
LOCATION OF ALL SUCH UTILITIES AND
STRUCTURES AND ASSUME ALL LIABILITY FOR
DAMAGE TO THEM.

No.	REVISION	DATE	BY
2	ISSUED FOR SITE PLAN APPROVAL	MAY 2021	RGJ
1	ISSUED FOR COORDINATION	MAY 2021	RGJ

SCALE	
1:1500	
0 15 30 45 60	

DESIGN	RGJMEL
CHECKED	RGJ
DRAWN	MEL
CHECKED	RGJ
APPROVED	RGJ

FOR REVIEW ONLY

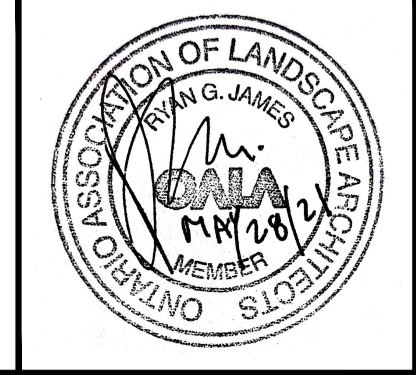

NOVATECH
Engineers, Planners & Landscape Architects
Suite 200, 240 Michael Cowpland Drive
Ottawa, Ontario, Canada K2M 1P6
Telephone: (613) 254-9643
Facsimile: (613) 254-5867
Website: www.novatech-eng.com

LOCATION SORTATION FACILITY 99 BILL LEATHAM DRIVE, 2 LEIKIN DRIVE AND 20 LEIKIN DRIVE, OTTAWA, ONTARIO	PROJECT No. 121137-00
DRAWING NAME LANDSCAPE OVERALL PLAN	REV # 2
	DRAWING No. 121137-L0

C:\Users\rgj\OneDrive\Desktop\121137-L0.dwg, 10 May 31, 2021, 2:45pm, mltal

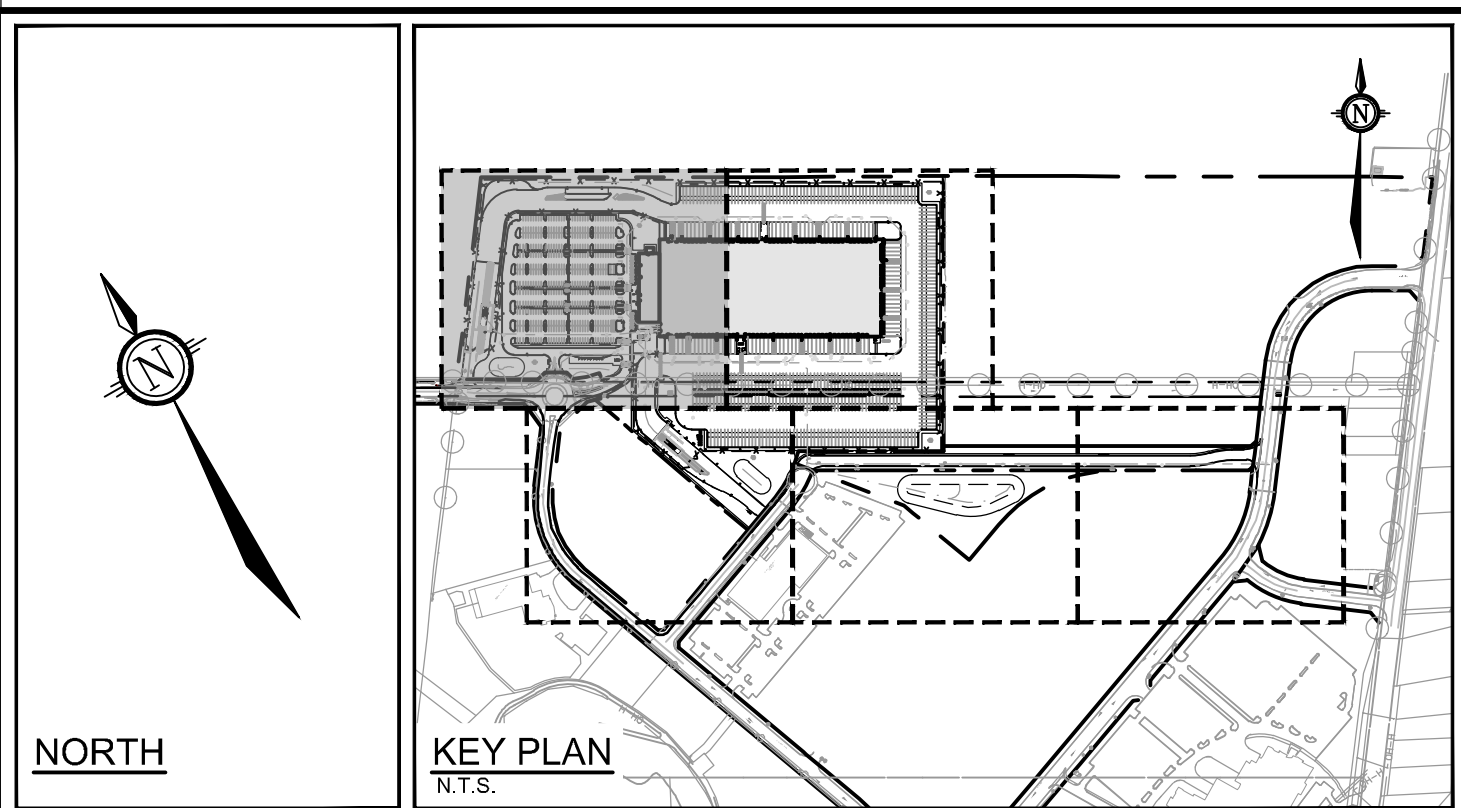
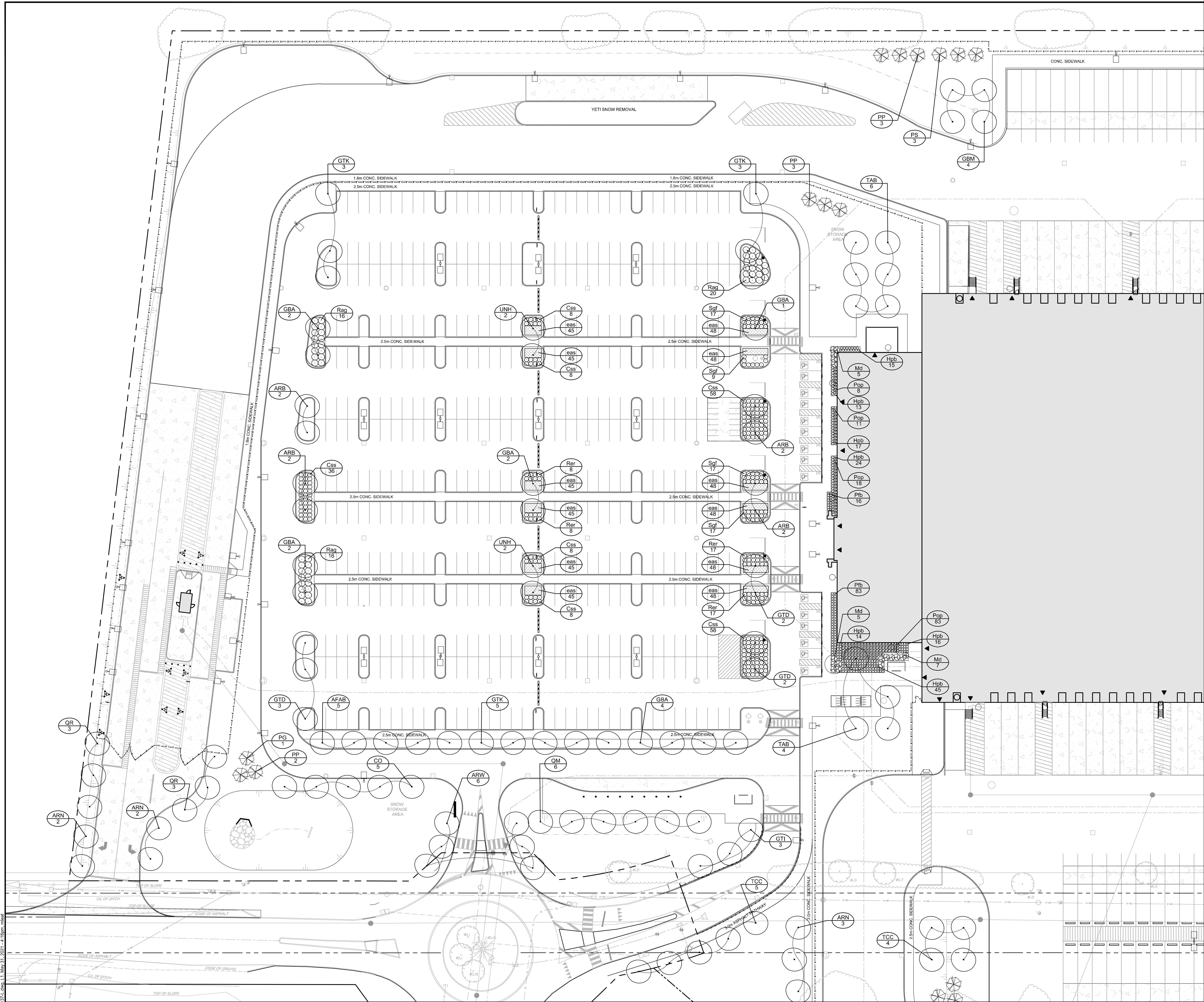

- LEGEND**
- PROPOSED CONIFEROUS TREE
 - PROPOSED DECIDUOUS TREE
 - PROPOSED SHRUBS
 - ORNAMENTAL GRASSES
 - SPECIES (SEE PLANT LIST)
 - QUANTITY
 - CHAIN LINK FENCE

- GENERAL**
1. Read and interpret this drawing/ drawing set in conjunction with all the contract details and specifications, including related civil, utility, structural, architectural, mechanical, electrical, environmental, geotechnical, and survey information.
 2. The Contractor is to determine the exact location, size, material, and elevation of all existing utilities prior to commencing construction. Protect and assume responsibility for all existing utilities regardless of being shown on the drawings.
 3. It is essential to use the plans and details in conjunction with the specifications and notes.
 4. Do not scale drawings. Work to dimensions only.
 5. Protect all existing and retained vegetation for the duration of construction according to the contract details and specifications.
 6. Reinstall all areas and items damaged or disturbed, beyond the Limit of Work, because of construction activities, including but not limited to construction staging areas, haul roads, stockpile areas, etc. to the satisfaction of the Consultant. Unless otherwise noted, Contractor is to reinstall all areas to pre-construction condition or better to the satisfaction of the Contract Administrator.

- PLANTING**
1. Plant material to be No. 1 Grade and is to comply with Canadian Standards for Nursery Stock (latest edition) published by the Canadian Nursery Landscape Association.
 2. Use structurally sound plant material with strong fibrous root system free of disease, defects, and injuries. Use trees with straight trunks, well and characteristically branched for species. Obtain approval from consultant of plant material at source prior to digging. All trees and shrubs to be container grown, potted, WB or BB, as indicated on Plant List. Bare root plants are only acceptable for certain species and as approved by the Landscape Architect.
 3. Plant material substitutions are not to be permitted without the written approval from the Consultant, with 48 hours notice, prior to shipping plant material.
 4. Plant locations are schematic; approximate only. Contractor is to stake out locations on site for approval by the Landscape Architect prior to installation. Contractor will assume full responsibility if the Landscape Architect is not notified.
 5. The illustrated number of plants shown in the Planting Plan supersedes the estimated number in the Plant List.
 6. Ensure trees are thoroughly watered following planting. Monitor material and ensure adequate moisture until acceptance.
 7. In heavy clay or poorly drained soils, set root ball with root collar 75-100mm higher than finished grade.
 8. Approved topsoil depths are as follows:
 - a. Plant Beds - 450mm continuous depth. Applies to shrubs, perennials, vines, and groundcovers.
 - b. Sod/ Seed Areas - 100mm depth.
 - c. Reforestation - 300mm depth.
 9. Sod to be No. 1 Kentucky Bluegrass Sod grown from minimum mixture of 3 Kentucky Bluegrass cultivars. Quality and source are to comply with Canadian Standards for Nursery Stock, Section 17, (latest edition) published by the Canadian Nursery Landscape Nursery Landscape Association.
 10. Install a 1.2m sod strip adjacent to all hard surfaces. Note, sod is not typically graphically shown on plans.
 11. Apply the following mineral fertilizer unless soil tests show other requirements:
 - a. Plant Beds - (8-32-16), i.e. 8% Nitrogen, 32% Phosphorus, 16% Potash per manufacturer specifications.
 - b. Sod Areas - (8-32-16), i.e. 8% Nitrogen, 32% Phosphorus, 16% Potash at a rate of 350kg/ha.
 12. Where applicable, for any plant areas with a mix of species/ cultivars notes, Contractor is to cluster like plants in groups of 3-5 and evenly distribute these in the noted area.

PLANT LIST

KEY	QTY	BOTANICAL NAME	COMMON NAME	SIZE	COND	SPACING
Coniferous Trees						
PG	1	<i>Picea glauca</i>	White Spruce	200cm Ht	WB	As Shown
PP	8	<i>Picea pungens</i>	Colorado Spruce	200cm Ht	WB	As Shown
PS	3	<i>Pinus strobus</i>	Eastern White Pine	200cm Ht	WB	As Shown
Deciduous Trees						
ARB	8	<i>Acer rubrum 'Bowhal'</i>	Bowhal Red Maple	50mm Cal	WB	As Shown
ARW	6	<i>Acer rubrum 'New World'</i>	New World Red Maple	50mm Cal	WB	As Shown
ARV	7	<i>Acer rubrum 'Northwood'</i>	Northwood Red Maple	50mm Cal	WB	As Shown
AFAB	5	<i>Acer x freemanii 'Firefall'</i>	Firefall Maple	50mm Cal	WB	As Shown
CO	5	<i>Celtis occidentalis</i>	Hackberry	50mm Cal	WB	As Shown
GBA	11	<i>Ginkgo biloba 'Autumn Gold'</i>	Autumn Gold Ginkgo	50mm Cal	WB	As Shown
GBM	4	<i>Ginkgo biloba 'Majesty'</i>	Majesty Ginkgo	50mm Cal	WB	As Shown
GTD	7	<i>Gleditsia triacanthos 'Draves'</i>	Street Keeper Locust	50mm Cal	WB	As Shown
GTI	3	<i>Gleditsia triacanthos var. 'inermis 'Impressa'</i>	Imperial Honeylocust	50mm Cal	WB	As Shown
GTK	11	<i>Gleditsia triacanthos var. 'inermis 'Skycole'</i>	Skyline Honeylocust	50mm Cal	WB	As Shown
QM	6	<i>Quercus macrocarpa</i>	Bur Oak	50mm Cal	WB	As Shown
QR	6	<i>Quercus rubra</i>	Red Oak	50mm Cal	WB	As Shown
TAB	10	<i>Tilia americana 'Boulevard'</i>	Boulevard Linden	50mm Cal	WB	As Shown
TCC	9	<i>Tilia cordata 'Corzani'</i>	Corzani Linden	50mm Cal	WB	As Shown
UNH	2	<i>Ulmus x 'New Horizon'</i>	New Horizon Elm	50mm Cal	WB	As Shown
Deciduous Shrubs						
Cas	184	<i>Cornus sanguinea 'Arctic Sun' (CATC)</i>	Arctic Sun Dogwood	60cm Ht	PT	As Shown
Hpb	144	<i>Hydrangea paniculata 'Bombshell'</i>	Bombshell Hydrangea	60cm Ht	PT	As Shown
Pap	120	<i>Physacarpus opulifolius 'Polaris 1'</i>	Gamstop Burgundy Candy Hinebark	60cm Ht	PT	As Shown
Pib	83	<i>Potentilla fruticosa 'Bella Sol'</i>	Bombshell Hydrangea	40cm Ht	PT	As Shown
Rag	52	<i>Rhus aromatica 'Gro-Low'</i>	Gro-Low Fragrant Sumac	60cm Ht	PT	As Shown
Rer	50	<i>Rosa Easy Elegance 'B&I' raga'</i>	Easy Elegance All The Rage	60cm Ht	PT	As Shown
Sgf	50	<i>Spiraea japonica 'Goldflame'</i>	Goldflame Spirea	60cm Ht	PT	As Shown
Coniferous Shrubs						
Md	17	<i>Microbiota decussata</i>	Siberian Carpet Cypress	40cm Spr	PT	As Shown
Ornamental Grasses						
cas	558	<i>Elymus arenarius 'Blue Dune'</i>	Blue Dune Lyme Grass	1g	PT	50cm O.C.

NOTE:
THE POSITION OF ALL POLE LINES, CONDUITS, WATERMANS, SEWERS AND OTHER UNDERGROUND AND OVERGROUND UTILITIES AND STRUCTURES IS NOT NECESSARILY SHOWN ON THE CONTRACT DRAWINGS, AND WHERE SHOWN, THE ACCURACY OF THE POSITION OF SUCH UTILITIES AND STRUCTURES IS NOT GUARANTEED. BEFORE STARTING WORK, DETERMINE THE EXACT LOCATION OF ALL SUCH UTILITIES AND STRUCTURES AND ASSUME ALL LIABILITY FOR DAMAGE TO THEM.

NOT FOR CONSTRUCTION

No.	REVISION	DATE	BY
2	ISSUED FOR SITE PLAN APPROVAL	MAY 28/21	RGJ
1	ISSUED FOR COORDINATION	MAY 20/21	RGJ

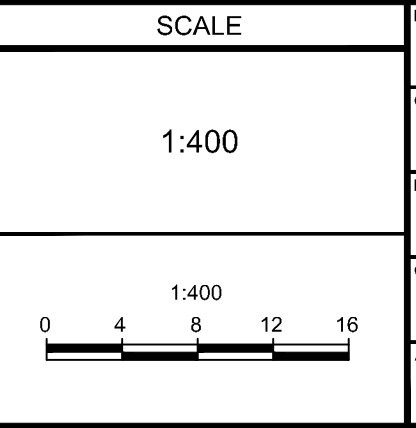

FOR REVIEW ONLY

RGJMEL
RGJ
MEL
RGJ
RGJ

NOVATECH
Engineers, Planners & Landscape Architects
Suite 200, 240 Michael Cowpland Drive
Ottawa, Ontario, Canada K2M 1P6
Telephone: (613) 254-9643
Facsimile: (613) 254-5867
Website: www.novatech-eng.com

LOCATION
SORTATION FACILITY
99 BILL LEATHER DRIVE, 2 LEIKIN DRIVE AND 20 LEIKIN DRIVE, OTTAWA, ONTARIO

DRAWING NAME
LANDSCAPE NORTH WEST DEVELOPMENT

PROJECT NO.: 121137-00
REV: # 2
DRAWING NO.: 121137-L1

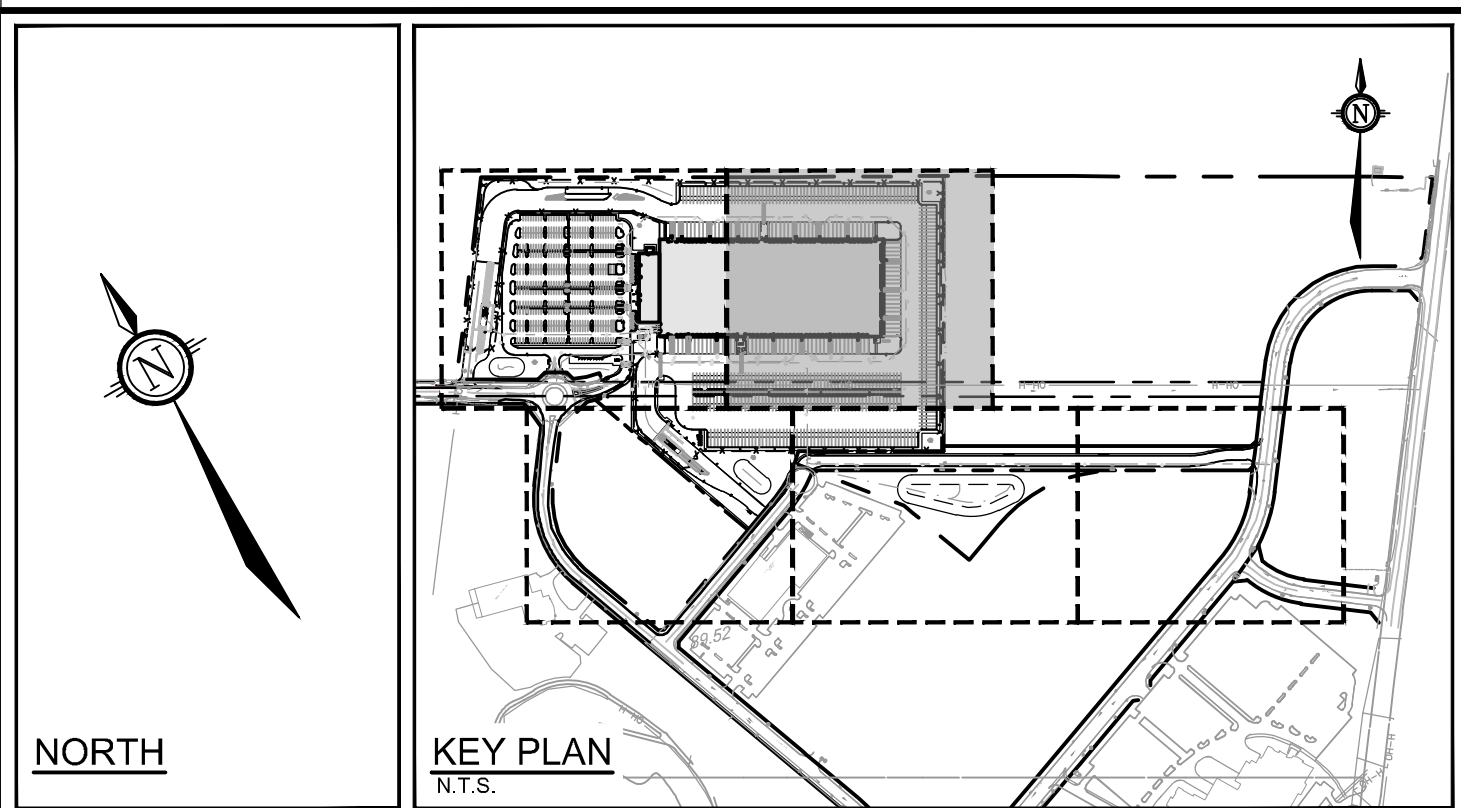
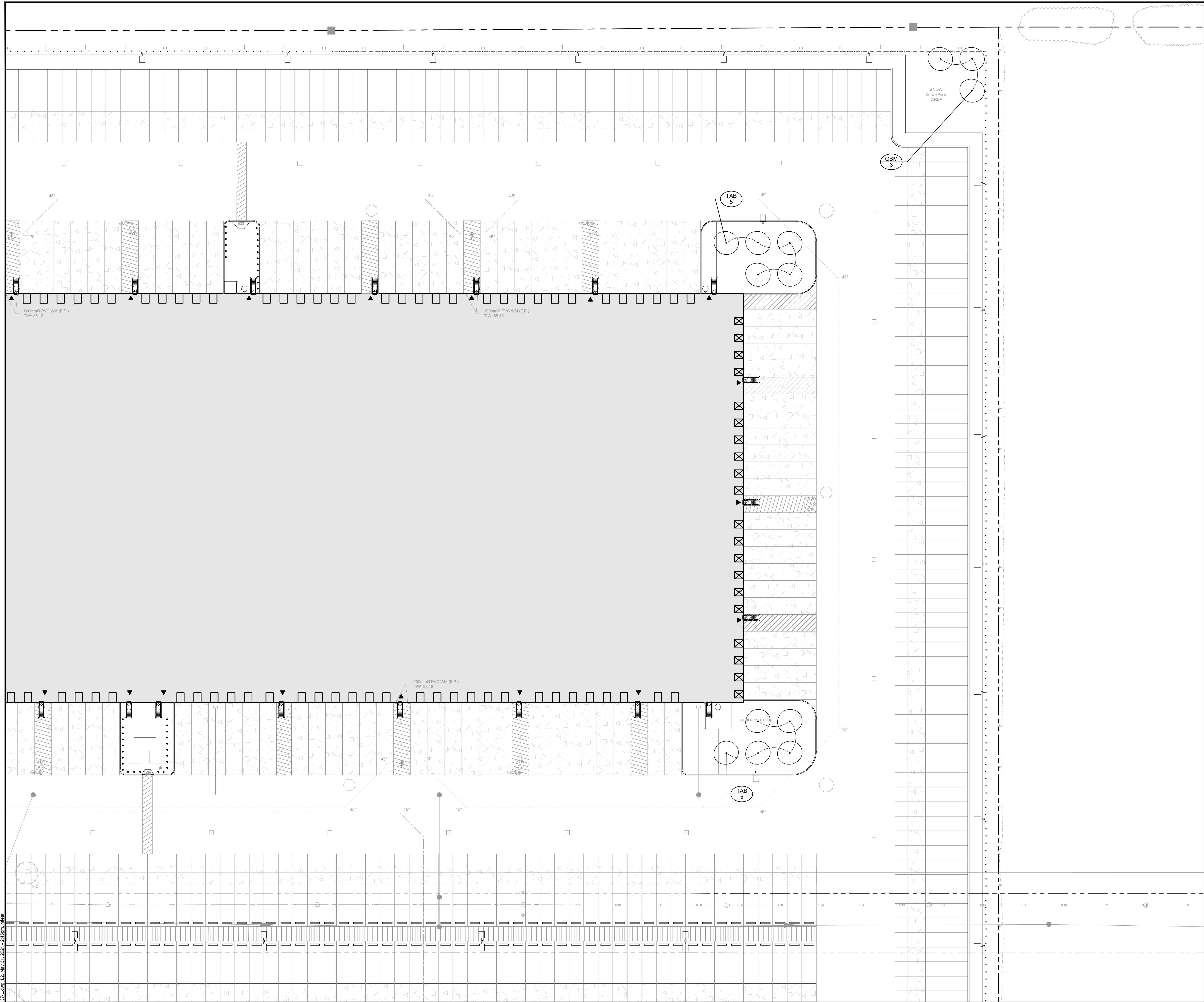

NORTH

KEY PLAN
N.T.S.

LEGEND

- PROPOSED CONIFEROUS TREE
- PROPOSED DECIDUOUS TREE
- PROPOSED SHRUBS
- ORNAMENTAL GRASSES
- SPECIES (SEE PLANT LIST)
- QUANTITY
- CHAIN LINK FENCE

PLANT LIST

KEY	QTY	BOTANICAL NAME	COMMON NAME	SIZE	COND	SPACING
Deciduous Trees						
GBM	3	<i>Crataegus bibba 'Magyar'</i>	Magyar Crataeg	50mm Cal	WB	As Shown
TAB	10	<i>Fila americana 'Boulevard'</i>	Boulevard Linden	50mm Cal	WB	As Shown

NOTE:
THE POSITION OF ALL POLE LINES, CONDUITS,
WATERMANS, SEWERS AND OTHER
UNDERGROUND AND OVERGROUND UTILITIES AND
STRUCTURES IS NOT NECESSARILY SHOWN ON
THE CONTRACT DRAWINGS, AND WHERE SHOWN,
THE ACCURACY OF THE POSITION OF SUCH
UTILITIES AND STRUCTURES IS NOT GUARANTEED.
BEFORE STARTING WORK, DETERMINE THE EXACT
LOCATION OF ALL SUCH UTILITIES AND
STRUCTURES AND ASSUME ALL LIABILITY FOR
DAMAGE TO THEM.

**NOT FOR
CONSTRUCTION**

No.	REVISION	DATE	BY
2	ISSUED FOR SITE PLAN APPROVAL	MAY 28/21	RGJ
1	ISSUED FOR COORDINATION	MAY 20/21	RGJ

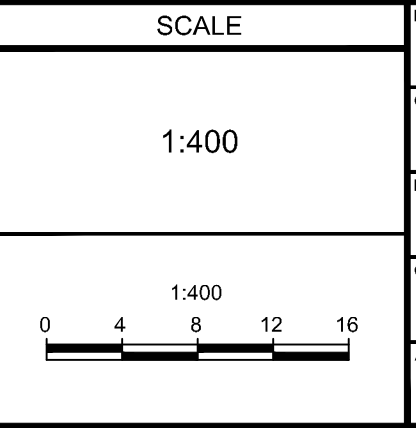

FOR REVIEW ONLY
DESIGN: RGJ/MEL
CHECKED: RGJ
DRAWN: MEL
CHECKED: RGJ
APPROVED: RGJ

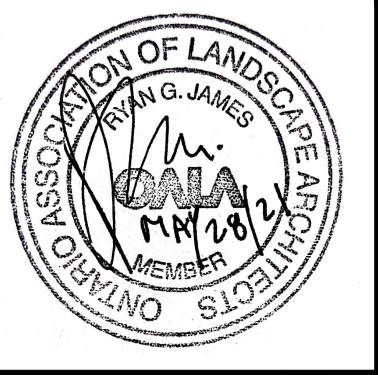

NOVATECH
Engineers, Planners & Landscape Architects
Suite 200, 240 Michael Copeland Drive
Ottawa, Ontario, Canada K2M 1P6
Telephone: (613) 254-9643
Facsimile: (613) 254-5867
Website: www.novatech-eng.com

LOCATION	PROJECT No.
SORTATION FACILITY 99 BILL LEATHER DRIVE, 2 LEIKIN DRIVE AND 20 LEIKIN DRIVE, OTTAWA, ONTARIO	121137-00
DRAWING NAME	REV #
LANDSCAPE NORTH EAST DEVELOPMENT	2
DRAWING No.	121137-L2

C:\Users\12137\OneDrive\Documents\121137-L2.dwg, L2, May 31, 2021, 2:45pm, m.mel

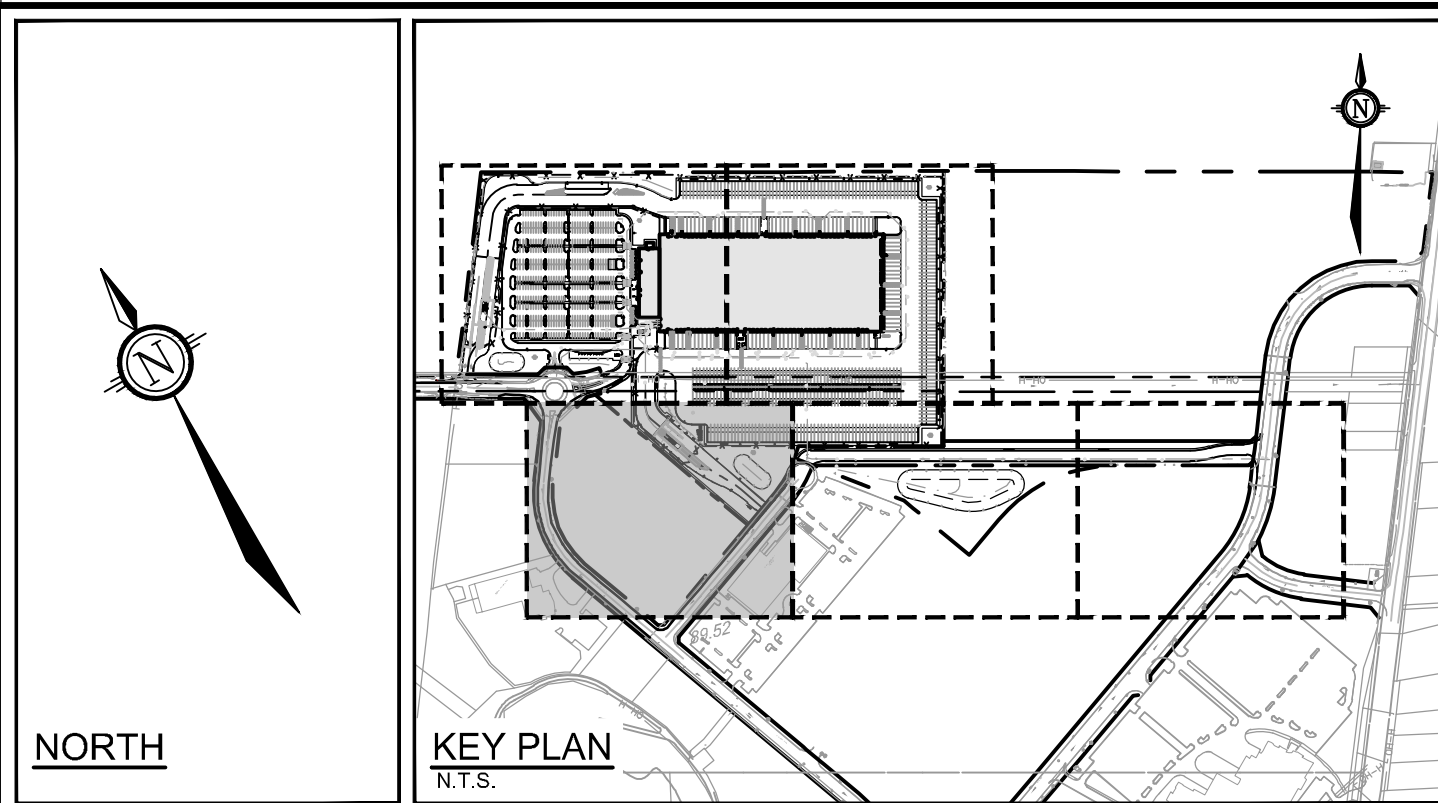
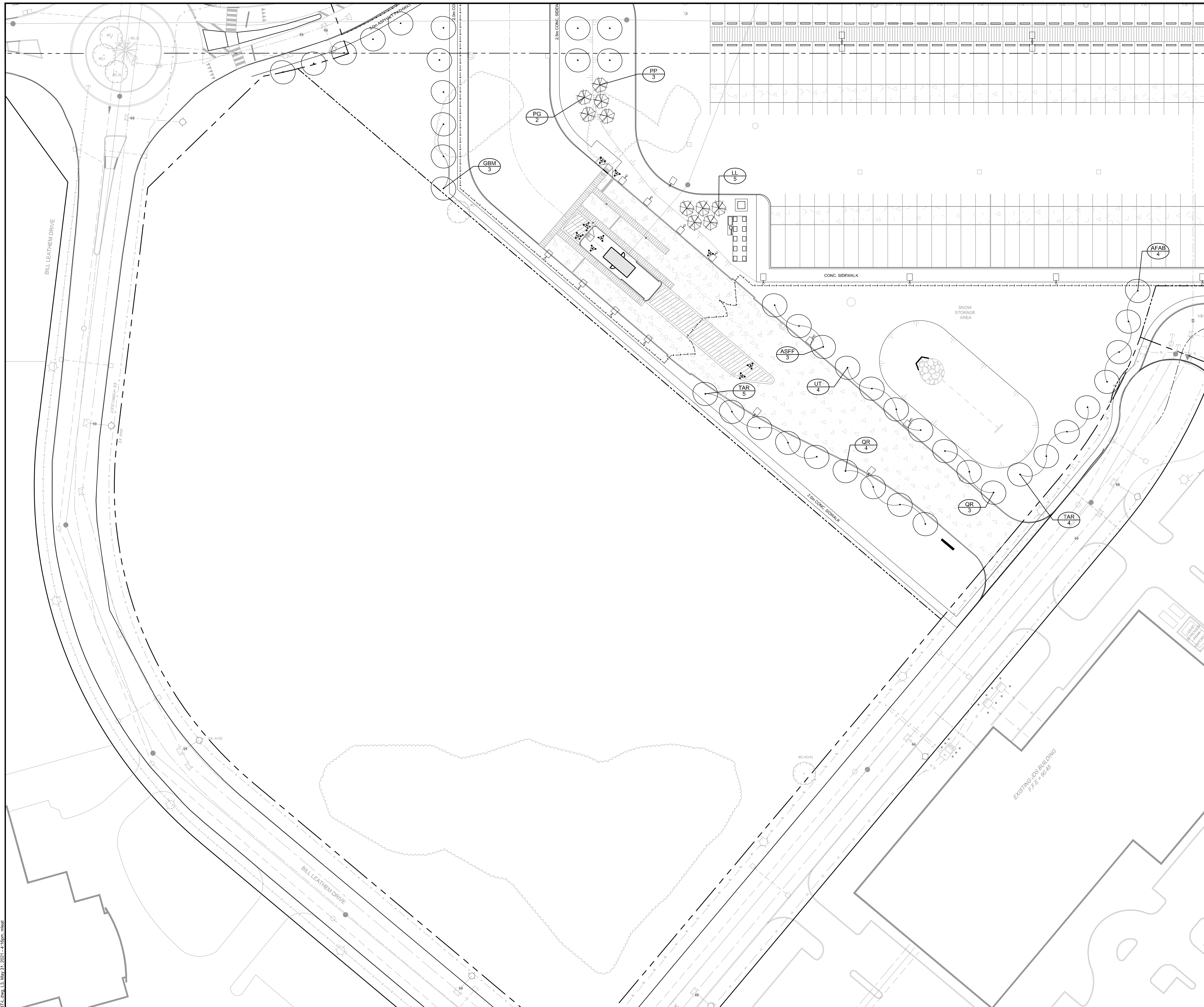

- LEGEND**
- PROPOSED CONIFEROUS TREE
 - PROPOSED DECIDUOUS TREE
 - PROPOSED SHRUBS
 - ORNAMENTAL GRASSES
 - SPECIES (SEE PLANT LIST)
 - QUANTITY
 - CHAIN LINK FENCE

PLANT LIST
121137 - Plant List - L3

KEY	QTY	BOTANICAL NAME	COMMON NAME	SIZE	COND	SPACING
Coniferous Trees						
LL	5	<i>Larix laricina</i>	Tamarack	200cm Ht	WB	As Shown
PG	2	<i>Picea glauca</i>	White Spruce	200cm Ht	WB	As Shown
PP	3	<i>Picea pungens</i>	Colorado Spruce	200cm Ht	WB	As Shown
Deciduous Trees						
ASFF	3	<i>Acer saccharum 'Fall Fiesta'</i>	Fall Fiesta Sugar Maple	50mm Cal	WB	As Shown
AFAB	4	<i>Acer x freemanii 'Fiesta'</i>	Fiesta Maple	50mm Cal	WB	As Shown
GBM	3	<i>Ginkgo biloba 'Magyar'</i>	Magyar Ginkgo	50mm Cal	WB	As Shown
QR	7	<i>Quercus rubra</i>	Red Oak	50mm Cal	WB	As Shown
TAR	9	<i>Tilia americana 'Redmond'</i>	Redmond Linden	50mm Cal	WB	As Shown
UT	4	<i>Ulmus x Trampii 'Marlon Glossy'</i>	Triumph Elm	50mm Cal	WB	As Shown

NOTE:
THE POSITION OF ALL POLE LINES, CONDUITS, WATERMANS, SEWERS AND OTHER UNDERGROUND AND OVERGROUND UTILITIES AND STRUCTURES IS NOT NECESSARILY SHOWN ON THE CONTRACT DRAWINGS, AND WHERE SHOWN, THE ACCURACY OF THE POSITION OF SUCH UTILITIES AND STRUCTURES IS NOT GUARANTEED. BEFORE STARTING WORK, DETERMINE THE EXACT LOCATION OF ALL SUCH UTILITIES AND STRUCTURES AND ASSUME ALL LIABILITY FOR DAMAGE TO THEM.

NOT FOR CONSTRUCTION

No.	REVISION	DATE	BY
2	ISSUED FOR SITE PLAN APPROVAL	MAY 2021	RGJ
1	ISSUED FOR COORDINATION	MAY 2021	RGJ

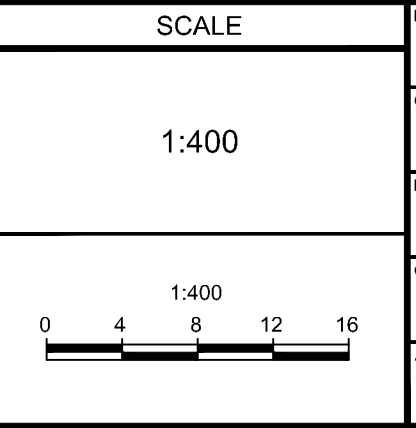

DESIGN	FOR REVIEW ONLY
RGJMEL	
RGJ	
MEL	
RGJ	
RGJ	

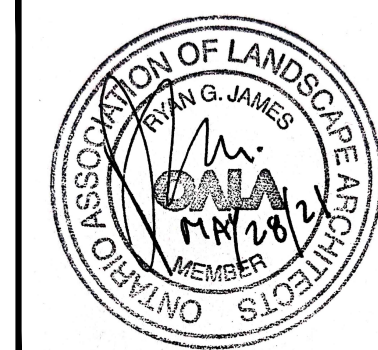

NOVATECH
Engineers, Planners & Landscape Architects
Suite 200, 240 Michael Cowpland Drive
Ottawa, Ontario, Canada K2M 1P6
Telephone: (613) 254-9643
Facsimile: (613) 254-5867
Website: www.novatech-eng.com

LOCATION		PROJECT No.
SORTATION FACILITY 99 BILL LEATHER DRIVE, 2 LEIKIN DRIVE AND 20 LEIKIN DRIVE, OTTAWA, ONTARIO		121137-00
DRAWING NAME		REV
LANDSCAPE SOUTH WEST DEVELOPMENT		# 2
DRAWING No.		121137-L0

C:\Users\121137\Documents\121137-00\121137-00.dwg, L3, May 31, 2021, 4:10pm, m.mel

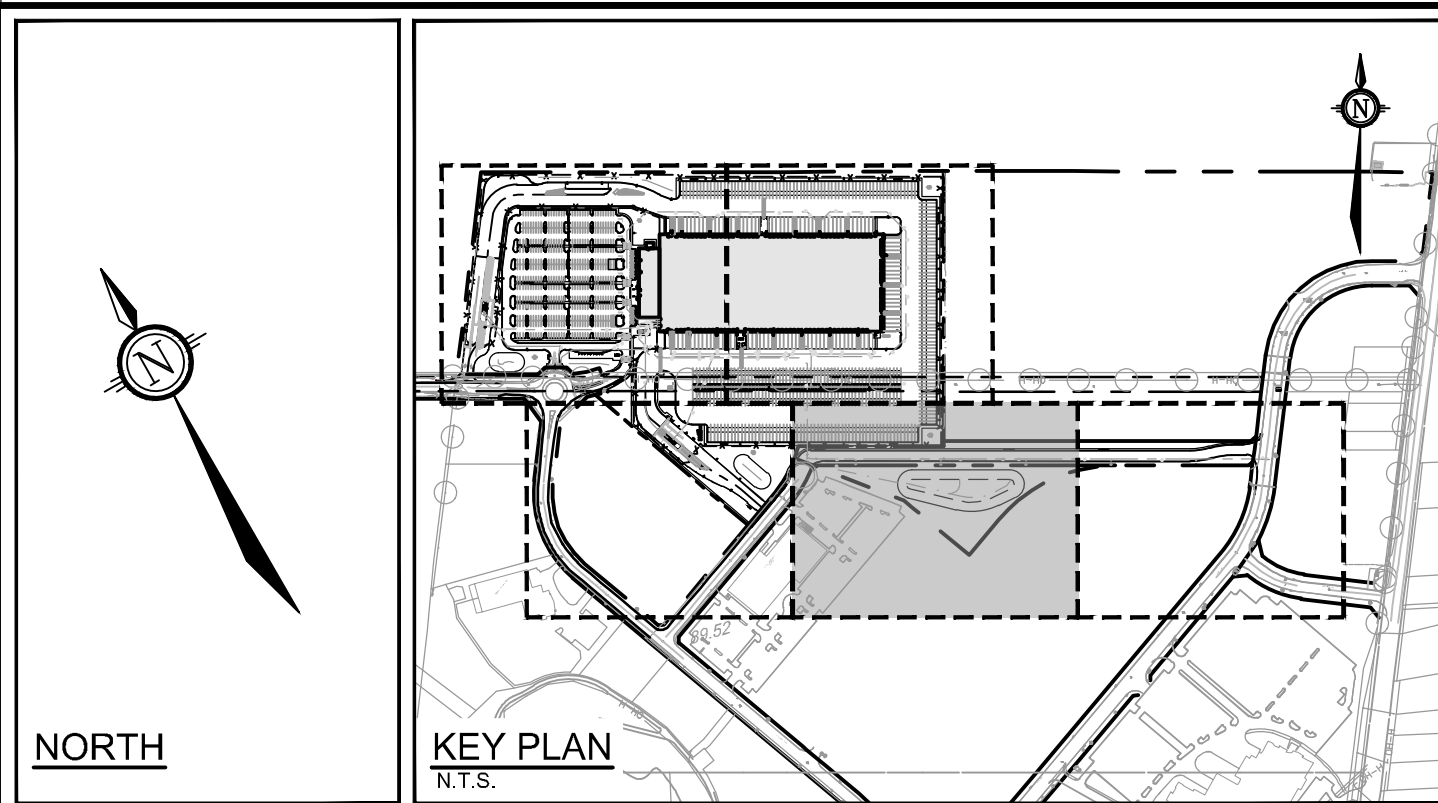
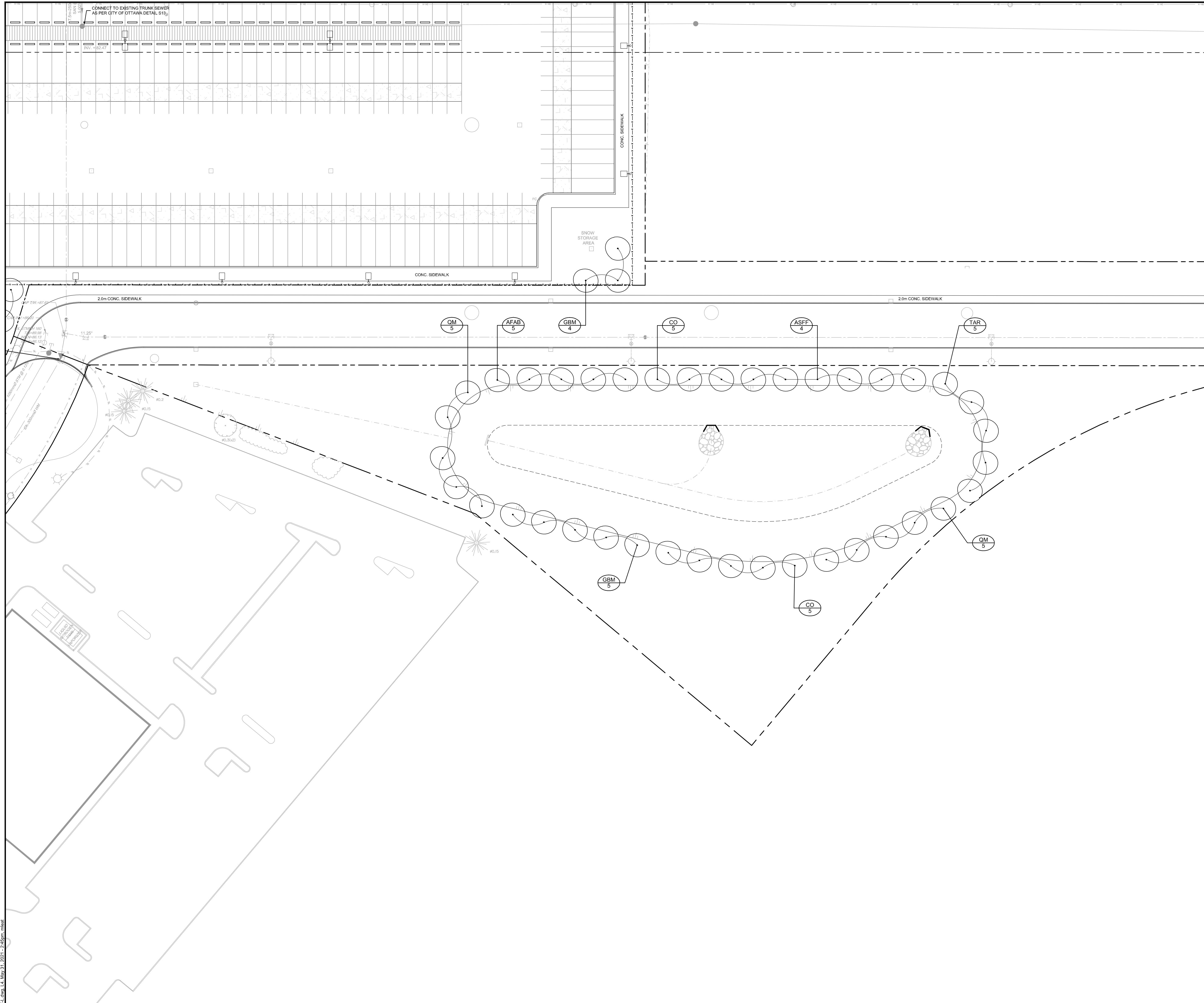

NORTH

KEY PLAN
N.T.S.

LEGEND

- PROPOSED CONIFEROUS TREE
- PROPOSED DECIDUOUS TREE
- PROPOSED SHRUBS
- ORNAMENTAL GRASSES
- SPECIES (SEE PLANT LIST)
- QUANTITY
- CHAIN LINK FENCE

NOTE:
THE POSITION OF ALL POLE LINES, CONDUITS,
WATERMANS, SEWERS AND OTHER
UNDERGROUND AND OVERGROUND UTILITIES AND
STRUCTURES IS NOT NECESSARILY SHOWN ON
THE CONTRACT DRAWINGS, AND WHERE SHOWN,
THE ACCURACY OF THE POSITION OF SUCH
UTILITIES AND STRUCTURES IS NOT GUARANTEED.
BEFORE STARTING WORK, DETERMINE THE EXACT
LOCATION OF ALL SUCH UTILITIES AND
STRUCTURES AND ASSUME ALL LIABILITY FOR
DAMAGE TO THEM.

**NOT FOR
CONSTRUCTION**

No.	REVISION	DATE	BY
2	ISSUED FOR SITE PLAN APPROVAL	MAY 2021	RGJ
1	ISSUED FOR COORDINATION	MAY 2021	RGJ

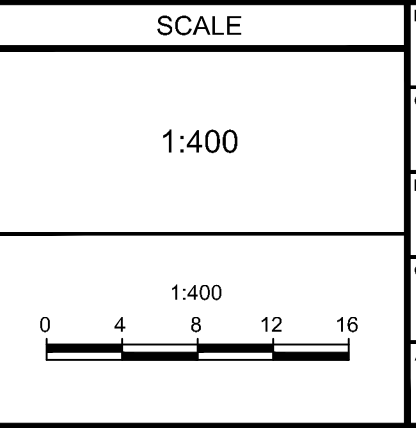

DESIGN	RGJ/MEL
CHECKED	RGJ
DRAWN	MEL
CHECKED	RGJ
APPROVED	RGJ

FOR REVIEW ONLY

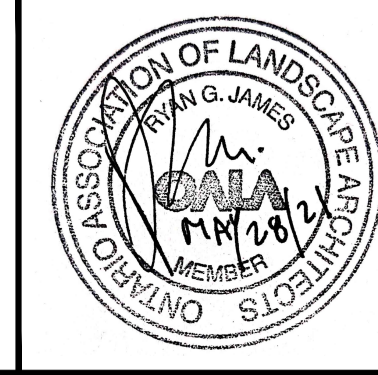

PLANT LIST

KEY	QTY	BOTANICAL NAME	COMMON NAME	SIZE	COND	SPACING
Deciduous Trees						
ASF 4	4	<i>Acer saccharum</i> 'Fall Fiesta'	Fall Fiesta Sugar Maple	50mm Cal	WB	As Shown
AFAB 5	5	<i>Acer x freemanii</i> 'Fretal'	Fretal Maple	50mm Cal	WB	As Shown
CO 10	10	<i>Celtis occidentalis</i>	Hackberry	50mm Cal	WB	As Shown
GBM 9	9	<i>Ginkgo biloba</i> 'Magyar'	Magyar Ginkgo	50mm Cal	WB	As Shown
OM 10	10	<i>Quercus macrocarpa</i>	Bur Oak	50mm Cal	WB	As Shown
TAR 5	5	<i>Tilia americana</i> 'Redmond'	Redmond Linden	50mm Cal	WB	As Shown

NOVATECH
Engineers, Planners & Landscape Architects
Suite 200, 240 Michael Copeland Drive
Ottawa, Ontario, Canada K2M 1P6
Telephone: (613) 254-9643
Facsimile: (613) 254-5867
Website: www.novatech-eng.com

LOCATION SORTATION FACILITY 99 BILL LEATHEN DRIVE, 2 LEIKIN DRIVE AND 20 LEIKIN DRIVE, OTTAWA, ONTARIO	PROJECT No. 121137-00
DRAWING NAME LANDSCAPE SOUTH EAST DEVELOPMENT	REV # 2
DRAWING No. 121137-L4	

C:\Users\121137\OneDrive\landscaping\121137-L4.dwg, L4, May 31, 2021, 2:45pm, mtaal

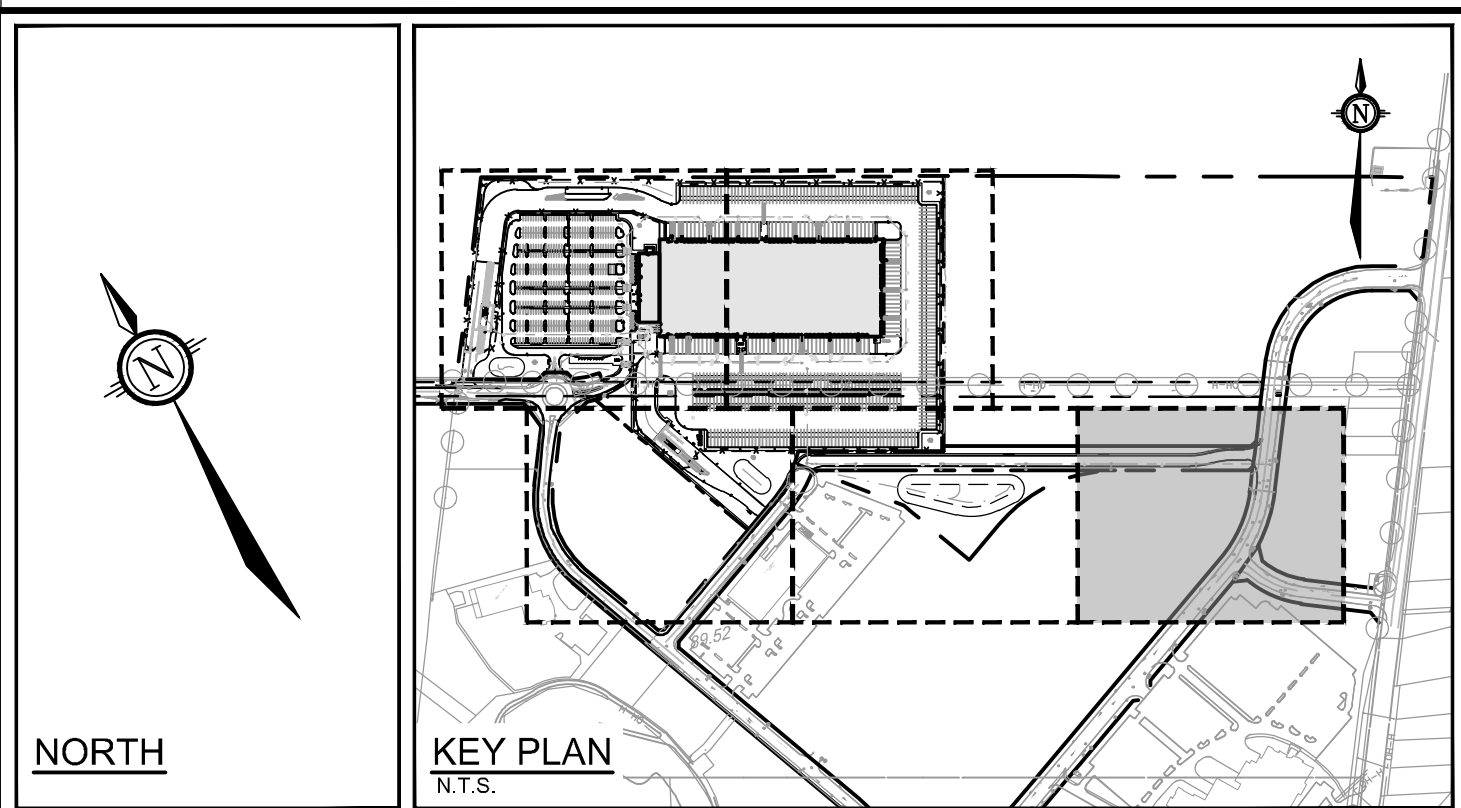
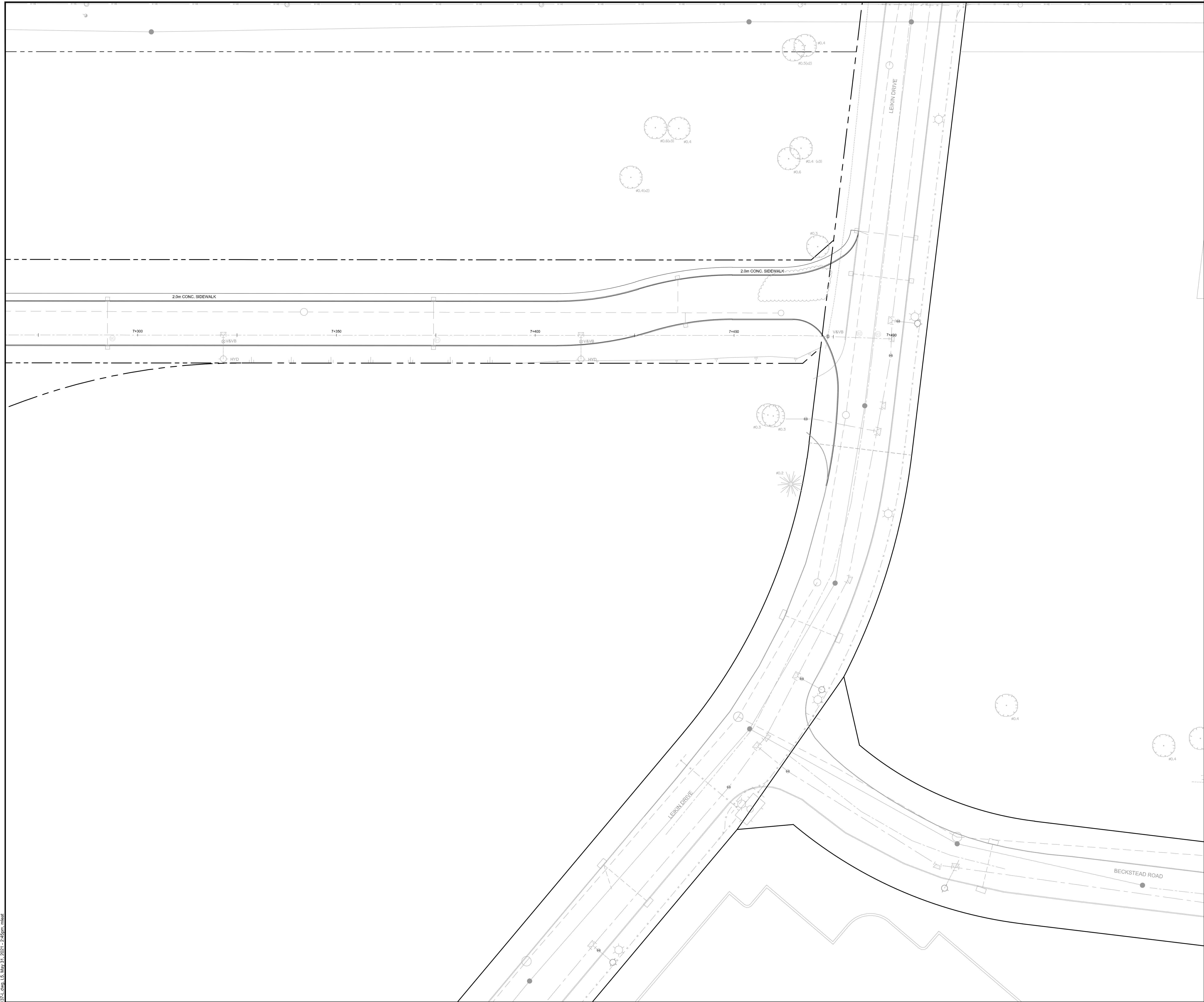

- LEGEND**
- PROPOSED CONIFEROUS TREE
 - PROPOSED DECIDUOUS TREE
 - PROPOSED SHRUBS
 - ORNAMENTAL GRASSES
 - SPECIES (SEE PLANT LIST)
 - QUANTITY
 - CHAIN LINK FENCE

NOTE:
 THE POSITION OF ALL POLE LINES, CONDUITS,
 WATERMANS, SEWERS AND OTHER
 UNDERGROUND AND OVERGROUND UTILITIES AND
 STRUCTURES IS NOT NECESSARILY SHOWN ON
 THE CONTRACT DRAWINGS, AND WHERE SHOWN,
 THE ACCURACY OF THE POSITION OF SUCH
 UTILITIES AND STRUCTURES IS NOT GUARANTEED.
 BEFORE STARTING WORK, DETERMINE THE EXACT
 LOCATION OF ALL SUCH UTILITIES AND
 STRUCTURES AND ASSUME ALL LIABILITY FOR
 DAMAGE TO THEM.

**NOT FOR
CONSTRUCTION**

No.	REVISION	DATE	BY
2	ISSUED FOR SITE PLAN APPROVAL	MAY 2021	RGJ
1	ISSUED FOR COORDINATION	MAY 2021	RGJ

SCALE

1:400

DESIGN	RGJMEL
CHECKED	RGJ
DRAWN	MEL
CHECKED	RGJ
APPROVED	RGJ

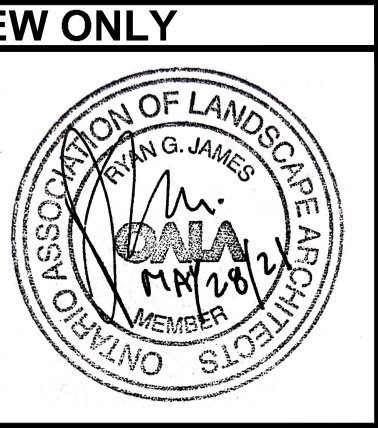

NOVATECH
 Engineers, Planners & Landscape Architects
 Suite 200, 240 Michael Cowpland Drive
 Ottawa, Ontario, Canada K2M 1P6
 Telephone: (613) 254-9643
 Facsimile: (613) 254-5867
 Website: www.novatech-eng.com

LOCATION SORTATION FACILITY 99 BILL LEATHEN DRIVE, 2 LEIKIN DRIVE AND 20 LEIKIN DRIVE, OTTAWA, ONTARIO	
DRAWING NAME LANDSCAPE PRIVATE ROAD	PROJECT No. 121137-00
	REV # 2
	DRAWING No. 121137-L5

C:\Users\121137\Documents\121137-00\121137-L5.dwg, L5, May 31, 2021, 2:45pm, m.mel