

**GENERAL NOTES:**

- It is the responsibility of the appropriate contractor or official to report any errors, omissions or discrepancies on this plan with actual site conditions to the Landscape Architect before proceeding with construction.
- The contractor is to notify all utility companies and authorities prior to any excavation and ascertain locations of underground services.
- The contractor is to reinstate all areas and items damaged as a result of construction activity.
- The contractor is to comply with all pertinent codes and by-laws.
- The contractor is to maintain a positive surface run-off throughout the entire construction period.
- The Landscape Architect is not responsible for subsurface conditions.
- The contractor is to identify all existing trees to remain on site with the Landscape Architect prior to construction.
- The contractor is to stake the proposed location of all plant material in conjunction with the Landscape Architect prior to excavation.
- Minimum distances for selected deciduous trees are as follows:
  - Building Foundations 7.5m
  - Sidewalks 1.5m
  - Public Streets 2.5m
  - Underground Infrastructure 2.0m
- All trees within 1m of underground utility trenches are to be excavated by hand.
- Remove all protective wrapping from tree trunks after installation.
- Staking of trees shall only be performed if necessary.
- Ensure that mulch is pulled back a min. distance of 75mm from base of tree trunk.

EXISTING TREE LIST						
KEY	QTY	BOTANICAL NAME	COMMON NAME	SIZE	CONDITION	REMARKS
<b>TREES</b>						
AN	1	Acer negundo	Manitoba Maple	100mm DBH	Good	To remain
GT	3	Gleditsia triacanthos	Honey Locust	200-350mm DBH	Good	To remain
PP	2	Picea pungens	Colorado Spruce	200mm DBH	Good	To remain
RC	1	Rhamnus cathartica	Common Buckthorn	100mm DBH	Good	To be removed
UA	1	Ulmus americana	American Elm	400mm DBH	Dead	To remain

PROPOSED PLANT LIST						
KEY	QTY	BOTANICAL NAME	COMMON NAME	SIZE	CONDITION	REMARKS
<b>TREES</b>						
GB	1	Ginkgo biloba	Maidenhair Tree	60mm Ø	B&B	Male Tree
JL	1	Syringa reticulata	Japanese Tree Lilac	60mm Ø	B&B	Single Leader
<b>SHRUBS</b>						
AH	5	Hydrangea arborescens 'Annabelle'	Annabelle Hydrangea	1 gallon pot	Potted	Space 1000mm o.c.
RR	4	Rosa rugosa	Rugosa rose	800mm pot	Potted	Space 1000mm o.c.
WC	11	Thuja occidentalis	Eastern White Cedar	1500mm Ht.	Bare Root	Space 500mm o.c. 3 trunks or more
<b>PERENNIALS</b>						
GH	13	Hosta 'Guacamole'	Guacamole Hosta	1 gallon pot	Potted	Space 600mm o.c.
KF	20	Calamagrostis 'Karl Foerster'	Feather Reed Grass	250mm pot	Potted	Space 600mm o.c.

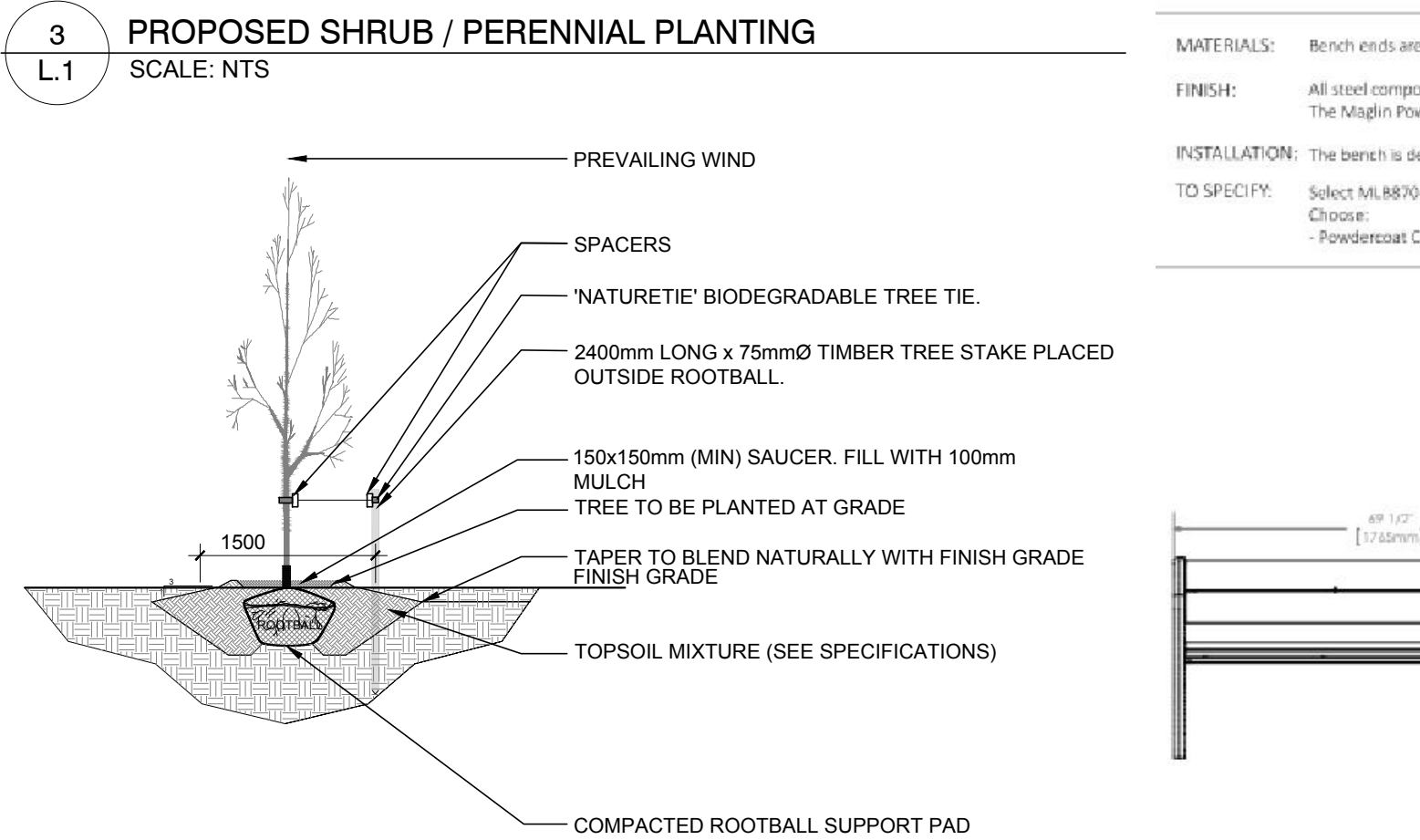
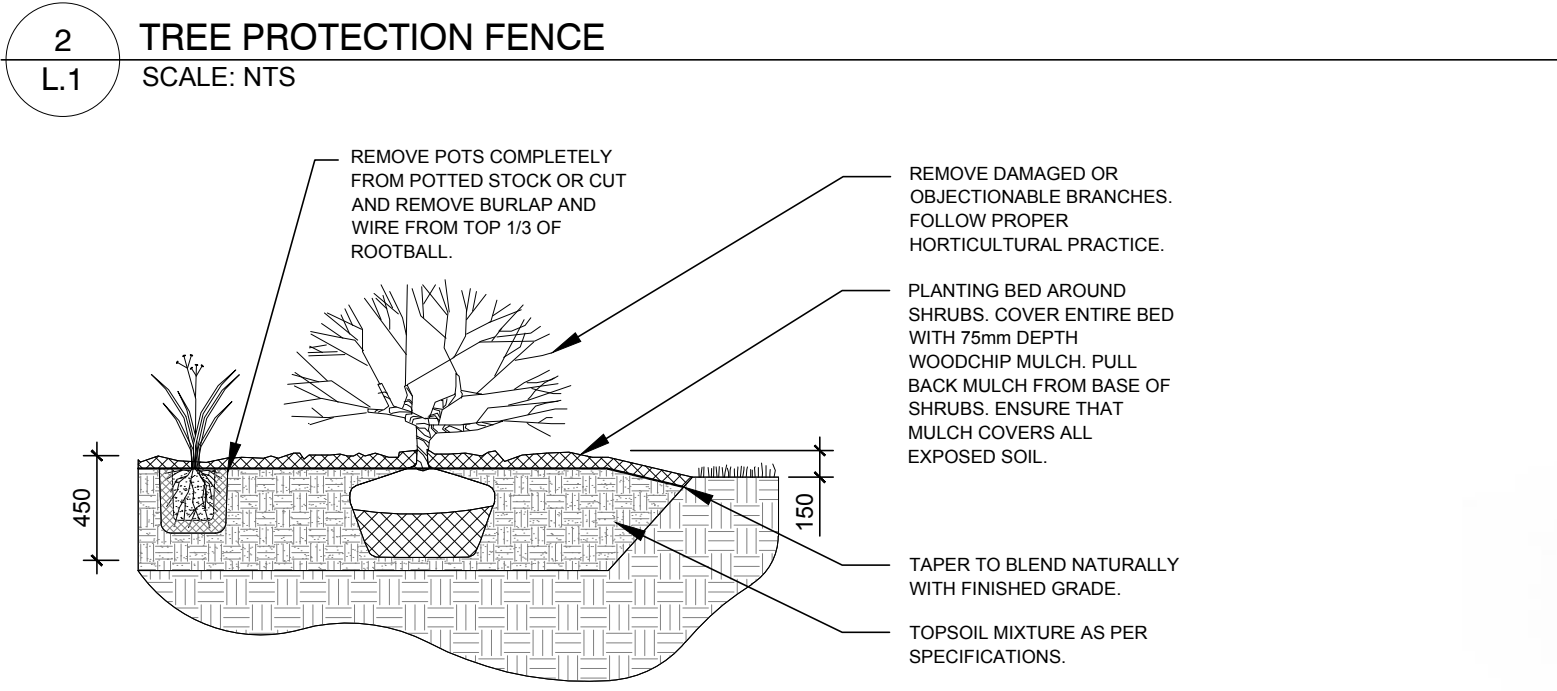
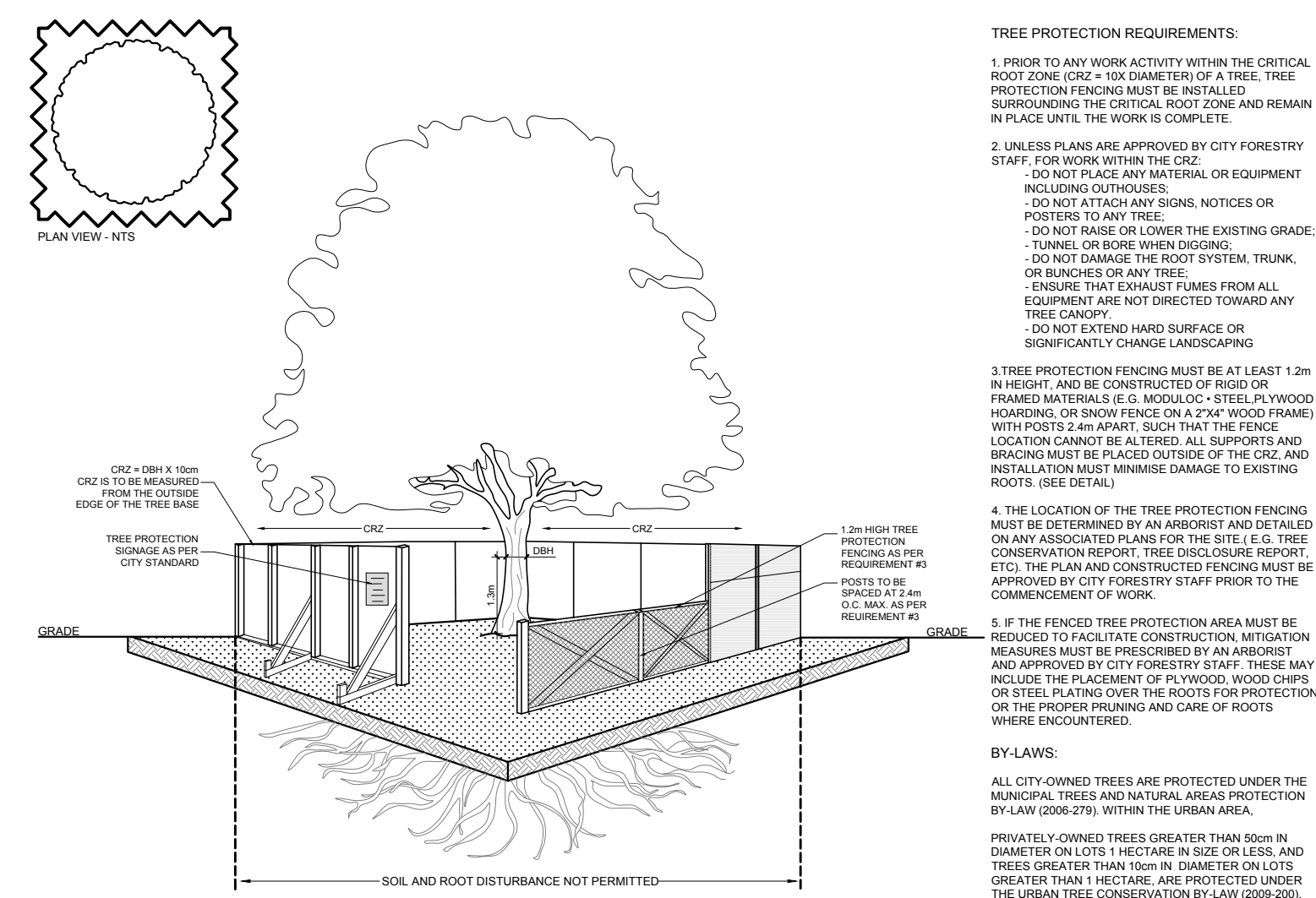
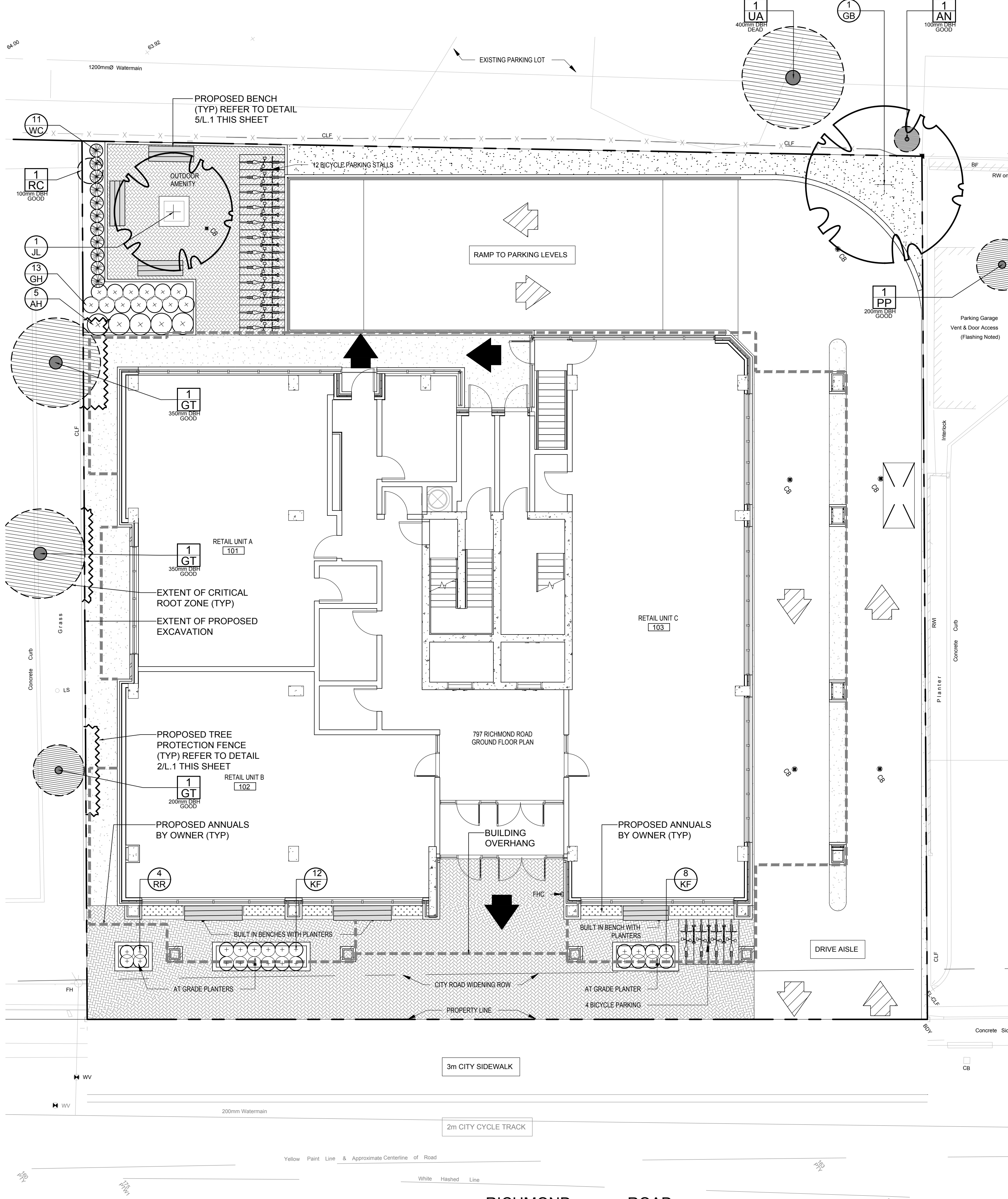

**1 TREE CONSERVATION REPORT & LANDSCAPE PLAN**  
SCALE: 1:100

**4 DECIDUOUS TREE PLANTING**  
SCALE: NTS

**5 PROPOSED BENCH**  
SCALE: NTS

**LEGEND**

- EXISTING TREE TO REMAIN
- EXISTING TREE TO BE REMOVED
- TREE PROTECTION FENCE
- PROPOSED SOD
- PROPOSED PEASTONE MULCH
- PROPOSED DECIDUOUS TREE
- PROPOSED SHRUBS / PERENNIALS
- PROPOSED PRECAST CONCRETE PAVERS
- PROPOSED ANNUALS BY OWNER
- PROPOSED BENCH

No.	Issue	Date	DR	CK
6	REVISED PER NEW SITE PLAN	02/07/2022	ML	JL
5	ISSUED FOR COORDINATION	02/03/2022	ML	JL
4	REVISED PER CITY COMMENTS	01/24/2022	ML	JL
3	ISSUED FOR DISCUSSION AND REVIEW	05/18/2021	ML	JL
2	ISSUED FOR DISCUSSION AND REVIEW	05/13/2021	ML	JL
1	ISSUED FOR DISCUSSION AND REVIEW	05/11/2021	ML	JL

**JAMES B. LENOX & ASSOCIATES INC.**  
LANDSCAPE ARCHITECTS  
3332 CARLING AVE. OTTAWA, ONTARIO K2J 1S8  
Tel: (613) 722-5168 Fax: (866) 343-3942

**PROJECT**  
RICHMOND APARTMENTS  
797 RICHMOND ROAD, OTTAWA ON

**DRAWING**  
TREE CONSERVATION REPORT &  
LANDSCAPE PLAN

	SCALE	AS SHOWN
	START DATE	MAY 2021
	PROJECT NO.	21CHM2138
	DRAWING NO.	L.1

**PROJECT NORTH**

D07-12-21-0088

#18550