

APPROVED
By Lily Xu at 11:38 am, Feb 12, 2025

LILY XU, MCIP, RPP
MANAGER, DEVELOPMENT REVIEW SOUTH
PLANNING, DEVELOPMENT, AND BUILDING SERVICES
DEPARTMENT, CITY OF OTTAWA

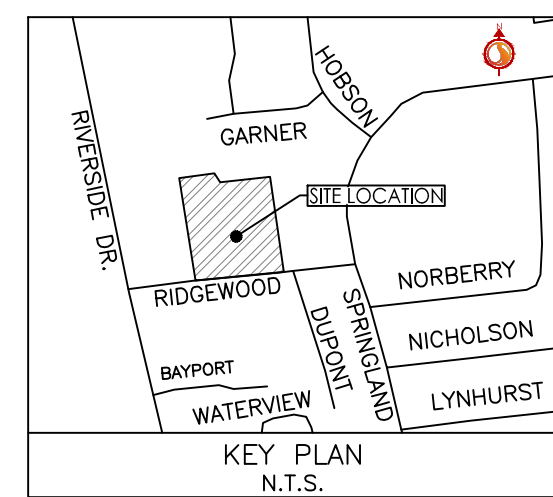

Stantec Consulting Ltd.
400 - 1331 Clyde Avenue
Ottawa ON
Tel. 613.722.4420
www.stantec.com

Copyright Reserved

The Contractor shall verify and be responsible for all dimensions. DO NOT scale the drawing - any errors or omissions shall be reported to Stantec without delay.
The Copyrights to all designs and drawings are the property of Stantec. Reproduction or use for any purpose other than that authorized by Stantec is forbidden.

Legend

R100A
0.31 259
SANITARY DRAINAGE AREA ID#
POPULATION
SANITARY DRAINAGE AREA ha.

G100A
0.11 INFL
SANITARY DRAINAGE AREA ID#
INFILTRATION RATES
SANITARY DRAINAGE AREA ha.

SANITARY DRAINAGE AREA
PROPOSED SANITARY SEWER
EXISTING SANITARY SEWER

Notes

SANITARY STATS

POPULATION COUNT
TOWER 1 and BUILDING 2
37 - STUDIO APTS @ 1.4PPU = 52 PEOPLE
167 - 1 BEDROOM APTS @ 1.4PPU = 234 PEOPLE
88 - 2 BEDROOM APTS @ 2.1PPU = 185 PEOPLE
10 - 3 BEDROOM APTS @ 3.1PPU = 31 PEOPLE
TOTAL POPULATION TOWER 1+BUILDING 2 = 502 PEOPLE
BUILDING 3
30 - STUDIO APTS @ 1.4PPU = 42 PEOPLE
41 - 1 BEDROOM APTS @ 1.4PPU = 57 PEOPLE
16 - 2 BEDROOM APTS @ 2.1PPU = 34 PEOPLE
TOTAL POPULATION TOWER 3 = 133 PEOPLE
BUILDING 4
6 - STUDIO APTS @ 1.4PPU = 8 PEOPLE
33 - 1 BEDROOM APTS @ 1.4PPU = 46 PEOPLE
15 - 2 BEDROOM APTS @ 2.1PPU = 32 PEOPLE
TOTAL POPULATION TOWER 4 = 86 PEOPLE
COMMERCIAL AREA = 700m² (0.07ha)
TOTAL POPULATION = 721
TOTAL COMMERCIAL SPACE = 700m² (0.07ha) @ 28,000 L/ha/day

5	ISSUED FOR SPA	MJS	DT	24.08.13
4	REVISED ROOF RELEASE RATES	MJS	DT	24.04.02
3	REVISED AS PER CITY COMMENTS	MJS	DT	24.01.15
2	REVISED AS PER CITY COMMENTS	MJS	DT	23.03.02
1	REVISED AS PER CITY COMMENTS	MJS	DT	22.07.05
0	ISSUED FOR SPA	MJS	AMP	21.06.09
Revision		By	Appd.	YY.MM.DD

File Name:	160401536 DB DWG	MJS	AMP	MJS	21.06.01
		Dwn.	Chkd.	Dsgn.	YY.MM.DD

Permit-Seal



Client/Project

BRIGIL HOMES
98 LOIS STREET
GATINEAU, QC
J8Y 3R7
MOONEY'S BAY
729 RIDGEWOOD AVENUE
OTTAWA, ON, CANADA

Title

SANITARY DRAINAGE PLAN

Project No.	Scale	0 3 9 15m
160401536	1:300	
Drawing No.	Sheet	Revision

SA-1 7 of 7

5

PLAN # 18552

\\s1\apps\160401536\160401536.dwg
2024/08/13 11:38 AM
ORIGINAL SHEET - ARCH D