

SITE LOCATION

LEGEND / SYMBOL

- EXISTING TREE TO BE REMOVED (REFER TO TCR)
- PROPOSED DECIDUOUS TREE DETAIL 1/L2.01
- PROPOSED CONIFEROUS TREE DETAIL 1/L2.01
- PROPOSED SHRUBS / PERENNIALS / GRASSES DETAIL 1/L2.01
- PROPOSED UNIT PAVING TYPE A DETAIL 5/L2.01 and 1/L2.02
- PROPOSED UNIT PAVING TYPE B DETAIL 5/L2.01 and 1/L2.02
- PROPOSED UNIT PAVING TYPE C DETAIL 5/L2.01 and 1/L2.02
- PROPOSED CONCRETE PAVING
- PROPOSED P.C CONCRETE SEGMENTAL PLANTER WALL DETAIL 2/L2.01 and 6/L2.02
- PROPOSED 0.6m HT. WEATHERING STEEL (COR-TEN) PLANTER DETAIL 4/L2.01
- PROPOSED BENCH / SEATING
- PROPOSED AGGREGATE MAINTENANCE STRIP DETAIL 5/L2.02
- PROPOSED BICYCLE PARKING SPACES PROVIDED: 4
- PROPOSED BICYCLE RACK PROPOSED QTY: 2 DETAIL 6/L2.01

GENERAL NOTES

- 1 This drawing shall be read in conjunction with all relevant Architectural, Engineering and related Drawings and Documents.
- 2 Refer to Engineering Drawings for Grading and Servicing.
- 3 Refer to Architectural Drawings for Site layout.
- 4 Contractor shall provide the location(s) of all services/utilities by consulting Municipal Authorities and Utility companies and shall be responsible for adequate protection from damage during construction.
- 5 Plant material shall be No.1 Grade and shall comply with the Metric Guide Specifications For Nursery Stock (latest edition), published by the Canadian Nursery Trades Association.
- 6 Plant Material locations are **Schematic / Approximate only**. Contractor shall stake out locations on site prior to work.
- 7 Contractor shall guarantee all plant material for a period of one (1) full year from the date of final acceptance.
- 8 **Shrubs** shall be planted in a continuous prepared bed of 450mm depth planting soil mix covered over with a woven polypropylene weed control fabric (**LANDSCAPE FABRIC-Green-Line by Thrac-LINQ**) and 75mm depth composted pine mulch to finish grade, as specified.
- 9 **Perennials and Ornamental Grasses** shall be planted in a continuous prepared bed of 450mm depth planting soil mix covered over with 75mm depth composted pine mulch to finish grade. (**NO WEED CONTROL FABRIC**), as specified.
- 10 Sod areas to receive 125mm topsoil. Sod shall be No. 1 quality conforming to the Canadian Nursery Sod Growers Specification.
- 11 Reinstatement all areas damaged or disturbed beyond the limit of Work.
- 12 Plant Material substitutions shall not be permitted without written approval from the Consultant.
- 13 Contractor shall advise Consultant a minimum of **48hrs.** prior to proceeding landscape work and any required Field Reviews.
- 14 **THIS PLAN HAS BEEN PREPARED FOR MUNICIPAL SITE PLAN APPROVAL ONLY AND MAY NOT BE USED FOR ANY OTHER PURPOSE.**

PLANT MATERIAL SCHEDULE

CODE	BOTANICAL NAME	COMMON NAME	QTY.	SIZE	REMARKS
DECIDUOUS TREES					
AC	AMELANCHIER CANADENSIS	SHADBLOW SERVICEBERRY	5	50mm cal	B&B, single stem
AFJ	ACER x FREEMANII JEFFERSRED	AUTUMN BLAZE MAPLE	4	50mm cal	B&B, single stem
AR	ACER RUBRUM	RED MAPLE	3	50mm cal	B&B, single stem
AS	ACER SACCHARUM	SUGAR MAPLE	4	50mm cal	B&B, single stem
QM	QUERCUS MACROCARPA	BUR OAK	4	50mm cal	B&B, single stem
QR	QUERCUS RUBRA	RED OAK	4	50mm cal	B&B, single stem
SR	SYRINGA RETICULATA 'IVORY SILK'	IVORY SILK JAPANESE TREE LILAC	7	50mm cal	B&B, single stem
TA	TILIA AMERICANA	AMERICAN BASSWOOD	6	50mm cal	B&B, single stem
CONIFEROUS SHRUBS					
JCO	JUNIPERUS CHINENSIS 'ONTARIO GREEN'	ONTARIO GREEN JUNIPER	56	125cm ht	Potted
TD	THUJA OCCIDENTALIS	EASTERN WHITE CEDAR	4	150 cm ht	B&B
DECIDUOUS SHRUBS					
HAA	HYDRANGEA ARBORESCENS ANNABELLE	ANNABELLE HYDRANGEA	40	50cm ht	potted, 100cm o/c
PO	PHYSOCARPUS OPULIFOLIUS	COMMON NINEBARK	28	50cm ht	potted, 100cm o/c
PON	PHYSOCARPUS OPULIFOLIUS NANUS	DWARF NINEBARK	36	50cm ht	potted, 100cm o/c
RB	ROSA BLANDA	SHRUB ROSE	25	50cm ht	potted, 100cm o/c
SJAW	SPIRAEA JAPONICA ANTHONY WATERER	ANTHONY WATERER SPIREA	34	50cm ht	potted, 100cm o/c
SJG	SPIRAEA JAPONICA GOLDMOUND	GOLDMOUND SPIREA	62	50cm ht	potted, 100cm o/c
ST	SPIRAEA TRILOBATA	DWARF WANDOUTTEI SPIREA	44	50cm ht	potted, 100cm o/c
VD	VIBURNUM DENTATUM	ARROWWOOD	18	50cm ht	potted, 100cm o/c
VINES					
PQ	PARTHENOCISSUS QUINQUEFOLIA	VIRGINIA CREEPER	90	2 yr.	potted
PERENNIALS					
Cal	COREOPSIS lanceolata	COREOPSIS	170	15 cm pot	plant 60cm o/c
Ger	GERANIUM maculatum	WILD GERANIUM	164	15 cm pot	plant 60cm o/c
Hem	HEMEROCALLIS 'Hyperion'	Hyperion DAYLILY	201	15 cm pot	plant 60cm o/c
Rud	RUDEBECKIA fulgida 'Goldstrum'	BLACK-EYED SUSAN	80	15 cm pot	plant 60cm o/c
ORNAMENTAL GRASSES					
Cal	CALAMAGROSTIS x acutiflora Karl Foerster	KARL FOERSTER REED GRASS	60	15cm pot	plant 75cm o/c
Pv	PANICUM virgatum	SWITCH GRASS	21	15cm pot	plant 75cm o/c
Sch1	SCHIZACHYRIUM scoparium	LITTLE BLUESTEM	35	15cm pot	plant 75cm o/c
Sch2	SCHIZACHYRIUM scoparium 'Prairie Blues'	LITTLE BLUESTEM	36	15cm pot	plant 75cm o/c
Sor	SORGHASTRUM nutans	INDIAN GRASS	62	15cm pot	plant 75cm o/c
Spo	SPOROBOLUS heterolepis	PAIRIE DROPSEED	82	15cm pot	plant 75cm o/c

FOR APPROVAL ONLY

no.	date	revision
7.	JAN.12/24	RE-ISSUE FOR SPA
6.	JUNE 29/23	ISSUE FOR 30% REVIEW
5.	FEB. 22/23	RE-ISSUE FOR SPA
4.	JULY 11/22	RE-ISSUE FOR SPA
3.	JUNE 8/21	CHANGES PER SITE PLAN
2.	MAY 28/21	ISSUE FOR SPA (REVIEW)
1.	MAY 27/21	ISSUE FOR COORDINATION / REVIEW

North Arrow

Stamp

Contractor shall check and verify all dimensions on site and report all errors and/or omissions to the Consultant.
 Work to be done in accordance with all applicable codes and by-laws.
 Do not scale Drawing.
 This Drawing shall not be used for construction until signed by the Consultant.
 Copyright reserved. This Drawing is the exclusive property of Levstek Consultants Inc. and shall not be used without consent.

Consultant
LEVSTEK CONSULTANTS
 LANDSCAPE ARCHITECTS
 1871 Hugh Crescent - Ottawa - Ontario - K9A 2W6
 613 - 826 - 0518

Client
brigil

Project
MOONEY'S BAY
 729 RIDGEWOOD AVENUE

Drawing Title
LANDSCAPE PLAN

Drawn	MGB	Drawing No.	L1.01
Scale	1:300	Project No.	1180

THIS DRAWING IS COLOUR DEPENDENT.
 NON-COLOUR COPIES MAY ALTER
 INTERPRETATION.

D07-12-21-0089

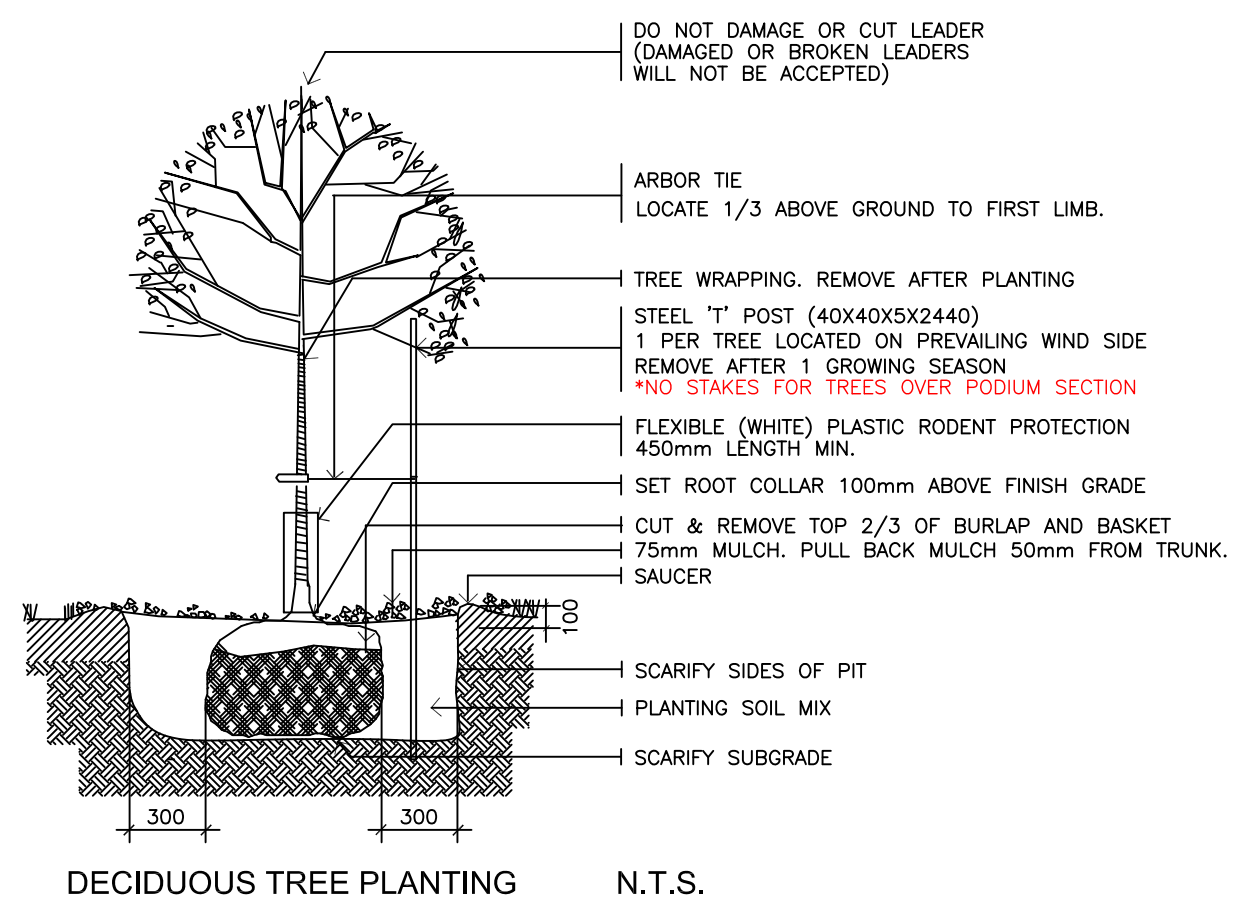

DECIDUOUS TREE PLANTING N.T.S.

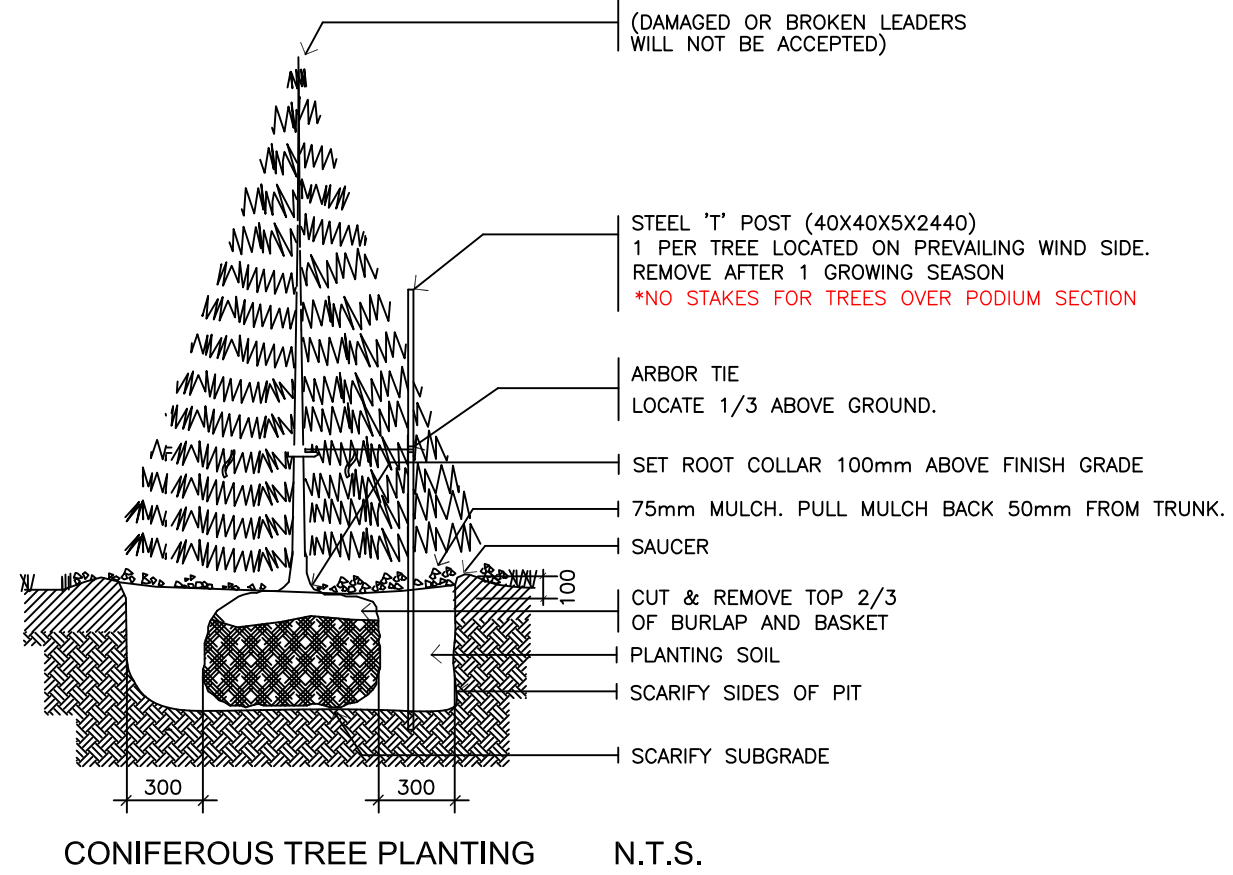

CONIFEROUS TREE PLANTING N.T.S.

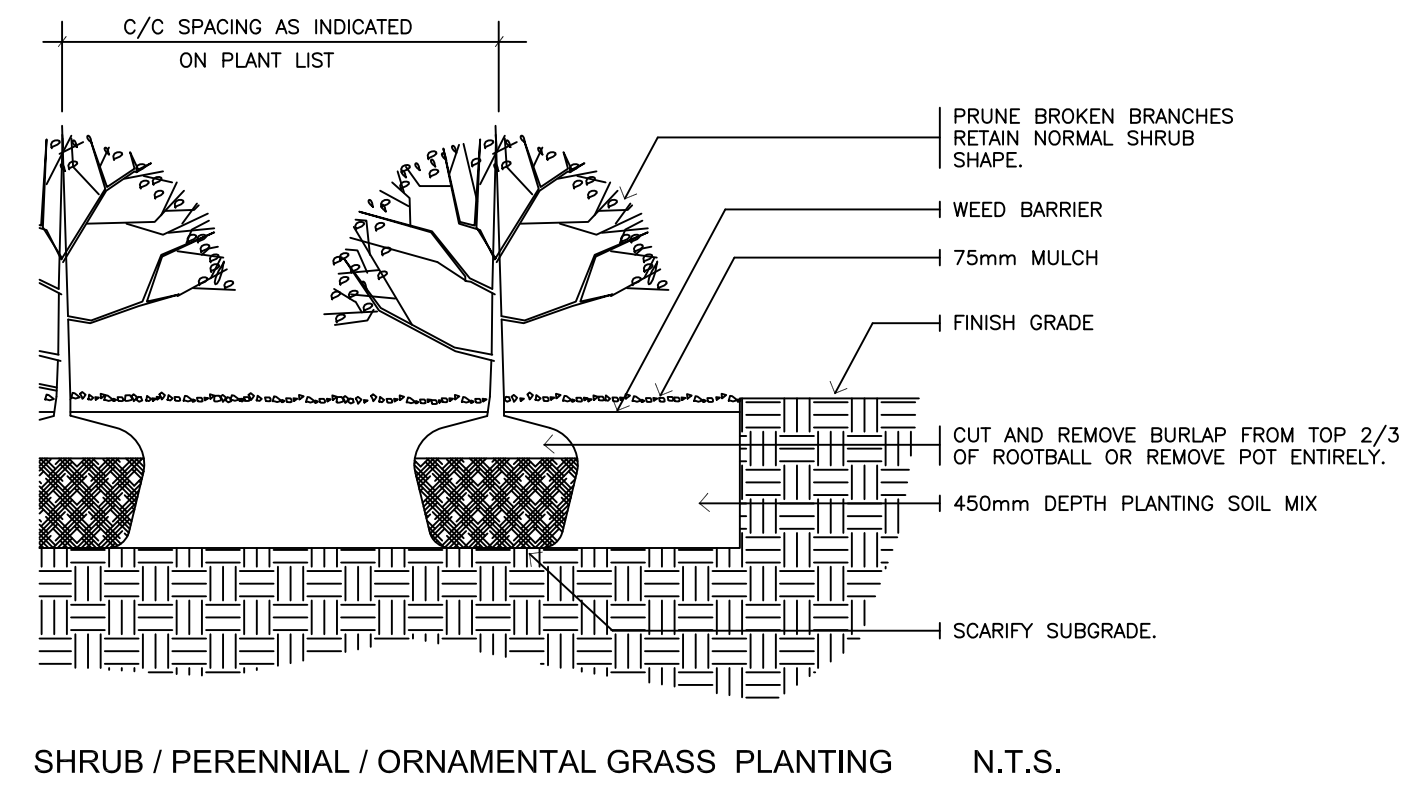

SHRUB / PERENNIAL / ORNAMENTAL GRASS PLANTING N.T.S.

*ROOT BARRIER SHALL BE INSTALLED IN CONFORMANCE WITH INTENSIVE GREEN ROOF INVERTED ROOFING ASSEMBLY

1 L2.01 PLANTING DETAILS NTS

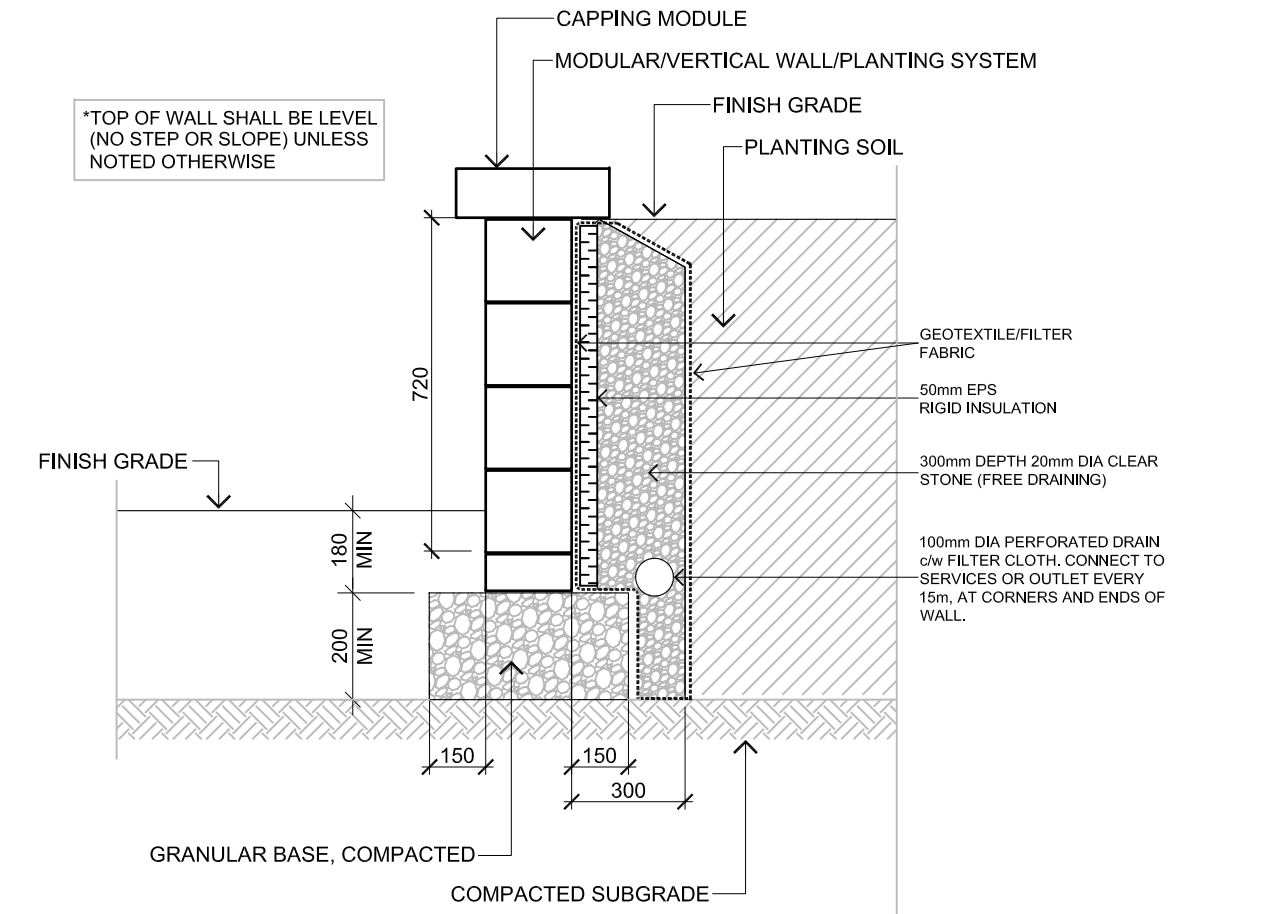

2 L2.01 AT GRADE P.C. CONCRETE PLANTER WALL NTS

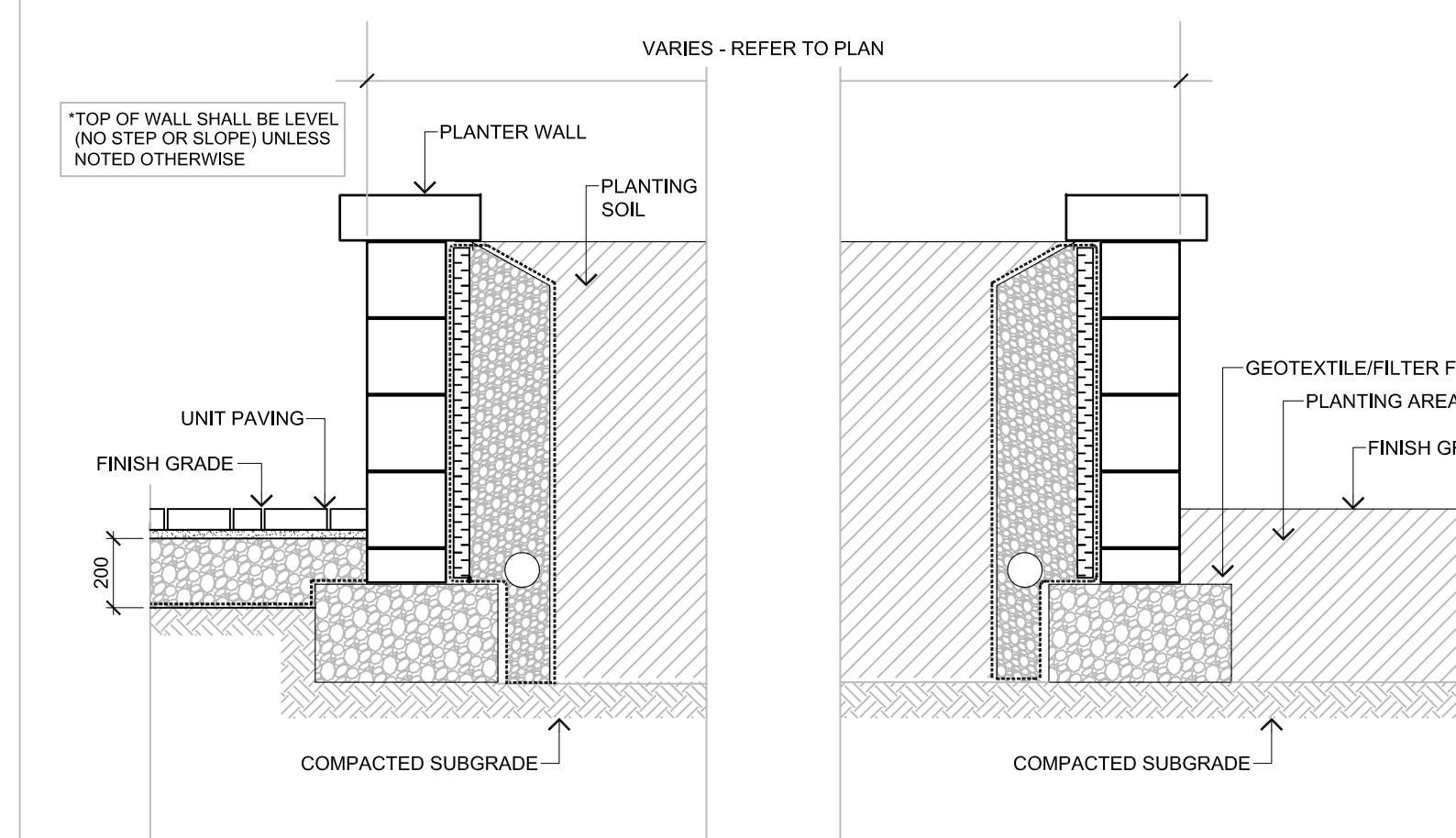

3 L2.01 AT GRADE UNIT PAVING / PLANTER / PLANTING NTS

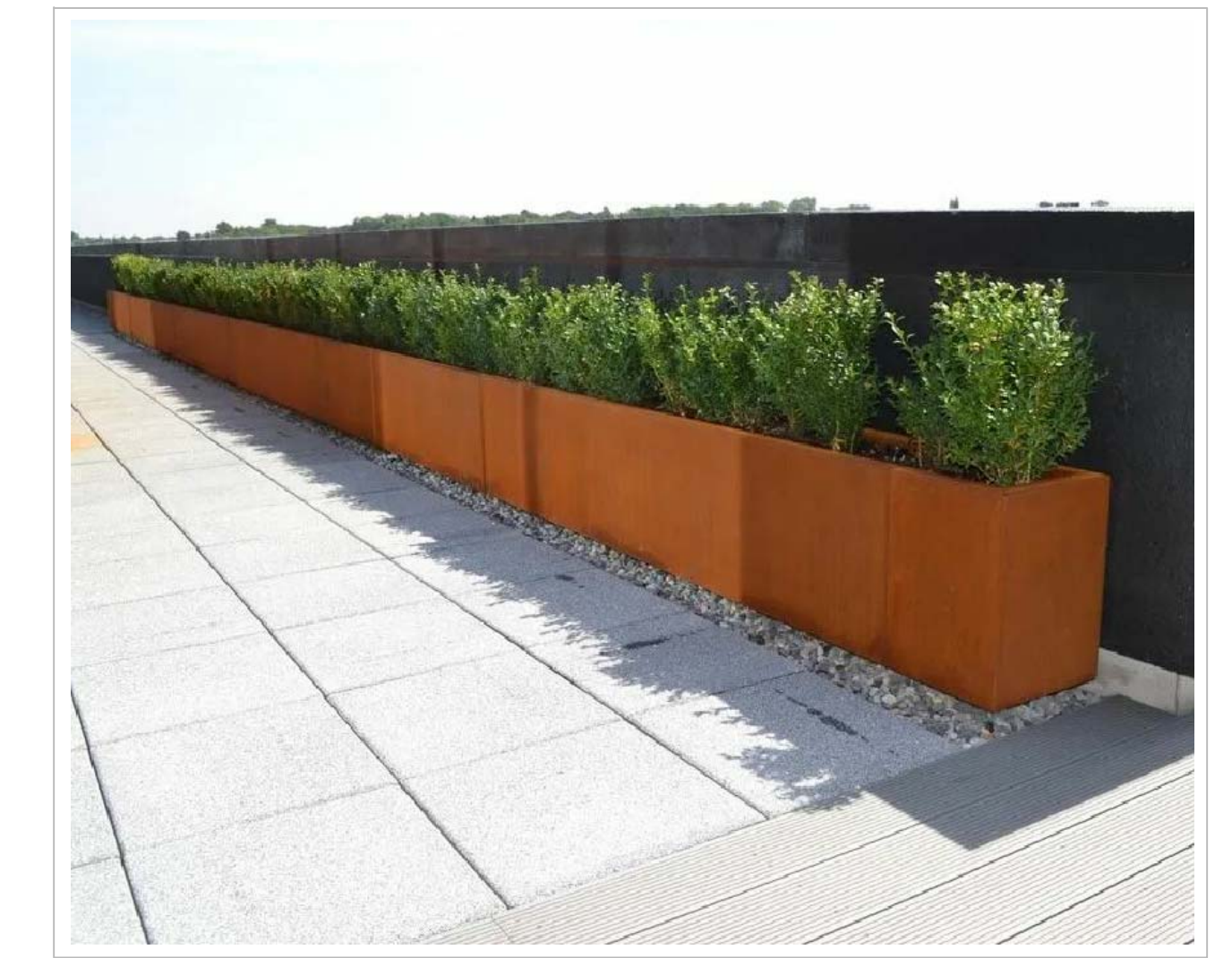

4 L2.01 ILLUSTRATIVE IMAGE WEATHERING STEEL (COR-TEN) PLANTER

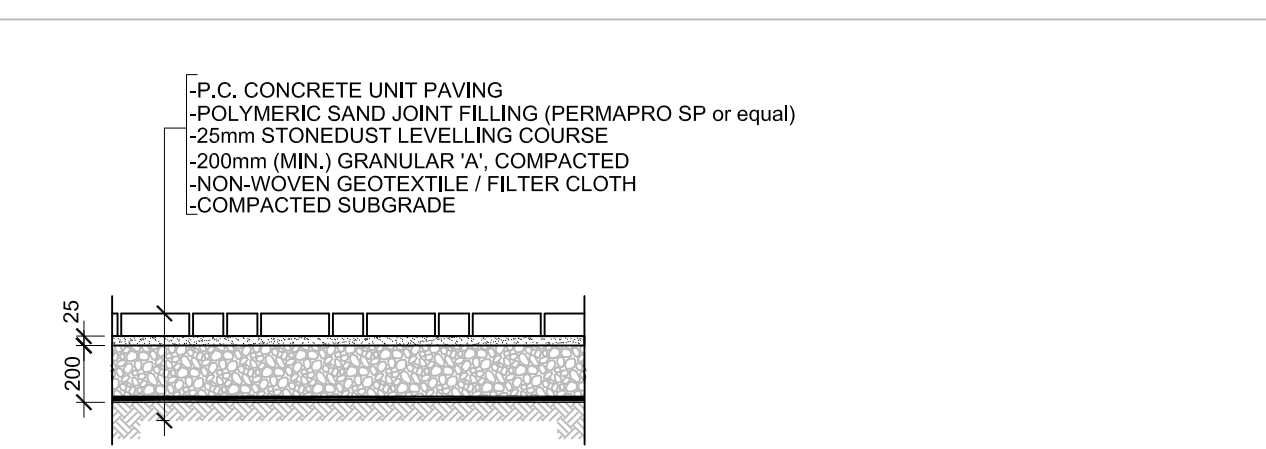

4a L2.01 AT GRADE UNIT PAVING NTS

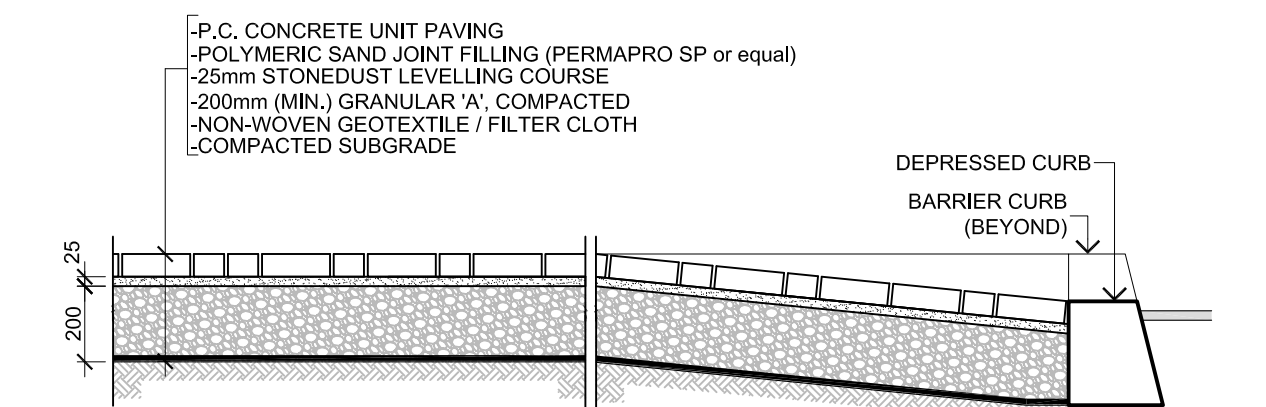

4b L2.01 AT GRADE UNIT PAVING / CURB SECTION NTS

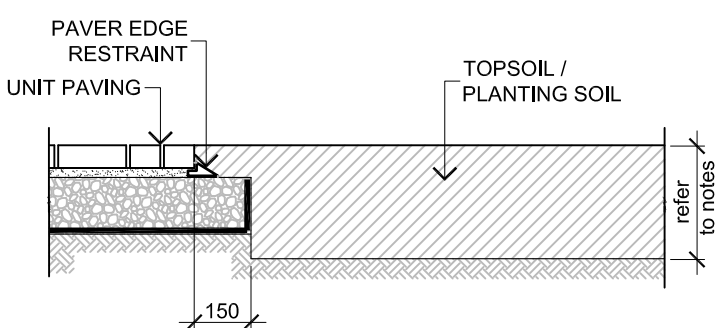

4c L2.01 AT GRADE UNIT PAVING / SOD / PLANTING SECTION NTS

5 L2.01 AT GRADE UNIT PAVING DETAILS NTS

500 SERIES
MBR-0500-00003
 Legacy #MBR500-S

MATERIALS: All parts of the bike rack are made from H.S. steel tube.
 FINISH: All steel components are protected with E-Coat rust proofing. The Maglin Powdercoat System provides a durable finish on all metal surfaces.
 INSTALLATION: The bike rack is delivered pre-assembled. It is available with either a surface mount or direct burial installation option.
 TO SPECIFY: Select MBR-0500-00003
 Choose: - Powdercoat Color

HEIGHT: 35" (88.9cm) LENGTH: 19.25" (48.9cm) WEIGHT: 13.27 lbs (6.0kg)

MAGLIN
 Site Furnishings

1-800-734-5854
 4167-268-0219
 www.maglin.com
 info@maglin.com

All drawings, specifications, design and details on this page remain the property of Maglin's Site Furnishings Inc. and may not be used without Maglin's authorization. Details and specifications may vary due to control by improvements of our products.

INSTALLATION: SURFACE MOUNT
 FINISH: BLACK (GLOSS) POWDERCOAT

6 L2.01 BICYCLE RACK NTS

FOR APPROVAL ONLY

no.	date	revision
2.	JAN.12/24	RE-ISSUE FOR SPA
1.	JUNE 29/23	ISSUE FOR 30% REVIEW

North Arrow

Stamp

Contractor shall check and verify all dimensions on site and report all errors and/or omissions to the Consultant.
 Work to be done in accordance with all applicable codes and by-laws.
 Do not scale Drawing.

This Drawing shall not be used for construction until signed by the Consultant.
 Copyright reserved. This Drawing is the exclusive property of Levstek Consultants Inc. and shall not be used without consent.

Consultant

LEVSTEK CONSULTANTS
 LANDSCAPE ARCHITECTS

5871 Hugh Crescent - Ottawa - Ontario - K9A 2W0
 613 - 826 - 0518

Client

brigil

Project

MOONEY'S BAY
 729 RIDGEWOOD AVENUE

Drawing Title

LANDSCAPE DETAILS 1

Drawn	MGB	Drawn No.	L2.01
Scale	AS SHOWN	Project No.	1180

D07-12-21-0089

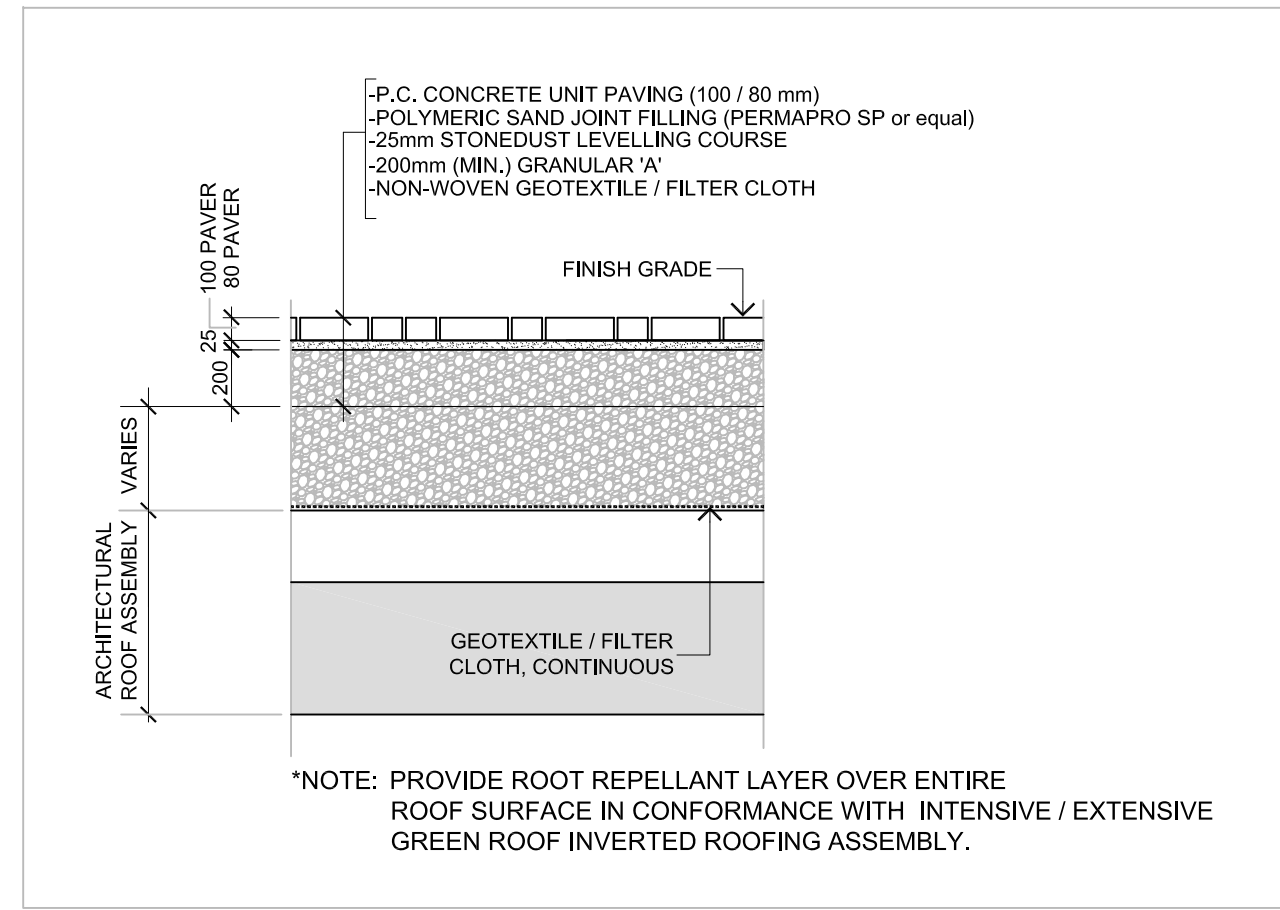

1 PODIUM
L2.02 UNIT PAVING NTS

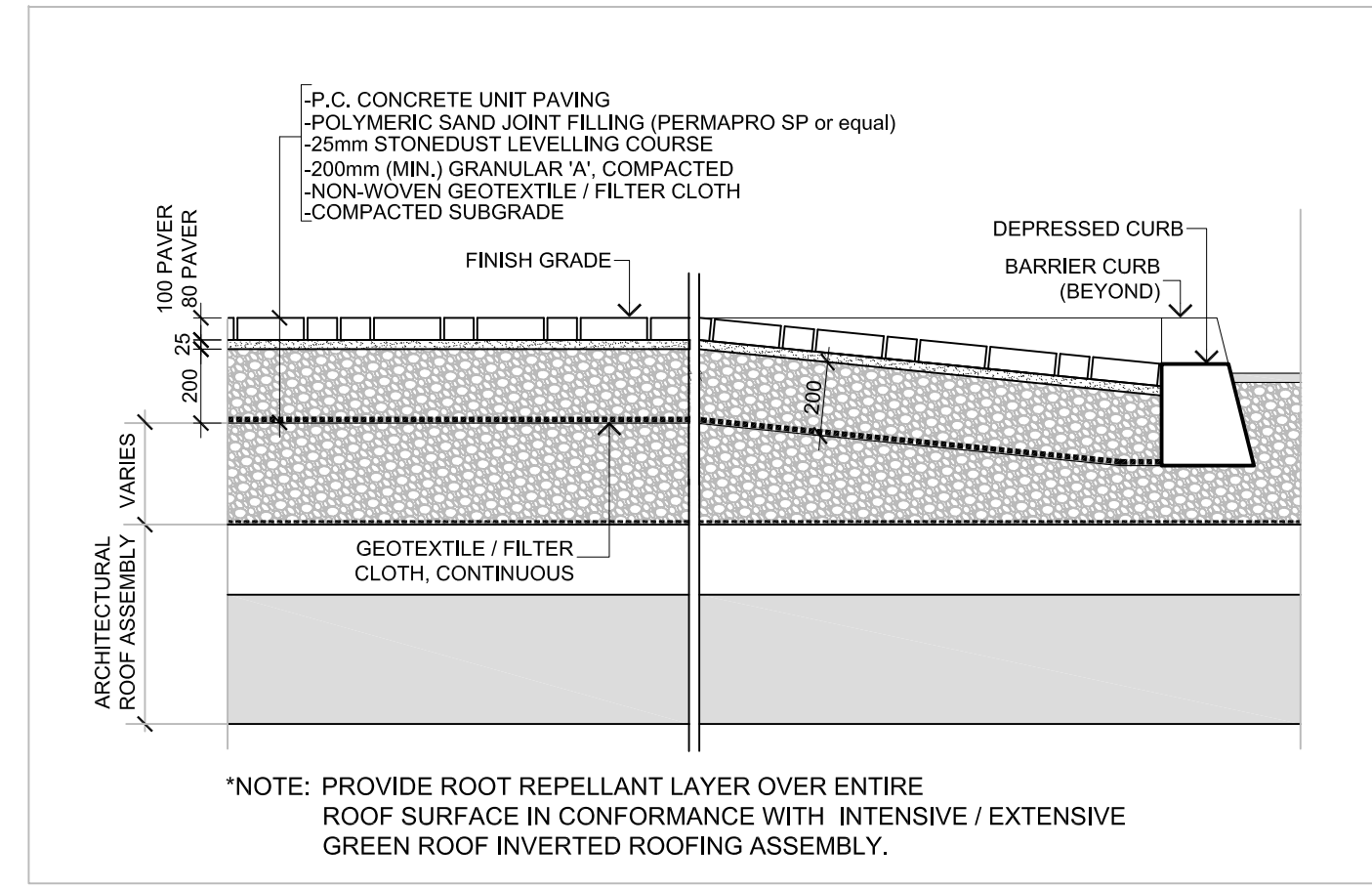

2 PODIUM
L2.02 UNIT PAVING / CURB SECTION NTS

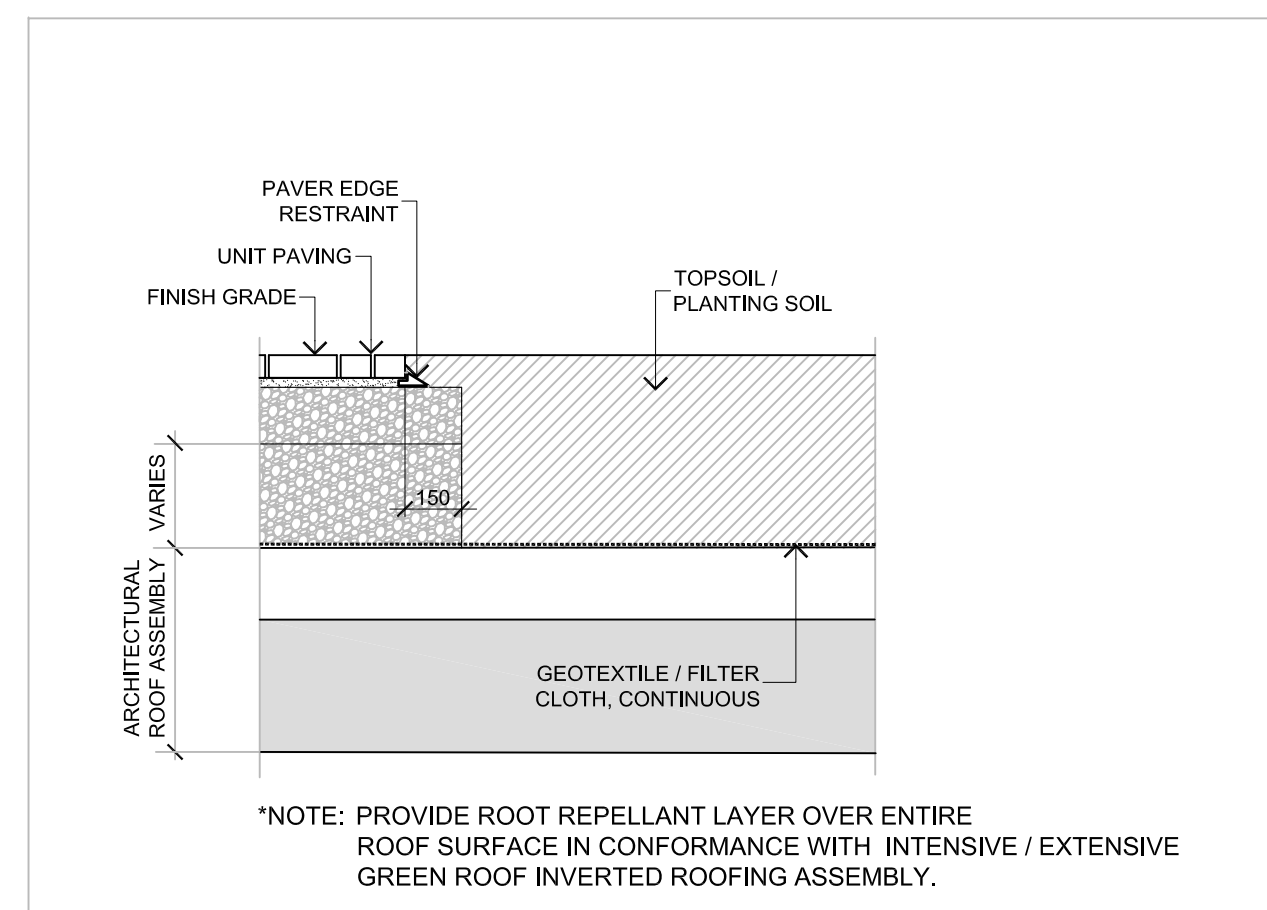

3 PODIUM
L2.02 UNIT PAVING / PLANTING NTS

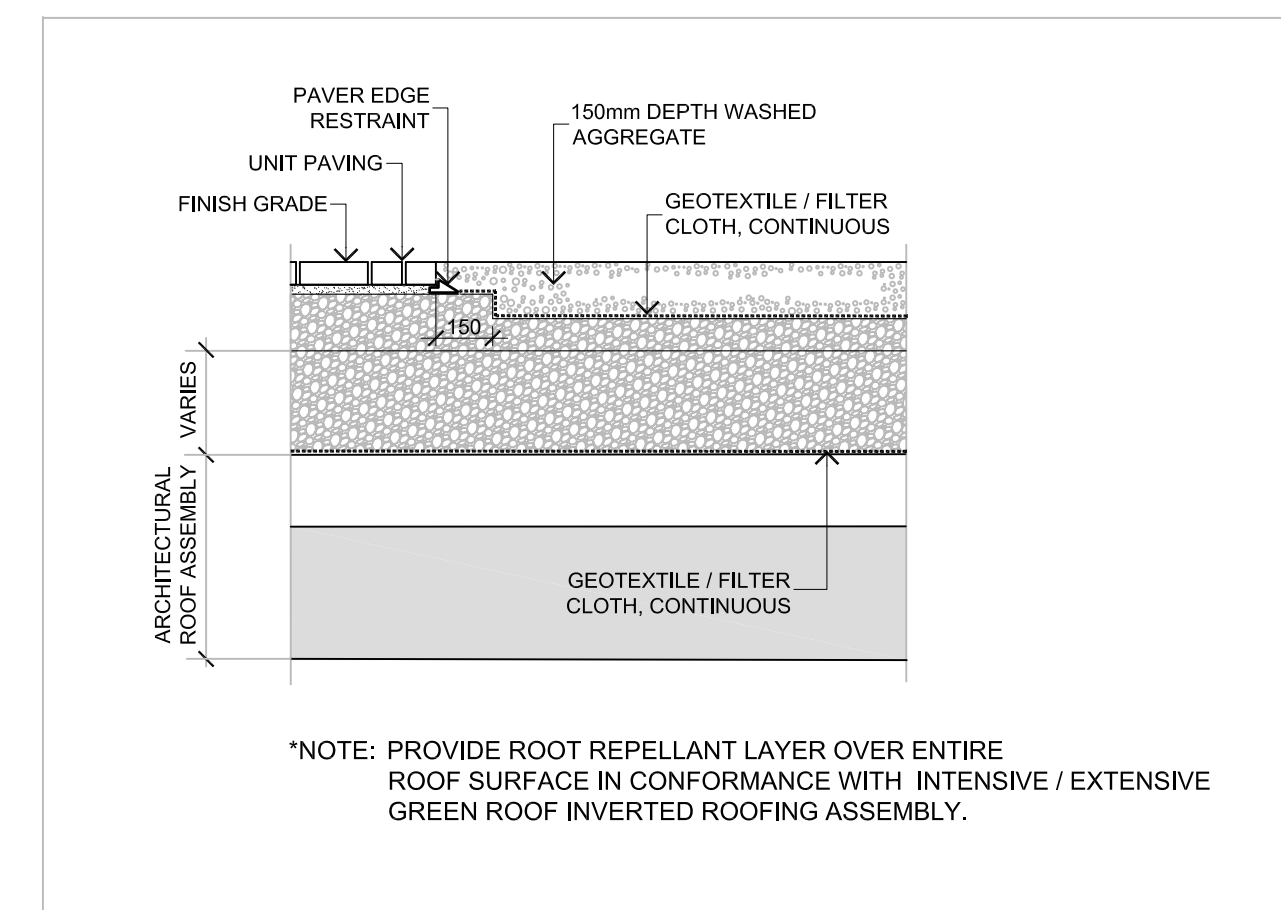

4 PODIUM
L2.02 UNIT PAVING / MAINTENANCE STRIP NTS

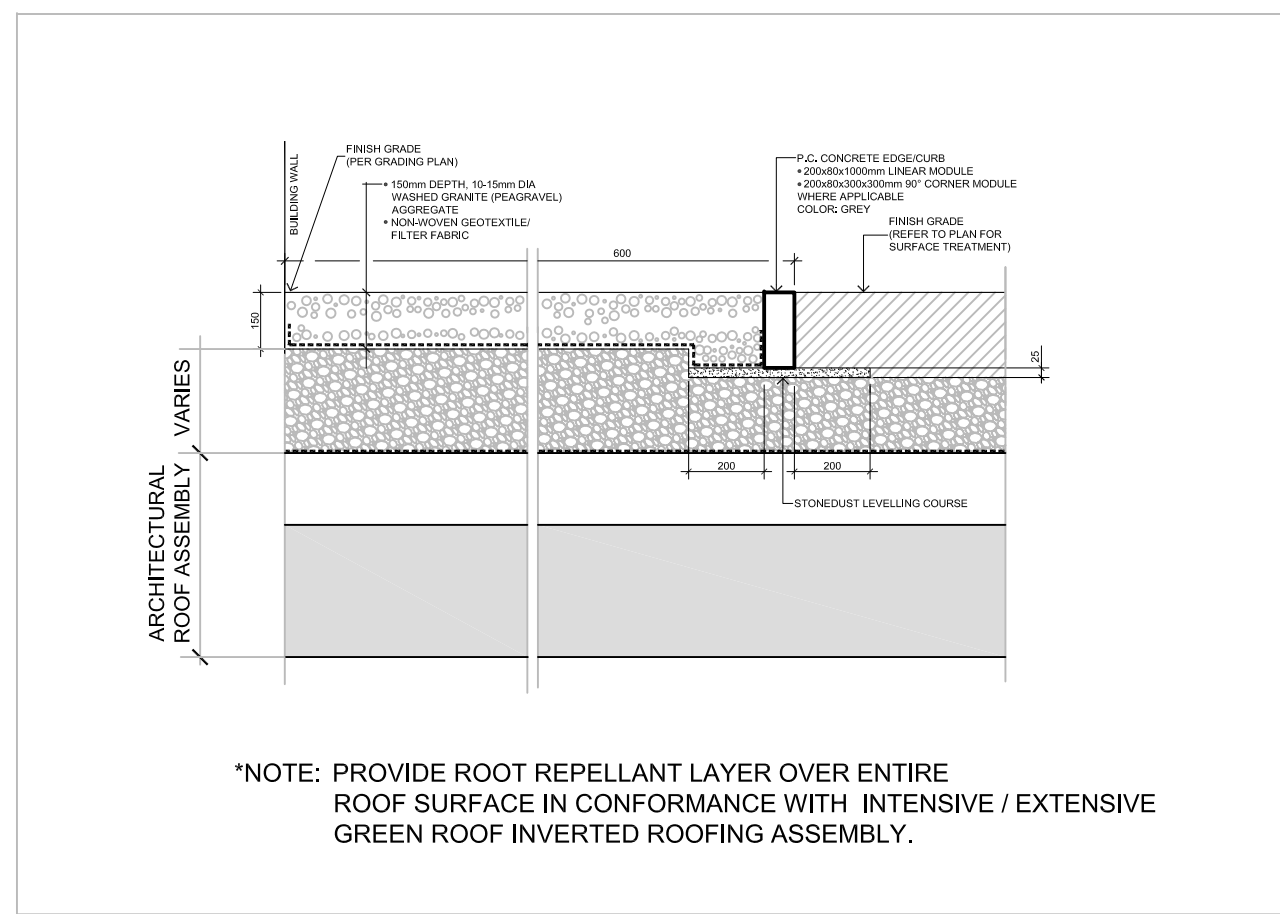

5 PODIUM
L2.02 MAINTENANCE STRIP w/ EDGE SECTION NTS

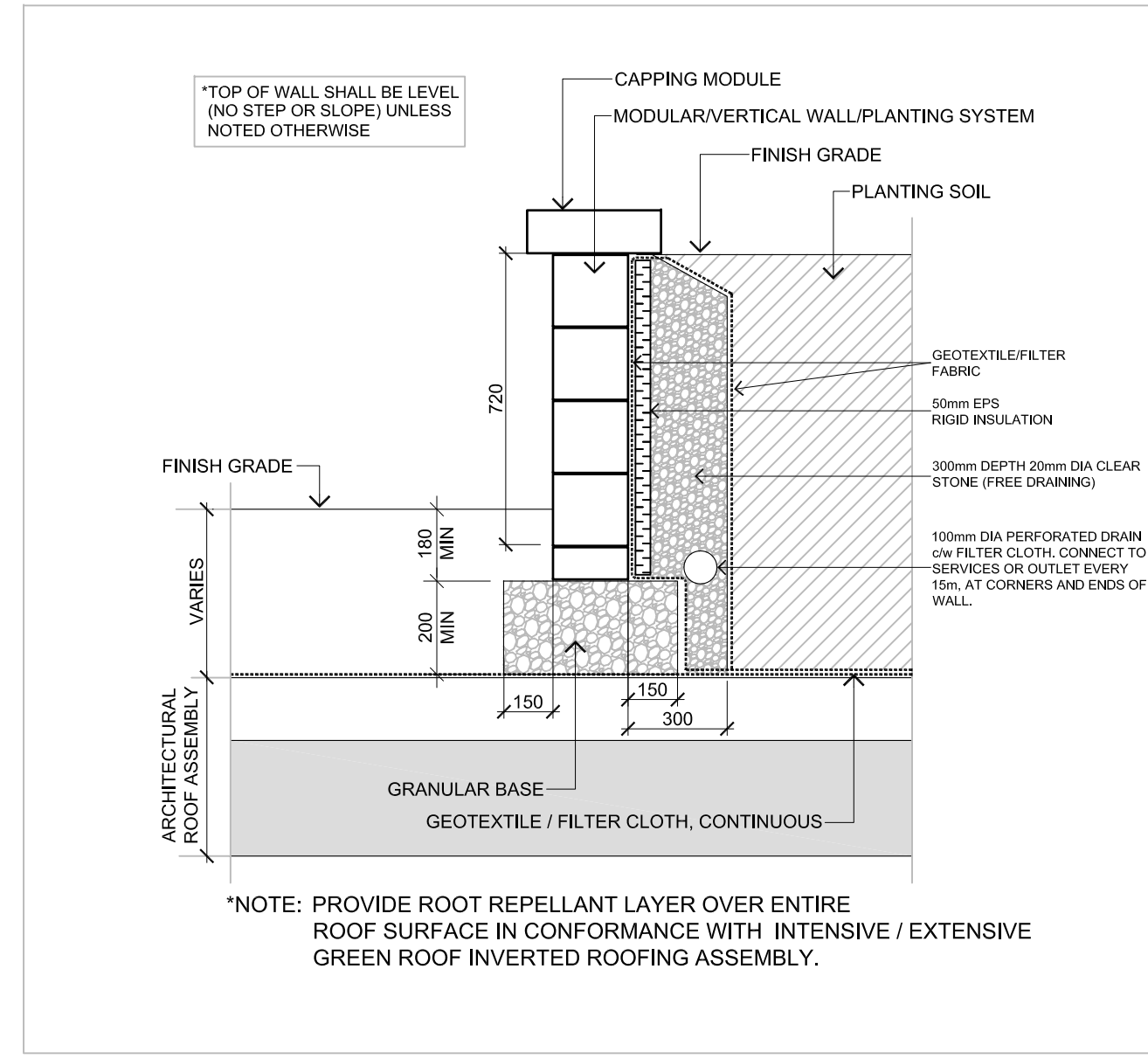

6 PODIUM
L2.02 P.C. CONCRETE PLANTER WALL NTS

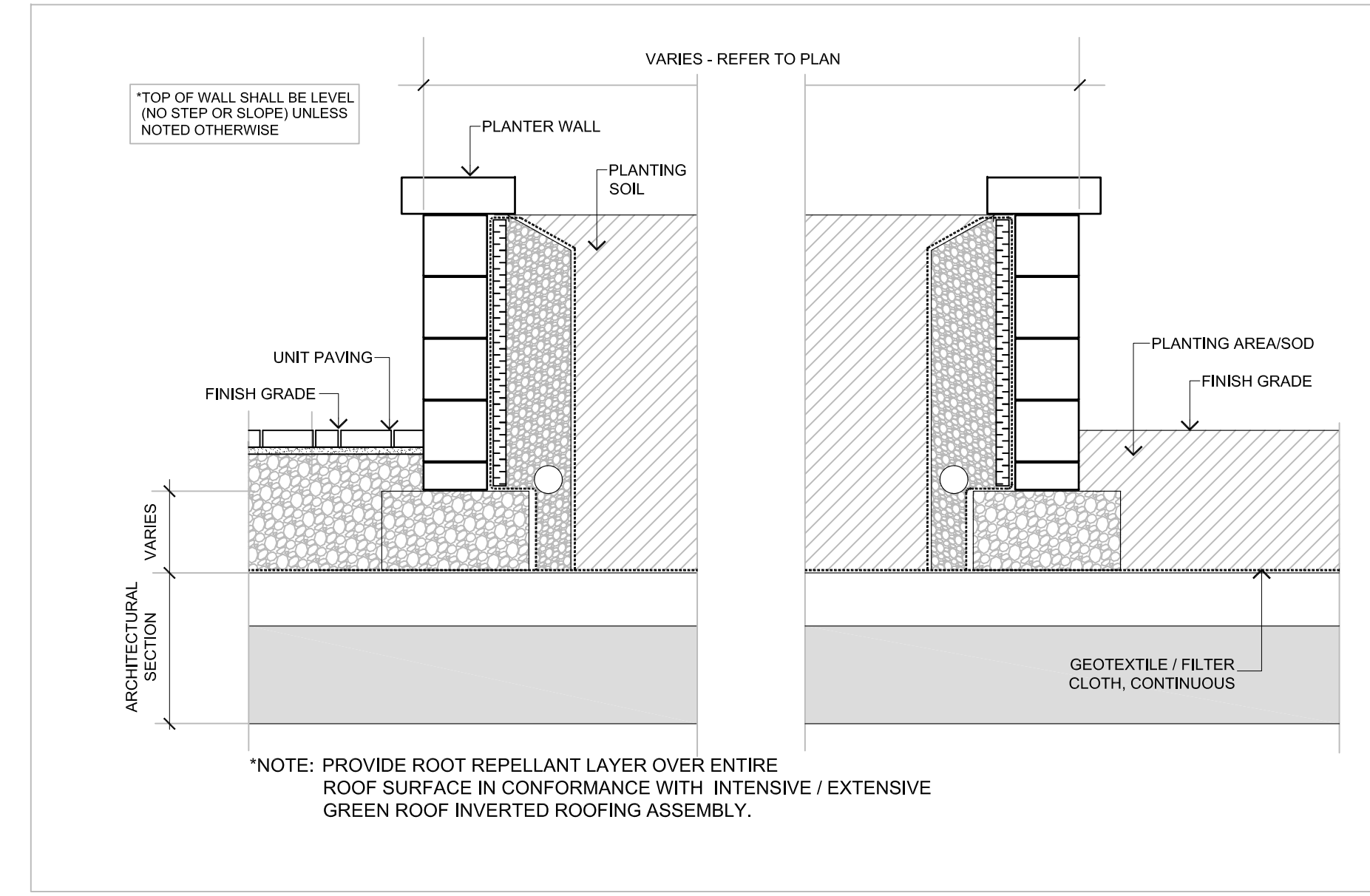

7 PODIUM
L2.02 UNIT PAVING / PLANTER / PLANTING NTS

FOR APPROVAL ONLY

no.	date	revision
3.	JAN.12/24	RE-ISSUE FOR SPA
2.	OCT.25/23	ISSUE FOR REVIEW / COORDINATION
1.	JUNE 29/23	ISSUE FOR 30% REVIEW

Contractor shall check and verify all dimensions on site and report all errors and/or omissions to the Consultant.
Work to be done in accordance with all applicable codes and by-laws.
Do not scale Drawing.
This Drawing shall not be used for construction until signed by the Consultant.
Copyright reserved. This Drawing is the exclusive property of Levstek Consultants Inc. and shall not be used without consent.

Consultant

LEVSTEK CONSULTANT'S
LANDSCAPE ARCHITECTS

3871 Hugh Crescent - Ottawa - Ontario - K9A 2W0
613 - 826 - 0518

Client

brigil

Project

MOONEY'S BAY
729 RIDGEWOOD AVENUE

Drawing Title

LANDSCAPE DETAILS 2

Drawn	MGB	Drawn No.	L2.02
Scale	AS SHOWN	Project No.	1180

D07-12-21-0089