

**LEVEL P1**

**BUILDING A+B:**

PARKING SPACES: **TOTAL 115**  
 RESIDENTIAL: 115 SPACES  
 BICYCLES: **100 HORIZONTAL**  
 LOCKERS: **211 UNITS**

**BUILDING D:**

PARKING SPACES: **TOTAL 90**  
 RESIDENTIAL: 66 SPACES  
 VISITORS: 24 SPACES  
 BICYCLES: **66 HORIZONTAL**  
 LOCKERS: **136 UNITS**

**APPROVED**  
 By Lily Xu at 1:51 pm, Aug 05, 2022

**1376, CARLING AV.**  
 PHASE 2

Design Title:  
**BASEMENT 1 PLAN  
 A,B&D**

Rev : 01	designed by : G.M.
date : 04/05/22	approved by : E.H.
file : 19-042	sheet: 17

**D07-12-21-0092**  
 Plan number : 18501

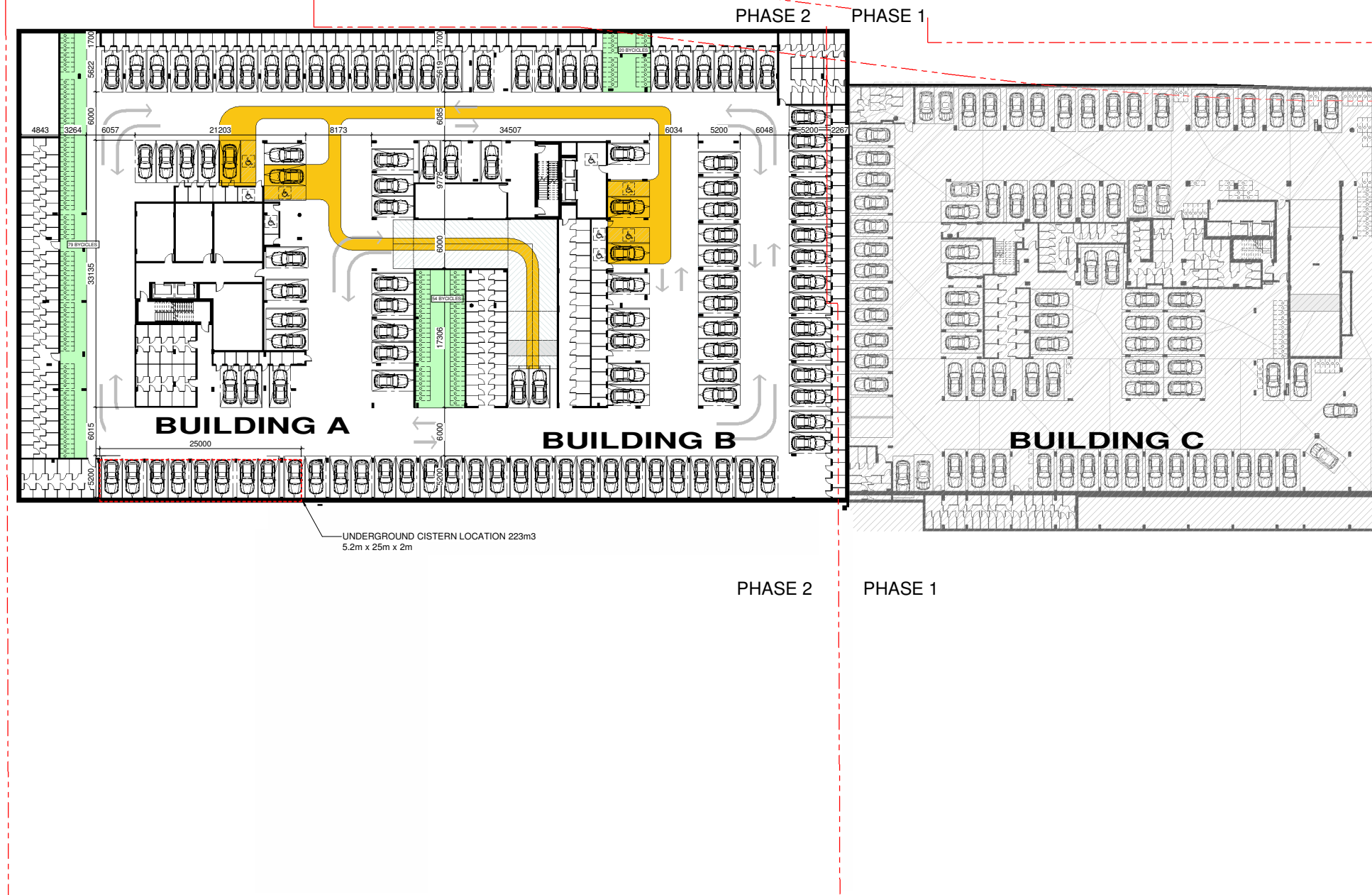
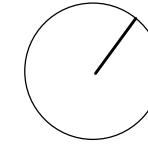

**LEVEL P2**

**BUILDING A+B:**

PARKING SPACES: **TOTAL 118**

RESIDENTIAL: 115 SPACES

VISITORS: 3 SPACES

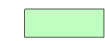
 **BICYCLES: 153 HORIZONTAL**

**LOCKERS: 252 UNITS**

**1376, CARLING AV.**

PHASE 2

**APPROVED**

By Lily Xu at 1:51 pm, Aug 05, 2022

**LILY XU, MCIP, RPP**  
**MANAGER, DEVELOPMENT REVIEW SOUTH**  
**PLANNING, INFRASTRUCTURE & ECONOMIC**  
**DEVELOPMENT DEPARTMENT, CITY OF OTTAWA**

Design Title:  
**BASEMENT 2 PLAN**  
**A,B&D**

Rev : 01	designed by : G.M.	/
date : 04/05/22	approved by : E.H.	
file : 19-042	sheet:	18