

CITY DETAILS

Related details from City of Ottawa Standard Tender Documents Volume No. 2 Standard Detail Drawings.

- SC4. Typical Concrete Sidewalk in Boulevard
- SC5. Sidewalk Construction Joints

NOVATECH DETAILS

Found on Sheet L2.

- D1. Standard Deciduous Tree Planting
- D2. Standard Coniferous Tree Planting
- D3. Shrub and Perennial Planting
- D4. Bike Layout

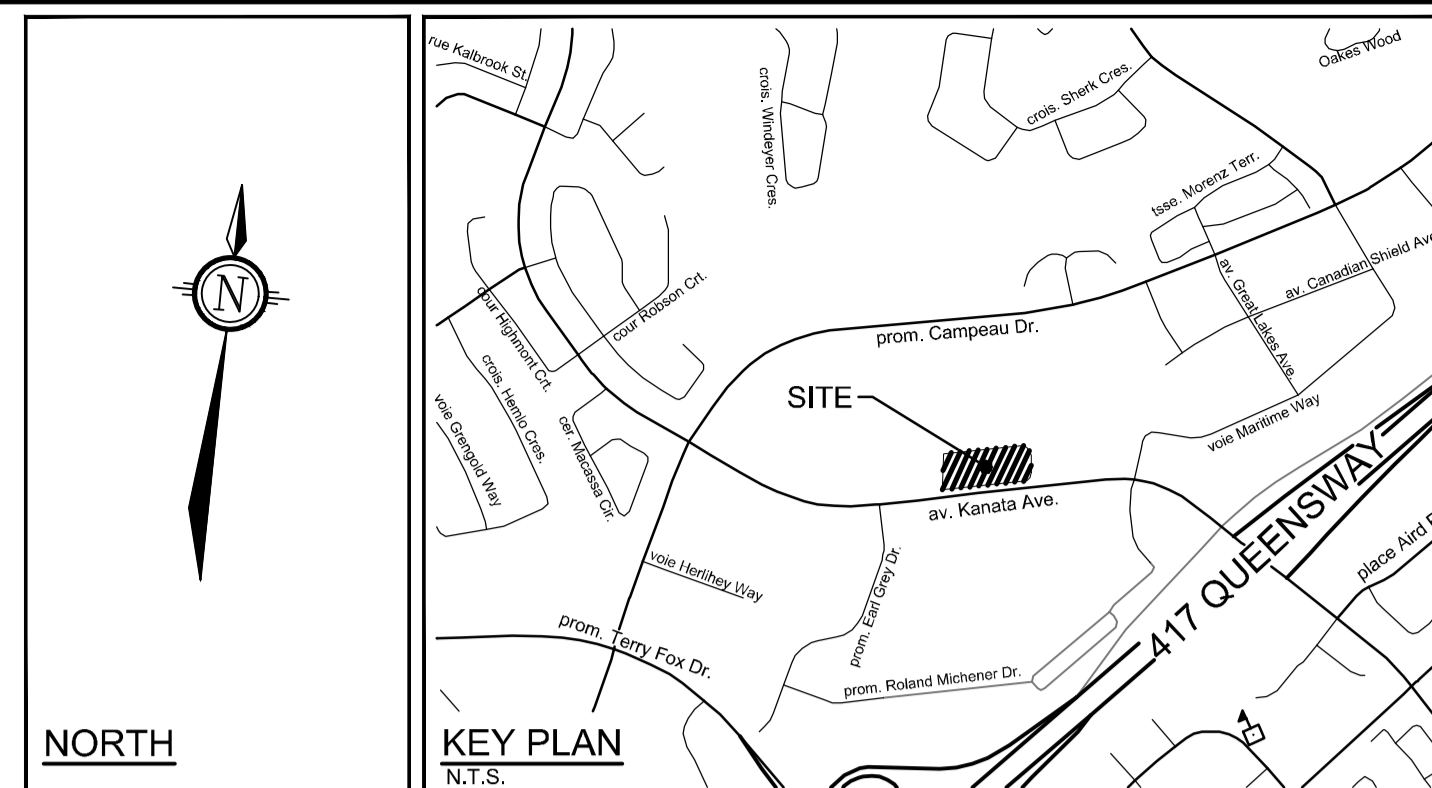

LEGEND

- PROPERTY LIMIT
- LIMIT OF UNDERGROUND GARAGE
- [Pattern] PROPOSED CONCRETE
- [Pattern] PROPOSED PAVERS TBD.
- [Pattern] CLEARSTONE
- [Pattern] SOD
- [Pattern] PERENNIALS
- [Symbol] PROPOSED DECIDUOUS TREE
- [Symbol] PROPOSED CONIFEROUS TREE
- [Symbol] PROPOSED SHRUBS
- [Symbol] PROPOSED BLACK CHAIN LINK FENCE 1.5m HT
- [Symbol] PROPOSED DECORATIVE METAL FENCE 1.5m HT
- [Symbol] GATE
- [Symbol] BENCH
- [Symbol] RECEPTACLE
- [Symbol] BICYCLE PARKING
- [Symbol] SPECIES (SEE PLANT LIST)
- [Symbol] QUANTITY

GENERAL

1. Read and interpret this drawing/ drawing set in conjunction with all the contract details and specifications, including related civil, utility, structural, architectural, mechanical, electrical, environmental, geotechnical, and survey information.
2. The Contractor is to determine the exact location, size, material, and elevation of all existing utilities prior to commencing construction. Protect and assume responsibility for all existing utilities regardless of being shown on the drawings.
3. It is essential to use the plans and details in conjunction with the specifications and notes.
4. Do not scale drawings. Work to dimensions only.
5. Protect all existing and retained vegetation for the duration of construction according to the contract details and specifications.
6. Reinstatement all areas and items damaged or disturbed, beyond the Limit of Work, because of construction activities, including but not limited to construction staging areas, haul roads, stockpile areas, etc. to the satisfaction of the Consultant. Unless otherwise noted, Contractor is to reinstate all areas to pre-construction condition or better to the satisfaction of the Contract Administrator.

PLANTING

1. Plant material to be No. 1 Grade and is to comply with Canadian Standards for Nursery Stock (latest edition) published by the Canadian Nursery Landscape Association. Use structurally sound plant material with strong fibrous root system free of disease, defects, and injuries. Use trees with straight trunks, well and characteristically branched for species. Obtain approval from consultant of plant material at source prior to digging. All trees and shrubs to be container grown, potted, W/B or B/S, as indicated on Plant List. Bare root plants are only acceptable for certain species and as approved by the Landscape Architect.
2. Plant material substitutions are not permitted without the written approval from the Consultant, with 48 hours notice, prior to shipping plant material.
3. Plant locations are schematic / approximate only. Contractor is to stake out locations on site for approval by the Landscape Architect prior to installation. Contractor will assume full responsibility if the Landscape Architect is not notified.
4. The illustrated number of plants shown in the Planting Plan supersedes the estimated number in the Plant List. Contractor to report any discrepancies to the Landscape Architect prior to installation. Contractor will assume full responsibility if the Landscape Architect is not notified.
5. Ensure trees are thoroughly watered following planting. Monitor material and ensure adequate moisture until acceptance.
6. In heavy clay or poorly drained soils, set root ball with root collar 75-100mm higher than finished grade.
7. Approved topsoil depths are as follows:
 - a. Plant Beds - 450mm continuous depth. Applies to shrubs, perennials, vines, and groundcovers.
 - b. Sod/ Seed Areas - 100mm depth.
 - c. Reforestation - 300mm depth.
8. Sod to be No. 1 Kentucky Bluegrass Sod grown from minimum mixture of 3 Kentucky Bluegrass cultivars. Quality and source are to comply with Canadian Standards for Nursery Stock, Section 17, (latest edition) published by the Canadian Nursery Landscape Association.
9. Install a 1.2m sod strip adjacent to all hard surfaces. Note, sod is not typically graphically shown on plans.
10. Apply the following mineral fertilizer unless soil tests show other requirements:
 - a. Plant Beds - (8-32-16), i.e. 8% Nitrogen, 32% Phosphorus, 16% Potash per manufacturer specifications.
 - b. Sod Areas - (8-32-16), i.e. 8% Nitrogen, 32% Phosphorus, 16% Potash at a rate of 350kg/ha.
11. Where applicable, for any plant areas with a mix of species/ cultivars notes, Contractor is to cluster like plants in groups of 3-5 and evenly distribute these in the noted area.

PLANT LIST

KEY	QTY	BOTANICAL NAME	COMMON NAME	SIZE	COND	SPACING
Coniferous Trees						
PS	3	<i>Pinus strobus</i>	Eastern White Pine	175cm HT	WB	As Shown
Deciduous Trees						
ARA	5	<i>Acer rubrum 'Autumn Spire'</i>	Autumn Spire Red Maple	50mm Cal	WB	As Shown
AS	4	<i>Acer saccharum</i>	Sugar Maple	50mm Cal	WB	As Shown
ASG	3	<i>Acer saccharum 'Green Mountain'</i>	Green Mountain Sugar Maple	50mm Cal	WB	As Shown
AXR	2	<i>Amelanchier x grandiflora 'Robin Hill'</i>	Robin Hill Serviceberry	50mm Cal	WB	As Shown
QR	3	<i>Quercus rubra</i>	Red Oak	50mm Cal	WB	As Shown
Deciduous Shrubs						
Ama	190	<i>Aronia melanocarpa 'Autumn Magic'</i>	Autumn Magic Chokecherry	60cm HT	PT	As Shown
Csa	41	<i>Cornus sericea 'Farrow'</i>	Arctic Fire Dogwood	2g	PT	As Shown
Hf	32	<i>Hydrangea paniculata 'SMHPLQF'</i>	Little Quick Fire Hydrangea	2g	PT	As Shown
Hll	47	<i>Hydrangea paniculata 'Little Lime 'Jane'</i>	Little Lime Hydrangea	2g	PT	As Shown
Pg	23	<i>Rhus aromatica 'Sourwood'</i>	Amber Jubilee Nettlebar	60cm HT	PT	As Shown
Ra	63	<i>Rhus aromatica</i>	Fragrant Sumac	3g	PT	As Shown
Rag	11	<i>Rhus aromatica 'Gro-Low'</i>	Gro-Low Fragrant Sumac	3g	PT	As Shown
Rt	10	<i>Rhus typhina</i>	Staghorn Sumac	7g	PT	As Shown
Ssa	39	<i>Sorbaria sorbifolia 'Sem'</i>	Sem False Spiraea	3g	PT	As Shown
Perennials						
Hbz	96	<i>Hemerocallis 'Bonanza'</i>	Bonanza Daylily	1g	PT	30cm O.C.
Hth	96	<i>Hemerocallis 'Frans Hals'</i>	Frans Hals Daylily	1g	PT	30cm O.C.
Hth	111	<i>Hosta 'Halcyon'</i>	Halcyon Hosta	1g	PT	90cm O.C.

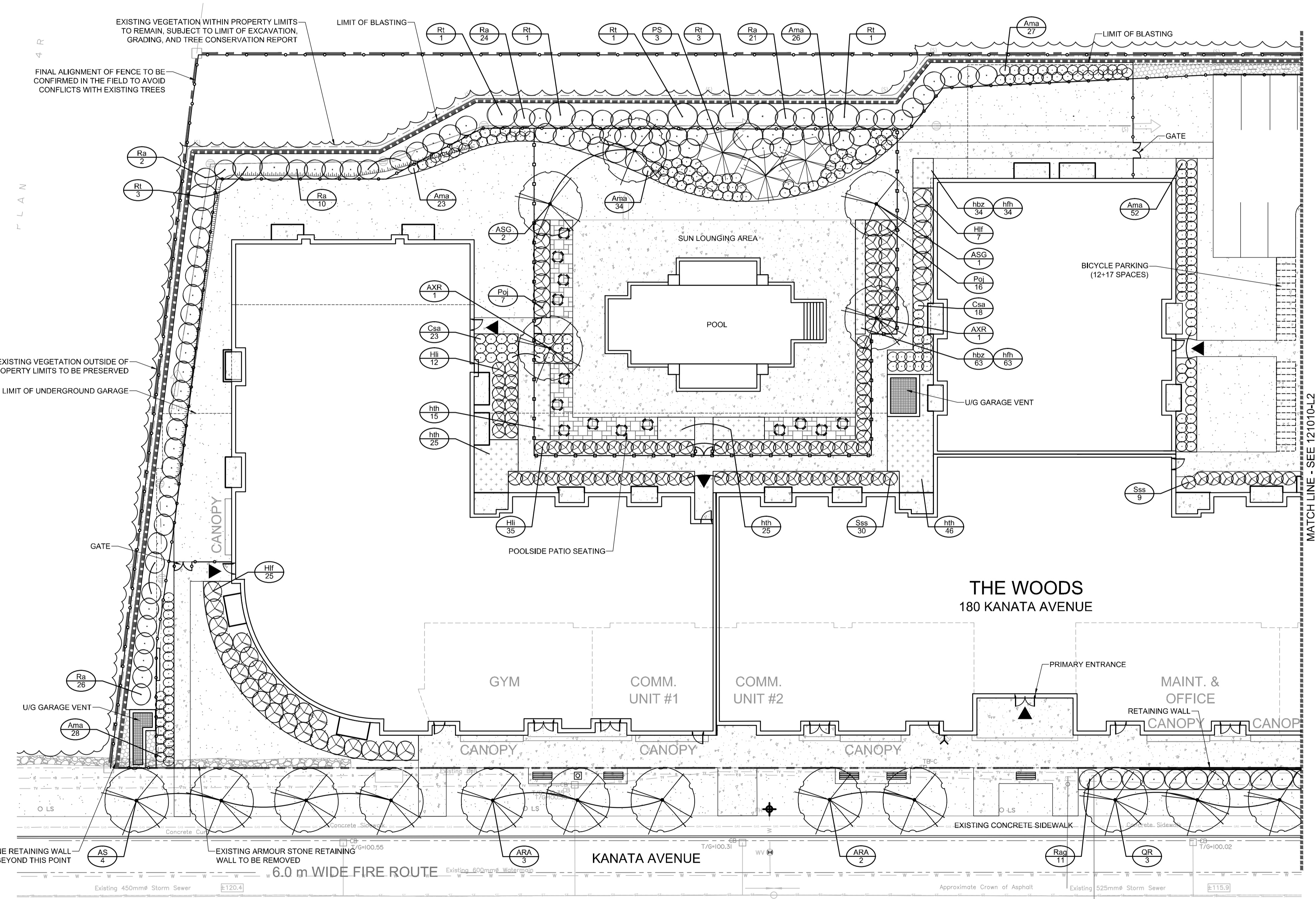

NOTE:
THE POSITION OF ALL POLE LINES, CONDUITS, WATERMANS, SEWERS AND OTHER UNDERGROUND AND OVERGROUND UTILITIES AND STRUCTURES IS NOT NECESSARILY SHOWN ON THE CONTRACT DRAWINGS, AND WHERE SHOWN, THE ACCURACY OF THE POSITION OF SUCH UTILITIES AND STRUCTURES IS NOT GUARANTEED. BEFORE STARTING WORK, DETERMINE THE EXACT LOCATION OF ALL SUCH UTILITIES AND STRUCTURES AND ASSUME ALL LIABILITY FOR DAMAGE TO THEM.

NOT FOR CONSTRUCTION

No.	REVISION	DATE	BY
5.	REVISED PER CITY COMMENTS	MAY 9/22	RJ
4.	REVISED PER CITY COMMENTS	MAR 11/22	RJ
3.	REVISED PER CITY COMMENTS	DEC 10/21	RJ
2.	ISSUED FOR CLIENT REVIEW	NOV 11/21	RJ
1.	ISSUED FOR SITE PLAN APPLICATION	JUL 9/21	RJ

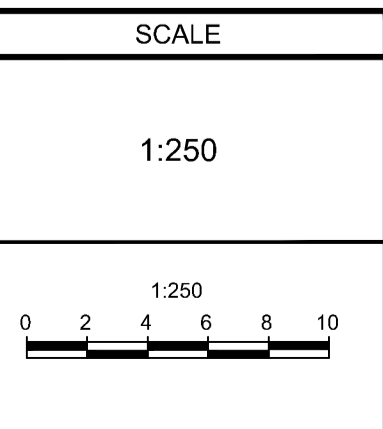

DESIGN	REVISION
RJ	
RJ	
MT	
MT	
RJ	

FOR REVIEW ONLY

NOVATECH
Engineers, Planners & Landscape Architects
Suite 200, 240 Michael Cowpland Drive
Ottawa, Ontario, Canada K2M 1P6
Telephone: (613) 254-9643
Facsimile: (613) 254-5867
Website: www.novatech-eng.com

LOCATION	CITY OF OTTAWA
THE WOODS, 180 KANATA AVENUE	
DRAWING NAME	
LANDSCAPE PLAN	
WESTERN PORTION	
AND POOL AREA	
PROJECT NO.	121010-00
REV	REV # 5
DRAWING NO.	121010-L1

M:\2021\121010\CADD\Landscaping\121010_L1.dwg, L1, May 10, 2022, 1:54pm, introduction

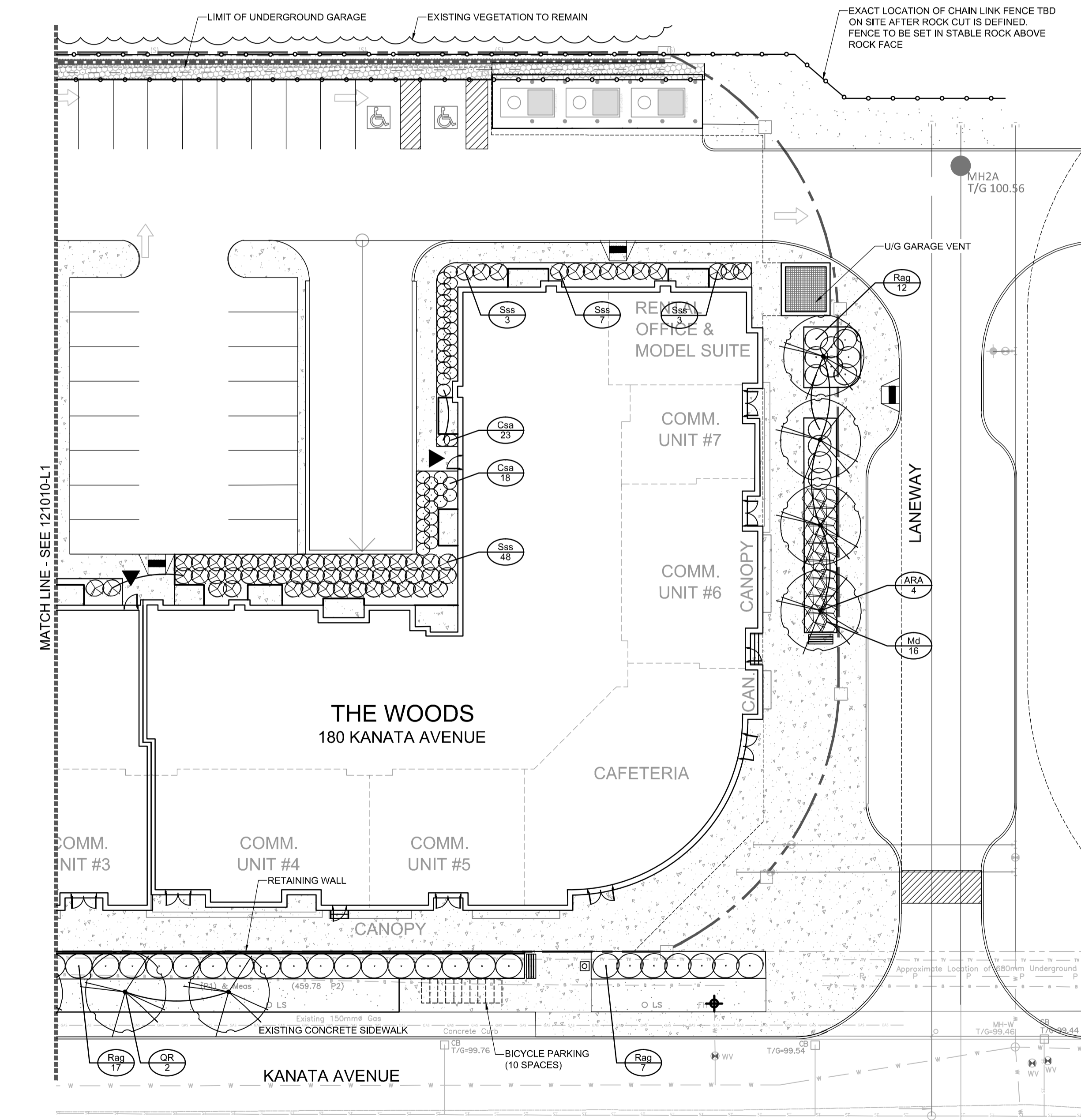
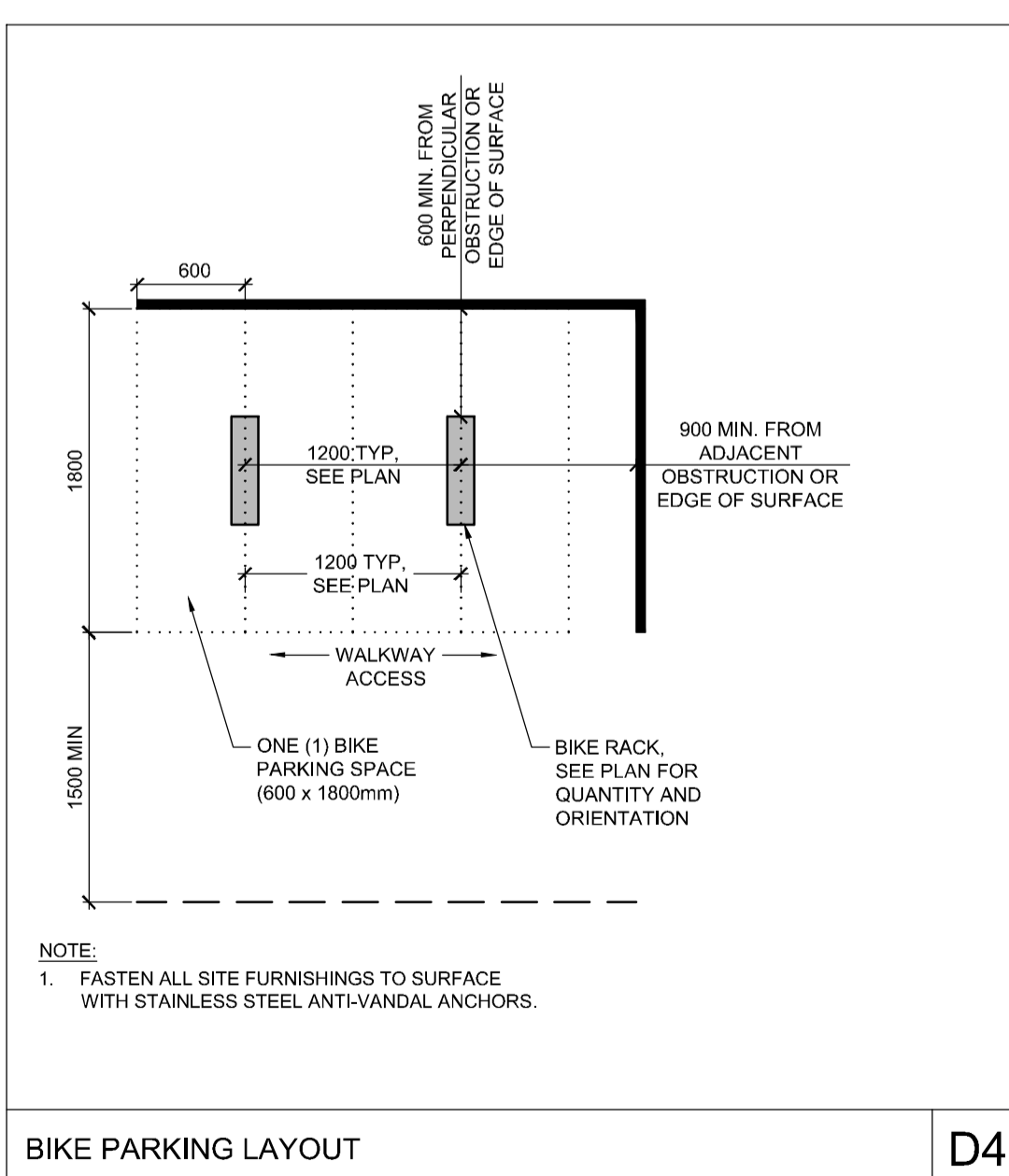
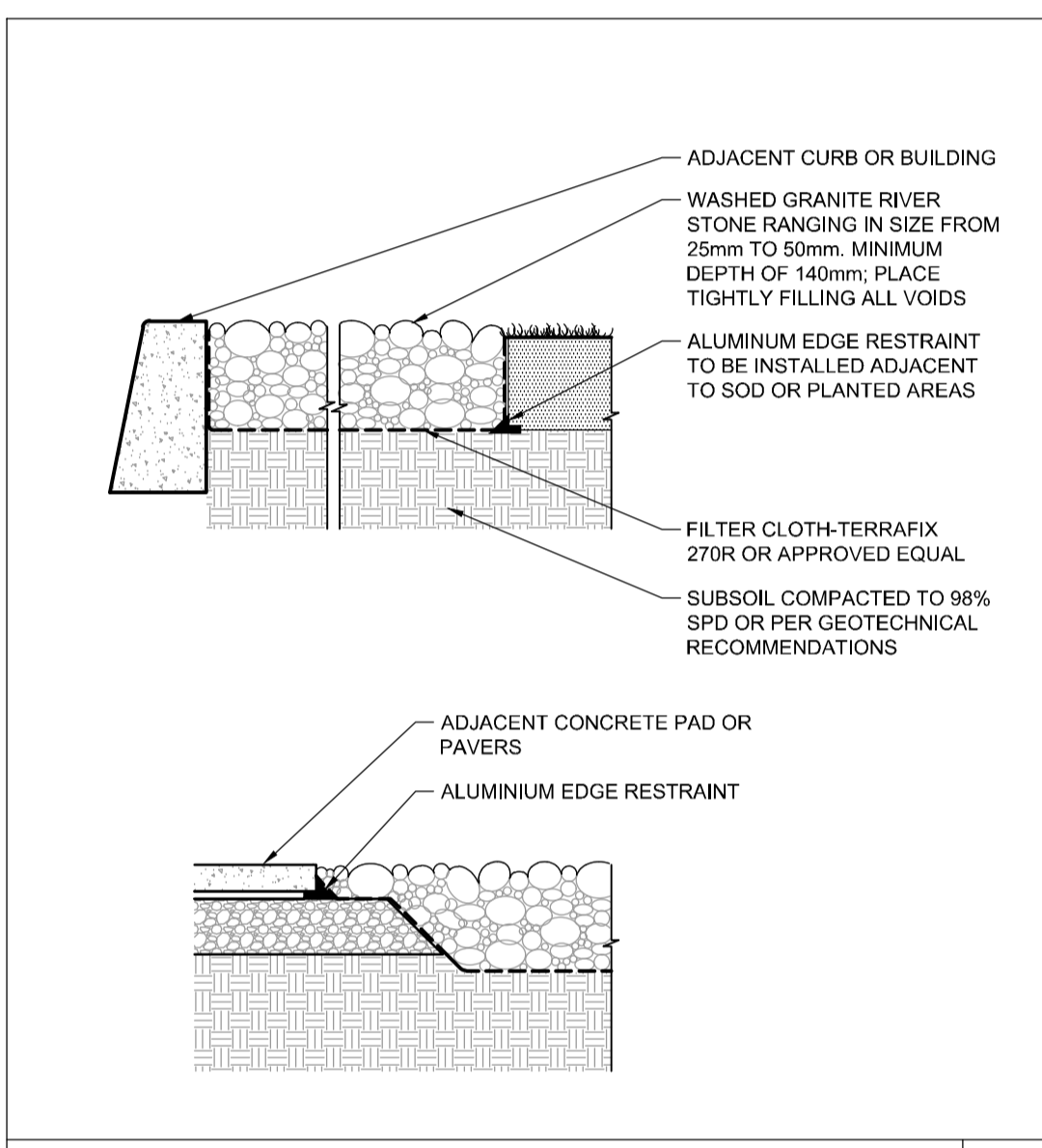
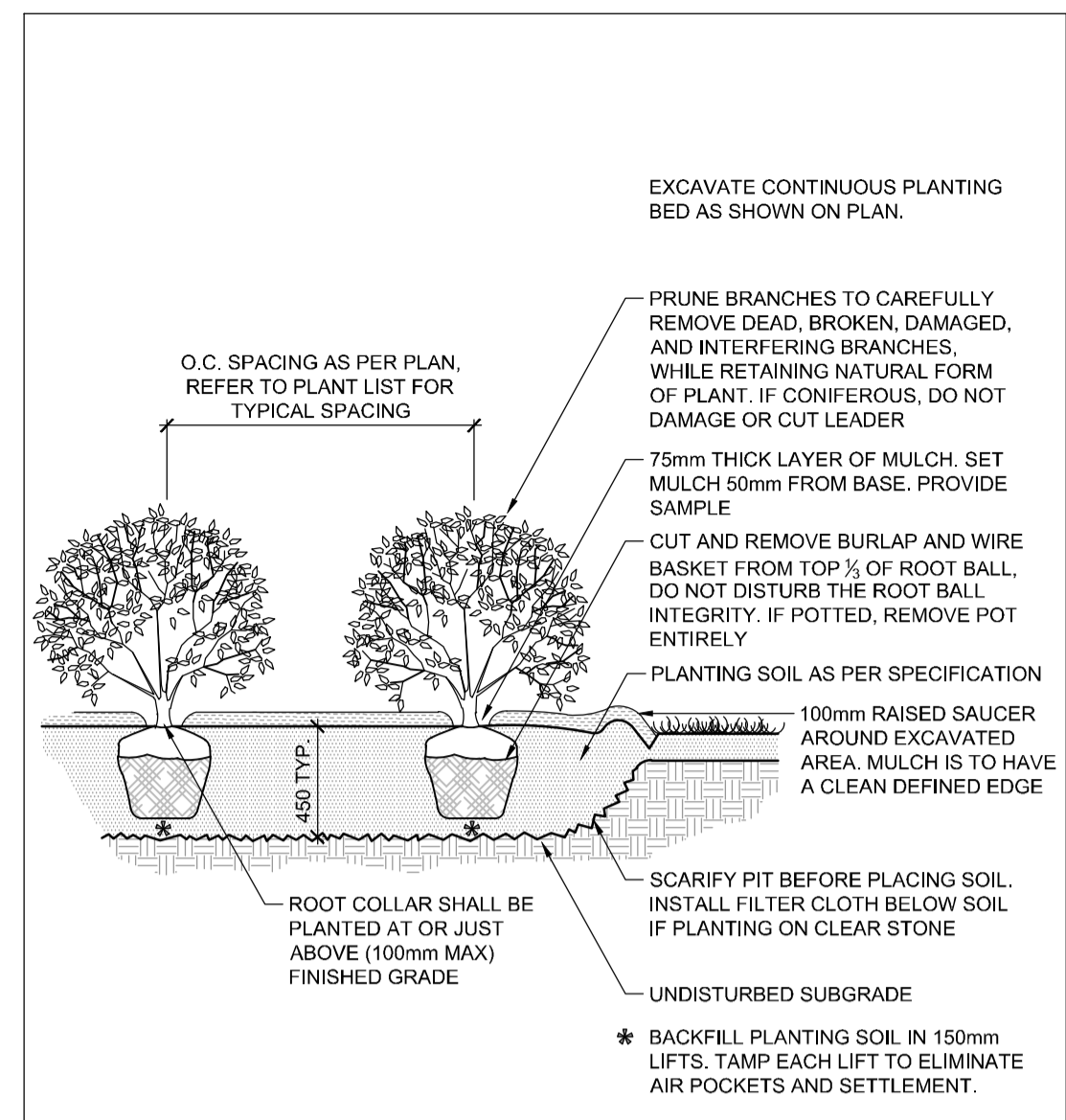
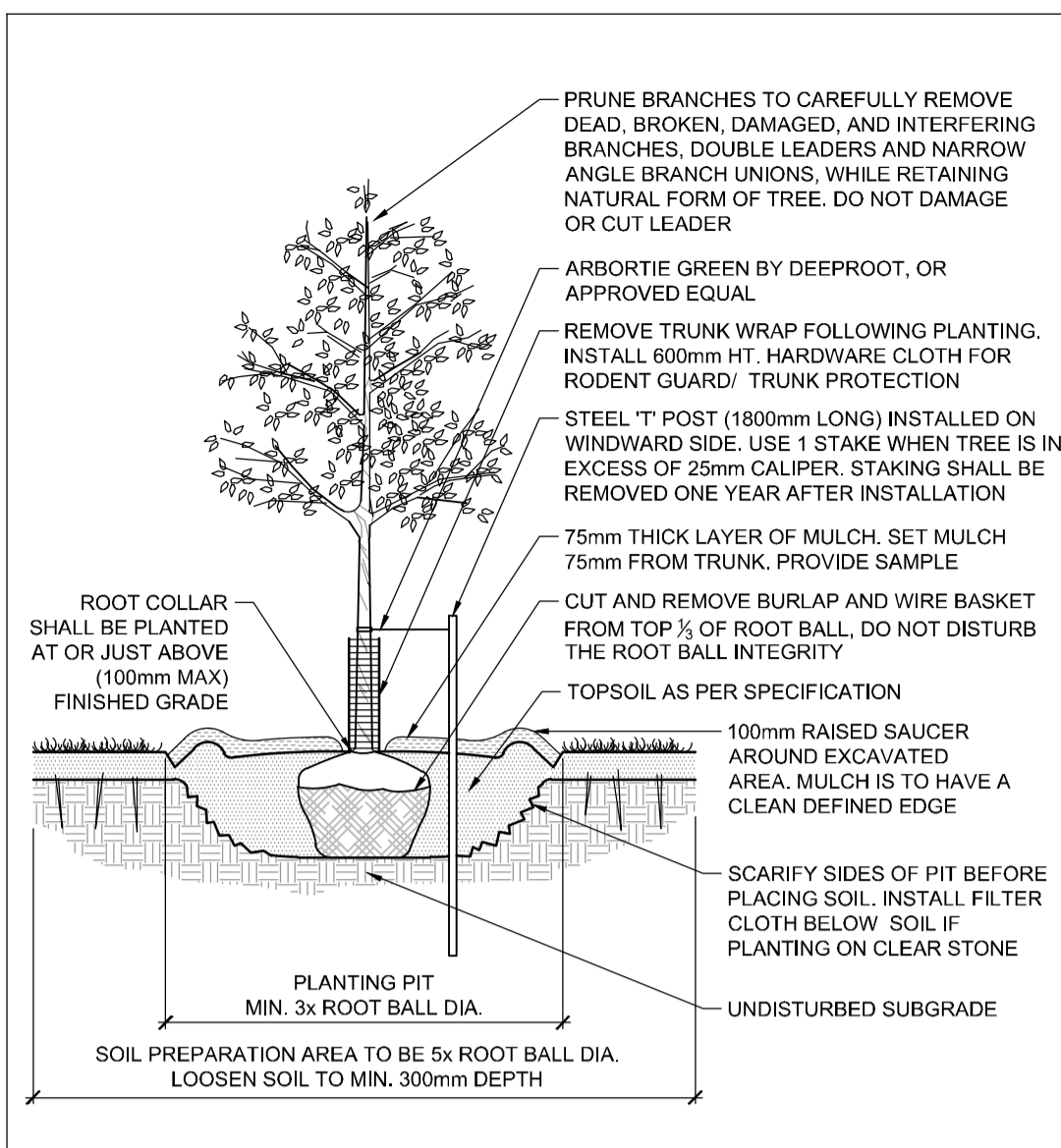

CITY DETAILS
 Related details from City of Ottawa Standard Tender Documents Volume No. 2 Standard Detail Drawings.
 SC4. Typical Concrete Sidewalk in Boulevard
 SC5. Sidewalk Construction Joints

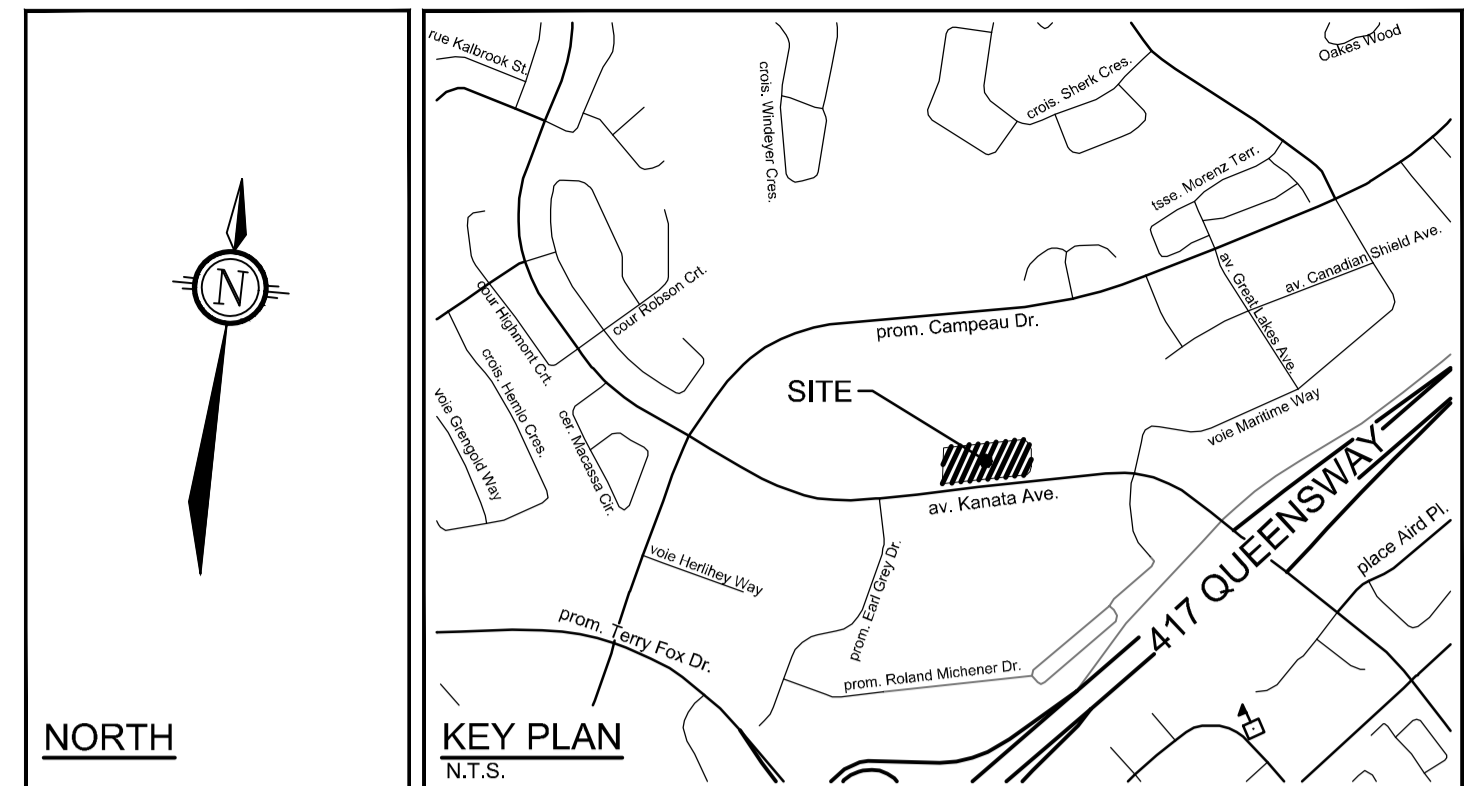

GENERAL

- Read and interpret this drawing/ drawing set in conjunction with all the contract details and specifications, including related civil, utility, structural, architectural, mechanical, electrical, environmental, geotechnical, and survey information.
- The Contractor is to determine the exact location, size, material, and elevation of all existing utilities prior to commencing construction. Protect and assume responsibility for all existing utilities regardless of being shown on the drawings.
- It is essential to use the plans and details in conjunction with the specifications and notes.
- Do not scale drawings. Work to dimensions only.
- Protect all existing and retained vegetation for the duration of construction according to the contract details and specifications.
- Reinstate all areas and items damaged or disturbed, beyond the Limit of Work, because of construction activities, including but not limited to construction staging areas, haul roads, stockpile areas, etc. to the satisfaction of the Consultant. Unless otherwise noted, Contractor is to reinstate all areas to pre-construction condition or better to the satisfaction of the Contract Administrator.

PLANTING

- Plant material to be No. 1 Grade and is to comply with Canadian Standards for Nursery Stock (latest edition) published by the Canadian Nursery Landscape Association. Use structurally sound plant material with strong fibrous root system free of disease, defects, and injuries. Use trees with straight trunks, well and characteristically branched for species. Obtain approval from consultant of plant material at source prior to digging. All trees and shrubs to be container grown, potted, WB or BB, as indicated on Plant List. Bare root plants are only acceptable for certain species and as approved by the Landscape Architect.
- Plant material substitutions are not permitted without the written approval from the Consultant, with 48 hours notice, prior to shipping plant material.
- Plant locations are schematic / approximate only. Contractor is to stake out locations on site for approval by the Landscape Architect prior to installation. Contractor will assume full responsibility if the Landscape Architect is not notified.
- Ensure trees are thoroughly watered following planting. Monitor material and ensure adequate moisture until acceptance.
- In heavy clay or poorly drained soils, set root ball with root collar 75-100mm higher than finished grade.
- Approved topsoil depths are as follows:
 - Plant Beds - 450mm continuous depth. Applies to shrubs, perennials, vines, and groundcovers.
 - Sod/ Seed Areas - 100mm depth.
 - Reforestation - 300mm depth.
- Install a 1.2m sod strip adjacent to all hard surfaces. Note, sod is not typically graphically shown on plans.
- Apply the following mineral fertilizer unless soil tests show other requirements:
 - Plant Beds - (8-32-16), i.e. 8% Nitrogen, 32% Phosphorus, 16% Potash per manufacturer specifications.
 - Sod Areas - (8-32-16), i.e. 8% Nitrogen, 32% Phosphorus, 16% Potash at a rate of 350kg/ha.
- Where applicable, for any plant areas with a mix of species/ cultivars notes, Contractor is to cluster like plants in groups of 3-5 and evenly distribute these in the noted area.

PLANT LIST

KEY	QTY	BOTANICAL NAME	COMMON NAME	SIZE	COND	SPACING
Deciduous Trees						
ARA	4	<i>Acer rubrum 'Autumn Spire'</i>	Autumn Spire Red Maple	50mm Cal	WB	As Shown
QR	2	<i>Quercus rubra</i>	Red Oak	50mm Cal	WB	As Shown
Coniferous Shrubs						
Md	16	<i>Microbiota decussata</i>	Siberian Carpet Cypress	40cm Spr	PT	As Shown
Deciduous Shrubs						
Csa	41	<i>Cornus sericea 'Farrow'</i>	Arctic Fire Dogwood	2g	PT	As Shown
Rag	36	<i>Rhus aromatica 'Gro-Low'</i>	Gro-Low Fragrant Sumac	3g	PT	As Shown
Sss	61	<i>Sorbaria sorbifolia 'Sem'</i>	Sem False Spirea	3g	PT	As Shown

NOTE:
THE POSITION OF ALL POLE LINES, CONDUITS, WATERMANS, SEWERS AND OTHER UNDERGROUND AND OVERGROUND UTILITIES AND STRUCTURES IS NOT NECESSARILY SHOWN ON THE CONTRACT DRAWINGS, AND WHERE SHOWN, THE ACCURACY OF THE POSITION OF SUCH UTILITIES AND STRUCTURES IS NOT GUARANTEED, BEFORE STARTING WORK, DETERMINE THE EXACT LOCATION OF ALL SUCH UTILITIES AND STRUCTURES AND ASSUME ALL LIABILITY FOR DAMAGE TO THEM.

NOT FOR CONSTRUCTION

No.	REVISION	DATE	BY
5.	REVISED PER CITY COMMENTS	MAY 9/22	RJ
4.	REVISED PER CITY COMMENTS	MAR 11/22	RJ
3.	REVISED PER CITY COMMENTS	DEC 10/21	RJ
2.	ISSUED FOR CLIENT REVIEW	NOV 11/21	RJ
1.	ISSUED FOR SITE PLAN APPLICATION	JUL 5/21	RJ

SCALE

1:250

0 2 4 6 8 10

DESIGN

RJ

CHECKED

RJ

DRAWN

MT

CHECKED

MT

APPROVED

RJ

FOR REVIEW ONLY

PROFESSIONAL LANDSCAPE ARCHITECT

MEMBER

MAY 9 2022

NOVATECH

Engineers, Planners & Landscape Architects
 Suite 200, 240 Michael Cowpland Drive
 Ottawa, Ontario, Canada K2M 1P6

Telephone (613) 254-9643
 Facsimile (613) 254-5867
 Website www.novatech-eng.com

LOCATION
CITY OF OTTAWA
THE WOODS, 180 KANATA AVENUE

DRAWING NAME
LANDSCAPE PLAN
EASTERN PORTION AND PARKING

PROJECT NO.
121010-00

REV
REV # 5

DRAWING NO.
121010-L2