

**CITY DETAILS**

Related details from City of Ottawa Standard Tender Documents Volume No. 2 Standard Detail Drawings.

- SC4. Typical Concrete Sidewalk in Boulevard
- SC5. Sidewalk Construction Joints

**NOVATECH DETAILS**

Found on Sheet L2.

- D1. Standard Deciduous Tree Planting
- D2. Standard Coniferous Tree Planting
- D3. Shrub and Perennial Planting
- D4. Bike Layout

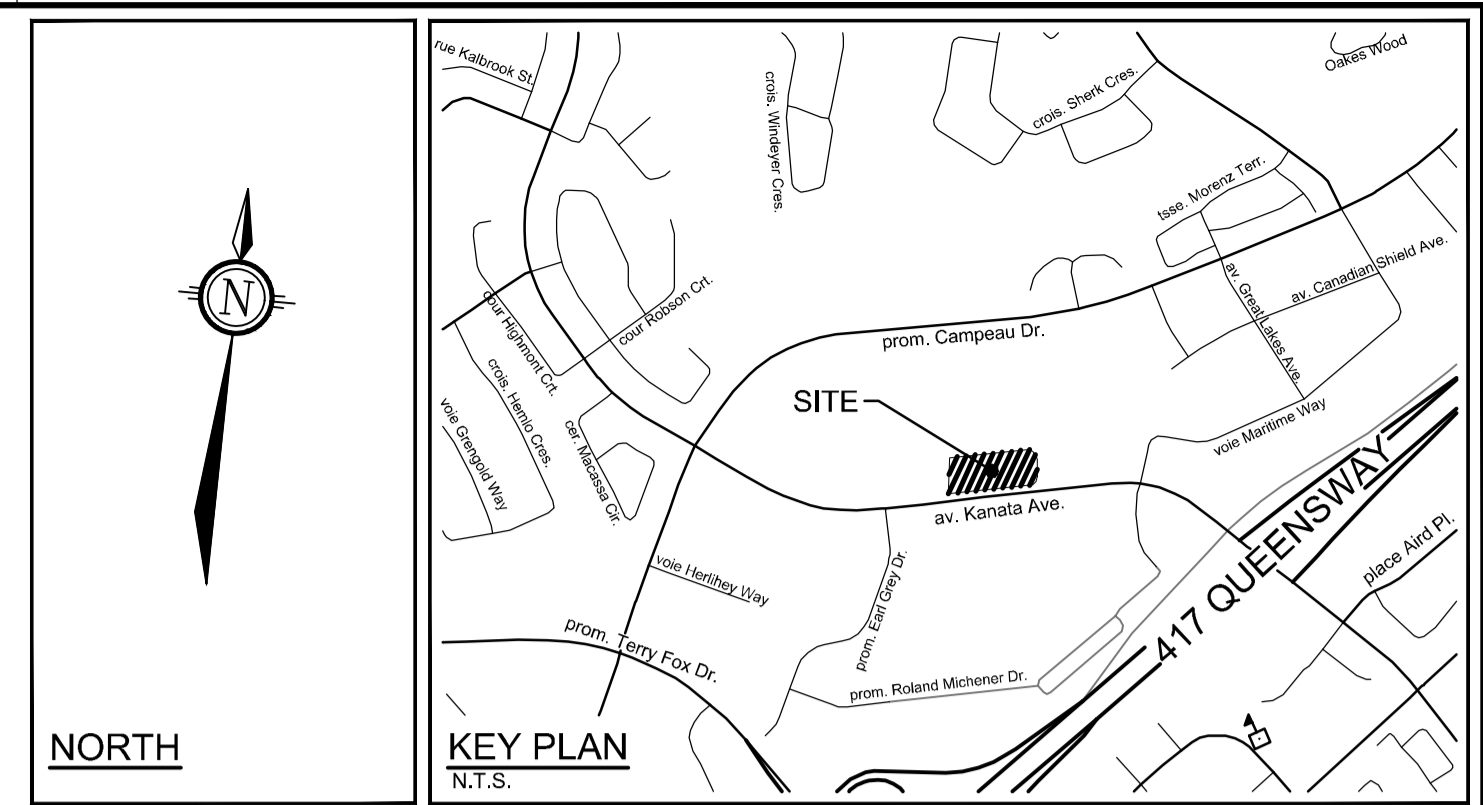

**LEGEND**

- PROPERTY LIMIT
- LIMIT OF UNDERGROUND GARAGE
- [Pattern] PROPOSED CONCRETE
- [Pattern] PROPOSED PAVERS TBD.
- [Pattern] CLEARSTONE
- [Pattern] SOD
- [Pattern] PERENNIALS
- [Symbol] PROPOSED DECIDUOUS TREE
- [Symbol] PROPOSED CONIFEROUS TREE
- [Symbol] PROPOSED SHRUBS
- [Symbol] PROPOSED BLACK CHAIN LINK FENCE 1.5m HT
- [Symbol] PROPOSED DECORATIVE METAL FENCE 1.5m HT
- [Symbol] GATE
- [Symbol] BENCH
- [Symbol] RECEPTACLE
- [Symbol] BICYCLE PARKING
- [Symbol] SPECIES (SEE PLANT LIST)
- [Symbol] QUANTITY

**GENERAL**

1. Read and interpret this drawing/ drawing set in conjunction with all the contract details and specifications, including related civil, utility, structural, architectural, mechanical, electrical, environmental, geotechnical, and survey information.
2. The Contractor is to determine the exact location, size, material, and elevation of all existing utilities prior to commencing construction. Protect and assume responsibility for all existing utilities regardless of being shown on the drawings.
3. It is essential to use the plans and details in conjunction with the specifications and notes.
4. Do not scale drawings. Work to dimensions only.
5. Protect all existing and retained vegetation for the duration of construction according to the contract details and specifications.
6. Reinstatement all areas and items damaged or disturbed, beyond the Limit of Work, because of construction activities, including but not limited to construction staging areas, haul roads, stockpile areas, etc. to the satisfaction of the Consultant. Unless otherwise noted, Contractor is to reinstate all areas to pre-construction condition or better to the satisfaction of the Contract Administrator.

**PLANTING**

1. Plant material to be No. 1 Grade and is to comply with Canadian Standards for Nursery Stock (latest edition) published by the Canadian Nursery Landscape Association. Use structurally sound plant material with strong fibrous root system free of disease, defects, and injuries. Use trees with straight trunks, well and characteristically branched for species. Obtain approval from consultant of plant material at source prior to digging. All trees and shrubs to be container grown, potted, WB or BB, as indicated on Plant List. Bare root plants are only acceptable for certain species and as approved by the Landscape Architect.
2. Plant material substitutions are not permitted without the written approval from the Consultant, with 48 hours notice, prior to shipping plant material.
3. Plant locations are schematic / approximate only. Contractor is to stake out locations on site for approval by the Landscape Architect prior to installation. Contractor will assume full responsibility if the Landscape Architect is not notified.
4. The illustrated number of plants shown in the Planting Plan supersedes the estimated number in the Plant List. Contractor to report any discrepancies to the Landscape Architect prior to installation.
5. Ensure trees are thoroughly watered following planting. Monitor material and ensure adequate moisture until acceptance.
6. In heavy clay or poorly drained soils, set root ball with root collar 75-100mm higher than finished grade.
7. Approved topsoil depths are as follows:
  - a. Plant Beds - 450mm continuous depth. Applies to shrubs, perennials, vines, and groundcovers.
  - b. Sod/ Seed Areas - 100mm depth.
  - c. Reforestation - 300mm depth.
8. Sod to be No. 1 Kentucky Bluegrass Sod grown from minimum mixture of 3 Kentucky Bluegrass cultivars. Quality and source are to comply with Canadian Standards for Nursery Stock, Section 17, (latest edition) published by the Canadian Nursery Landscape Association.
9. Install a 1.2m sod strip adjacent to all hard surfaces. Note, sod is not typically graphically shown on plans.
10. Apply the following mineral fertilizer unless soil tests show other requirements:
  - a. Plant Beds - (8-32-16), i.e. 8% Nitrogen, 32% Phosphorus, 16% Potash per manufacturer specifications.
  - b. Sod Areas - (8-32-16), i.e. 8% Nitrogen, 32% Phosphorus, 16% Potash at a rate of 350kg/ha.
11. Where applicable, for any plant areas with a mix of species/ cultivars notes, Contractor is to cluster like plants in groups of 3-5 and evenly distribute these in the noted area.

**PLANT LIST**

| KEY                     | QTY | BOTANICAL NAME                                  | COMMON NAME                 | SIZE     | COND | SPACING   |
|-------------------------|-----|---|-----------------------------|----------|------|-----------|
| <b>Coniferous Trees</b> |     |   |                             |          |      |           |
| PS                      | 3   | <i>Pinus strobus</i>                            | Eastern White Pine          | 175cm HT | WB   | As Shown  |
| <b>Deciduous Trees</b>  |     |   |                             |          |      |           |
| ARA                     | 5   | <i>Acer rubrum 'Autumn Spice'</i>               | Autumn Spice Red Maple      | 50mm Cal | WB   | As Shown  |
| AS                      | 4   | <i>Acer saccharum</i>                           | Sugar Maple                 | 50mm Cal | WB   | As Shown  |
| ASG                     | 3   | <i>Acer saccharum 'Green Mountain'</i>          | Green Mountain Sugar Maple  | 50mm Cal | WB   | As Shown  |
| AXR                     | 2   | <i>Amelanchier x grandiflora 'Robin Hill'</i>   | Robin Hill Serviceberry     | 50mm Cal | WB   | As Shown  |
| QR                      | 3   | <i>Quercus rubra</i>                            | Red Oak                     | 50mm Cal | WB   | As Shown  |
| <b>Deciduous Shrubs</b> |     |   |                             |          |      |           |
| Ama                     | 190 | <i>Aronia melanocarpa 'Autumn Magic'</i>        | Autumn Magic Chokeberry     | 60cm HT  | PT   | As Shown  |
| Csa                     | 41  | <i>Cornus sericea 'Farrow'</i>                  | Arctic Fire Dogwood         | 2g       | PT   | As Shown  |
| Hf                      | 32  | <i>Hydrangea paniculata 'SMHPLQF'</i>           | Little Quick Fire Hydrangea | 2g       | PT   | As Shown  |
| Hll                     | 47  | <i>Hydrangea paniculata 'Little Lime 'Jane'</i> | Little Lime Hydrangea       | 2g       | PT   | As Shown  |
| Pjg                     | 23  | <i>Rhus aromatica 'Sour Smack'</i>              | Amber Jubilee Nettlebar     | 60cm HT  | PT   | As Shown  |
| Ra                      | 63  | <i>Rhus aromatica</i>                           | Fragrant Sumac              | 3g       | PT   | As Shown  |
| Rag                     | 11  | <i>Rhus aromatica 'Gro-Low'</i>                 | Gro Low Fragrant Sumac      | 3g       | PT   | As Shown  |
| Rt                      | 10  | <i>Rhus typhina</i>                             | Staghorn Sumac              | 7g       | PT   | As Shown  |
| Ssa                     | 39  | <i>Sorbaria sorbifolia 'Sem'</i>                | Sem False Spiraea           | 3g       | PT   | As Shown  |
| <b>Perennials</b>       |     |   |                             |          |      |           |
| Hbz                     | 96  | <i>Hemerocallis 'Bonanza'</i>                   | Bonanza Daylily             | 1g       | PT   | 30cm O.C. |
| Hth                     | 96  | <i>Hemerocallis 'Frans Hals'</i>                | Frans Hals Daylily          | 1g       | PT   | 30cm O.C. |
| Hth                     | 111 | <i>Hosta 'Halcyon'</i>                          | Halcyon Hosta               | 1g       | PT   | 90cm O.C. |

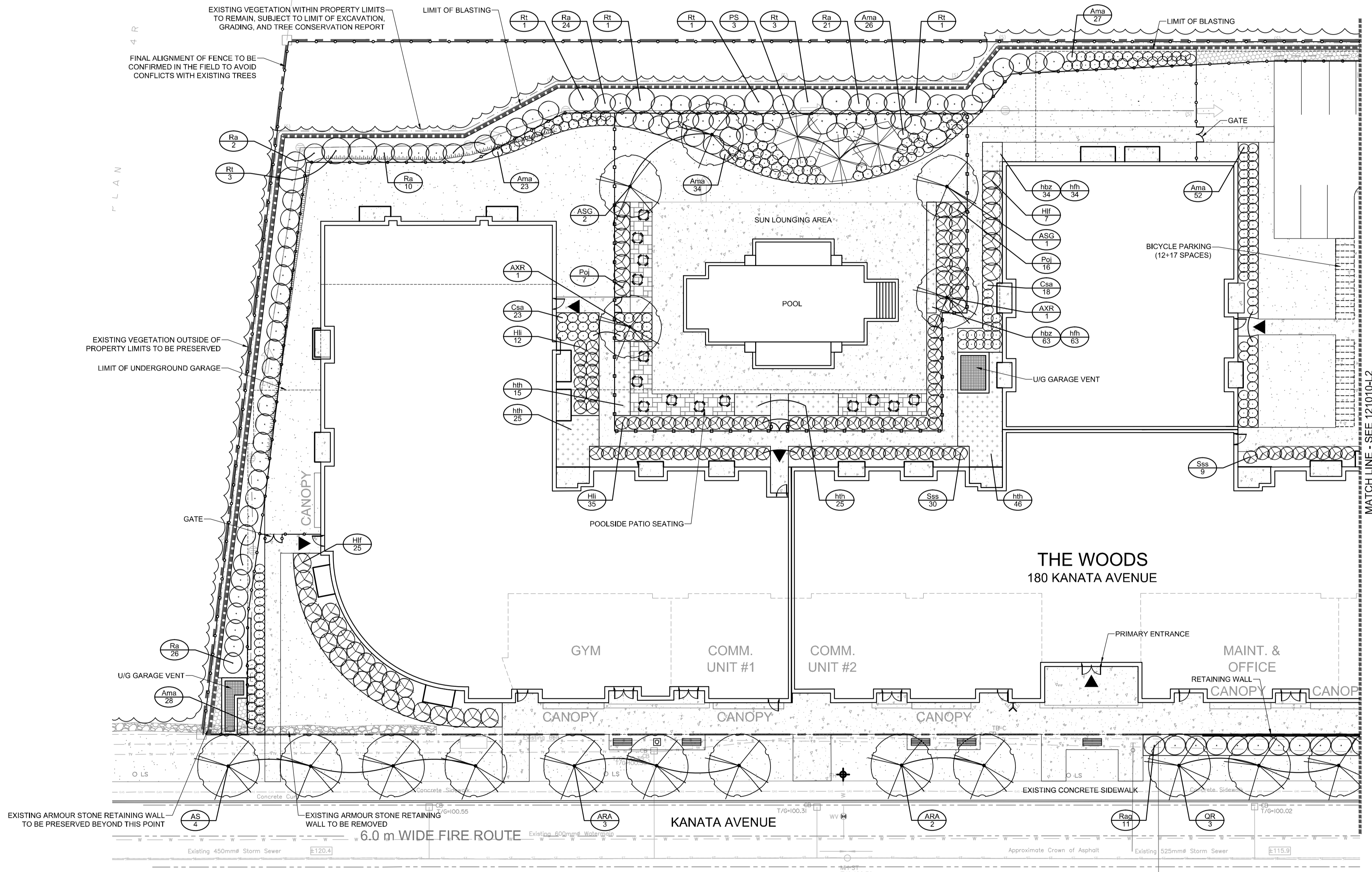

**NOTE:**  
THE POSITION OF ALL POLE LINES, CONDUITS, WATERMANS, SEWERS AND OTHER UNDERGROUND AND OVERGROUND UTILITIES AND STRUCTURES IS NOT NECESSARILY SHOWN ON THE CONTRACT DRAWINGS, AND WHERE SHOWN, THE ACCURACY OF THE POSITION OF SUCH UTILITIES AND STRUCTURES IS NOT GUARANTEED. BEFORE STARTING WORK, DETERMINE THE EXACT LOCATION OF ALL SUCH UTILITIES AND STRUCTURES AND ASSUME ALL LIABILITY FOR DAMAGE TO THEM.

**NOT FOR CONSTRUCTION**

| No. | REVISION                         | DATE      | BY |
|-----|----------------------------------|-----------|----|
| 5.  | REVISED PER CITY COMMENTS        | MAY 9/22  | RJ |
| 4.  | REVISED PER CITY COMMENTS        | MAR 11/22 | RJ |
| 3.  | REVISED PER CITY COMMENTS        | DEC 10/21 | RJ |
| 2.  | ISSUED FOR CLIENT REVIEW         | NOV 11/21 | RJ |
| 1.  | ISSUED FOR SITE PLAN APPLICATION | JUL 9/21  | RJ |

**SCALE**

1:250

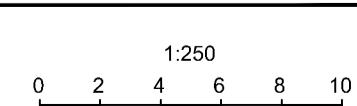

|          |    |
|----------|----|
| DESIGN   | RJ |
| CHECKED  | RJ |
| DRAWN    | MT |
| CHECKED  | MT |
| APPROVED | RJ |

**FOR REVIEW ONLY**



**NOVATECH**  
Engineers, Planners & Landscape Architects  
Suite 200, 240 Michael Cowpland Drive  
Ottawa, Ontario, Canada K2M 1P6  
Telephone (613) 254-9643  
Facsimile (613) 254-5867  
Website www.novatech-eng.com

**LOCATION**  
CITY OF OTTAWA  
THE WOODS, 180 KANATA AVENUE

**DRAWING NAME**  
LANDSCAPE PLAN  
WESTERN PORTION  
AND POOL AREA

PROJECT No.  
121010-00  
REV  
REV # 5  
DRAWING No.

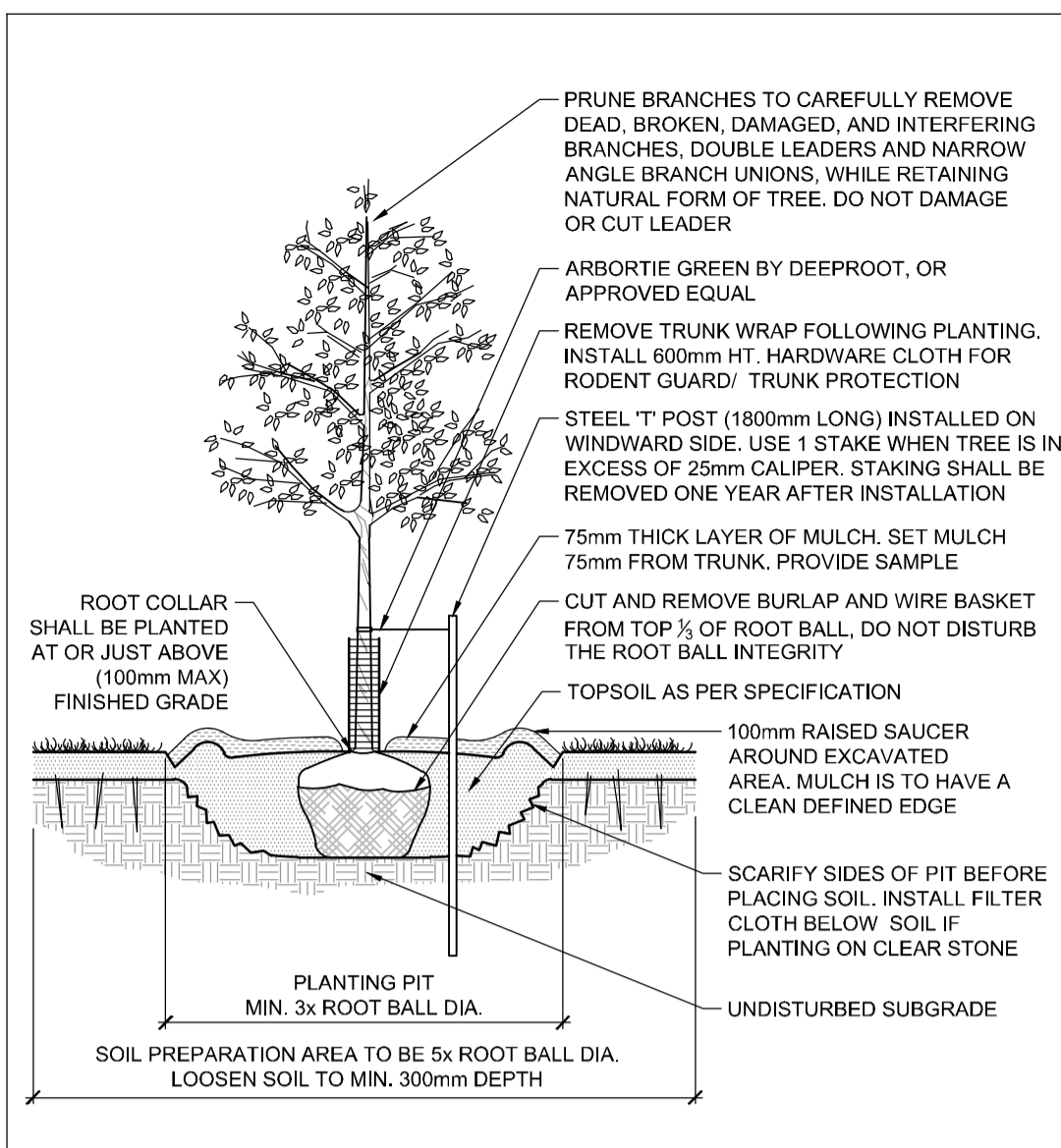

DECIDUOUS TREE PLANTING D1

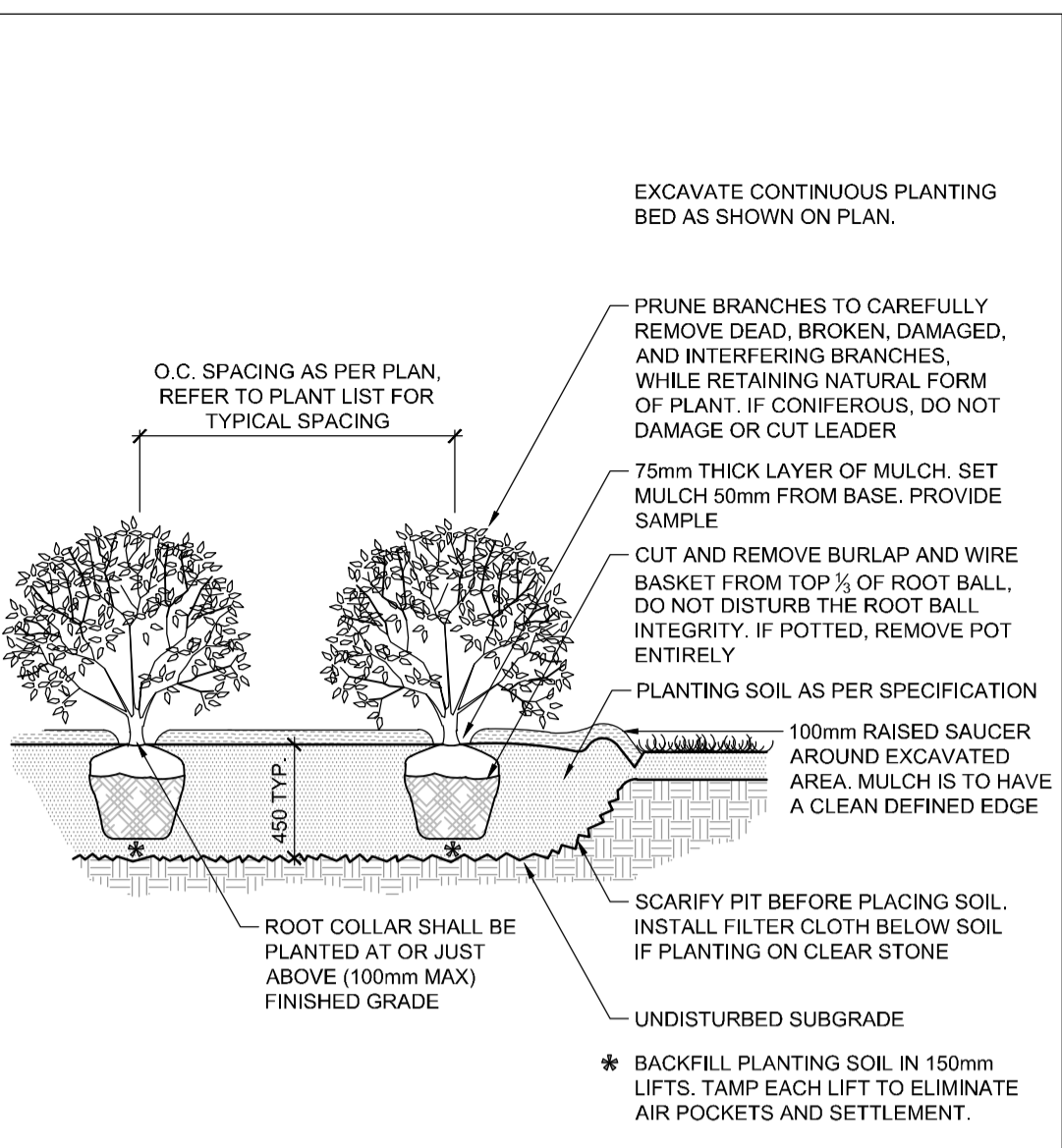

SHRUB AND PERENNIAL PLANTING D2

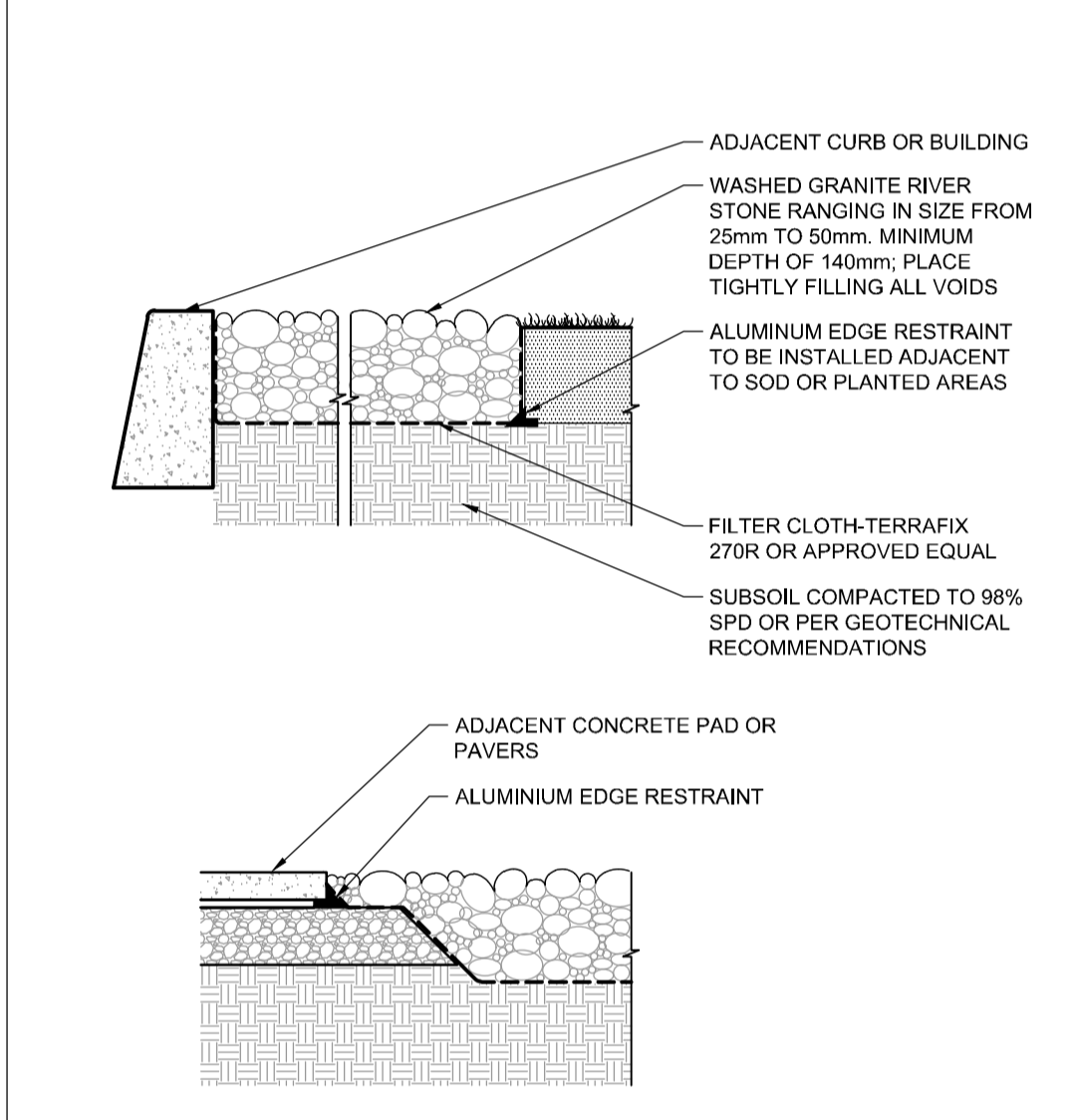

RIVER STONE D3

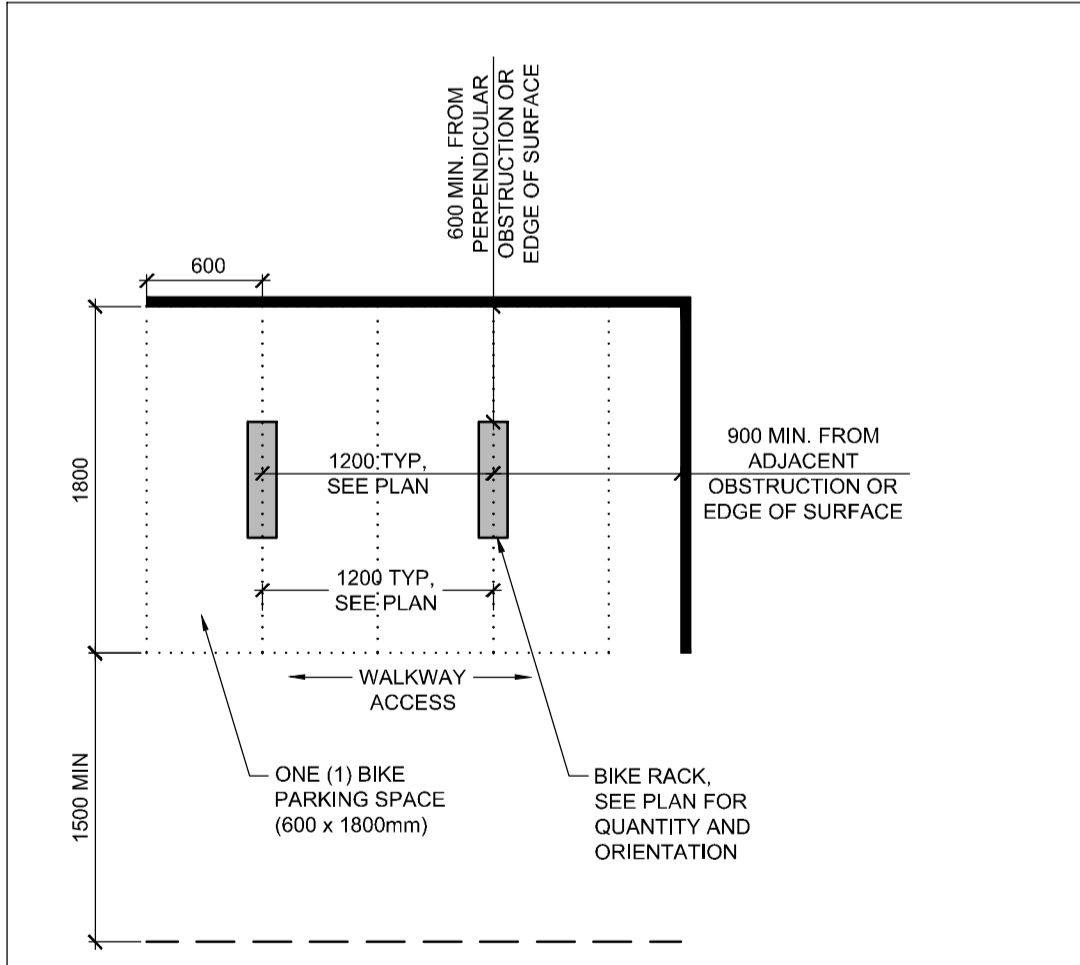

BIKE PARKING LAYOUT D4

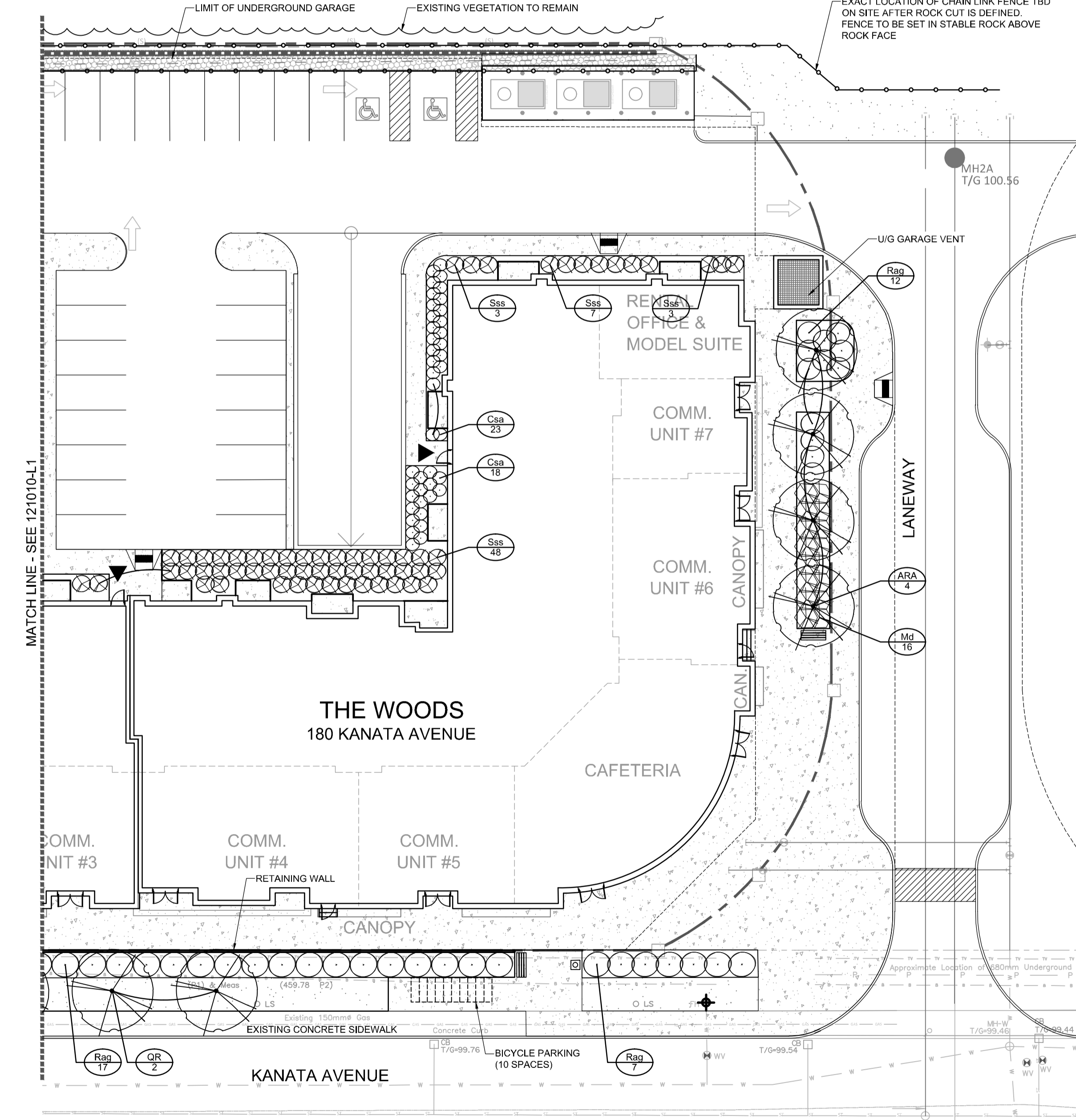

CITY DETAILS  
Related details from City of Ottawa Standard Tender Documents Volume No. 2 Standard Detail Drawings.  
SC4. Typical Concrete Sidewalk in Boulevard  
SC5. Sidewalk Construction Joints

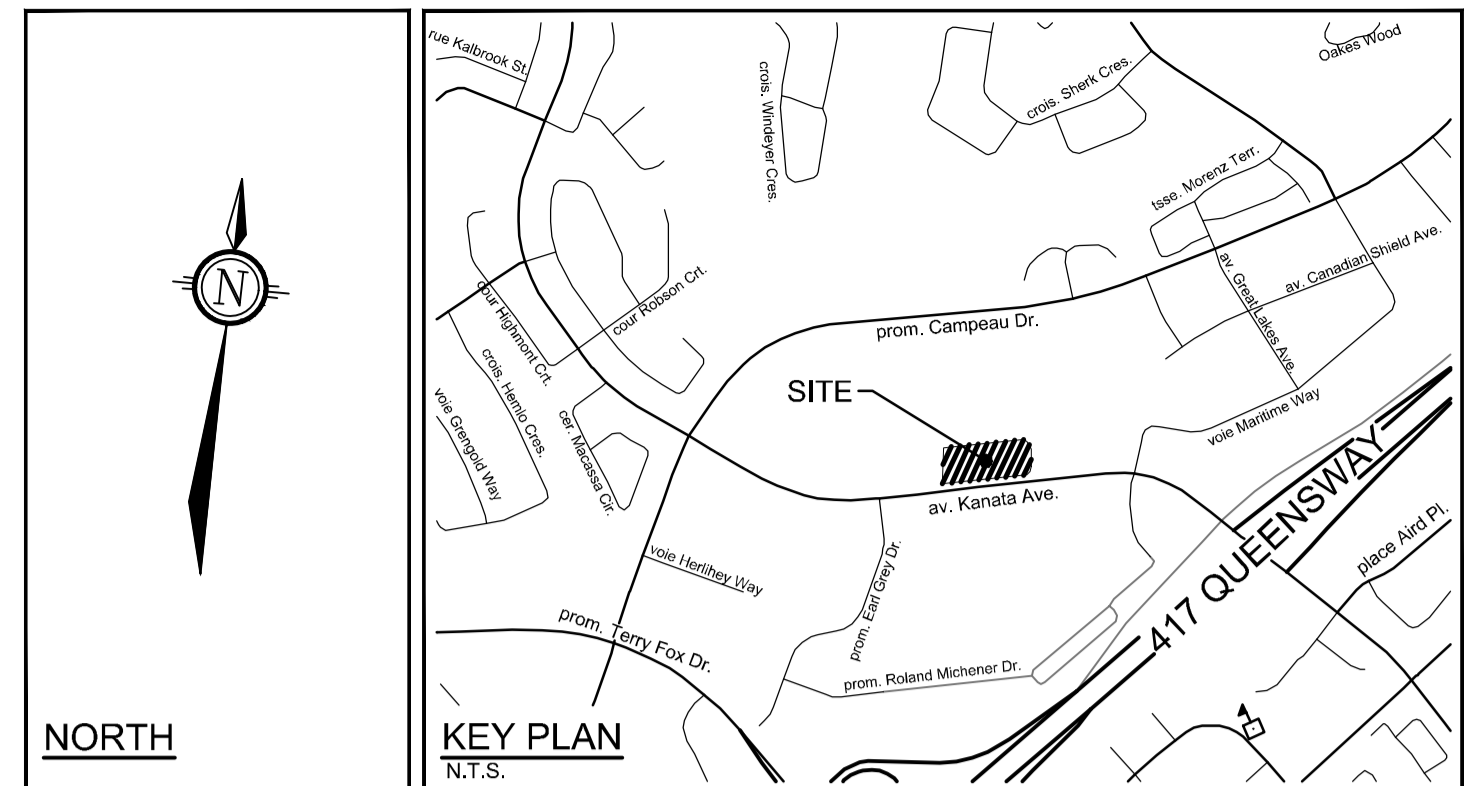

- LEGEND
- PROPERTY LIMIT
  - LIMIT OF UNDERGROUND GARAGE
  - PROPOSED CONCRETE
  - PROPOSED PAVERS TBD.
  - CLEARSTONE
  - SOD
  - PERENNIALS
  - PROPOSED DECIDUOUS TREE
  - PROPOSED CONIFEROUS TREE
  - PROPOSED SHRUBS
  - PROPOSED BLACK CHAIN LINK FENCE 1.5m HT
  - PROPOSED DECORATIVE METAL FENCE 1.5m HT
  - GATE
  - BENCH
  - RECEPTACLE
  - BICYCLE PARKING
  - SPECIES (SEE PLANT LIST)
  - QUANTITY
- GENERAL
- Read and interpret this drawing/ drawing set in conjunction with all the contract details and specifications, including related civil, utility, structural, architectural, mechanical, electrical, environmental, geotechnical, and survey information.
  - The Contractor is to determine the exact location, size, material, and elevation of all existing utilities prior to commencing construction. Protect and assume responsibility for all existing utilities regardless of being shown on the drawings.
  - It is essential to use the plans and details in conjunction with the specifications and notes.
  - Do not scale drawings. Work to dimensions only.
  - Protect all existing and retained vegetation for the duration of construction according to the contract details and specifications.
  - Reinstate all areas and items damaged or disturbed, beyond the Limit of Work, because of construction activities, including but not limited to construction staging areas, haul roads, stockpile areas, etc. to the satisfaction of the Consultant. Unless otherwise noted, Contractor is to reinstate all areas to pre-construction condition or better to the satisfaction of the Contract Administrator.

- PLANTING
- Plant material to be No. 1 Grade and is to comply with Canadian Standards for Nursery Stock (latest edition) published by the Canadian Nursery Landscape Association. Use structurally sound plant material with strong fibrous root system free of disease, defects, and injuries. Use trees with straight trunks, well and characteristically branched for species. Obtain approval from consultant of plant material at source prior to digging. All trees and shrubs to be container grown, potted, WB or BB, as indicated on Plant List. Bare root plants are only acceptable for certain species and as approved by the Landscape Architect.
  - Plant material substitutions are not permitted without the written approval from the Consultant, with 48 hours notice, prior to shipping plant material.
  - Plant locations are schematic / approximate only. Contractor is to stake out locations on site for approval by the Landscape Architect prior to installation. Contractor will assume full responsibility if the Landscape Architect is not notified.
  - Ensure trees are thoroughly watered following planting. Monitor material and ensure adequate moisture until acceptance.
  - In heavy clay or poorly drained soils, set root ball with root collar 75-100mm higher than finished grade.
  - Approved topsoil depths are as follows:
    - Plant Beds - 450mm continuous depth. Applies to shrubs, perennials, vines, and groundcovers.
    - Sod/ Seed Areas - 100mm depth.
    - Reforestation - 300mm depth.
  - Install a 1.2m sod strip adjacent to all hard surfaces. Note, sod is not typically graphically shown on plans.
  - Apply the following mineral fertilizer unless soil tests show other requirements:
    - Plant Beds - (8-32-16), i.e. 8% Nitrogen, 32% Phosphorus, 16% Potash per manufacturer specifications.
    - Sod Areas - (8-32-16), i.e. 8% Nitrogen, 32% Phosphorus, 16% Potash at a rate of 350kg/ha.
  - Where applicable, for any plant areas with a mix of species/ cultivars notes, Contractor is to cluster like plants in groups of 3-5 and evenly distribute these in the noted area.

PLANT LIST

| KEY                      | QTY | BOTANICAL NAME                    | COMMON NAME             | SIZE     | COND | SPACING  |
|--------------------------|-----|-----------------------------------|-------------------------|----------|------|----------|
| <b>Deciduous Trees</b>   |     |                                   |                         |          |      |          |
| ARA                      | 4   | <i>Acer rubrum 'Autumn Spire'</i> | Autumn Spire Red Maple  | 50mm Cal | WB   | As Shown |
| QR                       | 2   | <i>Quercus rubra</i>              | Red Oak                 | 50mm Cal | WB   | As Shown |
| <b>Coniferous Shrubs</b> |     |                                   |                         |          |      |          |
| Md                       | 16  | <i>Microbiota decussata</i>       | Siberian Carpet Cypress | 40cm Spr | PT   | As Shown |
| <b>Deciduous Shrubs</b>  |     |                                   |                         |          |      |          |
| Csa                      | 41  | <i>Cornus sericea 'Farrow'</i>    | Arctic Fire Dogwood     | 2g       | PT   | As Shown |
| Rag                      | 36  | <i>Rhus aromatica 'Gro-Low'</i>   | Gro-Low Fragrant Sumac  | 3g       | PT   | As Shown |
| Sss                      | 61  | <i>Sorbaria sorbifolia 'Sem'</i>  | Sem False Spirea        | 3g       | PT   | As Shown |

NOTE:  
THE POSITION OF ALL POLE LINES, CONDUITS, WATERMANS, SEWERS AND OTHER UNDERGROUND AND OVERGROUND UTILITIES AND STRUCTURES IS NOT NECESSARILY SHOWN ON THE CONTRACT DRAWINGS, AND WHERE SHOWN, THE ACCURACY OF THE POSITION OF SUCH UTILITIES AND STRUCTURES IS NOT GUARANTEED, BEFORE STARTING WORK, DETERMINE THE EXACT LOCATION OF ALL SUCH UTILITIES AND STRUCTURES AND ASSUME ALL LIABILITY FOR DAMAGE TO THEM.

NOT FOR CONSTRUCTION

| No. | REVISION                         | DATE      | BY |
|-----|----------------------------------|-----------|----|
| 5.  | REVISED PER CITY COMMENTS        | MAY 9/22  | RJ |
| 4.  | REVISED PER CITY COMMENTS        | MAR 11/22 | RJ |
| 3.  | REVISED PER CITY COMMENTS        | DEC 10/21 | RJ |
| 2.  | ISSUED FOR CLIENT REVIEW         | NOV 11/21 | RJ |
| 1.  | ISSUED FOR SITE PLAN APPLICATION | JUL 5/21  | RJ |

SCALE

1:250

0 2 4 6 8 10

| DESIGN | CHECKED | DRAWN | CHECKED | APPROVED |
|--------|---------|-------|---------|----------|
| RJ     | RJ      | MT    | MT      | RJ       |

FOR REVIEW ONLY

PROFESSIONAL LANDSCAPE ARCHITECT

NOVATECH

Engineers, Planners & Landscape Architects  
Suite 200, 240 Michael Cowpland Drive  
Ottawa, Ontario, Canada K2M 1P6

Telephone (613) 254-9643  
Facsimile (613) 254-5867  
Website www.novatech-eng.com

| LOCATION                                       | DRAWING NO. | PROJECT NO. |
|--|-------------|-------------|
| CITY OF OTTAWA<br>THE WOODS, 180 KANATA AVENUE | 121010-00   | 121010-00   |
| LANDSCAPE PLAN<br>EASTERN PORTION AND PARKING  | REV # 5     |             |
|  | DRAWING NO. | 121010-L2   |