

CITY DETAILS

Related details from City of Ottawa Standard Tender Documents
Volume No. 2 Standard Detail Drawings.

- SC4. Typical Concrete Sidewalk in Boulevard
- SC5. Sidewalk Construction Joints

NOVATECH DETAILS

Found on Sheet L2.

- D1. Standard Deciduous Tree Planting
- D2. Standard Coniferous Tree Planting
- D3. Shrub and Perennial Planting
- D4. Bike Layout

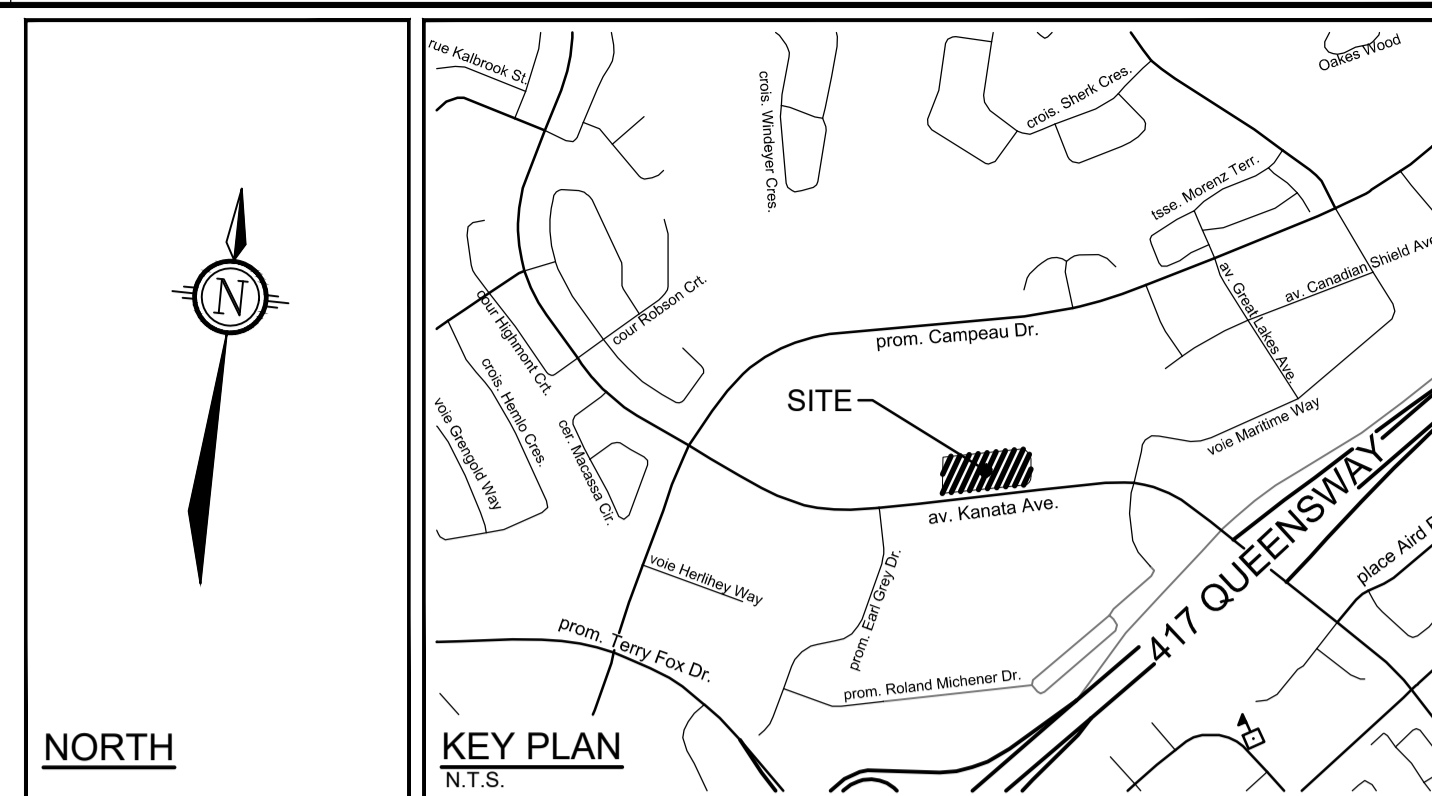

LEGEND

- PROPERTY LIMIT
- LIMIT OF UNDERGROUND GARAGE
- [Pattern] PROPOSED CONCRETE
- [Pattern] PROPOSED PAVERS TBD.
- [Pattern] SOD
- [Pattern] PERENNIALS
- [Symbol] PROPOSED DECIDUOUS TREE
- [Symbol] PROPOSED CONIFEROUS TREE
- [Symbol] PROPOSED SHRUBS
- [Symbol] PROPOSED BLACK CHAIN LINK FENCE 1.5m HT
- [Symbol] PROPOSED DECORATIVE METAL FENCE 1.5m HT
- [Symbol] GATE
- [Symbol] BENCH
- [Symbol] RECEPTACLE
- [Symbol] SPECIES (SEE PLANT LIST)
- [Symbol] QUANTITY

GENERAL

1. Read and interpret this drawing/ drawing set in conjunction with all the contract details and specifications, including related civil, utility, structural, architectural, mechanical, electrical, environmental, geotechnical, and survey information.
2. The Contractor is to determine the exact location, size, material, and elevation of all existing utilities prior to commencing construction. Protect and assume responsibility for all existing utilities regardless of being shown on the drawings.
3. It is essential to use the plans and details in conjunction with the specifications and notes.
4. Do not scale drawings. Work to dimensions only.
5. Protect all existing and retained vegetation for the duration of construction according to the contract details and specifications.
6. Reinstale all areas and items damaged or disturbed, beyond the Limit of Work, because of construction activities, including but not limited to construction staging areas, haul roads, stockpile areas, etc. to the satisfaction of the Consultant. Unless otherwise noted, Contractor is to reinstale all areas to pre-construction condition or better to the satisfaction of the Contract Administrator.

PLANTING

1. Plant material to be No. 1 Grade and is to comply with Canadian Standards for Nursery Stock (latest edition) published by the Canadian Nursery Landscape Association. Use structurally sound plant material with strong fibrous root system free of disease, defects, and injuries. Use trees with straight trunks, well and characteristically branched for species. Obtain approval from consultant of plant material at source prior to digging. All trees and shrubs to be container grown, potted, W/B or B/B, as indicated on Plant List. Bare root plants are only acceptable for certain species and as approved by the Landscape Architect.
2. Plant material substitutions are not permitted without the written approval from the Consultant, with 48 hours notice, prior to shipping plant material.
3. Plant locations are schematic / approximate only. Contractor is to stake out locations on site for approval by the Landscape Architect prior to installation. Contractor will assume full responsibility if the Landscape Architect is not notified.
4. The illustrated number of plants shown in the Planting Plan supersedes the estimated number in the Plant List. Contractor to report any discrepancies to the Landscape Architect prior to installation. Contractor will assume full responsibility if the Landscape Architect is not notified.
5. Ensure trees are thoroughly watered following planting. Monitor material and ensure adequate moisture until acceptance.
6. In heavy clay or poorly drained soils, set root ball with root collar 75-100mm higher than finished grade.
7. Approved topsoil depths are as follows:
 - a. Plant Beds - 450mm continuous depth. Applies to shrubs, perennials, vines, and groundcovers.
 - b. Sod/ Seed Areas - 100mm depth.
 - c. Reforestation - 300mm depth.
8. Sod to be No. 1 Kentucky Bluegrass Sod grown from minimum mixture of 3 Kentucky Bluegrass cultivars. Quality and source are to comply with Canadian Standards for Nursery Stock, Section 17, (latest edition) published by the Canadian Nursery Landscape Association.
9. Install a 1.2m sod strip adjacent to all hard surfaces. Note, sod is not typically graphically shown on plans.
10. Apply the following mineral fertilizer unless soil tests show other requirements:
 - a. Plant Beds - (8-32-16), i.e. 8% Nitrogen, 32% Phosphorus, 16% Potash per manufacturer specifications.
 - b. Sod Areas - (8-32-16), i.e. 8% Nitrogen, 32% Phosphorus, 16% Potash at a rate of 350kg/ha.
11. Where applicable, for any plant areas with a mix of species/ cultivars notes, Contractor is to cluster like plants in groups of 3-5 and evenly distribute these in the noted area.

PLANT LIST

KEY	QTY	BOTANICAL NAME	COMMON NAME	SIZE	COND	SPACING
Coniferous Trees						
PS	3	<i>Pinus strobus</i>	Eastern White Pine	175cm Ht	WB	As Shown
Deciduous Trees						
ARA	4	<i>Acer rubrum 'Autumn Spire'</i>	Autumn Spire Red Maple	50mm Cal	WB	As Shown
AXR	2	<i>Amelanchier x grandiflora 'Robin Hill'</i>	Robin Hill Serviceberry	50mm Cal	WB	As Shown
ASG	3	<i>Acer saccharum 'Green Mountain'</i>	Green Mountain Sugar Maple	50mm Cal	WB	As Shown
QR	3	<i>Quercus rubra</i>	Red Oak	50mm Cal	WB	As Shown
SRI	6	<i>Syringa reticulata 'Ivory Silk'</i>	Ivory Silk Japanese Tree Lilac	50mm Cal	WB	As Shown
Deciduous Shrubs						
Ama	165	<i>Aronia melanocarpa 'Autumn Magic'</i>	Autumn Magic Chokecherry	60cm Ht	PT	As Shown
Csa	51	<i>Cornus sericea 'Farrow'</i>	Arctic Fire Dogwood	2g	PT	As Shown
Hil	43	<i>Hydrangea paniculata 'Little Lime 'Jane'</i>	Little Lime Hydrangea	2g	PT	As Shown
Hil	23	<i>Hydrangea paniculata 'SMHPLQF'</i>	Little Quick Fire Hydrangea	2g	PT	As Shown
Paj	25	<i>Physocarpus opulifolius 'JEFAM'</i>	Amber Jubilee Ninebark	60cm Ht	PT	As Shown
Ra	91	<i>Rhus aromatica</i>	Fragrant Sumac	3g	PT	As Shown
Rag	46	<i>Rhus aromatica 'Gro-Low'</i>	Gro Low Fragrant Sumac	3g	PT	As Shown
Rt	11	<i>Rhus typhina</i>	Staghorn Sumac	7g	PT	As Shown
Sss	39	<i>Sorbaria sorbifolia 'Sem'</i>	Sem False Spirea	3g	PT	As Shown
Perennials						
hbc	203	<i>Hemerocallis 'Bonanza'</i>	Bonanza Daylily	1g	PT	30cm O.C.
hth	203	<i>Hemerocallis 'Frans Hals'</i>	Frans Hals Daylily	1g	PT	30cm O.C.
hth	117	<i>Hosta 'Halcyon'</i>	Halcyon Hosta	1g	PT	90cm O.C.

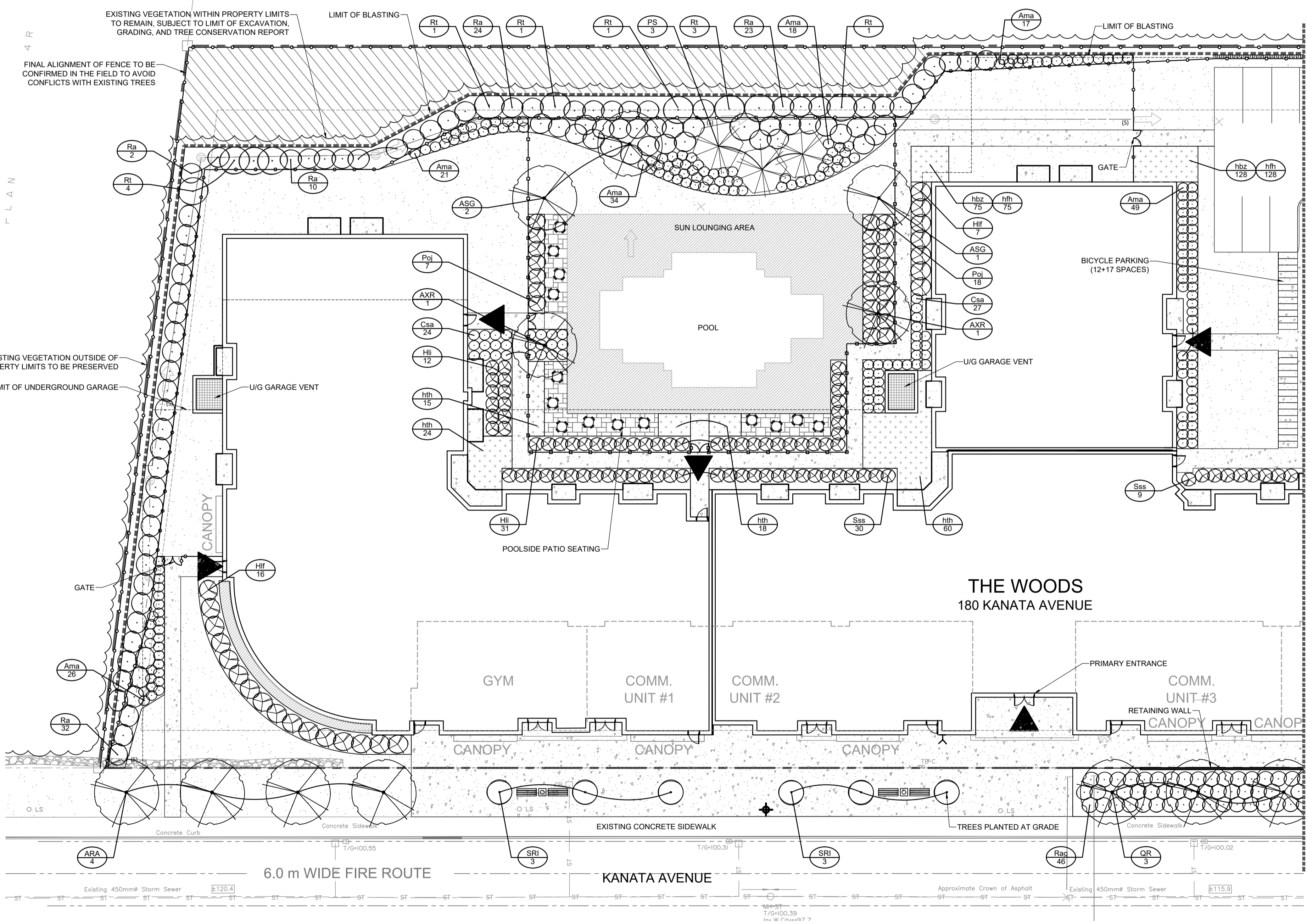

NOTE:
THE POSITION OF ALL POLE LINES, CONDUITS, WATERMANS, SEWERS AND OTHER UNDERGROUND AND OVERGROUND UTILITIES AND STRUCTURES IS NOT NECESSARILY SHOWN ON THE CONTRACT DRAWINGS, AND WHERE SHOWN, THE ACCURACY OF THE POSITION OF SUCH UTILITIES AND STRUCTURES IS NOT GUARANTEED. BEFORE STARTING WORK, DETERMINE THE EXACT LOCATION OF ALL SUCH UTILITIES AND STRUCTURES AND ASSUME ALL LIABILITY FOR DAMAGE TO THEM.

NOT FOR CONSTRUCTION

No.	REVISION	DATE	BY
3.	REVISED PER CITY COMMENTS	DEC 10/21	RJ
2.	ISSUED FOR CLIENT REVIEW	NOV 11/21	RJ
1.	ISSUED FOR SITE PLAN APPLICATION	JUL 5/21	RJ

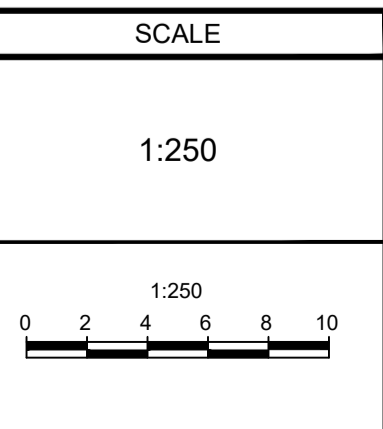

DESIGN	CHECKED	DRAWN	APPROVED
RJ	RJ	MT	MT
			RJ

FOR REVIEW ONLY



NOVATECH
Engineers, Planners & Landscape Architects
Suite 200, 240 Michael Cowpland Drive
Ottawa, Ontario, Canada K2M 1P6
Telephone (613) 254-9643
Facsimile (613) 254-5867
Website www.novatech-eng.com

LOCATION	DRAWING NAME	PROJECT No.
CITY OF OTTAWA THE WOODS, 180 KANATA AVENUE	LANDSCAPE WESTERN PORTION AND POOL AREA	121010-00
		REV # 3
		DRAWING No.
		121010-L1

M:\2021\121010\CADD\Landscapes\Plan\121010_L.dwg, L1, Dec 10, 2021, 10:27am, kjarrafly

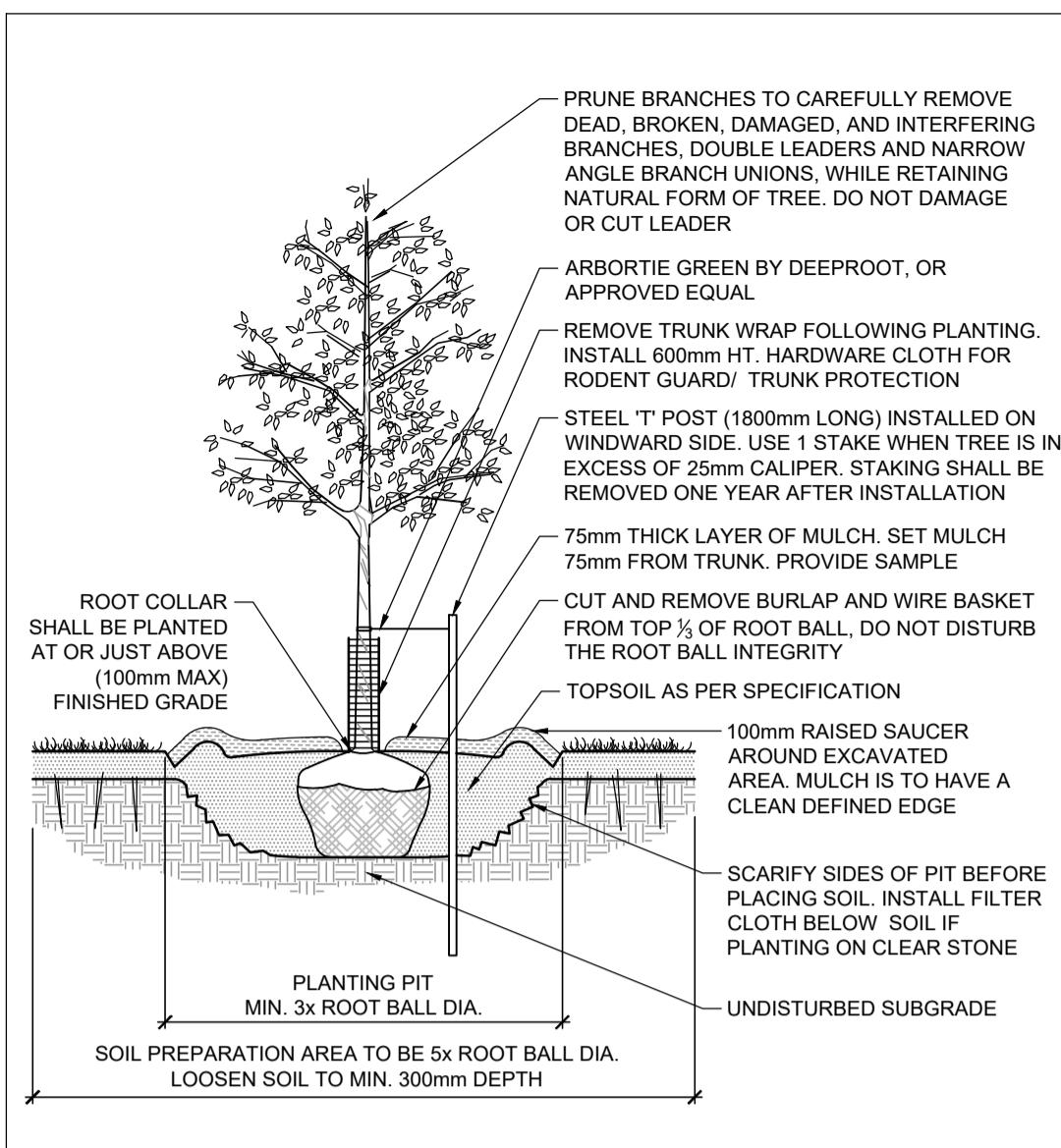

DECIDUOUS TREE PLANTING D1

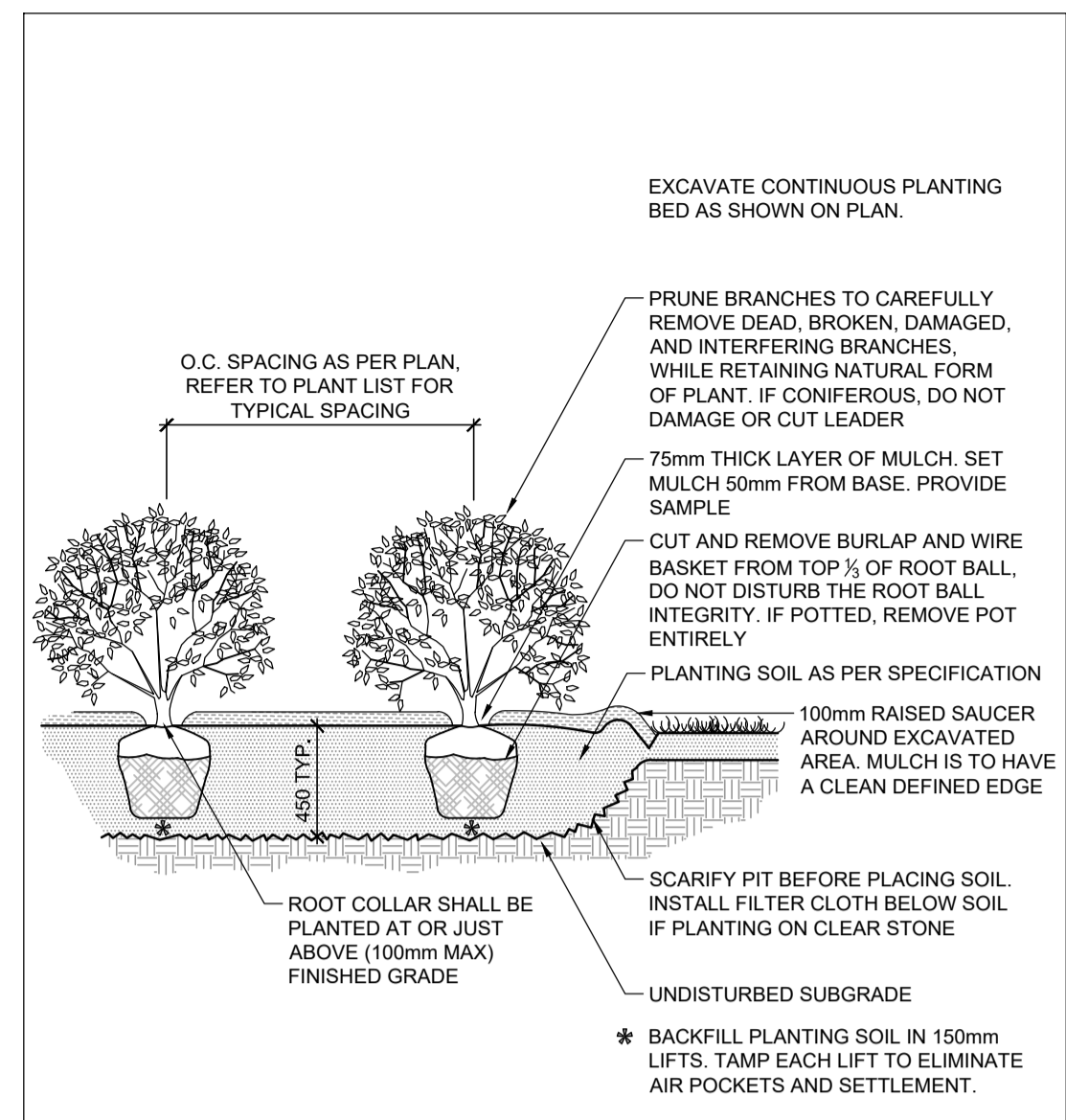

SHRUB AND PERENNIAL PLANTING D2

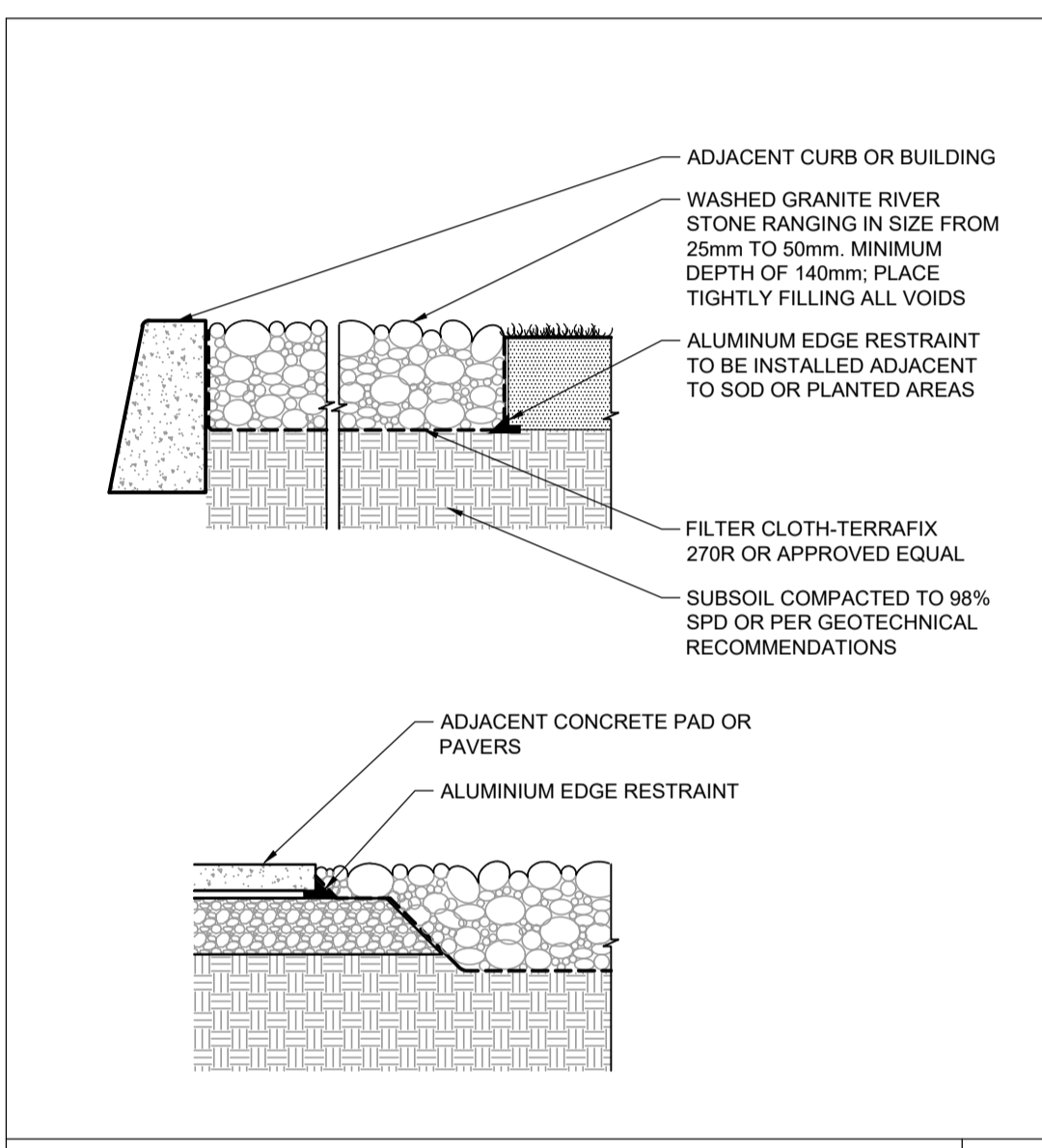

RIVER STONE D3

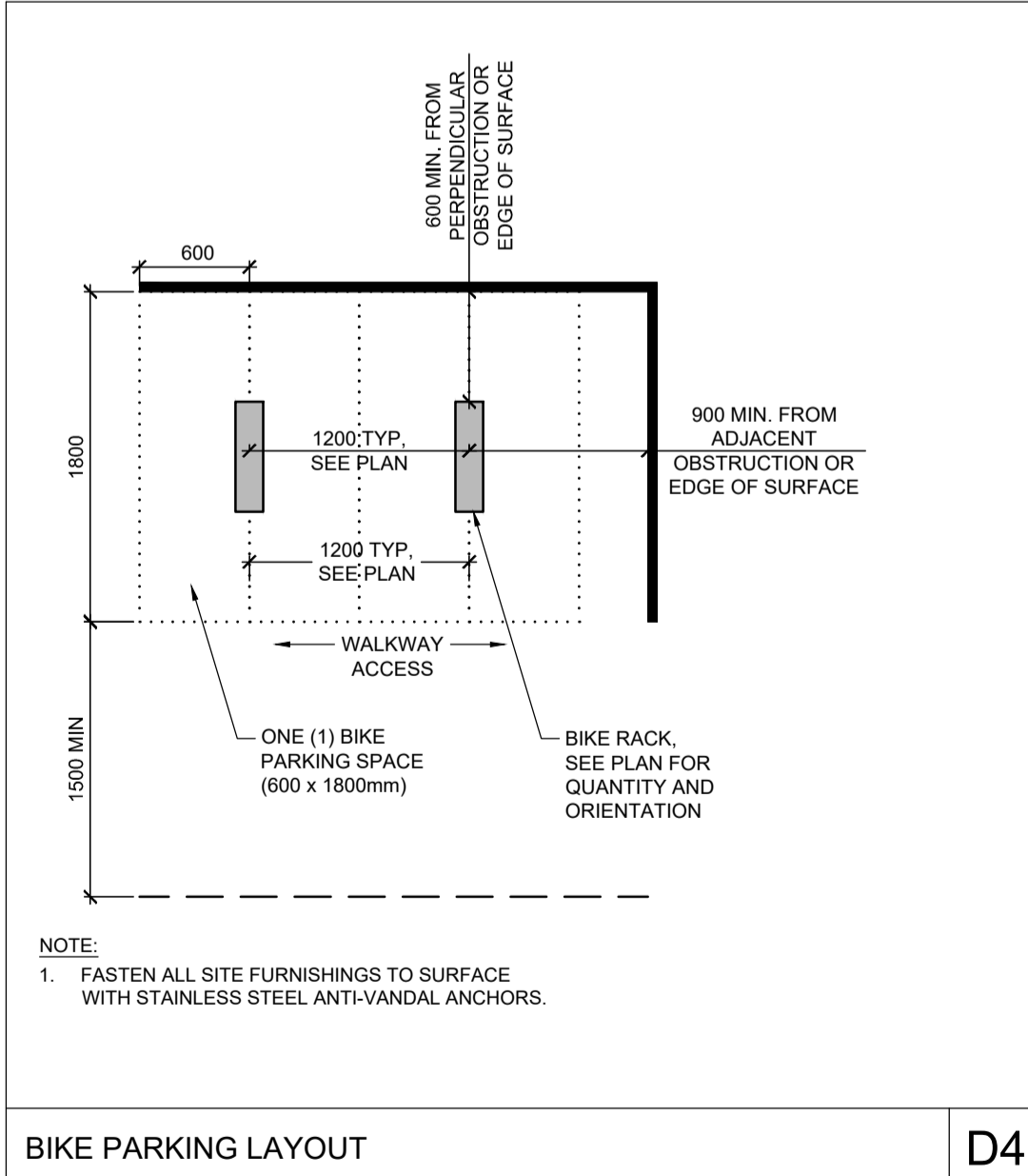

BIKE PARKING LAYOUT D4

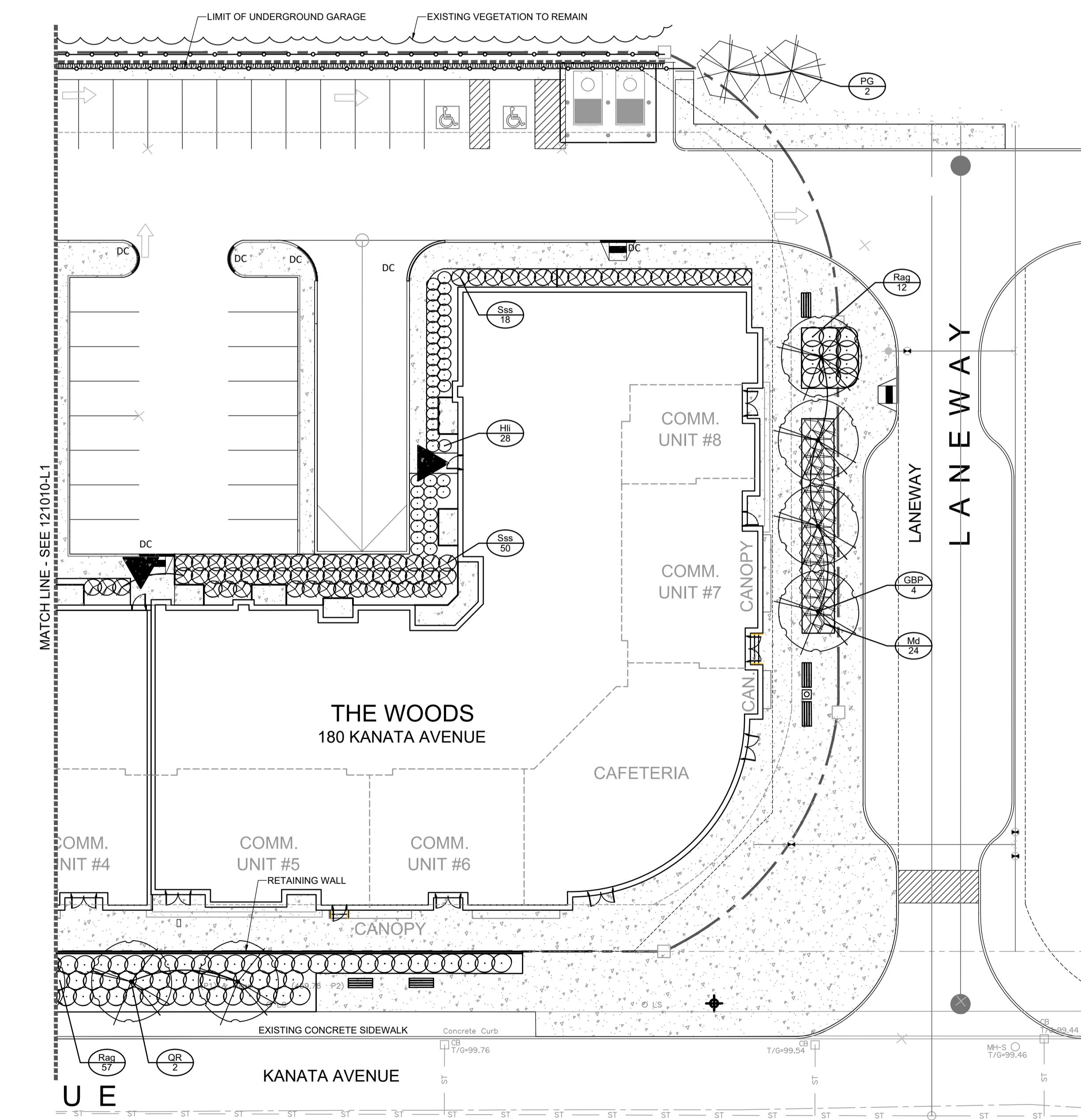

CITY DETAILS
 Related details from City of Ottawa Standard Tender Documents Volume No. 2 Standard Detail Drawings.
 SC4. Typical Concrete Sidewalk in Boulevard
 SC5. Sidewalk Construction Joints

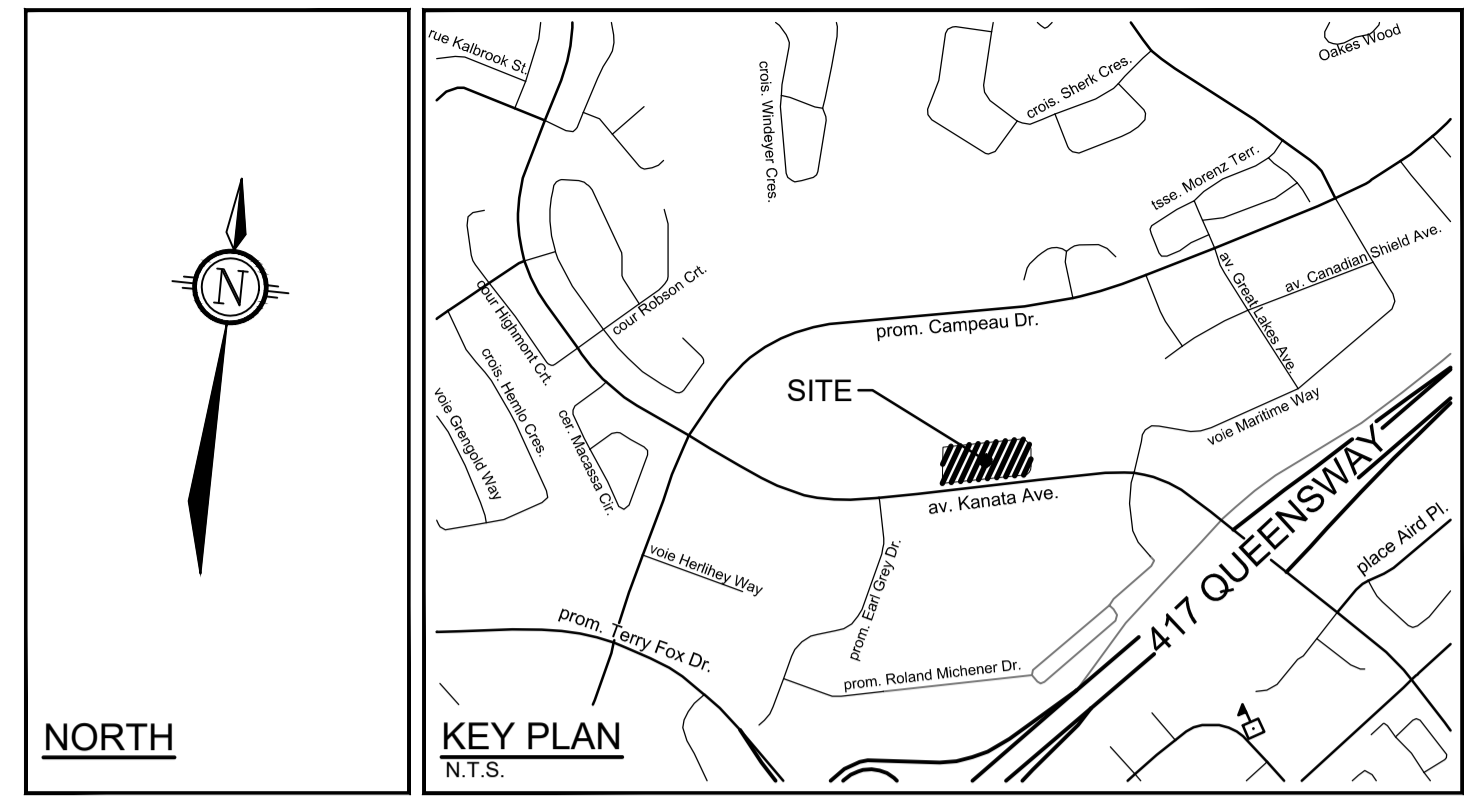

- LEGEND**
- PROPERTY LIMIT
 - LIMIT OF UNDERGROUND GARAGE
 - PROPOSED CONCRETE
 - PROPOSED PAVERS TBD.
 - SOD
 - PERENNIALS
 - PROPOSED DECIDUOUS TREE
 - PROPOSED CONIFEROUS TREE
 - PROPOSED SHRUBS
 - PROPOSED BLACK CHAIN LINK FENCE 1.5m HT
 - PROPOSED DECORATIVE METAL FENCE 1.5m HT
 - GATE
 - BENCH
 - RECEPTACLE
 - SPECIES (SEE PLANT LIST)
 - QUANTITY
- GENERAL**
- Read and interpret this drawing/ drawing set in conjunction with all the contract details and specifications, including related civil, utility, structural, architectural, mechanical, electrical, environmental, geotechnical, and survey information.
 - The Contractor is to determine the exact location, size, material, and elevation of all existing utilities prior to commencing construction. Protect and assume responsibility for all existing utilities regardless of being shown on the drawings.
 - It is essential to use the plans and details in conjunction with the specifications and notes.
 - Do not scale drawings. Work to dimensions only.
 - Protect all existing and retained vegetation for the duration of construction according to the contract details and specifications.
 - Reinstate all areas and items damaged or disturbed, beyond the Limit of Work, because of construction activities, including but not limited to construction staging areas, haul roads, stockpile areas, etc. to the satisfaction of the Consultant. Unless otherwise noted, Contractor is to reinstate all areas to pre-construction condition or better to the satisfaction of the Contract Administrator.

- PLANTING**
- Plant material to be No. 1 Grade and is to comply with Canadian Standards for Nursery Stock (latest edition) published by the Canadian Nursery Landscape Association. Use structurally sound plant material with strong fibrous root system free of disease, defects, and injuries. Use trees with straight trunks, well and characteristically branched for species. Obtain approval from consultant of plant material at source prior to digging. All trees and shrubs to be container grown, potted, WB or BB, as indicated on Plant List. Bare root plants are only acceptable for certain species and as approved by the Landscape Architect.
 - Plant material substitutions are not permitted without the written approval from the Consultant, with 48 hours notice, prior to shipping plant material.
 - Plant locations are schematic / approximate only. Contractor is to stake out locations on site for approval by the Landscape Architect prior to installation. Contractor will assume full responsibility if the Landscape Architect is not notified.
 - The illustrated number of plants shown in the Planting Plan supersedes the estimated number in the Plant List. Contractor to report any discrepancies to the Landscape Architect prior to installation. Contractor will assume full responsibility if the Landscape Architect is not notified.
 - Ensure trees are thoroughly watered following planting. Monitor material and ensure adequate moisture until acceptance.
 - In heavy clay or poorly drained soils, set root ball with root collar 75-100mm higher than finished grade.
 - Approved topsoil depths are as follows:
 - Plant Beds - 450mm continuous depth. Applies to shrubs, perennials, vines, and groundcovers.
 - Sod/ Seed Areas - 100mm depth.
 - Reforestation - 300mm depth.
 - Sod to be No. 1 Kentucky Bluegrass Sod grown from minimum mixture of 3 Kentucky Bluegrass cultivars. Quality and source are to comply with Canadian Standards for Nursery Stock, Section 17, (latest edition) published by the Canadian Nursery Landscape Nursery Landscape Association.
 - Install a 1.2m sod strip adjacent to all hard surfaces. Note, sod is not typically graphically shown on plans.
 - Apply the following mineral fertilizer unless soil tests show other requirements:
 - Plant Beds - (8-32-16), i.e. 8% Nitrogen, 32% Phosphorus, 16% Potash per manufacturer specifications.
 - Sod Areas - (8-32-16), i.e. 8% Nitrogen, 32% Phosphorus, 16% Potash at a rate of 350kg/ha.
 - Where applicable, for any plant areas with a mix of species/ cultivars notes, Contractor is to cluster like plants in groups of 3-5 and evenly distribute these in the noted area.

PLANT LIST

KEY	QTY	BOTANICAL NAME	COMMON NAME	SIZE	COND	SPACING
Coniferous Trees						
PG	2	<i>Picea glauca</i>	White Spruce	200cm Ht	WB	As Shown
Deciduous Trees						
GBP	4	<i>Ginkgo biloba 'Princeton Sentry'</i>	Princeton Sentry Ginkgo	45mm Cal	WB	As Shown
QR	2	<i>Quercus rubra</i>	Red Oak	50mm Cal	WB	As Shown
Coniferous Shrubs						
MJ	24	<i>Microbiota decussata</i>	Siberian Carpet Cypress	40cm Spr	PT	As Shown
Deciduous Shrubs						
Csa	44	<i>Cornus sericea 'Farrow'</i>	Arctic Fire Dogwood	2g	PT	As Shown
Rag	69	<i>Rhus aromatica 'Gro-Low'</i>	Gro Low Fragrant Sumac	3g	PT	As Shown
Sss	58	<i>Sorbaria sorbifolia 'Sem'</i>	Sem False Spiraea	3g	PT	As Shown

NOTE: THE POSITION OF ALL POLE LINES, CONDUITS, WATERMANS, SEWERS AND OTHER UNDERGROUND AND OVERGROUND UTILITIES AND STRUCTURES IS NOT NECESSARILY SHOWN ON THE CONTRACT DRAWINGS, AND WHERE SHOWN, THE ACCURACY OF THE POSITION OF SUCH UTILITIES AND STRUCTURES IS NOT GUARANTEED. BEFORE STARTING WORK, DETERMINE THE EXACT LOCATION OF ALL SUCH UTILITIES AND STRUCTURES AND ASSUME ALL LIABILITY FOR DAMAGE TO THEM.

NOT FOR CONSTRUCTION

No.	REVISION	DATE	BY
3.	REVISED PER CITY COMMENTS	DEC 10/21	RJ
2.	ISSUED FOR CLIENT REVIEW	NOV 11/21	RJ
1.	ISSUED FOR SITE PLAN APPLICATION	JUL 5/21	RJ

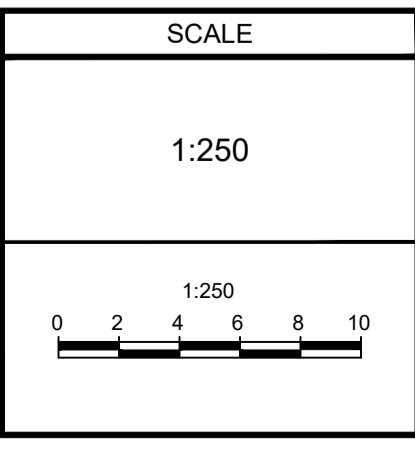

DESIGN	CHECKED	DRAWN	APPROVED
RJ	RJ	MT	MT
RJ	MT	MT	RJ

FOR REVIEW ONLY



NOVATECH
 Engineers, Planners & Landscape Architects
 Suite 200, 240 Michael Cowpland Drive
 Ottawa, Ontario, Canada K2M 1P6
 Telephone: (613) 254-9643
 Facsimile: (613) 254-5867
 Website: www.novatech-eng.com

LOCATION CITY OF OTTAWA THE WOODS, 180 KANATA AVENUE	PROJECT No. 121010-00
DRAWING NAME LANDSCAPE EASTERN PORTION AND PARKING	REV # REV # 3
	DRAWING No. 121010-L2

M:\2021\121010\CADD\Landscapes\Plan\121010_L.dwg, L2, Dec. 10, 2021, 10:27am, kkanaflyov